

INDEX TO DRAWINGS	
SHEET NO.	DESCRIPTION
1	TITLE SHEET
2	STANDARD PLANS SUMMARY
3	NOTES
4-6	TYPICAL ROADWAY SECTIONS
7-9	DEMOLITION PLANS
10-12	GEOMETRIC LAYOUT PLAN
13-15	ROADWAY PLANS
16	PROFILES
17-19	GRADING PLANS
20-23	CROSS SECTIONS
24	MISCELLANEOUS DETAILS
25	PAVEMENT MARKING, STRIPING AND SIGNAGE NOTES AND LEGEND
26-28	PAVEMENT MARKING, SIGNS AND STRIPING PLANS
29-30	TRAFFIC CONTROL PLANS
31-35	CONSTRUCTION PHASING PLANS
36	TRAFFIC SUMMARY
37-46	ELECTRICAL PLANS
47-51	TRAFFIC SIGNALIZATION PLANS

STATE OF HAWAII
DEPARTMENT OF TRANSPORTATION
HIGHWAYS DIVISION
HONOLULU, HAWAII
"AS-BUILT"
PLANS FOR
WILIKINA DRIVE
INTERSECTION IMPROVEMENTS
AT McNAIR GATE SCHOFIELD BARRACKS
PROJECT NO. 99C-02-00

DISTRICT OF WAHIAWA
ISLAND OF OAHU

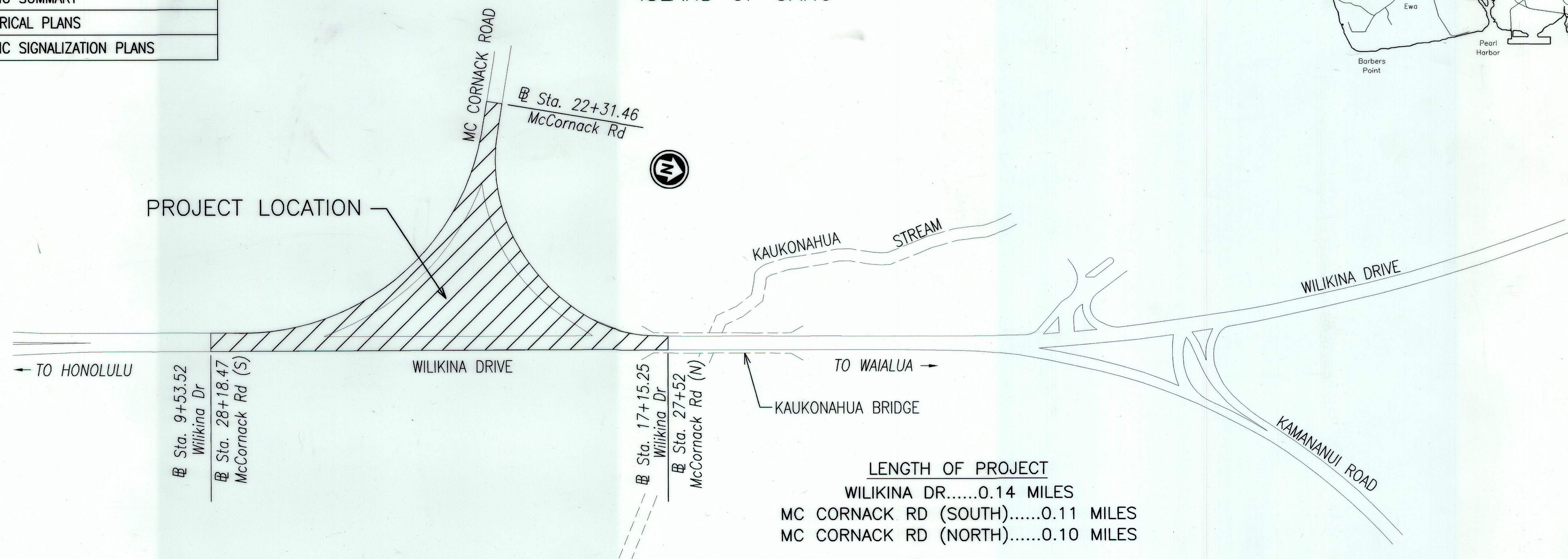

LAYOUT PLAN
NOT TO SCALE

FED. ROAD DIST. NO.	STATE	PROJ. NO.	FISCAL YEAR	SHEET NO.	TOTAL SHEETS
HAWAII	HAW.	99C-02-00	2001	1	51

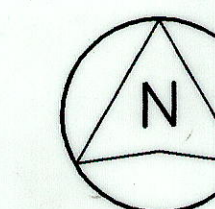
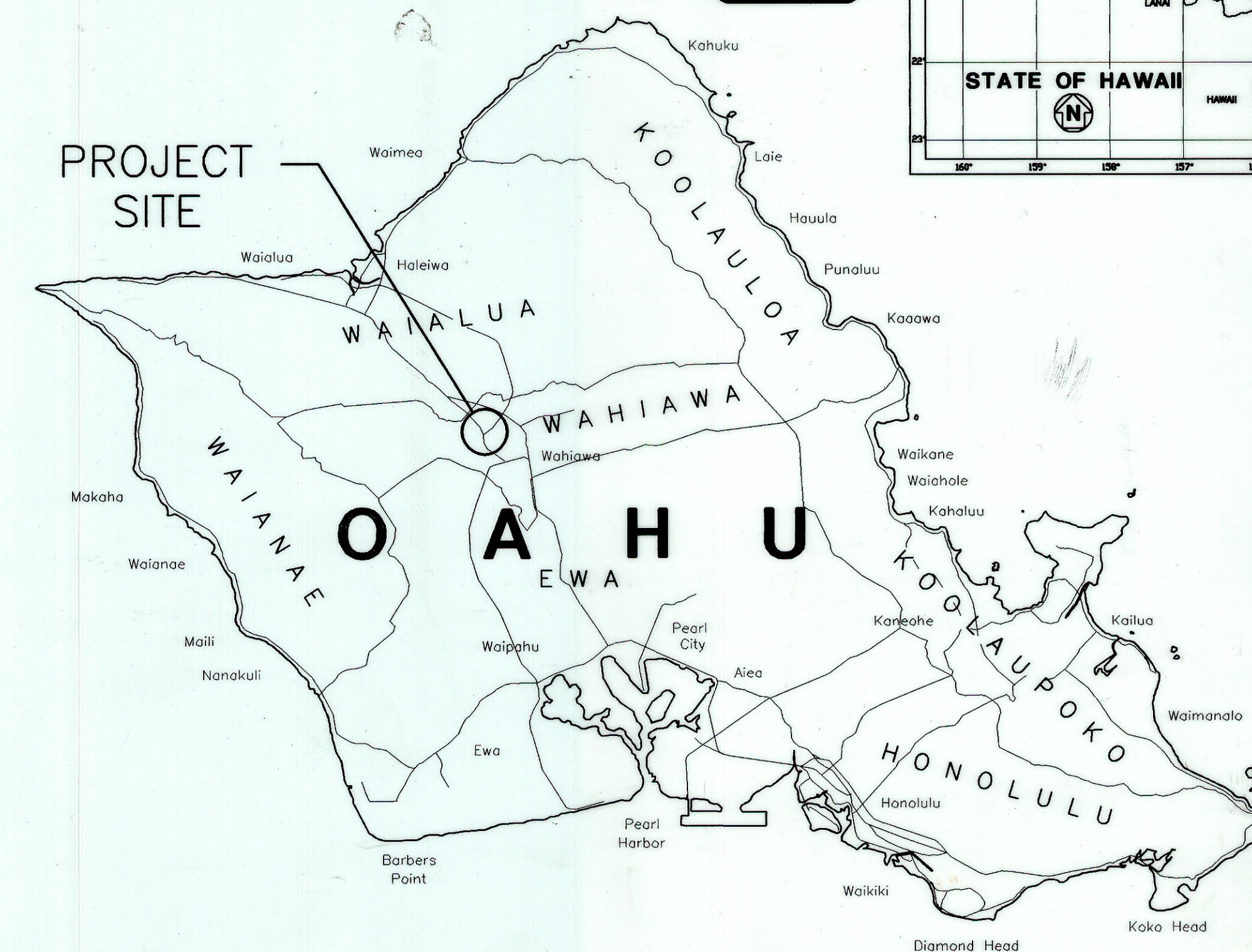
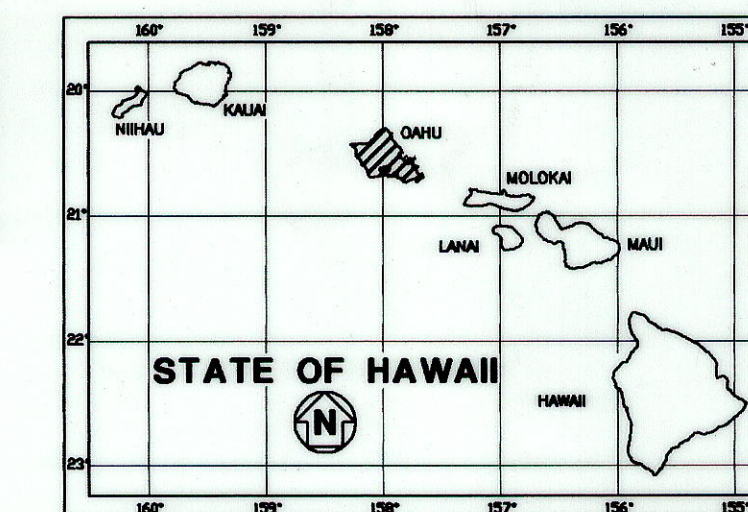
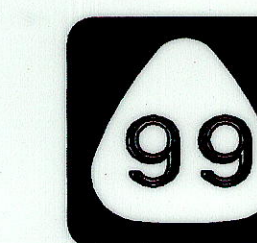

4 0 4 8
SCALE IN MILES

MILE POST 7.88 TO MILE POST 8.01

LENGTH OF PROJECT
WILIKINA DR.....0.14 MILES
MC CORNACK RD (SOUTH).....0.11 MILES
MC CORNACK RD (NORTH).....0.10 MILES

CHANGES MADE DURING CONSTRUCTION HAVE BEEN INCORPORATED ON THESE PLANS EXCEPT CHANGES IN THE ORIGINAL THEORETICAL QUANTITIES. FOR ACTUAL QUANTITIES, REFER TO PROJECT LEDGER AND/OR COMPUTATION BOOK.
[Signature] 3/21/01
RESIDENT ENGINEER DATE

DEPARTMENT OF TRANSPORTATION
STATE OF HAWAII
APPROVED:
[Signature] 3-21-01
for DIR. OF TRANSPORTATION DATE

ESH, INC.
DESIGNED BY:
H. KENNEDY
P.S. & E BY
692-7550
PHONE
MAR. 2001
DATE