

FED. ROAD DIST. NO.	STATE	FED. AID PROJ. NO.	FISCAL YEAR	SHEET NO.	TOTAL SHEETS
HAWAII	HAW.	NH-099-1(16)	1996	5	12

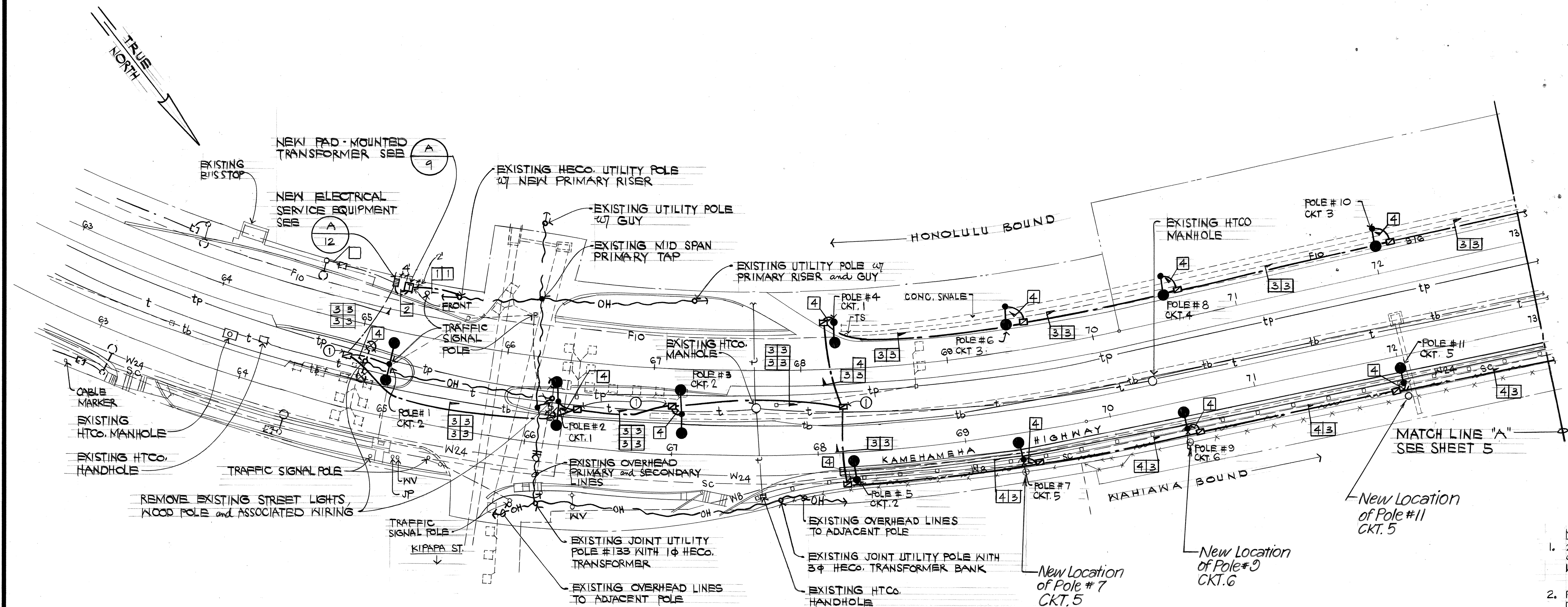

**ELECTRICAL SITE PLAN #1**  
SCALE: 1" = 40' - 0"

Sta. 68+15±Rt. to Sta. 73+00±Rt.  
New Location of concealed Conduit  
Below Grade.

- NOTES:**
- 2'x4' PULLBOX - HTCO STANDARD 435TB WITH CHECKER PLATE COVERS, ENGRAVE COVER WITH "STREET LIGHTING" IDENTIFIED ON PLAN BY "①".
  - PATCH ALL PAVEMENT, SIDEWALKS, CURBS, ETC. DAMAGED BY INSTALLATION OF NEW HIGHWAY LIGHTING SYSTEM TO MATCH EXISTING CONDITIONS.

- Notes:**
- Pull Boxes for Pole No. 5, 7, 9, 11, 12, 14, 16, 18, 20 and 22 to Remain at Same Original Location.
  - 6-Foot Mast Arms for Pole No. 7, 9, 11, 12, 14, 16, 18 and 20 have been changed to 10-Foot Mast Arms.

**GRAPHIC SCALE**

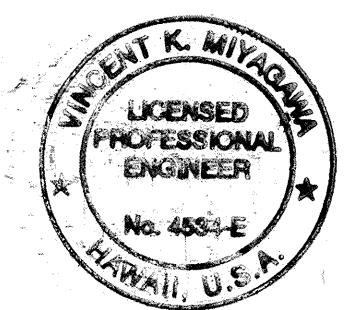
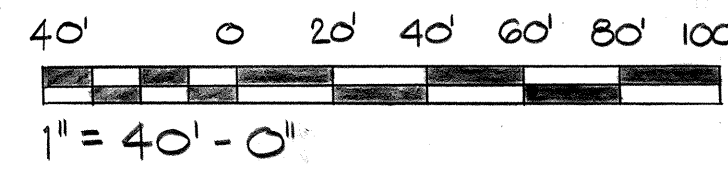

THIS WORK WAS PREPARED BY  
ME OR UNDER MY SUPERVISION

By: *[Signature]*  
Its: PROJECT ENGINEER  
Date: 5-22-92

STATE OF HAWAII  
DEPARTMENT OF TRANSPORTATION  
HIGHWAYS DIVISION

**ELECTRICAL SITE  
PLAN #1**

KAMEHAMEHA HIGHWAY - INSTALLATION OF HIGHWAY LIGHTS  
KIPAPA STREET TO WAIKALANI DRIVE  
PROJECT NO. NH-099-1(16)

SCALE: NO SCALE DATE:  
SHEET NO. 5 OF 12 SHEETS

ORIGINAL PLAN	SURVEY PLOTTED BY	DATE
NOTE BOOK	DRAWN BY	
	CHECKED BY	
	QUANTITIES BY	



FED. ROAD DIST. NO.	STATE	FED. AID PROJ. NO.	FISCAL YEAR	SHEET NO.	TOTAL SHEETS
HAWAII	HAW.	NH-099-1(16)	1996	6	12

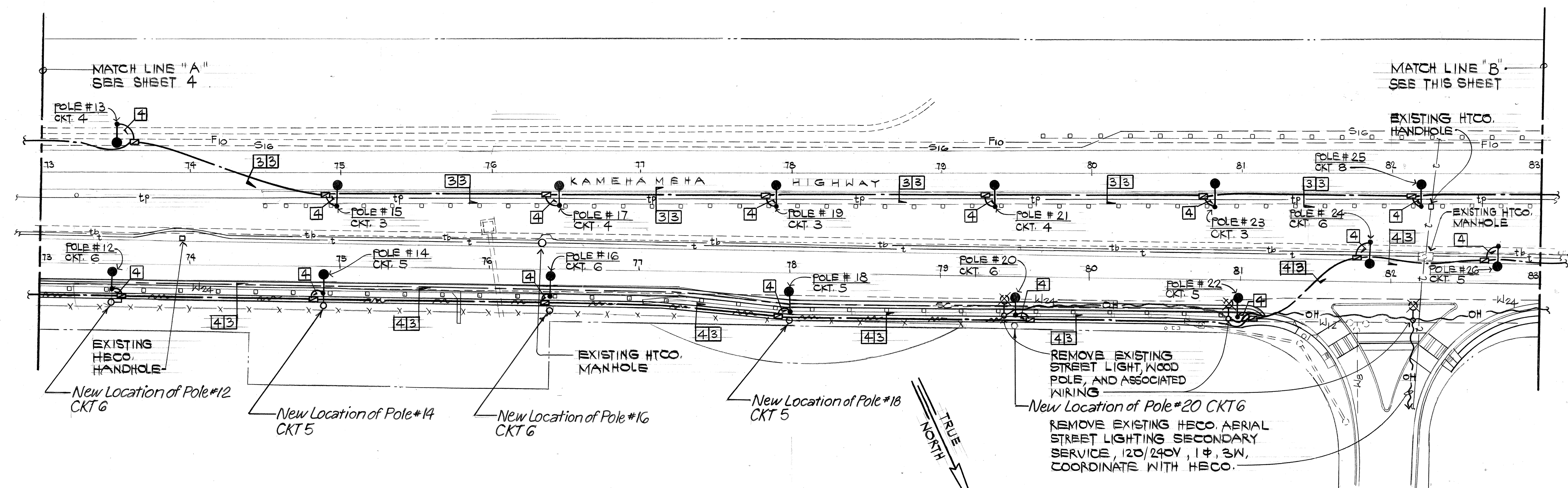

**NOTE**  
PATCH ALL PAVEMENT, SIDEWALKS, CURBS, ETC. DAMAGED BY INSTALLATION OF NEW HIGHWAY LIGHTING SYSTEM TO MATCH EXISTING CONDITIONS.

**ELECTRICAL SITE PLAN #2**  
SCALE: 1" = 40' - 0"

Sta. 73+00 ± Rt. to Sta. 81+10 ± Rt.  
New Location of concealed Conduit Below Grade.  
Note: Pullboxes to remain at original Locations.

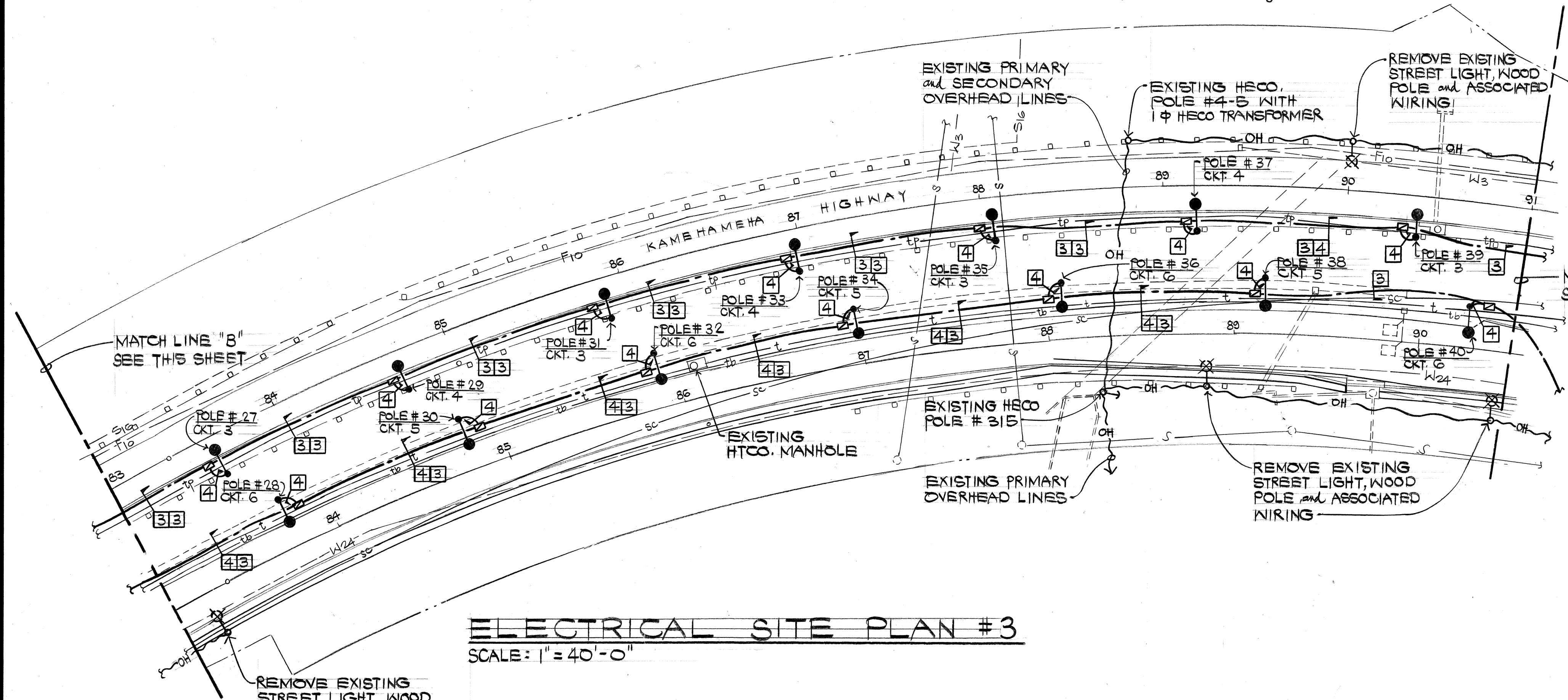

**ELECTRICAL SITE PLAN #3**  
SCALE: 1" = 40' - 0"

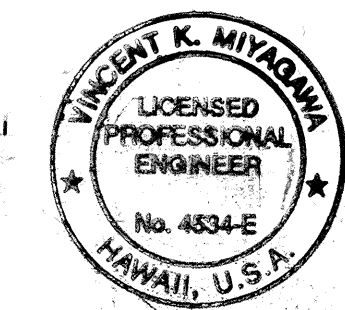
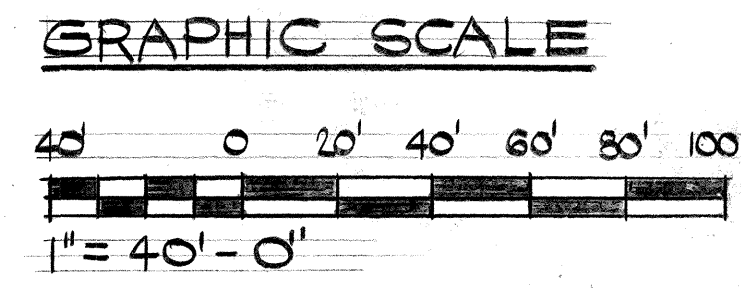

THIS WORK WAS PREPARED BY ME OR UNDER MY SUPERVISION

By: [Signature]  
PROJECT ENGINEER  
Date: 5-22-92

STATE OF HAWAII  
DEPARTMENT OF TRANSPORTATION  
HIGHWAYS DIVISION

**ELECTRICAL SITE  
PLANS #2 & #3**

KAMEHAMEHA HIGHWAY - INSTALLATION OF HIGHWAY LIGHTS  
KIPAPA STREET TO WAIKALANI DRIVE  
PROJECT NO. NH-099-1(16)

SCALE: NO SCALE

DATE:  
5-22-92

SURVEY PLOTTED BY	DATE
DRAWN BY	
DESIGNED BY	
QUANTITIES BY	
CHECKED BY	



FED. ROAD DIST. NO.	STATE	FED. AID PROJ. NO.	FISCAL YEAR	SHEET NO.	TOTAL SHEETS
HAWAII	HAW.	NH-099-1(16)	1996	7	12

**NOTES:**

1. REMOVE EXISTING STREET LIGHT, WOOD POLE AND ASSOCIATED WIRING, IDENTIFIED ON PLAN BY "2".
2. PATCH ALL PAVEMENT, SIDEWALKS, CURBS, ETC., DAMAGED BY INSTALLATION OF NEW HIGHWAY LIGHTING SYSTEM TO MATCH EXISTING CONDITIONS.

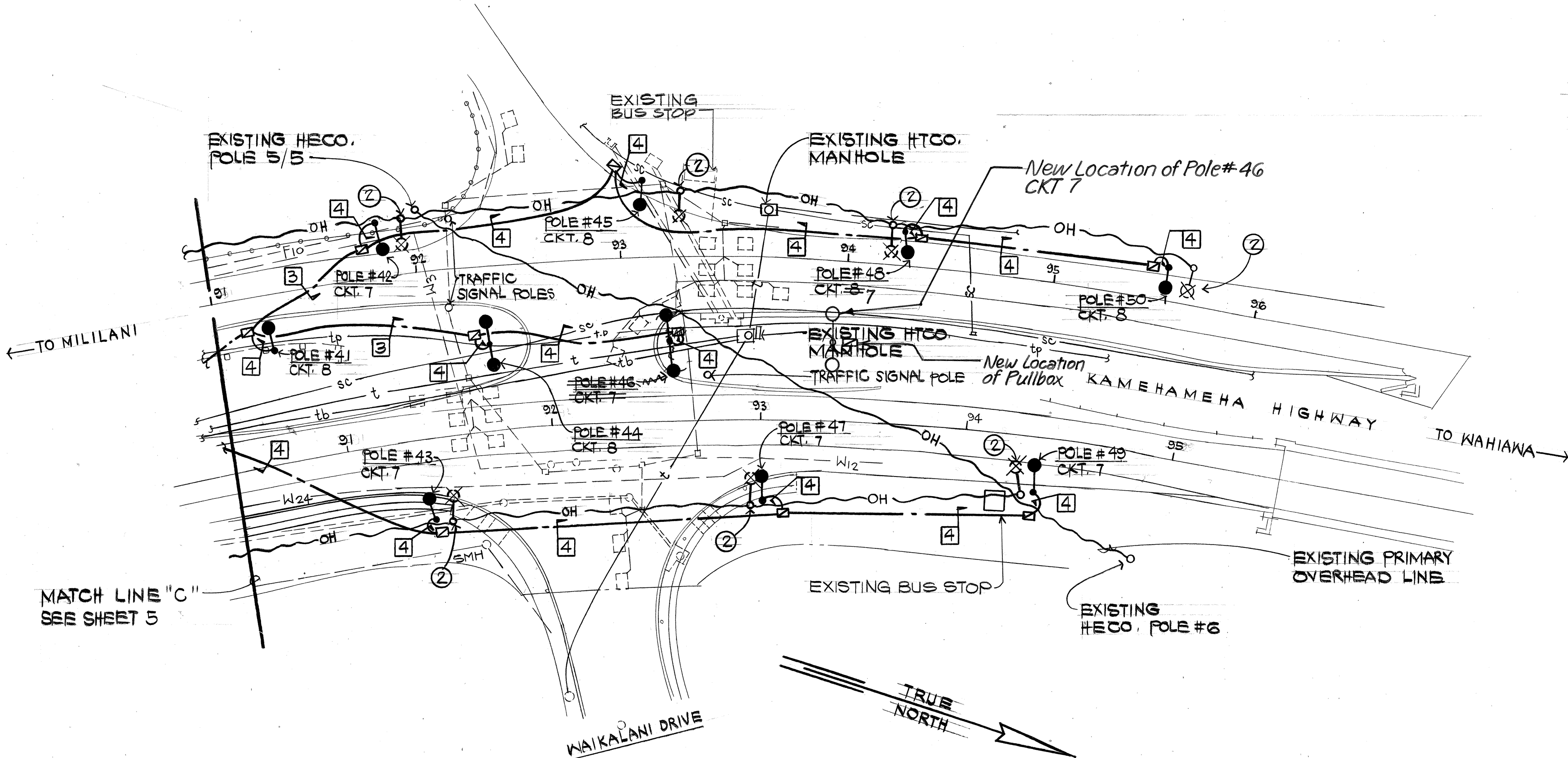

**ELECTRICAL SITE PLAN #4**  
SCALE: 1" = 40' - 0"

CKT. No.		CKT. BKR.		USE	CONN. LOAD (KVA)		WIRE SIZE	GND SIZE
		POLE	AMPS		A	B		
1	2	30		HIGHWAY LIGHTS	0.7	0.7	4	8
2	2	30		HIGHWAY LIGHTS	1.1	1.1	4	8
3	2	30		HIGHWAY LIGHTS	1.0	1.0	4	8
4	2	30		HIGHWAY LIGHTS	0.9	0.9	4	8
5	2	30		HIGHWAY LIGHTS	1.1	1.1	4	8
6	2	30		HIGHWAY LIGHTS	1.1	1.1	4	8
7	2	30		HIGHWAY LIGHTS	0.9	0.9	4	8
8	2	30		HIGHWAY LIGHTS	0.9	0.9	4	8
9	2	20		CONTROL	0.1	0.1	12	12
10	2	---		PFB	---	---	---	---
11	1	---		PFB	---	---	---	---
12	1	---		PFB	---	---	---	---
13	1	---		PFB	---	---	---	---
14	1	---		PFB	---	---	---	---
TOTAL LOAD/PHASE					7.8	7.8		
TOTAL LOAD					15.6 KVA			
DEMAND FACTOR					1.0			
DEMAND LOAD					15.6 KVA			
DEMAND AMPS					62 A			

SURVEY PLOTTED BY	DATE
DRAWN BY	
TRACED BY	
QUANTITIES BY	
CHECKED BY	
ORIGINAL PLAN	
NOTE BOOK	
NO.	

**GRAPHIC SCALE**

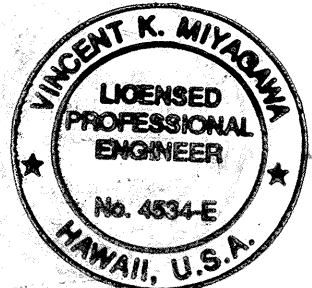
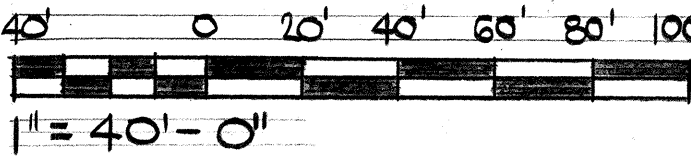

THIS WORK WAS PREPARED BY ME OR UNDER MY SUPERVISION

By *Vincent K. Miyahara*  
Its **PROJECT ENGINEER**  
Date **5-22-92**

STATE OF HAWAII  
DEPARTMENT OF TRANSPORTATION  
HIGHWAYS DIVISION  
**ELECTRICAL SITE PLAN #4**  
KAMEHAMEHA HIGHWAY - INSTALLATION OF HIGHWAY LIGHTS  
KIPAPA STREET TO WAIKALANI DRIVE  
PROJECT NO. NH-099-1(16)  
SCALE: NO SCALE 0"  
SHEET NO. 7 OF 12 SHEETS

DATE: