

INDEX TO DRAWINGS	
SHEET NO.	DESCRIPTION
1	TITLE SHEET
2	STANDARD PLANS SUMMARY
3	NPDES GENERAL NOTES
4 - 5	SAFETY IMPROVEMENT DETAILS, GENERAL NOTES AND LEGEND
6 - 7	ROCKFALL PROTECTION NETTING DETAILS
8 - 9	ROADWAY PLAN
10 - 22	CROSS SECTIONS

STATE OF HAWAII
DEPARTMENT OF TRANSPORTATION
HIGHWAYS DIVISION
HONOLULU, HAWAII
"AS-BUILT"
PLANS FOR
KAMEHAMEHA HIGHWAY
SAFETY IMPROVEMENTS
KIPAPA GULCH TOWARDS MILILANI
FEDERAL AID PROJECT NO. NH-099-1(14)

DISTRICT OF EWA
ISLAND OF OAHU

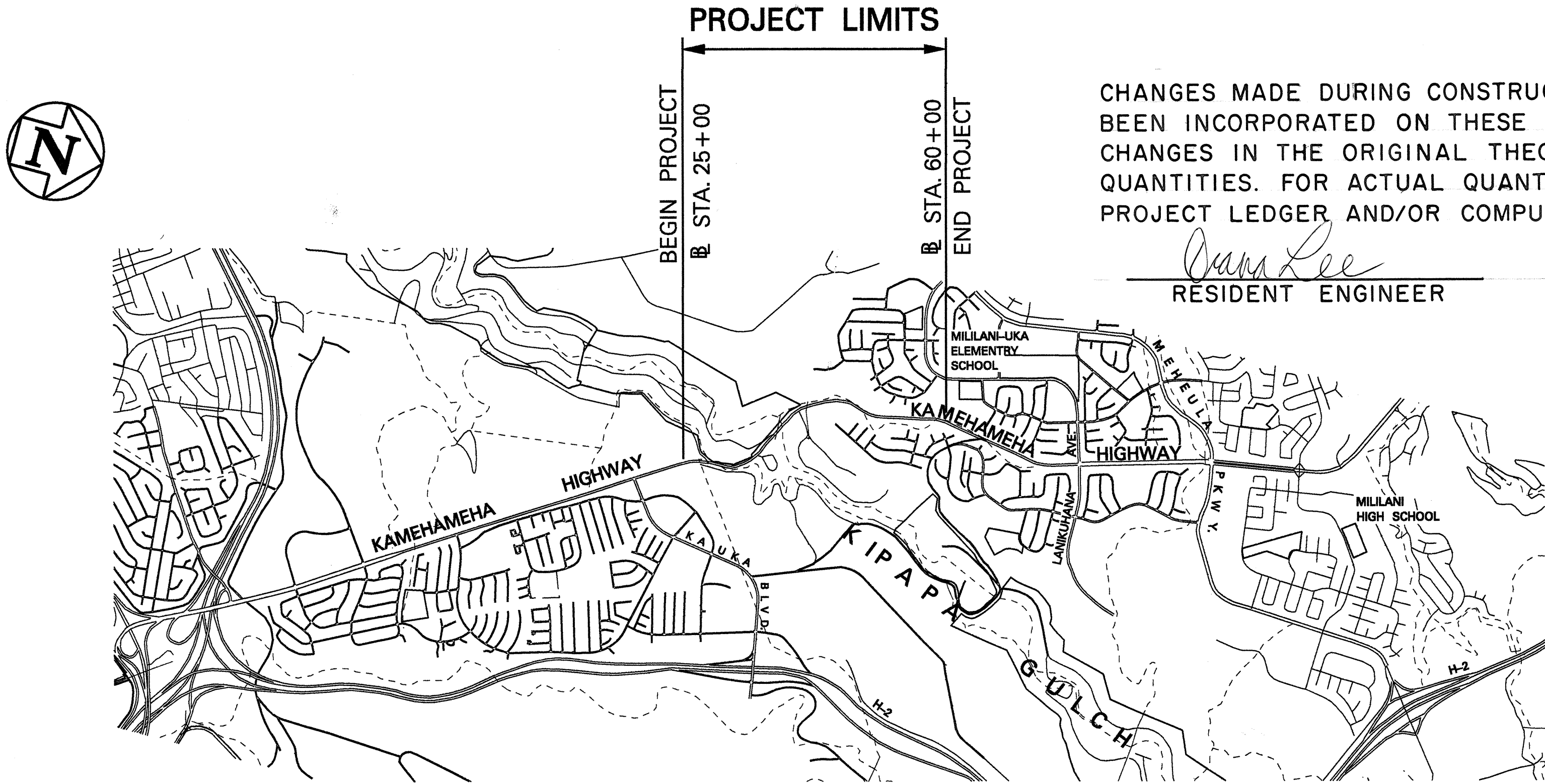
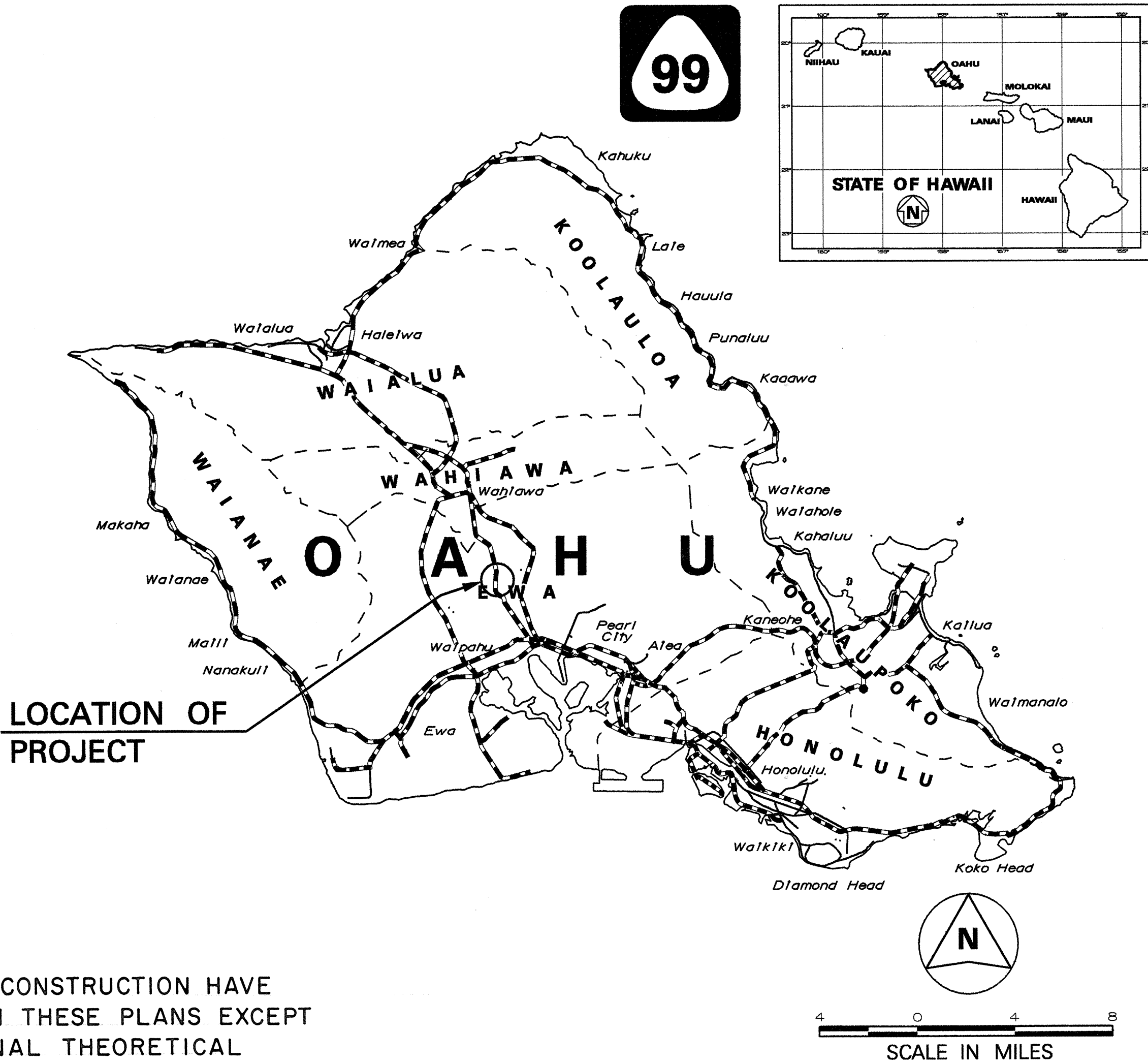

CHANGES MADE DURING CONSTRUCTION HAVE
BEEN INCORPORATED ON THESE PLANS EXCEPT
CHANGES IN THE ORIGINAL THEORETICAL
QUANTITIES. FOR ACTUAL QUANTITIES, REFER TO
PROJECT LEDGER AND/OR COMPUTATION BOOK.

10/28/98
DATE

FEDERAL AID PROJECTS PREVIOUSLY CONSTRUCTED
OR UNDER CONSTRUCTION

MILE POST 15.19 TO MILE POST 16.27

DESIGN DESIGNATION	
ADT (1992).....	29,868
ADT (2012).....	39,216
DHV	1,706
D	61/39
T	2.5 %
V	40 M.P.H.

LOCATION PLAN

GROSS LENGTH OF PROJECT.....1.08 MILES
NET LENGTH OF PROJECT.....0.663 MILES



6/21/95	Revised Title
DATE	REVISION

DEPARTMENT OF TRANSPORTATION STATE OF HAWAII	
APPROVED:	
	6-22-95
DIR. OF TRANSPORTATION	DATE

UNIT "E"
DESIGNED BY
J. FUJIMOTO
P. S. & E. BY
587-2249
PHONE
JAN. 1995
DATE