

FED. ROAD DIST. NO.	STATE	PROJ. NO.	FISCAL YEAR	SHEET NO.	TOTAL SHEETS
HAWAII	HAW.	99D-01-17	2022	13	35

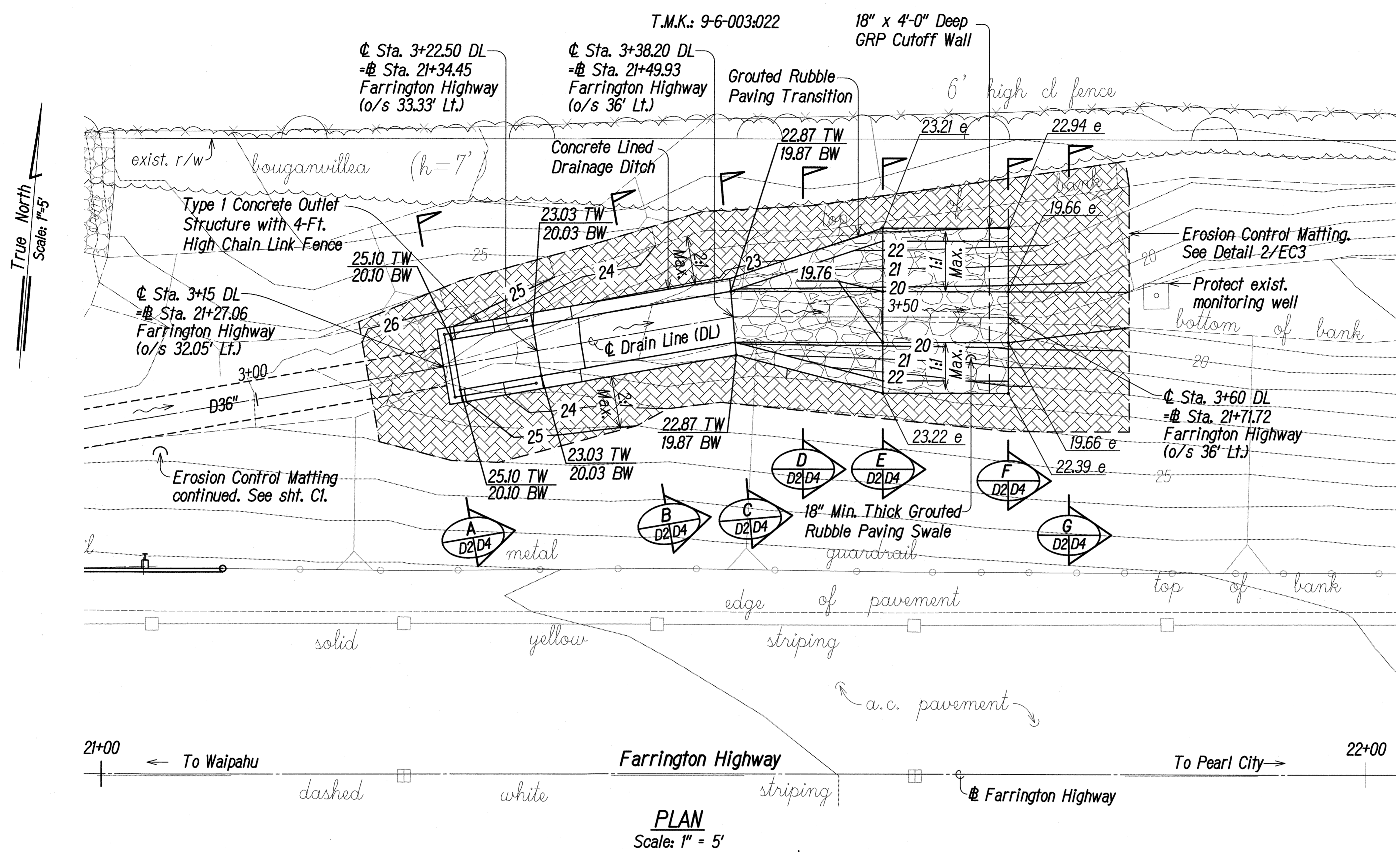

PLAN
Scale: 1" = 5'

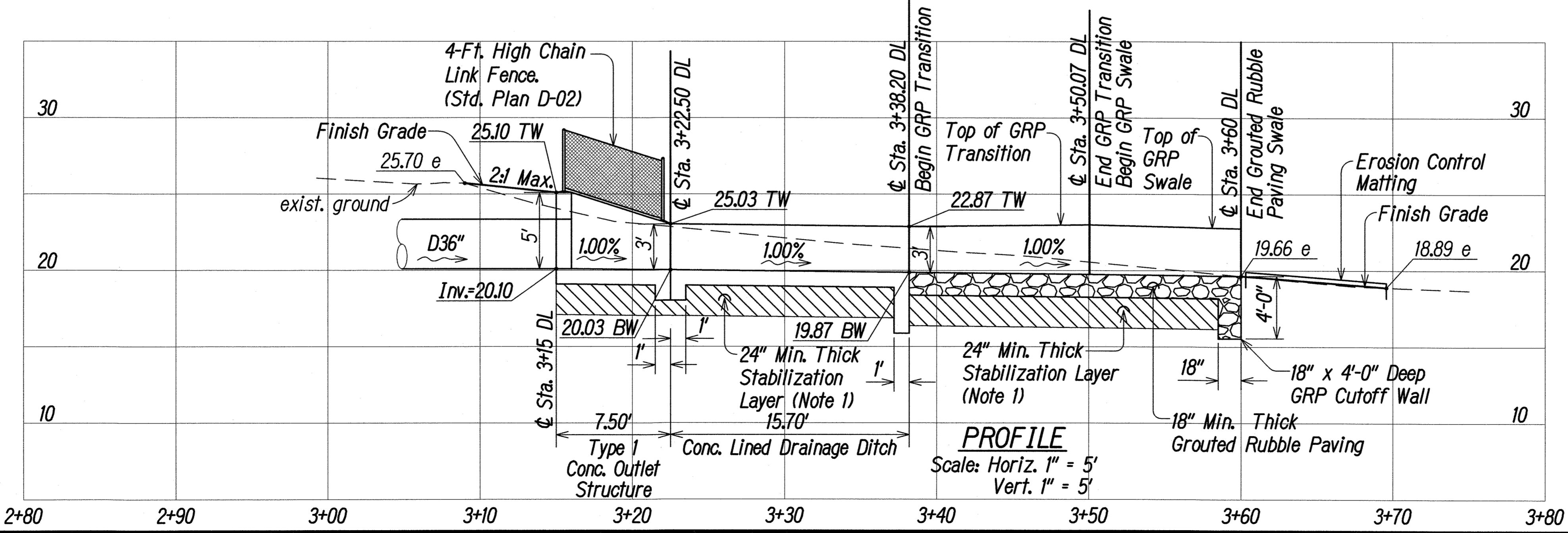

PROFILE
Scale: Horiz. 1" = 5'
Vert. 1" = 5'

Notes:

- Contractor shall over-excavate to a depth of 2 feet min. if soft and/or loose soil is encountered as determined by the Engineer. Install 2 feet min. thick Stabilization Layer consisting of No. 2 Basalt Aggregate (ASTM C33, No. 4 Gradation) wrapped with Non-Woven Filter Fabric (Mirafi 180N or equivalent).
- Excavation for the stabilization layer below the concrete-lined ditch, as required by the Engineer, will be paid for under item No. 206.0200 Excavation for Stabilization Layer.

SURVEY PLOTTED BY	DATE
DRAWN BY	
DESIGNED BY	
QUANTITIES BY	
CHECKED BY	
NO.	



THIS WORK WAS PREPARED BY ME OR UNDER MY SUPERVISION.
Russell M. Araki
 APRIL 30, 2022
 LIC. EXP. DATE

STATE OF HAWAII
 DEPARTMENT OF TRANSPORTATION
 HIGHWAYS DIVISION

DRAINAGE OUTLET PLAN

FARRINGTON HIGHWAY
 Drainage Improvements
 Vicinity of Leeward Community College
 PROJECT NO. 99D-01-17

Scale: As Shown Date: June 2021

SHEET No. D2 OF D4 SHEETS