

ORIGINAL PLAN	SURVEY PLOTTED BY	DATE
NOTE BOOK	DESIGNED BY	
	QUANTITIES BY	
	CHECKED BY	

C:\Documents and Settings\Peter\My Documents\Projects\2009-2013 Traffic Operational Improvements\Plans\Autocad Files\Construction\PI01-TITLE.dwg Mon May 20 2013 1:45pm

ESH/ATA DESIGNED BY
HWY-TO
692-7691
MAY 2013
PHONE
DATE

INDEX TO DRAWINGS	
SHEET NO.	DESCRIPTION
1	TITLE SHEET
2	STANDARD PLANS SUMMARY
3	ABBREVIATIONS AND LEGEND
4	GENERAL NOTES
5-6	WATER POLLUTION AND EROSION CONTROL NOTES AND ABBREVIATIONS
7-13	CONSTRUCTION, TRAFFIC, WATER, SEWER (CITY) AND UTILITY NOTES
14	TYPICAL SECTION
15	ROADWAY PLAN
16	FINISH GRADE PLAN
17	MISCELLANEOUS DETAILS
18	PAVEMENT MARKING LEGEND, DETAILS AND NOTES (STATE)
19	PAVEMENT MARKING DETAILS (CITY)
20-21	PAVEMENT MARKING AND TRAFFIC SIGNING PLAN
22-24	TRAFFIC CONTROL NOTES AND DETAILS
25	TRAFFIC CONTROL PLANS
26	LOW SPEED DIVIDED HIGHWAY WORK ZONE SIGNING PLAN, NOTES AND DETAILS
27	TRAFFIC SIGNAL NOTES AND LEGEND
28-30	TRAFFIC SIGNAL PLANS
31-32	TRAFFIC SIGNAL DETAILS
33	ELECTRICAL SYMBOLS AND NOTES
34-36	ELECTRICAL PLANS
37-41	ELECTRICAL DETAILS

STATE OF HAWAII
DEPARTMENT OF TRANSPORTATION
HIGHWAYS DIVISION
HONOLULU, HAWAII

"AS-BUILT"

PLANS FOR

TRAFFIC OPERATIONAL IMPROVEMENTS AT VARIOUS LOCATIONS

VICINITY OF KAMEHAMEHA HIGHWAY AND LUMIAINA STREET

PROJECT NO. 99C-01-13
TAX MAP KEY: 9-4-042
DISTRICT OF EWA
ISLAND OF OAHU

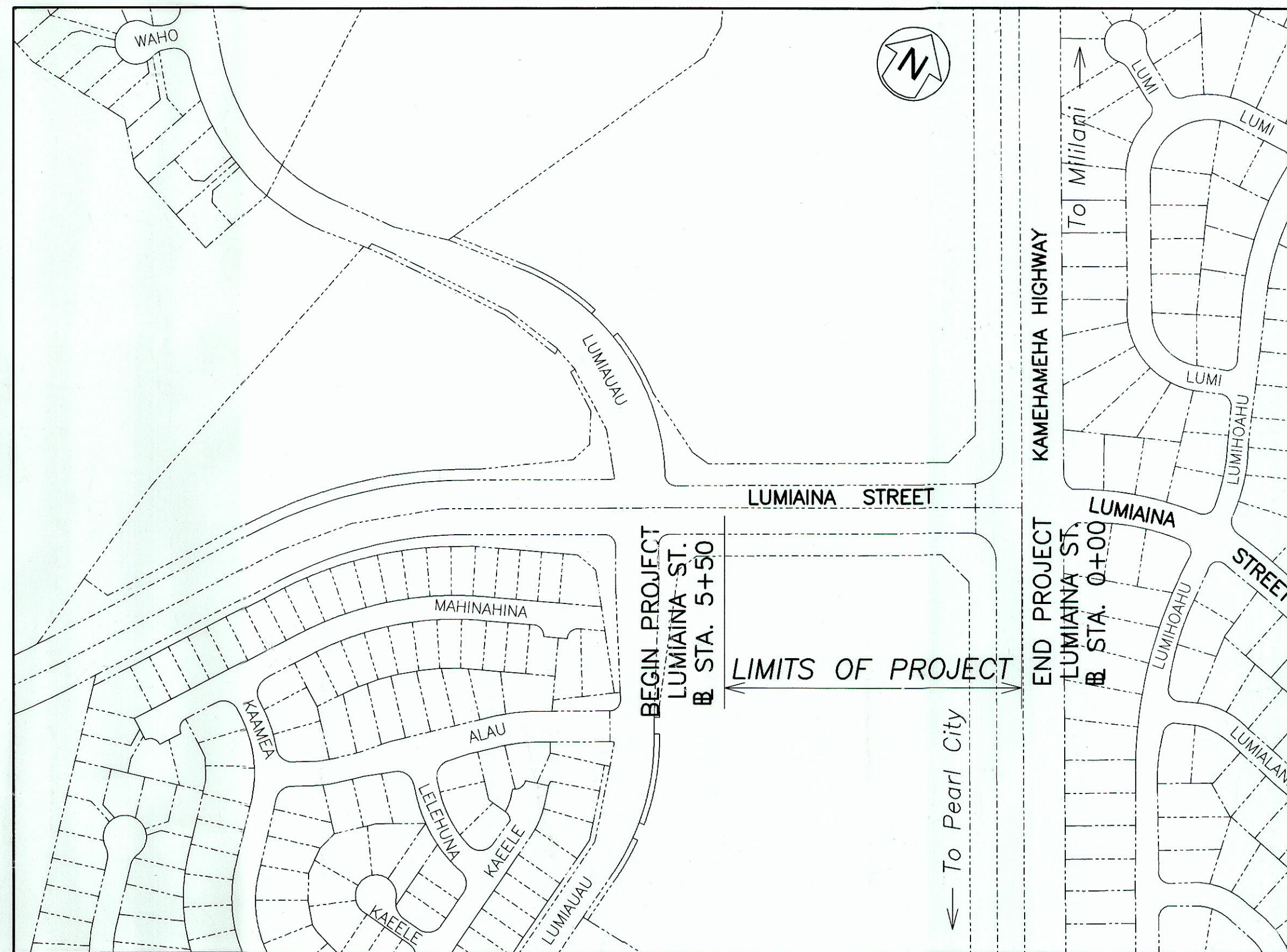

LOCATION PLAN

GROSS LENGTH OF PROJECT 0.19 MILES

SCALE IN HUNDRED FEET

FED. ROAD DIST. NO.	STATE	PROJ. NO.	FISCAL YEAR	SHEET NO.	TOTAL SHEETS
OAHU	HAW.	99C-01-13	2014	1	41

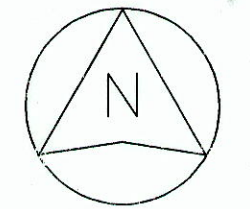
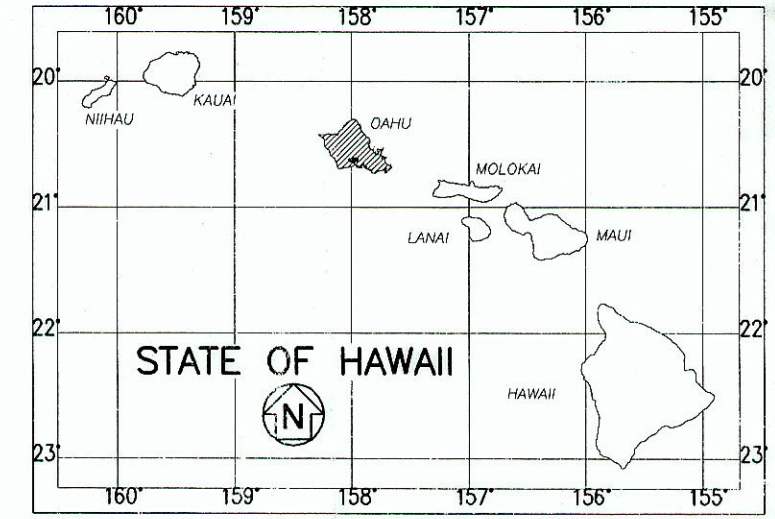

SCALE IN MILES

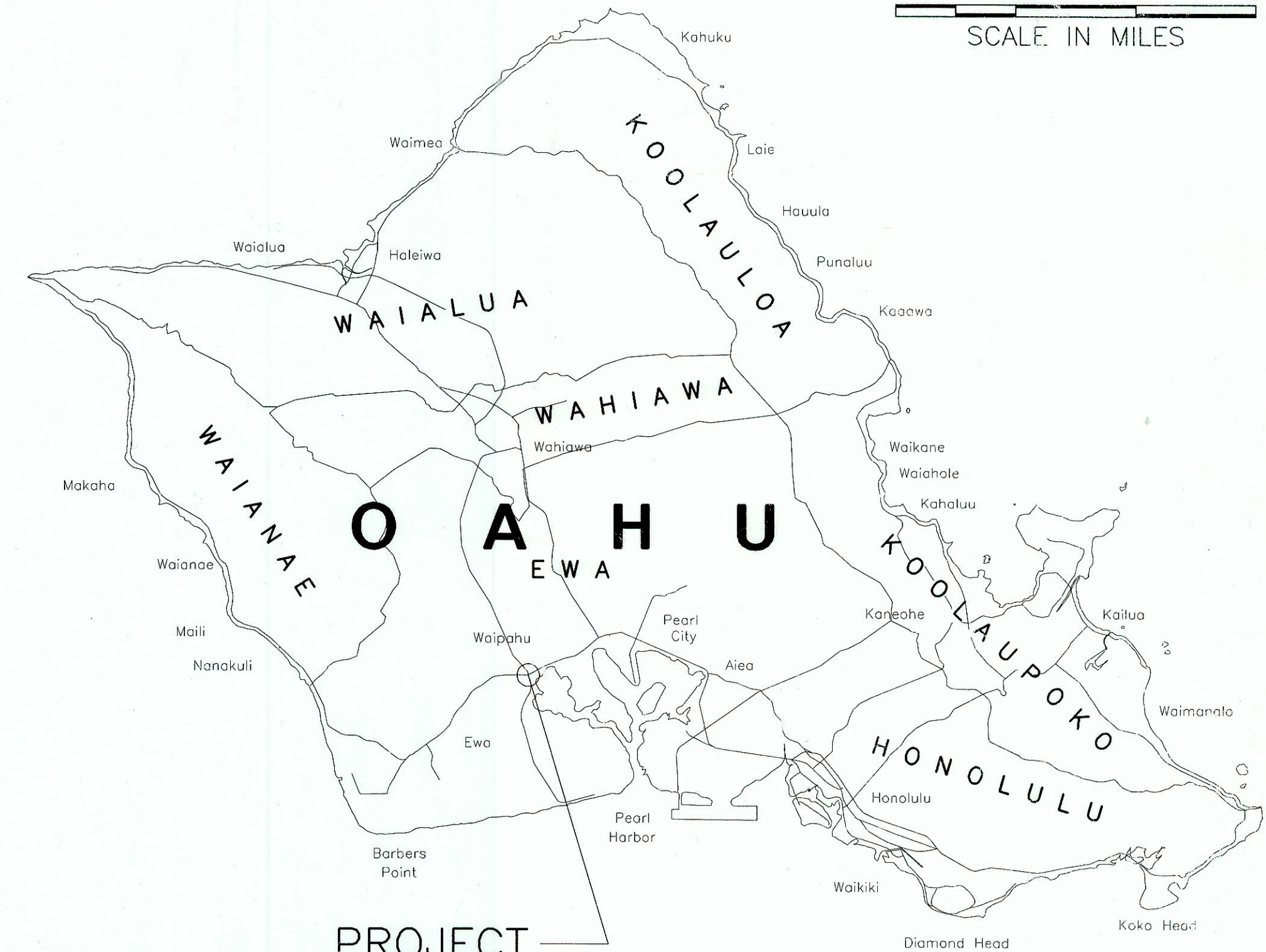

PROJECT LOCATION

CHANGES MADE DURING CONSTRUCTION HAVE BEEN INCORPORATED ON THESE PLANS EXCEPT CHANGES IN THE ORIGINAL THEORETICAL QUANTITIES. FOR ACTUAL QUANTITIES, REFER TO PROJECT LEDGER AND/OR COMPUTATION BOOK.

Samuel M. [Signature]
RESIDENT ENGINEER
1/6/16
DATE

DEPARTMENT OF TRANSPORTATION STATE OF HAWAII	
APPROVED:	
<i>[Signature]</i>	5/28/13
DIR. OF TRANSPORTATION	DATE