

FED. ROAD DIST. NO.	STATE	FED. AID PROJ. NO.	FISCAL YEAR	SHEET NO.	TOTAL SHEETS
HAWAII	HAW.	NH-099-1(029)	2014	83	84

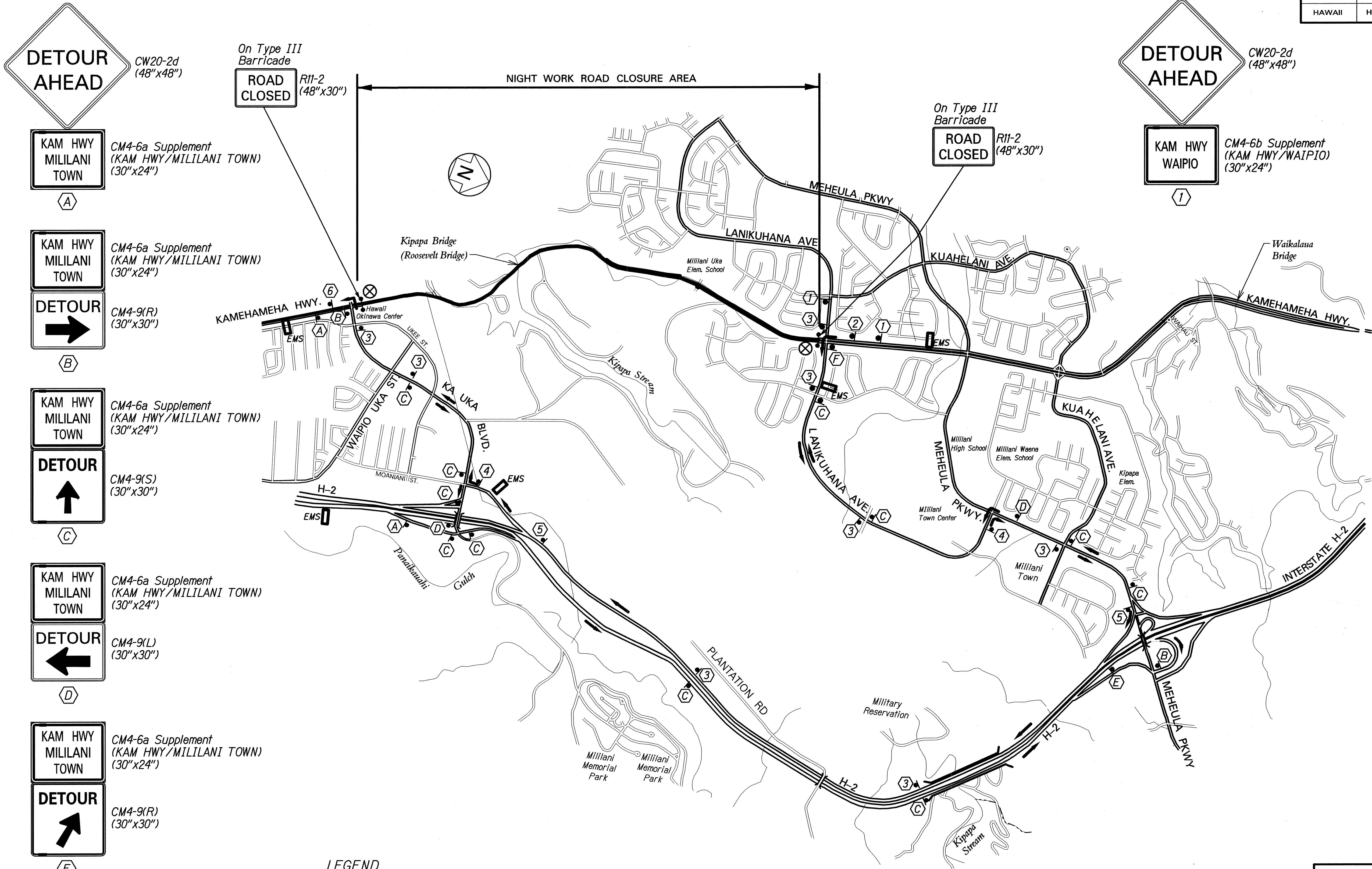

DETOUR AHEAD
CW20-2d
(48"x48")

KAM HWY
MILILANI
TOWN
CM4-6a Supplement
(KAM HWY/MILILANI TOWN)
(30"x24")

(A)

KAM HWY
MILILANI
TOWN
CM4-6a Supplement
(KAM HWY/MILILANI TOWN)
(30"x24")

DETOUR
CM4-9(R)
(30"x30")

(B)

KAM HWY
MILILANI
TOWN
CM4-6a Supplement
(KAM HWY/MILILANI TOWN)
(30"x24")

DETOUR
CM4-9(S)
(30"x30")

(C)

KAM HWY
MILILANI
TOWN
CM4-6a Supplement
(KAM HWY/MILILANI TOWN)
(30"x24")

DETOUR
CM4-9(L)
(30"x30")

(D)

KAM HWY
MILILANI
TOWN
CM4-6a Supplement
(KAM HWY/MILILANI TOWN)
(30"x24")

DETOUR
CM4-9(R)
(30"x30")

(E)

**END
DETOUR**
CM4-8a)
(30"x30")

KAM HWY
MILILANI
TOWN
CM4-6a Supplement
(KAM HWY/MILILANI TOWN)
(30"x24")

(F)

DETOUR AHEAD
CW20-2d
(48"x48")

KAM HWY
WAIPIO
CM4-6b Supplement
(KAM HWY/WAIPIO)
(30"x24")

(1)

KAM HWY
WAIPIO
CM4-6b Supplement
(KAM HWY/WAIPIO)
(30"x24")

DETOUR
CM4-9(L)
(30"x30")

(2)

KAM HWY
WAIPIO
CM4-6b Supplement
(KAM HWY/WAIPIO)
(30"x24")

DETOUR
CM4-9(S)
(30"x30")

(3)

KAM HWY
WAIPIO
CM4-6b Supplement
(KAM HWY/WAIPIO)
(30"x24")

DETOUR
CM4-9(R)
(30"x30")

(4)

KAM HWY
WAIPIO
CM4-6b Supplement
(KAM HWY/WAIPIO)
(30"x24")

DETOUR
CM4-9(R)
(30"x30")

(5)

**END
DETOUR**
CM4-8a)
(30"x30")

KAM HWY
WAIPIO
CM4-6b Supplement
(KAM HWY/WAIPIO)
(30"x24")

(6)

- LEGEND**
- Detour Route
 - Type III Barricade w/ "Road Closed" Sign
 - Road Closure Area
 - Electronic Message Sign (EMS)
 - Temporary Construction Sign w/Post
 - ⊗ Police Officer w/Vehicle Equipped w/Blue Strobe Light

STATE OF HAWAII
DEPARTMENT OF TRANSPORTATION
HIGHWAYS DIVISION
DETOUR PLAN
KAMEHAMEHA HIGHWAY RESURFACING
Vicinity of Ka Uka Boulevard
to Vicinity of Waihau Street
Federal Aid Project No. NH-099-1(029)
Scale: As Noted Date: Sept. 2013
SHEET No. 723 OF 24 SHEETS

SURVEY PLOTTED BY	DATE
DRAWN BY	
DESIGNED BY	
QUANTITIES BY	
CHECKED BY	

ORIGINAL PLAN	DATE
NOTE BOOK	
DESIGNED BY	
QUANTITIES BY	
CHECKED BY	

