

FED. ROAD DIST. NO.	STATE	PROJECT NO.	FISCAL YEAR	SHEET NO.	TOTAL SHEETS
HAWAII	HAW.	99D/G-01-08	2008	55	89

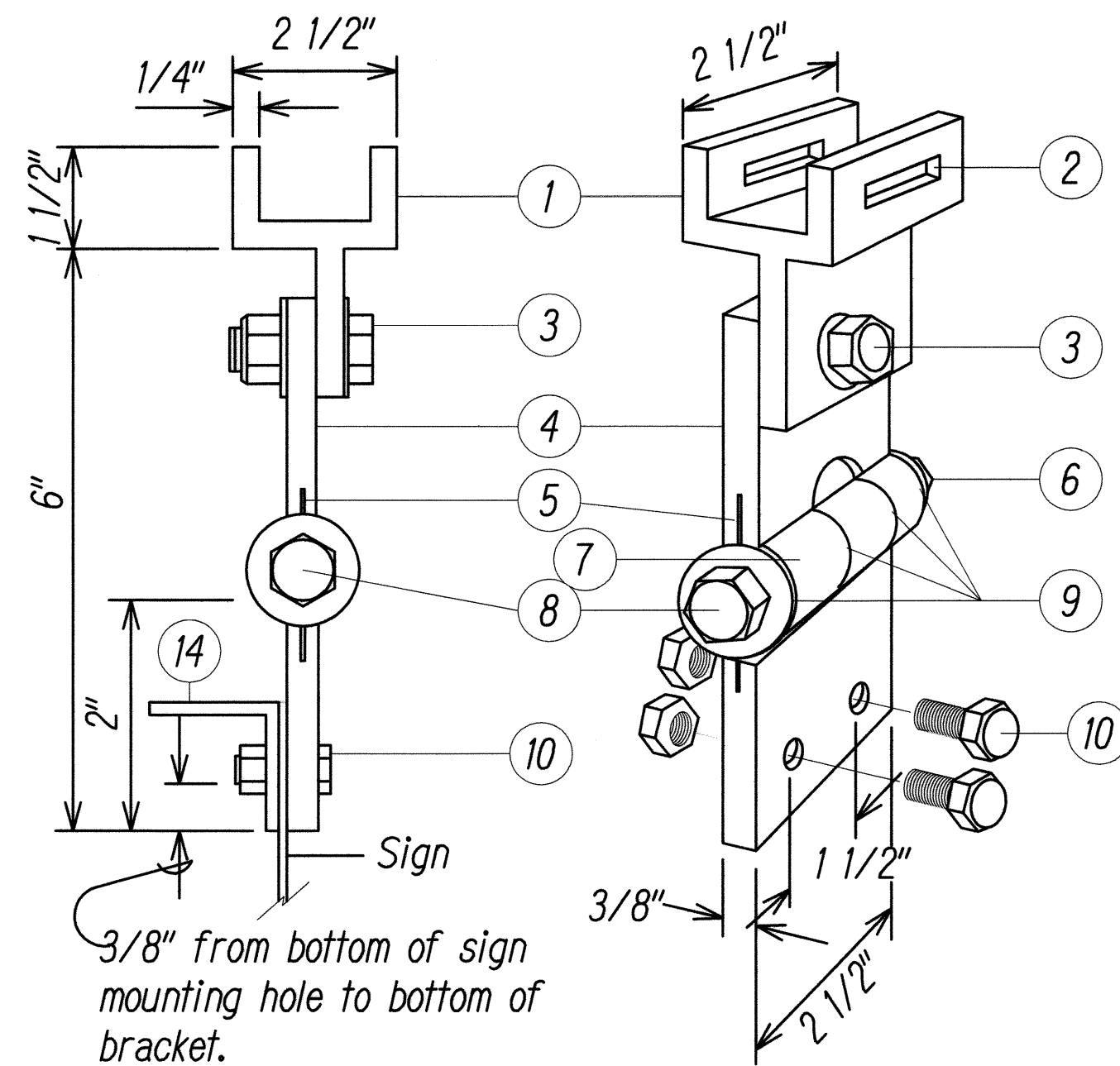

All Aluminum 6061T6 Alloy and Stainless Steel Components.

NOTES:
Dimensions may vary slightly.

**FIXED LENGTH NON-ADJUSTABLE
SWING SIGN BRACKET**
NOT TO SCALE

- ① Pivotal Upper Bracket
- ② 1 5/8" x 1/4" Slot for double strapping to electrolier mast arm. (M2G-34S(HD) .030" x 3/4" Heavy Duty Stainless Steel Strap with M2G-34B(HD) Buckle recommended.)
- ③ 1/2" - 13 x 1 1/2" Stainless Steel Hex Head Bolt with Stainless Steel Hex Lock Nut and 1/16" Stainless Steel Washer (both sides). Allows upper bracket to pivot and align with electrolier mast arm.
- ④ 6" Overall drop with Fixed Length Sign Bracket
- ⑤ Stainless Steel Dampener Spring (Removable)
- ⑥ Stainless Steel Hex Lock Nut with 1/16" Stainless Steel Washer
- ⑦ 1" O.D. Axle Housing
- ⑧ 1/2" - 13 x 4" Stainless Steel Hex Head Bolt with 1/16" Stainless Steel Washer
- ⑨ Oilite Bushing
- ⑩ Sign Mounting Sets, consisting of two each 5/16" - 18 x 1" Stainless Steel Hex Head Bolt with Stainless Steel Hex Lock Nut. Two holes on 1 1/2" centers provide positive lock sign mounting to bracket.
- ⑪ 8 1/4" overall length Upper Adjustable Sign Bracket section
- ⑫ 9" overall length Lower Adjustable Sign Bracket section, including Axle Housing (8" overall length to top of Axle Housing)
- ⑬ 1/2" - 13 x 1 1/2" Stainless Steel Hex Bolt with Stainless Steel Hex Lock Nut and 1/16" Stainless Steel Washers (both sides). Loosen lock nut, adjust bracket teeth to level sign.
- ⑭ 1 1/4" x 1 1/4" x 1/8" Aluminum Angle

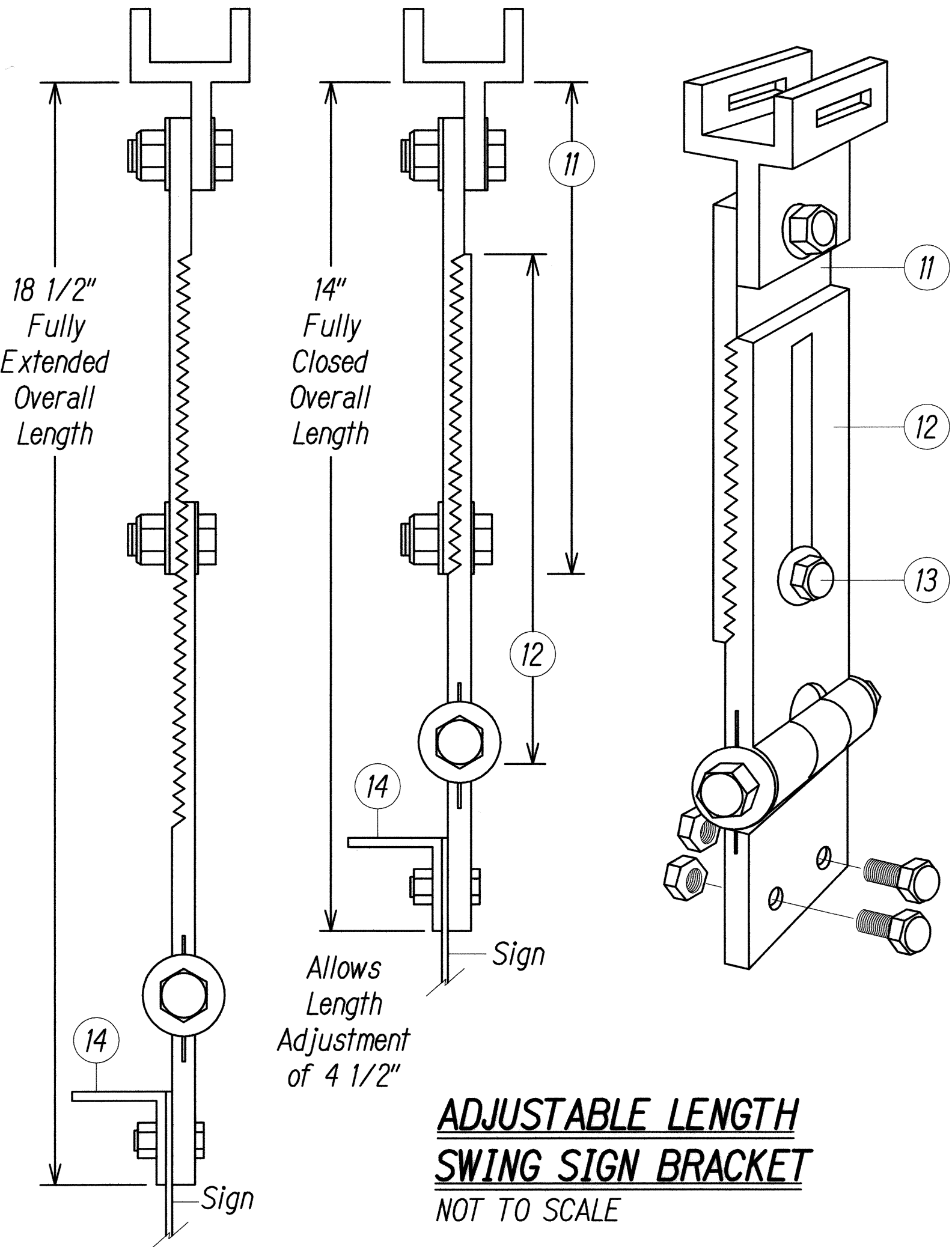

**ADJUSTABLE LENGTH
SWING SIGN BRACKET**
NOT TO SCALE

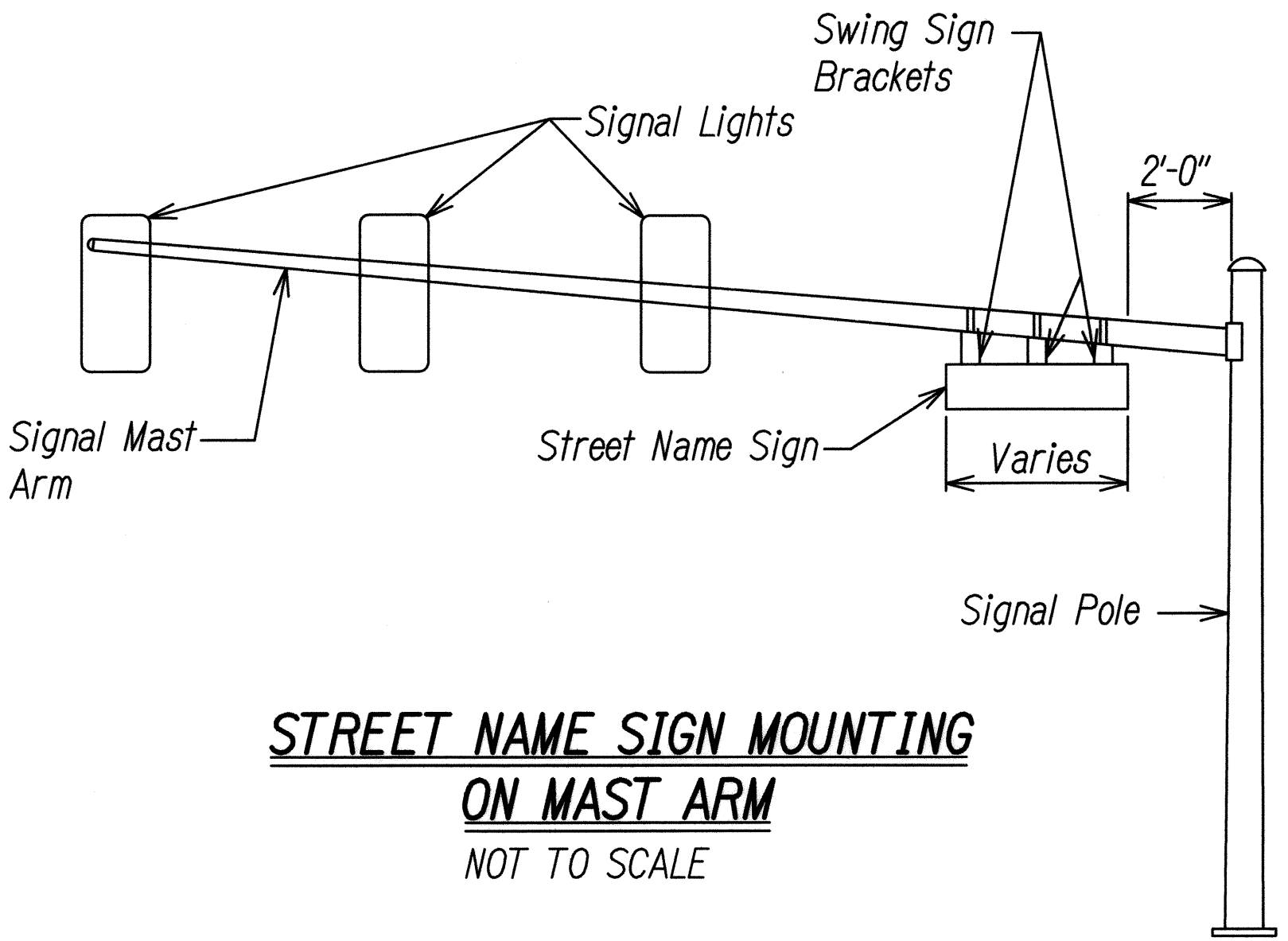

**STREET NAME SIGN MOUNTING
ON MAST ARM**
NOT TO SCALE

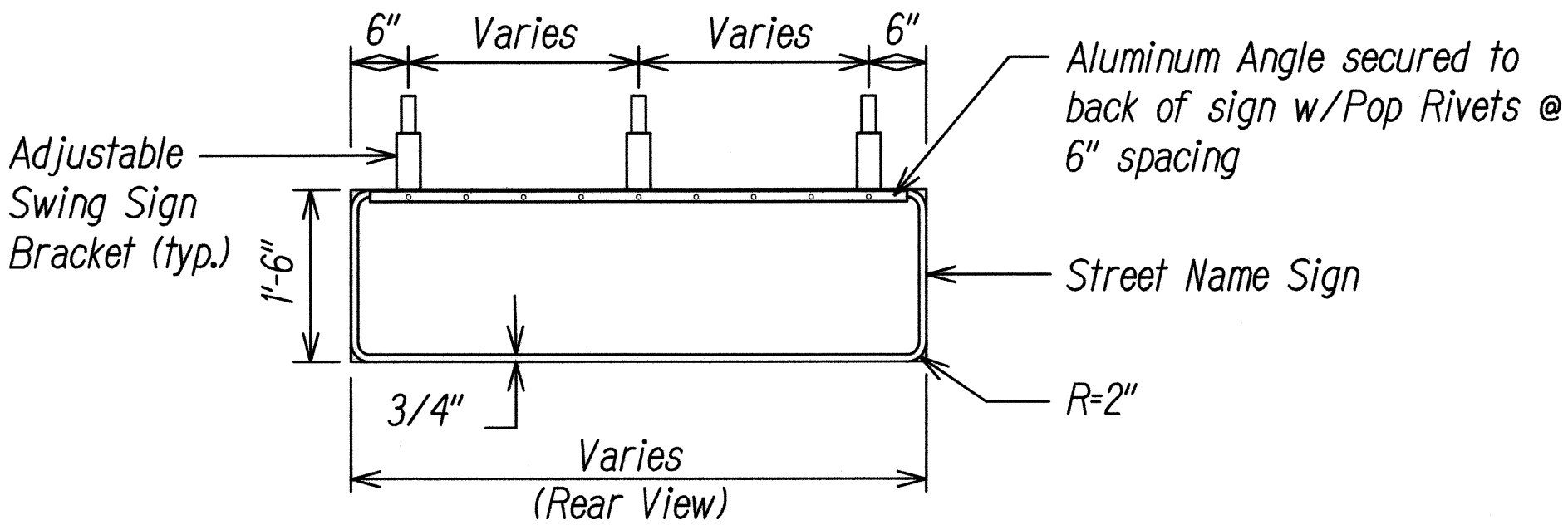

**PANEL & SWING BRACKET LAYOUT
FOR STREET NAME SIGN**
NOT TO SCALE

NOTES:

1. Street name signs shall have white message and border on green background.
2. All sign faces shall be completely reflectorized with Type "B" reflective sheeting.
3. The sign shall be in conformance with the requirements of Section 750 of the Standard Specification.

STATE OF HAWAII DEPARTMENT OF TRANSPORTATION HIGHWAYS DIVISION	
<u>STREET NAME SIGN DETAILS</u>	
KAMEHAMEHA HIGHWAY TRAFFIC OPERATIONAL IMPROVEMENTS VICINITY OF ACACIA ROAD TO CENTER DRIVE PROJECT NO. 99D/G-01-08	
Scale: As Shown	Date: April 2008