

FED. ROAD DIST. NO.	STATE	PROJECT NO.	FISCAL YEAR	SHEET NO.	TOTAL SHEETS
HAWAII	HAW.	99D/G-01-08	2008	63	89

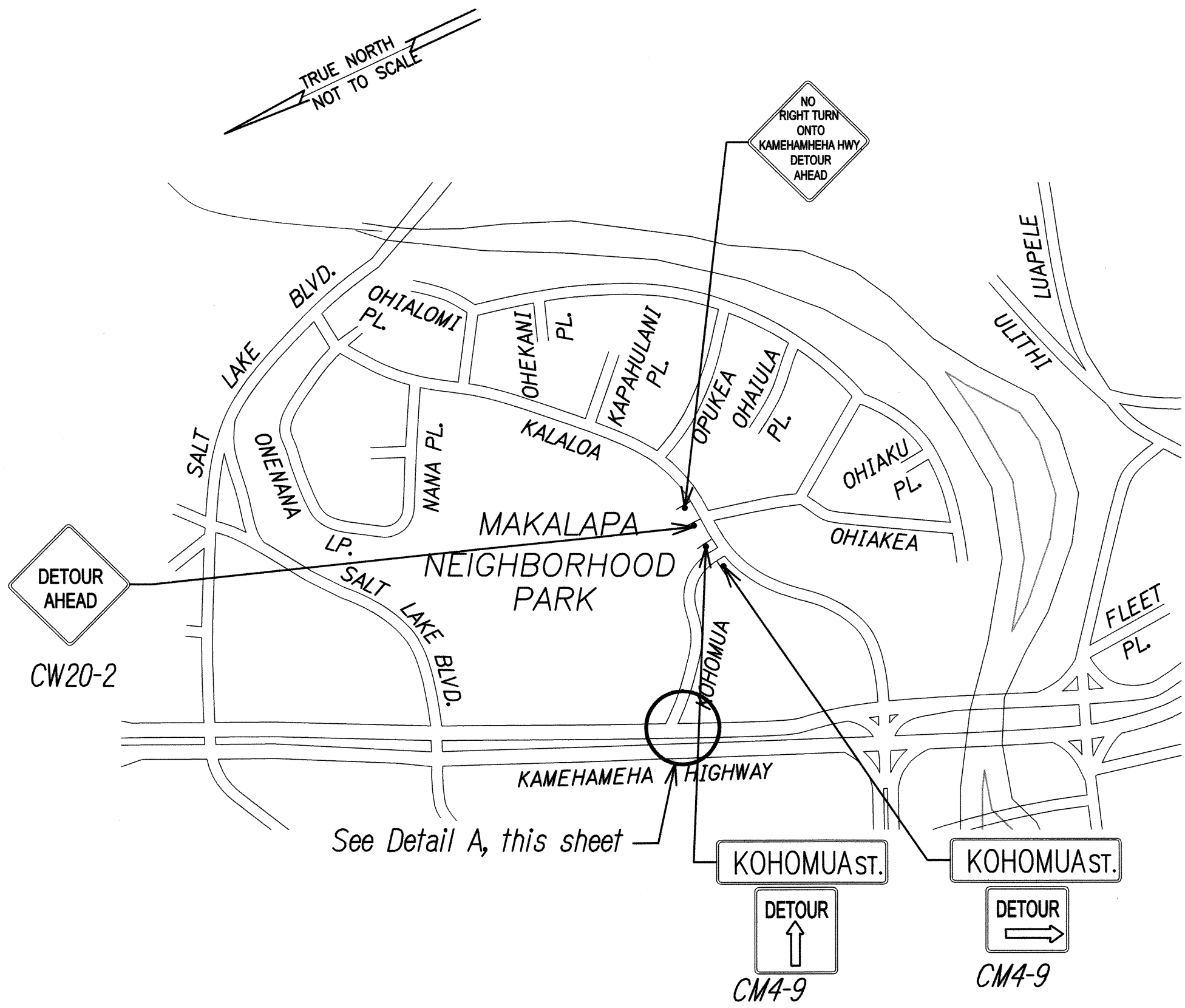

TRAFFIC CONTROL PLAN
DETOUR PLAN FOR KOHOMUA STREET
NOT TO SCALE

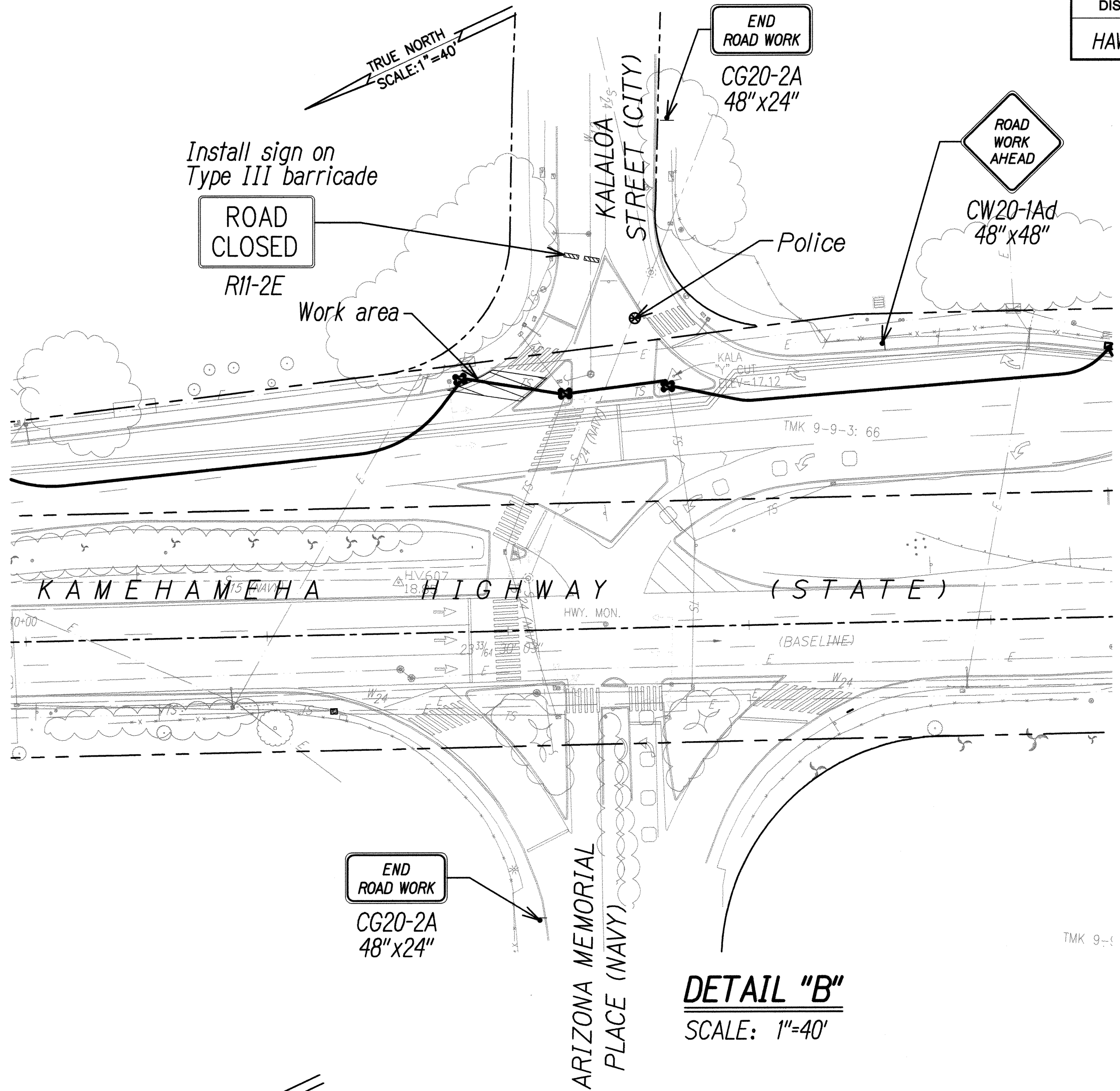
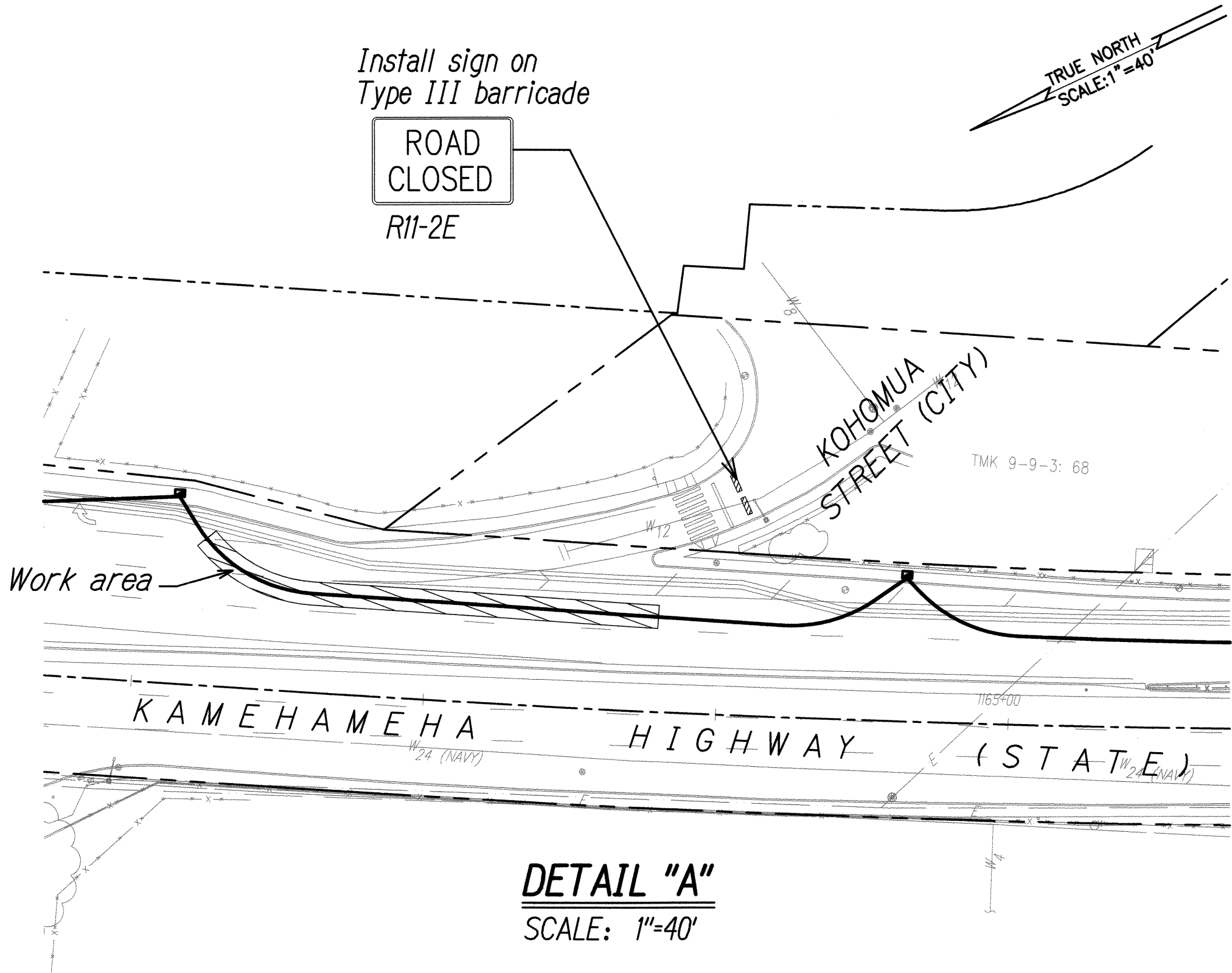
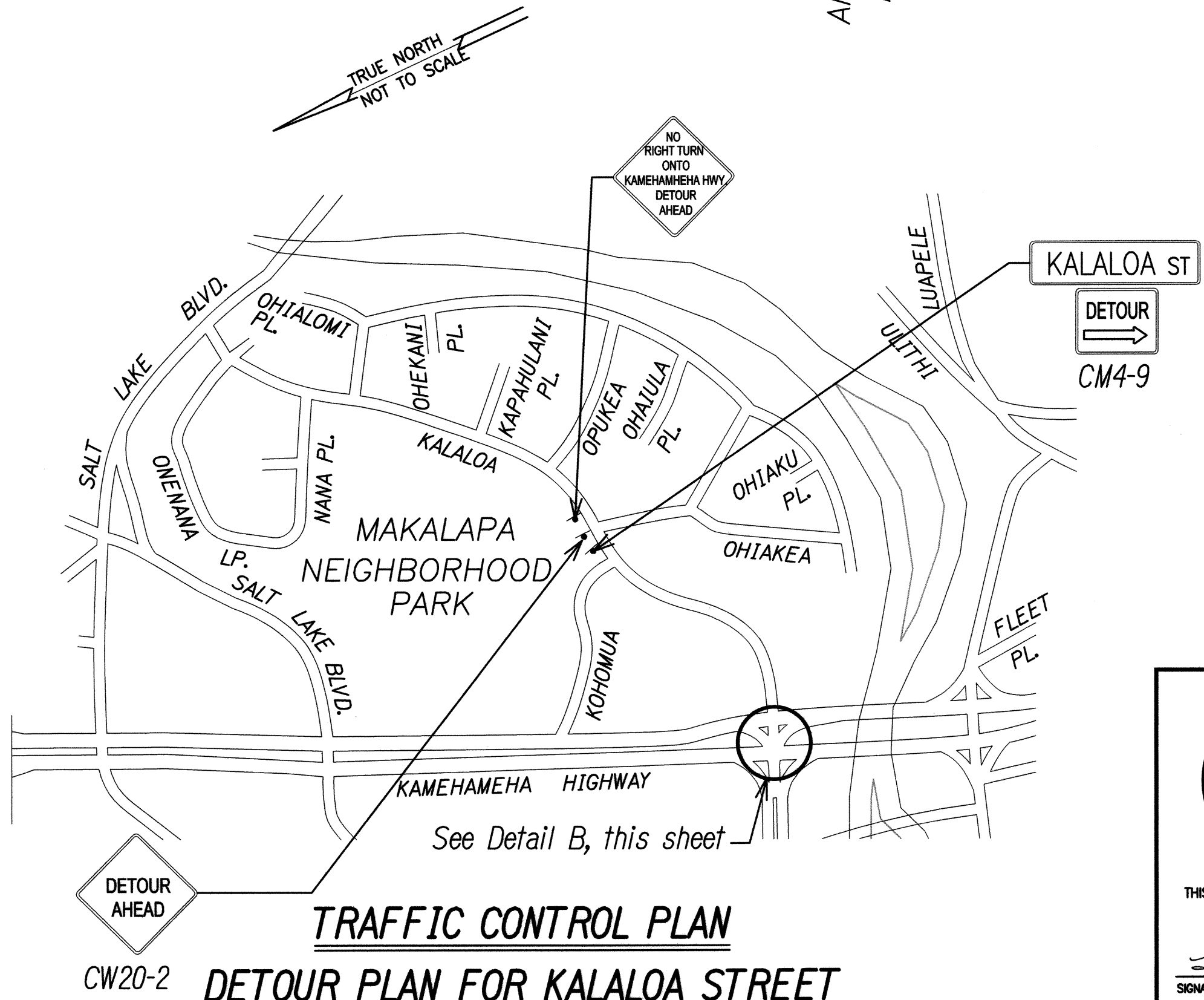

TRAFFIC CONTROL PLAN
DETOUR PLAN FOR KALALO A STREET
NOT TO SCALE

Note: For traffic control on Kamehameha Highway, see typical traffic control plans.

KEITH K. NIYA
LICENSED PROFESSIONAL ENGINEER
No. 8226-C
HAWAII, U.S.A.

THIS WORK WAS PREPARED BY ME OR UNDER MY SUPERVISION

Signature: _____
Date: 4/30/10

STATE OF HAWAII
DEPARTMENT OF TRANSPORTATION
HIGHWAYS DIVISION

DETOUR PLANS

KAMEHAMEHA HIGHWAY
TRAFFIC OPERATIONAL IMPROVEMENTS
VICINITY OF ACACIA ROAD TO CENTER DRIVE
PROJECT NO. 99D/G-01-08

Scale: As Shown Date: April 2008

SHEET No. TC-08 OF 8 SHEETS

SURVEY PLOTTED BY	DATE
DRAWN BY	
DESIGNED BY	
CHECKED BY	
ORIGINAL PLAN	
NOTE BOOK	
No.	

See Sheet TS-33 & TS-34 for Trench Details

Traceable Electrical Warning Tape in Accordance with HECO Spec. M0302

Finished Grade

PVC 40

Concrete Jacket, 3000 PSI Compressive Strength in 28 Days

See Note 2

Backfill



Either Material Conforming to the Requirements of the City and County of Honolulu Standard Specification for Public Works Construction, Dated September 1986, Section 16 - "Borrow", or Non-Contaminated Native Soil Material Which Does Not Contain More than 50% Gravel, and also, Does Not Contain Hard Lumps of Earth 3 Inches in Greatest Dimension, Rocks Larger than 3 Inches in Largest Dimension, Highly Plastic Clay, Poorly-Graded Sand and Gravel (Classified as SP and GP Using the United Soil Classification System), Organics, Debris, or Other Unsuitable or Deleterious Materials.



Select Granular Material Passing a One (1) Inch Sieve such as Three-Quarter (3/4) Inch Aggregate Base Course Gravel, S4C or Material that is free of Organics, Debris or Highly-Plastic Clay and Meets the Following Gradation:

Sleeve Size	Percent Passing by Weight
1"	100
3/4"	90 - 100
No. 4	35 - 100
No. 40	10 - 30
No. 200	3 - 15

TYPICAL DUCT SECTION (CONCRETE ENCASED)

Not to Scale

Notes:

- Electrical and Telephone Ducts Similar.
- Provide 2" Separation Between Ducts of Same System and 3" Between Ducts of Different Systems.
- Where Trench Encounters Existing Concrete or Asphalt Concrete, Surface Shall be Sawcut. Backfill, Compact and Patch Surface to Match Adjacent Area. See Trench Restoration Detail.
- See Duct Section Details for Conduit Arrangement.

SITE ELECTRICAL SYMBOLS

----- Underground Ductline

DUCT DESIGNATION

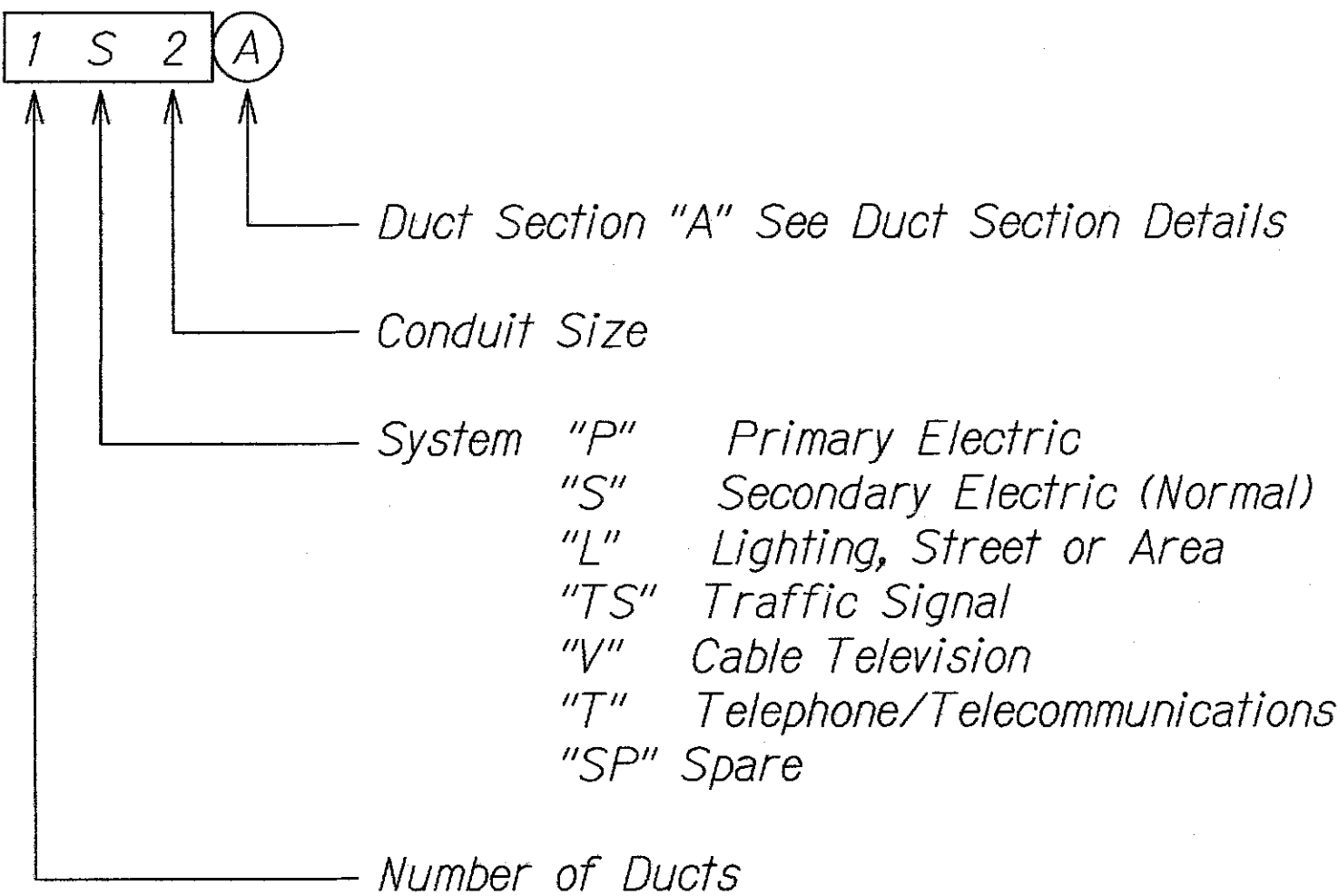

"AS-BUILT"

These Record Drawings Have Been Prepared Based on information Provided by Others. The Consultant has not Verified the Accuracy and/or Completeness of this Information and Shall Not be Responsible for any Errors or Omissions that May be Incorporated as a Result of Incomplete or Erroneous Information Provided by Others. Furthermore, the Method of Installation for the Street Light Underground Duct Lines and Light Standard Concrete Foundations Differs from the Construction Documents and the Consultant Shall Not be Responsible for These Design Deviations.

	STATE OF HAWAII DEPARTMENT OF TRANSPORTATION HIGHWAYS DIVISION
	DUCT SECTION DETAIL #
	ELECTRICAL SYMBOLS
	Kamehameha Highway Traffic Operational Improvements Vicinity of Acacia Road to Center Drive Project No. 99D/G-01-08
	Scale: Not to Scale Date: July, 2010

FED. ROAD DIST. NO.	STATE	PROJ. NO.	FISCAL YEAR	SHEET NO.	TOTAL SHEETS
HAWAII	HAW.	99D/G-01-08	2008	63S-2	89

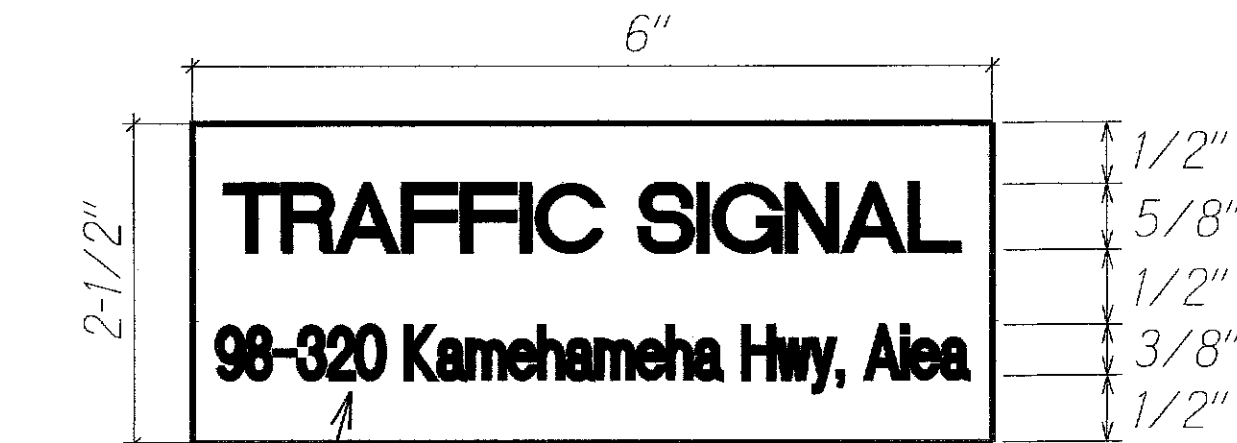
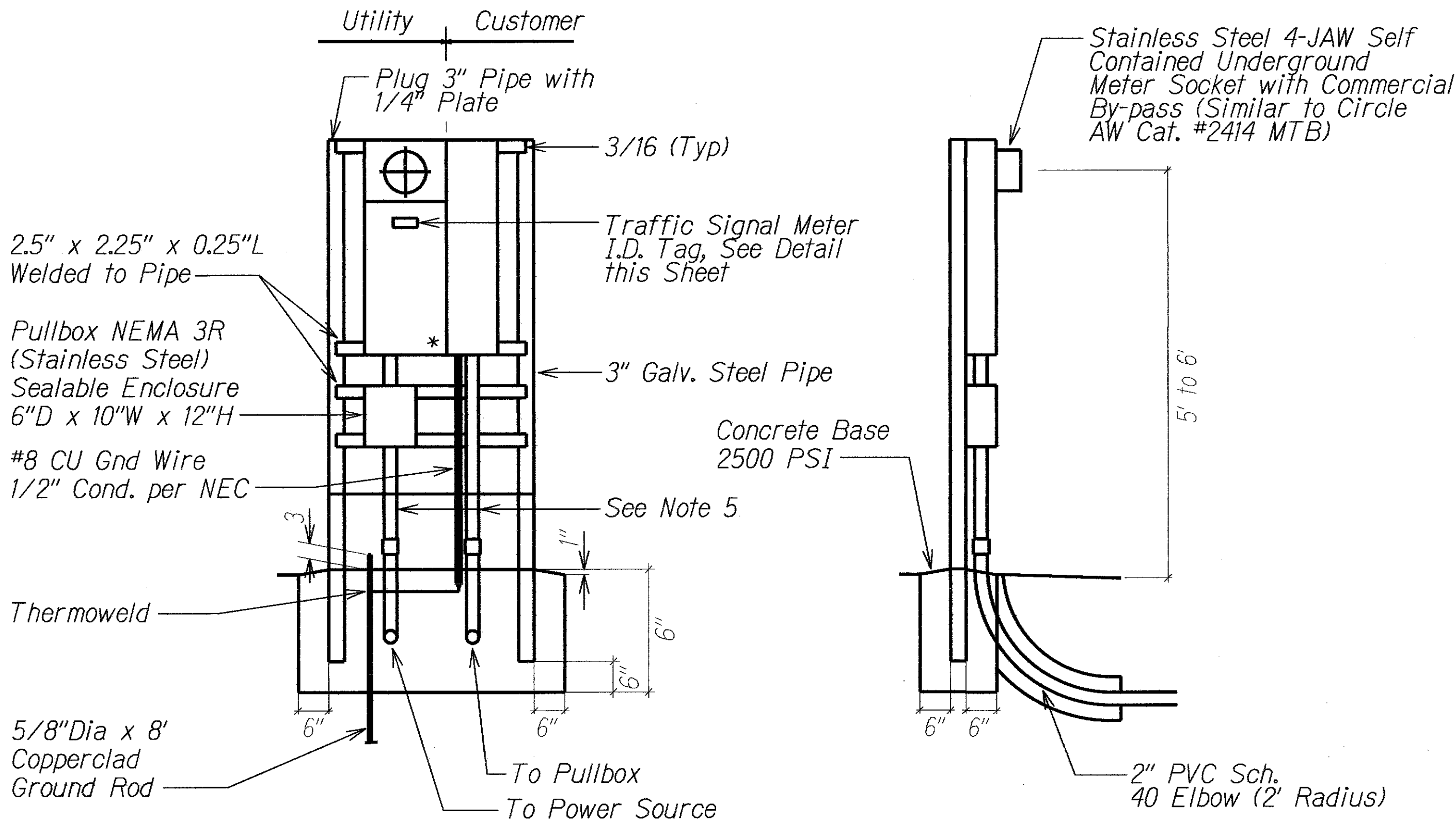

METER I.D. TAG DETAIL

Not to Scale

Notes:

1. Use 3-ply Laminated Flexible Plastic, Black-White-Black Thickness: Black Cap Sheet - 0.010", White Base Sheet - 0.052", Black Base Sheet - 0.010".
2. Attach to Meter Box Using Scotch 3M Brand Very High Bond (VHB) Double Coated Acrylic Foam Tape or Equivalent.
3. Letters/Numbers shall be 1/16" Stroke, (White in Color).
4. Letters/Numbers shall be Inscribed by Cutting Through "Black Cap Sheet" to Expose White Letters/Numbers.
5. Insert Service Address as Applicable
 - a. Kaahumanu Street : 98-320 Kamehameha Hwy, Aiea
 - b. Pali Momi Street : 98-201 Kamehameha Hwy, Aiea
 - c. Center Drive : 4301 Kamehameha Hwy, Moanalua

METER PEDESTAL FOR UNDERGROUND SERVICE

ELECTRICAL SERVICE DETAIL

Not to Scale

Notes:

1. Pedestal shall be Hot Dipped Galvanized after Fabrication.
2. All Fastening Bolts, Nuts, and Washers shall be Stainless Steel.
3. Provide 4 Ft. Clearance in Front of Meter.
4. * Denotes Sealable, NEMA 3r.
5. All Conduits Installed Above Grade Shall be Galvanized Rigid Conduit (GRC). Portions of GRC Installed in Concrete & Below Grade up to +12" Above Grade Shall be Coated with 2 Coats Asphaltic Based Paint.

"AS-BUILT"

These Record Drawings Have Been Prepared Based on information Provided by Others. The Consultant has not Verified the Accuracy and/or Completeness of this Information and Shall Not be Responsible for any Errors or Omissions that May be Incorporated as a Result of Incomplete or Erroneous Information Provided by Others. Furthermore, the Method of Installation for the Street Light Underground Duct Lines and Light Standard Concrete Foundations Differs from the Construction Documents and the Consultant Shall Not be Responsible for These Design Deviations.

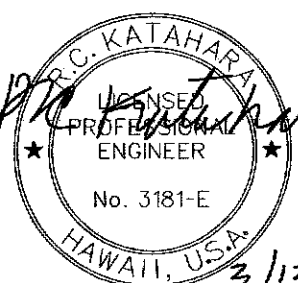
	STATE OF HAWAII DEPARTMENT OF TRANSPORTATION HIGHWAYS DIVISION
	METER DETAILS
	Kamehameha Highway Traffic Operational Improvements Vicinity of Acacia Road to Center Drive Project No. 99D/G-01-08
	Scale: Not to Scale Date: July, 2010

ORIGINAL PLAN	SURVEY PLOTTED BY	DATE
NOTE BOOK	DRAWN BY	
	DESIGNED BY	
	CHECKED BY	

FED. ROAD DIST. NO.	STATE	PROJ. NO.	FISCAL YEAR	SHEET NO.	TOTAL SHEETS
HAWAII	HAW.	99D/G-01-08	2008	63S-3	89

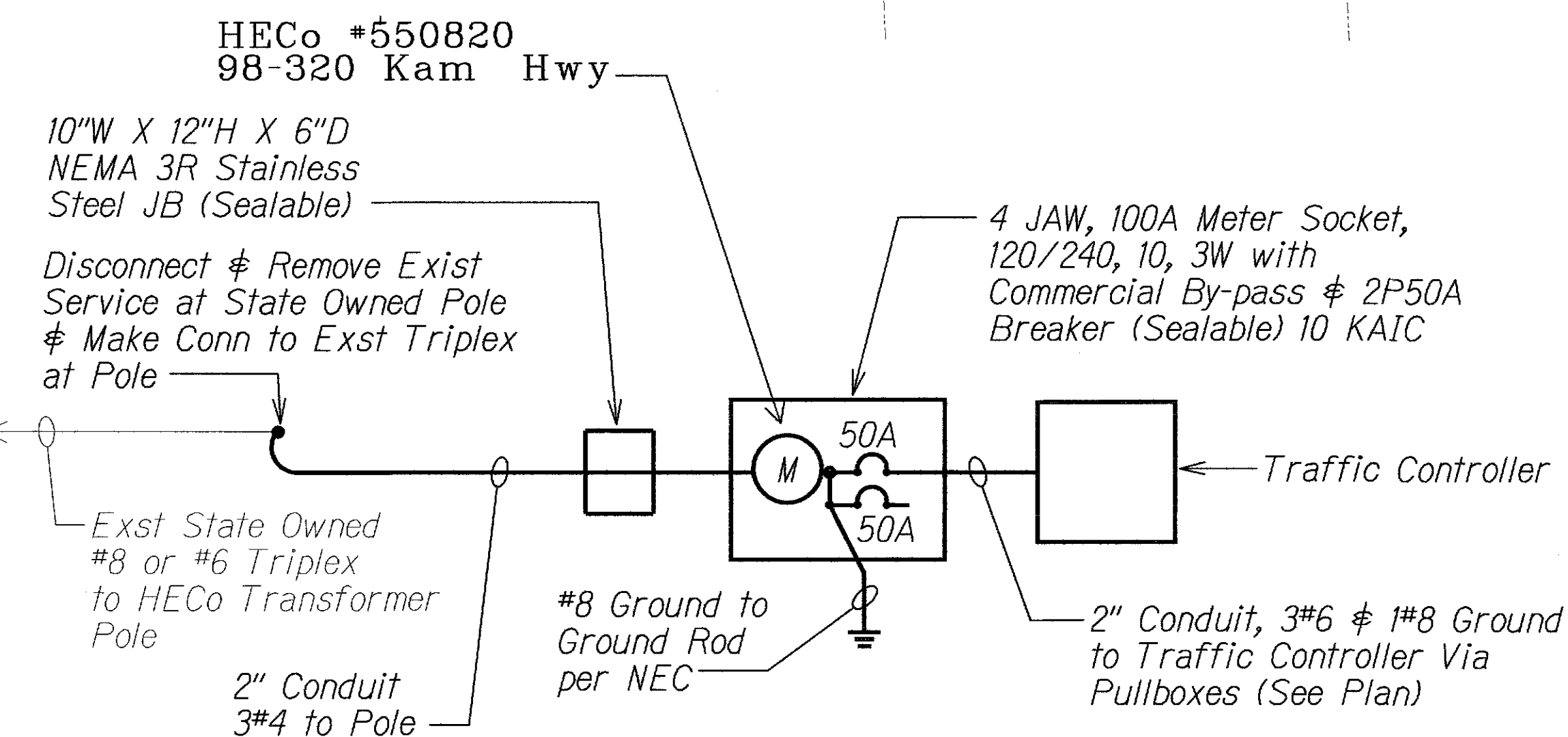
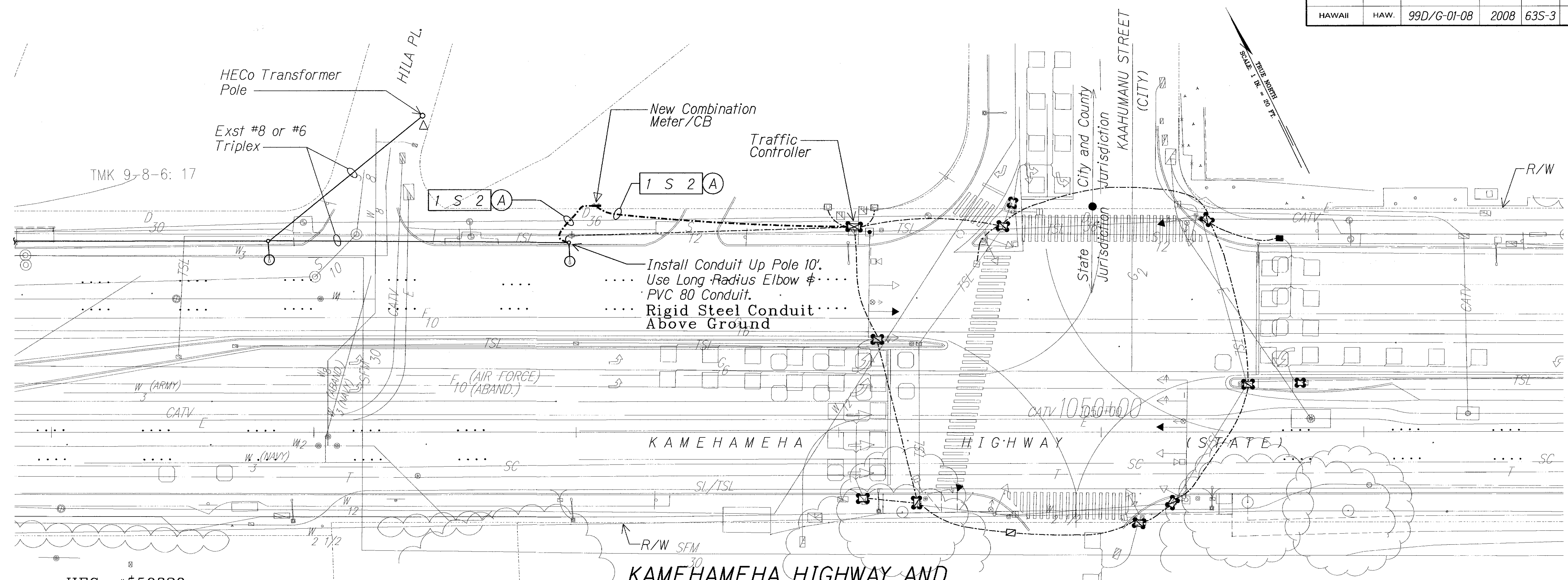

ONE-LINE DIAGRAM

Not to Scale

Notes:

- Coordinate Meter Switch Over (Old to New) With HECo. HECo to Disconnect Aerial Triplex at Transformer Pole to Allow De-Energized Cut-Over & to Reconnect After Meter is Connected.

LEGEND FOR AS-BUILT POSTINGS

	Squiggly line for as-built deletion
	Double line for as-built deletion
Roadway	Text for as-built posting

Notes:

- Light Lines Denote Existing Condition. Bold Lines Denote New Work.
- Refer to Trench Details on Sheet TS-33 and TS-34.
- Should Existing Fiber Optic Cable be Damaged by Contractor, Contractor shall Replace Existing Fiber Optic Cable at No Cost to the State.
- See sheet TS-06 for Traffic Signal Plan.

"AS-BUILT"

These Record Drawings Have Been Prepared Based on information Provided by Others. The Consultant has not Verified the Accuracy and/or Completeness of this Information and Shall Not be Responsible for any Errors or Omissions that May be Incorporated as a Result of Incomplete or Erroneous Information Provided by Others. Furthermore, the Method of Installation for the Street Light Underground Duct Lines and Light Standard Concrete Foundations Differs from the Construction Documents and the Consultant Shall Not be Responsible for These Design Deviations.

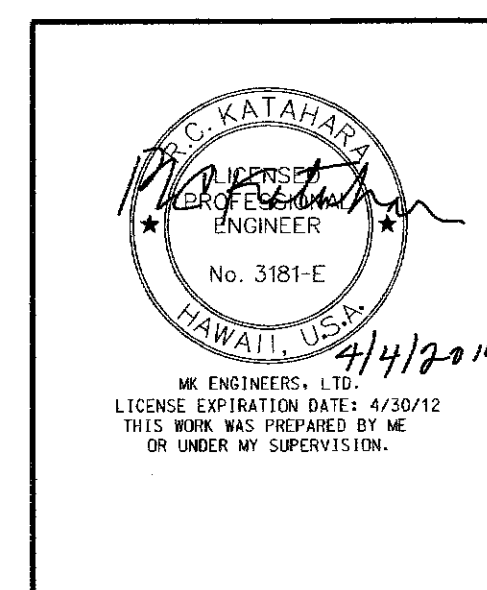
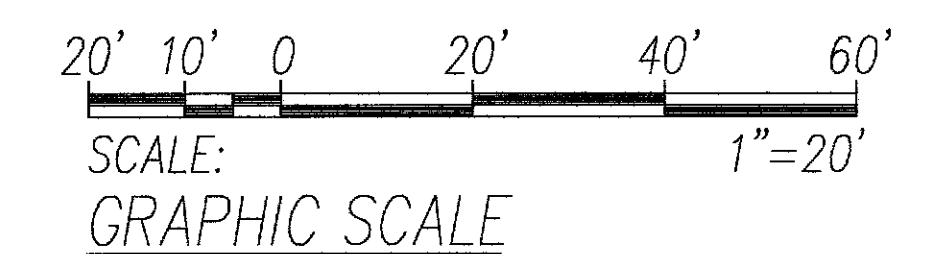
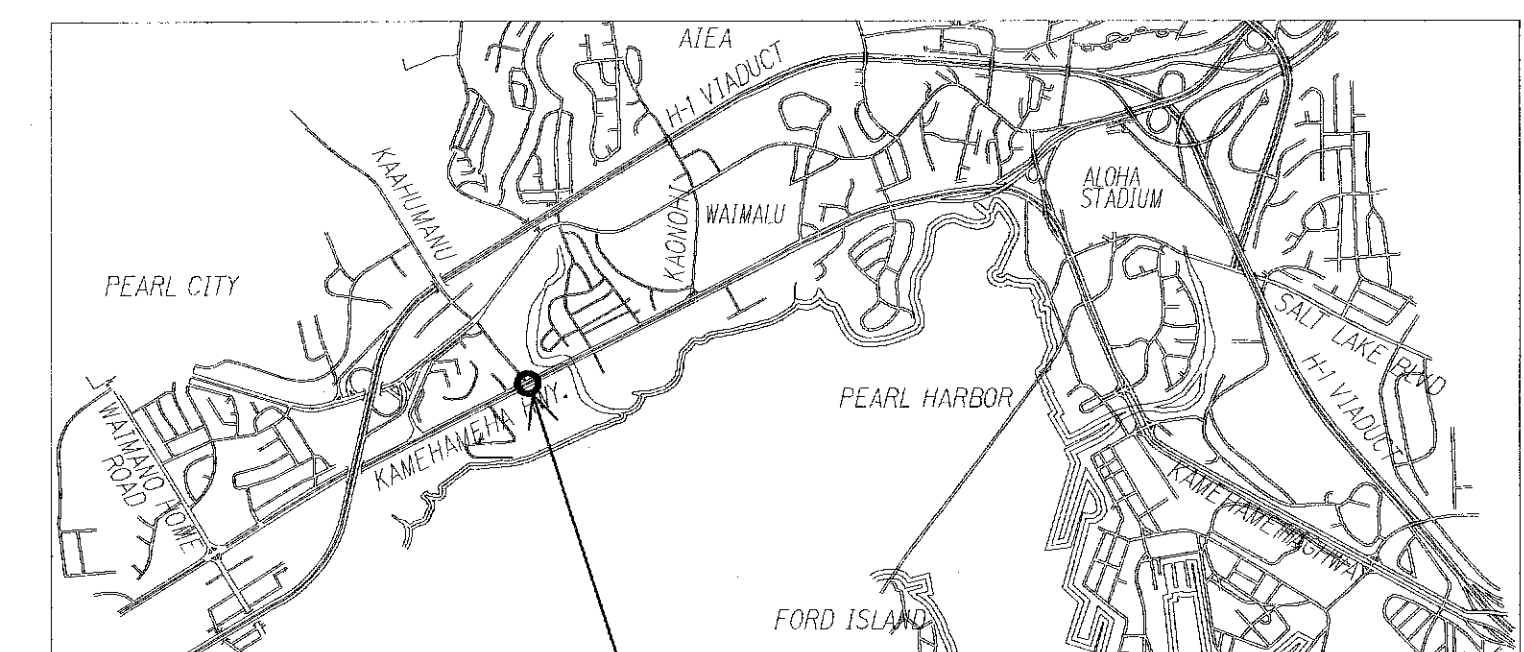

STATE OF HAWAII
DEPARTMENT OF TRANSPORTATION
HIGHWAYS DIVISION

SITE ELECTRICAL PLAN
& ONE-LINE DIAGRAM

Kamehameha Highway
Traffic Operational Improvements
Vicinity of Acacia Road to Center Drive
Project No. 99D/G-01-08

Scale: 1" = 20'-0" Date: July, 2010

SHEET No. E-3 OF 5 SHEETS

AS-BUILT

63S-3

FED. ROAD DIST. NO.	STATE	PROJ. NO.	FISCAL YEAR	SHEET NO.	TOTAL SHEETS
HAWAII	HAW.	99D/G-01-08	2008	63S-4	89

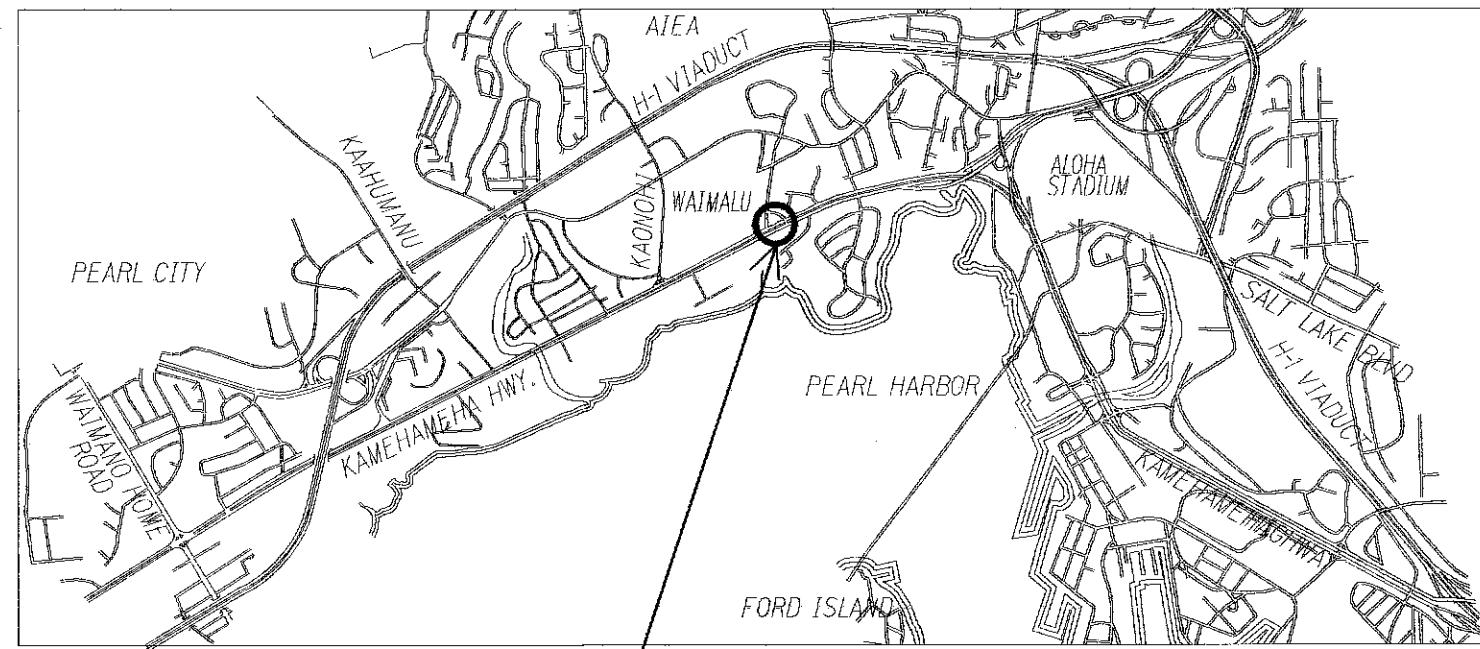

Project Site

10"W X 12"H X 6"D
NEMA 3R Stainless
Steel JB (Sealable)
2" Conduit
3#2 to Handhole
(Conductors by HECO)

HECo #550801
98-201 Kam Hwy

4 JAW, 100A Meter Socket,
120/240, 10, 3W with
Commercial By-pass & 2P50A
Breaker (Sealable) 30,000 AIC

Nema Type 1 Load Center with
3ea 2P50A CB (10,00AIC)
in Nema 4X Hinged Cabinet
Padlockable Enclosure

Inbound
Traffic Controller

Outbound
Traffic Controller

Denny's
Traffic Controller

Connect in
Exst Handhole

TMK 9-8-25: 40

TRUE NORTH
SCALE 1" = 20' ft.

ONE-LINE DIAGRAM

Not to Scale

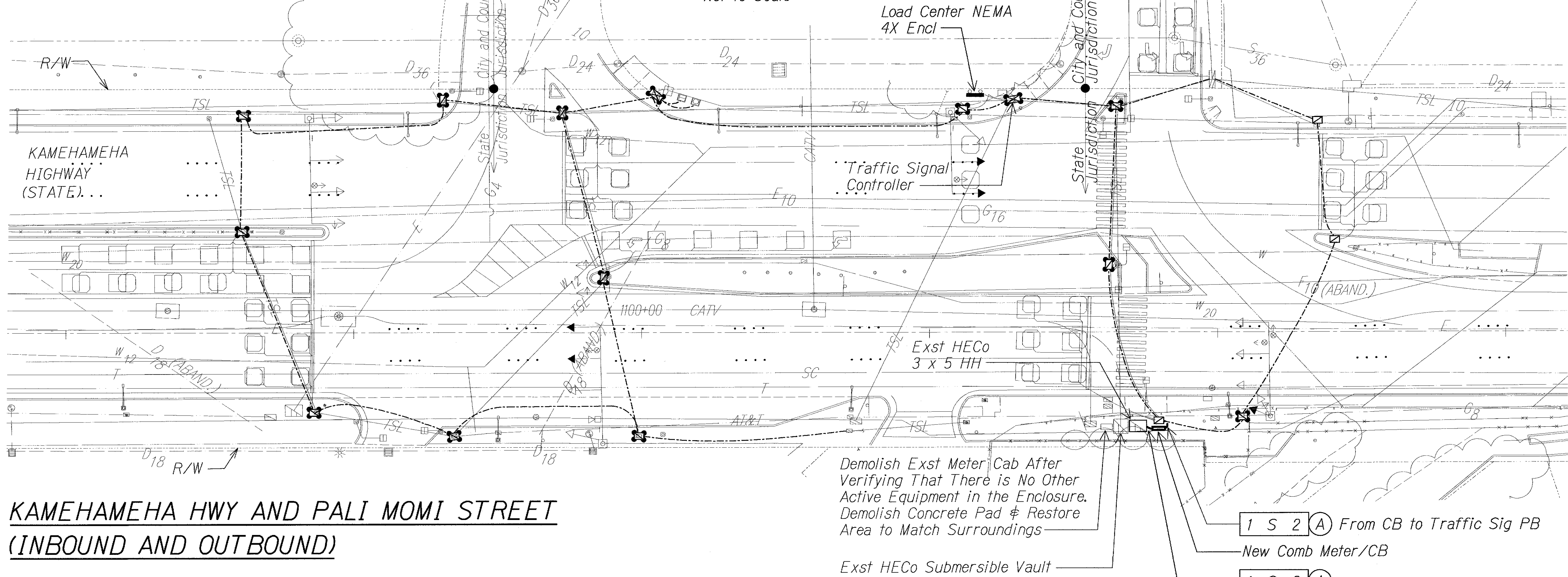

KAMEHAMEHA HWY AND PALI MOMI STREET (INBOUND AND OUTBOUND)

Notes:

- Light Lines Denote Existing Condition.
Bold Lines Denote New Work.
- Refer to Trench Details on Sheet TS-33 and TS-34.
- Should Existing Fiber Optic Cable be Damaged by Contractor, Contractor shall Replace Existing Fiber Optic Cable at No Cost to the State.
- See sheet TS-11 for Traffic Signal Plan.

LEGEND FOR AS-BUILT POSTINGS

	Squiggly line for as-built deletion
	Double line for as-built deletion
Roadway	Text for as-built posting

"AS-BUILT"

These Record Drawings Have Been Prepared Based on information Provided by Others. The Consultant has not Verified the Accuracy and/or Completeness of this Information and Shall Not be Responsible for any Errors or Omissions that May be Incorporated as a Result of Incomplete or Erroneous Information Provided by Others. Furthermore, the Method of Installation for the Street Light Underground Duct Lines and Light Standard Concrete Foundations Differs from the Construction Documents and the Consultant Shall Not be Responsible for These Design Deviations.

1 S 2 (A) From CB to Traffic Sig PB

New Comb Meter/CB

1 S 2 (A)

Install Conduit into Heco HH
Under HECO Supervision

20' 10' 0 20' 40' 60'
SCALE:
GRAPHIC SCALE
1"=20'

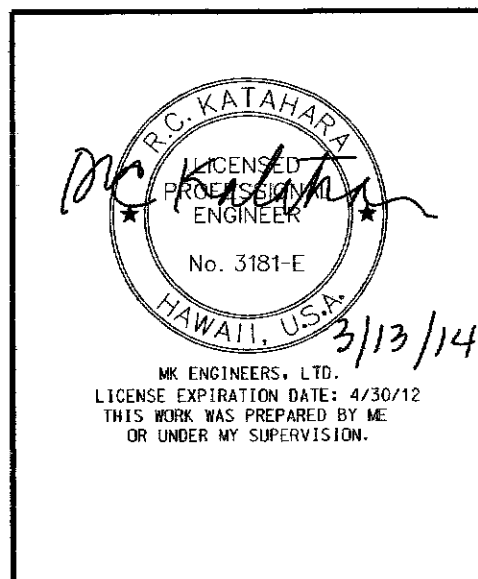

STATE OF HAWAII
DEPARTMENT OF TRANSPORTATION
HIGHWAYS DIVISION

SITE ELECTRICAL PLAN & ONE-LINE DIAGRAM

Kamehameha Highway
Traffic Operational Improvements
Vicinity of Acacia Road to Center Drive
Project No. 99D/G-01-08

Scale: 1" = 20'-0" Date: July, 2010

SHEET No. E-4 OF 5 SHEETS

