

| FED. ROAD DIST. NO. | STATE | PROJ. NO. | FISCAL YEAR | SHEET NO. | TOTAL SHEETS |
|---------------------|-------|-----------|-------------|-----------|--------------|
| HAWAII              | HAW.  | 99E-01-03 | 2004        | 8         | 12           |

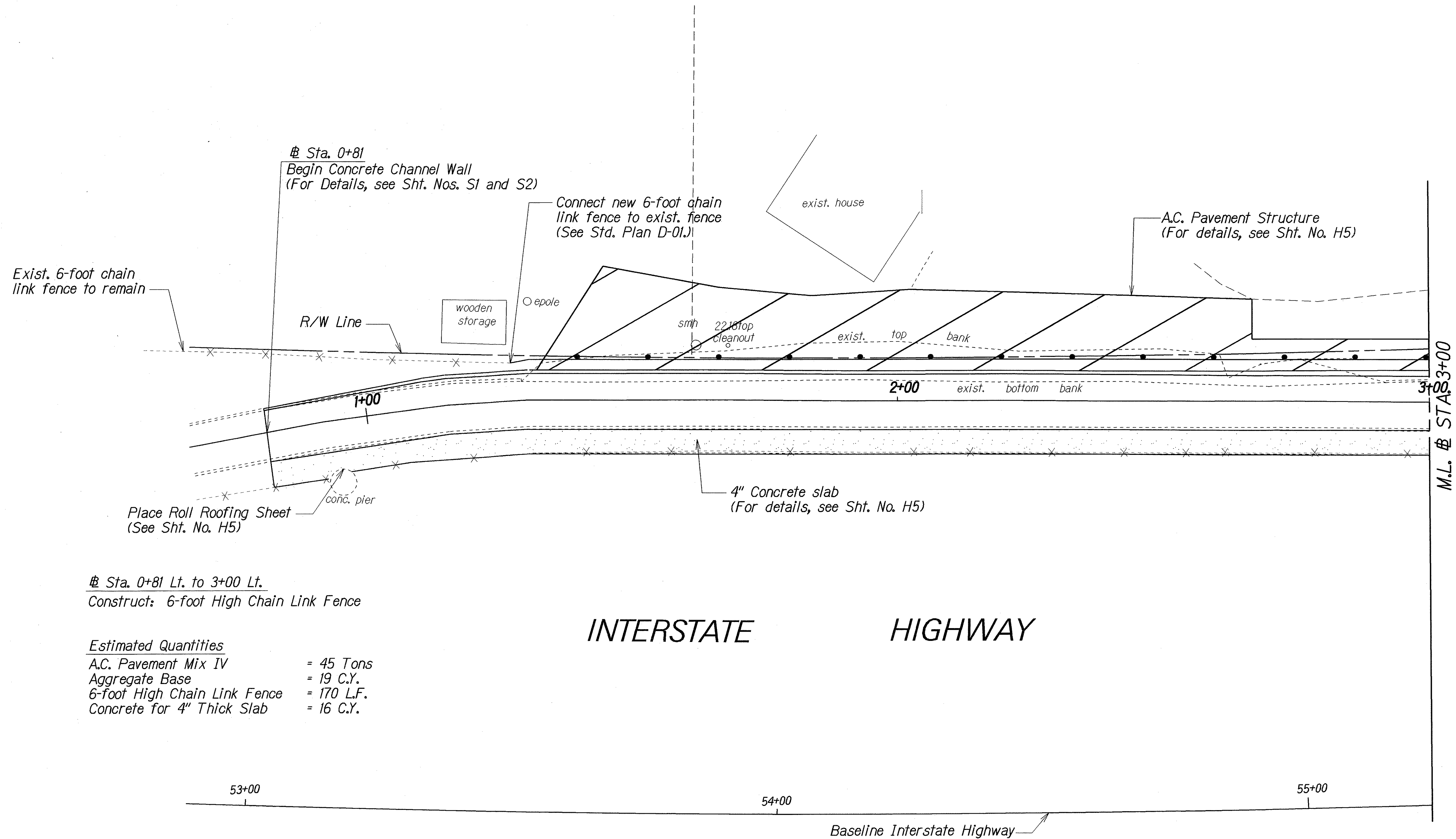

Sta. 0+81 Lt. to 3+00 Lt.  
 Construct: 6-foot High Chain Link Fence

Estimated Quantities

|                              |            |
|------------------------------|------------|
| A.C. Pavement Mix IV         | = 45 Tons  |
| Aggregate Base               | = 19 C.Y.  |
| 6-foot High Chain Link Fence | = 170 L.F. |
| Concrete for 4" Thick Slab   | = 16 C.Y.  |

|                   |      |
|-------------------|------|
| SURVEY PLOTTED BY | DATE |
| DRAWN BY          |      |
| DESIGNED BY       |      |
| NOTED BY          |      |
| CHECKED BY        |      |
| ORIGINAL PLAN     |      |
| NOTE BOOK         |      |
| QUANTITIES BY     |      |
| CHECKED BY        |      |

STATE OF HAWAII  
DEPARTMENT OF TRANSPORTATION  
HIGHWAYS DIVISION

DRAINAGE PLAN  
KAMEHAMEHA HIGHWAY DRAINAGE IMPROVEMENTS  
Vicinity of Wai'au Power Plant  
Project No. 99E-01-03  
Scale: 1"=10'      Date: Aug. 2003

SHEET No. H3 OF 5 SHEETS

