

FED. ROAD DIST. NO.	STATE	PROJ. NO.	FISCAL YEAR	SHEET NO.	TOTAL SHEETS
HAWAII	HAW.	93A-01-23M	2023	ADD. 19	26

**GENERAL NOTES FOR
TRAFFIC CONTROL PLAN (WITHIN CITY R/W)**

1. The Permittee shall make minor adjustments at intersections, driveways, bridges, structures, etc. to fit field conditions.
2. Cones or delineators shall be extended to a point where they are visible to approaching traffic.
3. Traffic control devices shall be installed such that the sign or device farthest from the work area is placed first. The others shall then be placed progressively toward the work area.
4. Regulatory and Warning Signs within the construction zone that are in conflict with the traffic control plans shall be removed or covered.
5. Flaggers and/or police officers shall be in sight of each other or in direct communication at all times.
6. When required by the issuing office, the Permittee shall install a flashing arrow signal as shown on the traffic control plans.
7. All traffic lanes shall be a minimum of 10 feet wide.
8. All construction warning signs shall be promptly removed or covered whenever the message is not applicable or not in use.
9. The backs of all signs used for traffic control shall be appropriately covered to preclude the display of inapplicable sign messages (i.e., when signs have messages on both faces).
10. Lane closure shall be limited only to the extent of accomplishing each day's work. As soon as each day's work is completed, the Permittee shall remove all traffic control devices no longer needed to permit free and safe passage of public traffic. Removal shall be in the reverse order of installation. Existing faded or obliterated pavement markings that are necessary for safe traffic flow in the construction area shall be replaced with temporary or permanent markings before opening the roadway to public traffic each day.
11. Permanent pavement markings and traffic signs shall be replaced upon completion of each phase of work.
12. Cones and delineators shall be spaced at a maximum distance of 20 feet apart. A minimum of six channelizing devices shall be used for each taper length.
13. Driveways shall be kept open unless the owners of the property using the driveway are otherwise provided for satisfactorily. Further, the Permittee shall control traffic going into and out of driveways.
14. Buffer and taper area on approach to any work area shall be kept clear of vehicles and equipment.
15. A high level warning device (flag tree) shall be installed on approach to all work areas.
16. "No Parking" signs shall be posted within any work area and for the buffer and taper areas approaching the work area.
17. Where an accessible pedestrian route is closed or blocked during construction, Contractor to provide temporary, accessible pedestrian route.
18. Traffic Control Plans are approved for work on any City street area only between the hours of 08:30 A.M. and 03:30 P.M. (Monday-Friday).

DESIGNED BY	DATE
DRAWN BY	DATE
CHECKED BY	DATE
NOTED BY	DATE
REVIEWED BY	DATE
APPROVED BY	DATE

△ **Approved:**

[Signature] 4/19/23 Date
 Chief, Traffic Review Branch, D.P.P. WA
 City & County of Honolulu
 (For Work within City ROW only)

7/7/23 Date	△ Added signature. Revision
<div style="display: flex; justify-content: space-between;"> <div>  <p>THIS WORK WAS PREPARED BY ME OR UNDER MY SUPERVISION. <i>[Signature]</i> 04/20/24 SIGNATURE EXPIRATION DATE OF THE LICENSE</p> </div> <div> <p>STATE OF HAWAII DEPARTMENT OF TRANSPORTATION HIGHWAYS DIVISION</p> <p>TRAFFIC CONTROL NOTES</p> <p>FARRINGTON HIGHWAY Uleahawa Stream Bridge Repairs Project. No. 93A-01-23M</p> <p>Scale: None Date: Mar. 2023</p> </div> </div>	
SHEET No. TC-2 OF 5 SHEETS	

FED. ROAD DIST. NO.	STATE	PROJ. NO.	FISCAL YEAR	SHEET NO.	TOTAL SHEETS
HAWAII	HAW.	93A-01-23M	2023	ADD. 21	26

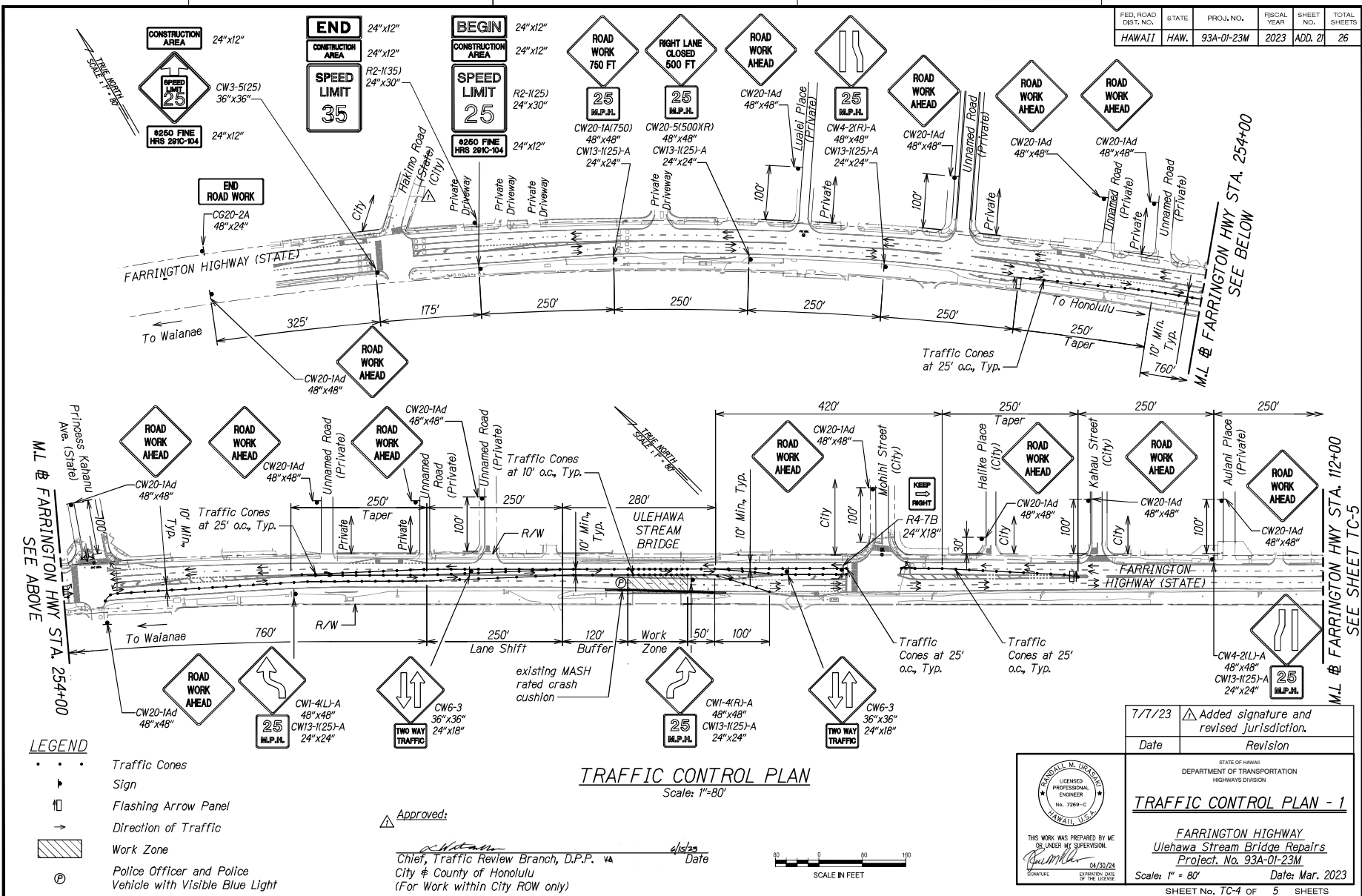

FED. ROAD DIST. NO.	STATE	PROJ. NO.	FISCAL YEAR	SHEET NO.	TOTAL SHEETS
HAWAII	HAW.	93A-01-23M	2023	ADD. 22	26

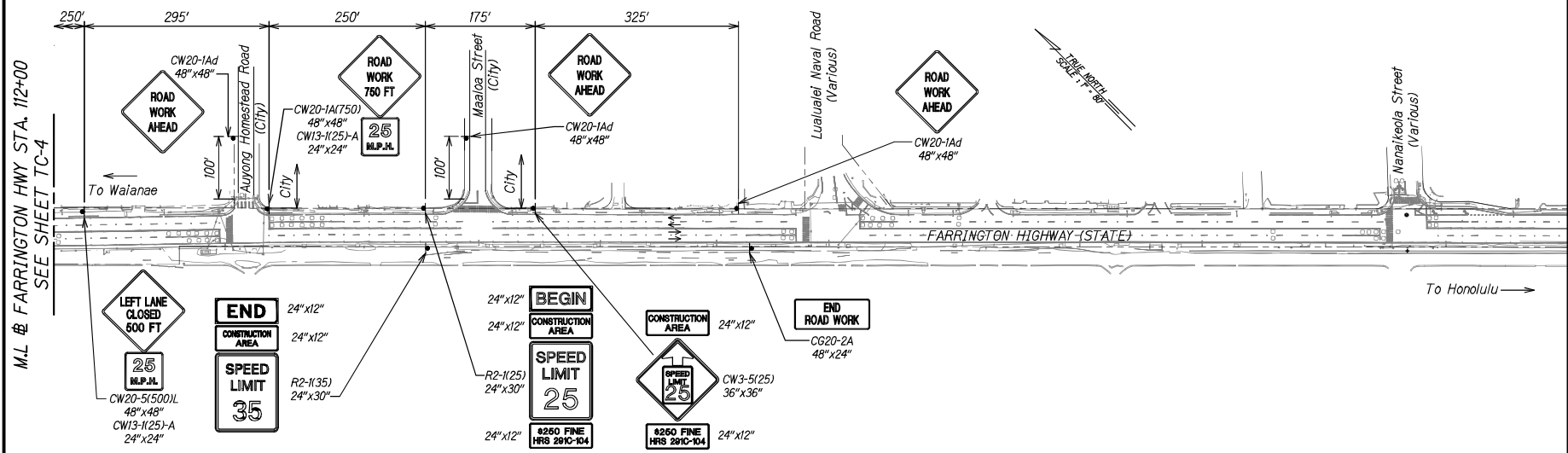

TRAFFIC CONTROL PLAN
Scale: 1"=80'

LEGEND

- ▴ Sign
- Direction of Traffic

Approved:

[Signature]
Chief, Traffic Review Branch, D.P.P. VA
City & County of Honolulu
(For Work within City ROW only)
Date: 4/5/23



7/7/23	Added signature.
Date	Revision

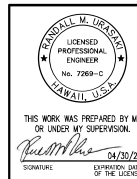

STATE OF HAWAII
DEPARTMENT OF TRANSPORTATION
HIGHWAYS DIVISION
TRAFFIC CONTROL PLAN - 2
FARRINGTON HIGHWAY
Ulehewa Stream Bridge Repairs
Project. No. 93A-01-23M
Scale: 1" = 80' Date: Mar. 2023

DESIGNED BY	DATE
DRAWN BY	
CHECKED BY	
NOTED BY	
APPROVED BY	
DATE	