

FED. ROAD DIST. NO.	STATE	PROJ. NO.	FISCAL YEAR	SHEET NO.	TOTAL SHEETS
HAWAII	HAW.	93A-01-12	2016	24	29

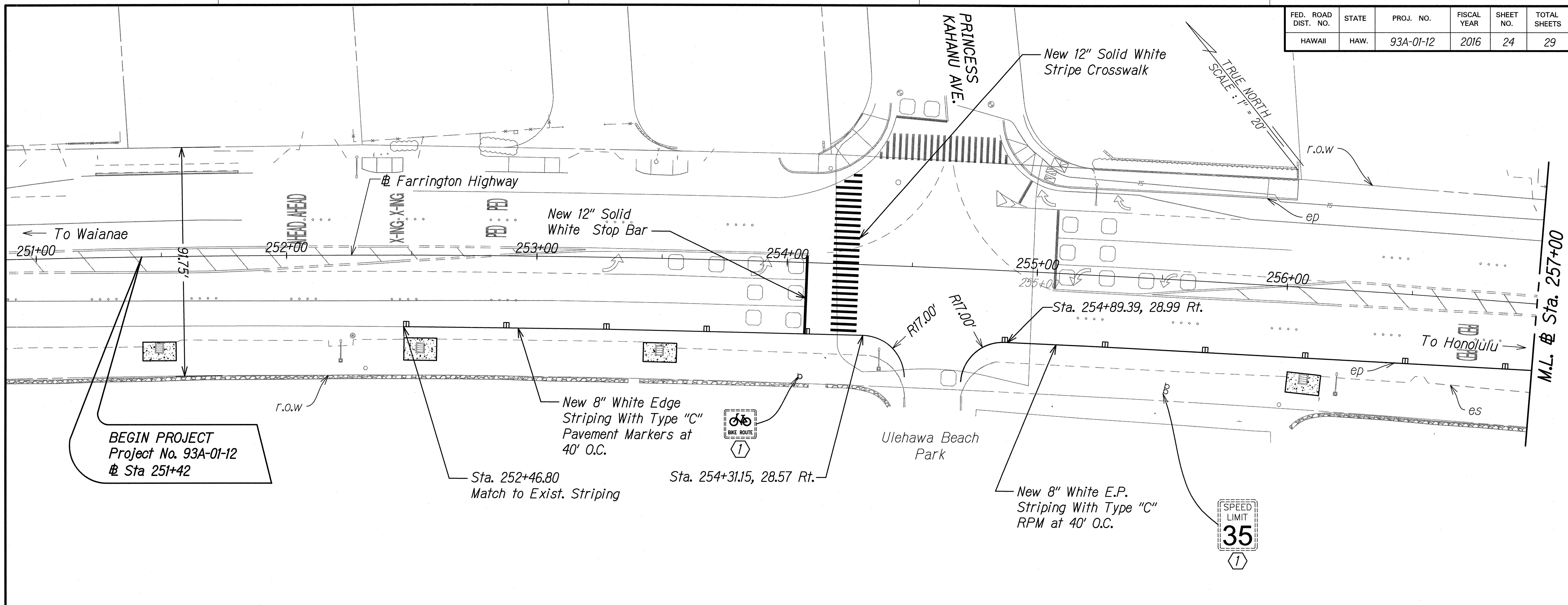

BEGIN PROJECT
Project No. 93A-01-12
Sta 251+42

- LEGEND:**
- ① Existing Sign(s) and Post(s) to Remain
 - ② Relocate Existing Sign(s) and Post(s) to New Location

SURVEY PLOTTED BY	DATE
DRAWN BY	
TRACED BY	
NOTE BOOK	
QUANTITIES BY	
CHECKED BY	
No.	

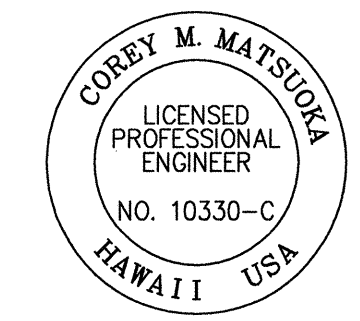

THIS WORK WAS PREPARED BY ME
OR UNDER MY SUPERVISION

Corey Matsuka 4/30/16
SIGNATURE EXPIRATION DATE OF THE LICENSE

STATE OF HAWAII
DEPARTMENT OF TRANSPORTATION
HIGHWAYS DIVISION

SIGNING AND PAVEMENT MARKING PLANS

FARRINGTON HIGHWAY DRAINAGE IMPROVEMENTS
Vicinity of Princess Kahanu Avenue
Project No. 93A-01-12

Scale: 1" = 20' Date: Oct. 2015

SHEET No. 1 OF 2 SHEETS

FED. ROAD DIST. NO.	STATE	PROJ. NO.	FISCAL YEAR	SHEET NO.	TOTAL SHEETS
HAWAII	HAW.	93A-01-12	2016	25	29

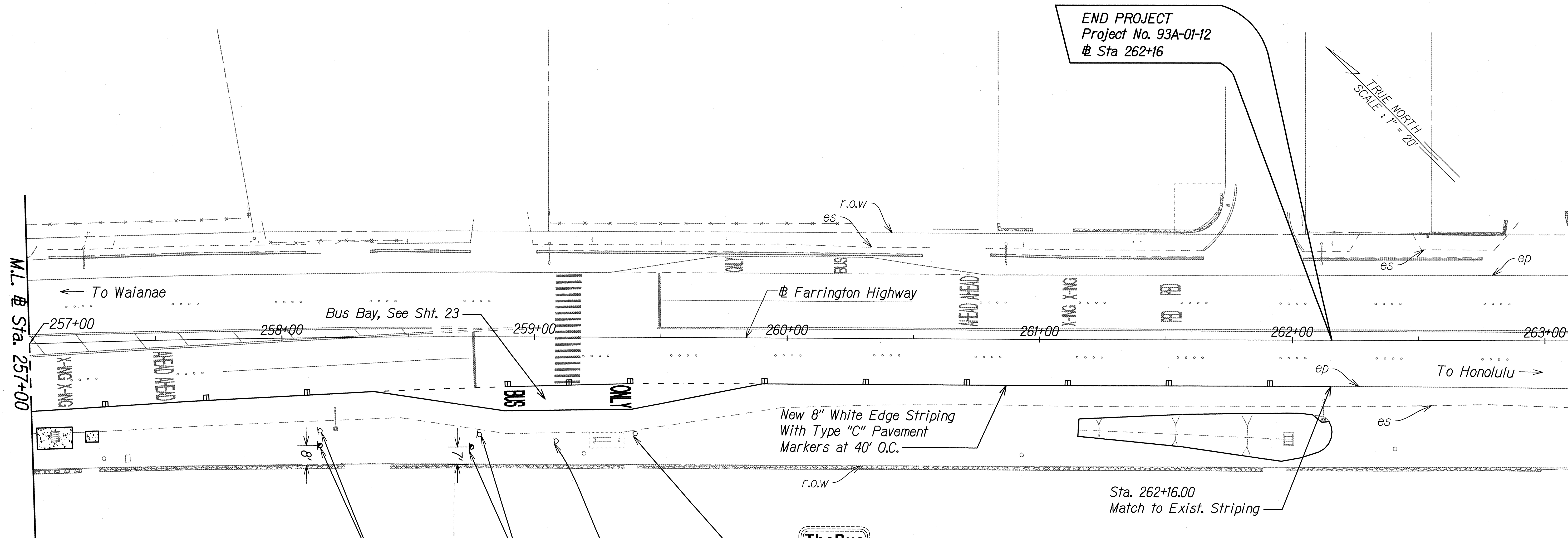

END PROJECT
Project No. 93A-01-12
Sta 262+16

TRUE NORTH
SCALE: 1" = 20'

New 8" White Edge Striping
With Type "C" Pavement
Markers at 40' O.C.

Sta. 262+16.00
Match to Exist. Striping

- LEGEND:**
- ① Existing Sign(s) and Post(s) to Remain
 - ② Relocate Existing Sign(s) and Post(s) to New Location. Signs to remain in relocated location.
 - ③ Cover Bus Stop Sign During Bus Stop Relocation

SURVEY PLOTTED BY	DATE
DRAWN BY	
DESIGNED BY	
QUANTITIES BY	
CHECKED BY	
ORIGINAL PLAN	No.

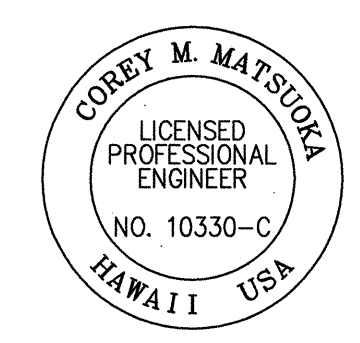
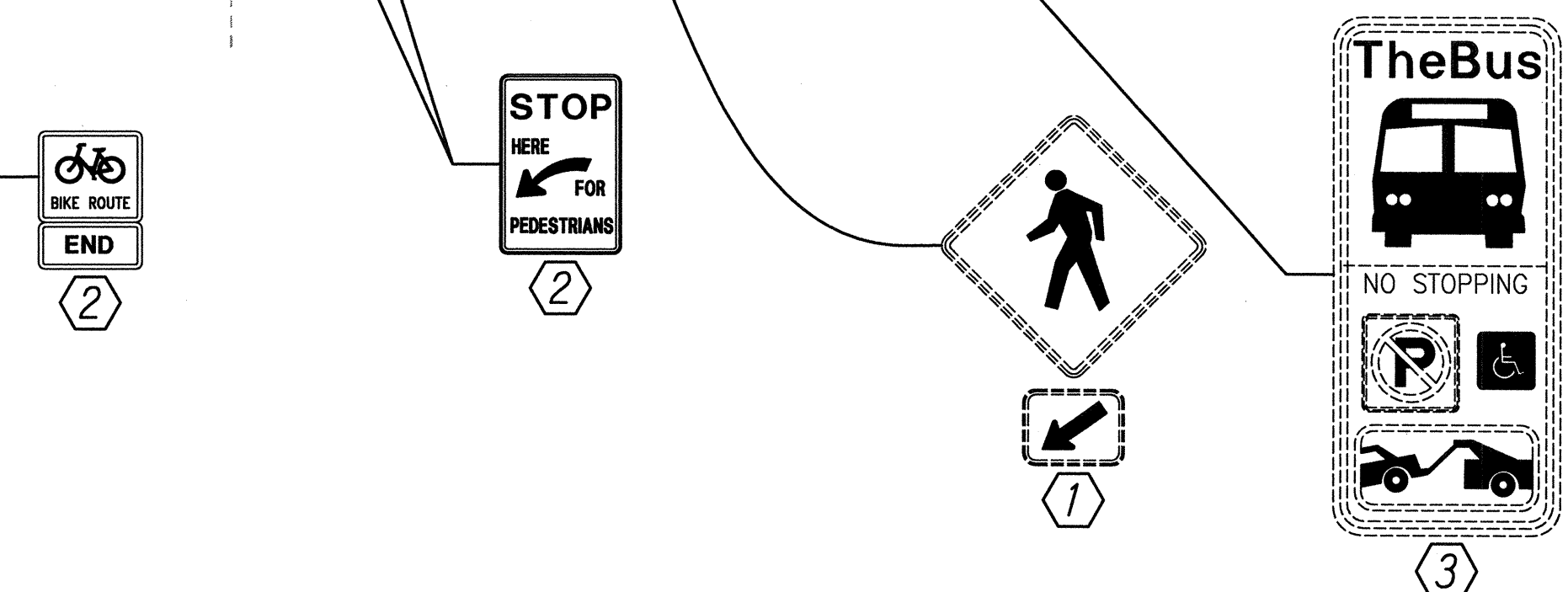

THIS WORK WAS PREPARED BY ME
OR UNDER MY SUPERVISION

Corey Matsuyoka 4/30/16
SIGNATURE EXPIRATION DATE OF THE LICENSE

STATE OF HAWAII
DEPARTMENT OF TRANSPORTATION
HIGHWAYS DIVISION

SIGNING AND PAVEMENT MARKING PLANS

FARRINGTON HIGHWAY DRAINAGE IMPROVEMENTS
Vicinity of Princess Kahanu Avenue
Project No. 93A-01-12

Scale: 1" = 20' Date: Oct. 2015

SHEET No. 2 OF 2 SHEETS