

| FED. ROAD DIST. NO. | STATE | FED. AID PROJ. NO. | FISCAL YEAR | SHEET NO. | TOTAL SHEETS |
|---------------------|-------|--------------------|-------------|-----------|--------------|
| HAWAII | HAW. | BR-093-1(21) | 2015 | 45 | 99 |

NOTES:

1. This Work Zone Sign Plan is intended for use on long-term stationary work zones/construction phases (3 days or more). All work zones or construction phases less than 3 days duration will use Traffic Control Plans shown in Section 645 of the Special Provisions.
2. All existing regulatory speed limit signs with posts within the work zone/project limits shall be removed and replaced with work zone speed limit sign assemblies (R2-1(25) and CW3-5(25) with "CONSTRUCTION AREA" and "\$250 FINE HRS 291C-104" Supplemental Signs).
3. Construction sign assemblies shall be installed on both the approaching and trailing ends of each work zones as shown on this plan.
4. Each construction warning sign and work zone speed limit assembly shall have a minimum of two (2) Type OM2-2V.. Refer to 2005 Hawaii Standard Specifications section 631 and 645 for furnishing and installing traffic control regulatory, warning, and miscellaneous signs.
5. Upon the completion of all physical work or as directed by the Engineer, all construction signs and work zone speed limit assemblies shall be removed. All speed limit signs and posts that were existing at the start of the project within the work zone/project limits shall be restored back to their original locations and configurations.
6. Placement of construction signs shall not obstruct the path of pedestrians and bicyclists.
7. For the removal and restoration of existing regulatory speed limit signs and new posts, as well as the installation, maintenance and removal of work zone speed limit sign assemblies, refer to 2005 Hawaii Standard Specifications section 631 and 645.

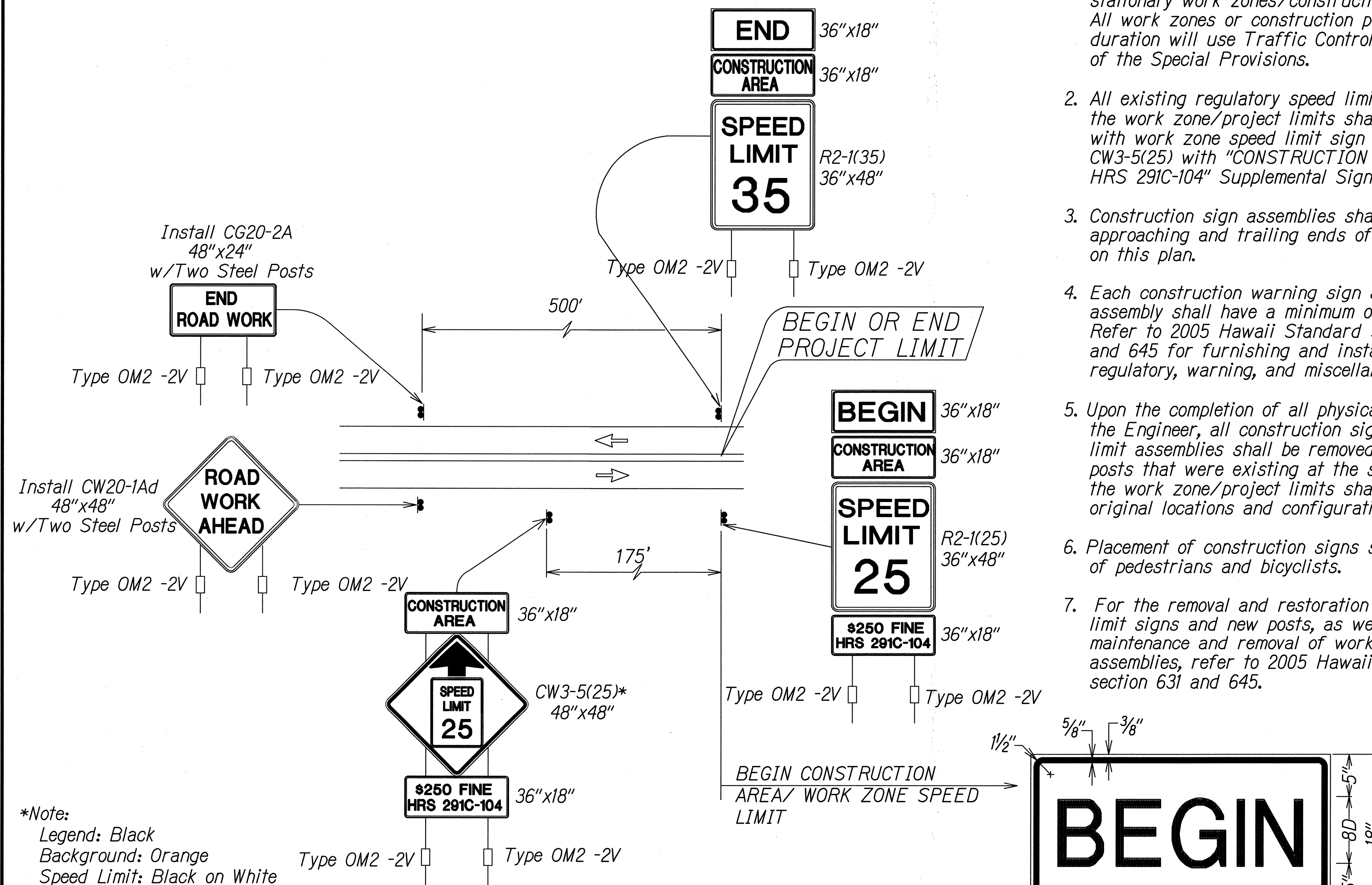

*Note:
 Legend: Black
 Background: Orange
 Speed Limit: Black on White

**TYPICAL DETAIL FOR CONSTRUCTION SIGNS
 ON TWO LANE OR MULTILANE UNDIVIDED LOW SPEED HIGHWAY**

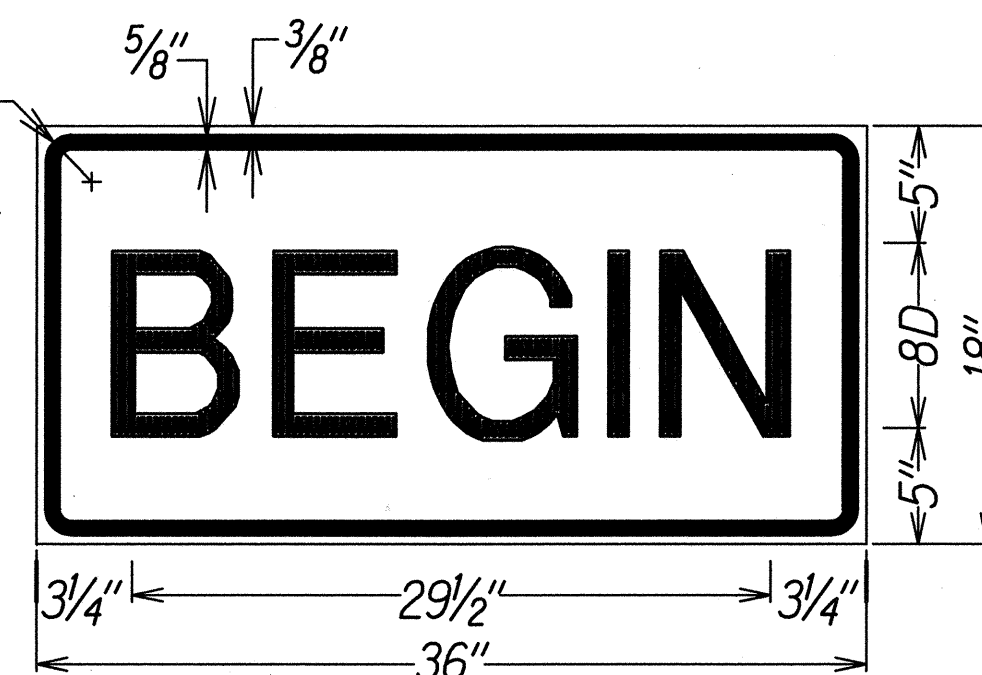

LEGEND: BLACK
 BACKGROUND: ORANGE

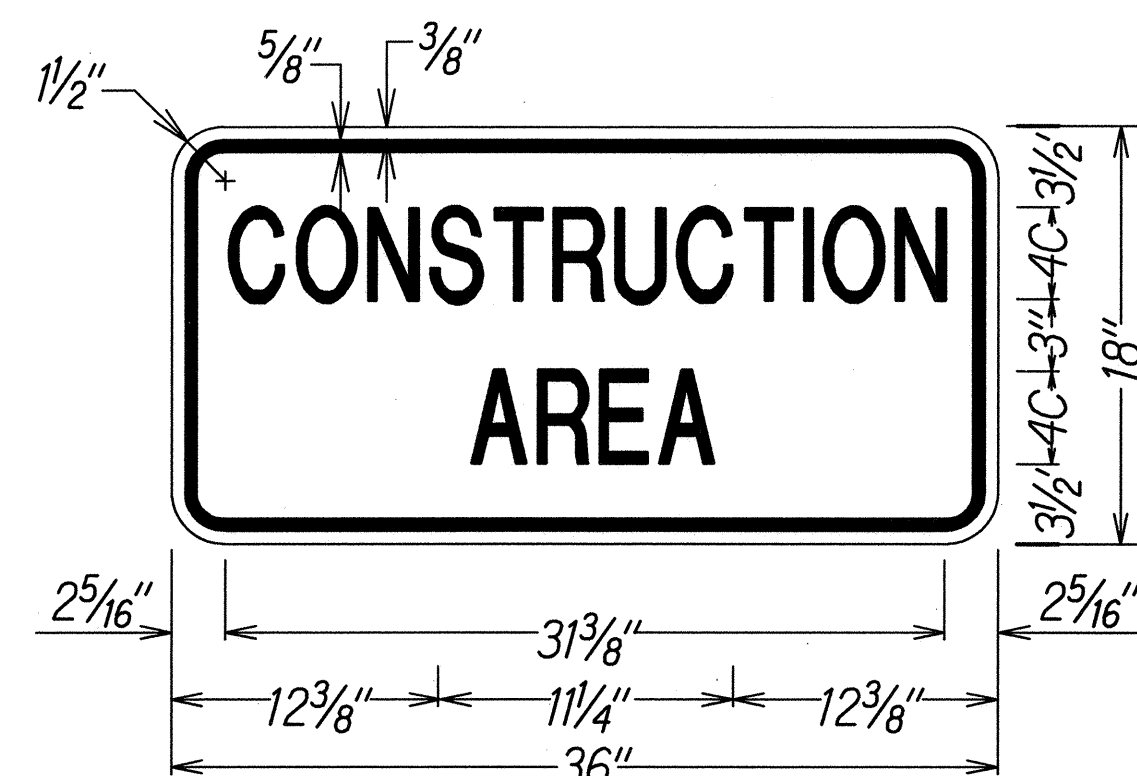

LEGEND: BLACK
 BACKGROUND: ORANGE

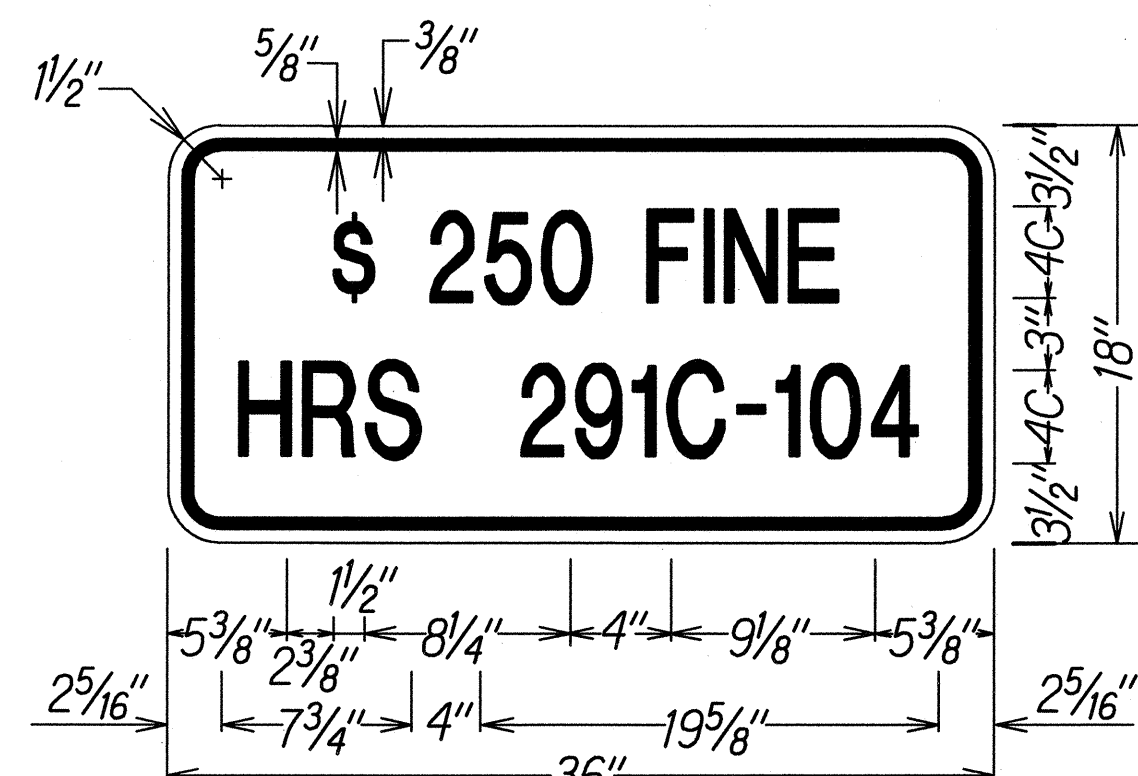

LEGEND: BLACK
 BACKGROUND: WHITE

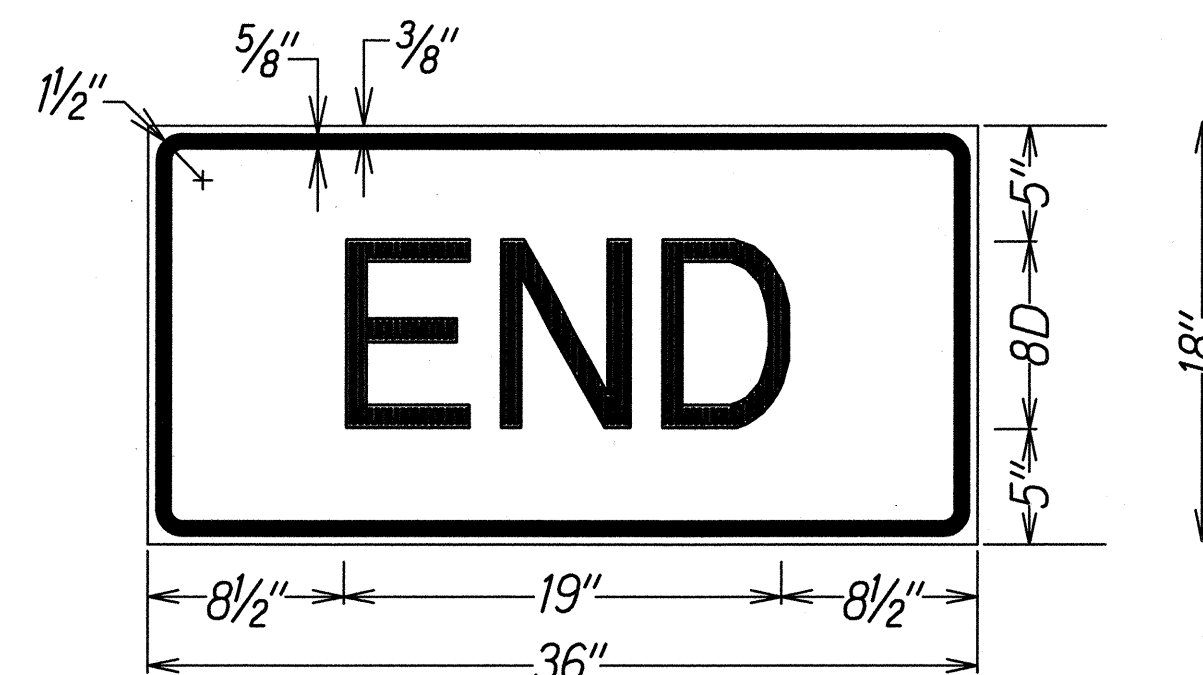

LEGEND: BLACK
 BACKGROUND: ORANGE

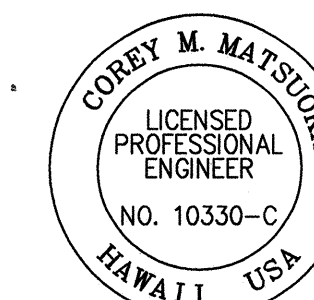

THIS WORK WAS PREPARED BY ME
 OR UNDER MY SUPERVISION

Signature: Corey Matsuda
 Date: 4/30/16

EXPIRATION
 DATE OF THE
 LICENSE

STATE OF HAWAII
 DEPARTMENT OF TRANSPORTATION
 HIGHWAYS DIVISION

WORK ZONE SIGNING PLAN,
NOTES & DETAILS
 FARRINGTON HIGHWAY
 Replacement of Maipalaoa Bridge
 Federal Aid Project No. BR-093-1(21)

Scale: N.T.S. Date: JUNE 2015
 SHEET No. 1 OF 1 SHEETS