

| FED. ROAD DIST. NO. | STATE | FEDERAL AID PROJ. NO. | FISCAL YEAR | SHEET NO. | TOTAL SHEETS |
|---------------------|-------|-----------------------|-------------|-----------|--------------|
| HAWAII              | HAW.  | STP-093-1(22)         | 2013        | 16        | 230          |

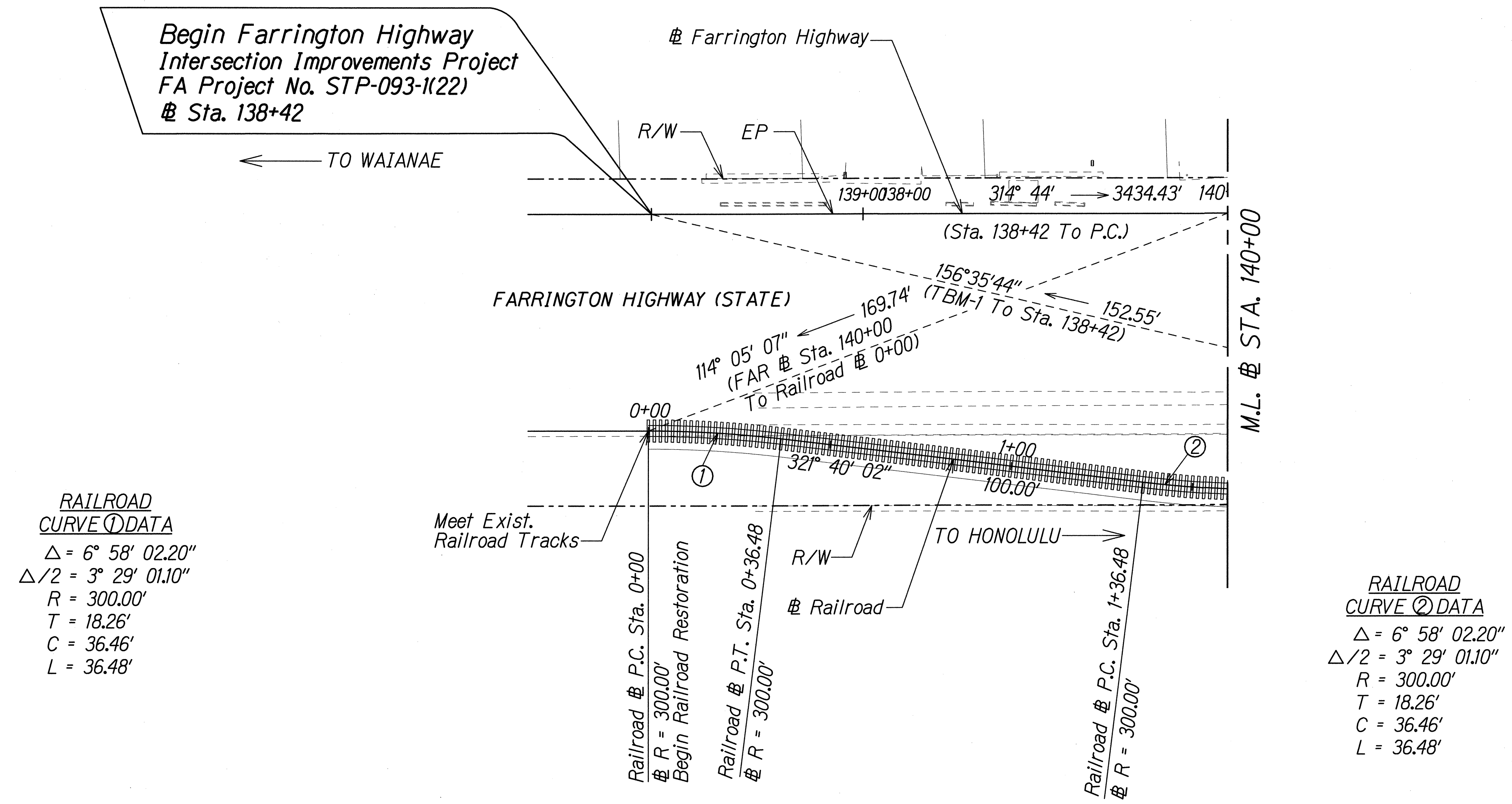

|                   |      |
|-------------------|------|
| SURVEY PLOTTED BY | DATE |
| DRAWN BY          |      |
| TRACED BY         |      |
| NOTE BOOK         |      |
| QUANTITIES BY     |      |
| CHECKED BY        |      |
| No.               |      |

J:\DOT - FARRINGTON HWY INTERSECTIONS\NANAKULI\_HALEAKALA\pp-01.dgn

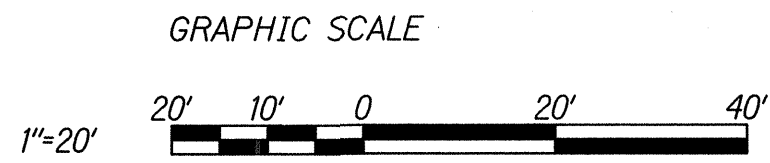

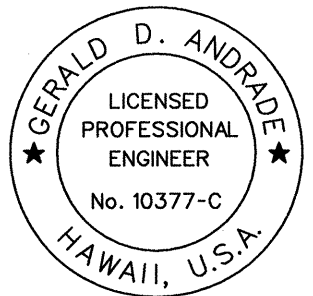

GERALD D. ANDRADE  
LICENSED PROFESSIONAL ENGINEER  
No. 10377-C  
HAWAII, U.S.A.

THIS WORK WAS PREPARED BY ME OR UNDER MY SUPERVISION.

*Gerald D. Andrade*  
SIGNATURE

04/30/14  
EXPIRATION DATE OF THE LICENSE

STATE OF HAWAII  
DEPARTMENT OF TRANSPORTATION  
HIGHWAYS DIVISION

**PLAN**  
**STA. 138+00 TO 140+00**

FARRINGTON HIGHWAY INTERSECTION IMPROVEMENTS  
AT NANAKULI AVENUE AND HALEAKALA AVENUE  
Federal-Aid Project No. STP-093-1(22)

Scale: As Noted      Date: April 2013

SHEET No. PP-1 OF 11 SHEETS



| FED. ROAD DIST. NO. | STATE | FEDERAL AID PROJ. NO. | FISCAL YEAR | SHEET NO. | TOTAL SHEETS |
|---------------------|-------|-----------------------|-------------|-----------|--------------|
| HAWAII              | HAW.  | STP-093-1(22)         | 2013        | C.O 17    | 230          |

**NOTE:**  
Exist. Mauka AC Curb to Remain unless otherwise specified.

TRUE NORTH  
SCALE: 1" = 20'

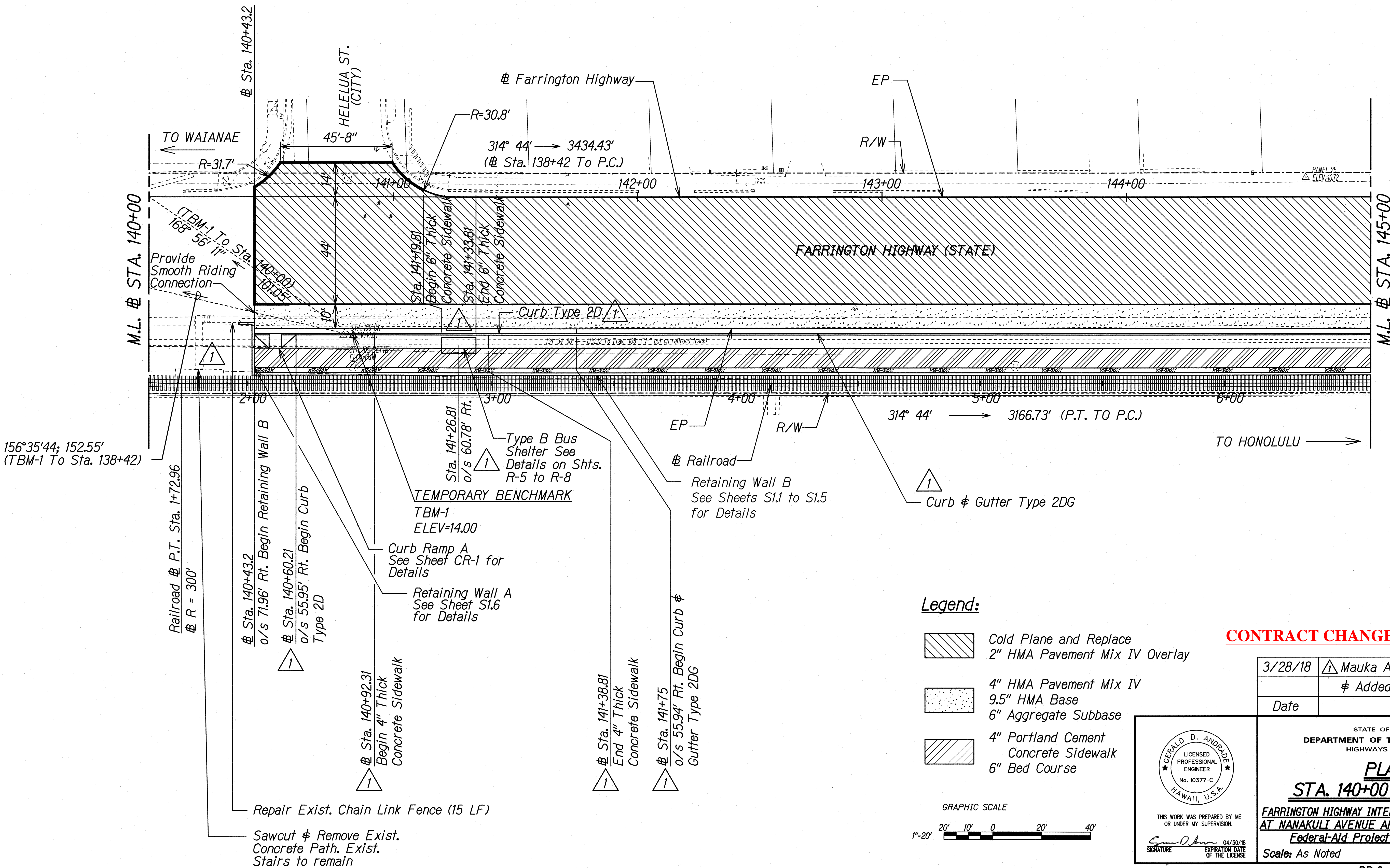

**Legend:**

- Cold Plane and Replace  
2" HMA Pavement Mix IV Overlay
- 4" HMA Pavement Mix IV  
9.5" HMA Base  
6" Aggregate Subbase
- 4" Portland Cement  
Concrete Sidewalk  
6" Bed Course

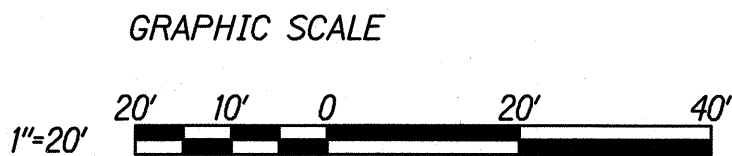

**CONTRACT CHANGE ORDER NO. 23**

| 3/28/18 | MAUKA AC CURB REVISIONS |
|---------|-------------------------|
|         | Added Bus Stop/Shelter  |
| Date    | Revision                |

THIS WORK WAS PREPARED BY ME OR UNDER MY SUPERVISION.

Signature: *Gerald D. Andrade* 04/30/18  
SIGNATURE EXPIRATION DATE OF THE LICENSE

STATE OF HAWAII  
DEPARTMENT OF TRANSPORTATION  
HIGHWAYS DIVISION

**PLAN**  
**STA. 140+00 TO 145+00**

**FARRINGTON HIGHWAY INTERSECTION IMPROVEMENTS  
AT NAKAKULI AVENUE AND HALEAKALA AVENUE**  
Federal Aid Project No. STP-093-1(22)

Scale: As Noted Date: April 2013

SHEET No. PP-2 OF 11 SHEETS

|               |                   |      |
|---------------|-------------------|------|
| ORIGINAL PLAN | SURVEY PLOTTED BY | DATE |
| NOTE BOOK     | DRAWN BY          |      |
|               | DESIGNED BY       |      |
|               | CHECKED BY        |      |

J:\DOT - FARRINGTON HWY INTERSECTIONS\NANAKULI HALEAKALA\pp-02.dgn



| FED. ROAD DIST. NO. | STATE | FEDERAL AID PROJ. NO. | FISCAL YEAR | SHEET NO. | TOTAL SHEETS |
|---------------------|-------|-----------------------|-------------|-----------|--------------|
| HAWAII              | HAW.  | STP-093-1(22)         | 2013        | C.O. 18   | 230          |

**NOTE:**  
Exist. Mauka AC Curb to Remain unless otherwise specified.

TRUE NORTH  
SCALE: 1" = 20'

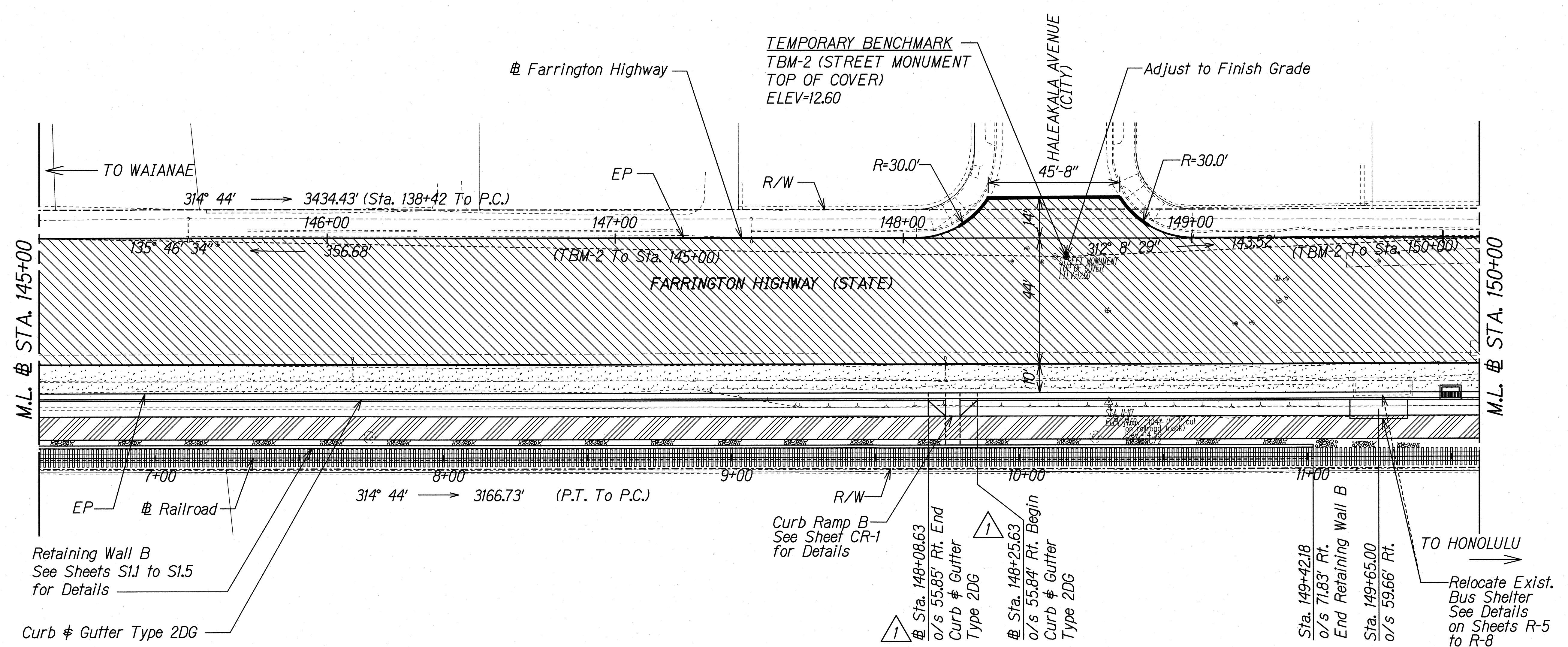

- Legend:**
- Cold Plane and Replace 2" HMA Pavement Mix IV Overlay
  - 4" HMA Pavement Mix IV
  - 9.5" HMA Base
  - 6" Aggregate Subbase
  - 4" Portland Cement Concrete Sidewalk
  - 6" Bed Course

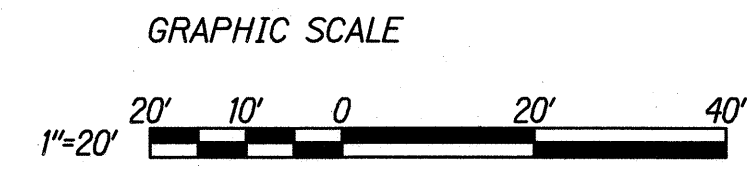

**CONTRACT CHANGE ORDER NO. 33**

|         |                           |
|---------|---------------------------|
| 3/28/18 | 1 Mauka AC Curb Revisions |
| Date    | Revision                  |

THIS WORK WAS PREPARED BY ME OR UNDER MY SUPERVISION.

Signature: *Gerald D. Andrade* Date: 04/30/18

EXPIRATION DATE OF THE LICENSE

STATE OF HAWAII  
DEPARTMENT OF TRANSPORTATION  
HIGHWAYS DIVISION

**PLAN**  
**STA. 145+00 TO 150+00**

**FARRINGTON HIGHWAY INTERSECTION IMPROVEMENTS  
AT NANAKULI AVENUE AND HALEAKALA AVENUE**  
Federal-Aid Project No. STP-093-1(22)

Scale: As Noted Date: April 2013

SHEET No. PP-3 OF 11 SHEETS

**C.O. 18**

|                   |      |
|-------------------|------|
| SURVEY PLOTTED BY | DATE |
| DRAWN BY          |      |
| CHECKED BY        |      |
| NOTE BOOK         |      |
| QUANTITIES BY     |      |
| CHECKED BY        |      |

J4/DO7 - FARRINGTON HWY INTERSECTIONS NANAKULI HALEAKALA/pp-03gn



| FED. ROAD DIST. NO. | STATE | FEDERAL AID PROJ. NO. | FISCAL YEAR | SHEET NO. | TOTAL SHEETS |
|---------------------|-------|-----------------------|-------------|-----------|--------------|
| HAWAII              | HAW.  | STP-093-K(22)         | 2013        | C.O. 19   | 230          |

**NOTE:**  
Exist. Mauka AC Curb to Remain unless otherwise specified.

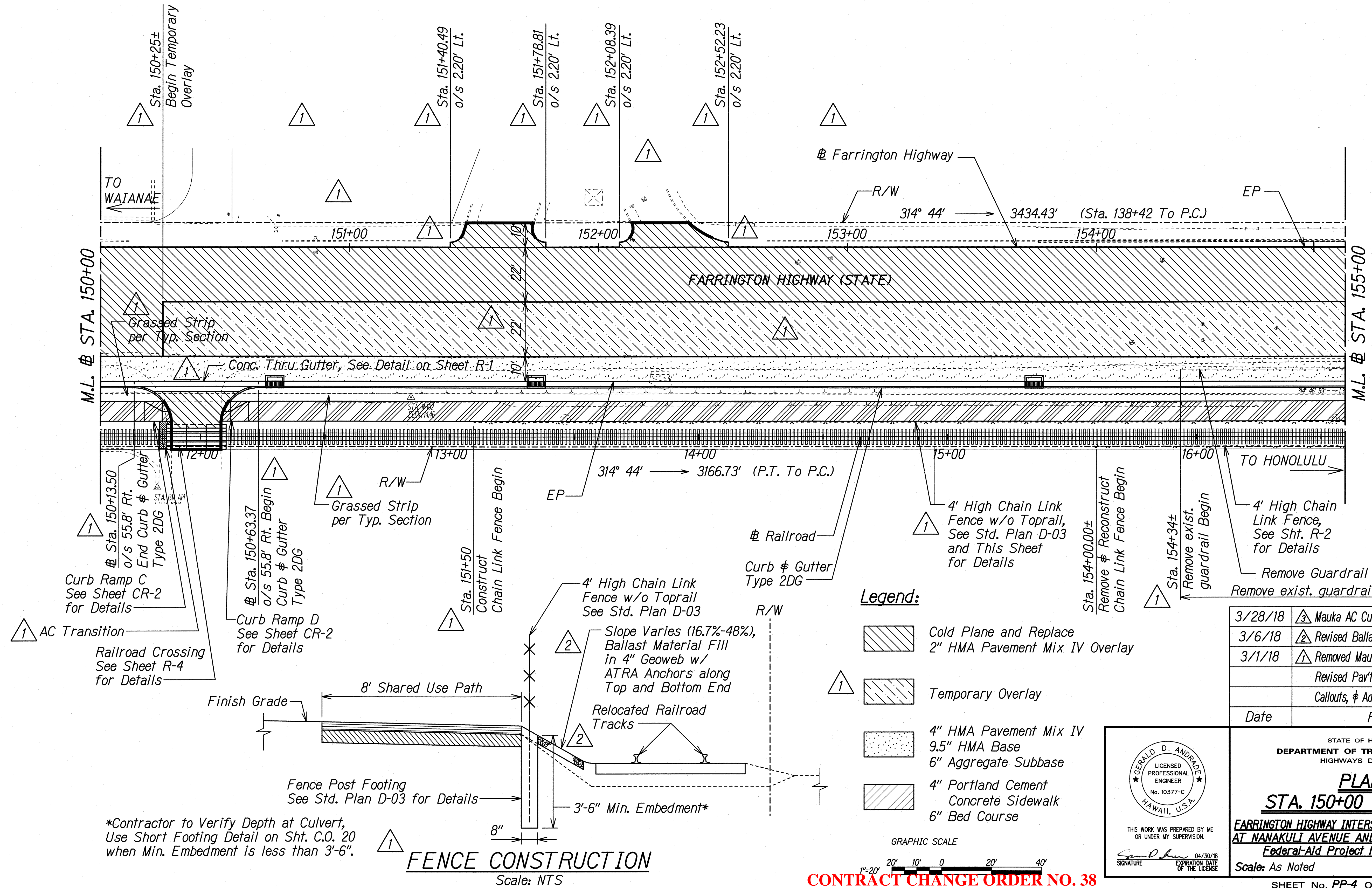
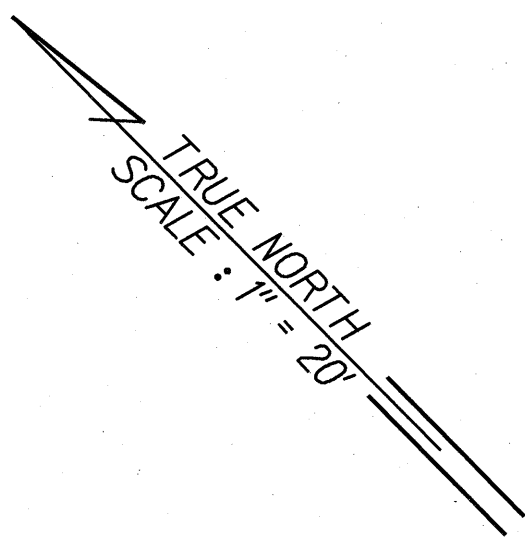

TO WAIANAE  
Sta. 150+25+ Begin Temporary Overlay  
Sta. 150+13.50 o/s 55.8' Rt. End Curb & Gutter Type 2DG  
Curb Ramp C See Sheet CR-2 for Details  
AC Transition  
Railroad Crossing See Sheet R-4 for Details

Sta. 150+63.37 o/s 55.8' Rt. Begin Curb & Gutter Type 2DG  
Curb Ramp D See Sheet CR-2 for Details  
Grassed Strip per Typ. Section  
R/W  
Sta. 151+50 Construct Chain Link Fence Begin

4' High Chain Link Fence w/o Toprail See Std. Plan D-03  
Slope Varies (16.7%-48%), Ballast Material Fill in 4" Geoweb w/ ATRA Anchors along Top and Bottom End  
Relocated Railroad Tracks  
Fence Post Footing See Std. Plan D-03 for Details  
3'-6" Min. Embedment\*  
8" Shared Use Path  
Finish Grade  
4' High Chain Link Fence w/o Toprail, See Std. Plan D-03 and This Sheet for Details  
4' High Chain Link Fence, See Sht. R-2 for Details  
Remove Guardrail  
Remove exist. guardrail

- Legend:**
- Cold Plane and Replace 2" HMA Pavement Mix IV Overlay
  - Temporary Overlay
  - 4" HMA Pavement Mix IV 9.5" HMA Base 6" Aggregate Subbase
  - 4" Portland Cement Concrete Sidewalk 6" Bed Course

\*Contractor to Verify Depth at Culvert, Use Short Footing Detail on Sht. C.O. 20 when Min. Embedment is less than 3'-6".

**FENCE CONSTRUCTION**  
Scale: NTS

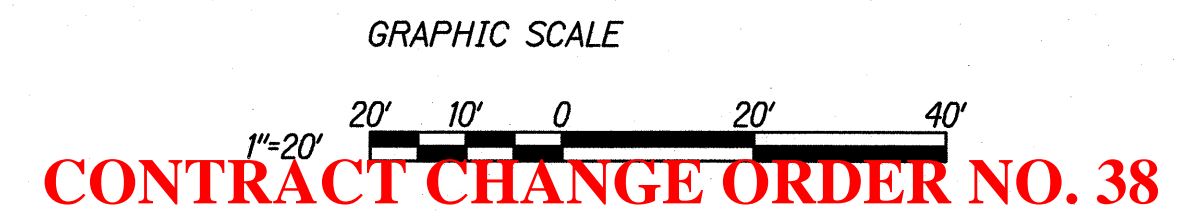

| Date    | Revision   |
|---------|--|
| 3/28/18 | 3 Mauka AC Curb Revisions  |
| 3/6/18  | 2 Revised Ballast Section Detail   |
| 3/1/18  | 1 Removed Mauka Drainage/Curb&Gutter, Revised Pav't Limits, Revised Stationing |
|         | Callouts, & Added Fence Construction   |

THIS WORK WAS PREPARED BY ME OR UNDER MY SUPERVISION.  
SIGNATURE: *Gerald D. Andrade* EXPIRATION DATE: 04/30/18 OF THE LICENSE

STATE OF HAWAII  
DEPARTMENT OF TRANSPORTATION  
HIGHWAYS DIVISION

**PLAN**  
**STA. 150+00 TO 155+00**  
**FARRINGTON HIGHWAY INTERSECTION IMPROVEMENTS AT NAKAKULI AVENUE AND HALEAKALA AVENUE**  
**Federal Aid Project No. STP-093-K(22)**

Scale: As Noted Date: April 2013

SHEET No. PP-4 OF 11 SHEETS

|                   |      |
|-------------------|------|
| SURVEY PLOTTED BY | DATE |
| DRAWN BY          |      |
| DESIGNED BY       |      |
| QUANTITIES BY     |      |
| CHECKED BY        |      |

J:\DOT - FARRINGTON HWY INTERSECTIONS\NANAKULI HALEAKALA\pp-04.dgn







| FED. ROAD DIST. NO. | STATE | FEDERAL AID PROJ. NO. | FISCAL YEAR | SHEET NO. | TOTAL SHEETS |
|---------------------|-------|-----------------------|-------------|-----------|--------------|
| HAWAII              | HAW.  | STP-093-1(22)         | 2013        | C.O.20S-1 | 230          |

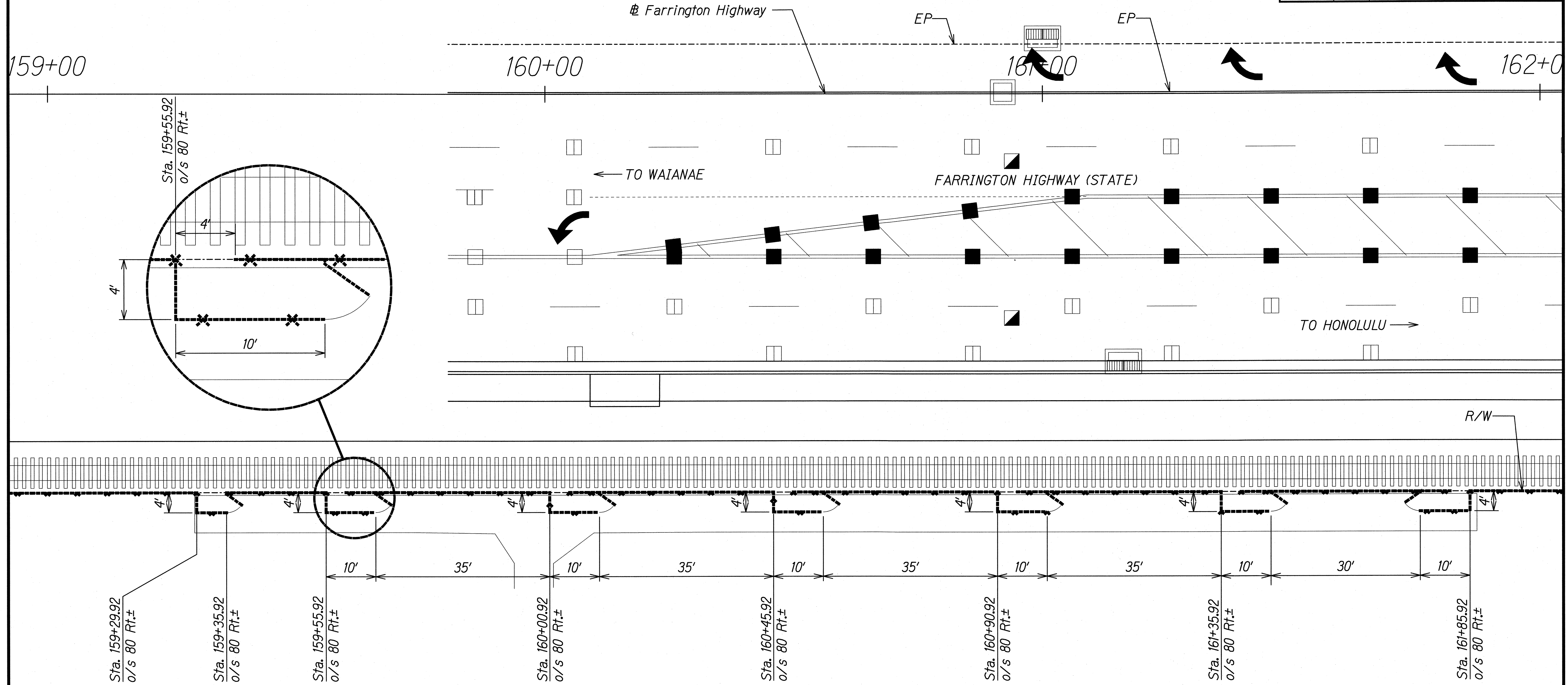

KA WAIHONA O KA NA'AUAO PUBLIC CHARTER SCHOOL  
~~NANAIKAPONO ELEMENTARY AND INTERMEDIATE SCHOOL~~  
TMK: 8-9-01:4

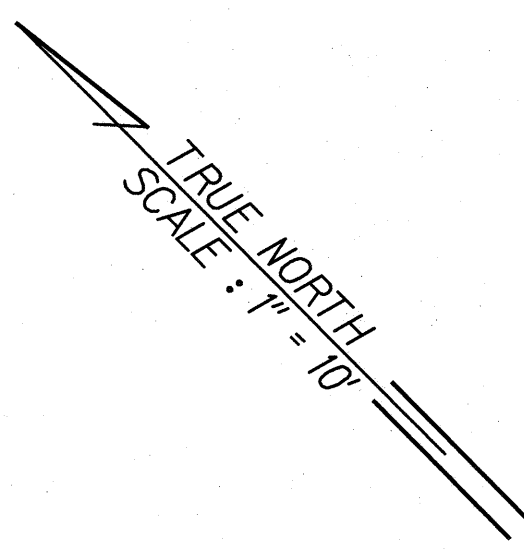

Note:  
1. See Standard Plan D-02 for Chain Link Fence and Fence Post Details.

|                   |      |
|-------------------|------|
| SURVEY PLOTTED BY | DATE |
| DRAWN BY          |      |
| DESIGNED BY       |      |
| QUANTITIES BY     |      |
| CHECKED BY        |      |

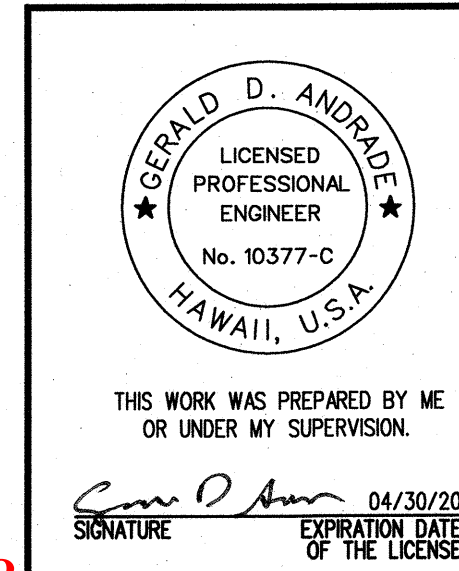

|  |             |
|--|-------------|
| 12/12/18   | Added Sheet |
| Date   | Revision    |
| STATE OF HAWAII<br>DEPARTMENT OF TRANSPORTATION<br>HIGHWAYS DIVISION<br><b>FENCE LAYOUT</b><br><b>STA. 159+00 TO 162+00</b><br>FARRINGTON HIGHWAY INTERSECTION IMPROVEMENTS<br>AT NANAKULI AVENUE AND HALEAKALA AVENUE<br>Federal-Aid Project No. STP-093-1(22)<br>Scale: As Noted<br>Date: April 2013 |             |

CONTRACT CHANGE ORDER NO. 38

"AS-BUILT"

SHEET No. PP-5A OF 11 SHEETS

C.O.20S-1



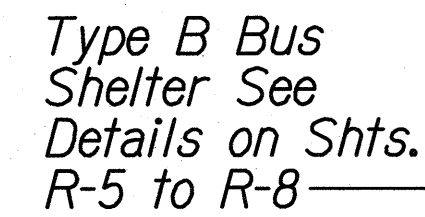

Demolish & Dispose  
Exist. Conc. Curb & Gutter  
Sawcut Exist. Conc. Sidewalk  
6" within Property Line

Curb & Gutter  
Type 2DG—

Sta. 162+32.93  
Remove & Reconstruct  
Chain Link Fence End  
See Details on  
Sheet R-2

Sta. 162+41.42  
o/s 55.64' Rt.  
End Curb & Gutter  
Type 2DG

Sta. 162+59.31  
Demolish & Dispose  
exist. AC curb  
and pavement  
End

*Railroad Crossing  
See Sheet R-4  
for Details*

- Curb Ramp G  
See Sheet CR-3  
for Details

Sta. 163+08.09  
o/s 55.63' Rt.  
Begin Curb & Gut  
Type 2NG

-Curb Ramp H  
See Sheet CR-3  
for Details

—Meet Exist. Curb

Legend:

 Cold Plane and Replace  
2" HMA Pavement Mix IV Overlay

  *Temporary Overlay*

4" HMA Pavement Mix IV  
9.5" HMA Base  
6" Aggregate Subbase (up to Sta. 113+59.38)  
18" Aggregate Subbase (Starting @ Sta. 163+59.38)

4" Portland Cement  
Concrete Sidewalk  
6" Bed Course

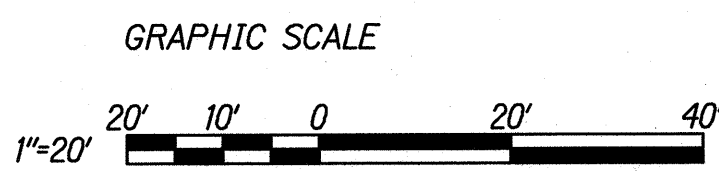

## CONTRACT CHANGE ORDER NO. 38

|         |   |
|---------|---|
| 3/28/18 | 2 Mauka AC Curb Revisions   |
| 3/1/18  | 1 Removed Mauka Drainage/Curb & Gutter,<br>Revised Pav't Limits, Revised Stationing<br>Callouts, & Added Fence Construction |
| Date    | Revision  |

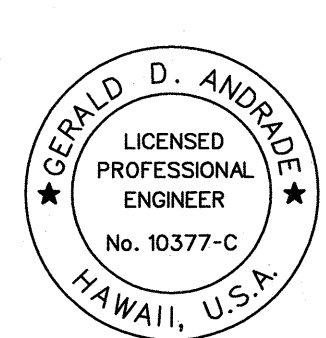

THIS WORK WAS PREPARED BY ME  
OR UNDER MY SUPERVISION.

*[Signature]* 04/30/18  
SIGNATURE EXPIRATION DATE  
OF THE LICENSE

STATE OF HAWAII  
DEPARTMENT OF TRANSPORTATION  
HIGHWAYS DIVISION

PLAN  
STA. 160+00 TO 164+00

FARRINGTON HIGHWAY INTERSECTION IMPROVEMENTS  
AT NAKANULI AVENUE AND HALEAKALA AVENUE  
Federal-Aid Project No. STP-093-(K22)

Scale: As Noted                      Date: April 2013

|                       |                         |            |
|-----------------------|-------------------------|------------|
| ORIGINAL<br>PLAN      | SURVEY PLOTTED BY _____ | DATE _____ |
|                       | DRAWN BY _____          | •          |
|                       | TRACED BY _____         | •          |
| NOTE BOOK             | DESIGNED BY _____       | •          |
|                       | QUANTITIES BY _____     | •          |
| N <sub>o.</sub> _____ | CHECKED BY _____        | •          |

J:/DOT - FARRINGTON HWY INTERSECTIONS NANAKULI HALEAKALA/pp\_06.dgn



| FED. ROAD DIST. NO. | STATE | FEDERAL AID PROJ. NO. | FISCAL YEAR | SHEET NO. | TOTAL SHEETS |
|---------------------|-------|-----------------------|-------------|-----------|--------------|
| HAWAII              | HAW.  | STP-093-1(22)         | 2013        | C.O. 22   | 230          |

**NOTE:**  
Exist. Mauka AC Curb to Remain unless otherwise specified.

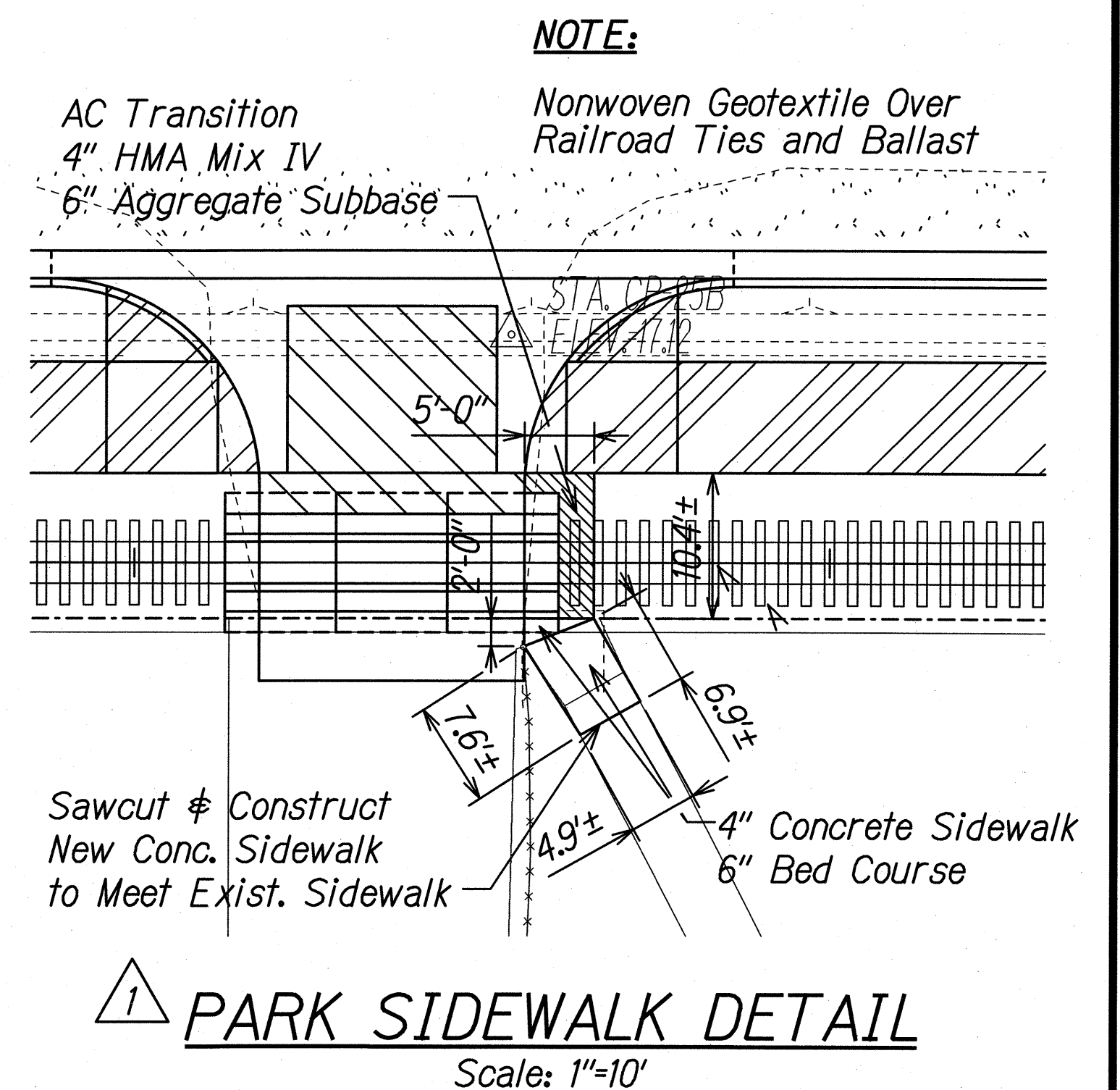
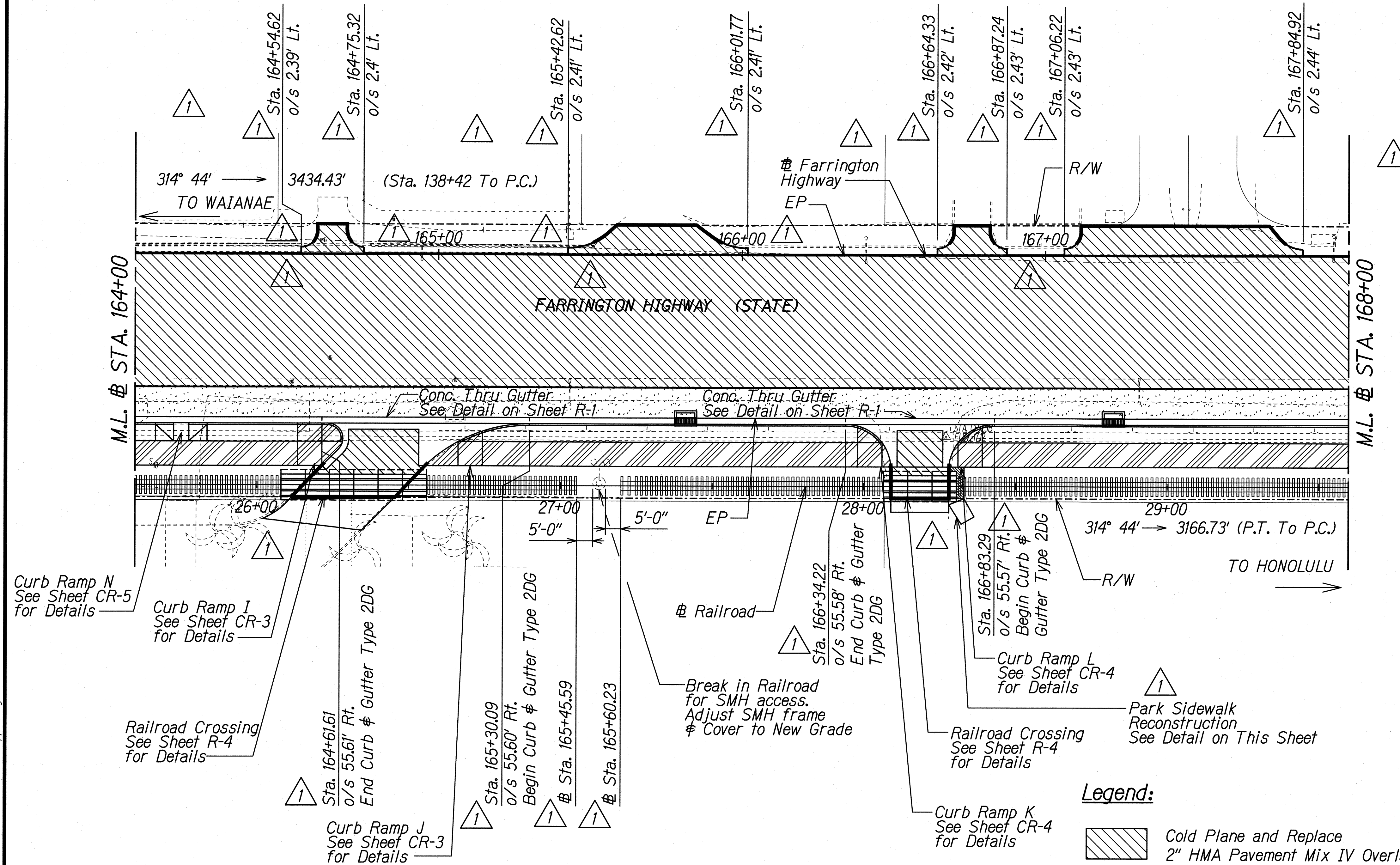
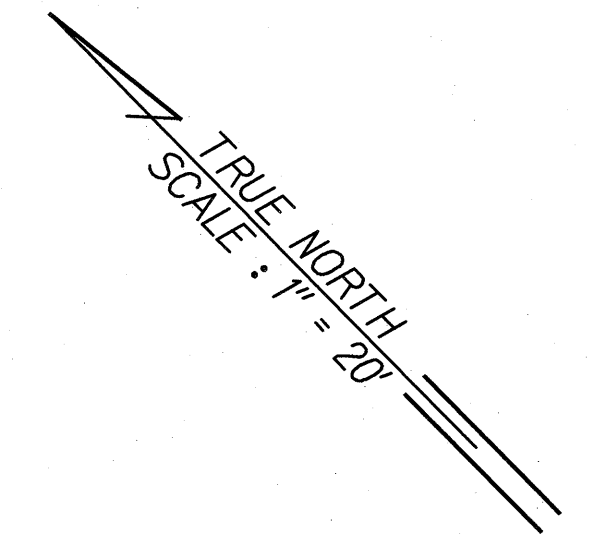

- Legend:**
- Cold Plane and Replace 2" HMA Pavement Mix IV Overlay
  - 4" HMA Pavement Mix IV 9.5" HMA Base 18" Aggregate Subbase
  - 4" Portland Cement Concrete Sidewalk 6" Bed Course

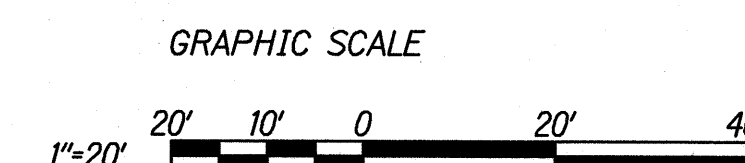

**CONTRACT CHANGE ORDER NO. 33**

| 3/28/18 | Removed Mauka Drainage/Curb&Gutter, Revised Pav't Limits, Revised Stationing |
|---------|--|
|         | Callouts, Added Park Sidewalk Detail   |
| Date    | Revision   |

THIS WORK WAS PREPARED BY ME OR UNDER MY SUPERVISION.

Signature: *Gerald D. Andrade* Date: 04/30/18

STATE OF HAWAII  
DEPARTMENT OF TRANSPORTATION  
HIGHWAYS DIVISION

**PLAN**  
**STA. 164+00 TO 168+00**

**FARRINGTON HIGHWAY INTERSECTION IMPROVEMENTS AT NAKAKULI AVENUE AND HALEAKALA AVENUE**  
Federal-Aid Project No. STP-093-1(22)

Scale: As Noted Date: April 2013

SHEET No. PP-7 OF 11 SHEETS



| FED. ROAD DIST. NO. | STATE | FEDERAL AID PROJ. NO. | FISCAL YEAR | SHEET NO. | TOTAL SHEETS |
|---------------------|-------|-----------------------|-------------|-----------|--------------|
| HAWAII              | HAW.  | STP-093-1(22)         | 2013        | C.O. 23   | 230          |

**NOTE:**  
Exist. Mauka AC Curb to Remain unless otherwise specified.

Sta. 168+85± to 169+10±  
Reconstruct IB Left Thru Lane (11' x 25')  
4" HMA Mix IV  
9.5" HMA Base  
Recompact Exist. Subbase

TRUE NORTH  
SCALE: 1" = 20'

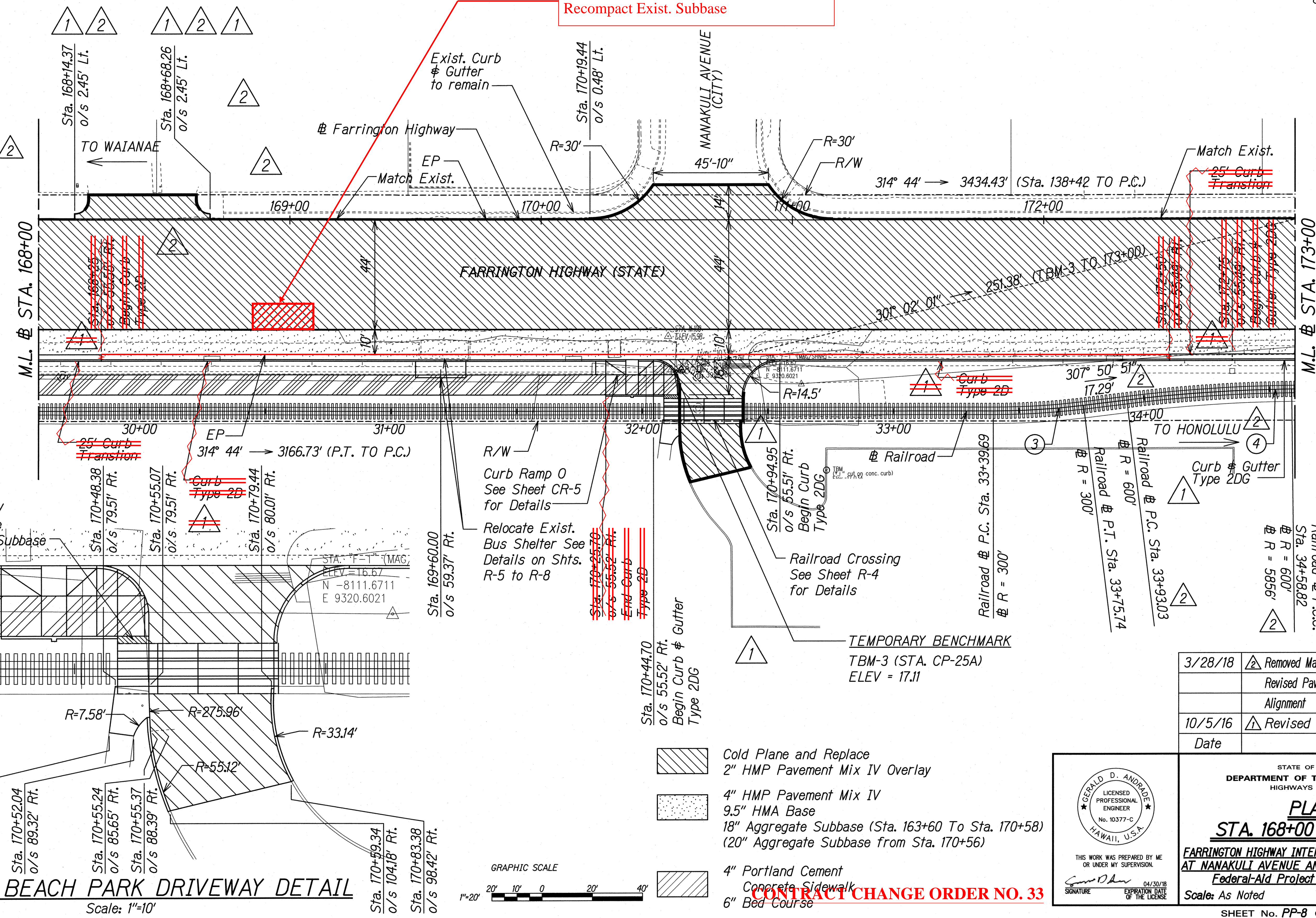

| RAILROAD CURVE ③ DATA            |  |
|----------------------------------|--|
| $\Delta = 6^\circ 53' 8.51''$    |  |
| $\Delta/2 = 3^\circ 26' 34.25''$ |  |
| $R = 300.00'$                    |  |
| $T = 18.05'$                     |  |
| $C = 36.03'$                     |  |
| $L = 36.05'$                     |  |

| RAILROAD CURVE ④ DATA            |  |
|----------------------------------|--|
| $\Delta = 6^\circ 16' 54.79''$   |  |
| $\Delta/2 = 3^\circ 08' 27.40''$ |  |
| $R = 600.00'$                    |  |
| $T = 32.92'$                     |  |
| $C = 65.75'$                     |  |
| $L = 65.78'$                     |  |

|               |      |
|---------------|------|
| ORIGINAL PLAN | DATE |
| DRAWN BY      |      |
| TRACED BY     |      |
| DESIGNED BY   |      |
| QUANTITIES BY |      |
| CHECKED BY    |      |

**NANAKULI BEACH PARK DRIVEWAY DETAIL**  
Scale: 1"=10'

- Cold Plane and Replace  
2" HMP Pavement Mix IV Overlay
- 4" HMP Pavement Mix IV  
9.5" HMA Base  
18" Aggregate Subbase (Sta. 163+60 To Sta. 170+58)  
20" Aggregate Subbase from Sta. 170+56
- 4" Portland Cement  
Concrete Sidewalk  
6" Bed Course

| Date    | Revision   |
|---------|--|
| 3/28/18 | ② Removed Mauka Drainage/Curb & Gutter, Revised Pav't Limits, Revised Railroad Alignment |
| 10/5/16 | ① Revised Curb & Driveway  |

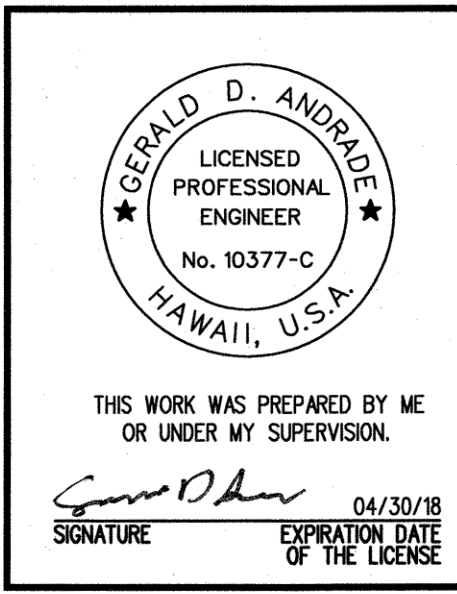

STATE OF HAWAII  
DEPARTMENT OF TRANSPORTATION  
HIGHWAYS DIVISION

**PLAN**  
**STA. 168+00 TO 173+00**

FARRINGTON HIGHWAY INTERSECTION IMPROVEMENTS  
AT NANAKULI AVENUE AND HALEAKALA AVENUE  
Federal-Aid Project No. STP-093-1(22)

Scale: As Noted Date: April 2013

SHEET No. PP-8 OF 11 SHEETS

**"AS-BUILT"**

**C.O. 23**



| FED. ROAD DIST. NO. | STATE | FEDERAL AID PROJ. NO. | FISCAL YEAR | SHEET NO. | TOTAL SHEETS |
|---------------------|-------|-----------------------|-------------|-----------|--------------|
| HAWAII              | HAW.  | STP-093-1(22)         | 2013        | C.O. 24   | 230          |

TRUE NORTH  
SCALE: 1" = 20'

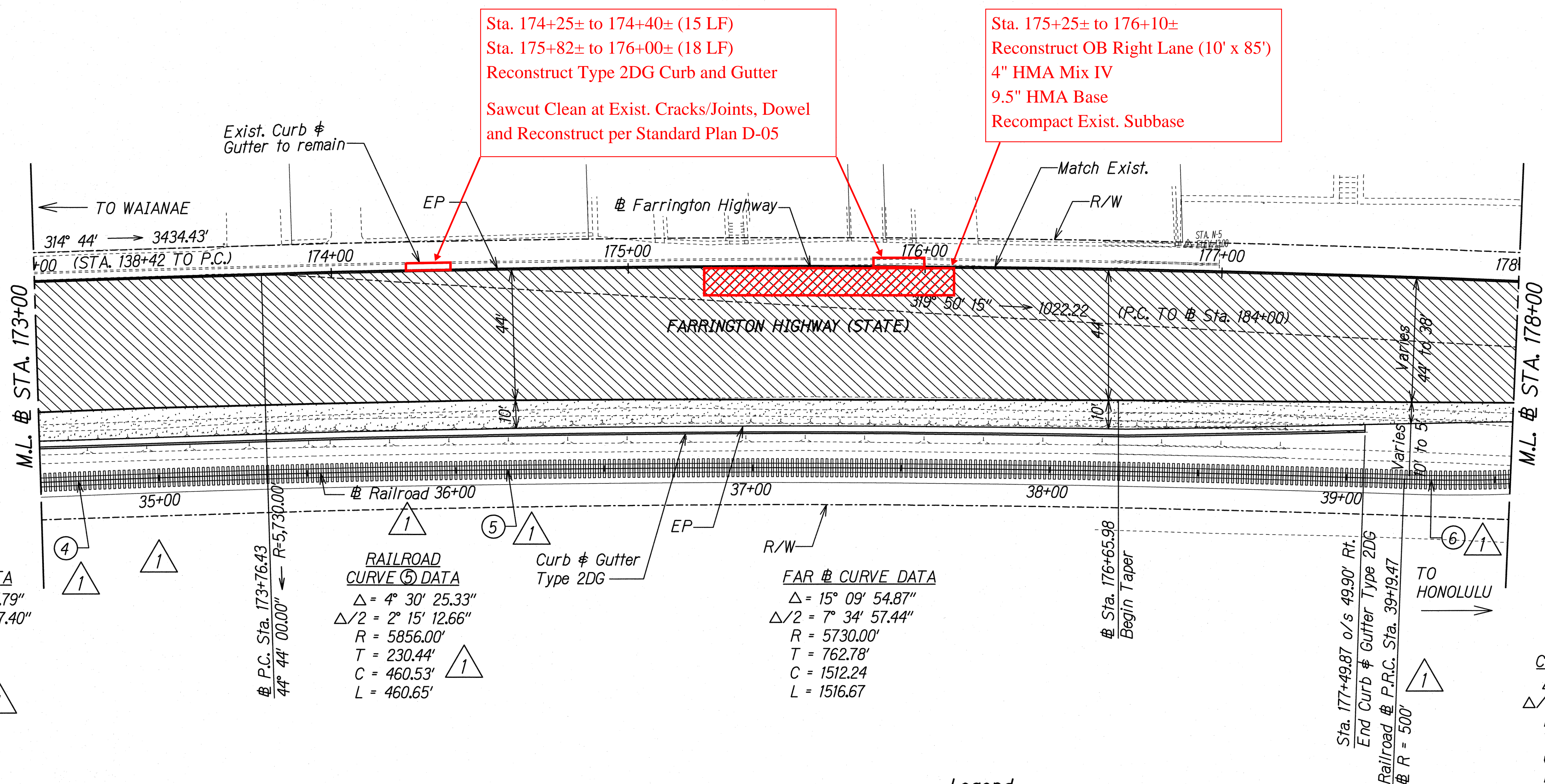

**RAILROAD CURVE ④ DATA**  
 $\Delta = 6^\circ 16' 54.79''$   
 $\Delta/2 = 3^\circ 08' 27.40''$   
 $R = 600.00'$   
 $T = 32.92'$   
 $C = 65.75'$   
 $L = 65.78'$

**RAILROAD CURVE ⑤ DATA**  
 $\Delta = 4^\circ 30' 25.33''$   
 $\Delta/2 = 2^\circ 15' 12.66''$   
 $R = 5856.00'$   
 $T = 230.44'$   
 $C = 460.53'$   
 $L = 460.65'$

**FAR @ CURVE DATA**  
 $\Delta = 15^\circ 09' 54.87''$   
 $\Delta/2 = 7^\circ 34' 57.44''$   
 $R = 5730.00'$   
 $T = 762.78'$   
 $C = 1512.24'$   
 $L = 1516.67'$

**RAILROAD CURVE ⑥ DATA**  
 $\Delta = 4^\circ 42' 23.44''$   
 $\Delta/2 = 2^\circ 21' 11.72''$   
 $R = 500.00'$   
 $T = 20.55'$   
 $C = 41.06'$   
 $L = 41.07'$

**Legend:**

- Cold Plane and Replace  
2" HMA Pavement Mix IV Overlay
- 4" HMA Pavement Mix IV  
9.5" HMA Base  
20" Aggregate Subbase

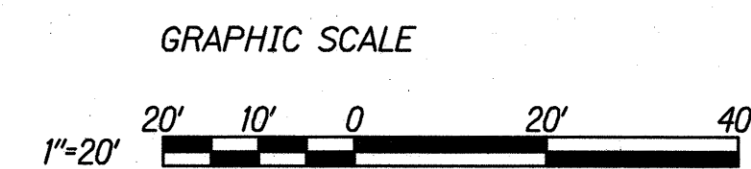

**CONTRACT CHANGE ORDER NO. 33**

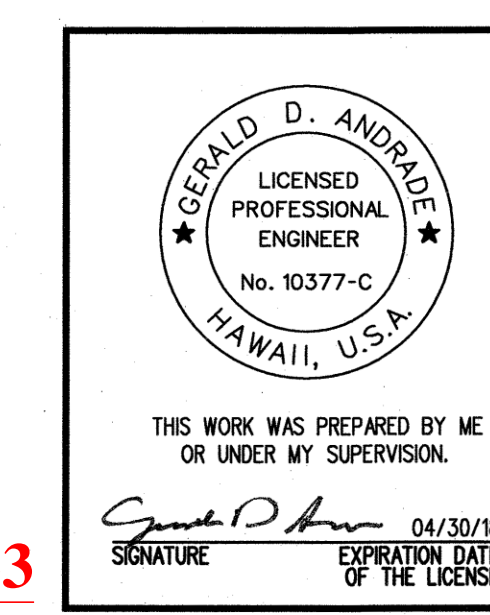

|  |                              |
|--|------------------------------|
| 3/28/18  | △ Revised Railroad Alignment |
| Date   | Revision                     |
| STATE OF HAWAII<br>DEPARTMENT OF TRANSPORTATION<br>HIGHWAYS DIVISION<br><br><b>PLAN</b><br><b>STA. 173+00 TO 178+00</b><br><b>FARRINGTON HIGHWAY INTERSECTION IMPROVEMENTS</b><br><b>AT NANAKULI AVENUE AND HALEAKALA AVENUE</b><br><b>Federal-Aid Project No. STP-093-1(22)</b> |                              |
| Scale: As Noted  | Date: April 2013             |
| SHEET No. PP-9 OF 11 SHEETS  |                              |

**"AS-BUILT"**

**C.O. 24**

ORIGINAL PLAN  
DATE  
SURVEY PLATTED BY  
DRAWN BY  
TRACED BY  
DESIGNED BY  
QUANTITIES BY  
CHECKED BY



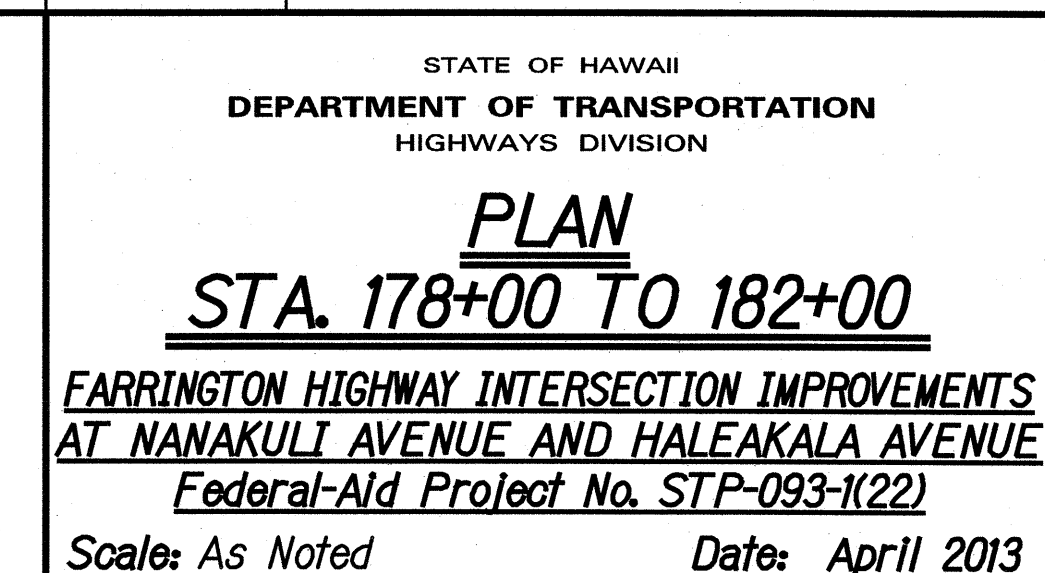

**C.O. 25**



| FED. ROAD DIST. NO. | STATE | FEDERAL AID PROJ. NO. | FISCAL YEAR | SHEET NO. | TOTAL SHEETS |
|---------------------|-------|-----------------------|-------------|-----------|--------------|
| HAWAII              | HAW.  | STP-093-1(22)         | 2013        | C.O. 26   | 230          |

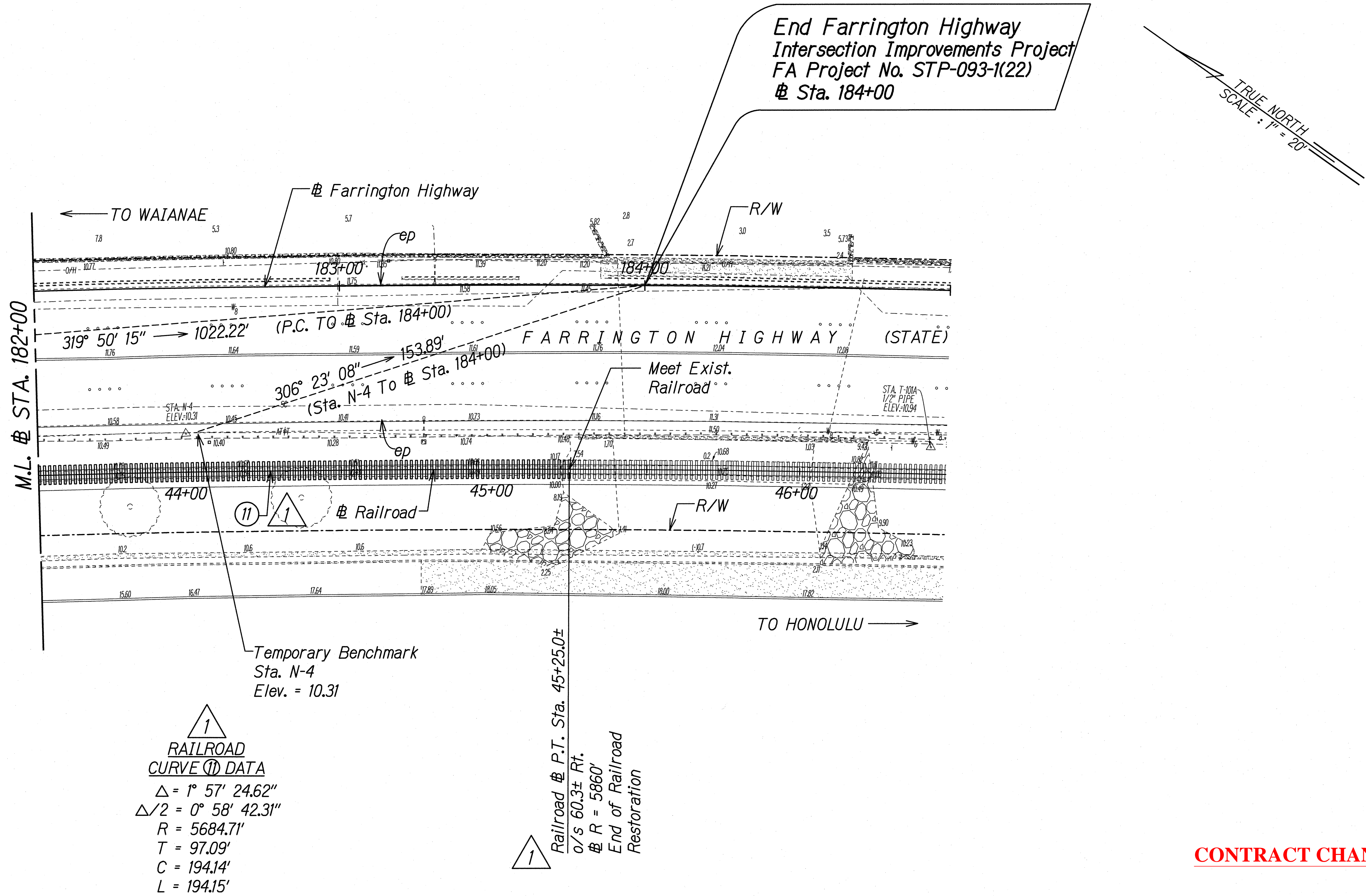

CONTRACT CHANGE ORDER NO. 33

|         |                              |
|---------|------------------------------|
| 3/28/18 | △ Revised Railroad Alignment |
| Date    | Revision                     |

GERALD D. ANDRADE  
LICENSED PROFESSIONAL ENGINEER  
No. 10377-C  
HAWAII, U.S.A.

THIS WORK WAS PREPARED BY ME OR UNDER MY SUPERVISION.  
SIGNATURE: *Gerald D. Andrade* 04/30/18  
EXPIRATION DATE OF THE LICENSE

STATE OF HAWAII  
DEPARTMENT OF TRANSPORTATION  
HIGHWAYS DIVISION

**PLAN**  
**STA. 182+00 TO STA. 185+00**  
**FARRINGTON HIGHWAY INTERSECTION IMPROVEMENTS**  
**AT NANAKULI AVENUE AND HALEAKALA AVENUE**  
**Federal-Aid Project No. STP-093-1(22)**

Scale: 1"=20' Date: April 2013

SHEET No. PP-11 OF 11 SHEETS

|               |                   |      |
|---------------|-------------------|------|
| ORIGINAL PLAN | SURVEY PLOTTED BY | DATE |
| NOTE BOOK     | DRAWN BY          |      |
| No.           | DESIGNED BY       |      |
|               | QUANTITIES BY     |      |
|               | CHECKED BY        |      |

J:\DOT - FARRINGTON HWY INTERSECTIONS\NANAKULI HALEAKALA\pp-11.dgn