

WATER POLLUTION AND EROSION CONTROL NOTES

FED. ROAD DIST. NO.	STATE	FEDERAL AID PROJ. NO.	FISCAL YEAR	SHEET NO.	TOTAL SHEETS
HAWAII	HAW.	STP-093-K(22)	2013	74	230

A. GENERAL:

- See Section 209 - Temporary Water Pollution, Dust, and Erosion Control. Section 209 describes but is not limited to: submittal requirements; scheduling of a water pollution and erosion control conference with the Engineer; construction requirements; method of measurement; and basis of payment.
- Effective October 1, 2008, follow the guidelines in the "Construction Best Management Practices Field Manual", dated January 2008 in developing, installing and maintaining the Best Management Practices (BMP) for the project.
- Follow the guidelines in the Honolulu's City & County "Rules Relating to Soil Erosion Standards and Guidelines" along with applicable Soil Erosion Guidelines for projects on Maui, Molokai, Kauai, and Hawaii.
- The Engineer may assess liquidated damages of up to \$27,500 for non-compliance of each BMP requirement and each requirement stated in Section 209, for every day of non-compliance. There is no maximum limit on the amount assessed per day.
- The Engineer will deduct the cost from the progress payment for all citations received by the Department for non-compliance, or the Contractor shall reimburse the State for the full amount of the outstanding cost incurred by the State.
- For projects that require an NPDES Permit from the Department of Health, install a rain gage prior to any field work including the installation of any site-specific best management practices. The rain gage shall have a tolerance of at least 0.05 inches of rainfall, and have an opening of at least one-inch in diameter. Install the rain gage on the project site in an area that will not deter rainfall from entering the gage opening. The rain gage installation shall be stable and plumbed. Do not begin field work until the rain gage is installed and site-specific best management practices are in-place.

B. WASTE DISPOSAL:

- Waste Materials
Collect and store all waste materials in a securely lidded metal dumpster. The dumpster shall meet all local and State solid waste management regulations. Deposit all trash and construction debris from the site in the dumpster. Empty the dumpster a minimum of twice per week or as often as is deemed necessary. Do not bury construction waste materials onsite. The Contractor's supervisory personnel shall be instructed regarding the correct procedure for waste disposal. Post notices stating these practices in the office trailer and the Contractor shall be responsible for seeing that these procedures are followed.
- Hazardous Waste
Dispose all hazardous waste materials in the manner specified by local or State regulations and by the manufacturer. The Contractor's site personnel shall be instructed in these practices and shall be responsible for seeing that these practices are followed.
- Sanitary Waste
Collect all sanitary waste from the portable units a minimum of once per week, or as required.

C. EROSION AND SEDIMENT CONTROL INSPECTION AND MAINTENANCE PRACTICES:

- Inspect all control measures at least once each week and within 24 hours of any rainfall event of 0.5 inches or greater within a 24 hour period.
- Maintain all measures in good working order. If repair is necessary, it shall be initiated within 24 hours after the inspection.
- Remove built-up sediment from silt fence when it has reached one-third the height of the fence.
- Inspect silt screen or fence for depth of sediment, tears, to verify that the fabric is securely attached to the fence posts or concrete slab, and to verify that the fence posts are firmly in the ground. Inspect and verify the bottom of the silt screen is buried a minimum of 6 inches below the existing ground.

- Inspect temporary and permanent seeding and planting for bare spots, washouts, and healthy growth.
- Make a maintenance inspection report promptly after each inspection. Submit a copy to the Engineer no later than one week from the date of the inspection.
- Provide a stabilized construction entrance to reduce vehicle tracking of sediments. Include stabilized construction entrance in the Water Pollution, Dust, and Erosion Control submittals. Minimum length should be 50 feet. Minimum width should be 30 feet. Minimum depth should be 12 inches or as recommended by the soils engineer and underlain with geo-textile fabric. Clean the paved street adjacent to the site entrance daily or as required to remove any excess mud, cold planed materials, dirt, or rock tracked from the site. Cover dump trucks hauling material from the construction site with a tarpaulin.
- Include designated Concrete Washout Area(s) in the Water Pollution, Dust, and Erosion Control submittals.
- Submit the name of a specific individual designated responsible for inspections, maintenance and repair activities and filling out the inspection and maintenance report.
- Personnel selected for the inspection and maintenance responsibilities shall receive training from the Contractor. They shall be trained in all the inspection and maintenance practices necessary for keeping the erosion and sediment controls used onsite in good working order.
- Contain, remove, and dispose slurry generated from saw cutting of pavement in accordance with approved BMP practices. Payment for confinement, removal, and disposal of slurry shall be considered incidental to the various contract items.

D. GOOD HOUSEKEEPING BEST MANAGEMENT PRACTICES:

- Materials Pollution Prevention Plan
 - Applicable materials or substances listed below are expected to be present onsite during construction. Other materials and substances not listed below shall be added to the inventory.

Concrete	Fertilizers
Detergents	Petroleum Based Products
Paints (enamel and latex)	Cleaning Solvents
Metal Studs	Wood
Tar	Masonry Block
 - Use Material Management Practices to reduce the risk of spills or other accidental exposure of materials and substances to storm water runoff. Make an effort to store only enough product as is required to do the job.
 - Store all materials stored onsite in a neat, orderly manner in their appropriate containers and if possible under a roof or other enclosure.
 - Keep products in their original containers with the original manufacturer's label.
 - Do not mix substances with one another unless recommended by the manufacturer.
 - Whenever possible, use a product up completely before disposing of the container.
 - Follow manufacturer's recommendations for proper use and disposal.
 - Conduct a daily inspection to ensure proper use and disposal of materials onsite.

- Hazardous Material Pollution Prevention Plan
 - Keep products in original containers unless they are not resealable.
 - Retain original labels and material safety data sheets (MSDS).
 - Dispose of surplus products according to manufacturer's instructions and local and State regulations.

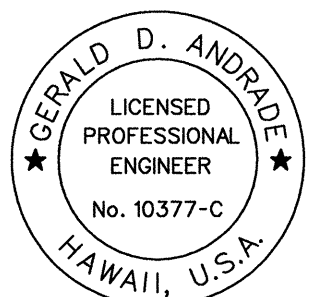
 <p>THIS WORK WAS PREPARED BY ME OR UNDER MY SUPERVISION. <i>Gerald D. Androet</i> SIGNATURE 04/30/14 EXPIRATION DATE OF THE LICENSE</p>	<p>STATE OF HAWAII DEPARTMENT OF TRANSPORTATION HIGHWAYS DIVISION</p> <p>WATER POLLUTION AND EROSION CONTROL NOTES - 1</p> <p>FARRINGTON HIGHWAY INTERSECTION IMPROVEMENTS AT NANAKULI AVENUE AND HALEAKALA AVENUE Federal-Aid Project No. STP-093-K(22)</p> <p>Scale: None Date: April 2013</p>
--	--

SURVEY PLOTTED BY _____	DATE _____
DRAWN BY _____	_____
TRACED BY _____	_____
NOTES BOOK _____	_____
QUANTITIES BY _____	_____
CHECKED BY _____	_____

ORIGINAL PLAN _____	_____
NOTES BOOK _____	_____
_____	_____

J:\DOT-FARRINGTON HWY INTERSECTIONS\NANAKULI HALEAKALA\CADD\Sheets\Misc\Pollution Control Notes 01 09-03-08.dgn

WATER POLLUTION AND EROSION CONTROL NOTES (CONT.)

FED. ROAD DIST. NO.	STATE	FEDERAL AID PROJ. NO.	FISCAL YEAR	SHEET NO.	TOTAL SHEETS
HAWAII	HAW.	STP-093-K(22)	2013	75	230

D. GOOD HOUSEKEEPING BEST MANAGEMENT PRACTICES: -Cont.

3. Onsite and Offsite Product Specific Plan

The following product specific practices shall be followed onsite:

- a. **Petroleum Based Products:**
Monitor all onsite vehicles for leaks and perform regular preventive maintenance to reduce the chance of leakage. Store petroleum products in tightly sealed containers which are clearly labeled. Apply asphalt substances used onsite according to the manufacturer's recommendation.
- b. **Fertilizers:**
Apply fertilizers used only in the minimum amounts recommended by the manufacturer. Once applied, work fertilizer into the soil to limit exposure to storm water. Storage shall be in a covered shed. Transfer the contents of any partially used bags of fertilizer to a sealable plastic bin to avoid spills.
- c. **Paints:**
Seal and store all containers when not required for use. Do not discharge excess paint to the highway drainage system. Dispose properly according to manufacturer's instructions or State and local regulations.
- d. **Concrete Trucks:**
Wash out or discharge concrete truck drum wash water only at a designated site. Do not discharge water in the highway drainage system or waters of the United States. Contact Drinking Water Branch, Department of Health at 586-4258 to receive permission to designate a disposal site. Clean disposal site as required or as requested by the Owner's representative.

4. Spill Control Plan

- a. Post a spill prevention plan to include measures to prevent and clean up each spill.
- b. The Contractor shall be the spill prevention and cleanup coordinator. Designate at least three site personnel who shall receive spill prevention and cleanup training. These individuals shall each become responsible for a particular phase of prevention and cleanup. Post the names of responsible spill personnel in the material storage area and in the office trailer onsite.
- c. Clearly post manufacturers' recommended methods for spill cleanup. Make site personnel aware of the procedures and the location of the information and cleanup supplies.
- d. Keep materials and equipment necessary for spill cleanup in the material storage area onsite.
- e. Clean up all spills immediately after discovery.
- f. Keep the spill area well ventilated. Personnel shall wear appropriate protective clothing to prevent injury from contact with a hazardous substance.
- g. Report spills of toxic hazardous material to the appropriate State or local government agency, regardless of the size.

E. PERMIT REQUIREMENTS:

1. If an NPDES Permit for Construction Dewatering is required, the Contractor shall be responsible to obtain the Permit from the Department of Health, Clean Water Branch.
2. Comply with all applicable State and Federal Permit conditions. Permits may include but are not limited to the following:
- a. NPDES Permit for Construction Activities*
 - b. Community Noise Permit
 - c. Special Management Area Use Permit
 - d. Coastal Zone Management Program

* The area of disturbed ground for the project includes a staging area to be located by the Contractor. Upon selecting the staging area, the Contractor shall update the site-specific BMP plan accordingly and submit to the Department of Health, Clean Water Branch. Should additional Permitting be required, the Contractor shall be responsible for obtaining the Permit from the Department of Health, Clean Water Branch, and shall bear all associated fees. The Contractor will not be granted a time extension should the staging area trigger additional permit requirements.

ORIGINAL PLAN	SURVEY PLOTTED BY	DATE
NOTE BOOK	DRAWN BY	
	TRACED BY	
	CHECKED BY	
	QUANTITIES BY	
	CHECKED BY	

J:\DOT-FARRINGTON HWY INTERSECTIONS\NANAKULI HALEAKALA\CADD\Sheets\Misc\Pollution Control Notes 02 09-03-08.dgn

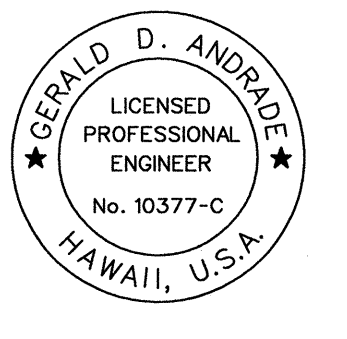
 <p>THIS WORK WAS PREPARED BY ME OR UNDER MY SUPERVISION.</p> <p><i>Gerald D. Andrade</i> 04/30/14 SIGNATURE EXPIRATION DATE OF THE LICENSE</p>	STATE OF HAWAII DEPARTMENT OF TRANSPORTATION HIGHWAYS DIVISION
	WATER POLLUTION AND EROSION CONTROL NOTES - 2
	FARRINGTON HIGHWAY INTERSECTION IMPROVEMENTS AT NANAKULI AVENUE AND HALEAKALA AVENUE Federal-Aid Project No. STP-093-K(22)
	Scale: None Date: April 2013
	SHEET No. ECP-2 OF 13 SHEETS

FED. ROAD DIST. NO.	STATE	FEDERAL AID PROJ. NO.	FISCAL YEAR	SHEET NO.	TOTAL SHEETS
HAWAII	HAW.	STP-093-1(22)	2013	76	230

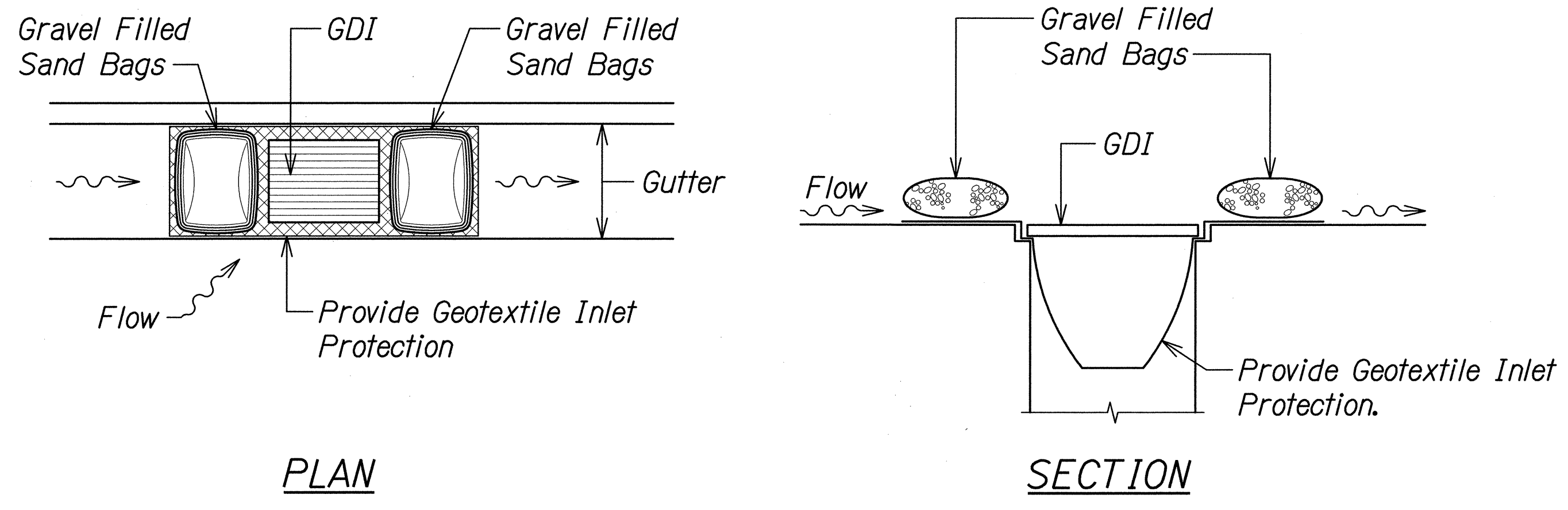

DROP INLET PROTECTION
Not to Scale

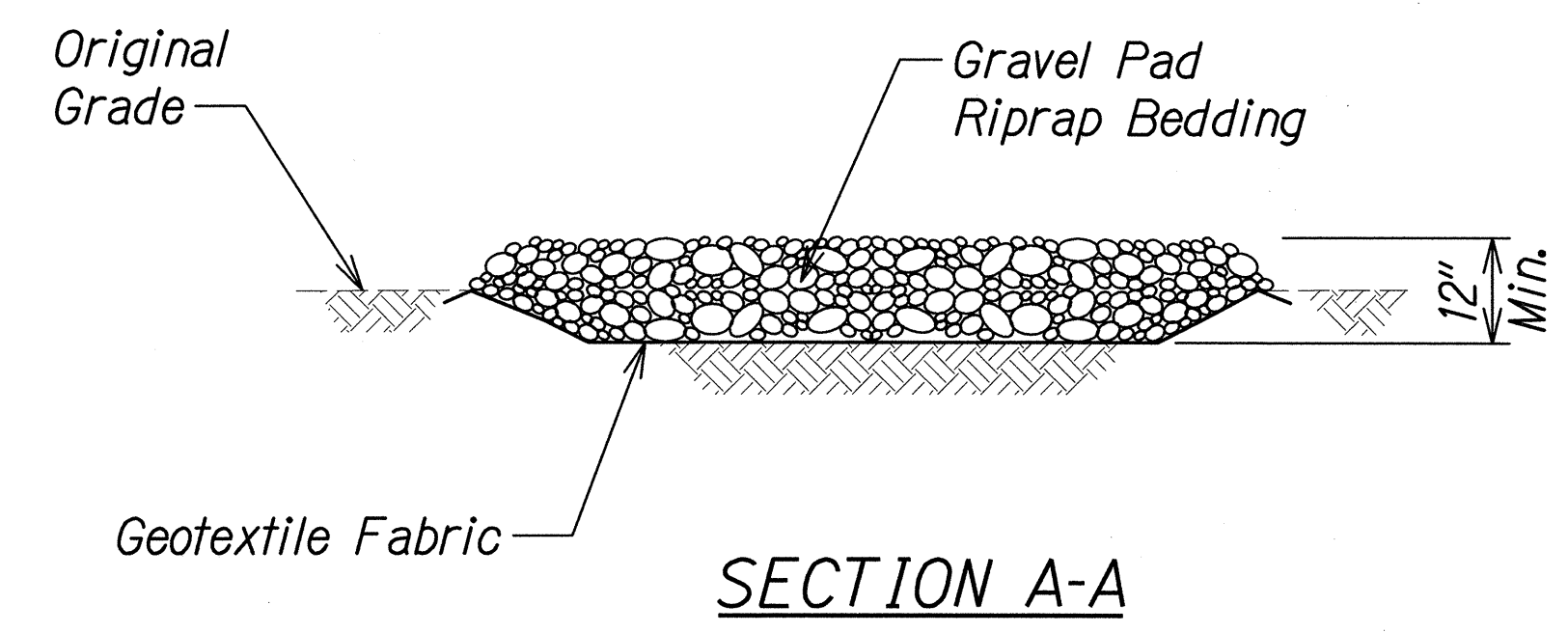
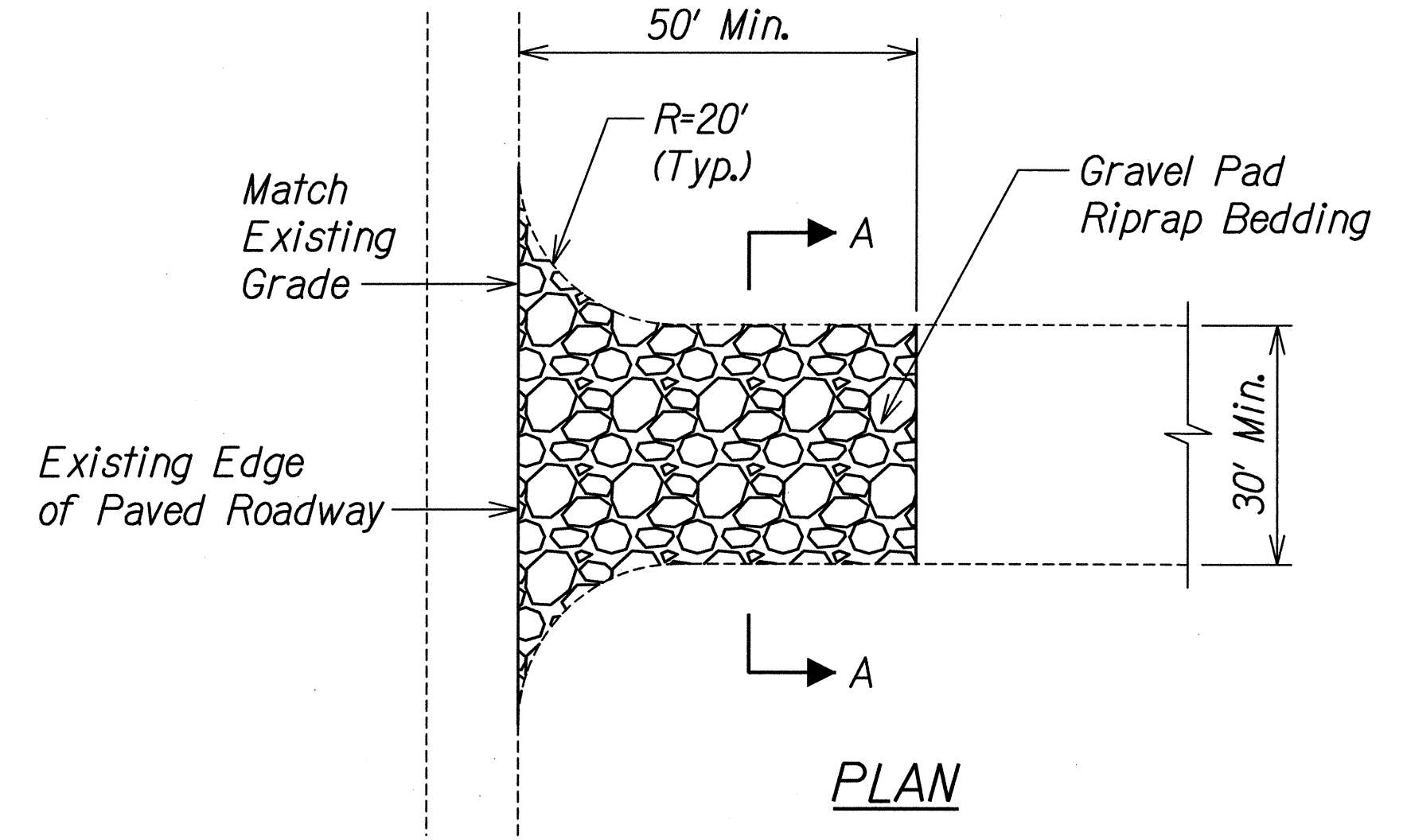
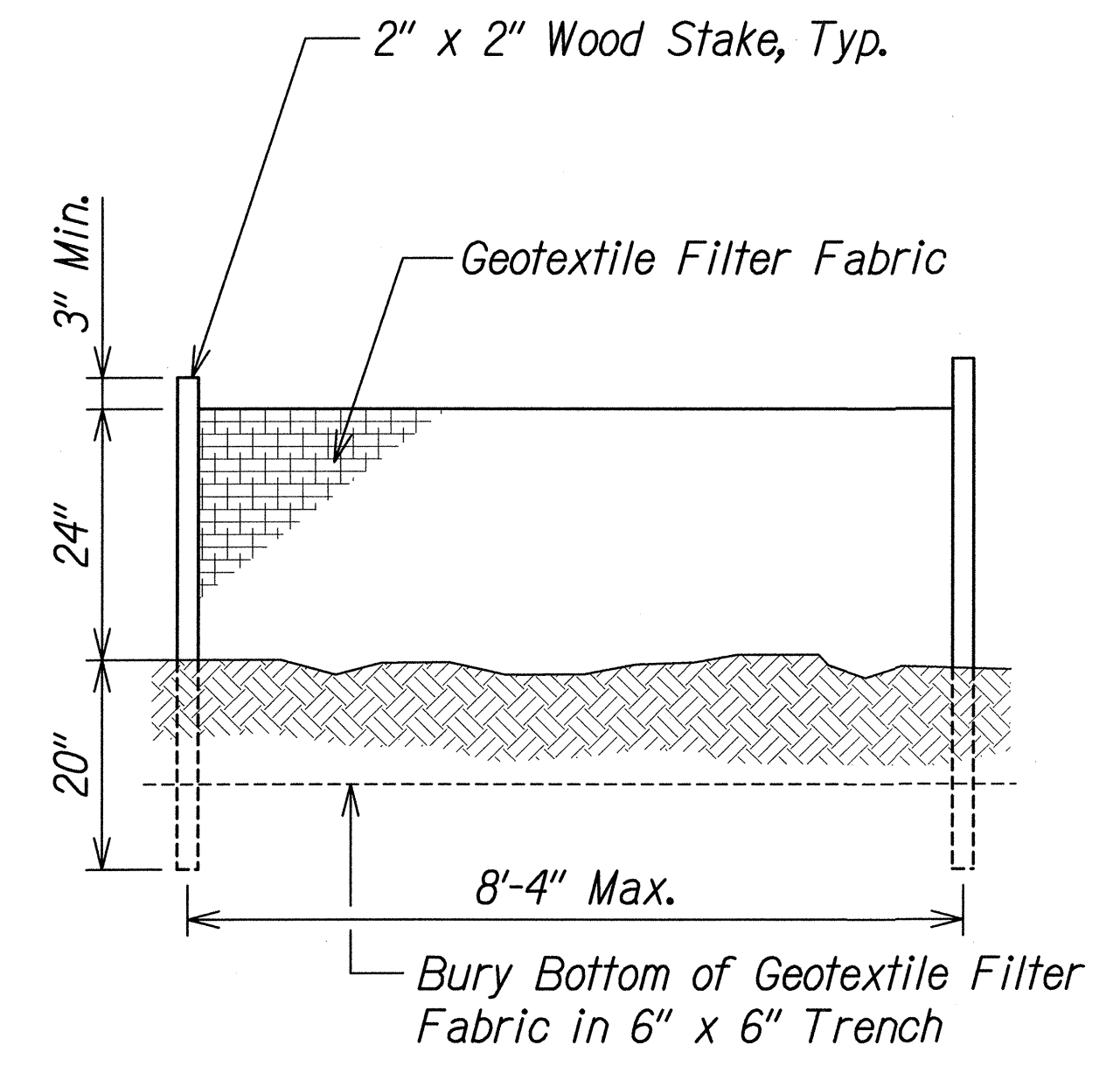

STABILIZED CONSTRUCTION ENTRANCE
Not to Scale

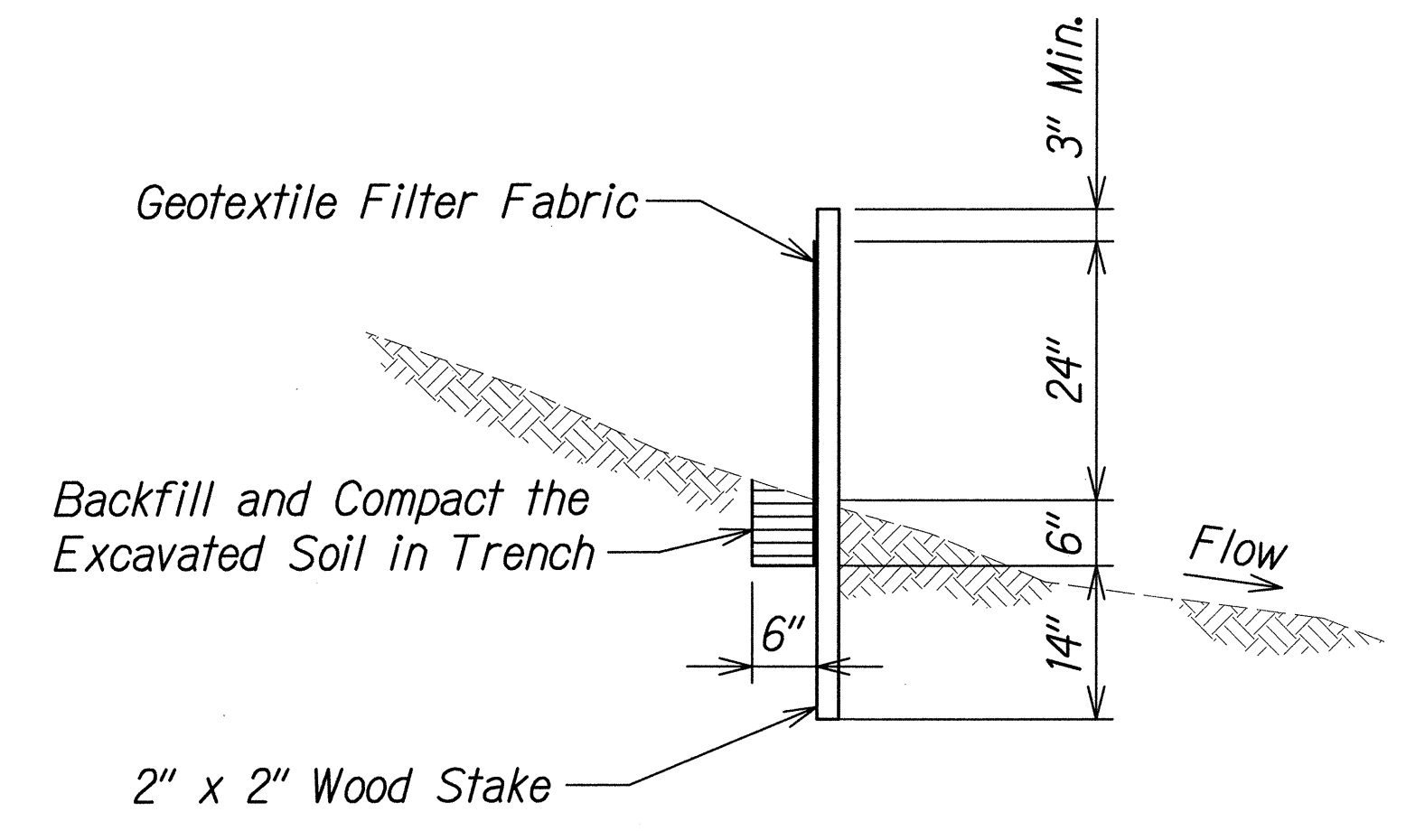

SILT FENCE DETAIL
Not to Scale

- SILT FENCE NOTES:**
- The filter fabric shall be a minimum of 36 inches wide.
 - If silt fence is obtained from manufacturer as a package (i.e. fabric attached to post) the manufacturer's installation instructions shall be adhered to.

SURVEY PLOTTED BY	DATE
DRAWN BY	
TRACED BY	
QUANTITIES BY	
CHECKED BY	
ORIGINAL PLAN	
NOTE BOOK	
DATE	

THIS WORK WAS PREPARED BY ME OR UNDER MY SUPERVISION.

SIGNATURE: *Gerald D. Andrade* EXPIRATION DATE: 04/30/14

STATE OF HAWAII
DEPARTMENT OF TRANSPORTATION
HIGHWAYS DIVISION

WATER POLLUTION AND EROSION CONTROL DETAILS

FARRINGTON HIGHWAY INTERSECTION IMPROVEMENTS
AT NANAKULI AVENUE AND HALEAKALA AVENUE
Federal-Aid Project No. STP-093-1(22)

Scale: Not To Scale Date: April 2013

FED. ROAD DIST. NO.	STATE	FEDERAL AID PROJ. NO.	FISCAL YEAR	SHEET NO.	TOTAL SHEETS
HAWAII	HAW.	STP-093-1(22)	2013	77	230

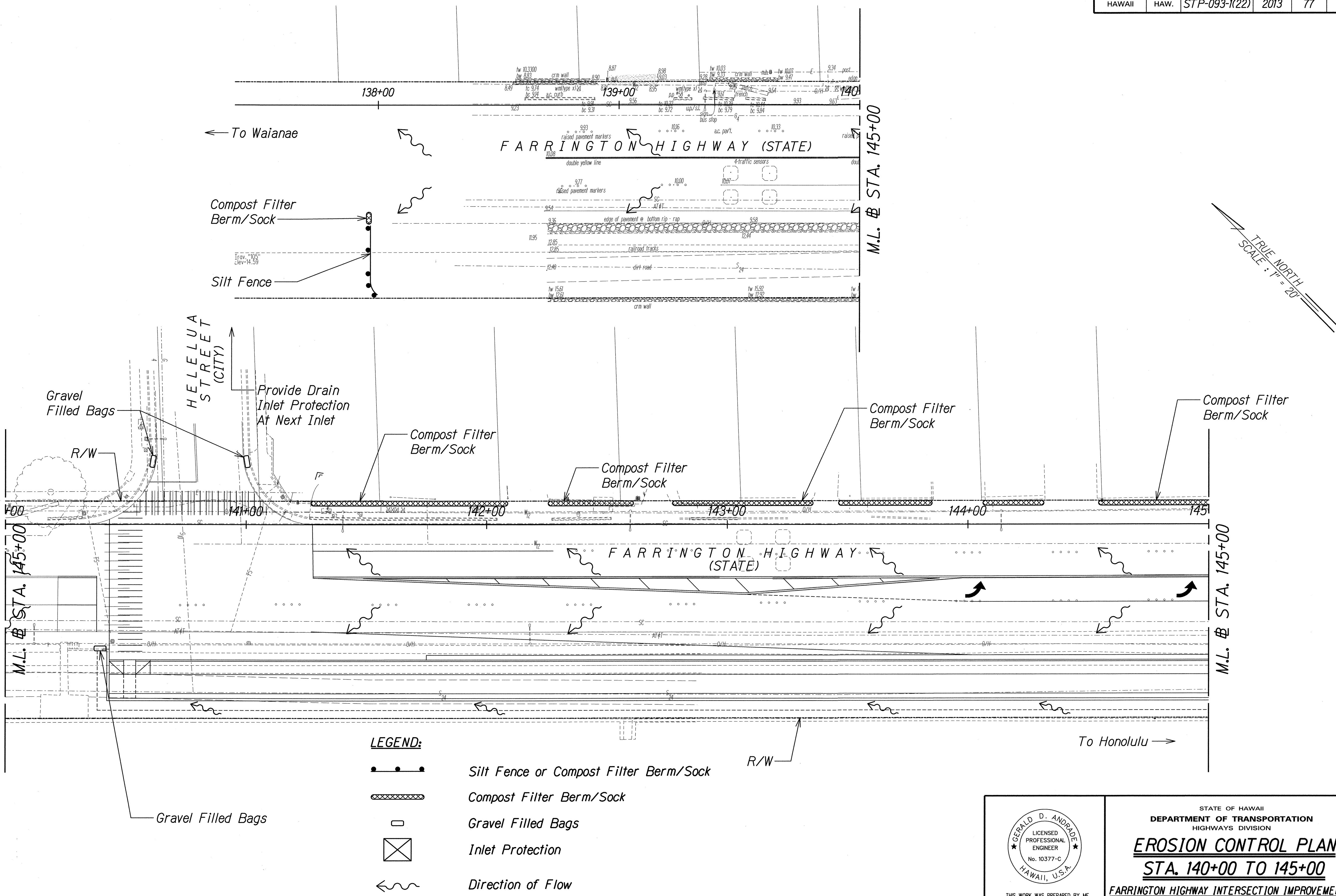

TRUE NORTH
SCALE: 1"=20'

SURVEY PLOTTED BY	DATE
DRAWN BY	
TRACED BY	
QUANTITIES BY	
CHECKED BY	
ORIGINAL PLAN	
NOTE BOOK	
N.	

J:\DOT-FARRINGTON HWY INTERSECTIONS\NANAKULI HALEAKALA\CADD\Sheets\ECP\ECP_01.dgn

THIS WORK WAS PREPARED BY ME OR UNDER MY SUPERVISION.

Signature: *Gerald D. Andros* 04/30/14
EXPIRATION DATE OF THE LICENSE

STATE OF HAWAII
DEPARTMENT OF TRANSPORTATION
HIGHWAYS DIVISION

EROSION CONTROL PLAN
STA. 140+00 TO 145+00

FARRINGTON HIGHWAY INTERSECTION IMPROVEMENTS
AT NANAKULI AVENUE AND HALEAKALA AVENUE
Federal-Aid Project No. STP-093-1(22)

Scale: 1"=20' Date: April 2013

SHEET No. ECP-4 OF 13 SHEETS

FED. ROAD DIST. NO.	STATE	FEDERAL AID PROJ. NO.	FISCAL YEAR	SHEET NO.	TOTAL SHEETS
HAWAII	HAW.	STP-093-1(22)	2013	78	230

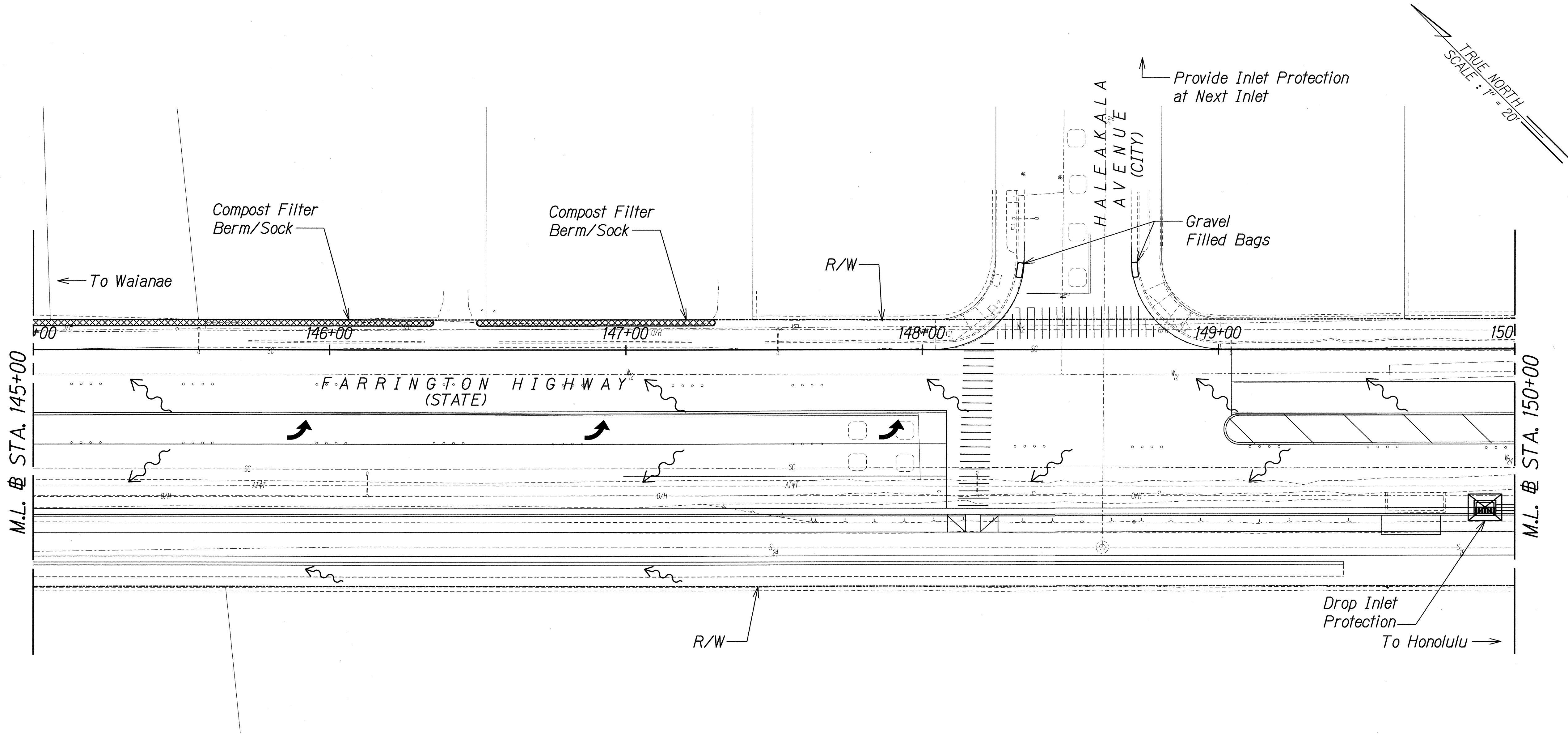

LEGEND:

- Silt Fence or Compost Filter Berm/Sock
- Compost Filter Berm/Sock
- Gravel Filled Bags
- Inlet Protection
- Direction of Flow

SURVEY PLOTTED BY	DATE
DRAWN BY	
TRACED BY	
QUANTITIES BY	
CHECKED BY	

ORIGINAL PLAN	DATE
NOTE BOOK	
DATE	

J:\DOT-FARRINGTON HWY INTERSECTIONS\NANAKULI HALEAKALA\CADD\Sheets\ECP\ECP_02.dgn

THIS WORK WAS PREPARED BY ME OR UNDER MY SUPERVISION.

Signature: *Gerald D. Andrade* 04/30/14
EXPIRATION DATE OF THE LICENSE

STATE OF HAWAII
DEPARTMENT OF TRANSPORTATION
HIGHWAYS DIVISION

EROSION CONTROL PLAN
STA. 145+00 TO 150+00

FARRINGTON HIGHWAY INTERSECTION IMPROVEMENTS
AT NANAKULI AVENUE AND HALEAKALA AVENUE
Federal-Aid Project No. STP-093-1(22)

Scale: 1"=20' Date: April 2013

FED. ROAD DIST. NO.	STATE	FEDERAL AID PROJ. NO.	FISCAL YEAR	SHEET NO.	TOTAL SHEETS
HAWAII	HAW.	STP-093-1(22)	2013	79	230

TRUE NORTH
SCALE: 1"=20'

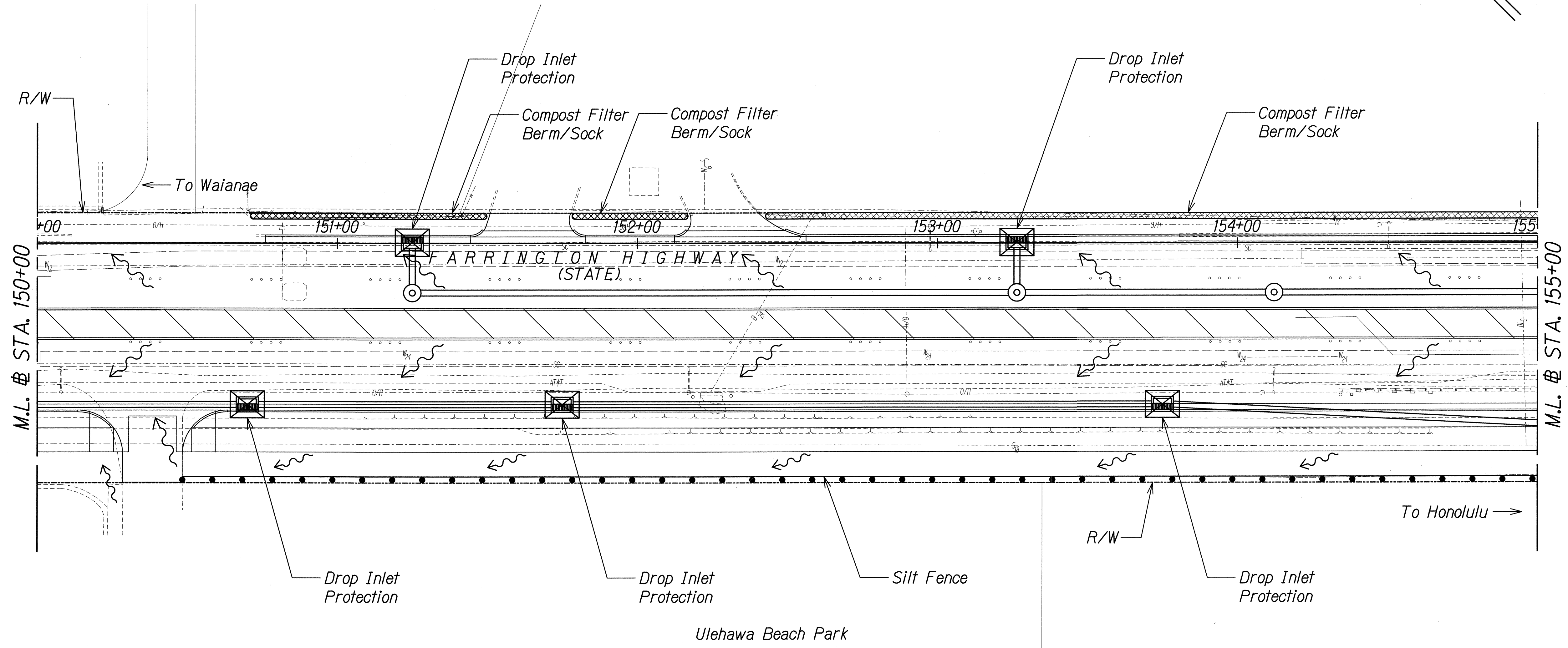

- LEGEND:**
- Silt Fence or Compost Filter Berm/Sock
 - x—x— Compost Filter Berm/Sock
 - Gravel Filled Bags
 - ⊠ Inlet Protection
 - ←~~~ Direction of Flow

SURVEY PLOTTED BY	DATE
DRAWN BY	
CHECKED BY	
NOTED BY	
QUANTITIES BY	
CHECKED BY	

J:\DOT-FARRINGTON HWY INTERSECTIONS\NANAKULI HALEAKALA\CADD\Sheets\ECP\ECP-03.dgn

THIS WORK WAS PREPARED BY ME OR UNDER MY SUPERVISION.

Signature: *Gerald D. Andrade* 04/30/14
EXPIRATION DATE OF THE LICENSE

STATE OF HAWAII
DEPARTMENT OF TRANSPORTATION
HIGHWAYS DIVISION

EROSION CONTROL PLAN
STA. 150+00 TO 155+00

FARRINGTON HIGHWAY INTERSECTION IMPROVEMENTS
AT NANAKULI AVENUE AND HALEAKALA AVENUE
Federal-Aid Project No. STP-093-1(22)

Scale: 1"=20' Date: April 2013

FED. ROAD DIST. NO.	STATE	FEDERAL AID PROJ. NO.	FISCAL YEAR	SHEET NO.	TOTAL SHEETS
HAWAII	HAW.	STP-093-1(22)	2013	80	230

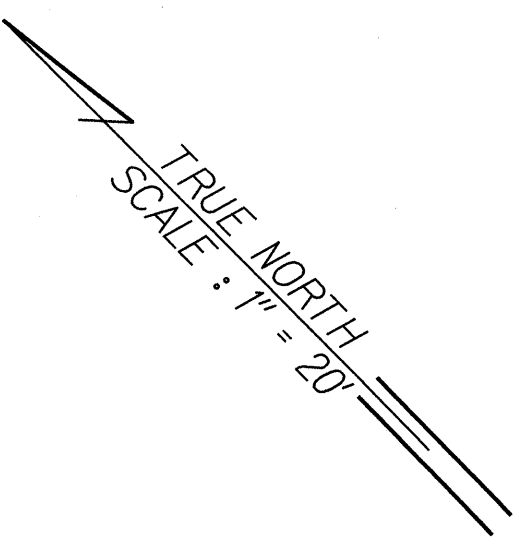
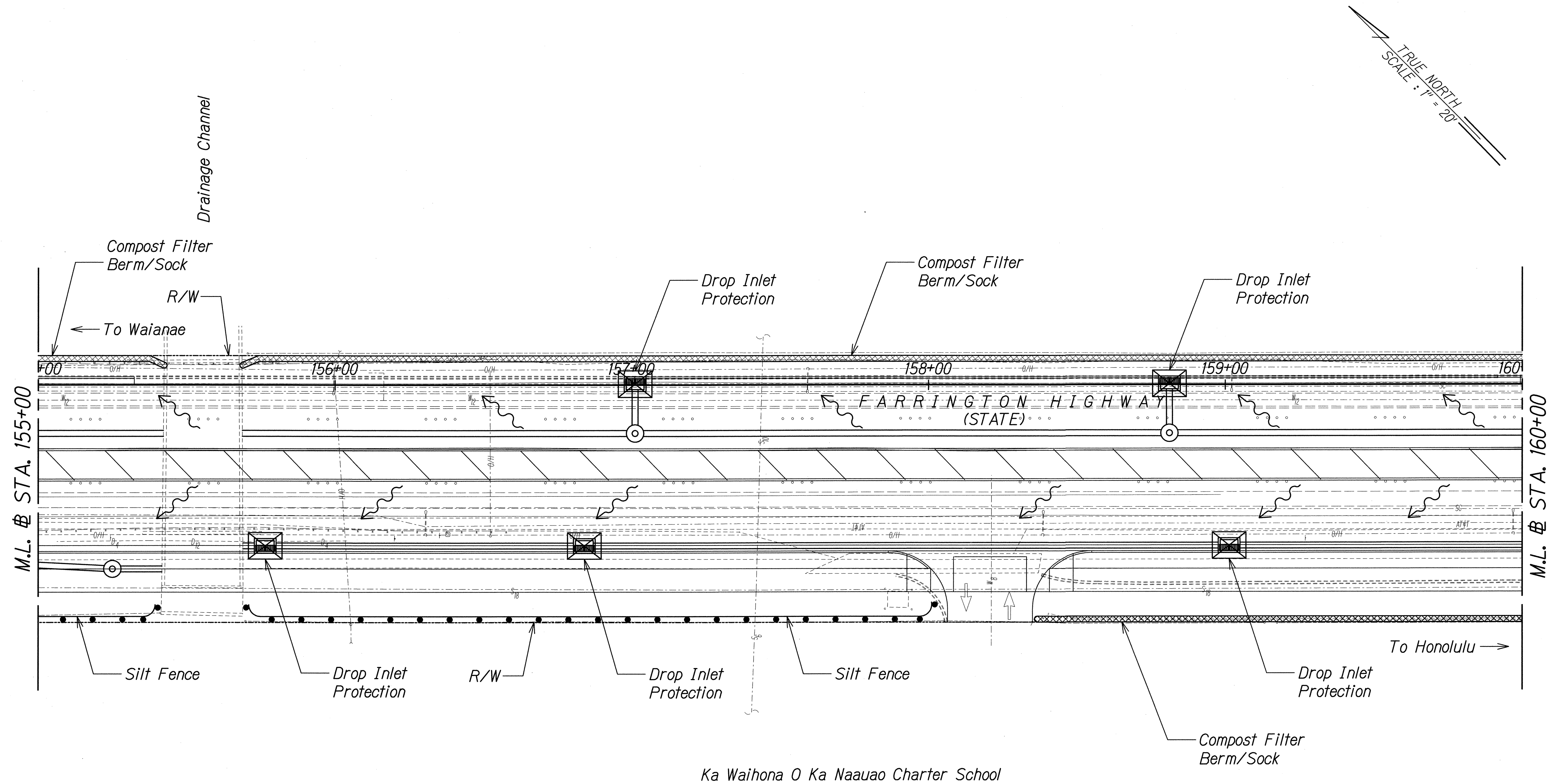

- LEGEND:**
- Silt Fence or Compost Filter Berm/Sock
 - Compost Filter Berm/Sock
 - Gravel Filled Bags
 - Inlet Protection
 - Direction of Flow

ORIGINAL PLAN	SURVEY PLOTTED BY	DATE
NOTES BOOK	DRAWN BY	
	TRACED BY	
	QUANTITIES BY	
	CHECKED BY	
	IN	

J:/DOT-FARRINGTON HWY INTERSECTIONS NAKAKULI HALEAKALA/CADD/Sheets/ECP/ECP_04.dgn

THIS WORK WAS PREPARED BY ME OR UNDER MY SUPERVISION.

Signature: *Gerald D. Andrade* 04/30/14
 EXPIRATION DATE OF THE LICENSE

STATE OF HAWAII
 DEPARTMENT OF TRANSPORTATION
 HIGHWAYS DIVISION

EROSION CONTROL PLAN
STA. 155+00 TO 160+00

FARRINGTON HIGHWAY INTERSECTION IMPROVEMENTS
 AT NAKAKULI AVENUE AND HALEAKALA AVENUE
 Federal-Aid Project No. STP-093-1(22)

Scale: 1"=20' Date: April 2013

FED. ROAD DIST. NO.	STATE	FEDERAL AID PROJ. NO.	FISCAL YEAR	SHEET NO.	TOTAL SHEETS
HAWAII	HAW.	STP-093-1(22)	2013	81	230

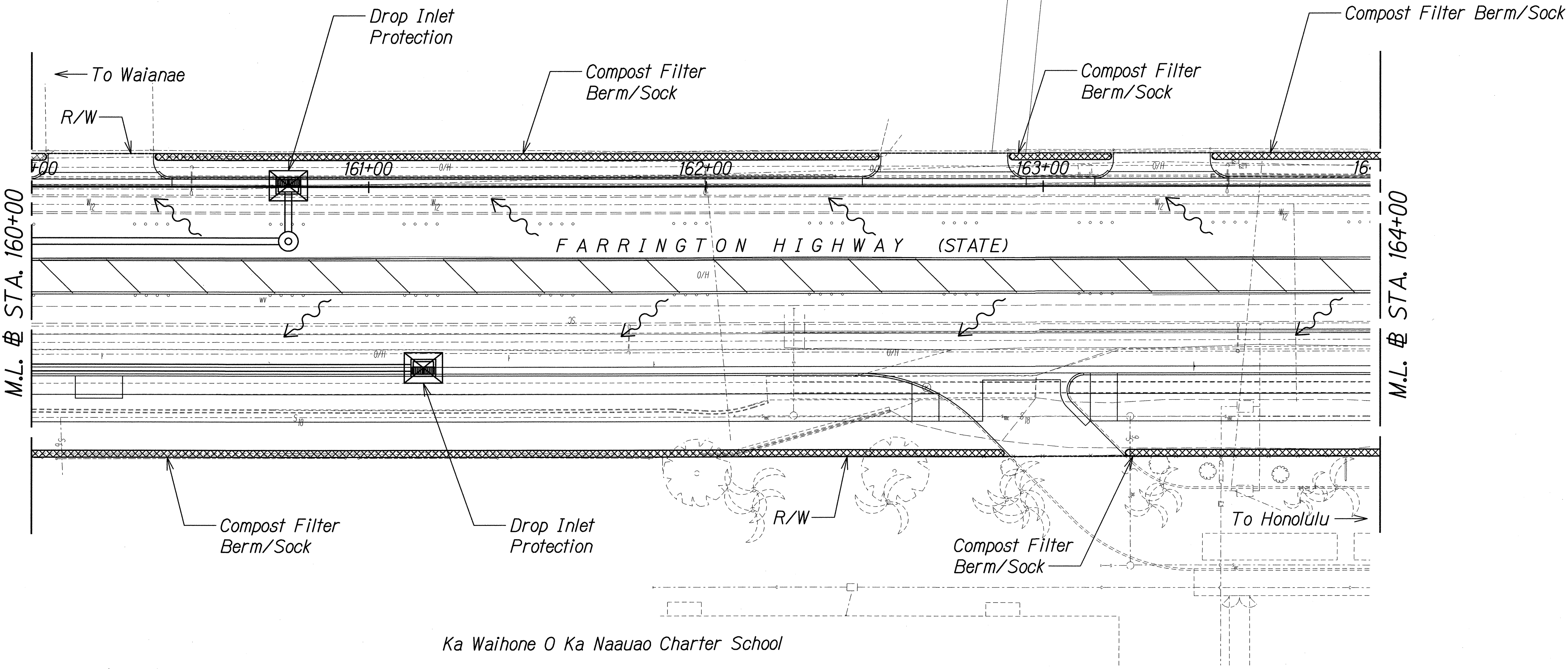
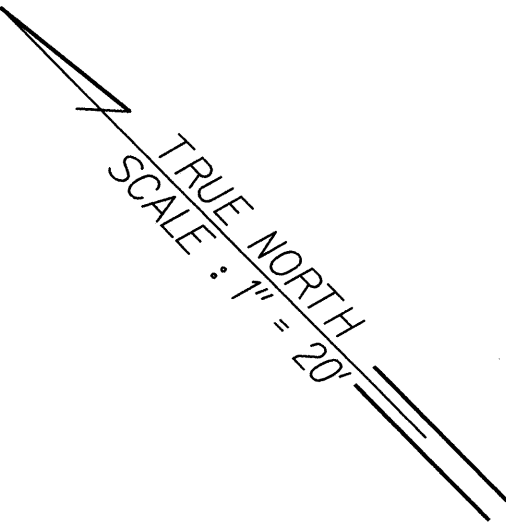

- LEGEND:**
- Silt Fence or Compost Filter Berm/Sock
 - Compost Filter Berm/Sock
 - Gravel Filled Bags
 - Inlet Protection
 - Direction of Flow

SURVEY PLOTTED BY	DATE
DRAWN BY	
TRACED BY	
NOTED BY	
CHECKED BY	
APPROVED BY	

J:\DOT-FARRINGTON HWY INTERSECTIONS\NANAKULI HALEAKALA\CADD\Sheets\ECP\ECP_05.dgn

THIS WORK WAS PREPARED BY ME OR UNDER MY SUPERVISION.

Gerald D. Andrade
SIGNATURE

04/30/14
EXPIRATION DATE OF THE LICENSE

STATE OF HAWAII
DEPARTMENT OF TRANSPORTATION
HIGHWAYS DIVISION

EROSION CONTROL PLAN
STA. 160+00 TO 164+00

FARRINGTON HIGHWAY INTERSECTION IMPROVEMENTS
AT NANAKULI AVENUE AND HALEAKALA AVENUE
Federal-Aid Project No. STP-093-1(22)

Scale: 1"=20' Date: April 2013

FED. ROAD DIST. NO.	STATE	FEDERAL AID PROJ. NO.	FISCAL YEAR	SHEET NO.	TOTAL SHEETS
HAWAII	HAW.	STP-093-1(22)	2013	82	230

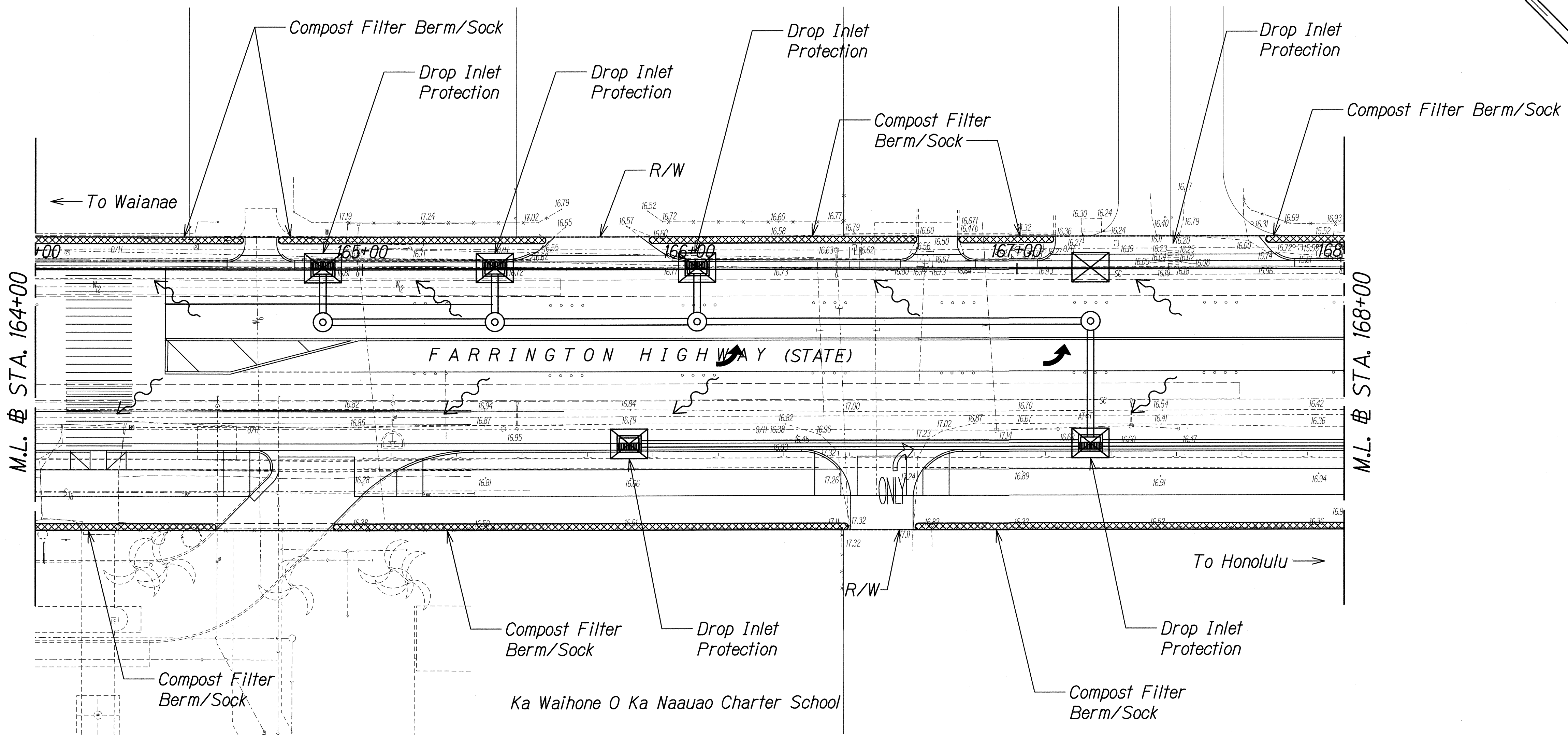
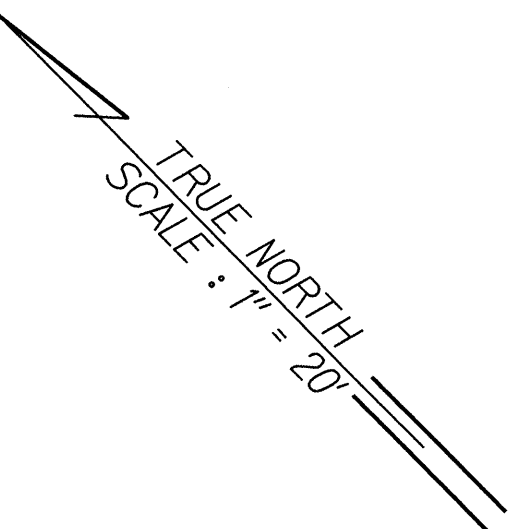

- LEGEND:**
- Silt Fence or Compost Filter Berm/Sock
 - Compost Filter Berm/Sock
 - Gravel Filled Bags
 - Inlet Protection
 - Direction of Flow

ORIGINAL PLAN NOTE BOOK No. _____	SURVEY PLOTTED BY _____	DATE _____
	DRAWN BY _____	
	TRACED BY _____	
	CHECKED BY _____	

J:\DOT-FARRINGTON HWY INTERSECTIONS\NAKULI HALEAKALA\CADD\Sheets\ECP\ECP-06.dgn

THIS WORK WAS PREPARED BY ME
OR UNDER MY SUPERVISION.

Gerald D. Andrae
SIGNATURE

04/30/14
EXPIRATION DATE
OF THE LICENSE

STATE OF HAWAII
DEPARTMENT OF TRANSPORTATION
HIGHWAYS DIVISION

EROSION CONTROL PLAN
STA. 164+00 TO 168+00

FARRINGTON HIGHWAY INTERSECTION IMPROVEMENTS
AT NAKULI AVENUE AND HALEAKALA AVENUE
Federal-Aid Project No. STP-093-1(22)

Scale: 1"=20' Date: April 2013

SHEET No. ECP-9 OF 13 SHEETS

FED. ROAD DIST. NO.	STATE	FEDERAL AID PROJ. NO.	FISCAL YEAR	SHEET NO.	TOTAL SHEETS
HAWAII	HAW.	STP-093-1(22)	2013	83	230

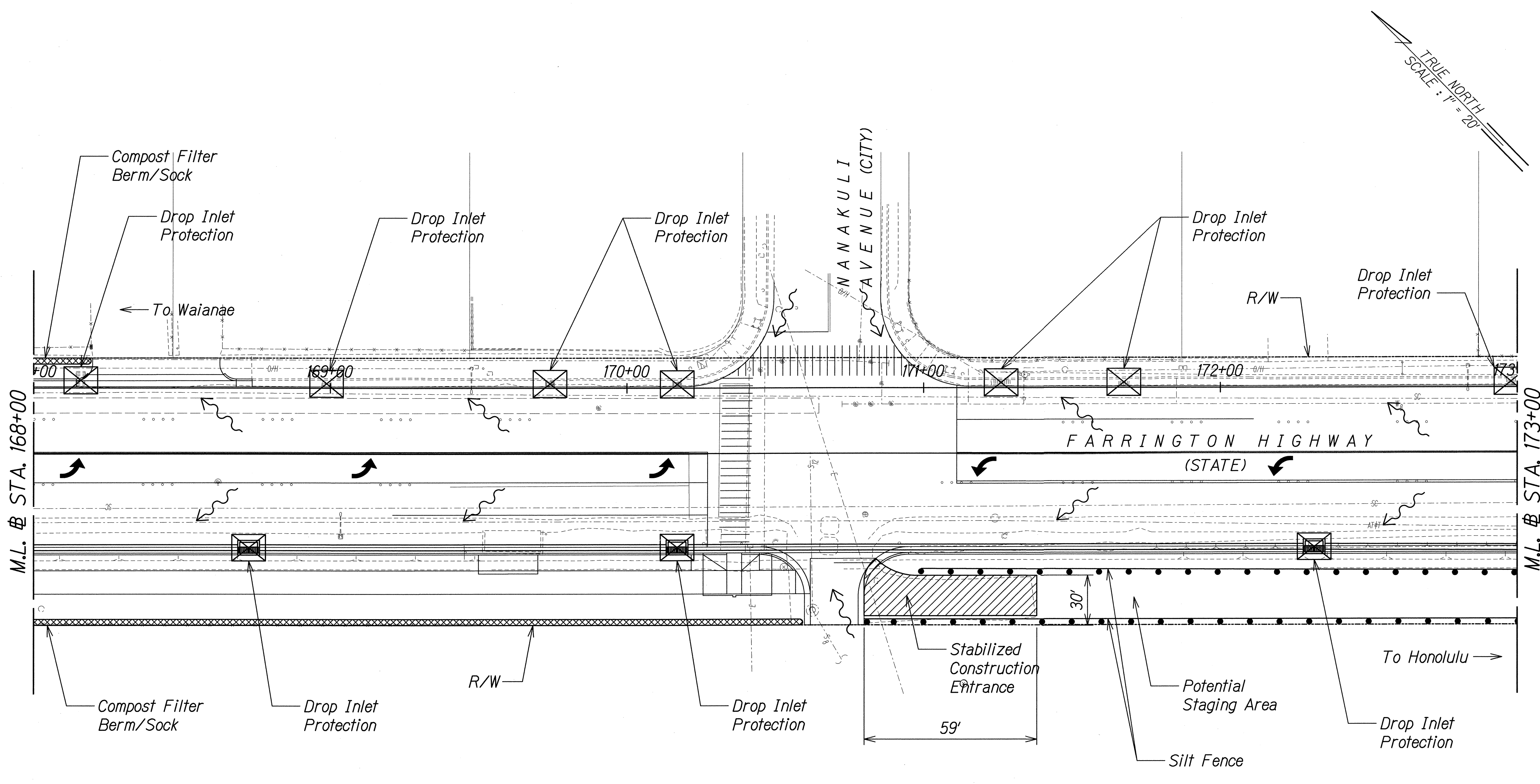

ORIGINAL PLAN	SURVEY PLOTTED BY	DATE
	DRAWN BY	
	TRACED BY	
	NOTED BY	
NOTE BOOK	QUANTITIES BY	
	CHECKED BY	

J:\DOT-FARRINGTON HWY INTERSECTIONS\NANAKULI HALEAKALA\CADD\Sheets\ECP\ECP_07.dgn

- LEGEND:**
- Silt Fence or Compost Filter Berm/Sock
 - Compost Filter Berm/Sock
 - Gravel Filled Bags
 - Inlet Protection
 - Direction of Flow

THIS WORK WAS PREPARED BY ME OR UNDER MY SUPERVISION.

Signature: *Gerald D. Andrade* 04/30/14
 EXPIRATION DATE OF THE LICENSE

STATE OF HAWAII
 DEPARTMENT OF TRANSPORTATION
 HIGHWAYS DIVISION

EROSION CONTROL PLAN
STA. 168+00 TO 173+00

FARRINGTON HIGHWAY INTERSECTION IMPROVEMENTS
 AT NANAKULI AVENUE AND HALEAKALA AVENUE
 Federal-Aid Project No. STP-093-1(22)

Scale: 1"=20' Date: April 2013

FED. ROAD DIST. NO.	STATE	FEDERAL AID PROJ. NO.	FISCAL YEAR	SHEET NO.	TOTAL SHEETS
HAWAII	HAW.	STP-093-1(22)	2013	84	230

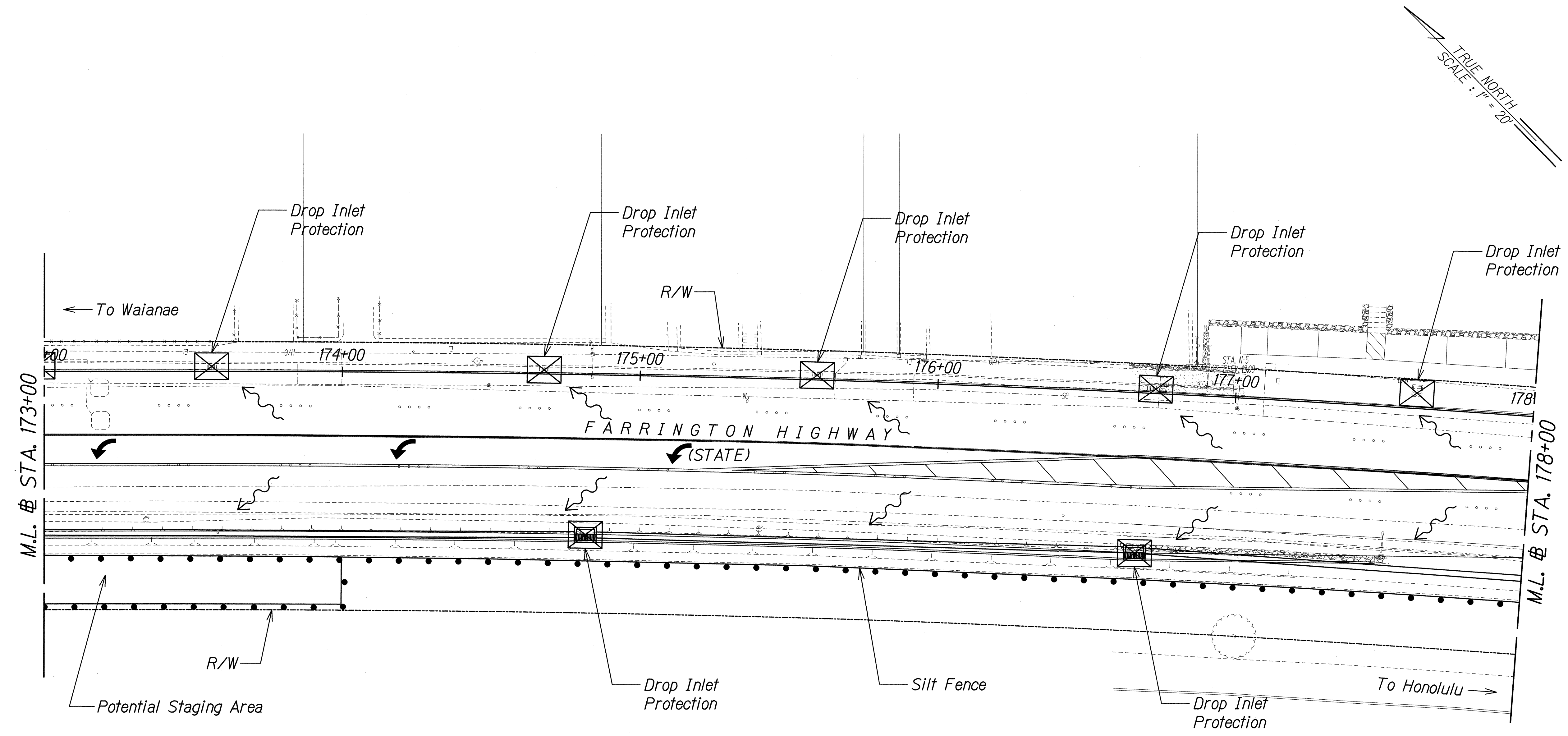

SURVEY PLOTTED BY	DATE
DRAWN BY	
TRACED BY	
NOTED BY	
CHECKED BY	
ORIGINAL PLAN	
NOTE BOOK	
N.	

J:\DOT-FARRINGTON HWY INTERSECTIONS\NANAKULI HALEAKALA\CADD\Sheets\ECP\ECP_08.dgn

- LEGEND:**
- Silt Fence or Composite Filter Berm/Sock
 - Compost Filter Berm/Sock
 - Gravel Filled Bags
 - Inlet Protection
 - Direction of Flow

THIS WORK WAS PREPARED BY ME OR UNDER MY SUPERVISION.

Signature: *Gerald D. Andros* Date: 04/30/14

EXPIRATION DATE OF THE LICENSE

STATE OF HAWAII
DEPARTMENT OF TRANSPORTATION
HIGHWAYS DIVISION

EROSION CONTROL PLAN
STA. 173+00 TO 178+00

FARRINGTON HIGHWAY INTERSECTION IMPROVEMENTS
AT NANAKULI AVENUE AND HALEAKALA AVENUE
Federal-Aid Project No. STP-093-1(22)

Scale: 1"=20' Date: April 2013

FED. ROAD DIST. NO.	STATE	FEDERAL AID PROJ. NO.	FISCAL YEAR	SHEET NO.	TOTAL SHEETS
HAWAII	HAW.	STP-093-1(22)	2013	85	230

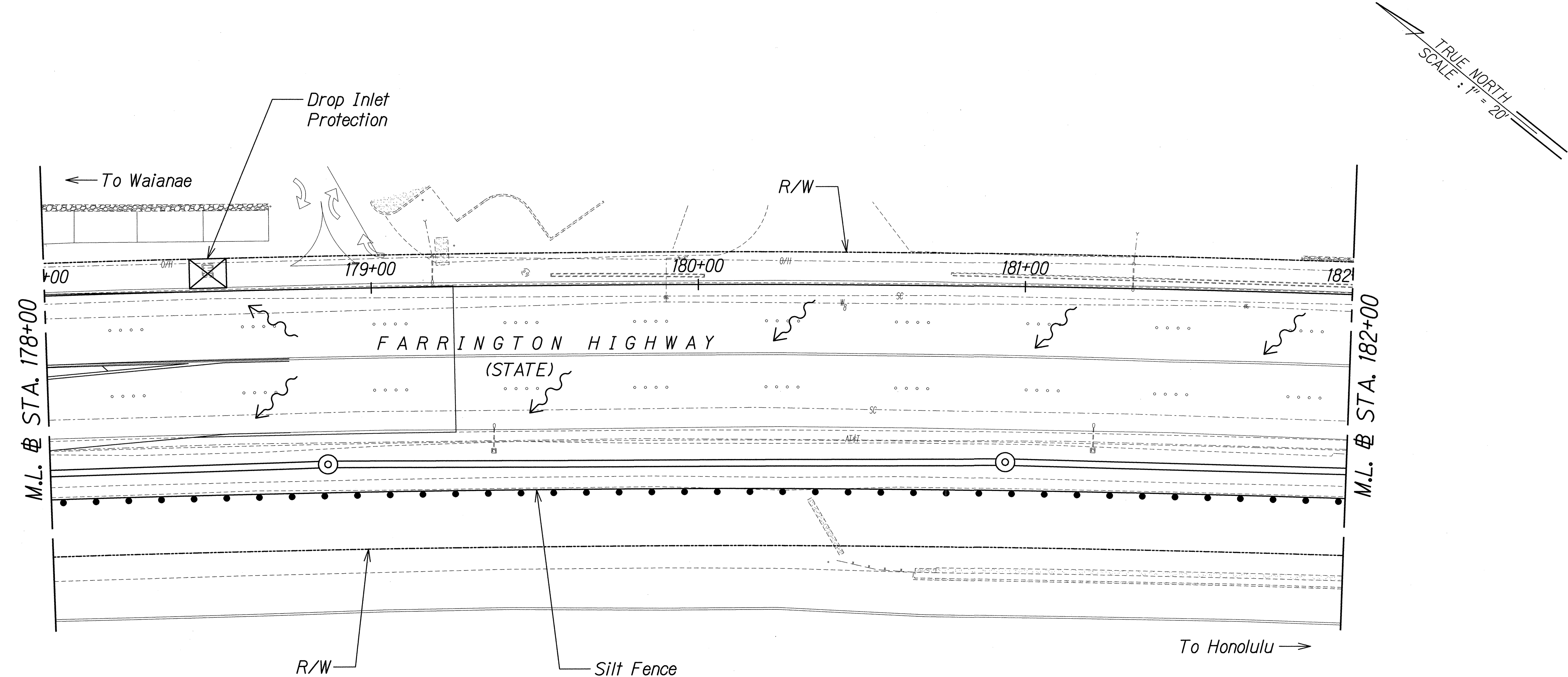

- LEGEND:**
- Silt Fence or Compost Filter Berm/Sock
 - Compost Filter Berm/Sock
 - Gravel Filled Bags
 - Inlet Protection
 - Direction of Flow

ORIGINAL PLAN	SURVEY PLOTTED BY	DATE
NOTE BOOK	DRAWN BY	
	TRACED BY	
	CHECKED BY	
	QUANTITIES BY	

J:/DOT-FARRINGTON HWY INTERSECTIONS NANAKULI HALEAKALA/CADD/Sheets/ECP/ECP_08.dgn

THIS WORK WAS PREPARED BY ME OR UNDER MY SUPERVISION.

Gerald D. Andrade 04/30/14
SIGNATURE EXPIRATION DATE OF THE LICENSE

STATE OF HAWAII
DEPARTMENT OF TRANSPORTATION
HIGHWAYS DIVISION

EROSION CONTROL PLAN
STA. 178+00 TO 182+00

FARRINGTON HIGHWAY INTERSECTION IMPROVEMENTS
AT NANAKULI AVENUE AND HALEAKALA AVENUE
Federal-Aid Project No. STP-093-1(22)

Scale: 1"=20' Date: April 2013

SHEET No. ECP-12 OF 13 SHEETS

FED. ROAD DIST. NO.	STATE	FEDERAL AID PROJ. NO.	FISCAL YEAR	SHEET NO.	TOTAL SHEETS
HAWAII	HAW.	STP-093-1(22)	2013	86	230

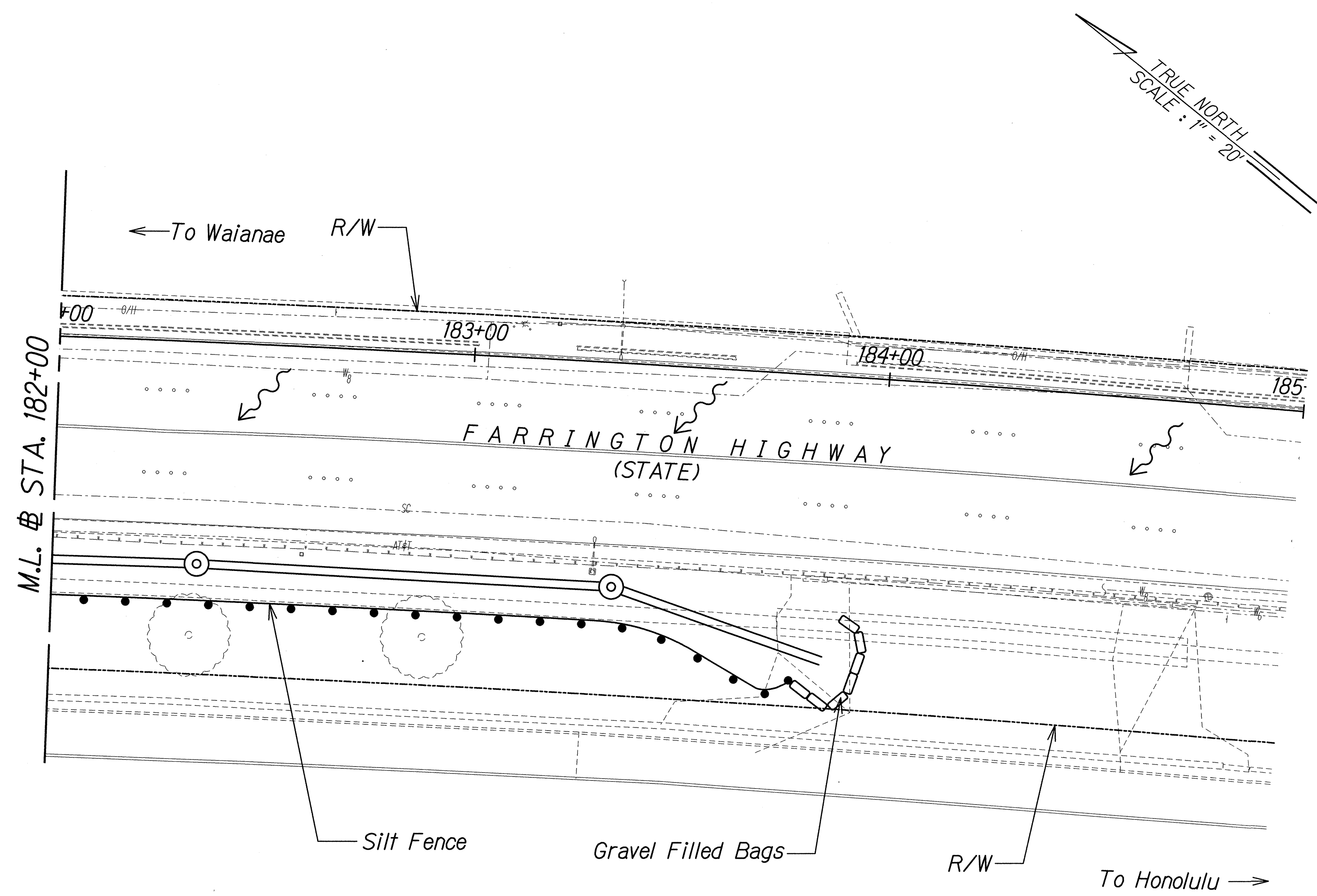

- LEGEND:**
- Silt Fence or Compost Filter Berm/Sock
 - Compost Filter Berm/Sock
 - Gravel Filled Bags
 - Inlet Protection
 - Direction of Flow

SURVEY PLOTTED BY	DATE
DRAWN BY	
TRACED BY	
CHECKED BY	
NOTE BOOK	
QUANTITIES BY	
CHECKED BY	
No.	

THIS WORK WAS PREPARED BY ME OR UNDER MY SUPERVISION.

Gerald D. Andrade
SIGNATURE

04/30/14
EXPIRATION DATE OF THE LICENSE

STATE OF HAWAII
DEPARTMENT OF TRANSPORTATION
HIGHWAYS DIVISION

EROSION CONTROL PLAN
STA. 182+00 TO 185+00

FARRINGTON HIGHWAY INTERSECTION IMPROVEMENTS
AT NANAKULI AVENUE AND HALEAKALA AVENUE
Federal-Aid Project No. STP-093-1(22)

Scale: 1"=20' Date: April 2013