

FED. ROAD DIST. NO.	STATE	FED. AID PROJ. NO.	FISCAL YEAR	SHEET NO.	TOTAL SHEETS
HAWAII	HAW.	BR-093-1(20)	2020	ADD.45	168

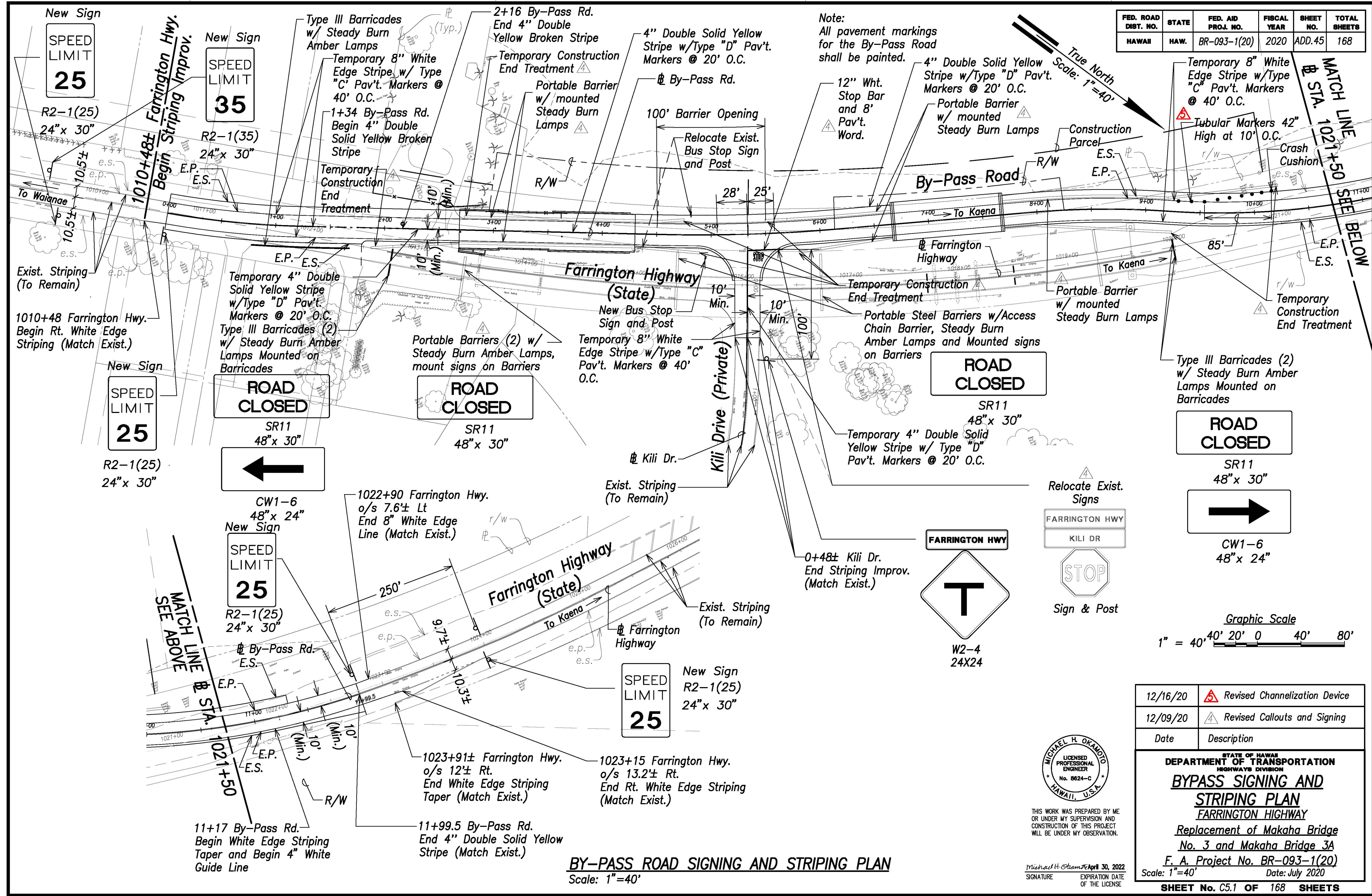

DATE	
SURVEY PLOTTED BY	
DESIGNED BY	
TRACED BY	
QUANTITIES BY	
CHECKED BY	
ORIGINAL PLAN	
NOTE BOOK	
No.	

BY-PASS ROAD SIGNING AND STRIPING PLAN
Scale: 1"=40'

MICHAEL H. OKAMOTO
LICENSED PROFESSIONAL ENGINEER
No. 8824-C
HAWAII, U.S.A.

THIS WORK WAS PREPARED BY ME OR UNDER MY SUPERVISION AND CONSTRUCTION OF THIS PROJECT WILL BE UNDER MY OBSERVATION.

Michael H. Okamoto April 30, 2022
SIGNATURE EXPIRATION DATE OF THE LICENSE

12/16/20	Revised Channelization Device
12/09/20	Revised Callouts and Signing
Date	Description
STATE OF HAWAII DEPARTMENT OF TRANSPORTATION HIGHWAYS DIVISION BYPASS SIGNING AND STRIPING PLAN FARRINGTON HIGHWAY Replacement of Makaha Bridge No. 3 and Makaha Bridge 3A F. A. Project No. BR-093-1(20) Scale: 1"=40' Date: July 2020	
SHEET No. C5.1 OF 168 SHEETS	

FED. ROAD DIST. NO.	STATE	FED. AID PROJ. NO.	FISCAL YEAR	SHEET NO.	TOTAL SHEETS
HAWAII	HAW.	BR-093-1(20)	2020	ADD.46	168

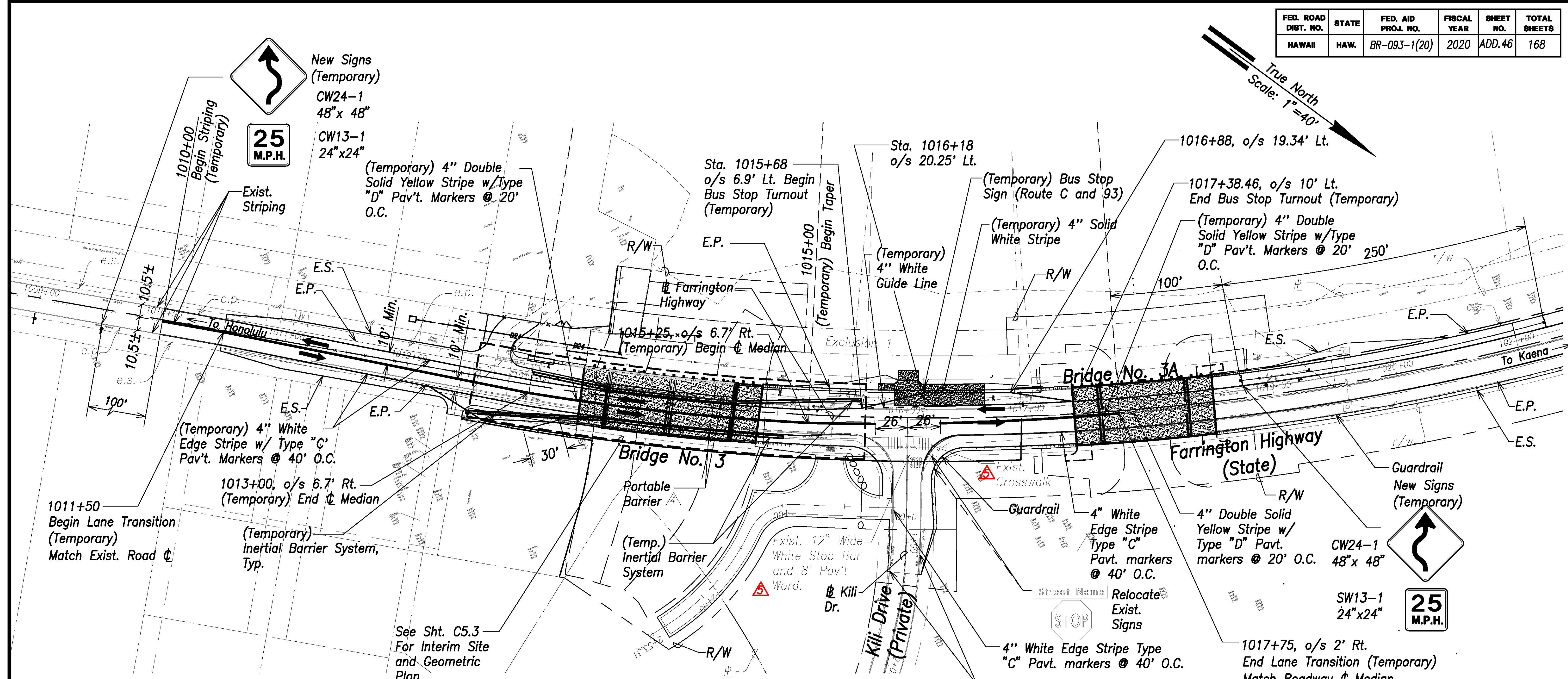
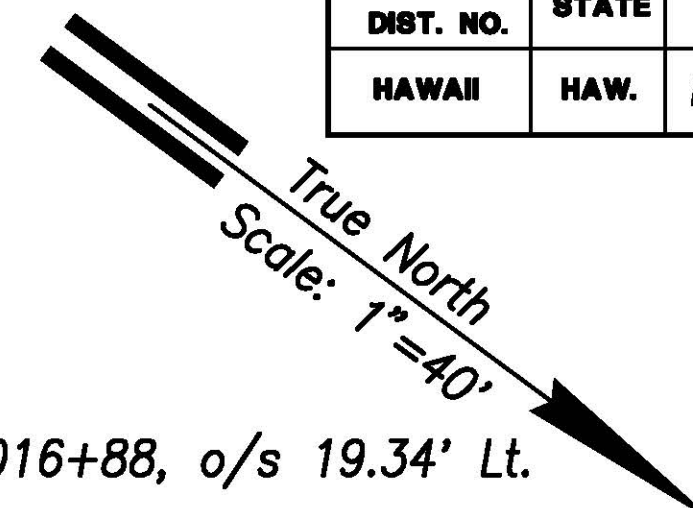

- Notes:
1. See Sheet C5.4 for Ultimate Roadway Signing and Striping Plan.
 2. All Temporary Striping shall be Paint.

INTERIM ROADWAY SIGNING AND STRIPING PLAN
Scale: 1"=40'

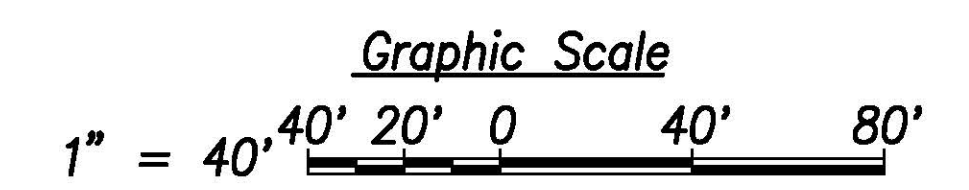

DATE	_____
SURVEY PLOTTED BY	_____
DRAWN BY	_____
NOTED BY	_____
CHECKED BY	_____
ORIGINAL PLAN	_____
NOTE BOOK	_____
No.	_____

12/09/20	▲ Revised Callouts to Show as Existing
12/09/20	▲ Revised Callouts and Added Pav't Word.
Date	Description



THIS WORK WAS PREPARED BY ME OR UNDER MY SUPERVISION AND CONSTRUCTION OF THIS PROJECT WILL BE UNDER MY OBSERVATION.

Michael H. Okamoto
APR 30, 2022
SIGNATURE EXPIRATION DATE OF THE LICENSE

STATE OF HAWAII
DEPARTMENT OF TRANSPORTATION
HIGHWAYS DIVISION

INTERIM ROADWAY SIGNING AND STRIPING PLAN
FARRINGTON HIGHWAY
Replacement of Makaha Bridge No. 3 and Makaha Bridge 3A
F. A. Project No. BR-093-1(20)
Scale: 1"=40' Date: July 2020

SHEET No. C5.2 OF 168 SHEETS

FED. ROAD DIST. NO.	STATE	FED. AID PROJ. NO.	FISCAL YEAR	SHEET NO.	TOTAL SHEETS
HAWAII	HAW.	BR-093-1(20)	2020	47	168

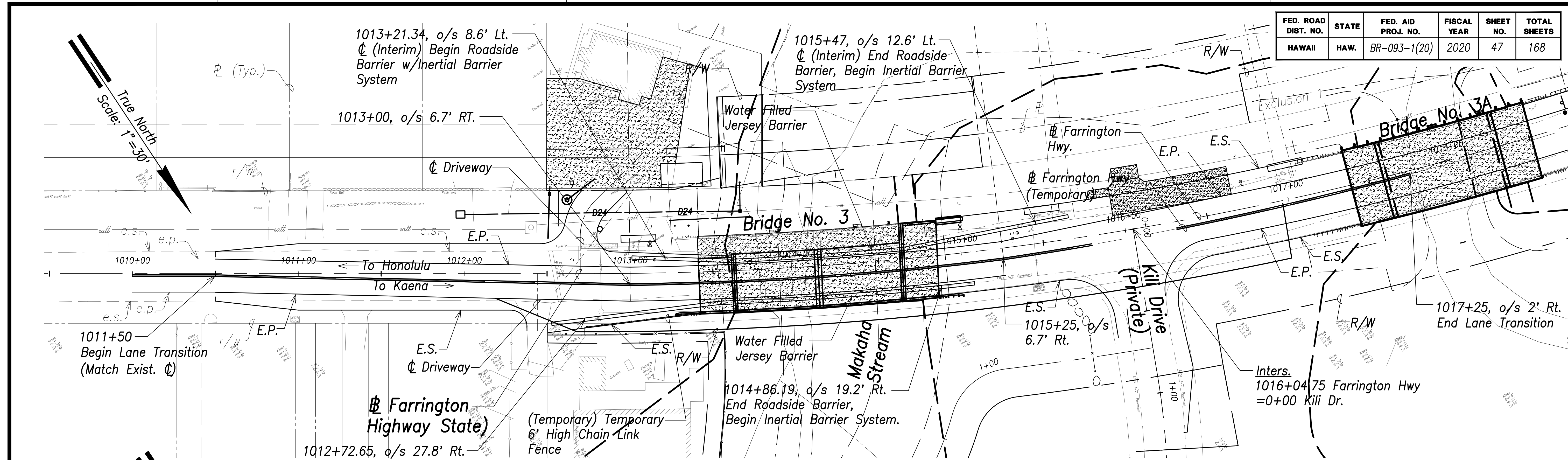

INTERIM SITE AND GEOMETRIC PLAN
Scale: 1"=30'

- Notes:
1. Install Inertial Barrier System per the Manufacturer's Recommendations.
 2. See Sheet C3.6 and C3.7 for Ultimate Roadway Plan.
 3. All Interim Striping shall be Painted.
 4. Provide smooth riding pavement at all connection and grade transition.



THIS WORK WAS PREPARED BY ME OR UNDER MY SUPERVISION AND CONSTRUCTION OF THIS PROJECT WILL BE UNDER MY OBSERVATION.

Michael H. Okamoto April 30, 2022
SIGNATURE EXPIRATION DATE OF THE LICENSE

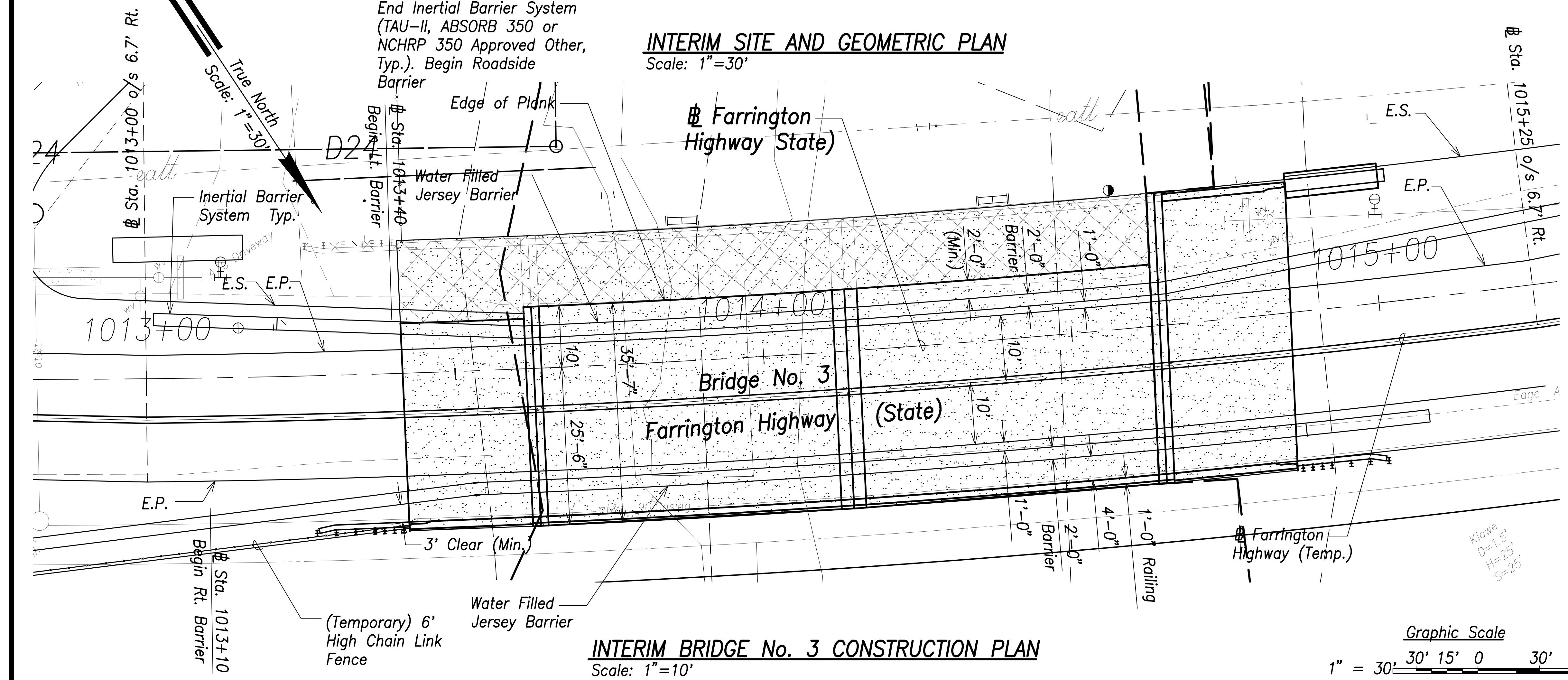

INTERIM BRIDGE No. 3 CONSTRUCTION PLAN
Scale: 1"=10'

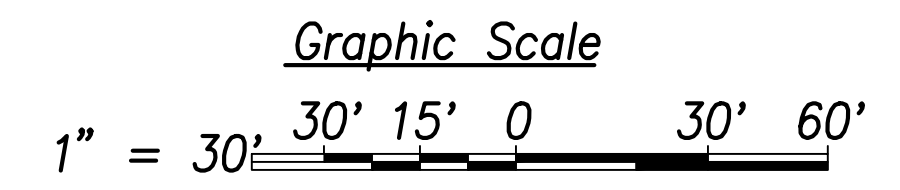

DATE	_____
SURVEY PLOTTED BY	_____
DRAWN BY	_____
TRACED BY	_____
DESIGNED BY	_____
QUANTITIES BY	_____
CHECKED BY	_____
ORIGINAL PLAN	_____
NOTE BOOK	_____
No.	_____

STATE OF HAWAII
DEPARTMENT OF TRANSPORTATION
HIGHWAYS DIVISION

GEOMETRIC PLAN - INTERIM

FARRINGTON HIGHWAY
Replacement of Makaha Bridge
No. 3 and Makaha Bridge 3A
F. A. Project No. BR-093-1(20)
Scale: 1"=30' Date: July 2020

SHEET No. C5.3 OF 168 SHEETS

FED. ROAD DIST. NO.	STATE	FED. AID PROJ. NO.	FISCAL YEAR	SHEET NO.	TOTAL SHEETS
HAWAII	HAW.	BR-093-1(20)	2020	49	168

Broken White Lane Line

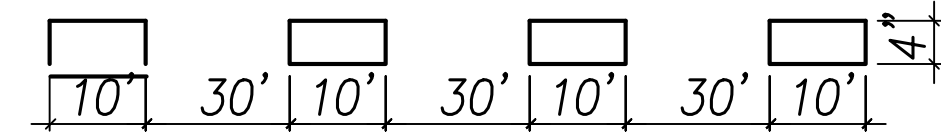

Solid White Edge Line or Lane Line

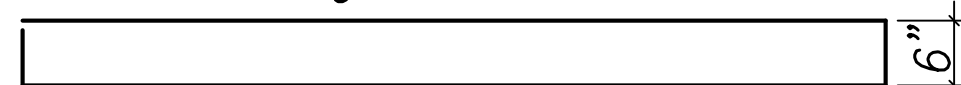

Solid White Channelizing Line

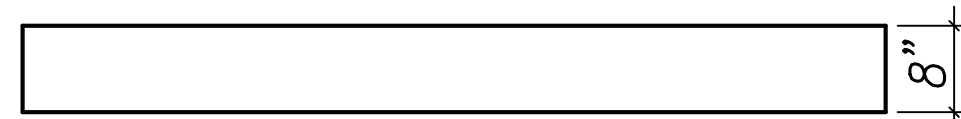

Guide Line (White or Yellow)

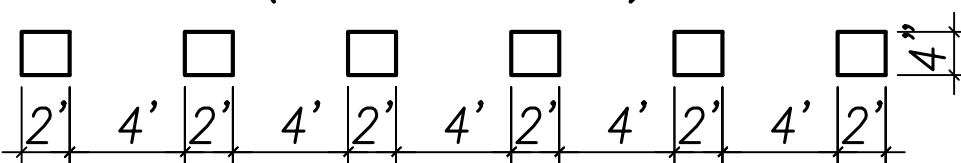

Bike Lane Guide Line (White)

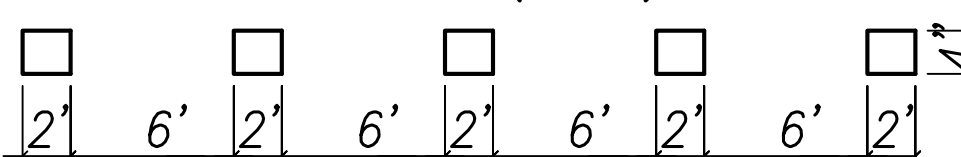

Yellow Edge Line

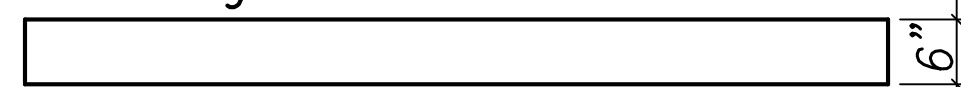

Double Solid (White or Yellow)

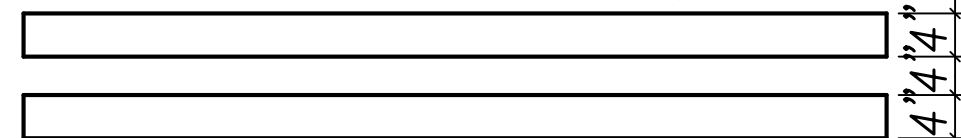

Broken Double Yellow

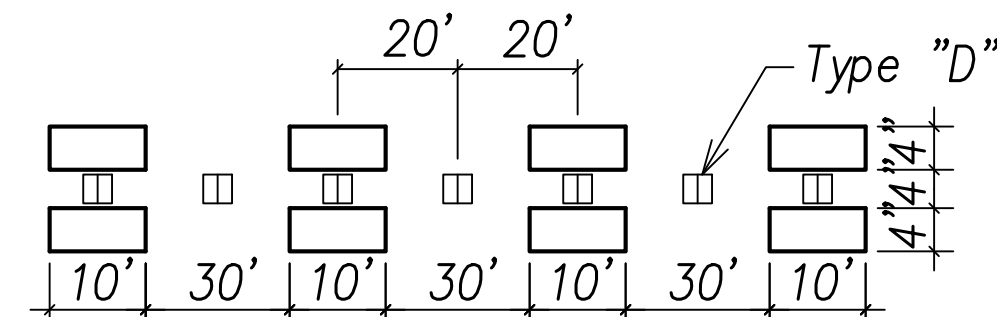

TYPES OF LONGITUDINAL LINES

Not to Scale

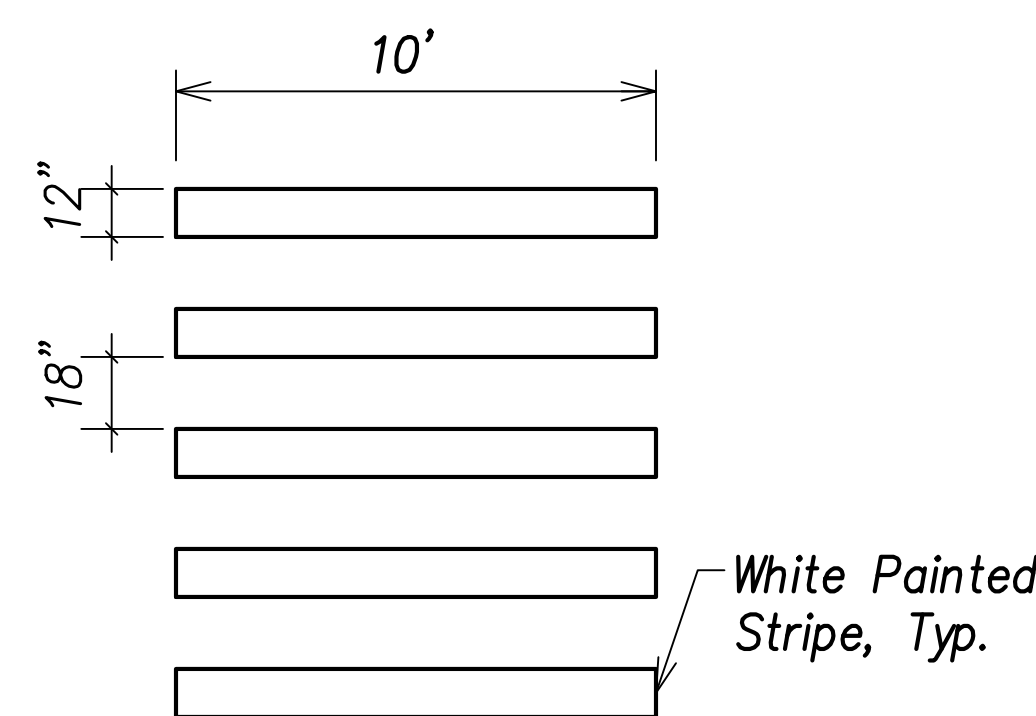

TYPICAL CROSSWALK

Not to Scale

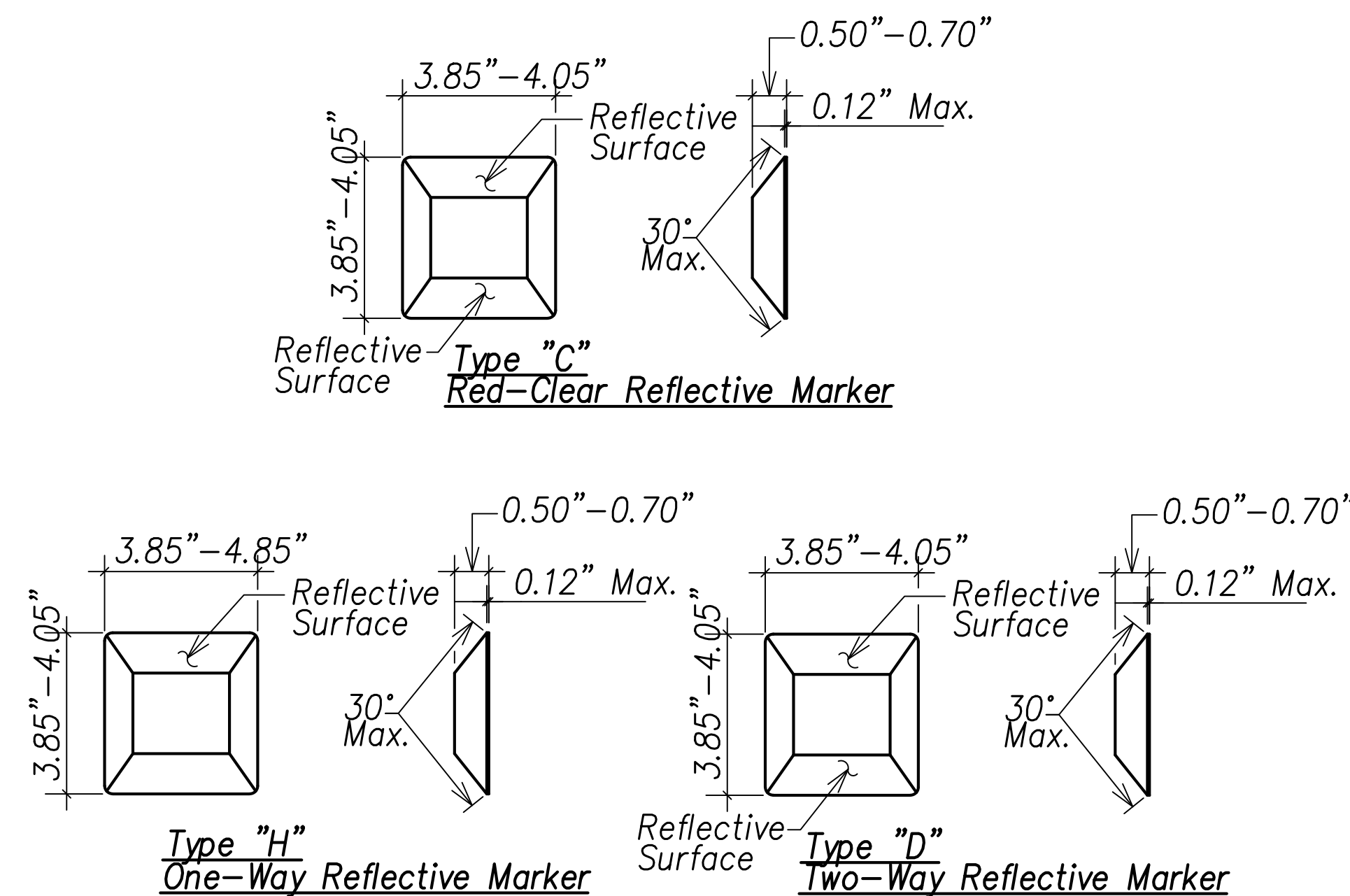

STANDARD RAISED PAVEMENT MARKERS

Not to Scale

Install Street Name Signs

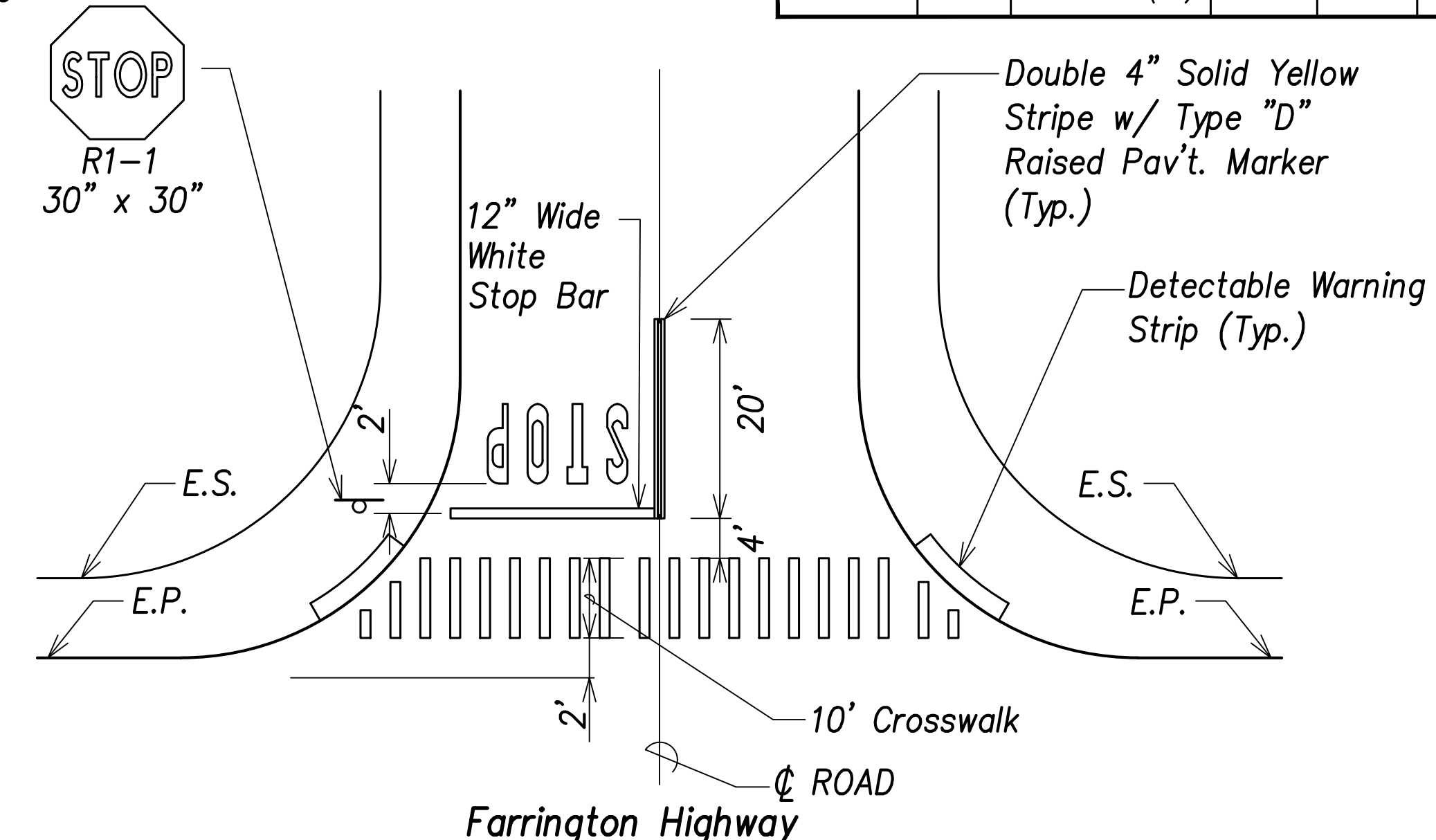

INTERSECTION SIGN AND PAVEMENT MARKINGS

Not To Scale

Note:

See Standard Plan TE-01 to TE-03 for Miscellaneous Sign Details and Sign Post Mounting Details.

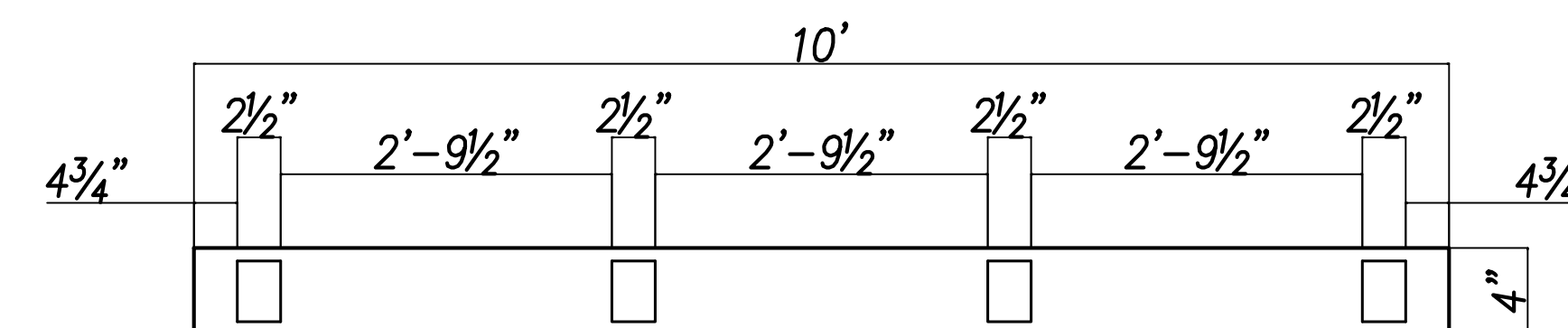

Top View

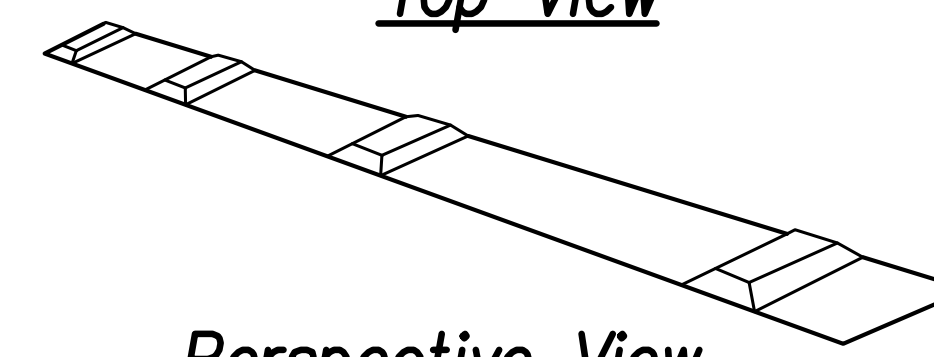

Perspective View

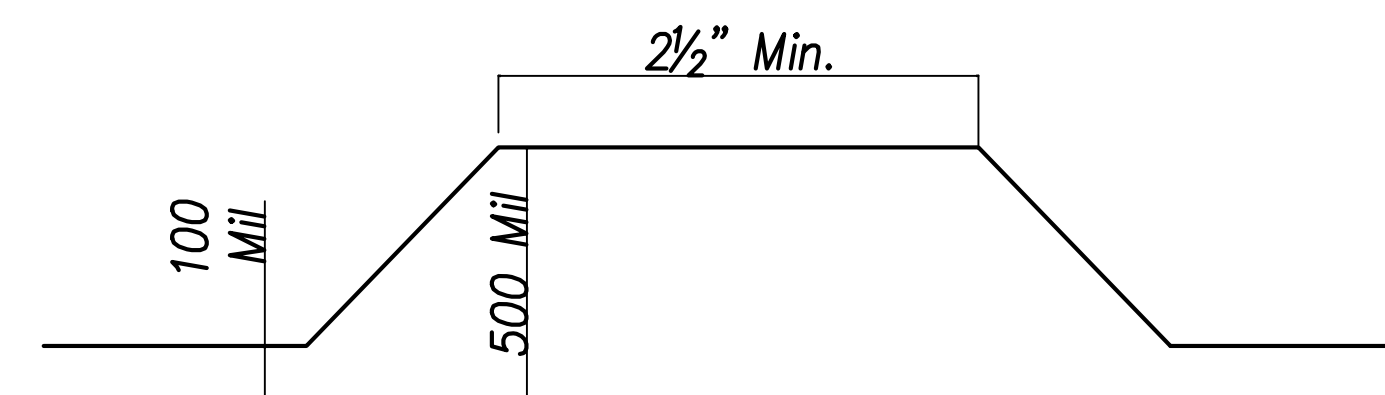

Side View

Note:

- Profiles Shall be Placed on 36" o.c., Shall be 500 mil Height, Including 100 mil Baseline, and Shall Have a Width Equal to Approximately The Baseline Width.

Profiled Thermoplastic Striping

Not to Scale

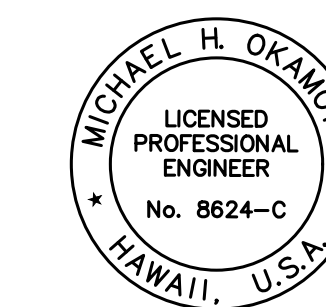

THIS WORK WAS PREPARED BY ME OR UNDER MY SUPERVISION AND CONSTRUCTION OF THIS PROJECT WILL BE UNDER MY OBSERVATION.

Michael H. Okamoto April 30, 2022
SIGNATURE EXPIRATION DATE OF THE LICENSE

STATE OF HAWAII DEPARTMENT OF TRANSPORTATION HIGHWAYS DIVISION

SIGN AND STRIPING DETAILS

FARRINGTON HIGHWAY

Replacement of Makaha Bridge

No. 3 and Makaha Bridge 3A

F. A. Project No. BR-093-1(20)

Scale: As Shown Date: July 2020

SHEET No. C5.5 OF 168 SHEETS

SURVEY PLOTTED BY	DATE
DRAWN BY	
TRACED BY	
DESIGNED BY	
QUANTITIES BY	
CHECKED BY	
ORIGINAL PLAN	
NOTE BOOK	
No.	