

FED. ROAD DIST. NO.	STATE	PROJ. NO.	FISCAL YEAR	SHEET NO.	TOTAL SHEETS
HAWAII	HAW.	93A-01-01 93A-02-01	2004	48	48

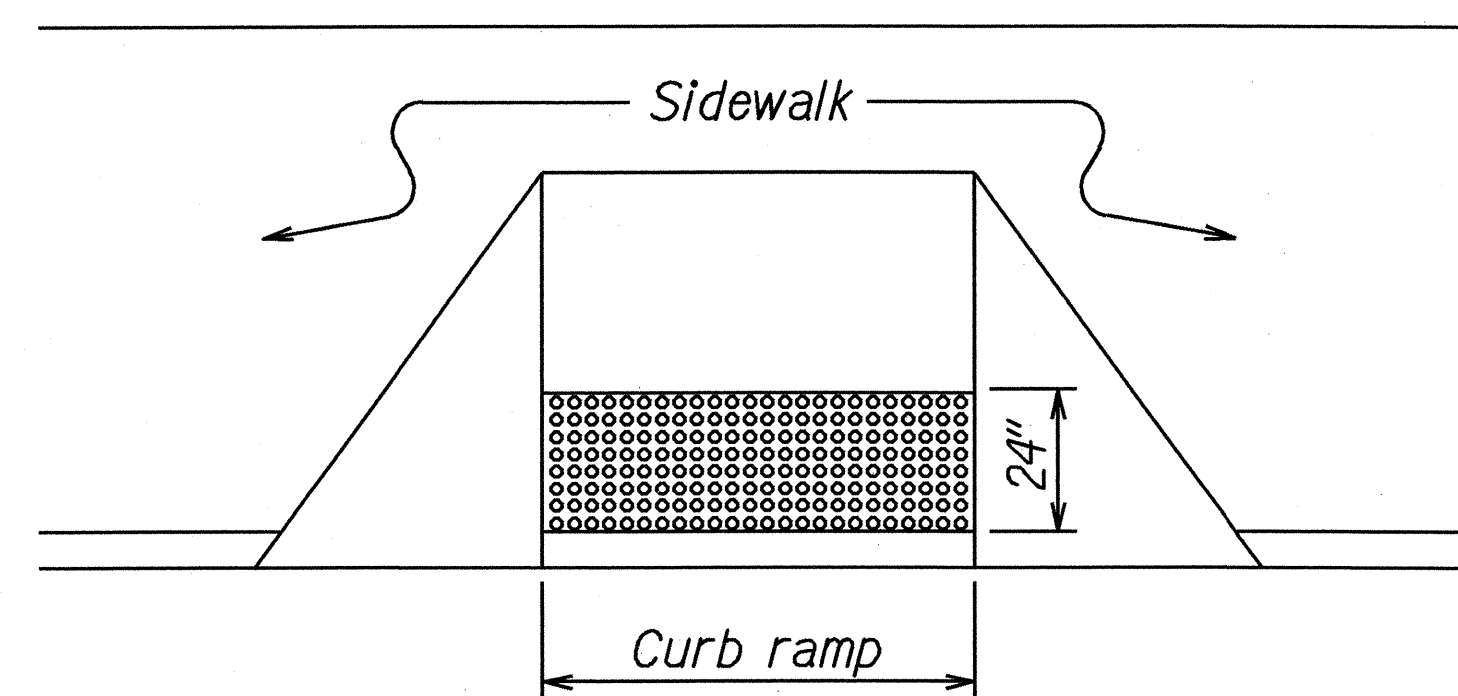

DETECTABLE WARNING AT CURB RAMP

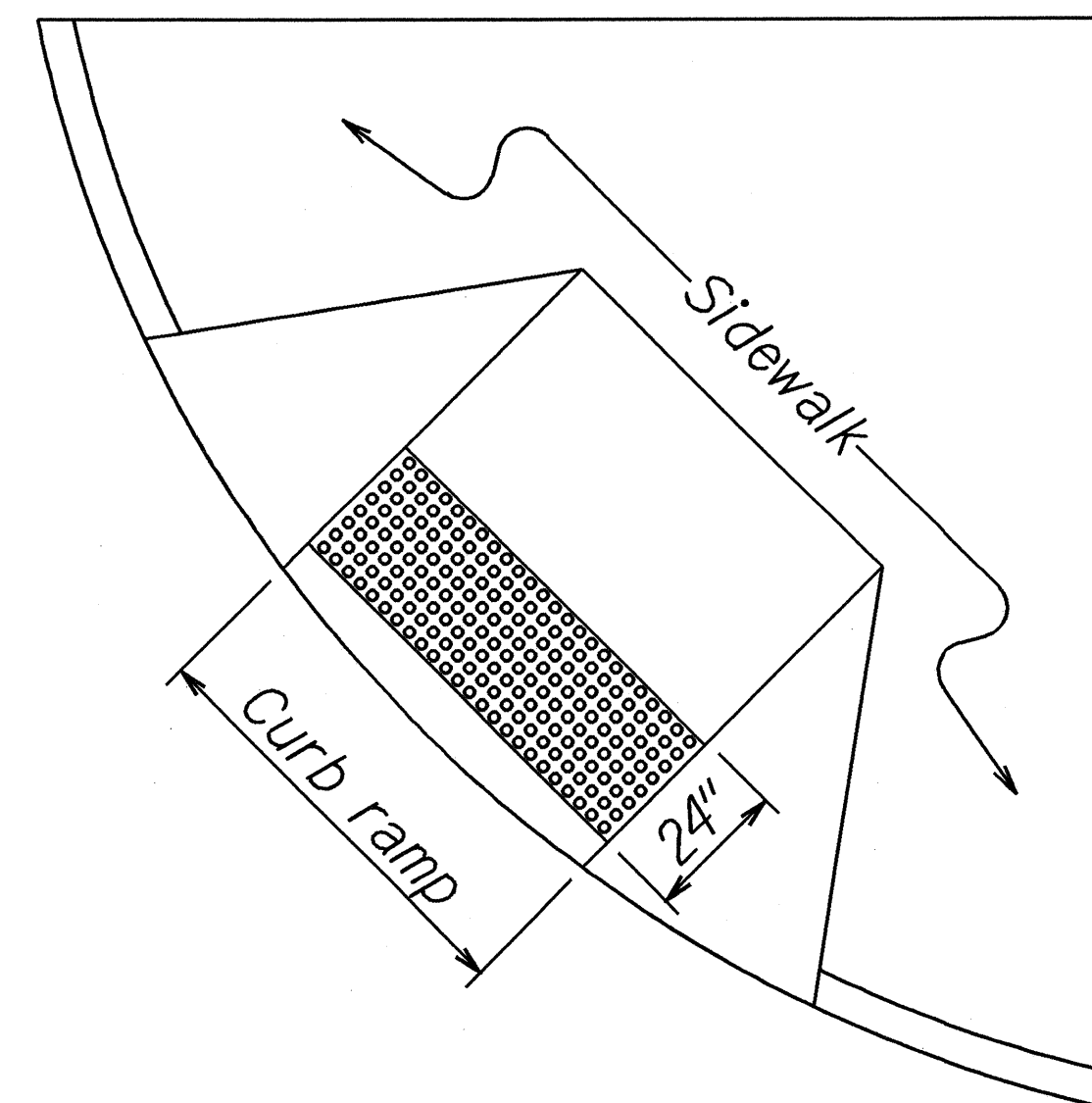

SHARED CURB RAMP WITH
DETECTABLE WARNING

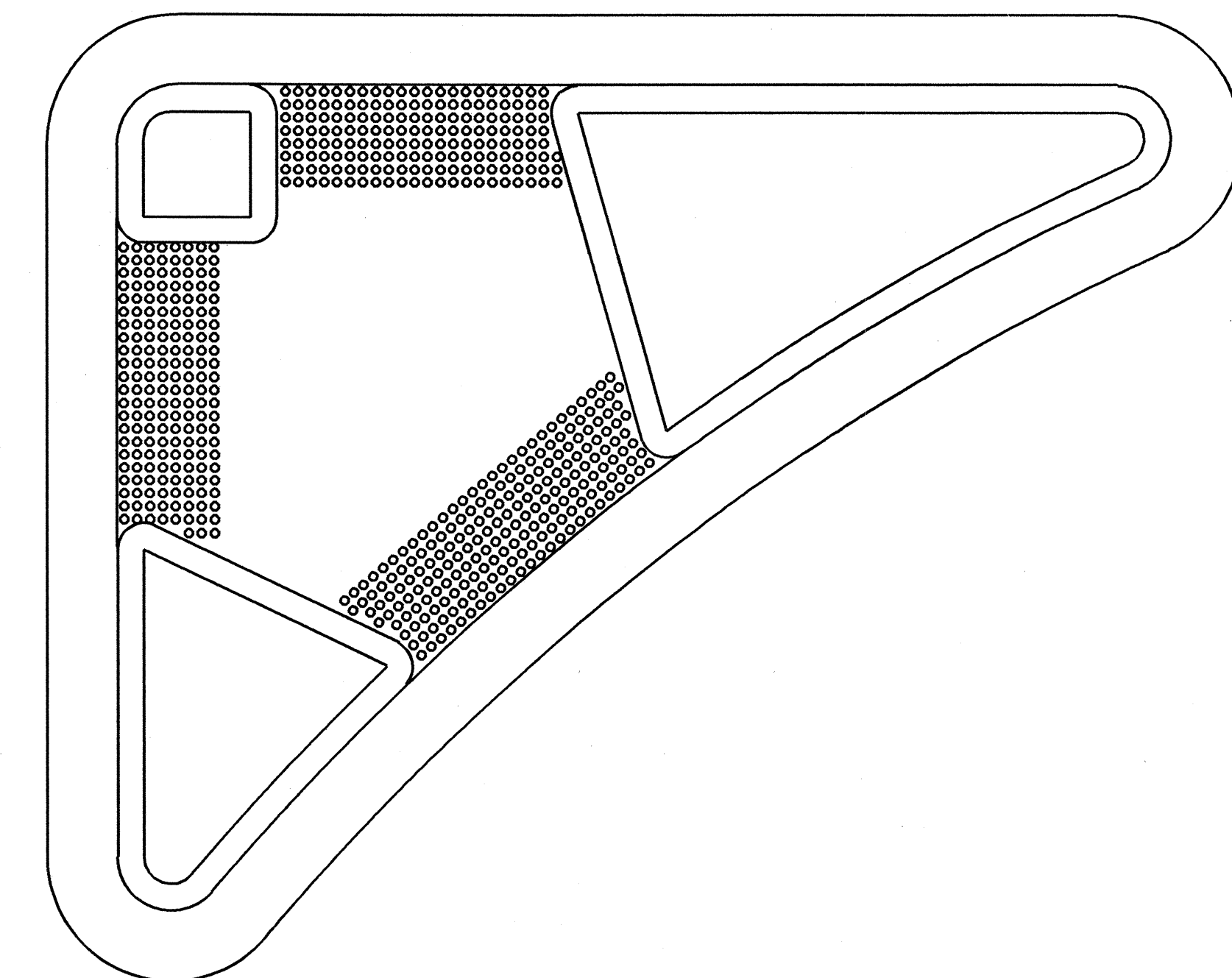

REFUGE ISLAND WITH DETECTABLE WARNING

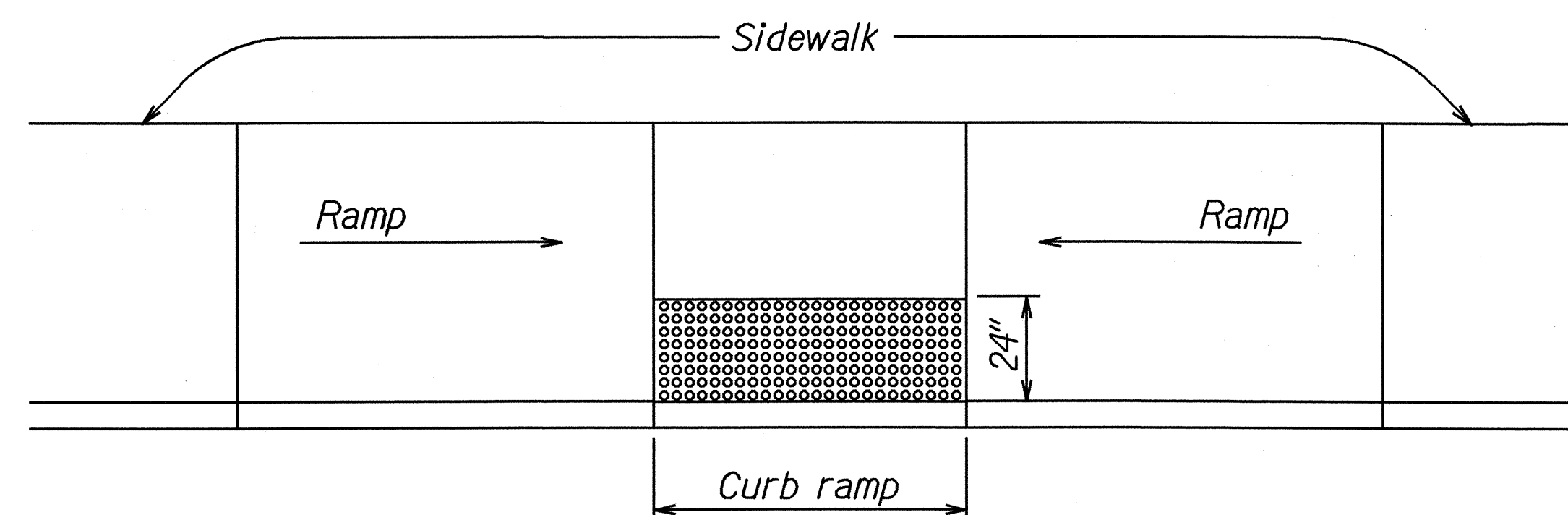

TRANSITION RAMP WITH DETECTABLE WARNING

TYPICAL INSTALLATION OF DETECTABLE WARNINGS

Not to Scale

NOTES:

1. Detectable warnings shall be 24 inches in the direction of travel and extend the full width of the curb ramp or flush surface (does not include flares).
2. Truncated domes shall have a diameter of 0.9 inch at the bottom, a diameter of 0.4 inch at the top, a height of 0.2 inch and a center-to-center spacing of 2.35 inches measured along one side of a square arrangement.
3. Domes shall be aligned on a square grid in the predominant direction of travel to permit wheels to roll between the domes.
4. There shall be a minimum of 70 percent contrast in light reflectance between the detectable warning and an adjoining surface, or the detectable warning shall be "safety yellow".
5. The material used to provide visual contrast shall be an integral part of the detectable warning surface.
6. The detectable warning shall be located so that the edge nearest the curb line or other potential hazard is 6 to 8 inches from the curb line or other potential hazard, such as a reflecting pool edge or the edge of a transit platform.

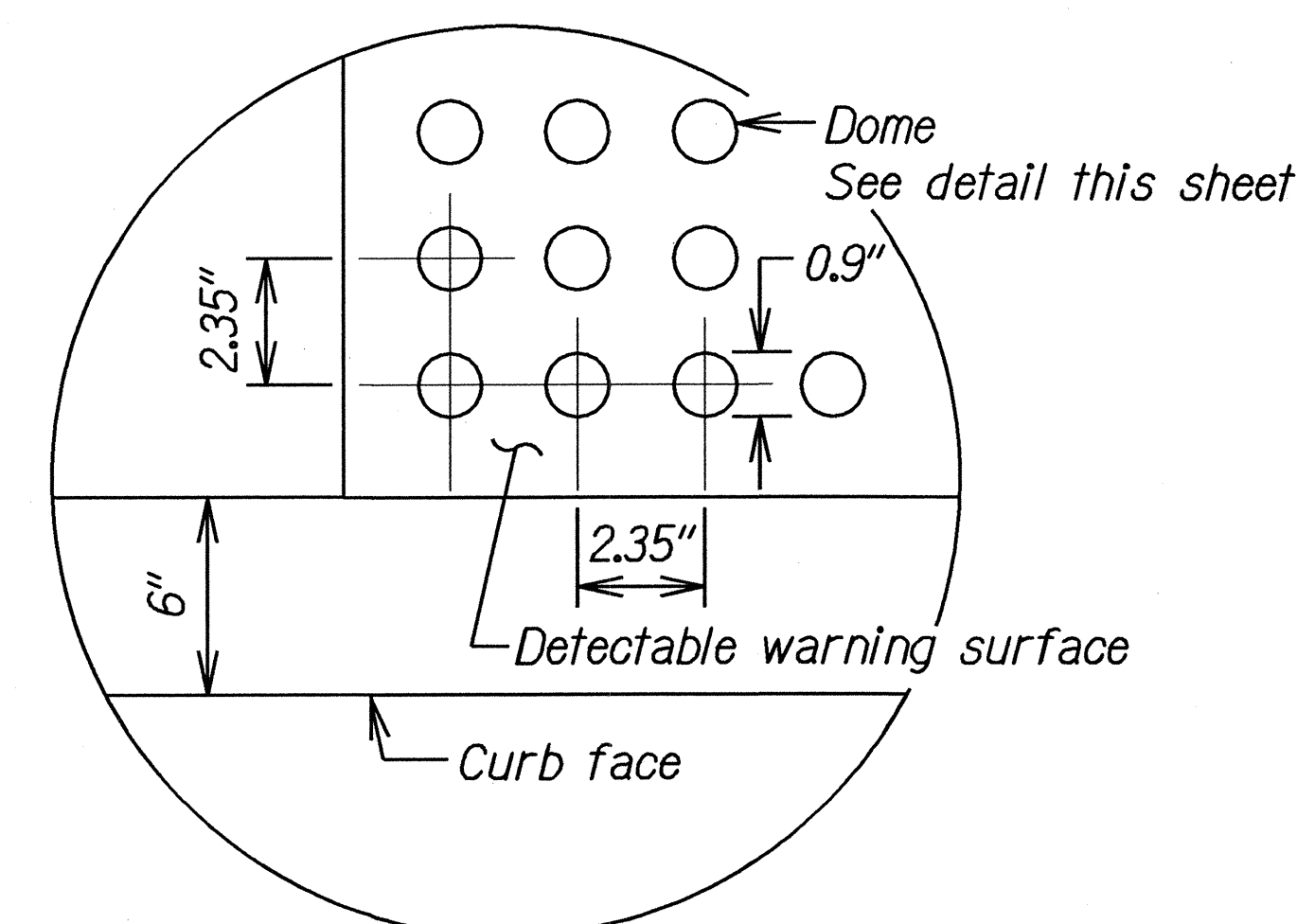

ENLARGEMENT

DETECTABLE WARNING DETAIL

Not to Scale

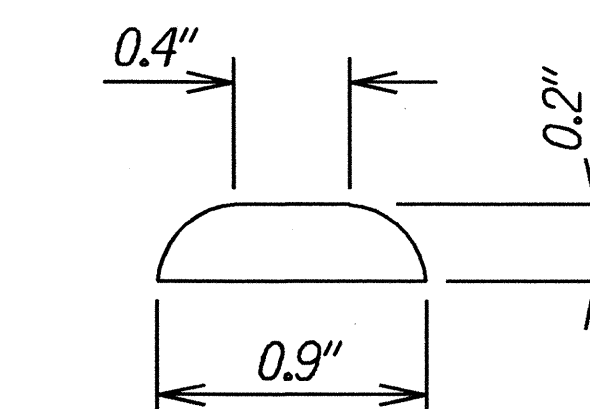

DOME SECTION

STATE OF HAWAII DEPARTMENT OF TRANSPORTATION HIGHWAYS DIVISION	
<u>DETECTABLE WARNING DETAILS</u>	
FARRINGTON HIGHWAY DRAINAGE IMPROVEMENTS Vicinity of Nanakuli Avenue to Nanakuli Stream and Vicinity of Lualei Place to Princess Kahanu Avenue Project Nos. 93A-01-01 & 93A-02-01	
Not to Scale	Date: August, 2002
SHEET No. 1 OF 1 SHEETS	

ORIGINAL PLAN	SURVEY PLOTTED BY	DATE
NOTE BOOK	DRAWN BY	
TO/ASON	DESIGNED BY	
NO. CHECKED BY	QUANTITIES BY	