

FED. ROAD DIST. NO.	STATE	FED. AID PROJ. NO.	FISCAL YEAR	SHEET NO.	TOTAL SHEETS
HAWAII	HAW.	STP-093-1(18)	2003	14	98

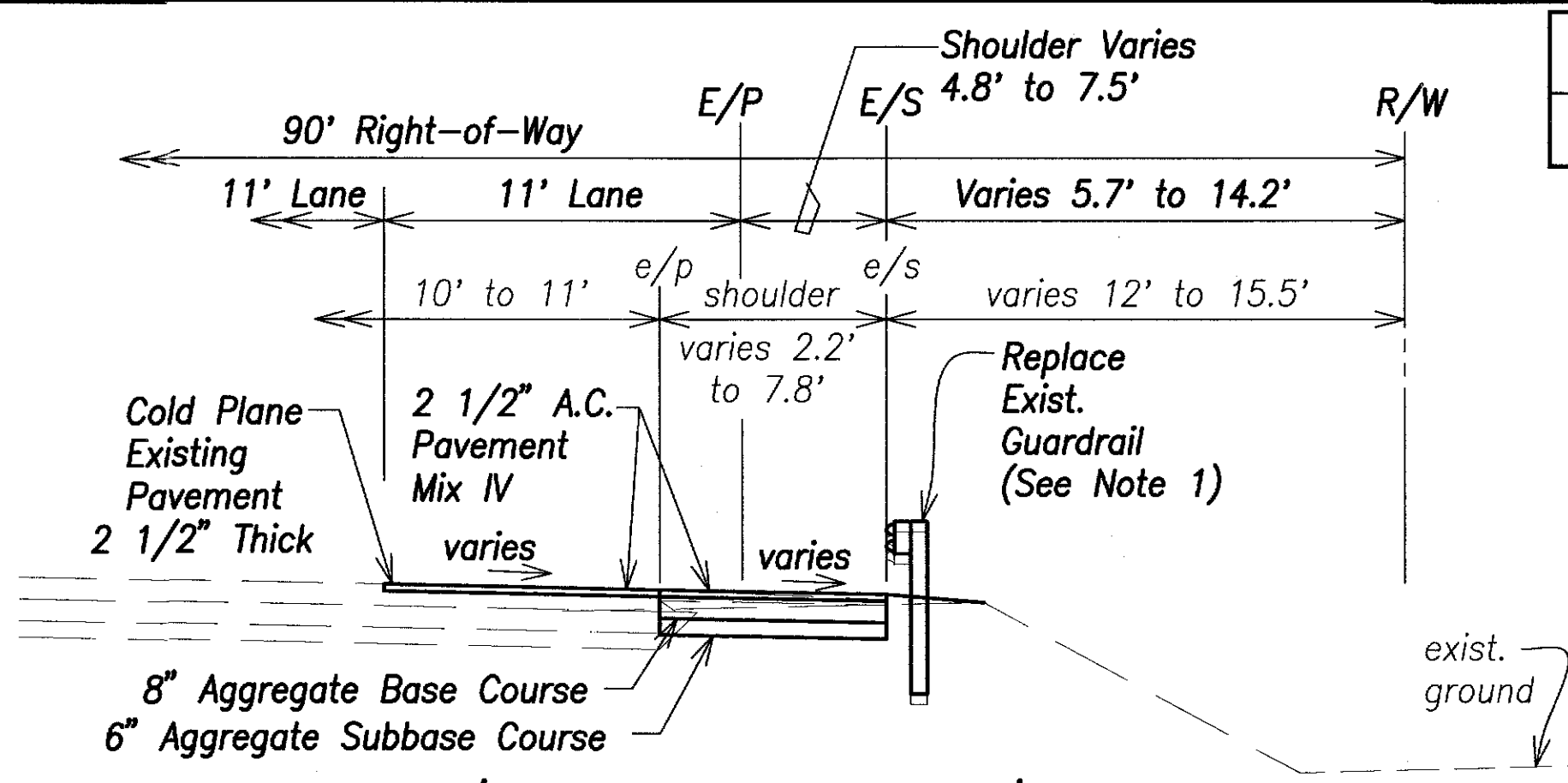
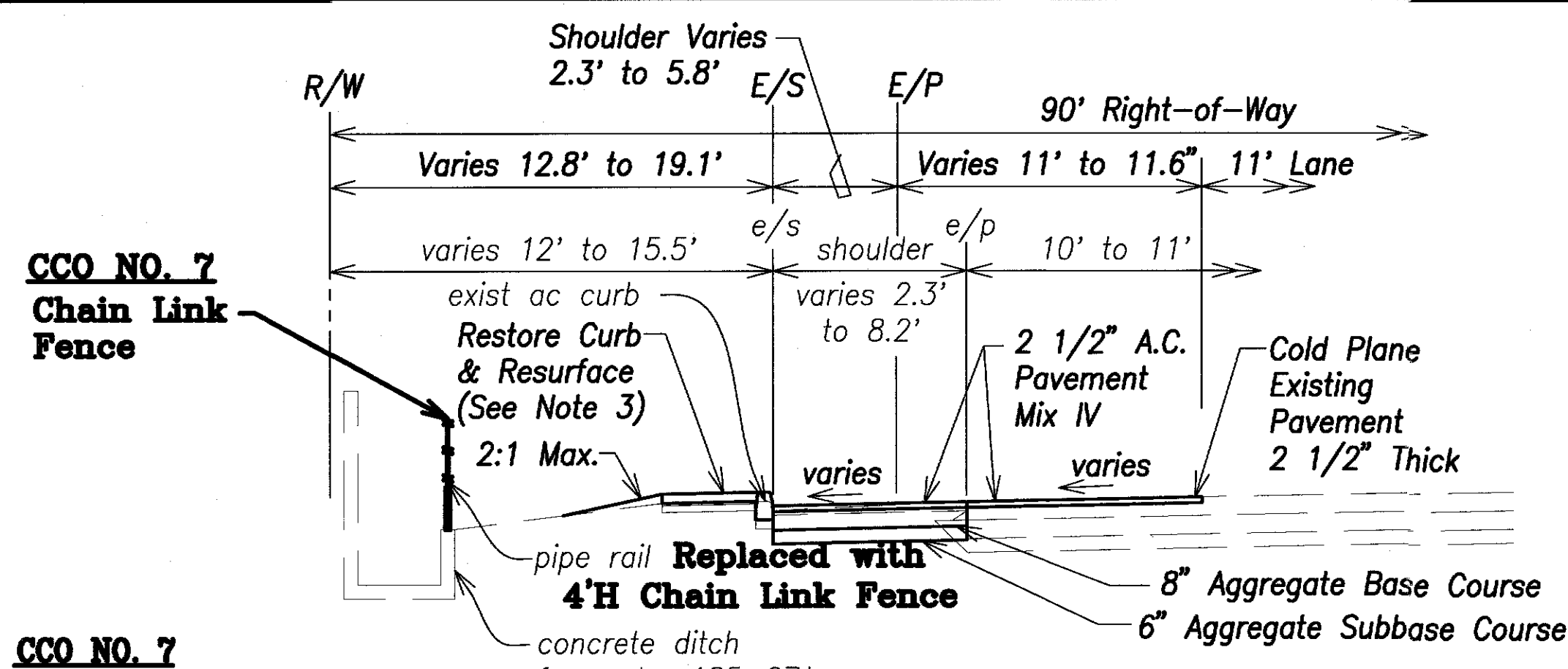

CCO NO. 7
Chain Link Fence
Restore Curb & Resurface (See Note 3)
2:1 Max.
pipe rail
concrete ditch from sta. 185+07±

Farrington # STA. 184+00 TO # STA. 185+99
Scale: 1" = 5'

Farrington # STA. 182+80 TO # STA. 185+99
Scale: 1" = 5'

Sta. 184+00 to Sta. 193+00
Raise Existing Drainage Wall 6" to 12". Remove Existing Railing and Replace with 4' High Chain Link Fence. (See Details A, B, C in Plan Sheet C098 S-1)

CCO NO. 7
Chain Link Fence
pipe rail to be Replaced with 4'H Chain Link Fence
concrete ditch
a.c. footpath 1" a.c. mix. no. V 3" untreated base

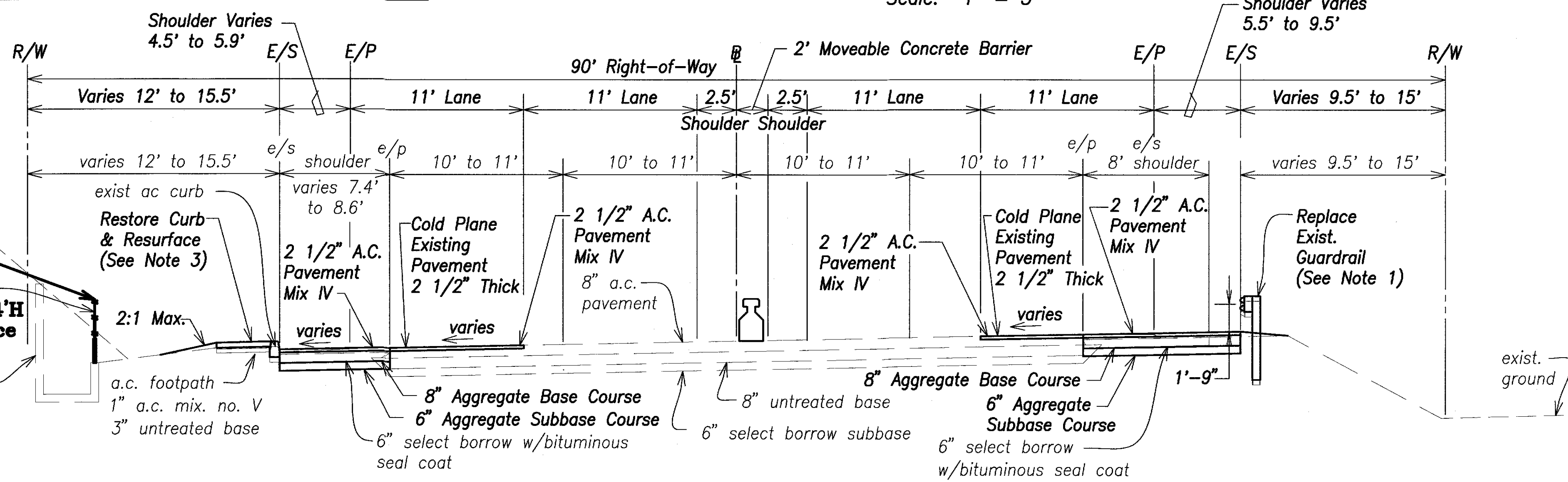

TYPICAL SECTION - Farrington # STA. 185+99 TO # STA. 202+92.23
Scale: 1" = 5'

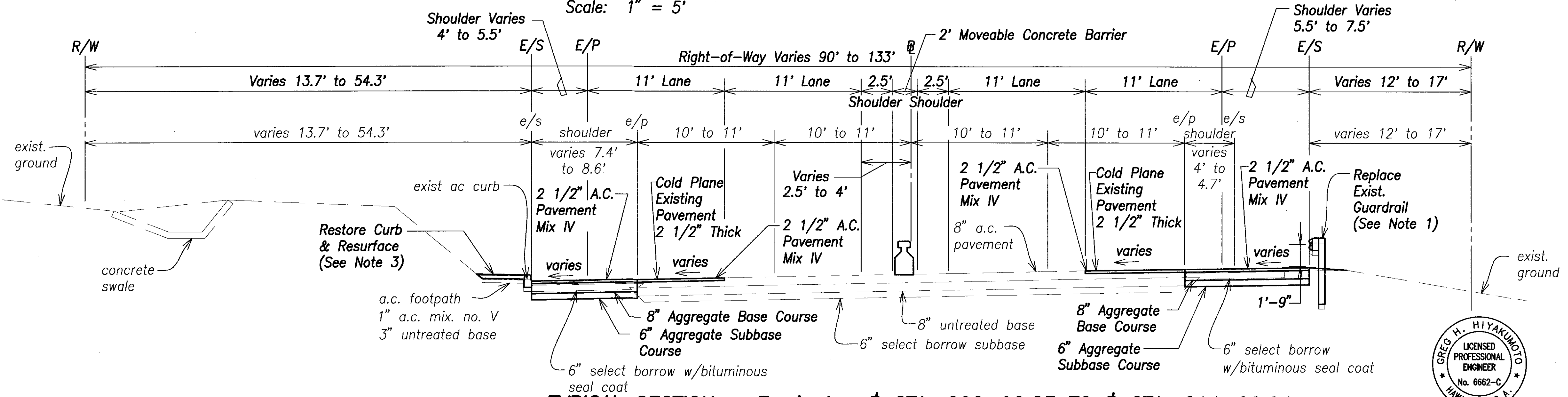

TYPICAL SECTION - Farrington # STA. 202+92.23 TO # STA. 214+02.04
Scale: 1" = 5'

- Notes:**
- Adjust New Guardrails to Maintain a Height of 1'-9" for all Locations.
 - Maximum cross-slope within the shoulder shall be 4.5%.
 - Restore curb & resurface exist A.C. footpath. Refer to "Shoulder Reconstruction Plan" sheets.
 - Grass covering shall be established on all graded areas.

LEGEND FOR AS-BUILT POSTINGS

	Squiggly line for as-built deletion
	Double line for as-built deletion
	Text for as-built posting

DATE
SURVEY PLOTTED BY
DRAWN BY
DESIGNED BY
QUANTITIES BY
CHECKED BY
ORIGINAL PLAN
NOTE BOOK
No.

GREG H. HIYAKIMOTO
LICENSED PROFESSIONAL ENGINEER
No. 6662-C
HAWAII, U.S.A.

THIS WORK WAS PREPARED BY ME OR UNDER MY SUPERVISION.

Signature: [Signature]
April 30, 2006
EXPIRATION DATE OF THE LICENSE

STATE OF HAWAII
DEPARTMENT OF TRANSPORTATION
HIGHWAYS DIVISION

MAIL POINT MEDIAN BARRIER
TYPICAL SECTIONS - 1
FARRINGTON HIGHWAY SAFETY IMPROVEMENTS
NANAKULI TO MAKAHA
F.A.I. Proj. No. STP-093-1(18)

Scale: 1" = 5' Date: 04/23/03

FED. ROAD DIST. NO.	STATE	FED. AID PROJ. NO.	FISCAL YEAR	SHEET NO.	TOTAL SHEETS
HAWAII	HAW.	STP-093-1(18)	2003	15	98

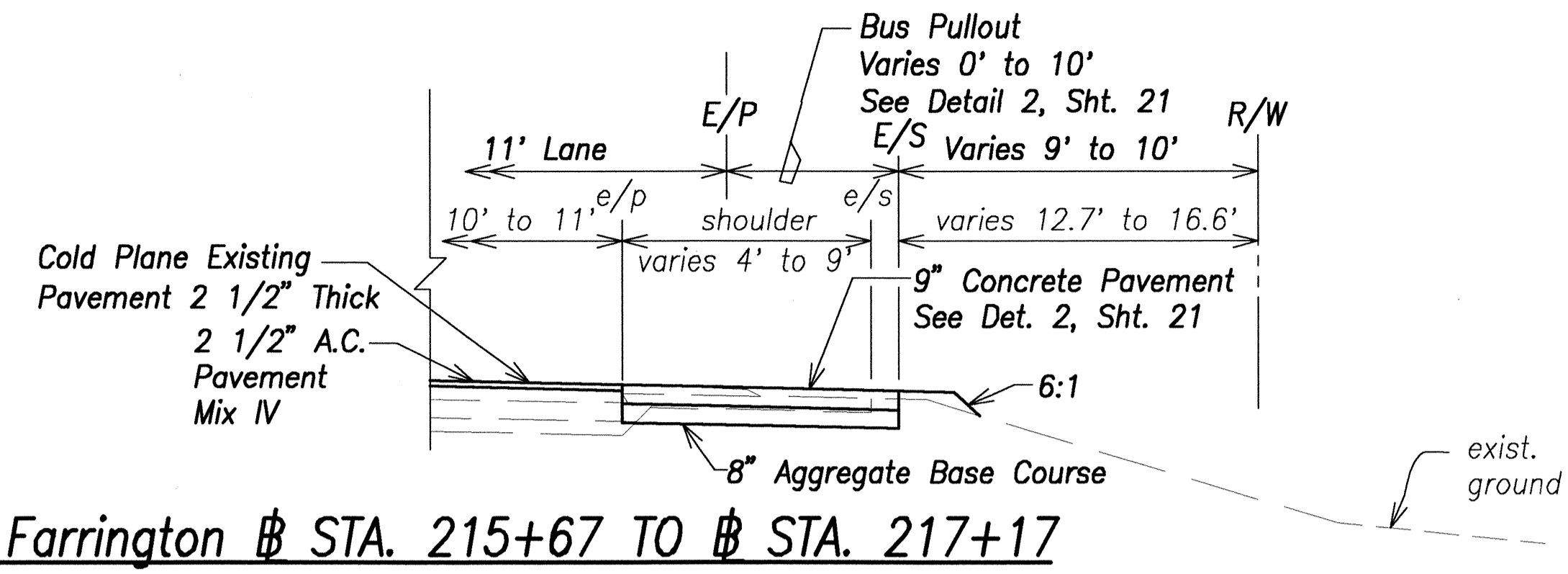

Farrington STA. 215+67 TO STA. 217+17

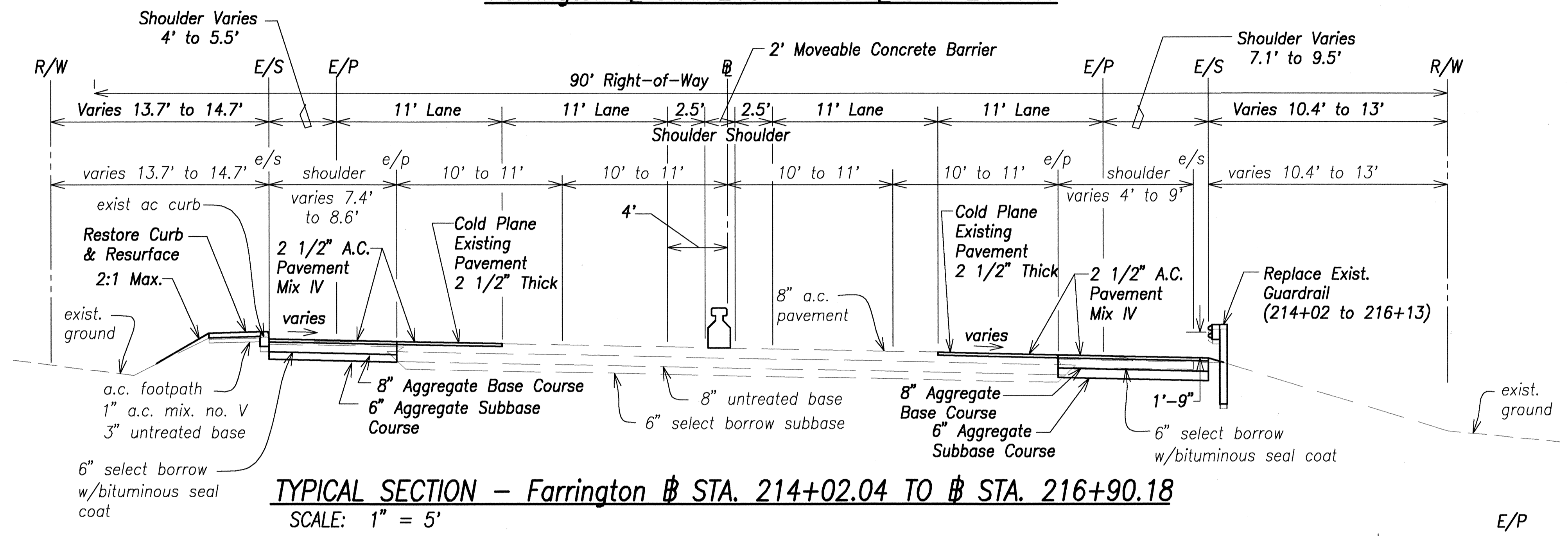

TYPICAL SECTION - Farrington STA. 214+02.04 TO STA. 216+90.18
SCALE: 1" = 5'

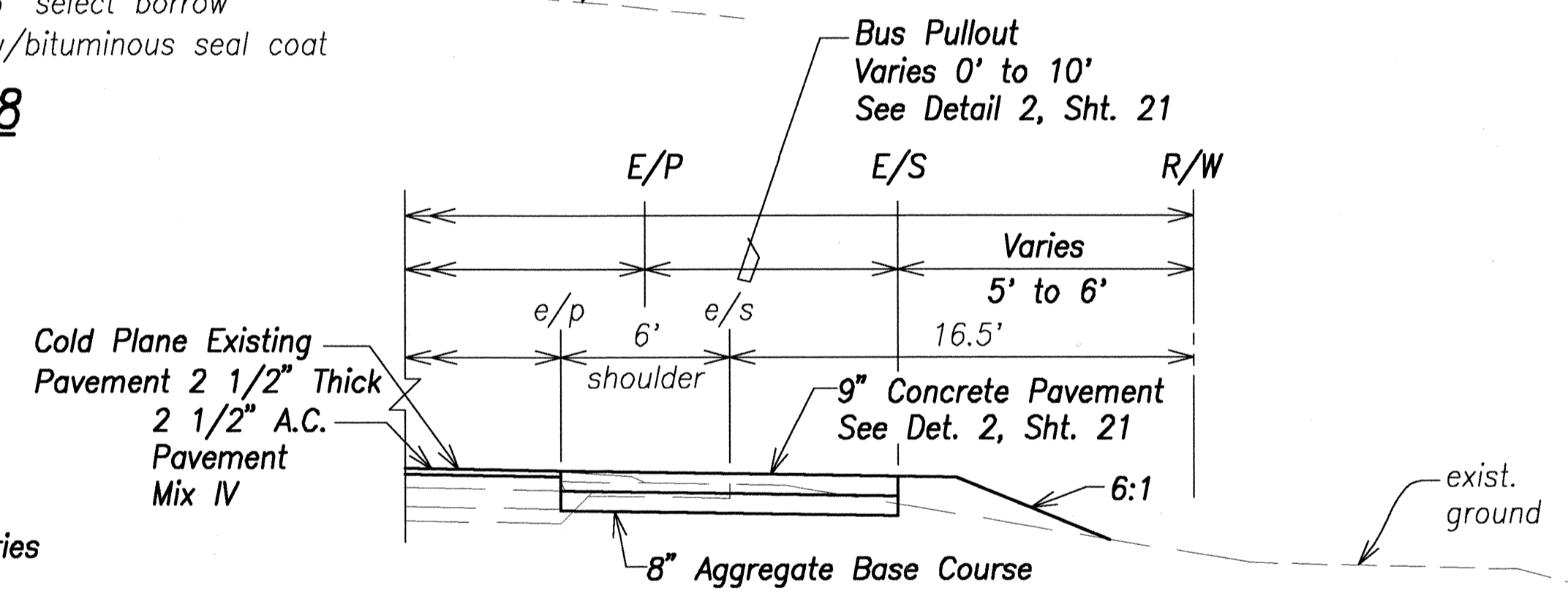

Farrington STA. 221+35 TO STA. 222+85

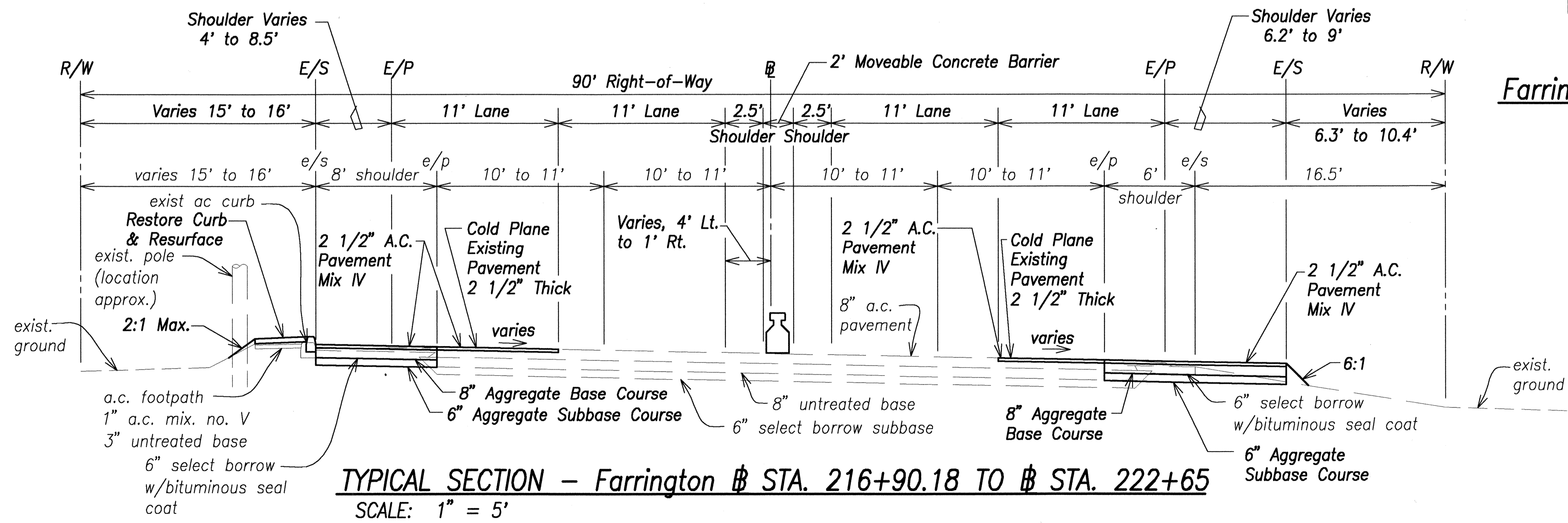

TYPICAL SECTION - Farrington STA. 216+90.18 TO STA. 222+65
SCALE: 1" = 5'

Note:
Refer to notes on Median Barrier Typical Sections - 1

SURVEY PLOTTED BY	DATE
DRAWN BY	
DESIGNED BY	
QUANTITIES BY	
CHECKED BY	
ORIGINAL PLAN	
NOTE BOOK	
No.	



THIS WORK WAS PREPARED BY ME OR UNDER MY SUPERVISION.

SIGNATURE: [Signature] April 30, 2004
EXPIRATION DATE OF THE LICENSE

STATE OF HAWAII
DEPARTMENT OF TRANSPORTATION
HIGHWAYS DIVISION

**MAIL POINT MEDIAN BARRIER
TYPICAL SECTIONS - 2**

FARRINGTON HIGHWAY SAFETY IMPROVEMENTS
NANAKULI TO MAKAHA
F.A.I. Proj. No. STP-093-1(18)

Scale: 1" = 5' Date: 04/23/03

SHEET No. 15 OF 98 SHEETS

FED. ROAD DIST. NO.	STATE	FED. AID PROJ. NO.	FISCAL YEAR	SHEET NO.	TOTAL SHEETS
HAWAII	HAW.	STP-093-1(18)	2003	16	98

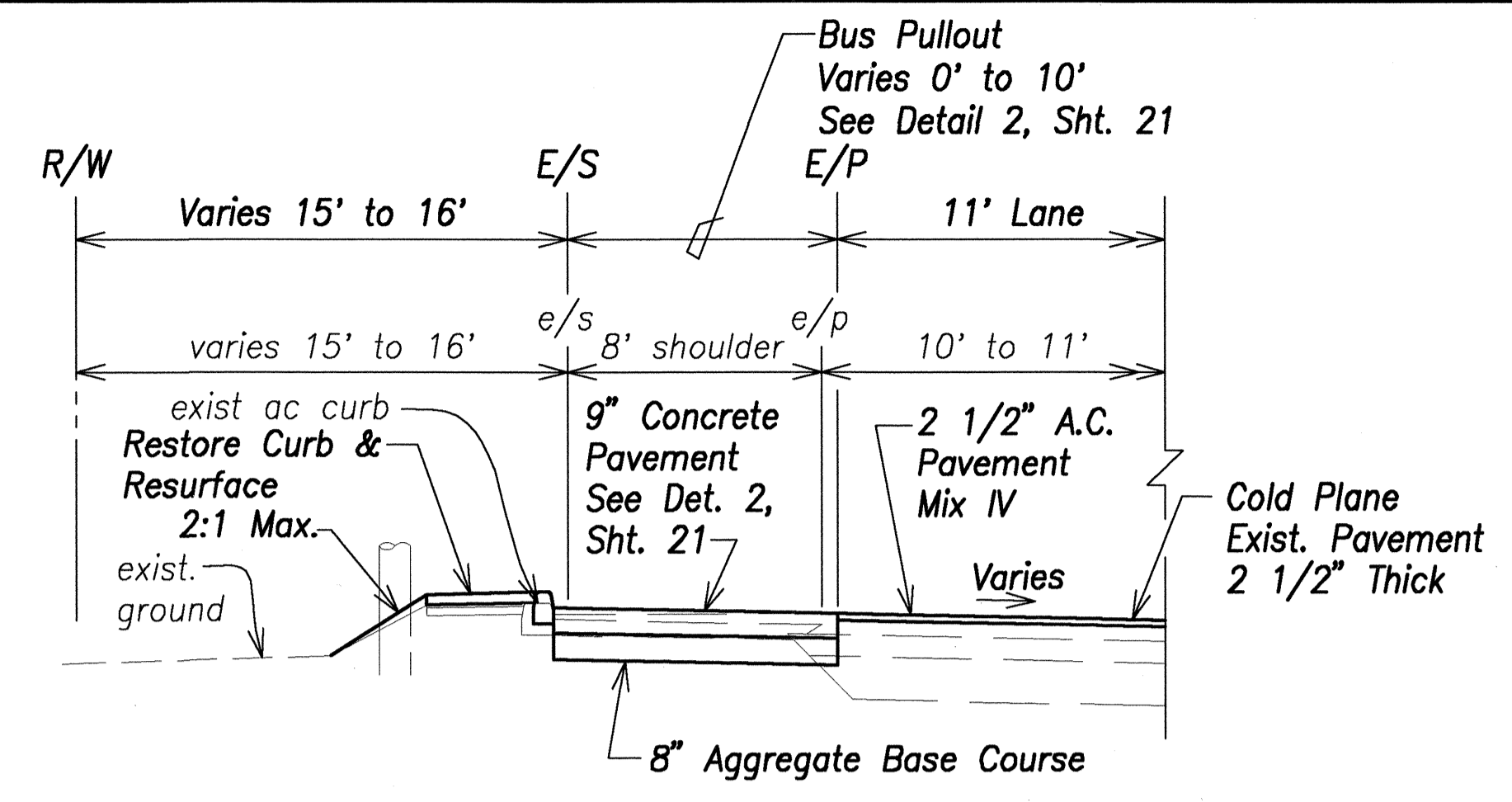

Farrington # STA. 222+95 TO # STA. 224+45

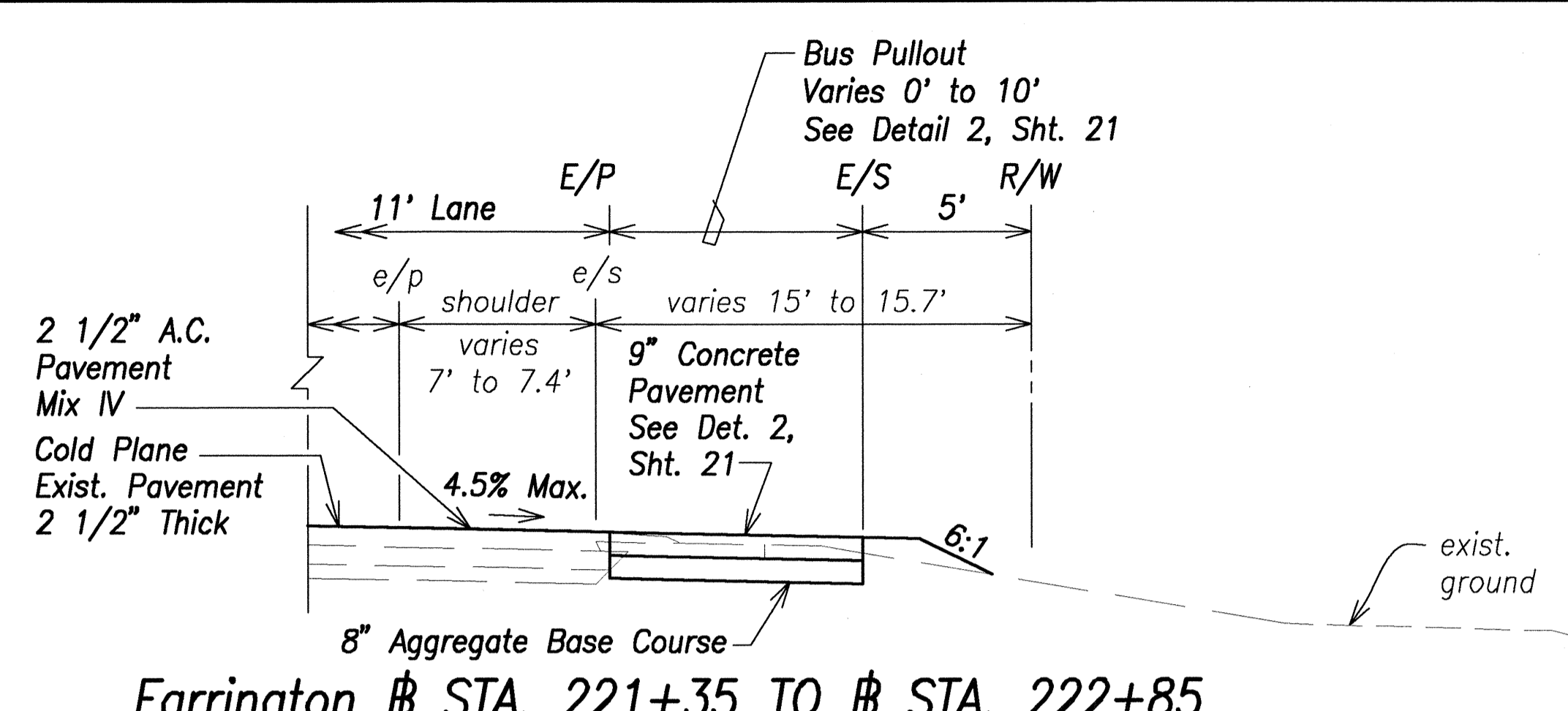

Farrington # STA. 221+35 TO # STA. 222+85

Note:
Refer to notes on Median Barrier
Typical Sections - 1

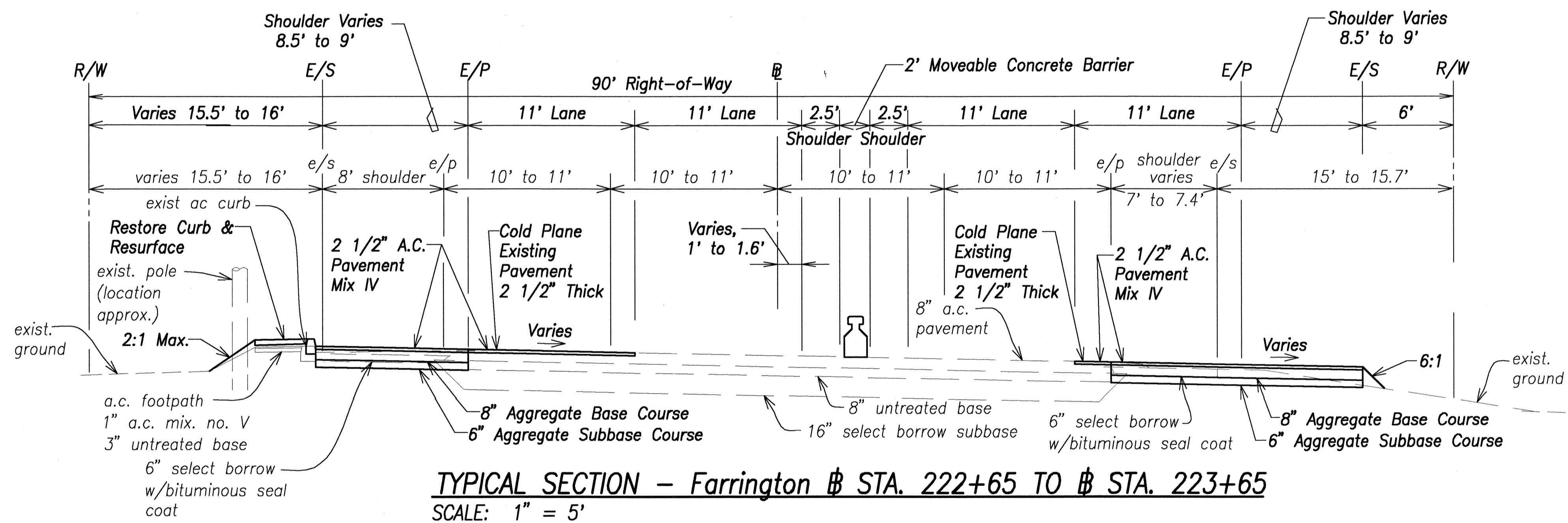

TYPICAL SECTION - Farrington # STA. 222+65 TO # STA. 223+65
SCALE: 1" = 5'

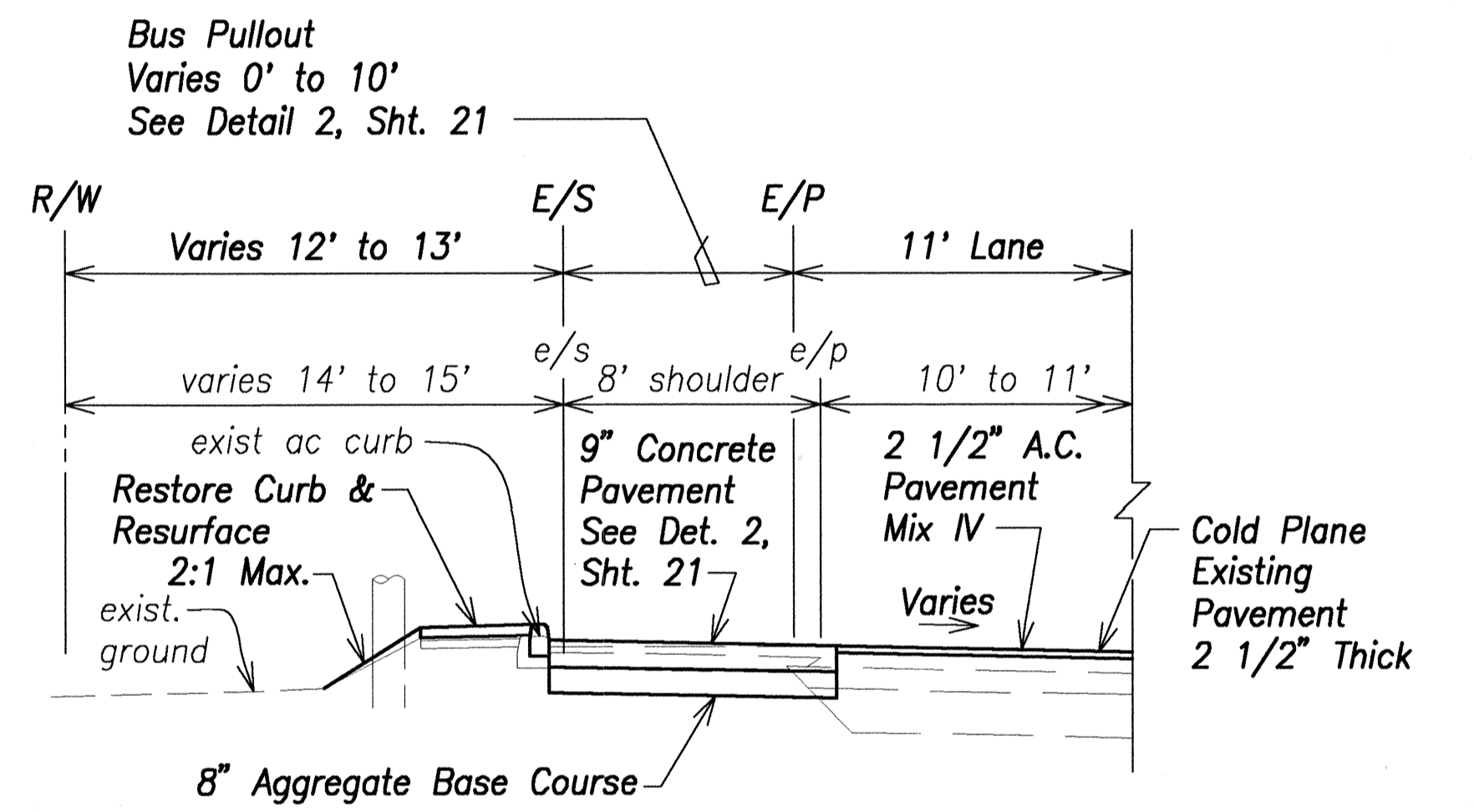

Farrington # STA. 230+06 TO # STA. 231+56

Note:
Adjust Guardrail to
Maintain a Height
of 1'-9", Typ. for
all Locations.

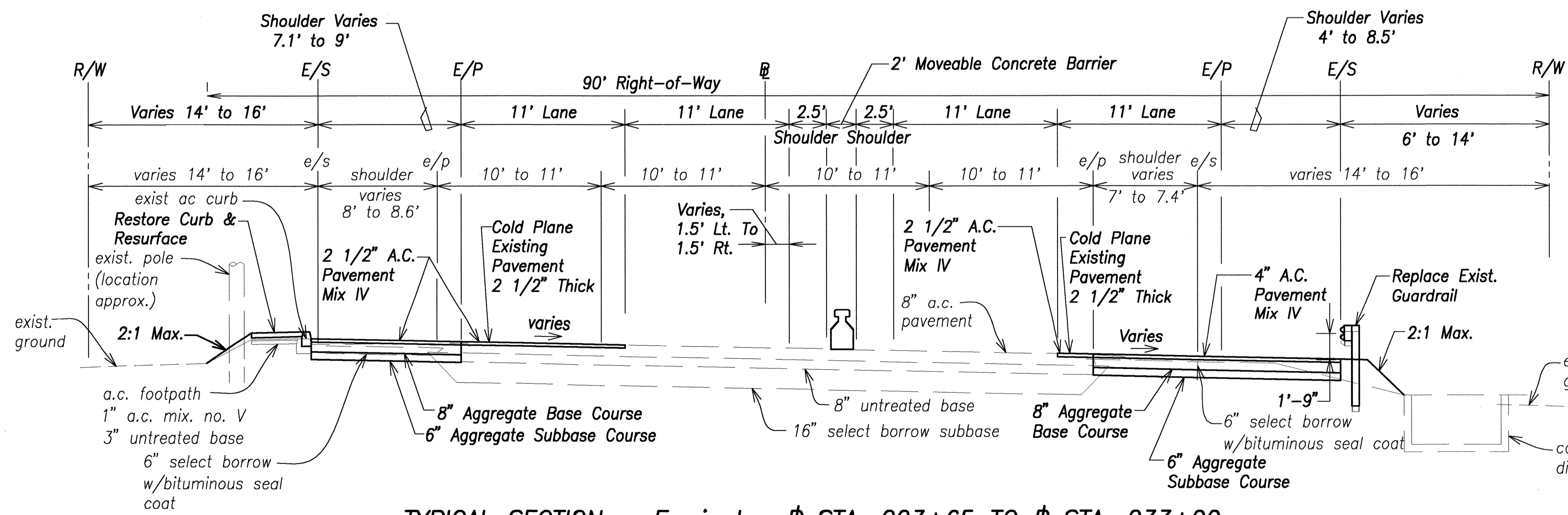

TYPICAL SECTION - Farrington # STA. 223+65 TO # STA. 233+00
SCALE: 1" = 5'

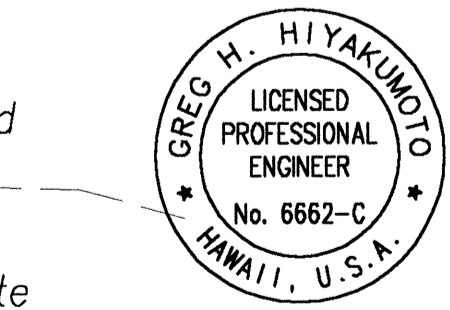

THIS WORK WAS PREPARED BY ME
OR UNDER MY SUPERVISION.

STATE OF HAWAII
DEPARTMENT OF TRANSPORTATION
HIGHWAYS DIVISION

MAIL POINT MEDIAN BARRIER
TYPICAL SECTIONS - 3

FARRINGTON HIGHWAY SAFETY IMPROVEMENTS
NANAKULI TO MAKAHA
F.A.I. Proj. No. STP-093-1(18)

Scale: 1" = 5' Date: 04/23/03

SHEET No. 16 OF 98 SHEETS

SURVEY PLOTTED BY	DATE
DRAWN BY	
DESIGNED BY	
QUANTITIES BY	
CHECKED BY	
ORIGINAL PLAN	
NOTE BOOK	
No.	

FED. ROAD DIST. NO.	STATE	FED. AID PROJ. NO.	FISCAL YEAR	SHEET NO.	TOTAL SHEETS
HAWAII	HAW.	STP-093-1(18)	2003	17	98

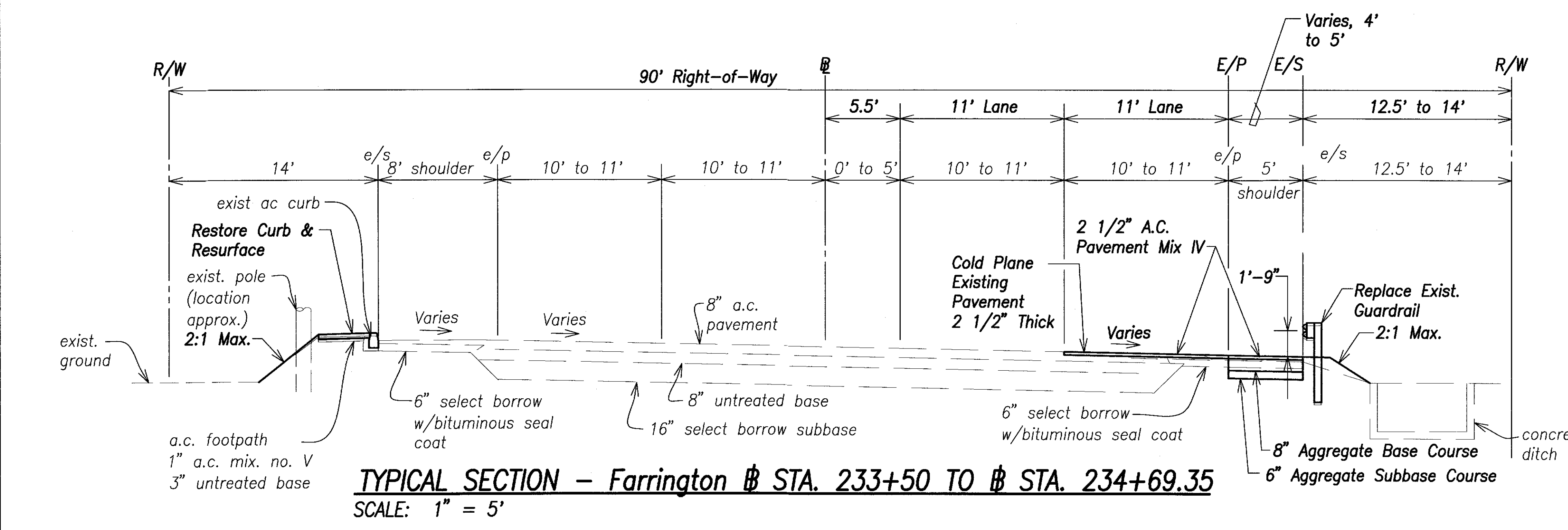
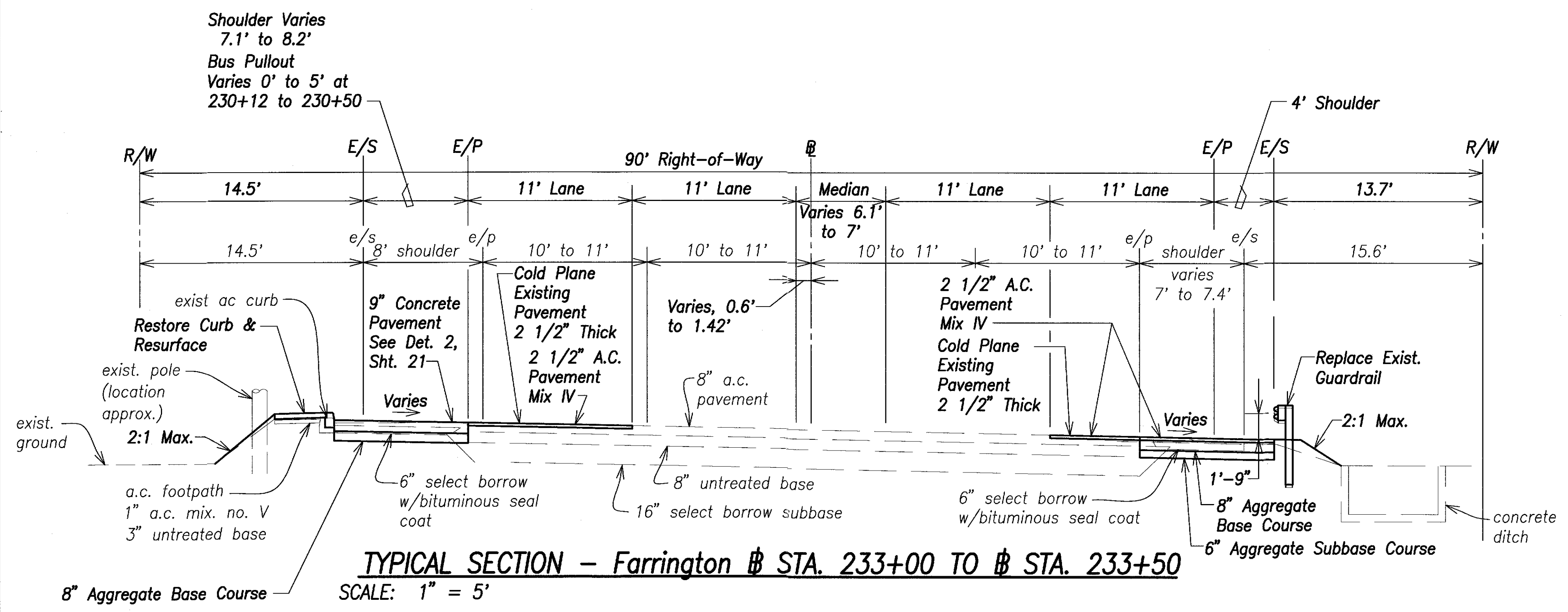

CCO NO. 5

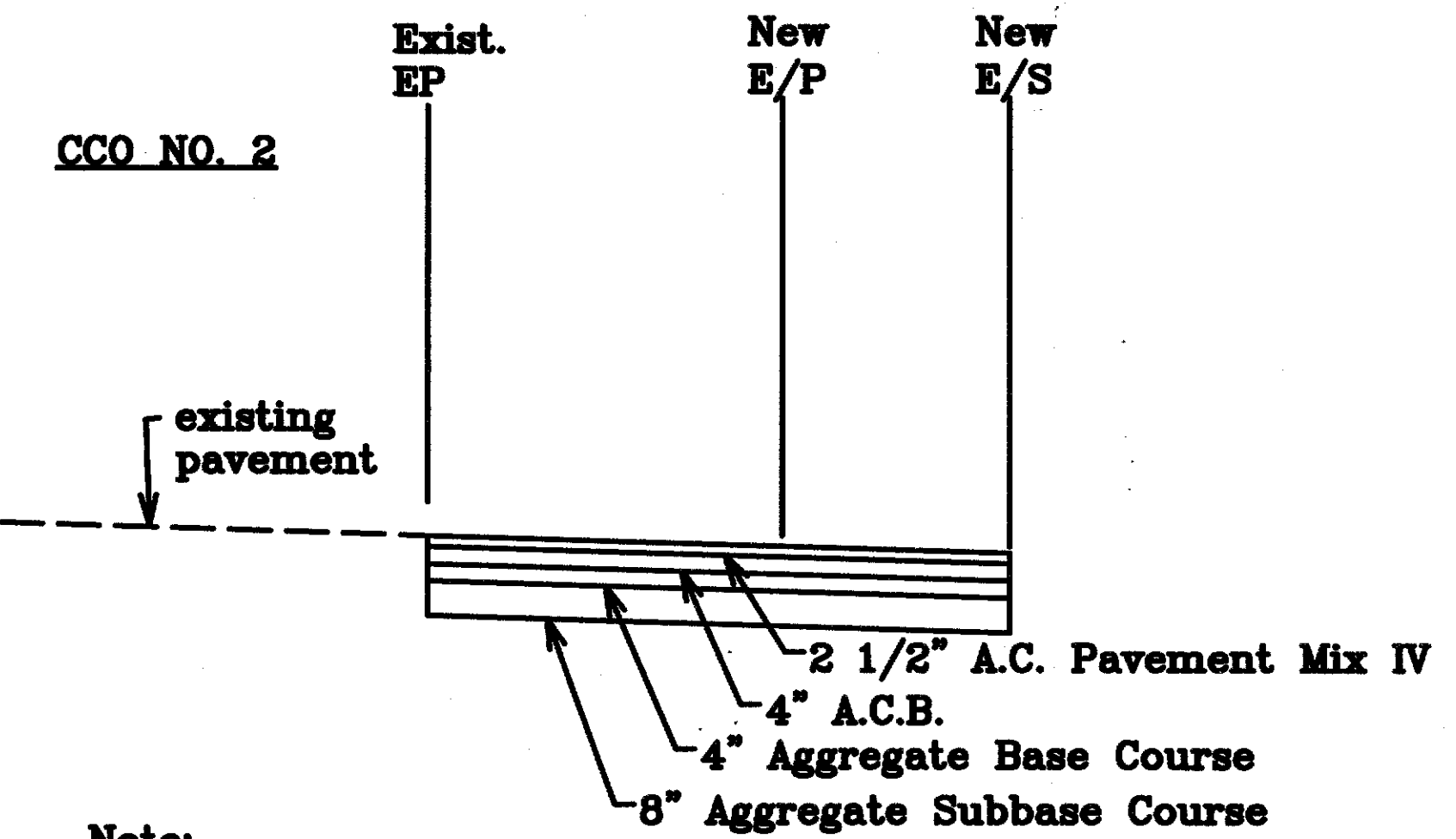
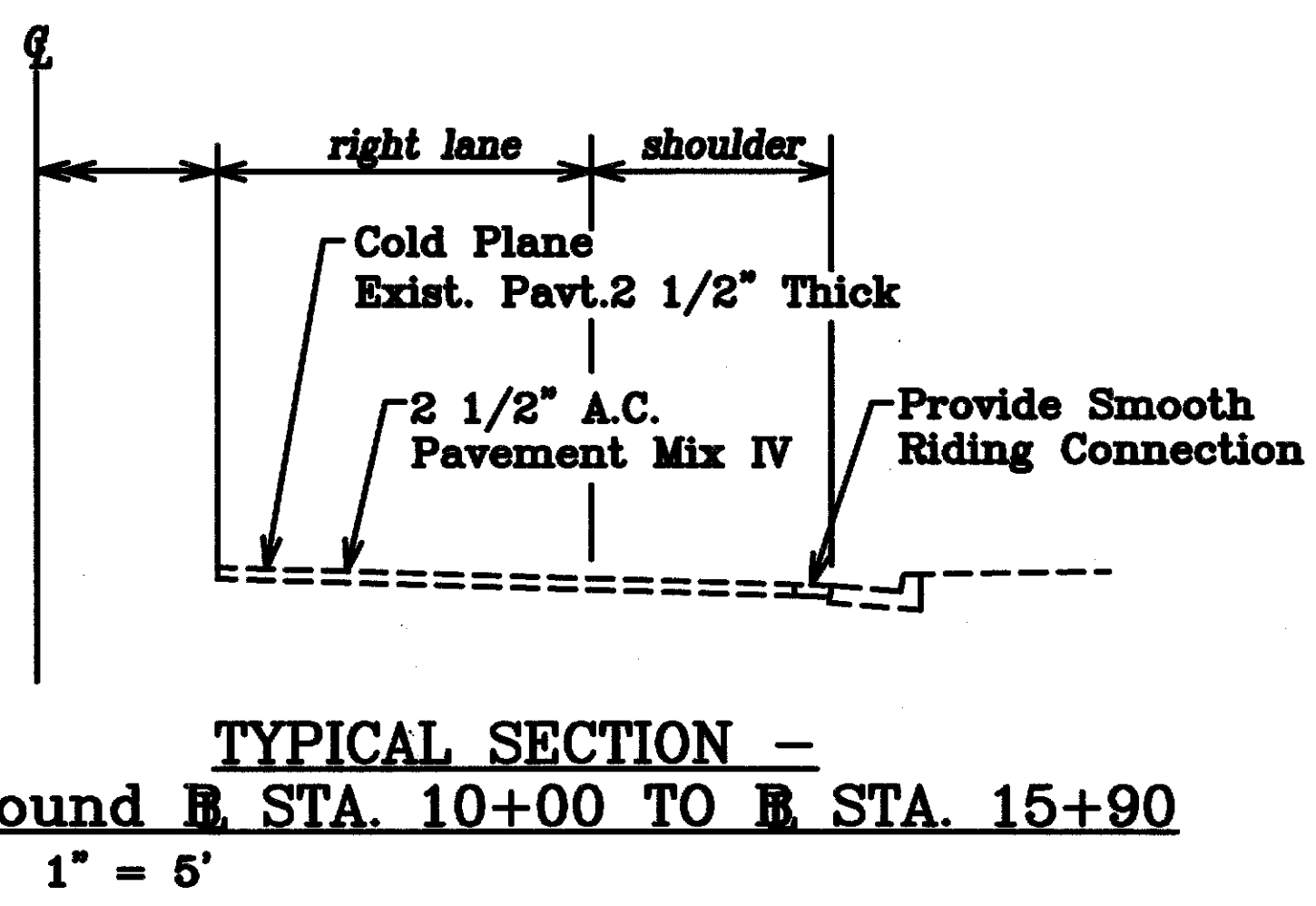

Note:
See Plan Sheet Nos. 14 through 17 for Details Not Shown

REVISED PAVEMENT STRUCTURE DETAIL TYPICAL SECTIONS -
STA. 198+00 to STA. 234+69.35 (Inbound)
STA. 184+00 to STA. 233+50 (Outbound)
Not to Scale

Note:
Refer to notes on Median Barrier Typical Sections - 1

LEGEND FOR AS-BUILT POSTINGS

~~~~~ Squiggly line for as-built deletion

==== Double line for as-built deletion

Roadway Text for as-built posting

GREG H. HIYAKUNDO  
LICENSED PROFESSIONAL ENGINEER  
No. 6662-C  
HAWAII, U.S.A.

THIS WORK WAS PREPARED BY ME OR UNDER MY SUPERVISION.

Signature: [Signature] April 30, 2006  
EXPIRATION DATE OF THE LICENSE

STATE OF HAWAII  
DEPARTMENT OF TRANSPORTATION  
HIGHWAYS DIVISION

**MAIL POINT MEDIAN BARRIER TYPICAL SECTIONS - 4**

FARRINGTON HIGHWAY SAFETY IMPROVEMENTS  
NANAKULI TO MAKAHA  
F.A.I. Proj. No. STP-093-1(18)

Scale: 1" = 5' Date: 04/23/03

SHEET No. 17 OF 98 SHEETS

|                   |       |
|-------------------|-------|
| DATE              | ..... |
| SURVEY PLANNED BY | ..... |
| DRAWN BY          | ..... |
| DESIGNED BY       | ..... |
| QUANTITIES BY     | ..... |
| CHECKED BY        | ..... |
| ORIGINAL PLAN     | ..... |
| NOTE BOOK         | ..... |
| No.               | ..... |

| FED. ROAD DIST. NO. | STATE | FED. AID PROJ. NO. | FISCAL YEAR | SHEET NO. | TOTAL SHEETS |
|---------------------|-------|--------------------|-------------|-----------|--------------|
| HAWAII              | HAW.  | STP-093-1(18)      | 2003        | 18        | 98           |

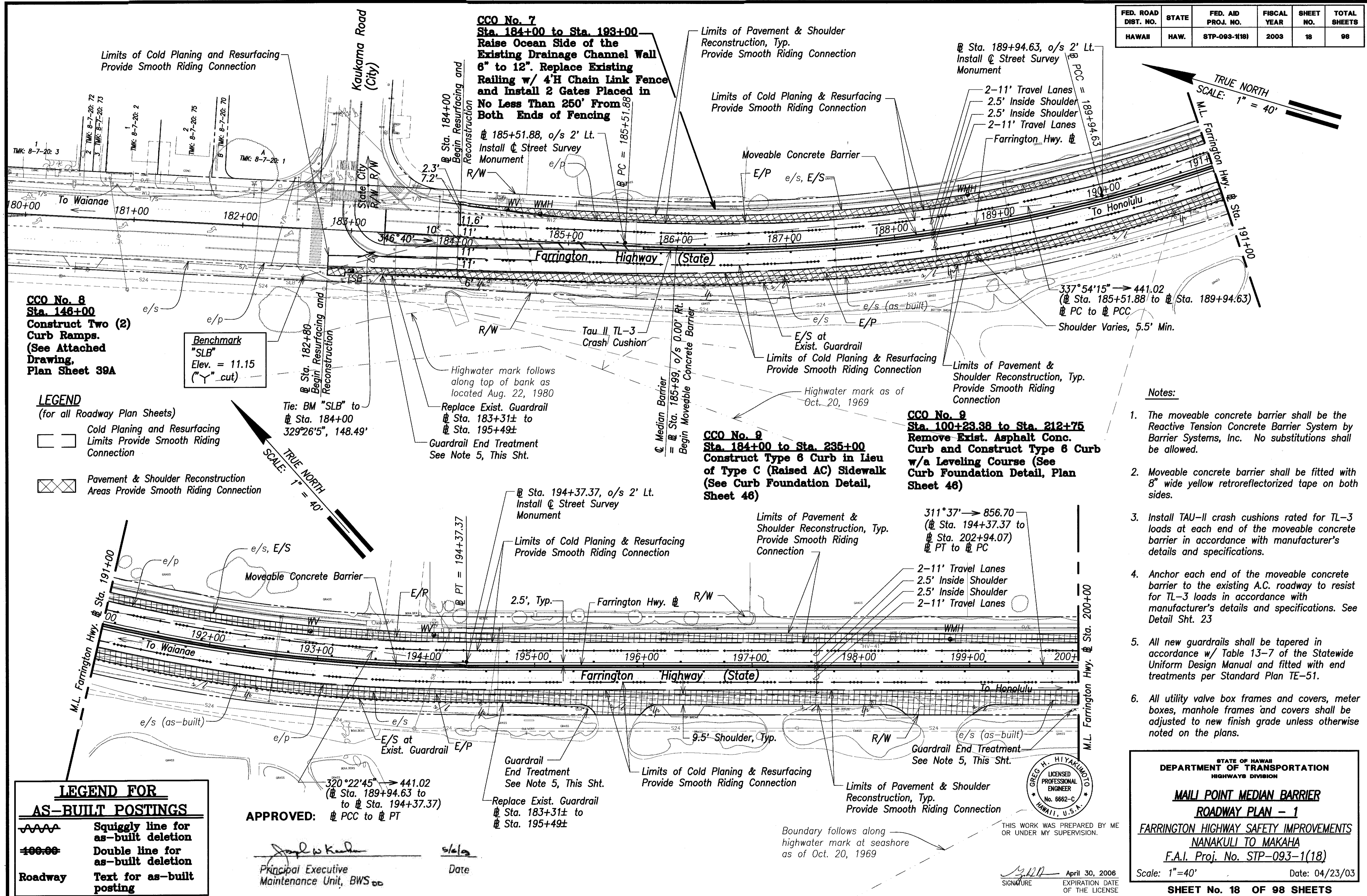

**CCO No. 8**  
**Sta. 148+00**  
 Construct Two (2)  
 Curb Ramps.  
 (See Attached  
 Drawing,  
 Plan Sheet 39A)

Benchmark  
 "SLB"  
 Elev. = 11.15  
 ("cut")

- LEGEND**  
 (for all Roadway Plan Sheets)
- Cold Planing and Resurfacing Limits Provide Smooth Riding Connection
  - Pavement & Shoulder Reconstruction Areas Provide Smooth Riding Connection

**LEGEND FOR AS-BUILT POSTINGS**

- Squiggly line for as-built deletion
- Double line for as-built deletion
- Roadway** Text for as-built posting

APPROVED:   
 Principal Executive Maintenance Unit, BWS  
 Date: 5/6/03

- Notes:**
- The moveable concrete barrier shall be the Reactive Tension Concrete Barrier System by Barrier Systems, Inc. No substitutions shall be allowed.
  - Moveable concrete barrier shall be fitted with 8" wide yellow retroreflectorized tape on both sides.
  - Install TAU-II crash cushions rated for TL-3 loads at each end of the moveable concrete barrier in accordance with manufacturer's details and specifications.
  - Anchor each end of the moveable concrete barrier to the existing A.C. roadway to resist for TL-3 loads in accordance with manufacturer's details and specifications. See Detail Sht. 23
  - All new guardrails shall be tapered in accordance w/ Table 13-7 of the Statewide Uniform Design Manual and fitted with end treatments per Standard Plan TE-51.
  - All utility valve box frames and covers, meter boxes, manhole frames and covers shall be adjusted to new finish grade unless otherwise noted on the plans.



THIS WORK WAS PREPARED BY ME OR UNDER MY SUPERVISION.  
 SIGNATURE:   
 EXPIRATION DATE OF THE LICENSE: April 30, 2006

STATE OF HAWAII  
 DEPARTMENT OF TRANSPORTATION  
 HIGHWAYS DIVISION

**MAIL POINT MEDIAN BARRIER ROADWAY PLAN - 1**

FARRINGTON HIGHWAY SAFETY IMPROVEMENTS  
 NANAKULI TO MAKAHA  
 F.A.I. Proj. No. STP-093-1(18)

Scale: 1"=40' Date: 04/23/03

SHEET No. 18 OF 98 SHEETS

"AS-BUILT"



| FED. ROAD DIST. NO. | STATE | FED. AID PROJ. NO. | FISCAL YEAR | SHEET NO. | TOTAL SHEETS |
|---------------------|-------|--------------------|-------------|-----------|--------------|
| HAWAII              | HAW.  | STP-093-1(18)      | 2003        | 20        | 98           |

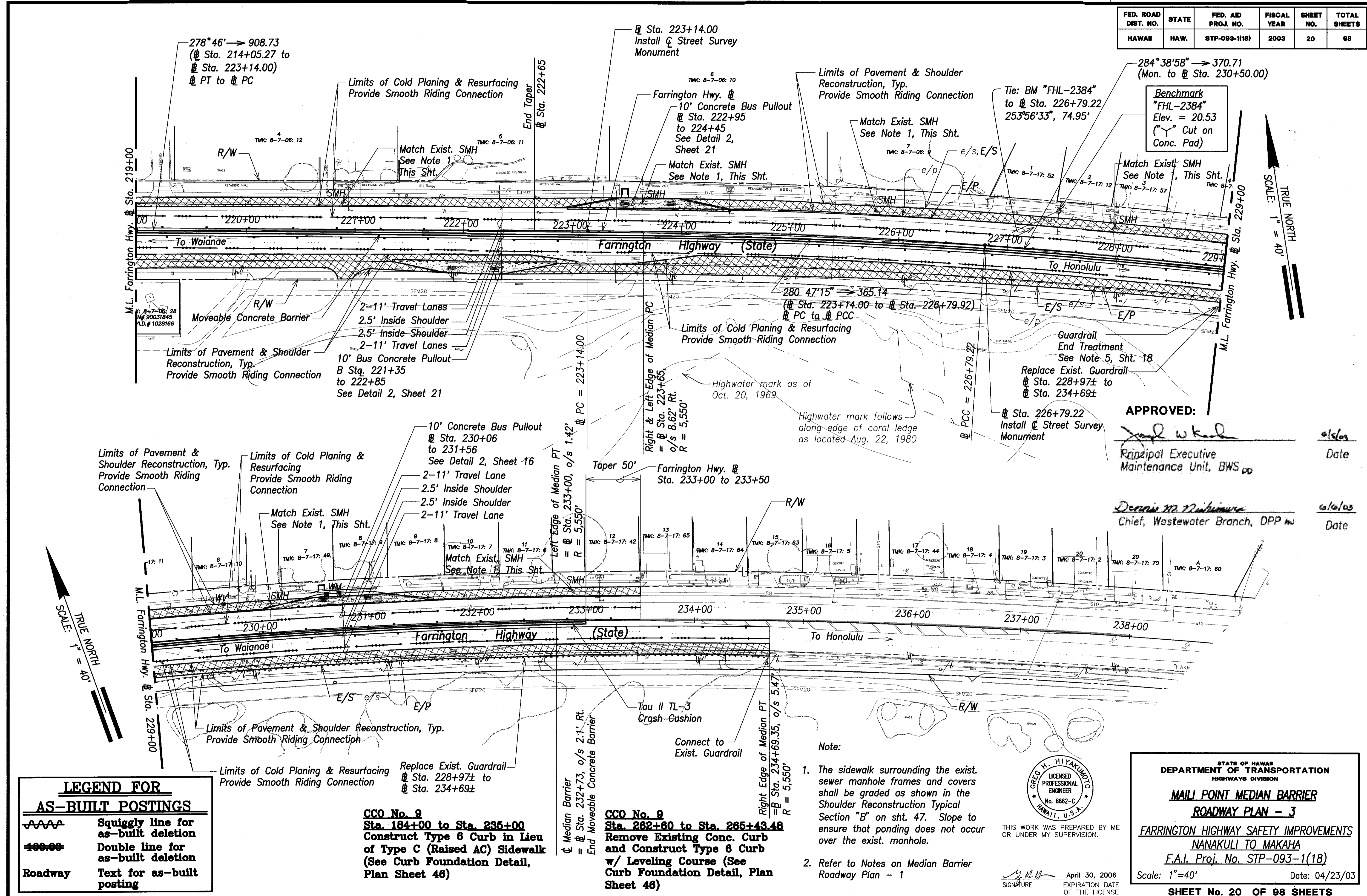

**APPROVED:**  
*[Signature]*  
 Principal Executive  
 Maintenance Unit, BWS  
 Date: 01/09

*[Signature]*  
 Chief, Wastewater Branch, DPP  
 Date: 6/6/03

**LEGEND FOR AS-BUILT POSTINGS**

|  |                                     |
|--|-------------------------------------|
|  | Squiggly line for as-built deletion |
|  | Double line for as-built deletion   |
|  | Text for as-built posting           |

**CCO No. 9**  
 Sta. 184+00 to Sta. 235+00  
 Construct Type 6 Curb in Lieu of Type C (Raised AC) Sidewalk (See Curb Foundation Detail, Plan Sheet 46)

**CCO No. 9**  
 Sta. 262+60 to Sta. 265+43.48  
 Remove Existing Conc. Curb and Construct Type 6 Curb w/ Leveling Course (See Curb Foundation Detail, Plan Sheet 46)

- Note:
- The sidewalk surrounding the exist. sewer manhole frames and covers shall be graded as shown in the Shoulder Reconstruction Typical Section "B" on sht. 47. Slope to ensure that ponding does not occur over the exist. manhole.
  - Refer to Notes on Median Barrier Roadway Plan - 1



THIS WORK WAS PREPARED BY ME OR UNDER MY SUPERVISION.  
*[Signature]*  
 April 30, 2006  
 EXPIRATION DATE OF THE LICENSE

STATE OF HAWAII  
 DEPARTMENT OF TRANSPORTATION  
 HIGHWAYS DIVISION

**MAIL POINT MEDIAN BARRIER ROADWAY PLAN - 3**

FARRINGTON HIGHWAY SAFETY IMPROVEMENTS  
 NANAKULI TO MAKAHA  
 F.A.I. Proj. No. STP-093-1(18)

Scale: 1"=40' Date: 04/23/03

**SHEET No. 20 OF 98 SHEETS**

| FED. ROAD DIST. NO. | STATE | FED. AID PROJ. NO. | FISCAL YEAR | SHEET NO. | TOTAL SHEETS |
|---------------------|-------|--------------------|-------------|-----------|--------------|
| HAWAII              | HAW.  | STP-093-1(18)      | 2003        | 21        | 98           |

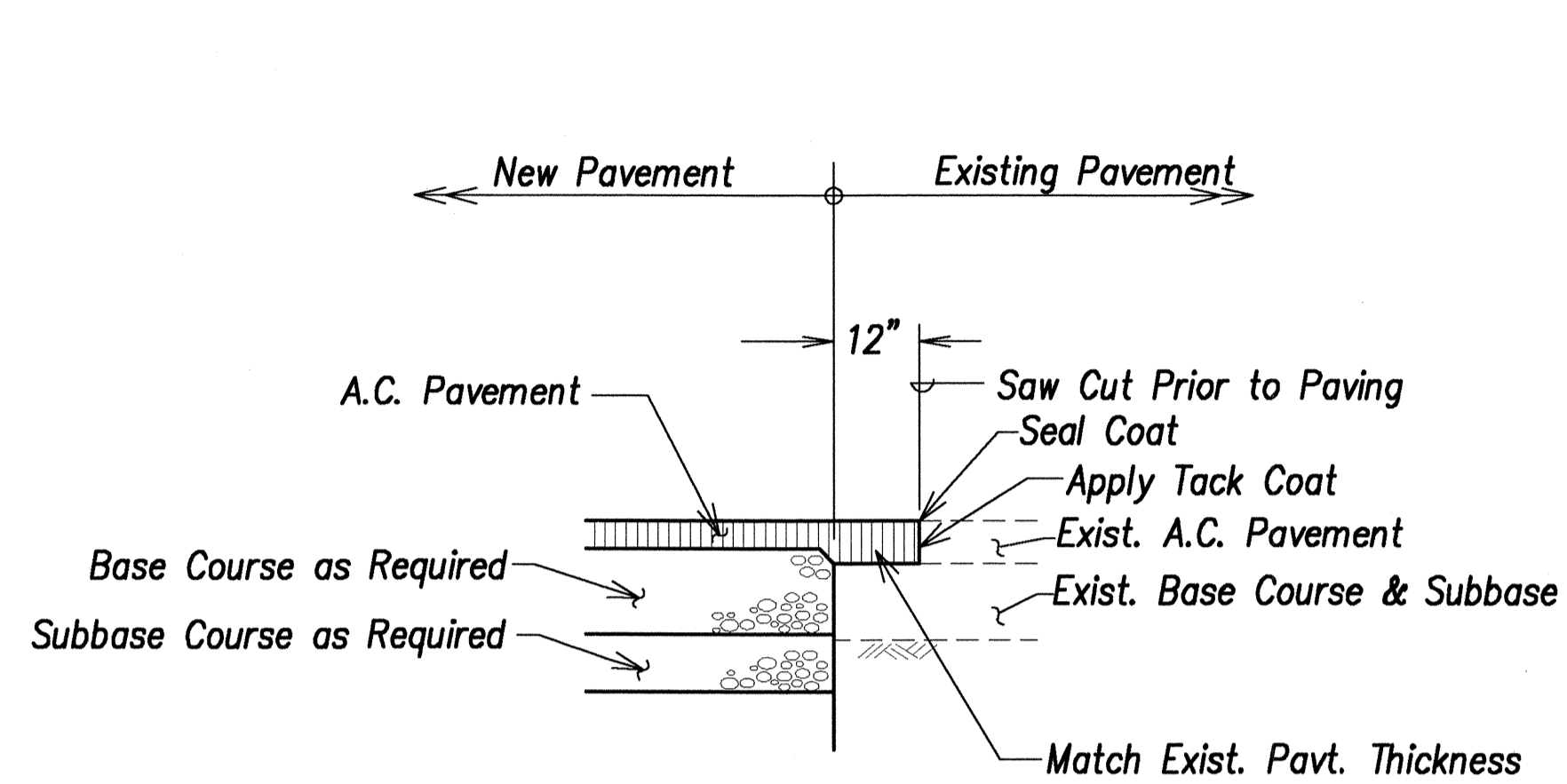

**PAVEMENT CONNECTION** 1  
Scale: 1" = 2'-0" 14, 15 & 16 | 21

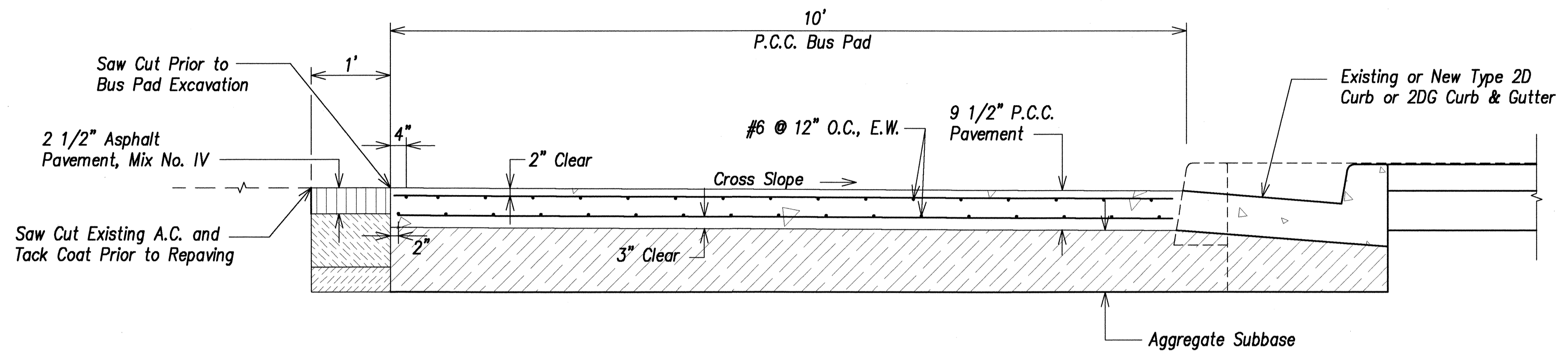

**P.C.C. BUS PAD PAVEMENT DETAIL** 3  
Not to Scale 15 & 16 | 21

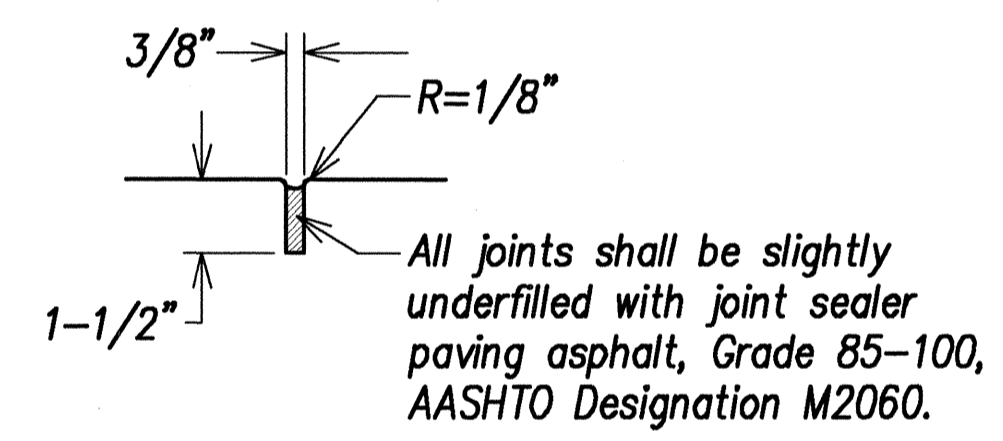

- NOTES:**
1. Transverse joints shall be weakened—plane contraction joints spaced less than 15 feet apart (Section "AA").
  2. Pavement shall be broom-finished transversely.
  3. Concrete pad shall not extend into intersection. Shorten dimension as required.

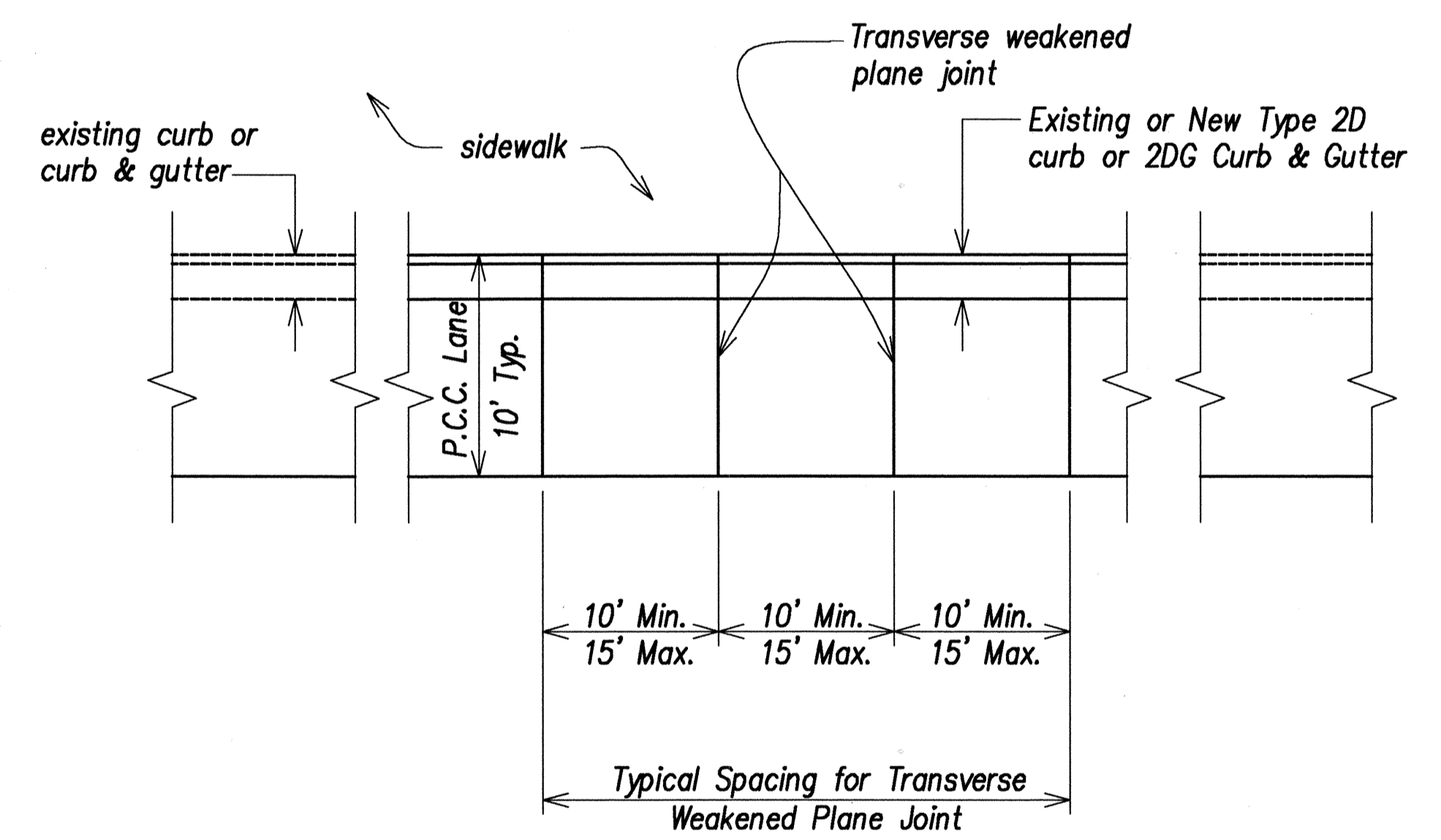

**TYPICAL JOINT LOCATION AND LAYOUT PLAN FOR P.C.C. BUS PAD** 4  
Not to Scale 15 & 16 | 21

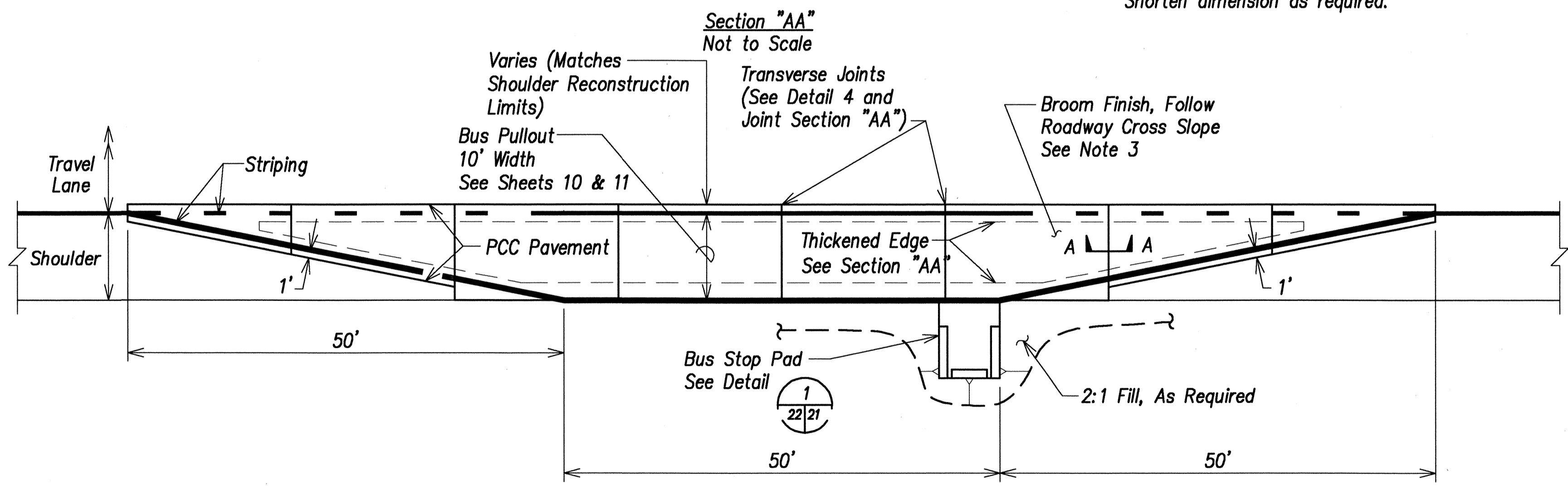

**CONCRETE BUS PULLOUT** 2  
Scale: 1" = 10'-0" 15 & 16 | 21

|             |       |
|-------------|-------|
| DATE        | _____ |
| DESIGNED BY | _____ |
| CHECKED BY  | _____ |
| NO. _____   | _____ |

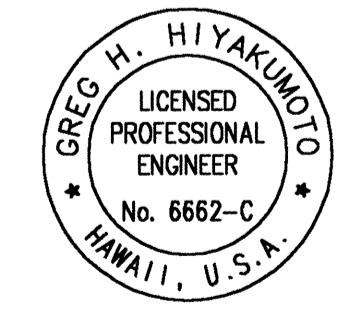

THIS WORK WAS PREPARED BY ME OR UNDER MY SUPERVISION.

SIGNATURE: *Greg H. Hiyaunoto* April 30, 2004  
EXPIRATION DATE OF THE LICENSE

STATE OF HAWAII  
DEPARTMENT OF TRANSPORTATION  
HIGHWAYS DIVISION

**MAIL POINT MEDIAN BARRIER  
ROADWAY DETAILS**

FARRINGTON HIGHWAY SAFETY IMPROVEMENTS  
NANAKULI TO MAKAHA  
F.A.I. Proj. No. STP-093-1(18)

Scale: As shown Date: 04/23/03

**SHEET No. 21 OF 98 SHEETS**

| FED. ROAD DIST. NO. | STATE | FED. AID PROJ. NO. | FISCAL YEAR | SHEET NO. | TOTAL SHEETS |
|---------------------|-------|--------------------|-------------|-----------|--------------|
| HAWAII              | HAW.  | STP-093-1(18)      | 2003        | 22        | 98           |

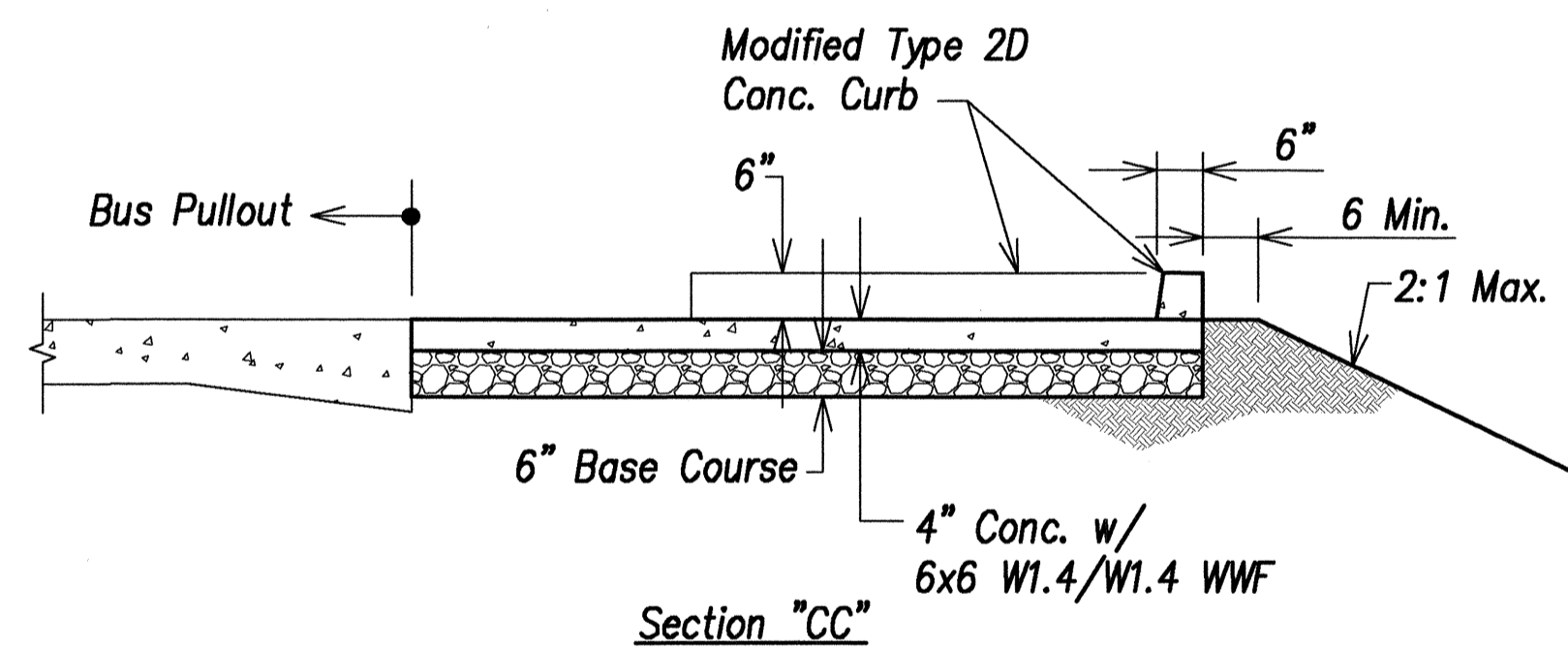
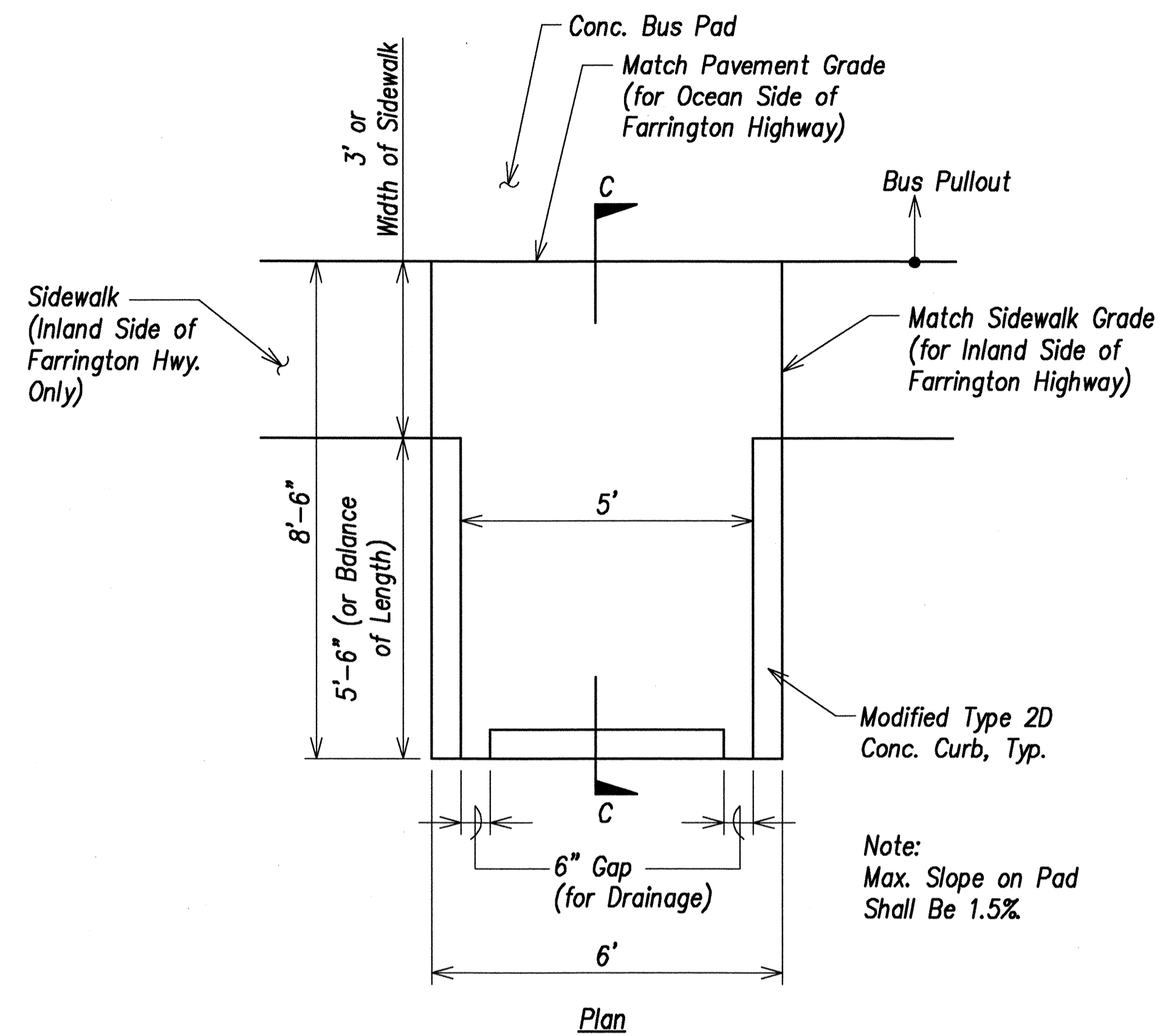

**BUS STOP PAD** 1  
 Scale: 1" = 2'-0" 22 | 21

|               |      |
|---------------|------|
| DESIGNED BY   | DATE |
| DRAWN BY      |      |
| CHECKED BY    |      |
| ORIGINAL PLAN |      |
| NOTE BOOK     |      |
| No.           |      |

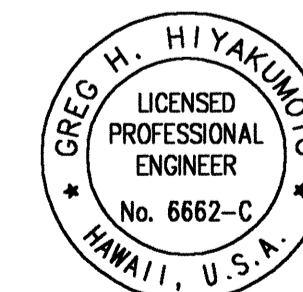

THIS WORK WAS PREPARED BY ME OR UNDER MY SUPERVISION.

SIGNATURE: *[Signature]* April 30, 2004  
 EXPIRATION DATE OF THE LICENSE

STATE OF HAWAII  
 DEPARTMENT OF TRANSPORTATION  
 HIGHWAYS DIVISION

**MAIL POINT MEDIAN BARRIER  
 ROADWAY DETAILS**

FARRINGTON HIGHWAY SAFETY IMPROVEMENTS  
 NANAKULI TO MAKAHA  
 F.A.I. Proj. No. STP-093-1(18)

Scale: As shown Date: 04/23/03

**SHEET No. 22 OF 98 SHEETS**



| FED. ROAD DIST. NO. | STATE | FED. AID PROJ. NO. | FISCAL YEAR | SHEET NO. | TOTAL SHEETS |
|---------------------|-------|--------------------|-------------|-----------|--------------|
| HAWAII              | HAW.  | STP-093-1(18)      | 2003        | 24        | 98           |

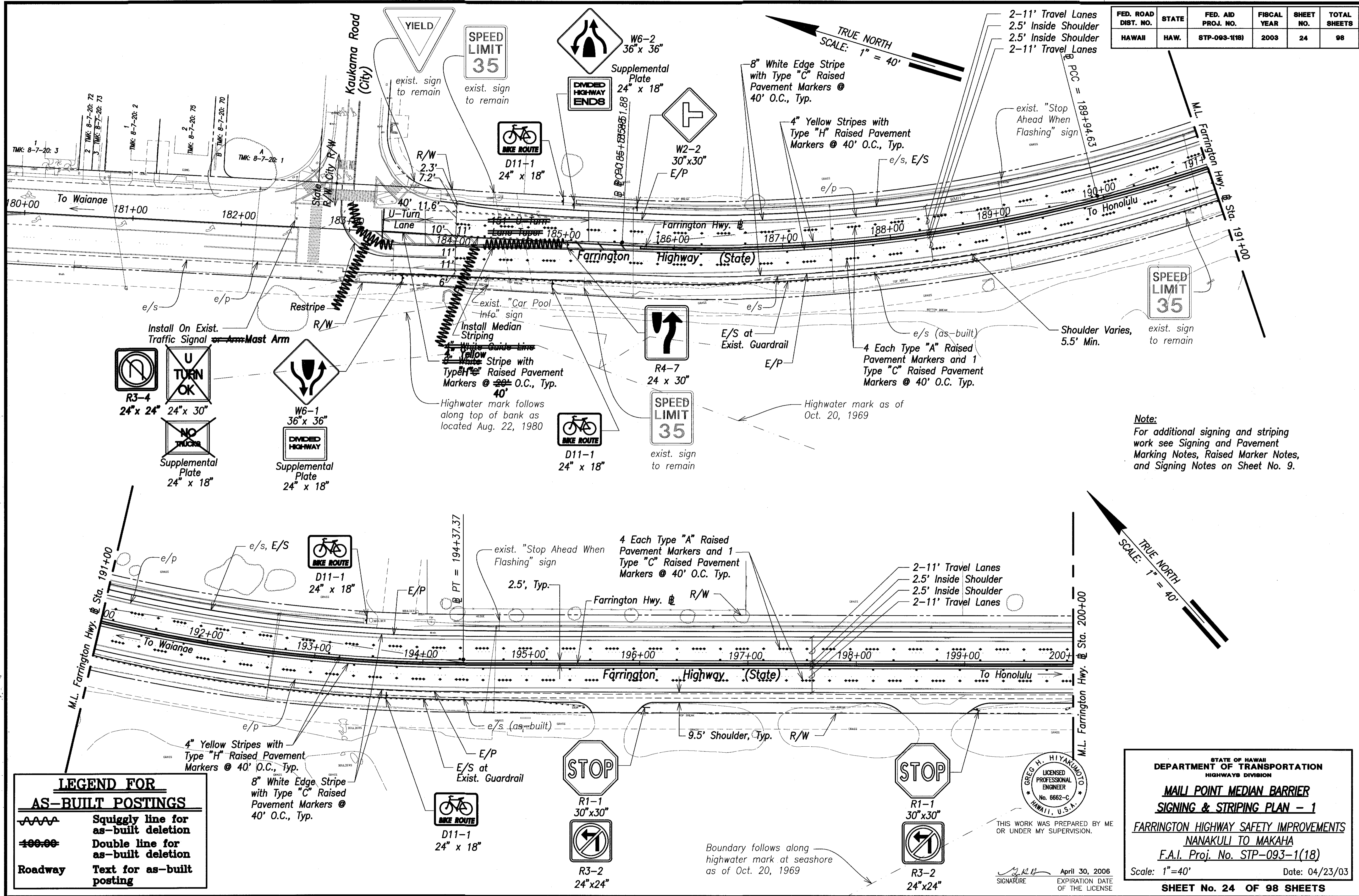

**Note:**  
For additional signing and striping work see Signing and Pavement Marking Notes, Raised Marker Notes, and Signing Notes on Sheet No. 9.

**LEGEND FOR AS-BUILT POSTINGS**

|  |                                     |
|--|-------------------------------------|
|  | Squiggly line for as-built deletion |
|  | Double line for as-built deletion   |
|  | Text for as-built posting           |

|                   |       |
|-------------------|-------|
| DATE              | ..... |
| SURVEY PLOTTED BY | ..... |
| DESIGNED BY       | ..... |
| DESIGNED BY       | ..... |
| QUANTITIES BY     | ..... |
| CHECKED BY        | ..... |
| ORIGINAL PLAN     | ..... |
| NOTE BOOK         | ..... |
| No.               | ..... |

RMTG JOB NO.: 1-18835-0E

THIS WORK WAS PREPARED BY ME OR UNDER MY SUPERVISION.

**GREG H. HIYAKIMOTO**  
LICENSED PROFESSIONAL ENGINEER  
No. 8662-C  
HAWAII, U.S.A.

APR 30 2006  
EXPIRATION DATE OF THE LICENSE

STATE OF HAWAII  
DEPARTMENT OF TRANSPORTATION  
HIGHWAYS DIVISION

**MAIL POINT MEDIAN BARRIER  
SIGNING & STRIPING PLAN - 1**

FARRINGTON HIGHWAY SAFETY IMPROVEMENTS  
NANAKULI TO MAKAHA  
F.A.I. Proj. No. STP-093-1(18)

Scale: 1"=40' Date: 04/23/03

**SHEET No. 24 OF 98 SHEETS**

**"AS-BUILT"**

| FED. ROAD DIST. NO. | STATE | FED. AID PROJ. NO. | FISCAL YEAR | SHEET NO. | TOTAL SHEETS |
|---------------------|-------|--------------------|-------------|-----------|--------------|
| HAWAII              | HAW.  | STP-093-1(18)      | 2003        | 25        | 98           |

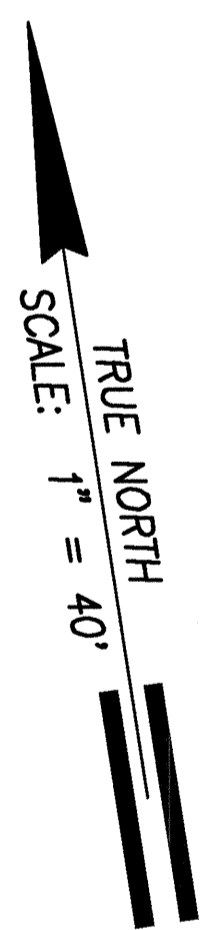
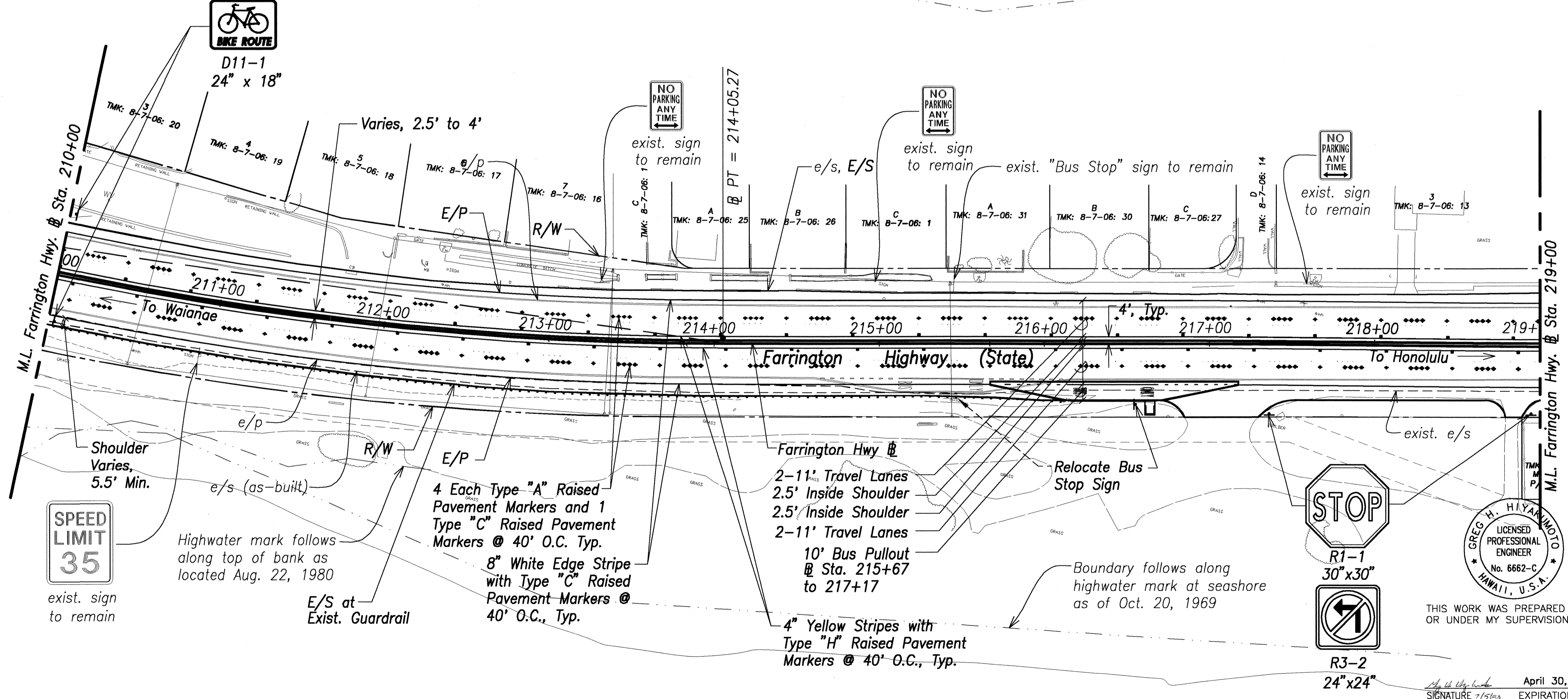
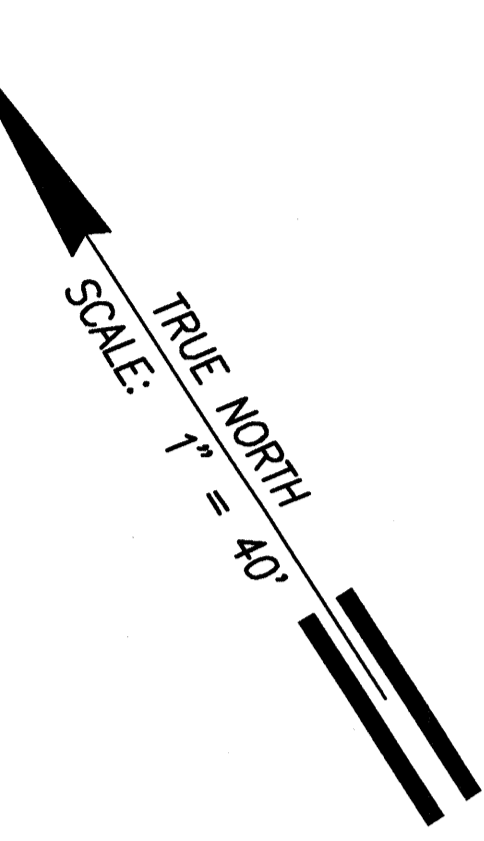
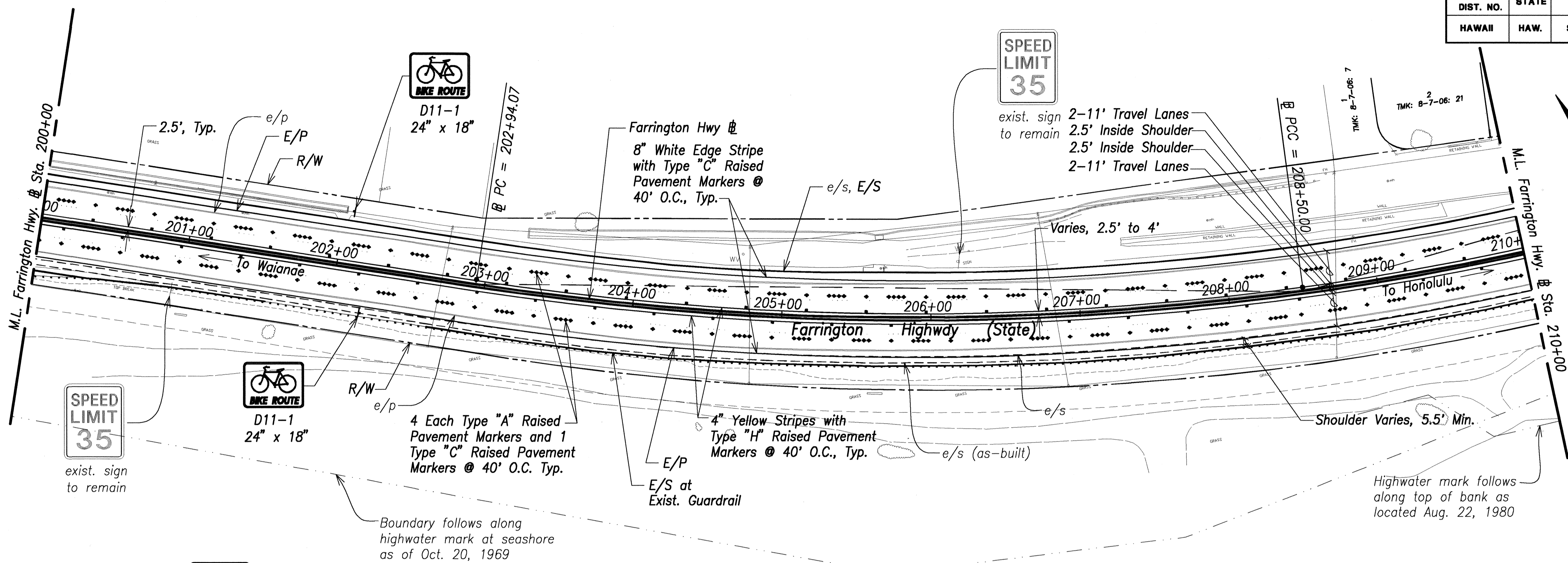

Note:  
For additional signing and striping work see Signing and Pavement Marking Notes, Raised Marker Notes, and Signing Notes on Sheet No. 9.

|                   |       |
|-------------------|-------|
| DATE              | ..... |
| SURVEY PLOTTED BY | ..... |
| DESIGNED BY       | ..... |
| TRACED BY         | ..... |
| NOTE BOOK         | ..... |
| QUANTITIES BY     | ..... |
| CHECKED BY        | ..... |
| No.               | ..... |



THIS WORK WAS PREPARED BY ME OR UNDER MY SUPERVISION.  
 SIGNATURE: [Signature] April 30, 2004  
 EXPIRATION DATE OF THE LICENSE

STATE OF HAWAII  
 DEPARTMENT OF TRANSPORTATION  
 HIGHWAYS DIVISION

**MAIL POINT MEDIAN BARRIER  
 SIGNING & STRIPING PLAN - 2**

FARRINGTON HIGHWAY SAFETY IMPROVEMENTS  
 NANAKULI TO MAKAHA  
 F.A.I. Proj. No. STP-093-1(18)

Scale: 1"=40' Date: 04/23/03

**SHEET No. 25 OF 98 SHEETS**

