

FED. ROAD DIST. NO.	STATE	PROJ. NO.	FISCAL YEAR	SHEET NO.	TOTAL SHEETS
HAWAII	HAW.	93A-02-90	1992	7	7

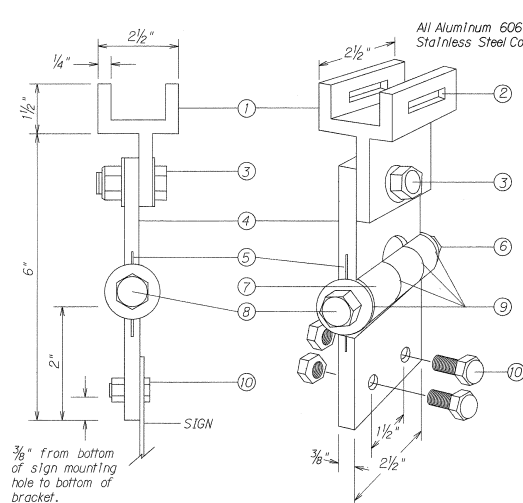

**FIXED LENGTH NON-ADJUSTABLE  
SWING SIGN BRACKET**

- ① Pivotal Upper Bracket
- ② 1 3/8" x 1/4" Slot for double strapping to electroliner mast arm. (M2G-34S(HD).030" x 3/4" Heavy Duty Stainless Steel Strap with M2G-34B(HD) Buckle recommended.)
- ③ 1/2" - 13 x 1 1/2" Stainless Steel Hex Head Bolt with Stainless Steel Hex Lock Nut and 1/16" Stainless Steel Washer (both sides). Allows upper bracket to pivot and align with electroliner mast arm.
- ④ 6" Overall drop with Fixed Length Sign Bracket
- ⑤ Stainless Steel Damper Spring (Removable)
- ⑥ Stainless Steel Hex Lock Nut with 1/16" Stainless Steel Washer
- ⑦ 1" O.D. Axle Housing
- ⑧ 1/2" - 13 x 4" Stainless Steel Hex Head Bolt with 1/16" Stainless Steel Washer
- ⑨ Ollite Bushing
- ⑩ Sign Mounting Sets, consisting of two each 3/16" - 18 x 1" Stainless Steel Hex Head Bolt with Stainless Steel Hex Lock Nut. Two holes on 1/2" centers provide positive lock sign mounting to bracket.

All Aluminum 6061T6 Alloy and Stainless Steel Components.

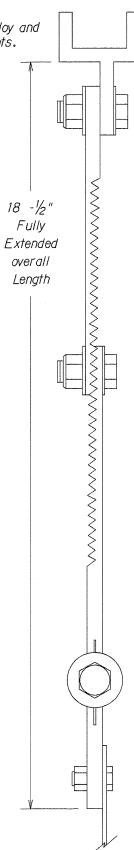

Allows  
Length  
Adjustment  
of 4 1/2"

**ADJUSTABLE LENGTH  
SWING SIGN BRACKET**

- ⑪ 8 1/4" overall length Upper Adjustable Sign Bracket section
- ⑫ 9" overall length Lower Adjustable Sign Bracket section, including Axle Housing (8" overall length to top of Axle Housing)
- ⑬ 1/2" - 13 x 1 1/2" Stainless Steel Hex Bolt with Stainless Steel Hex Lock Nut and 1/16" Stainless Steel Washers (both sides). Loosen lock nut, adjust bracket teeth to level sign.

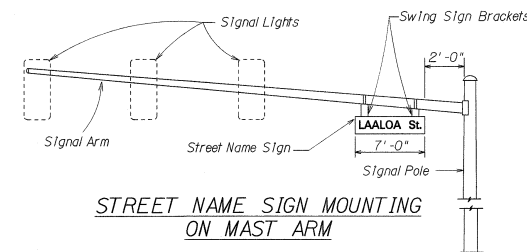

**STREET NAME SIGN MOUNTING  
ON MAST ARM**

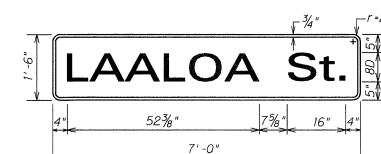

**D3-1  
TYPICAL PANEL LAYOUT  
FOR STREET NAME SIGN  
ON TRAFFIC SIGNAL MAST ARM**

**NOTES:**

1. Provide the same message on the front and back side of the sign. Payment will not be made separately but shall be considered as one unit.
2. Colors:  
Legend - White (Reflectorized)  
Background - Green (Reflectorized)
3. All panels shall be reflectorized with Type B reflective sheeting in accordance with Section 712.20 of the Standard Specifications.
4. All signs shall conform to section 621 of the Standard Specifications and the latest editions and amendments of the following FHWA publications:  
a. "Manual on Uniform Traffic Control Devices for Streets and Highways" (MUTCD)  
b. "Standard Highway Signs"  
c. "Standard Alphabets for Highway Signs"

5. Borders and messages shall conform to details as shown on the plans and as specified in the MUTCD.
6. Sign mounting brackets, fixtures, fasteners, and all necessary hardware, and equipment, tools, labor, materials and other incidentals for installation, will not be paid for separately but shall be considered incidental to street name sign installation.

STATE OF HAWAII DEPARTMENT OF TRANSPORTATION HIGHWAYS DIVISION
<b>STREET NAME SIGN # MOUNTING DETAIL</b>
<b>FARRINGTON HIGHWAY</b>
<b>Intersection Improvements at Laaloa Street</b>
<b>PROJECT NO. 93A-01-91</b>
Scale: Not to Scale Date: April, 1992
SHEET No. 7 OF 7 SHEETS

Dimensions may vary slightly.

DESIGNED BY	DATE
DRAWN BY	
CHECKED BY	
IN CHARGE	
NOTED BY	
DATE MADE	
NO.	