

FED. ROAD DIST. NO.	STATE	FED. AID PROJ. NO.	FISCAL YEAR	SHEET NO.	TOTAL SHEETS
HAWAII	HAW.	5-09003	1965	32	162

NOTES:

- These plans are intended to show what Traffic Reroute plan must be used during any particular phase of construction. The contractor may combine as many phases of construction with a similar reroute plan as he may deem necessary.
- If the contractor chooses, he may construct a connection for the Inbound Lanes between Sta. 115 and 126. Having accomplished this, he may combine phases 2 and 4 and then construct 3 and 5 together.
- The contractor may alter the reroute plans to suit his equipment and men subject to the approval of the engineer.
- All signs are to be reused during construction wherever possible as directed by the engineer.
- Barricades as shown on the plans are intended as a guide only, and the exact type, number and location of barricades shall be as directed by the engineer.
- Barricades shall conform to Part V of the Manual on Uniform Traffic Control Devices for Streets and Highways.
- Rental (including installation and maintenance) of barricades, blinkers and amber beacons will be paid under item 115 "Maintaining Detours."
- Temporary paved crossovers shall be removed by the Contractor and will be paid for under item 19, "Roadway Excavation." Any necessary backfilling shall be considered incidental to roadway excavation. For Typical Section of Temporary Pavement, see sheet 4.

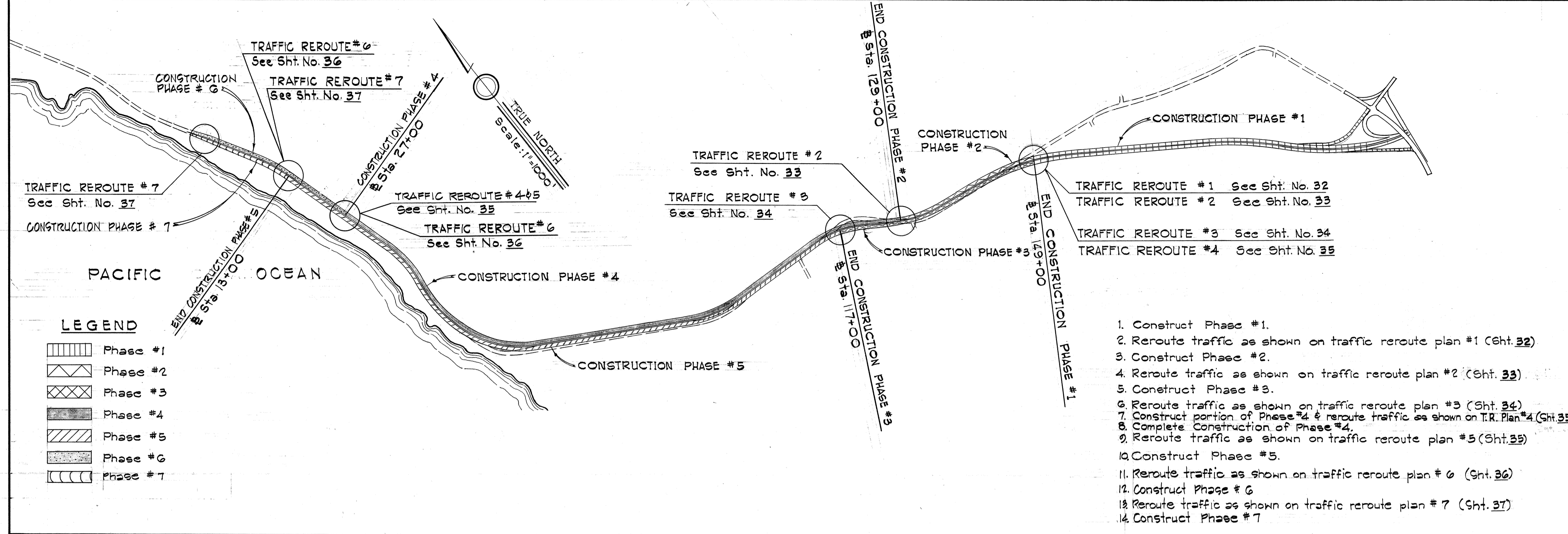

- Construct Phase #1.
- Reroute traffic as shown on traffic reroute plan #1 (Sht. 32)
- Construct Phase #2.
- Reroute traffic as shown on traffic reroute plan #2 (Sht. 33)
- Construct Phase #3.
- Reroute traffic as shown on traffic reroute plan #3 (Sht. 34)
- Construct portion of Phase #4 & reroute traffic as shown on T.R. Plan #4 (Sht. 35)
- Complete Construction of Phase #4.
- Reroute traffic as shown on traffic reroute plan #5 (Sht. 35)
- Construct Phase #5.
- Reroute traffic as shown on traffic reroute plan #6 (Sht. 36)
- Construct Phase #6
- Reroute traffic as shown on traffic reroute plan #7 (Sht. 37)
- Construct Phase #7

LEGEND

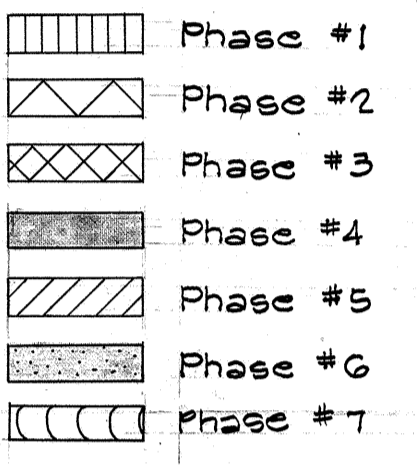

SUMMARY OF SIGNS

TYPE	DESCRIPTION	NO.
M5-7(L)	Detour Barricade With Blinkers	21
M5-7(R)	" " " "	24
R3-9	" " " "	1
R10-3	Road Closed	1
R4-7(R)	Keep → Right	2
R6-3	Two Way Traffic Ahead	1
R6-3	" " " " Portable Stand	1
W1-2(L)	" " " "	1
W1-2(R)	" " " "	1
W1-4(L)	" " " "	2
W1-4(R)	" " " "	1
W6-1	Divided Hwy	1
W13-1(25)	25 M.P.H.	2
W20-1a	Road Const. 1500 Ft.	3
W20-5d(L)	Left Lane Closed Ahead	1
W1-6(R)	" " " "	1
R1-1	Stop	1
R3-1	No Left Turn	1

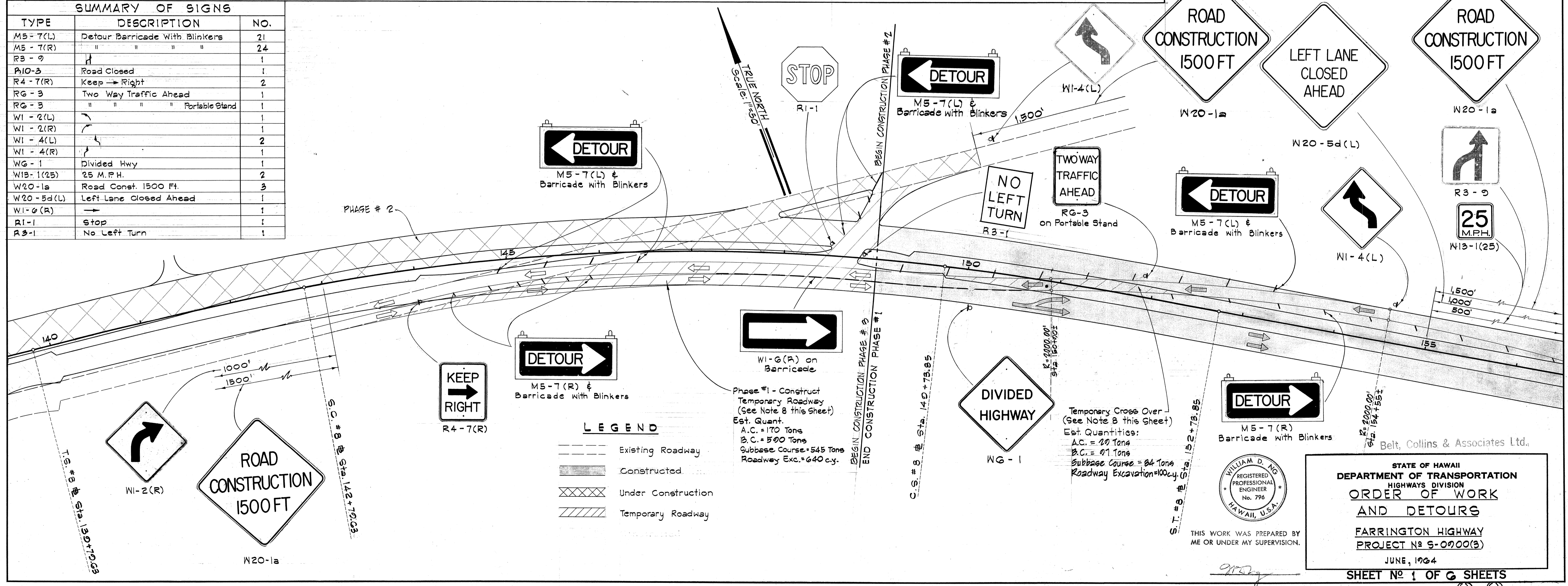

LEGEND

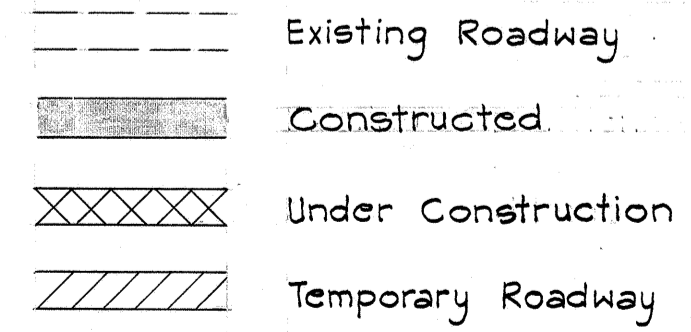

SURVEY PLOTTED BY: _____ DATE: _____
 DRAWN BY: _____
 CHECKED BY: _____
 NOTE BOOK: _____
 QUANTITIES BY: _____
 CHECKED BY: _____
 No. _____

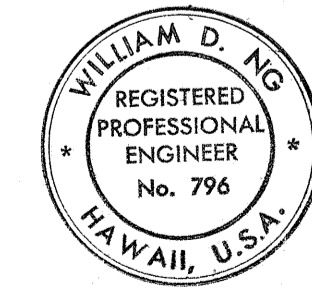

STATE OF HAWAII
 DEPARTMENT OF TRANSPORTATION
 HIGHWAYS DIVISION
**ORDER OF WORK
 AND DETOURS**
 FARRINGTON HIGHWAY
 PROJECT No. 5-0900(3)
 JUNE, 1964

SHEET No. 1 OF 6 SHEETS

FED. ROAD DIST. NO.	STATE	FED. AID PROJ. NO.	FISCAL YEAR	SHEET NO.	TOTAL SHEETS
HAWAII	HAW.	5-0900(3)	1965	33	162

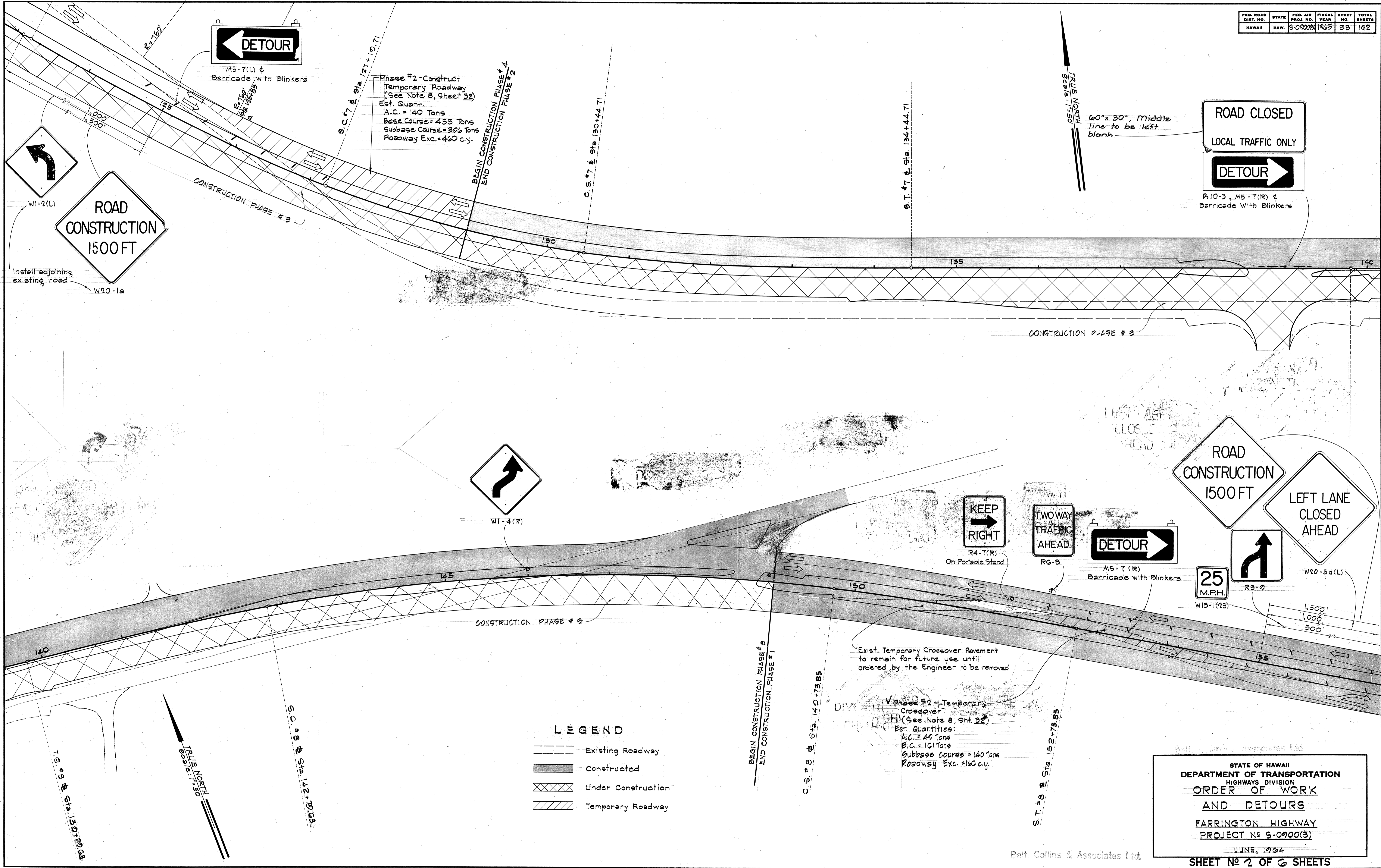

DETOUR
←

M5-7(L) &
Barricade with Blinkers

Phase #2 - Construct
Temporary Roadway
(See Note 8, Sheet 32)
Est. Quant.
A.C. = 140 Tons
Base Course = 455 Tons
Subbase Course = 300 Tons
Roadway Exc. = 460 c.y.

BEGIN CONSTRUCTION PHASE #4
END CONSTRUCTION PHASE #2

60"x 30", Middle
line to be left
blank

ROAD CLOSED
LOCAL TRAFFIC ONLY

DETOUR →

P10-3, M5-7(R) &
Barricade With Blinkers

ROAD CONSTRUCTION
1500 FT

W1-2(L)

Install adjoining
existing road
W20-1a

↗

W1-4(R)

KEEP RIGHT
→

R4-7(R)
On Portable Stand

TWO WAY TRAFFIC AHEAD

RG-3

DETOUR →

M5-7(R)
Barricade with Blinkers

25 M.P.H.

W13-1(25)

↗

R3-9

ROAD CONSTRUCTION
1500 FT

LEFT LANE CLOSED AHEAD

W20-5d(L)

LEGEND

- Existing Roadway
- █ Constructed
- ▨ Under Construction
- ▤ Temporary Roadway

Exist. Temporary Crossover Pavement
to remain for future use until
ordered by the Engineer to be removed

Phase #2 - Temporary
Crossover
(See Note 8, Sht. 32)
Est. Quantities:
A.C. = 40 Tons
B.C. = 101 Tons
Subbase Course = 140 Tons
Roadway Exc. = 160 c.y.

DATE	
SURVEY PLOTTED BY	
DRAWN BY	
DESIGNED BY	
QUANTITIES BY	
CHECKED BY	
ORIGINAL PLAN	
NOTE BOOK	
No.	

Belt Collins & Associates Ltd.

STATE OF HAWAII
DEPARTMENT OF TRANSPORTATION
HIGHWAYS DIVISION
**ORDER OF WORK
AND DETOURS**
FARRINGTON HIGHWAY
PROJECT No 5-0900(3)
JUNE, 1964

SHEET No 2 OF 6 SHEETS

Belt Collins & Associates Ltd.

33 33

FED. ROAD DIST. NO.	STATE	FED. AID PROJ. NO.	FISCAL YEAR	SHEET NO.	TOTAL SHEETS
HAWAII	HAW.	5-09003	1965	34	162

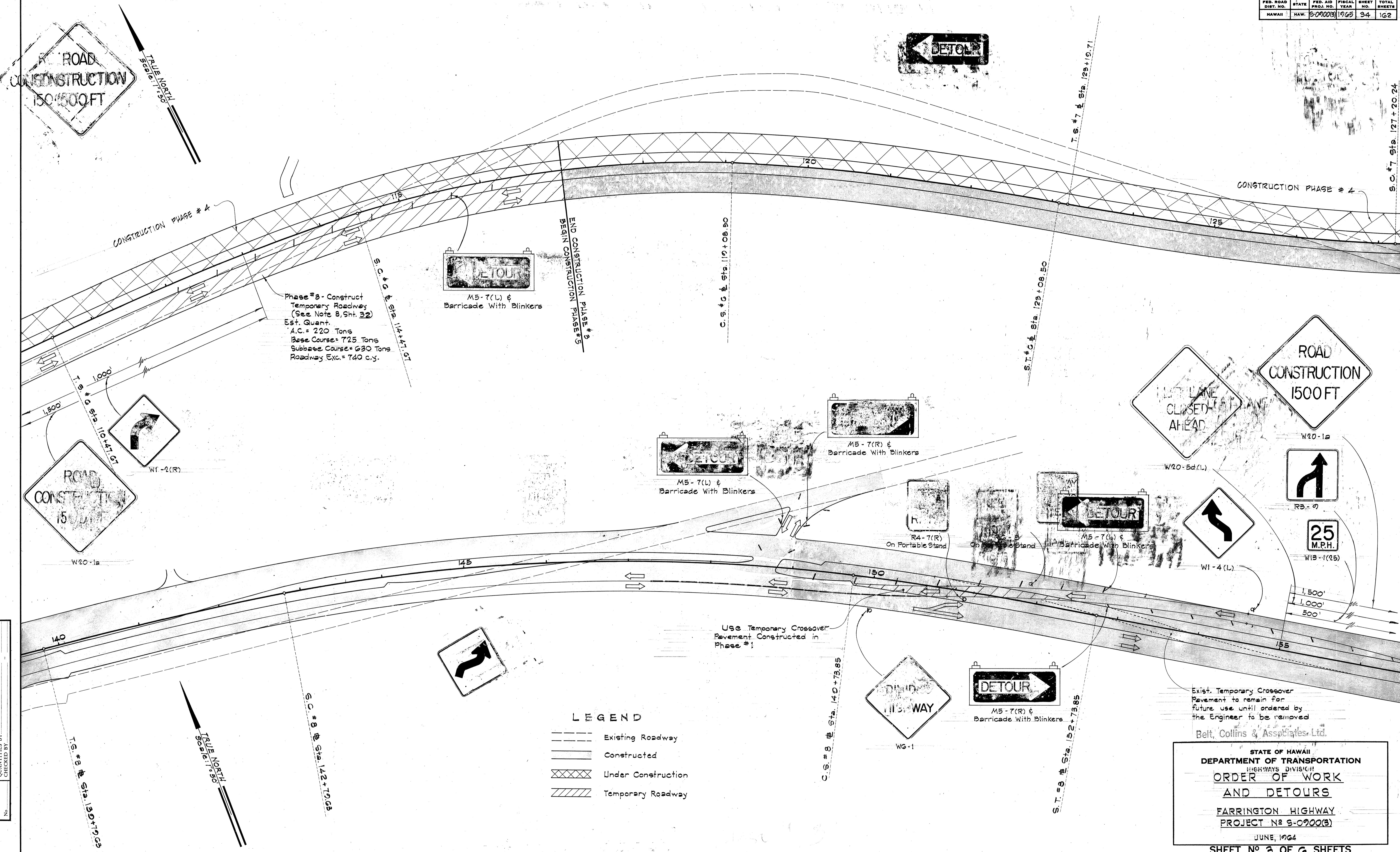

Phase #3 - Construct Temporary Roadway (See Note B, Sht. 32)
 Est. Quant.
 A.C. = 220 Tons
 Base Course = 725 Tons
 Subbase Course = 630 Tons
 Roadway Exc. = 740 c.y.

END CONSTRUCTION PHASE #3
 BEGIN CONSTRUCTION PHASE #4

Use Temporary Crossover Pavement Constructed in Phase #1

Exist. Temporary Crossover Pavement to remain for future use until ordered by the Engineer to be removed
 Belt, Collins & Associates, Ltd.

- LEGEND**
- Existing Roadway
 - ==== Constructed
 - XXXX Under Construction
 - //// Temporary Roadway

STATE OF HAWAII
 DEPARTMENT OF TRANSPORTATION
 HIGHWAYS DIVISION
**ORDER OF WORK
 AND DETOURS**
 FARRINGTON HIGHWAY
 PROJECT No 5-09003
 JUNE, 1964
 SHEET No 3 OF 6 SHEETS

ORIGINAL PLAN No. _____
 SURVEY BLOTTED BY _____ DATE _____
 DRAWN BY _____
 TRACED BY _____
 QUANTITIES BY _____
 CHECKED BY _____

FED. ROAD DIST. NO.	STATE	FED. AID PROJ. NO.	FISCAL YEAR	SHEET NO.	TOTAL SHEETS
HAWAII	HAW.	5-0900(3)	1965	35	122

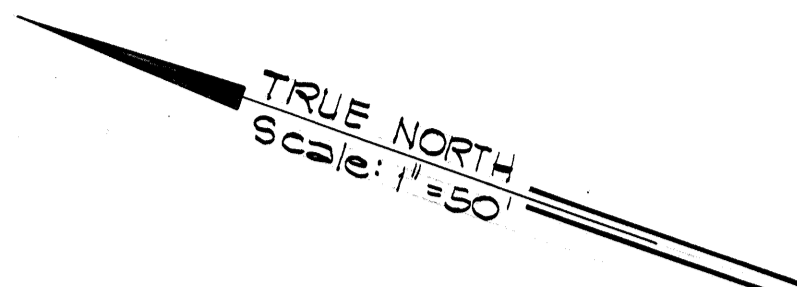
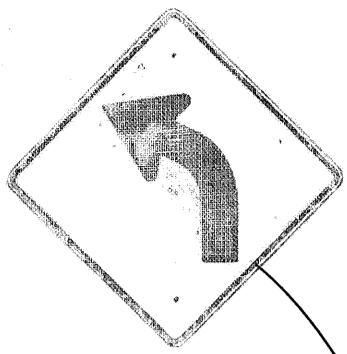

ROAD CLOSED
LOCAL TRAFFIC ONLY

DETOUR →

P10-3, M5-7(R) & Barricade with Blinkers

60" x 30", Middle line to be left blank

Begin Construction Phase # 4
End Construction Phase # 4

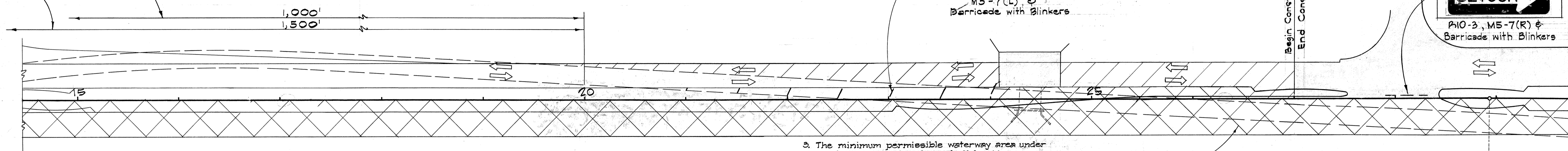

CURVE DATA

①	②	③
Δ = 15° 34' 00"	Δ = 33° 11' 00"	Δ = 17° 37' 00"
4/2 = 7° 47' 00"	4/2 = 16° 35' 30"	4/2 = 8° 48' 30"
R = 875.65	R = 366.87	R = 340.00
T = 110.67	T = 100.31	T = 52.60
C = 237.17	C = 200.52	C = 104.13
L = 237.90	L = 212.48	L = 104.54

Phase # 4 - Construct Temporary Roadway (See Note B, Sht. 32)
Est. Quant.
A.C. = 162 Tons
Base Course = 530 Tons
Subbase Course = 460 Tons
Roadway Exc. = 540 c.y.

Construction Phase # 4
1. Contractor shall demolish exist. wing walls and build Outbound Lanes structure as shown.
2. Contractor shall install temporary structure & 554' ± of temporary Roadway. Installation & removal of the temporary structure shall be considered incidental to the demolition of the exist. Bridge. (See Special Provisions)
Est. Quant.
A.C. = 60 Tons
Base Course = 190 Tons
Subbase Course = 166 Tons
Roadway Exc. = 760 c.y.

3. The minimum permissible waterway area under the temporary structure shall be 14 square feet. Two 36" culvert pipes may be used.

CONSTRUCTION PHASE # 5

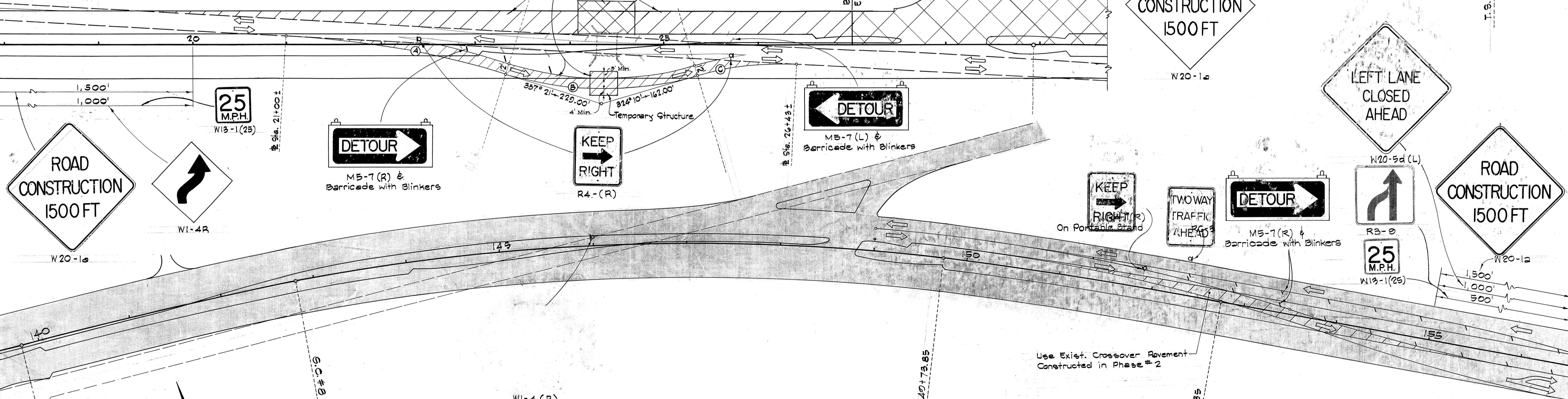

LEGEND

- Existing Roadway
- Constructed
- XXXX Under Construction
- //// Temporary Roadway

ORIGINAL SURVEY PLOTTED BY: DATE: _____
DRAWN BY: _____
DESIGNED BY: _____
CHECKED BY: _____
NOTE BOOK No. _____

Belt, Collins & Associates Ltd.

STATE OF HAWAII
DEPARTMENT OF TRANSPORTATION
HIGHWAYS DIVISION
**ORDER OF WORK
AND DETOURS**
FARRINGTON HIGHWAY
PROJECT No 5-0900(3)
JUNE, 1964
SHEET No 4 OF 6 SHEETS

FED. ROAD DIST. NO.	STATE	FED. AID PROJ. NO.	FISCAL YEAR	SHEET NO.	TOTAL SHEETS
HAWAII	HAW.	5-0900(3)	1965	36	162

Temporary Crossover
(See Note 8, Sht. 32)
Est. Quantities:
A.C. 16.0 Tons
Roadway Exc. 68.4 c.y.
B.C. 105.0 Tons

TRUE NORTH
Scale: 1"=50'

CONSTRUCTION PHASE #6

Phase #5 - Construct
Temporary Roadway
(See Note 8, Sht. 32)
Est. Quant.
A.C. = 72 Tons
Base Course = 230 Tons
Subbase Course = 200 Tons
Roadway Exc. = 240 c.y.

DETOUR

M5-7(L) +
Barricade with Blinkers

BEGIN CONSTRUCTION PHASE #7
END CONSTRUCTION PHASE #5

ROAD
CONSTRUCTION
1500 FT



W1-2(R)

TWO WAY
TRAFFIC
KEEP
AHEAD

DETOUR

M5-7(L) +
Barricade with Blinkers



W1-4(L)



R3-9

25
M.P.H.
W13-(25)

LEFT LANE
CLOSED
AHEAD

W20-5d(L)

ROAD
CONSTRUCTION
1500 FT

W20-1a

CONSTRUCT PHASE #6

BEGIN CONSTRUCTION PHASE #6

DIVIDED
HIGHWAY

W6-1

KEEP
RIGHT

R4-7(R)

Temporary Crossover
(See Note 8, Sht. 32)
Est. Quantities:
A.C. = 36 Tons 52.3 Tons
B.C. = 115 Tons
Subbase Course = 100 Tons
Roadway Exc. = 120 c.y. 70.0 c.y.

DETOUR

M5-7(R)
Barricade with Blinkers

LEGEND

- Existing Roadway
- ▬ Constructed
- XXXX Under Construction
- ▨ Temporary Roadway

TRUE NORTH
Scale: 1"=50'

SURVEY PLOTTED BY	DATE
DESIGNED BY	
TRACED BY	
NOTE BOOK	
QUANTITIES BY	
CHECKED BY	

Belt, Collins & Associates Ltd.

STATE OF HAWAII
DEPARTMENT OF TRANSPORTATION
HIGHWAYS DIVISION
**ORDER OF WORK
AND DETOURS**
FARRINGTON HIGHWAY
PROJECT NO 5-0900(3)
JUNE, 1964
SHEET NO 5 OF 6 SHEETS

FED. ROAD DIST. NO.	STATE	FED. AID PROJ. NO.	FISCAL YEAR	SHEET NO.	TOTAL SHEETS
HAWAII	HAW.	5-0700(3)	1964	37	162

TRUE NORTH
Scale: 1"=50'

Temporary Crossover
(See Note B, Sht. 32)
Est. Quantities:
A.C. = 58 Tons
B.C. = 189 Tons
Roadway Exc. = 126 c.y.

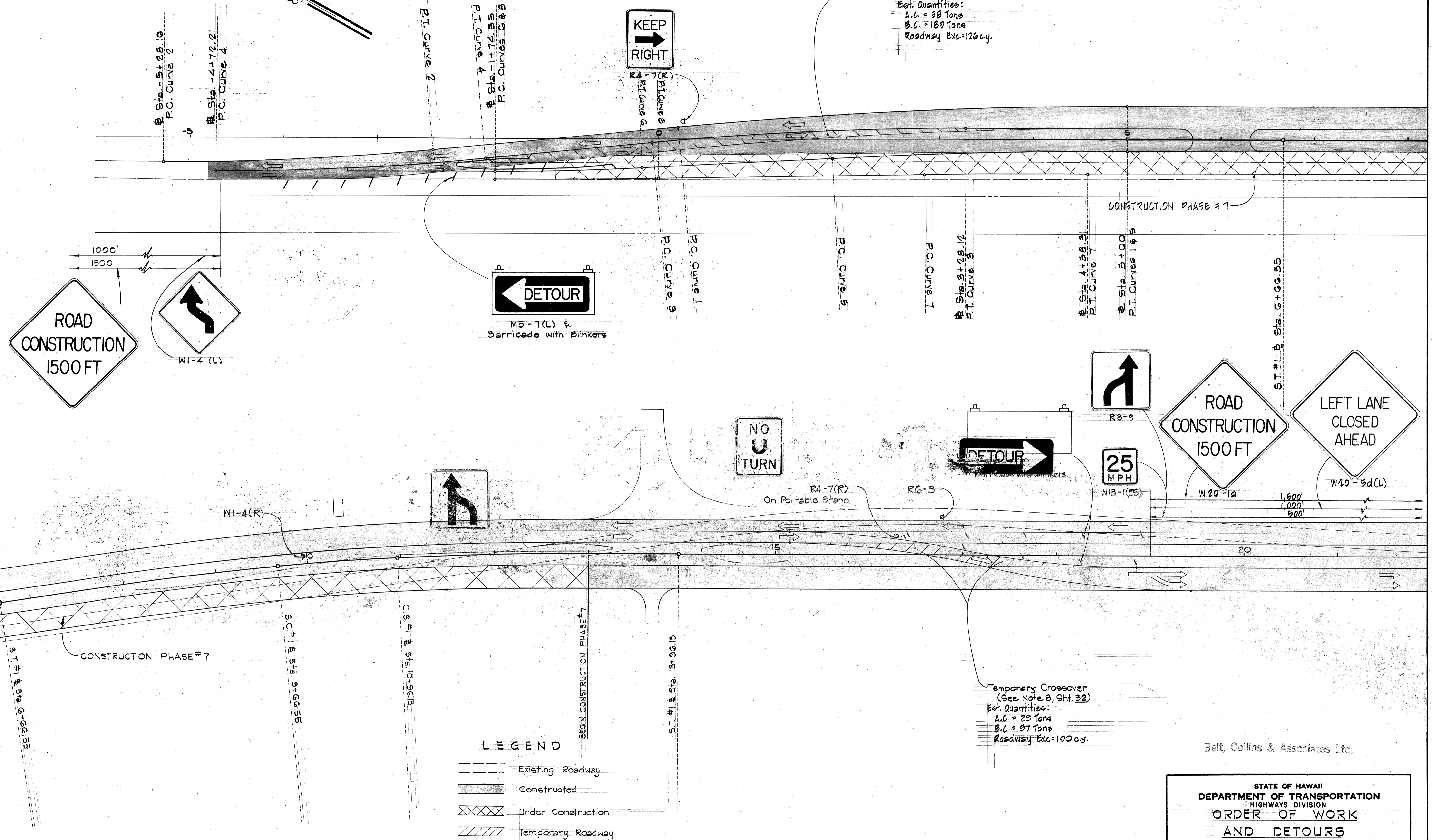

LEGEND

- Existing Roadway
- Constructed
- XXXX Under Construction
- //// Temporary Roadway

DATE: _____
 SURVEY PLOTTED BY: _____
 DRAWN BY: _____
 DESIGNED BY: _____
 CHECKED BY: _____
 ORIGINAL PLAN: _____
 NOTE BOOK: _____
 No. _____

STATE OF HAWAII
 DEPARTMENT OF TRANSPORTATION
 HIGHWAYS DIVISION
**ORDER OF WORK
 AND DETOURS**
 FARRINGTON HIGHWAY
 PROJECT NO 5-0700(3)
 JUNE, 1964
 SHEET NO 6 OF 6 SHEETS

Belt, Collins & Associates Ltd.