

FILE NO.	DATE	PROJ. NO.	SHEET NO.	TOTAL SHEETS
100-0-01	4-24-61	D-0900-01-59	59	100

"AS BUILT" PLAN

NO CHANGE WAS MADE DURING CONSTRUCTION OF THIS PROJECT.

R. T. Smith
RESIDENT ENGINEER
DATE: 11-10-61

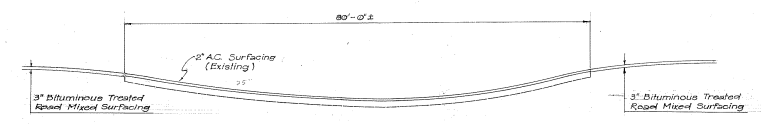

APPROXIMATE PROFILE OF EXISTING CONCRETE FORD

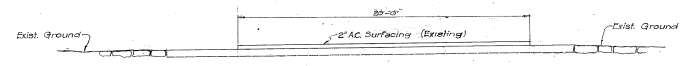

CROSS SECTION OF EXISTING CONCRETE FORD

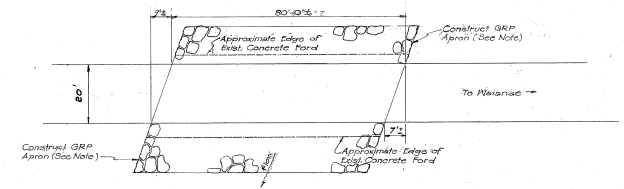

PLAN - EXISTING CONCRETE FORD

NOTE:
All work on existing concrete fords to be done by others. No asphalt work on existing fords.

GROSS LENGTH OF PROJECT.....1.620 Mile
CONCRETE FORDS.....0.085 Mile
NET LENGTH OF ROADWAY.....1.535 Mile

APPROVED: *Sam O. Hirose*
DATE: 4-24-61
FOR DIRECTOR OF TRANSPORTATION

DEPARTMENT OF TRANSPORTATION
DIVISION OF HIGHWAYS
STATE OF HAWAII
IMPROVEMENTS OF A PORTION OF KAENA POINT ROAD
(MAKUA TO SATELLITE TRACKING STATION ROAD)
PROJ. NO. D-0900-01-59
SCALE: AS NOTED

SHEET No. OF SHEETS

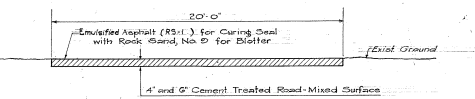
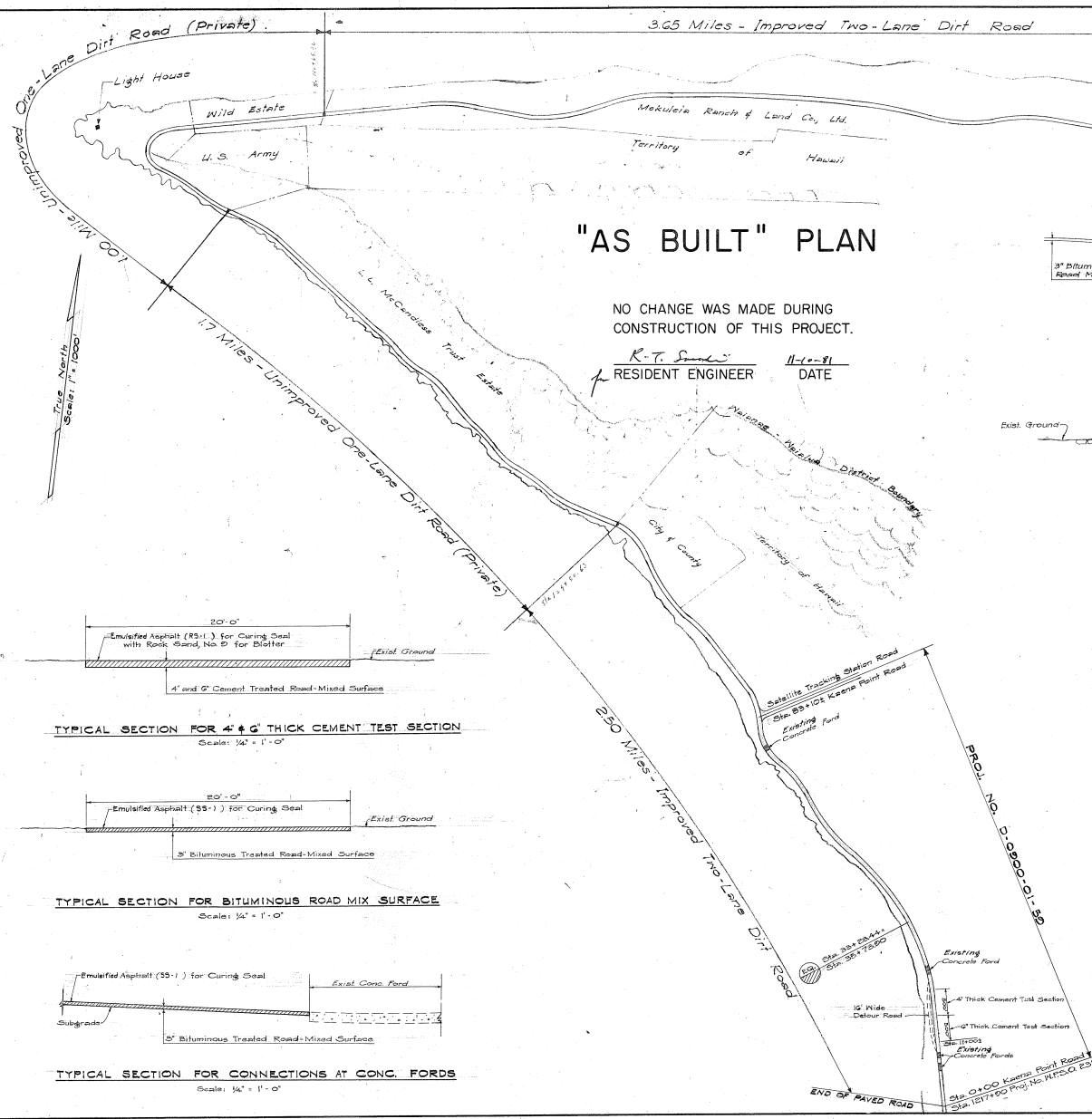

TYPICAL SECTION FOR 4' x 6' THICK CEMENT TEST SECTION

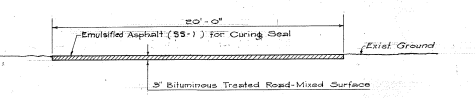

TYPICAL SECTION FOR BITUMINOUS ROAD MIX SURFACE

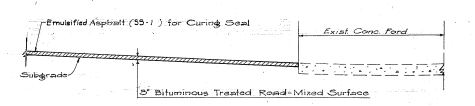

TYPICAL SECTION FOR CONNECTIONS AT CONC. FORDS

SURVEY PLANNED BY	DATE
DESIGNED BY	
DRAWN BY	
CHECKED BY	
ORIGINAL PLAN	
QUANTITIES CHECKED BY	
NO.	

H-3