

**TYPICAL JOINT LAYOUT PLAN WITH SKEWED JOINTS**

Not to Scale

**NOTES:**

1. The dimensions shown are for a 12 foot wide travel way lane width. For other lane widths adjust the transverse joint spacing to obtain a length to width ratio of not greater than 1.25 for the travel way lane slabs.
2. Skew the typical transverse joint with a 2 foot offset counter clockwise from a perpendicular to the edge of pavement for every 12 feet along that perpendicular.
3. Space transverse joint at successive intervals at 12', 15', 13', and 14' in the direction of travel. Repeat for the remaining joints.
4. For travel way lanes, reinforce odd shaped slabs and slabs with mismatched joints. Odd shaped slabs are slabs with length to width ratios greater than 1.25 and other nonsquare shaped slabs. Triangular shapes are not allowed.
5. For the shoulder, reinforcing is not required for slabs that exceed the length to width ration of 1.25. Triangular shapes are not allowed.
6. Locate transverse construction joints at a minimum distance of ten (10) feet from the nearest planned construction joint.
7. Provide shop drawings for joint layout where obstructions such as manholes are encountered, and at intersections with other streets.
8. For other Joint Requirements, See Section 411 of the Special Provisions and/or Standard Specifications

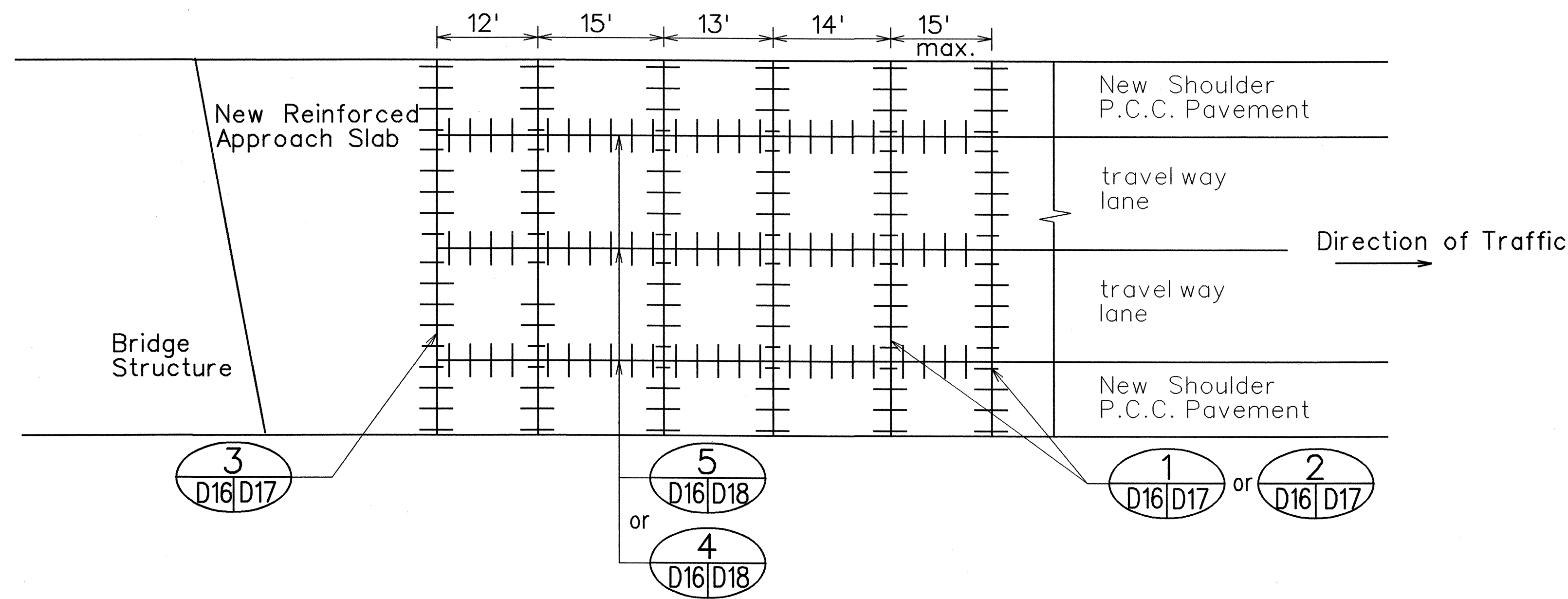

**TRANSVERSE JOINT TRANSITION  
ODD SKEW TO TYPICAL SKEW**

Not to Scale

ORIGINAL PLAN	SURVEY PLOTTED BY	DATE
NOTE BOOK	DRAWN BY	
DESIGNED BY	CHECKED BY	
066 Jen Samud		
06/06/06		

STATE OF HAWAII DEPARTMENT OF TRANSPORTATION HIGHWAYS DIVISION	
<b><u>P.C.C. PAVEMENT LAYOUT</u></b>	
<b><u>NIMITZ HIGHWAY AND</u></b>	
<b><u>ALA MOANA BOULEVARD RESURFACING</u></b>	
<b><u>Fort Street to Piikoi Street</u></b>	
<b><u>Project No. 92AB-01-06M</u></b>	
Scale: Not to Scale	Date: April 2006
SHEET No. 1 OF 1 SHEETS	

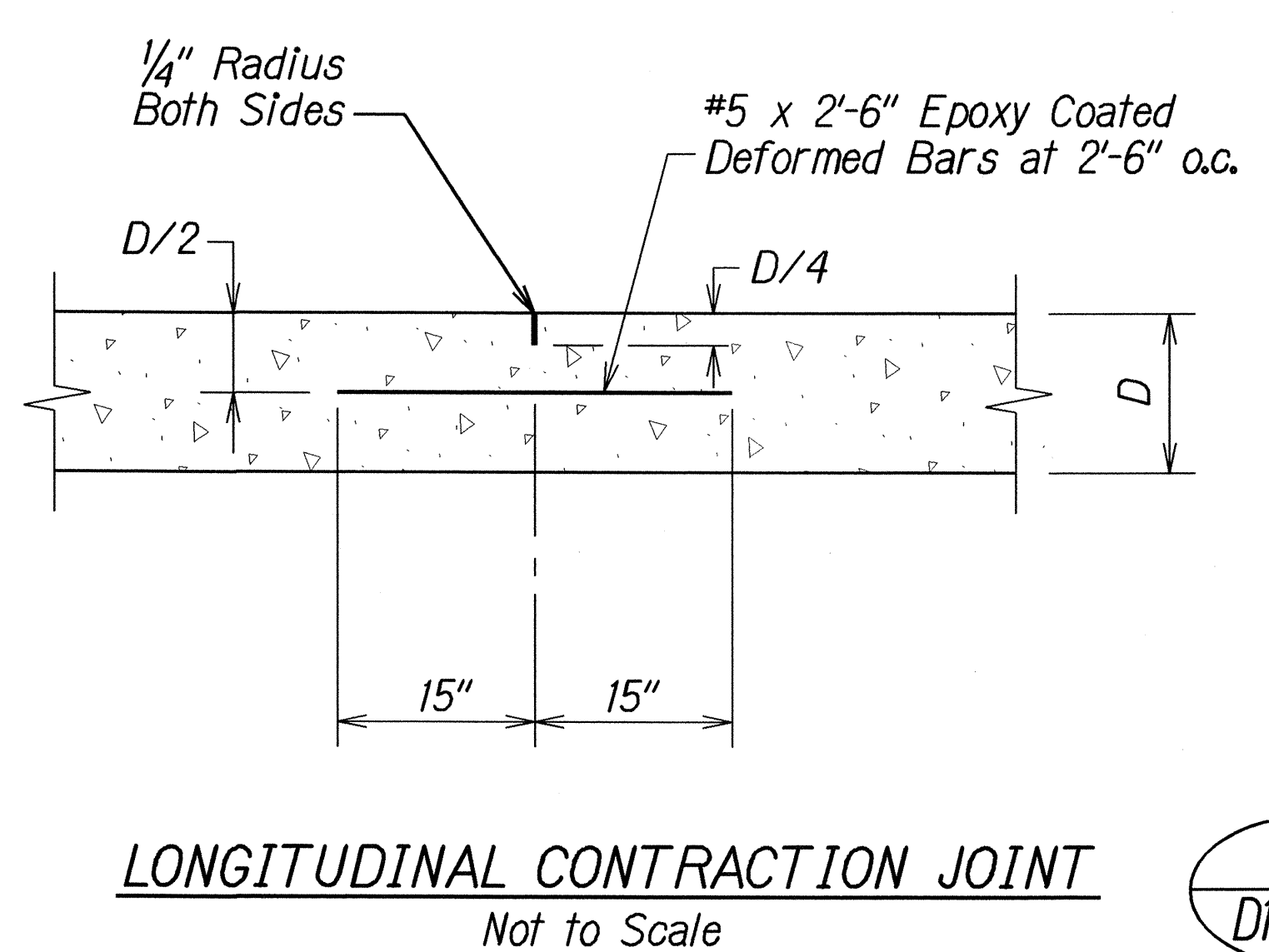
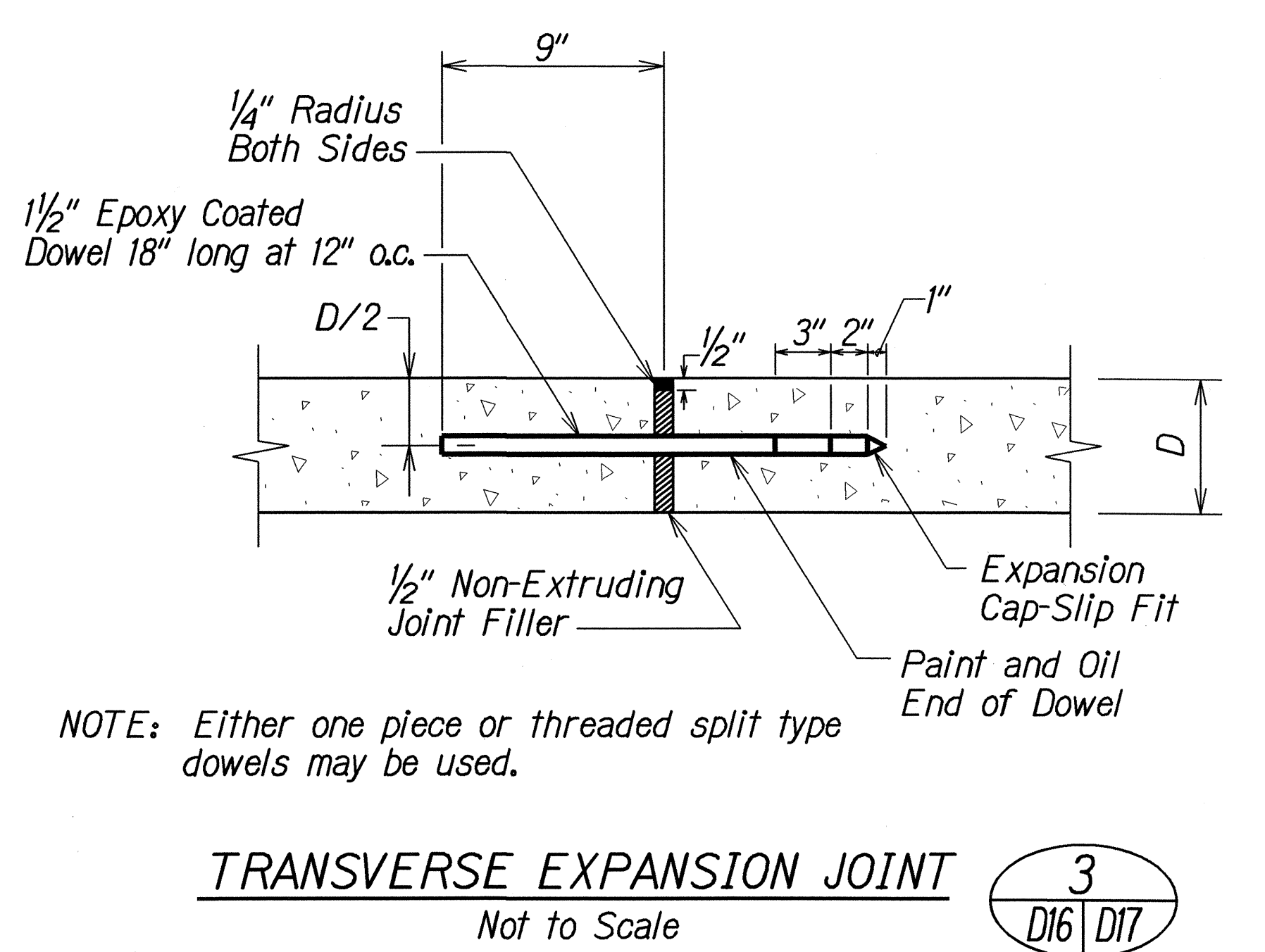
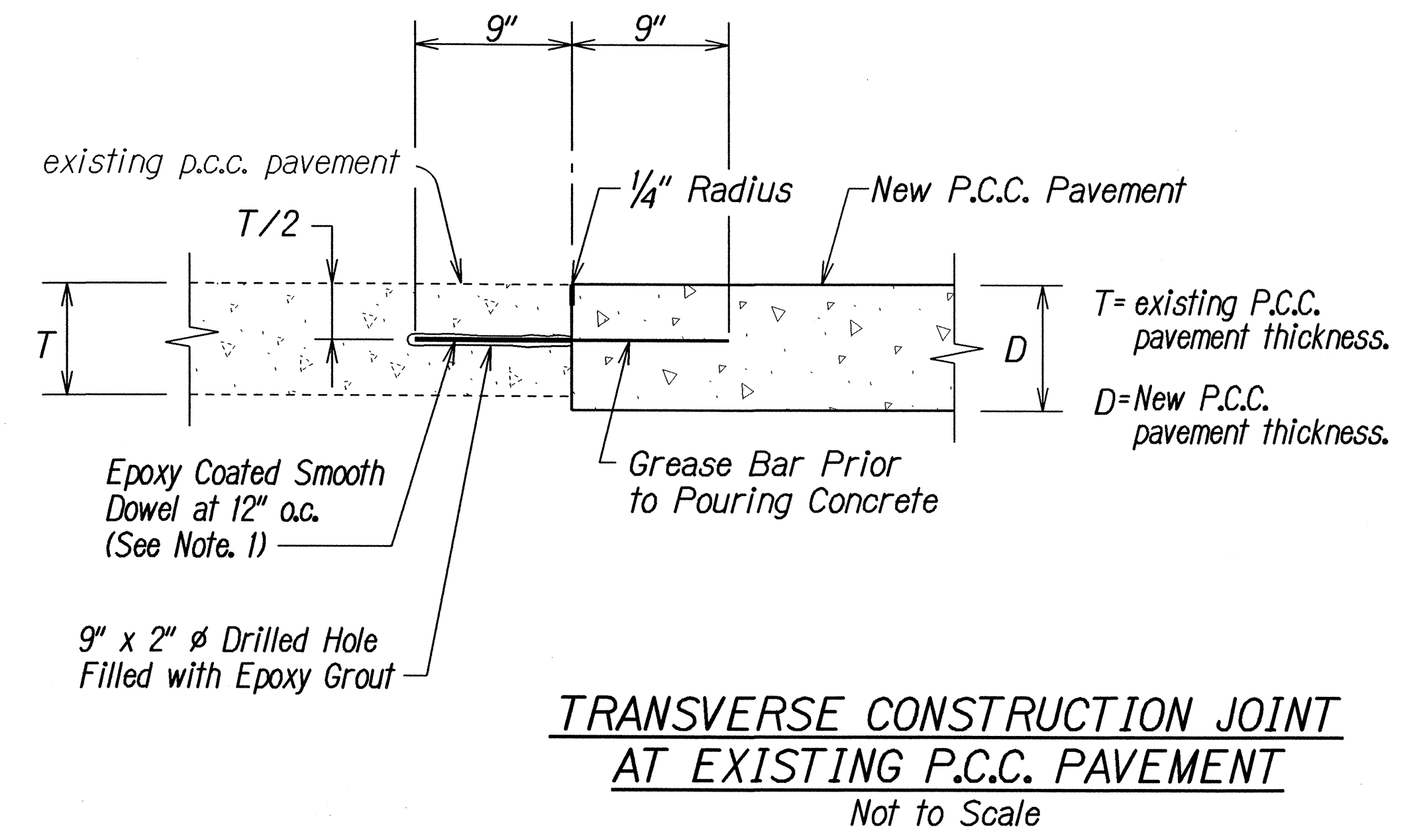
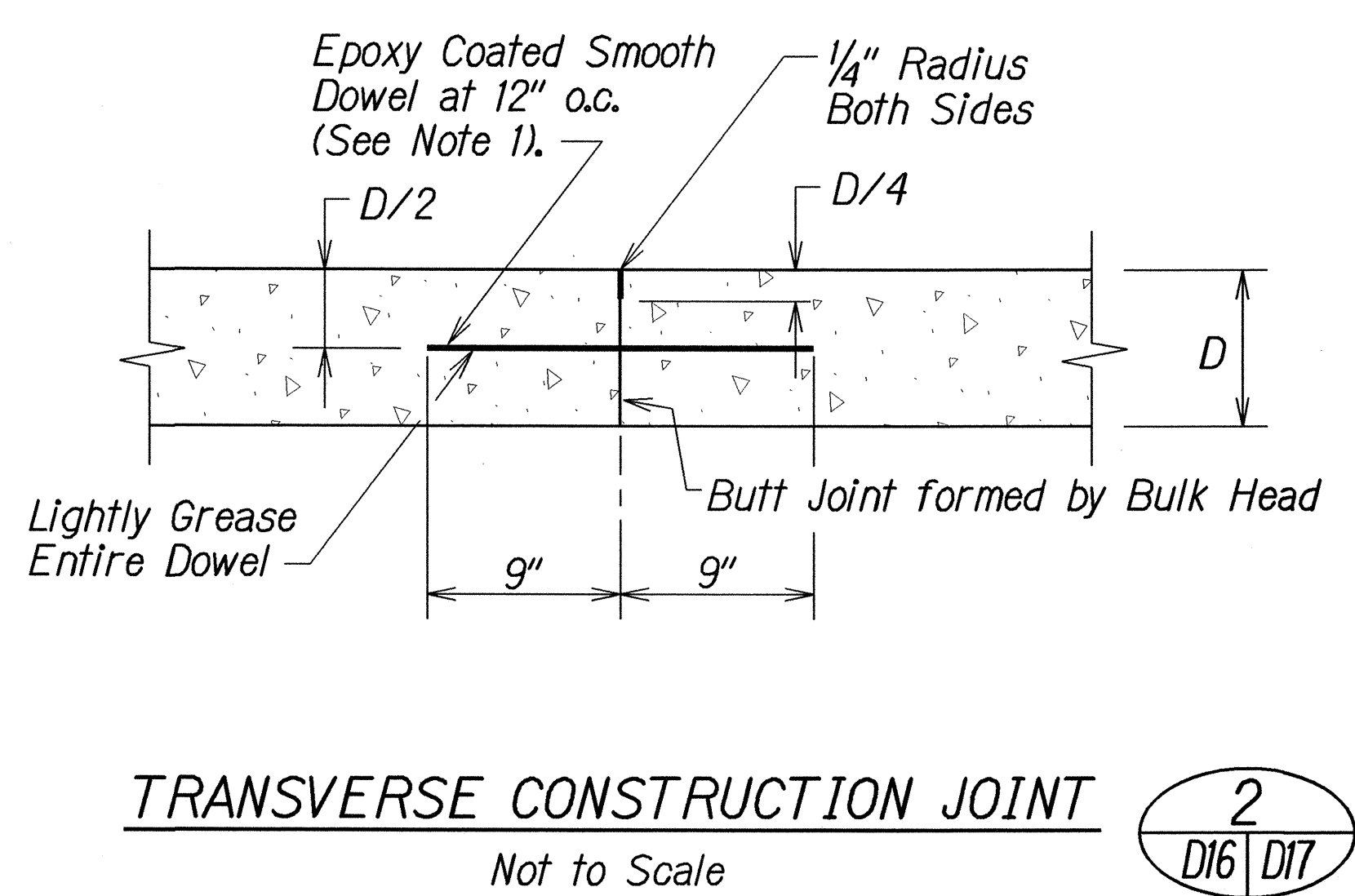
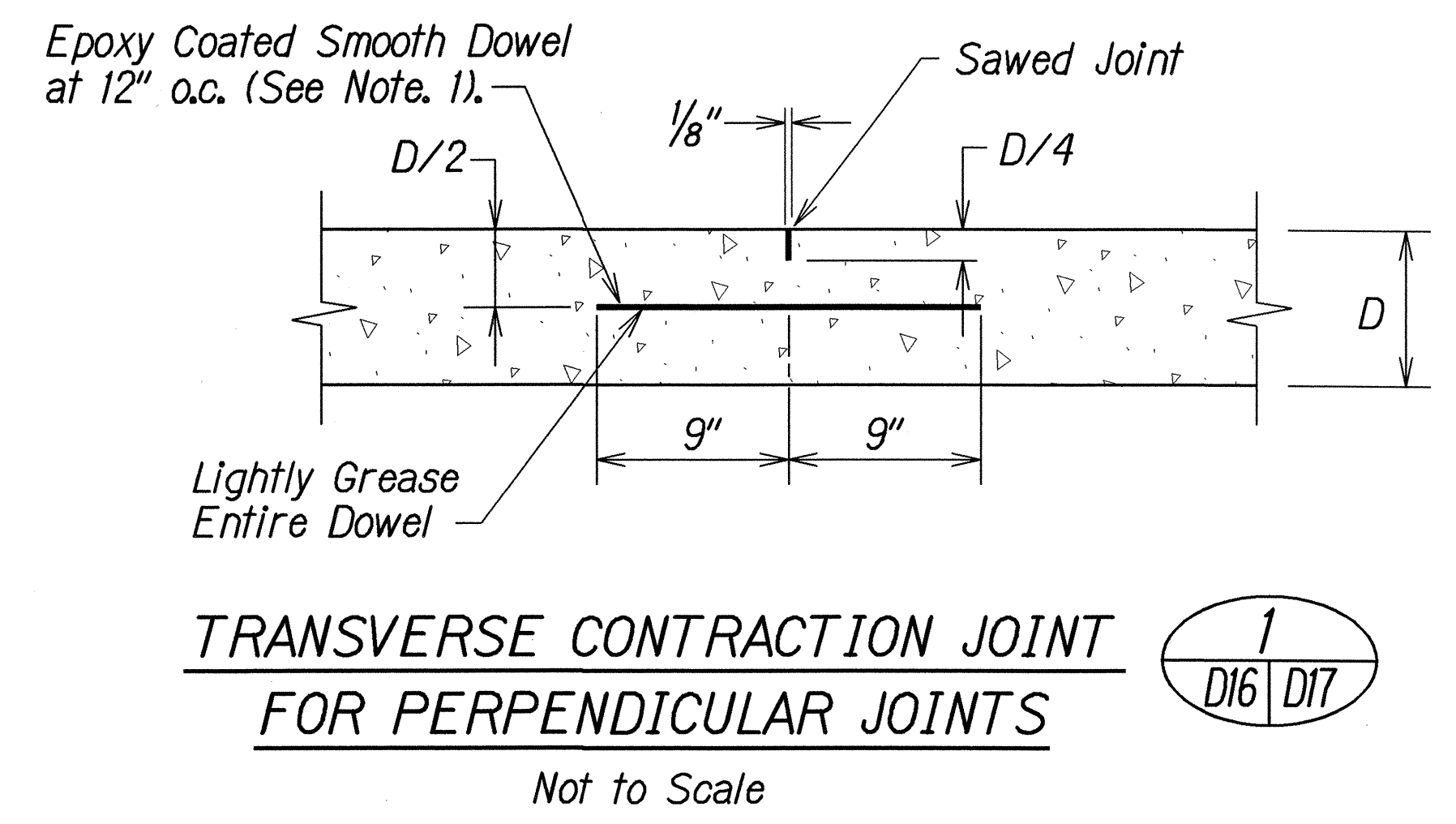

- NOTES:**
- Epoxy Coated Dowels shall Conform to AASHTO M284/M 284/M-95 Grade, 40 or 60. For pavements with  $D < 10"$ , use  $1/4" \times 1'-6"$  long dowels. For pavements with  $D > 10"$ , use  $1/2" \times 1'-6"$  long dowels.
  - Transverse Construction Joints shall be located at a Minimum Distance of 10 Feet from the Nearest Transverse Contraction Joint. Joint shall be perpendicular to paving lane.
  - It is critical that dowels be positioned in place parallel to the pavement surface and paving lane direction to avoid future cracks in the P.C.C. pavement. The ends of the dowels shall not deviate more than 0.01' from the parallel in 9' length.
  - See Typical Joint Location and Layout Plan for Transverse Joint Spacing.
  - The Contractor shall not damage the epoxy coating on the dowel in any way during shipment, handling, or placement. Damaged epoxy coated dowels shall be replaced at no cost to the State.
  - Tiebars are to be located a minimum distance of 15 inches from a transverse joint. Tiebars closer to the transverse joint may interfere with joint movement.

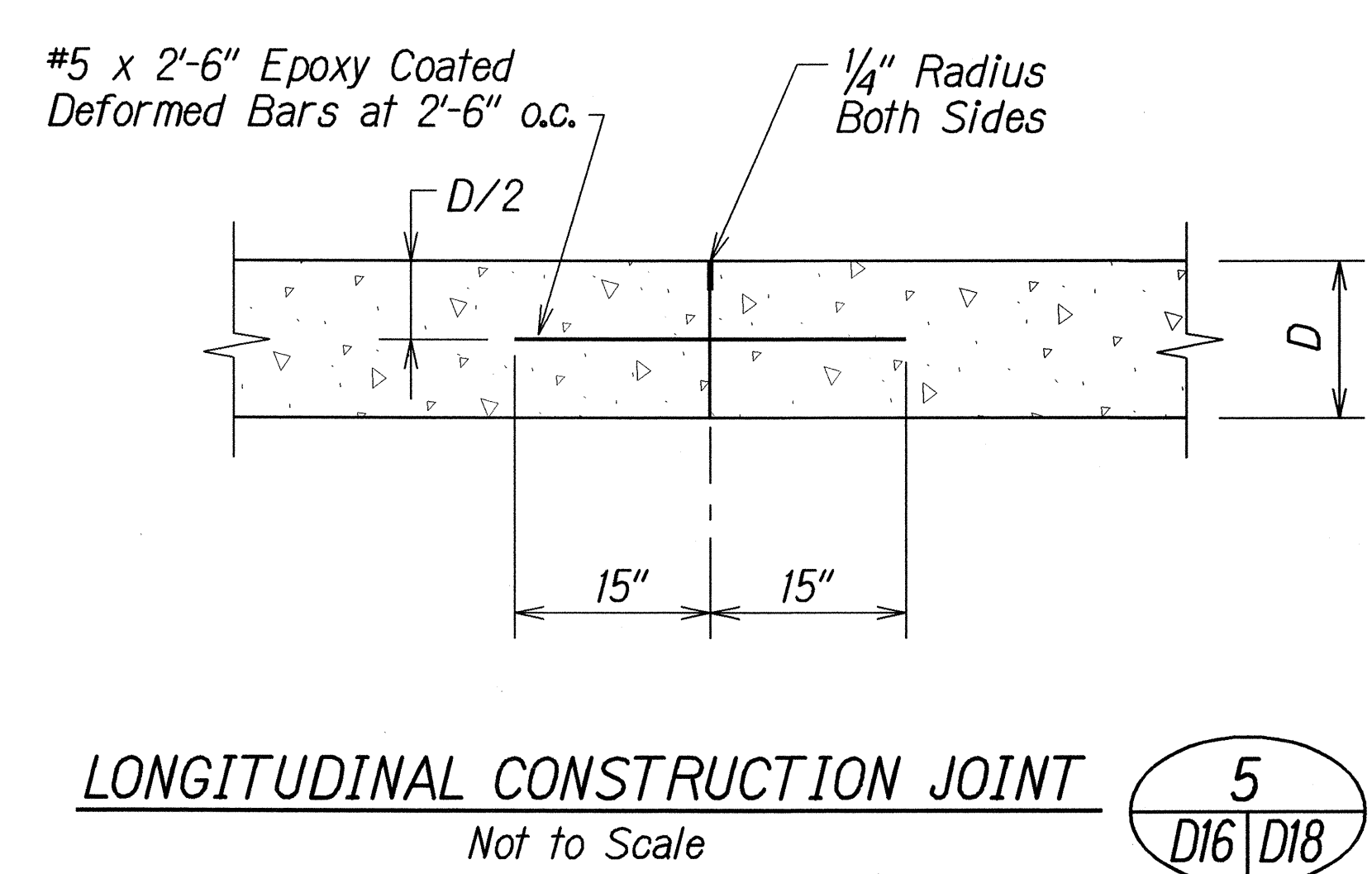
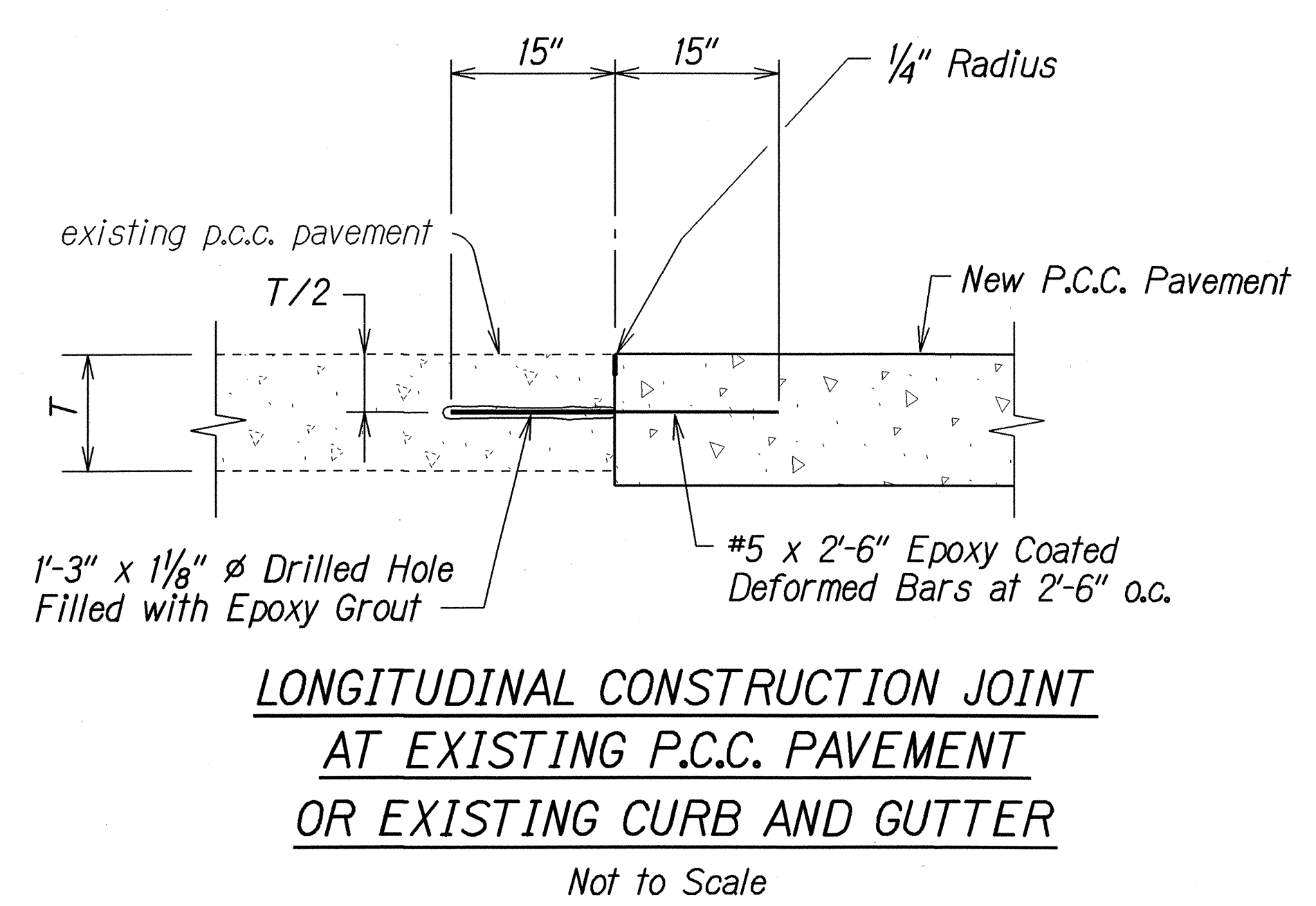

ORIGINAL PLAN	SURVEY PLOTTED BY	DATE
DRAWN BY		
TRACED BY		
DESIGNED BY		
CHECKED BY		
NOTED BY		

STATE OF HAWAII  
DEPARTMENT OF TRANSPORTATION  
HIGHWAYS DIVISION

**P.C.C. PAVEMENT JOINT DETAILS**

NIMITZ HIGHWAY AND  
ALA MOANA BOULEVARD RESURFACING  
Fort Street to Piikoi Street  
Project No. 92AB-01-06M

Scale: Not to Scale      Date: April 2006

SHEET No. 1 OF 1 SHEETS