

FED. ROAD DIST. NO.	STATE	FED. AID PROJ. NO.	FISCAL YEAR	SHEET NO.	TOTAL SHEETS
HAWAII	HAW.	NH-092-1(030)	2021	ADD. 18	50

O.B. # Sta. 90+51± to O.B. # Sta. 90+64±, o.s. 22.57'± Lt.
O.B. # Sta. 90+67± to O.B. # Sta. 90+82±, o.s. 60.28'± Rt.

*Demolish existing curb ramps and replace with 5' Wide Concrete Sidewalk (up to face of existing back curb) and Type 2D Curb. For details, see Standard Plans D-05 and D-15. Any damage to the existing shoulder shall be reconstructed with 2" PMA over 3" ACB With Polymer Modified Asphalt.

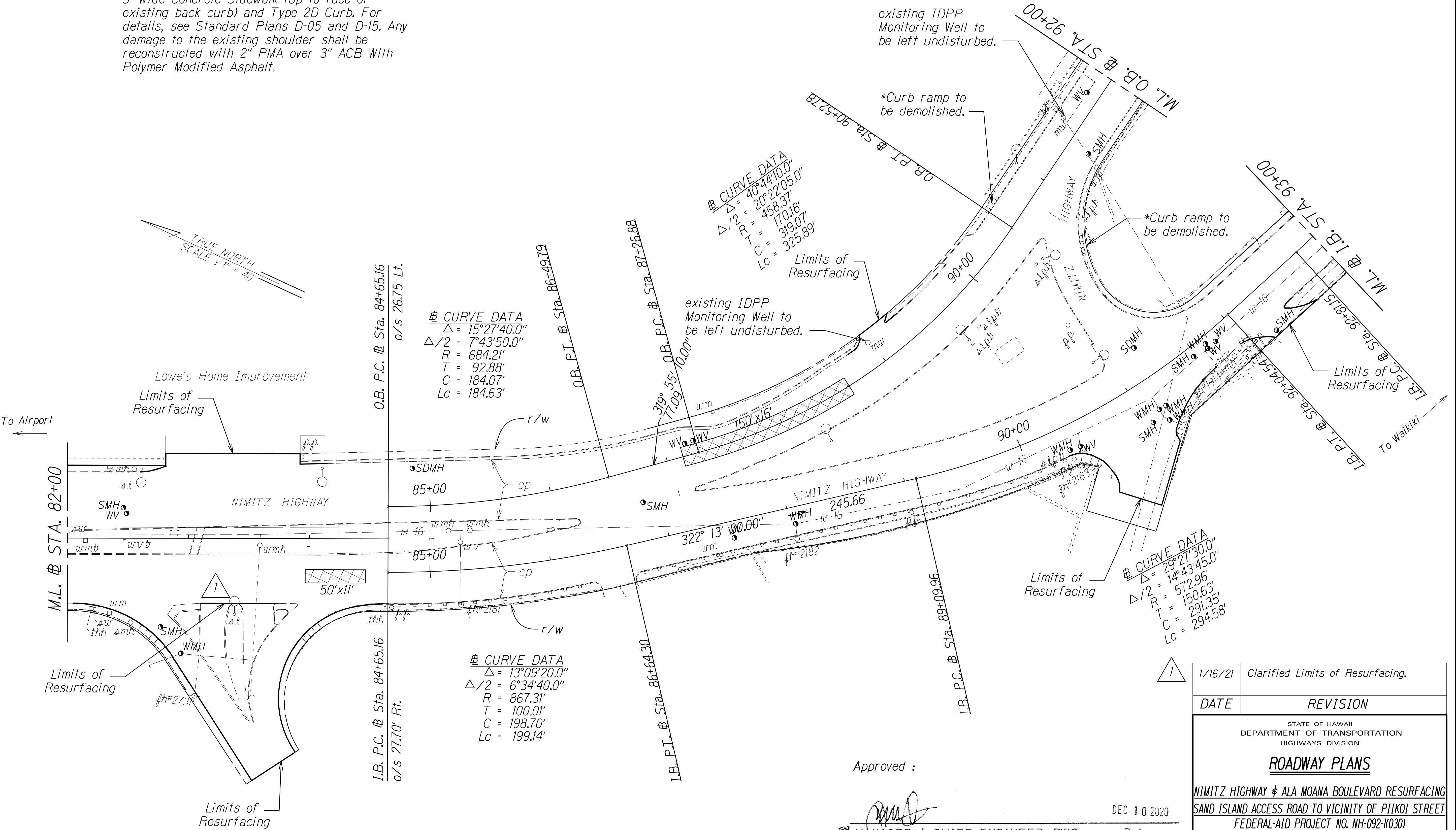

SURVEY PLOTTED BY	DATE
DRAWN BY	
TRACED BY	
DESIGNED BY	
CHECKED BY	

ORIGINAL PLAN	
NOTE BOOK	
DATE	

Note: Adjust Water Manhole and Water Valve Box frames and covers to new finish grade.

Approved :

MANAGER & CHIEF ENGINEER, BWS
(For work affecting BWS Facilities in City/State R/W and BWS easements only)

DEC 10 2020

Date

1/16/21 Clarified Limits of Resurfacing.

DATE REVISION

STATE OF HAWAII
DEPARTMENT OF TRANSPORTATION
HIGHWAYS DIVISION
ROADWAY PLANS
NIMITZ HIGHWAY & ALA MOANA BOULEVARD RESURFACING
SAND ISLAND ACCESS ROAD TO VICINITY OF PIKOI STREET
FEDERAL-AID PROJECT NO. NH-092-1(030)

Scale: 1" = 40.0' Date: November, 2020

SHEET No. 6 OF 12 SHEETS

ADD. 18

FED. ROAD DIST. NO.	STATE	FED. AID PROJ. NO.	FISCAL YEAR	SHEET NO.	TOTAL SHEETS
HAWAII	HAW.	NH-092-1(030)	2021	ADD. 22	50

Reconstruct Entire Roadway from Sta. 22+37.5 to Sta. 7+15.0

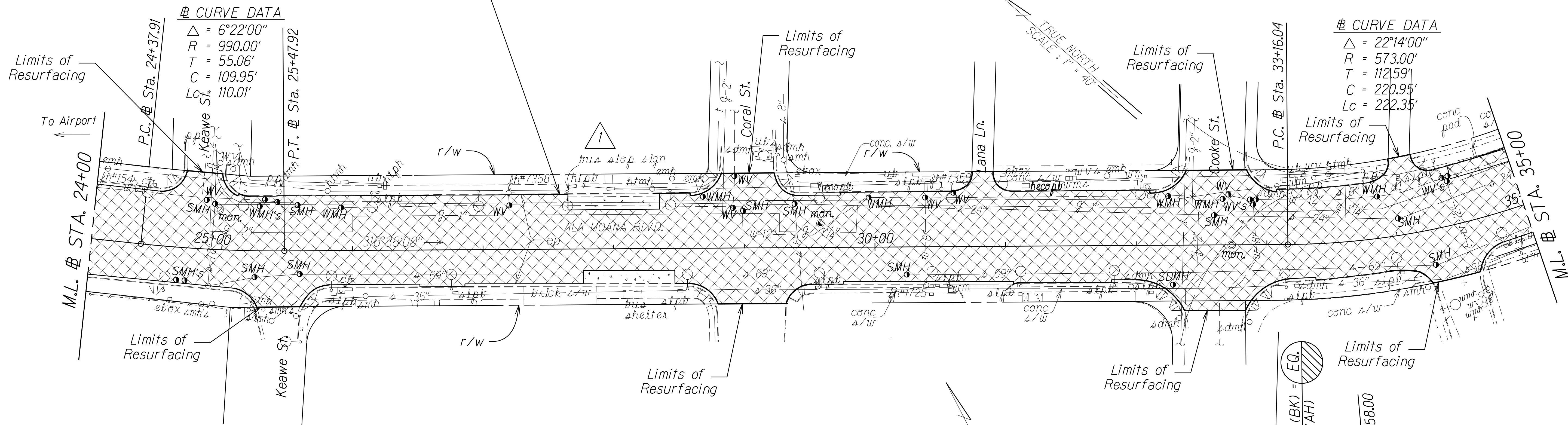

Reconstruct Entire Roadway from Sta. 22+37.5 to Sta. 7+15.0

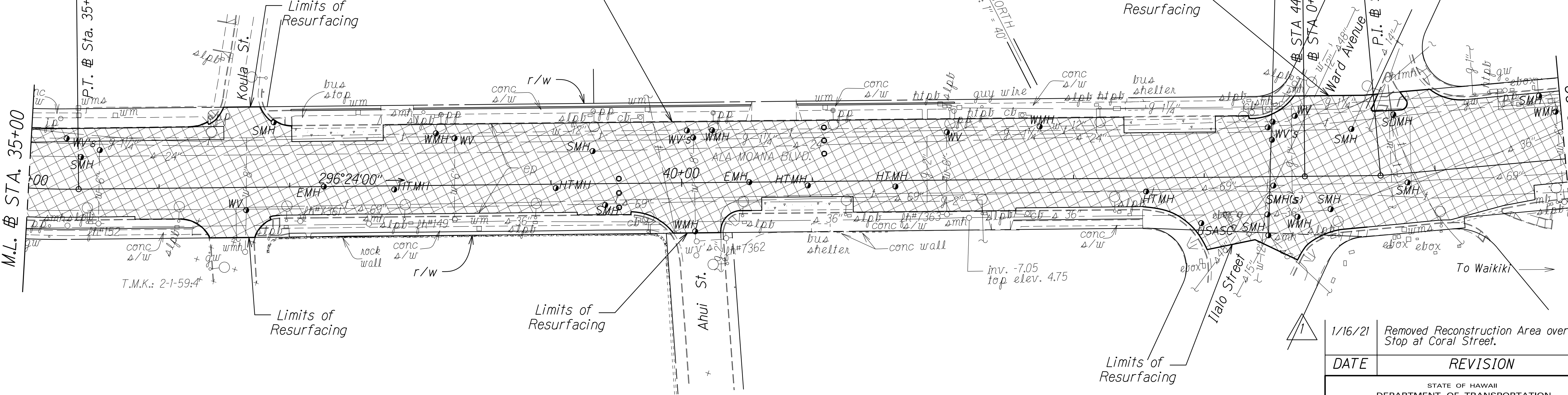

- Accusense Mag In-Pavement Sensor replacement work to be done by others.

Note: Adjust Water Manhole and Water Valve Box frames and covers to new finish grade.

Approved :

[Signature]

MANAGER & CHIEF ENGINEER, BWS
(For work affecting BWS Facilities in City/State R/W and BWS easements only)

DEC 10 2020

Date

1/16/21	Removed Reconstruction Area over Bus Stop at Coral Street.
DATE	REVISION
STATE OF HAWAII DEPARTMENT OF TRANSPORTATION HIGHWAYS DIVISION	
ROADWAY PLANS	
NIMITZ HIGHWAY & ALA MOANA BOULEVARD RESURFACING SAND ISLAND ACCESS ROAD TO VICINITY OF PIKOI STREET FEDERAL-AID PROJECT NO. NH-092-1(030)	
Scale: 1" = 40.0'	Date: November, 2020
SHEET No. 10 OF 12 SHEETS	

FED. ROAD DIST. NO.	STATE	FED. AID PROJ. NO.	FISCAL YEAR	SHEET	TOTAL SHEETS
HAWAII	HAW.	NH-092-1(030)	2021	ADD. 33	50

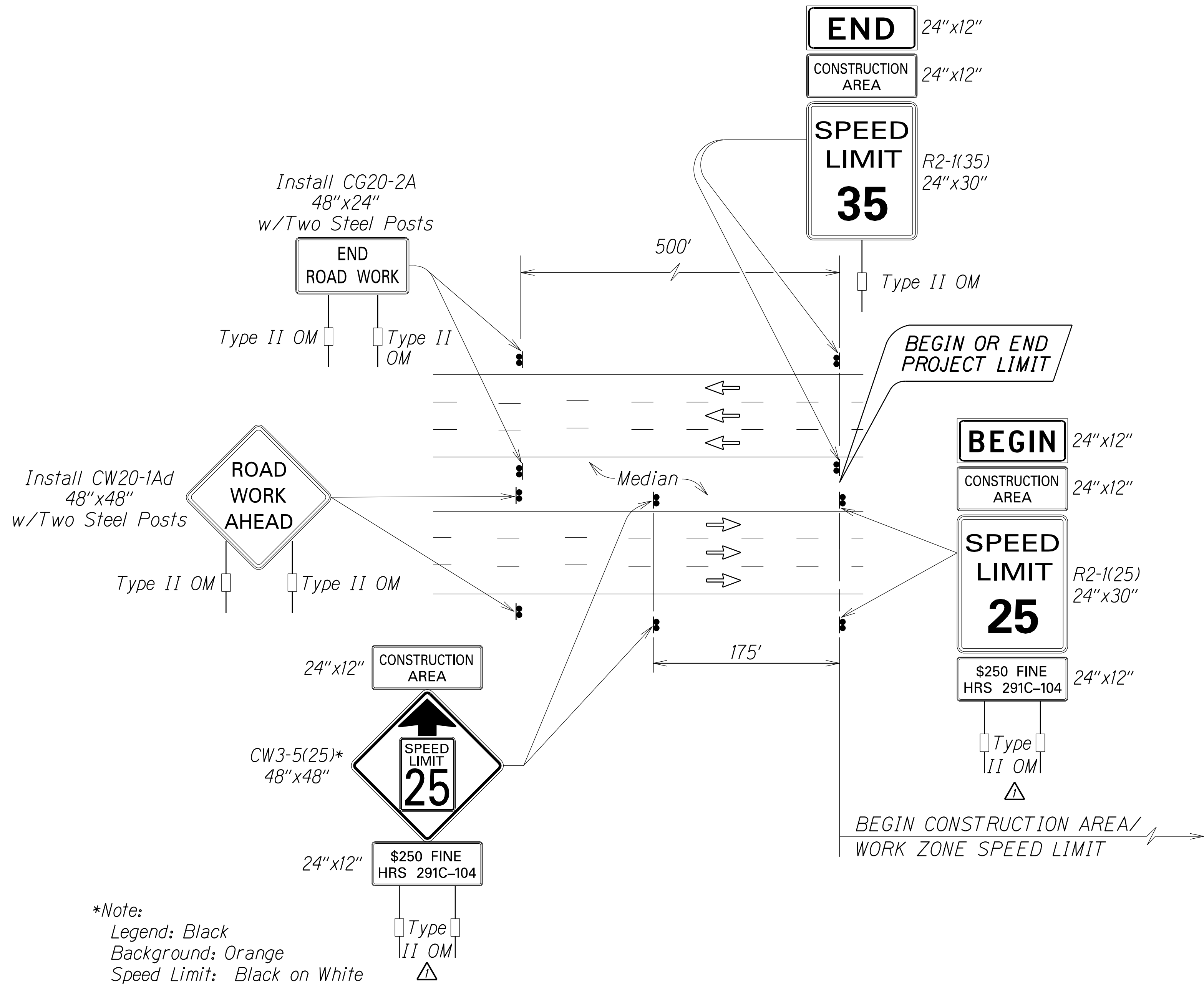

*Note:
Legend: Black
Background: Orange
Speed Limit: Black on White

TYPICAL DETAIL FOR CONSTRUCTION SIGNS
ON MULTILANE DIVIDED LOW SPEED HIGHWAY

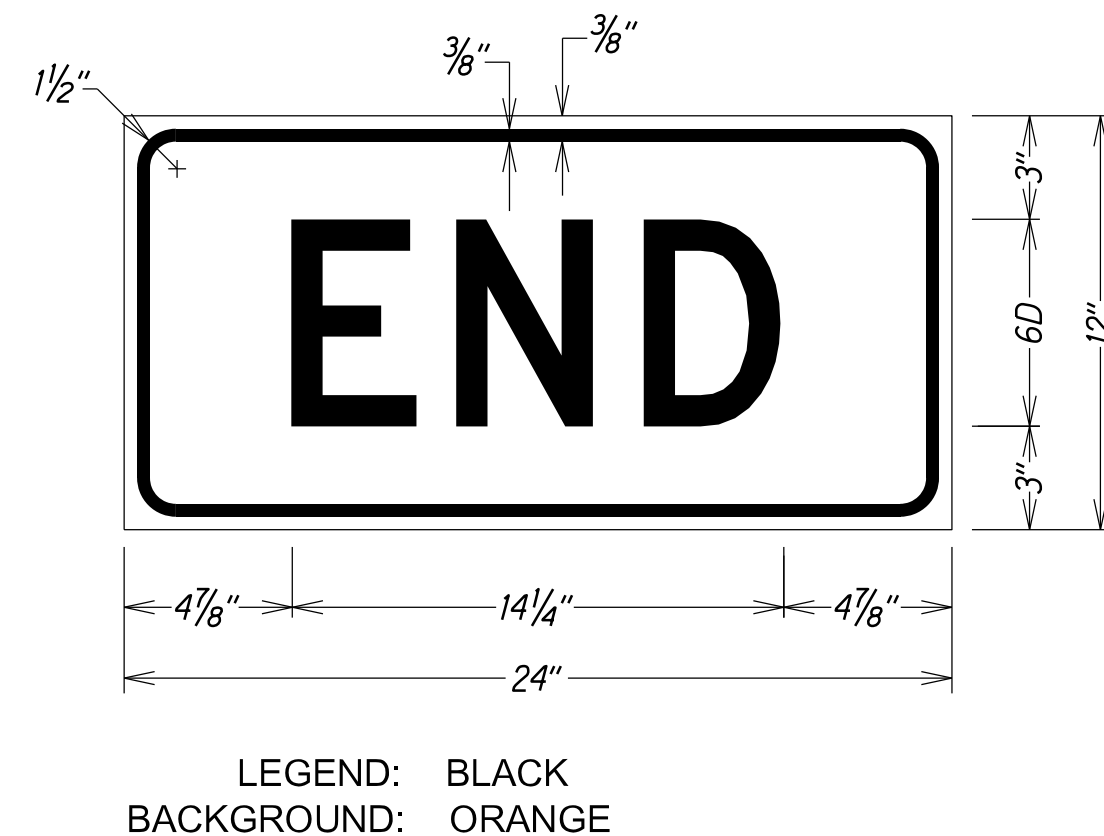
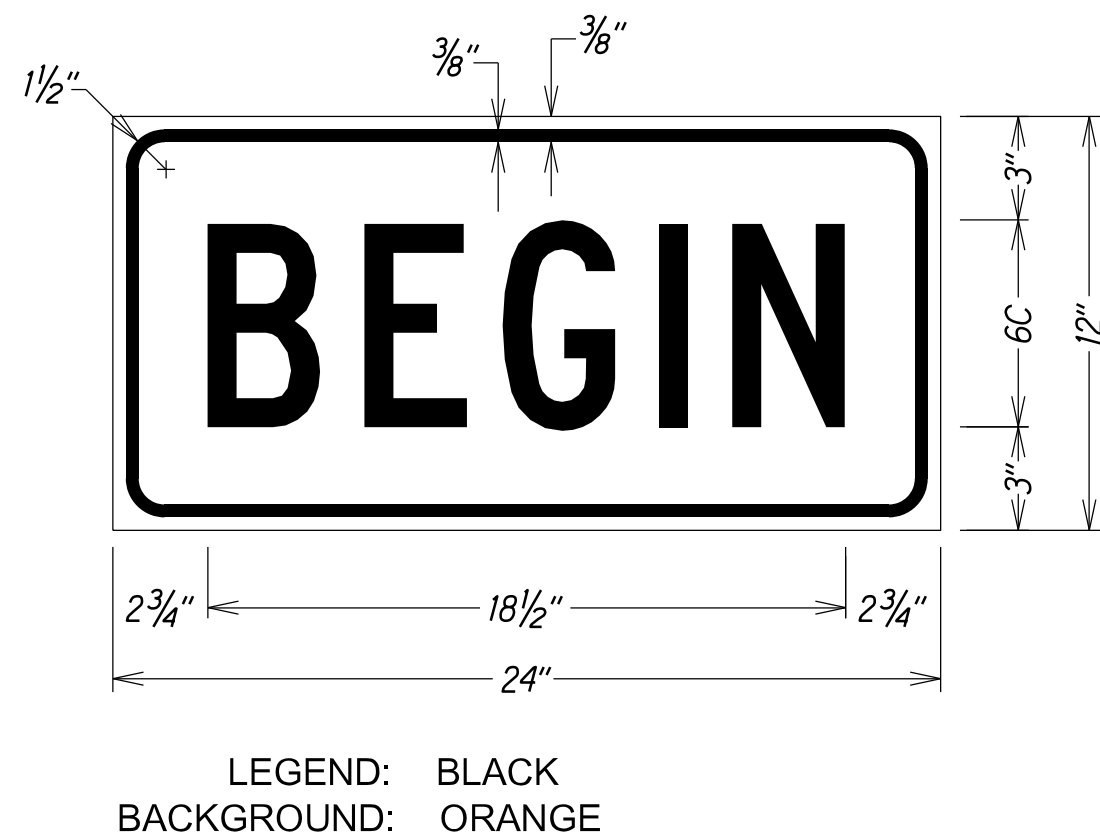
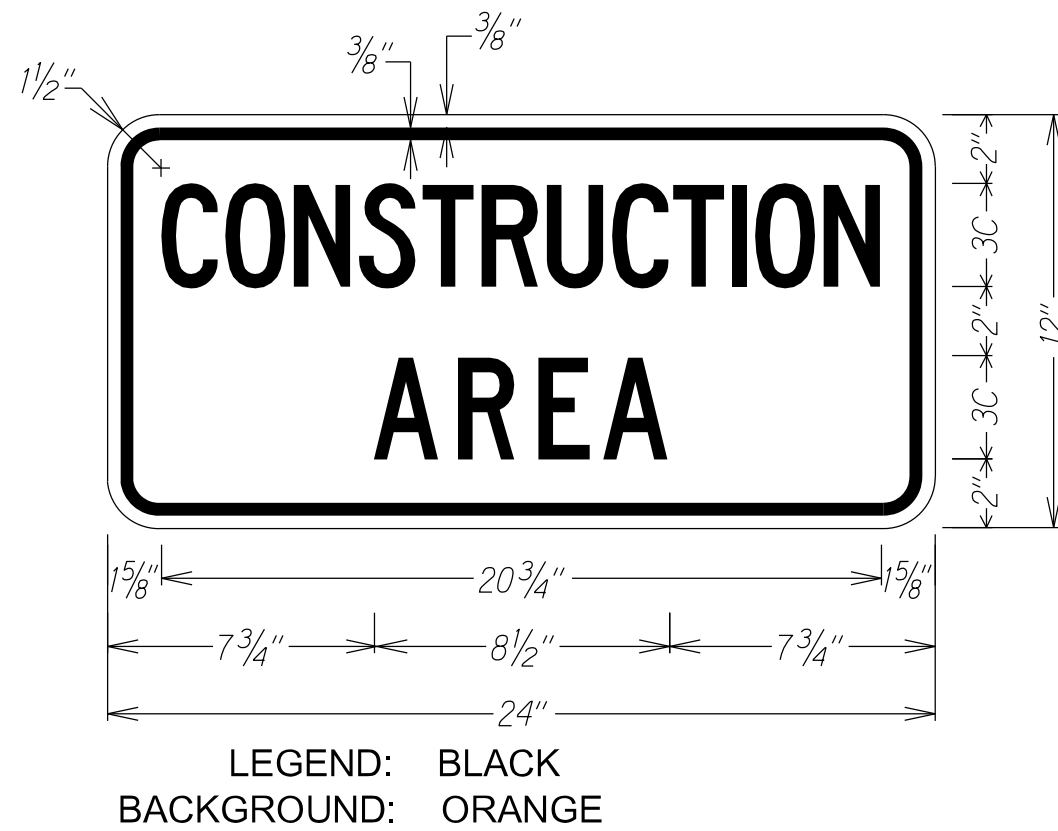

Work Zone Notes:

1. This Work Zone Sign Plan is intended for use on long-term stationary work zones/construction phases (3 days or more). All work zones or construction phases less than 3 days duration will use Traffic Control Plans shown in Section 645 of the Standard Specifications and/or Special Provisions.
2. All existing regulatory speed limit signs with posts within the work zone/project limits shall be removed and replaced with work zone speed limit sign assemblies (R2-1(25) and CW3-5(25) with "CONSTRUCTION AREA" and "\$250 FINE HRS 291C-104" Supplemental Signs).
3. Construction sign assemblies shall be installed on both the approaching and trailing ends of each work zone as shown on this plan.
4. Each construction warning sign shall have a minimum of two (2) Type II OM. Each work zone speed limit assembly shall have a minimum of one (1) Type II OM. Installation of each Type II OM shall be considered incidental to Item No. 645.0100 - Traffic Control.
5. Upon the completion of all physical work or as directed by the Engineer, all construction signs and work zone speed limit assemblies shall be removed. All speed limit signs and posts that were existing at the start of the project within the work zone/project limits shall be restored back to their original locations and configurations.
6. Placement of construction signs shall not obstruct the path of pedestrians and bicyclists.
7. The removal and restoration of existing regulatory speed limit signs with new posts along with the installation, maintenance and removal of work zone speed limit sign assemblies shall be considered incidental to Item No. 645.0100 - Traffic Control.

SURVEY PLOTTED BY	DATE
DRAWN BY	
TRACED BY	
DESIGNED BY	
CHECKED BY	
NOTED BY	
DATE	

2/11/21	Change sign assemblies to show two posts.
DATE	REVISION
STATE OF HAWAII DEPARTMENT OF TRANSPORTATION HIGHWAYS DIVISION LOW SPEED DIVIDED HIGHWAY WORK ZONE SIGNING PLAN, NOTES&DETAILS NIMITZ HIGHWAY & ALA MOANA BOULEVARD RESURFACING Sand Island Access Rd. to Vic of Piikoi St. Federal-Aid Project No. NH-092-1(030) Scale: As Shown Date: August, 2020	
SHEET No. T3 OF 20 SHEETS	

FED. ROAD DIST. NO.	STATE	FED. AID PROJ. NO.	FISCAL YEAR	SHEET NO.	TOTAL SHEETS
HAWAII	HAW.	NH-092-1(030)	2021	ADD. 34	50

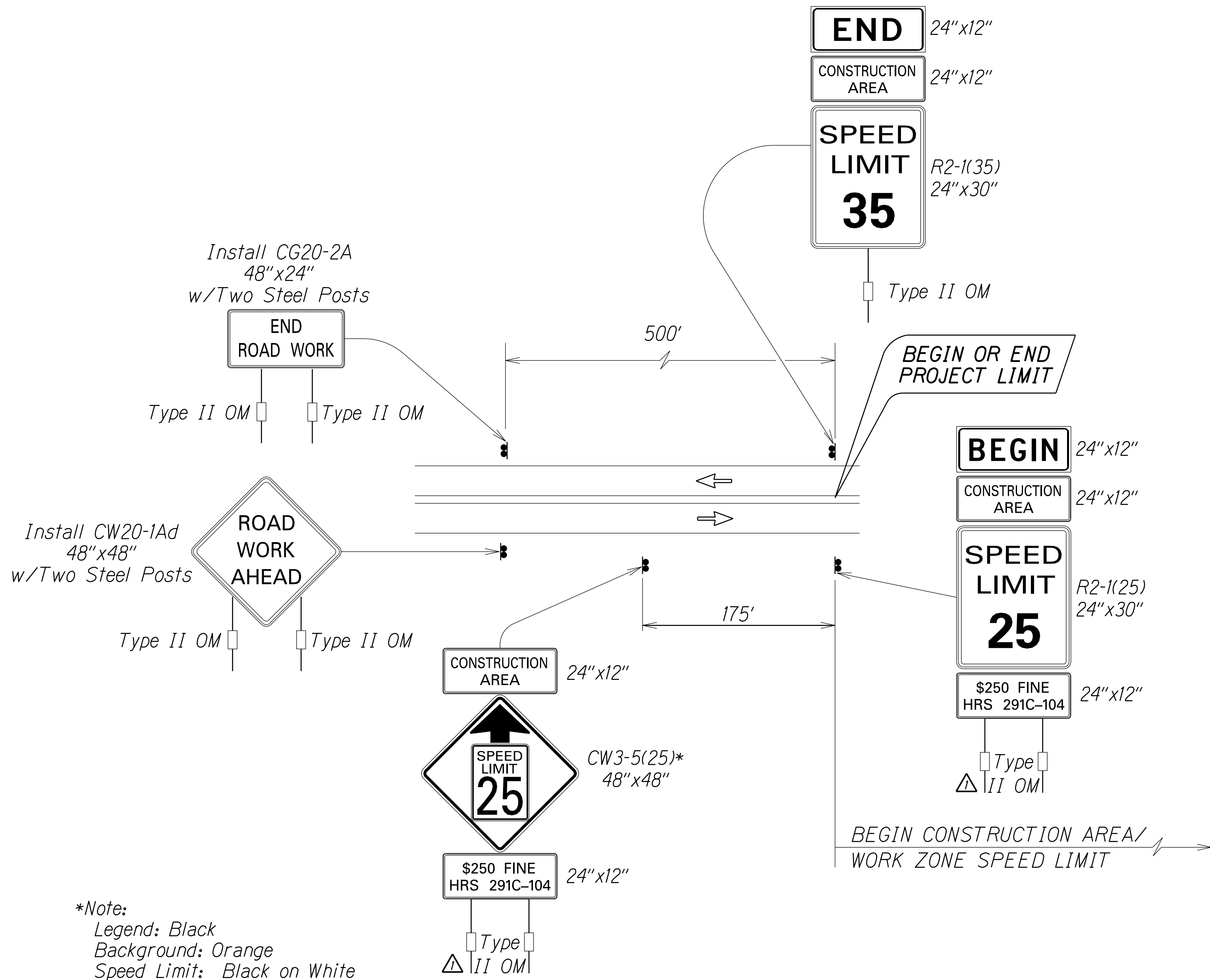

TYPICAL DETAIL FOR CONSTRUCTION SIGNS
ON TWO LANE OR MULTILANE UNDIVIDED LOW SPEED HIGHWAY

Work Zone Notes:

1. This Work Zone Sign Plan is intended for use on long-term stationary work zones/construction phases (3 days or more). All work zones or construction phases less than 3 days duration will use Traffic Control Plans shown in Section 645 of the Standard Specifications and/or Special Provisions.
2. All existing regulatory speed limit signs with posts within the work zone/project limits shall be removed and replaced with work zone speed limit sign assemblies (R2-1(25) and CW3-5(25) with "CONSTRUCTION AREA" and "\$250 FINE HRS 291C-104" Supplemental Signs).
3. Construction sign assemblies shall be installed on both the approaching and trailing ends of each work zone as shown on this plan.
4. Each construction warning sign shall have a minimum of two (2) Type II OM. Each work zone speed limit assembly shall have a minimum of one (1) Type II OM. Installation of each Type II OM shall be considered incidental to Item No. 645.0100 - Traffic Control.
5. Upon the completion of all physical work or as directed by the Engineer, all construction signs and work zone speed limit assemblies shall be removed. All speed limit signs and posts that were existing at the start of the project within the work zone/project limits shall be restored back to their original locations and configurations.
6. Placement of construction signs shall not obstruct the path of pedestrians and bicyclists.
7. The removal and restoration of existing regulatory speed limit signs with new posts along with the installation, maintenance and removal of work zone speed limit sign assemblies shall be considered incidental to Item No. 645.0100 - Traffic Control.

SURVEY PLOTTED BY	DATE
DRAWN BY	
TRACED BY	
DESIGNED BY	
CHECKED BY	
NOTED BY	
DATE	

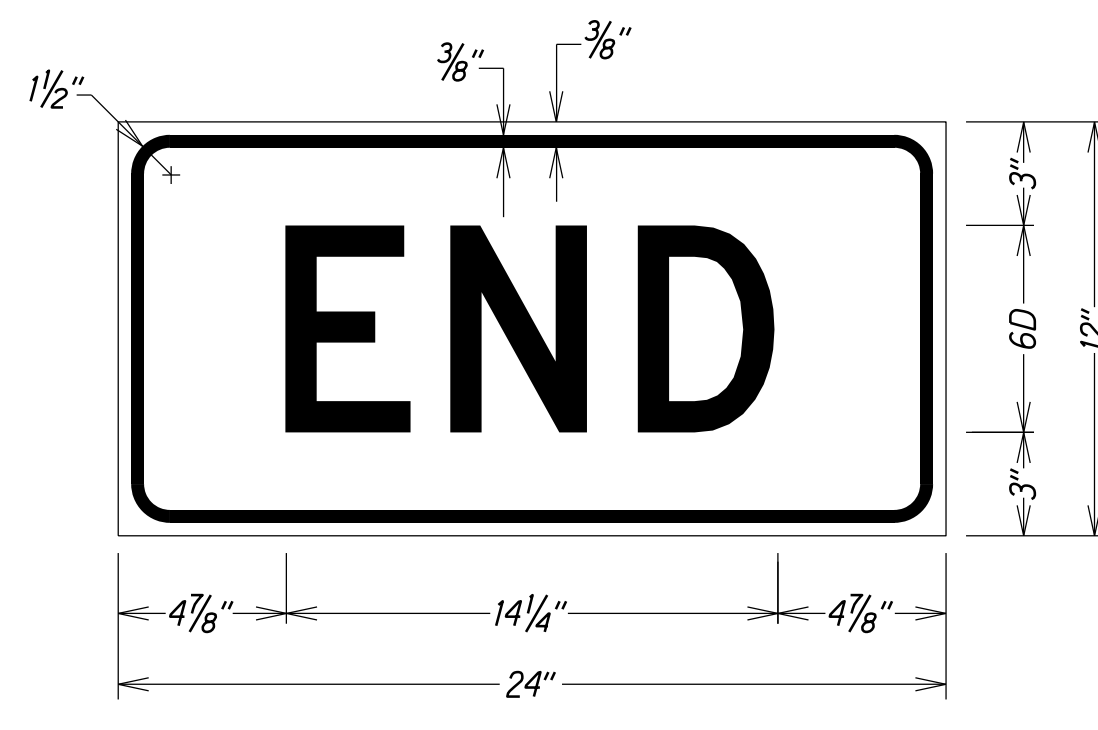
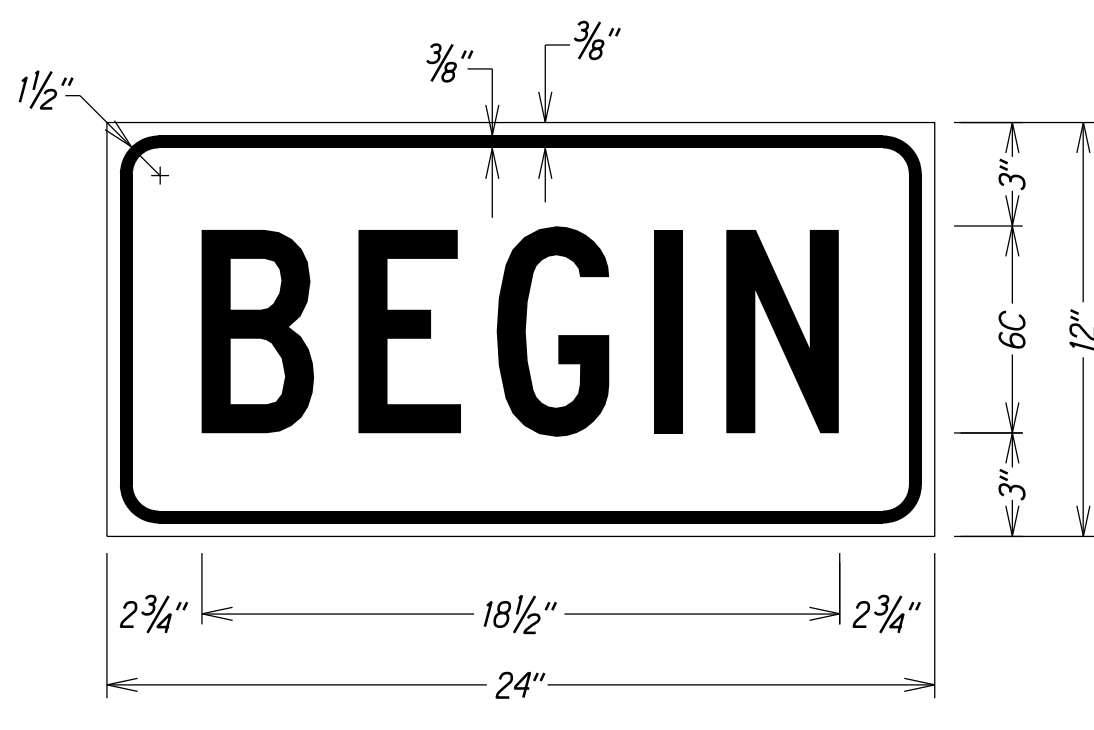
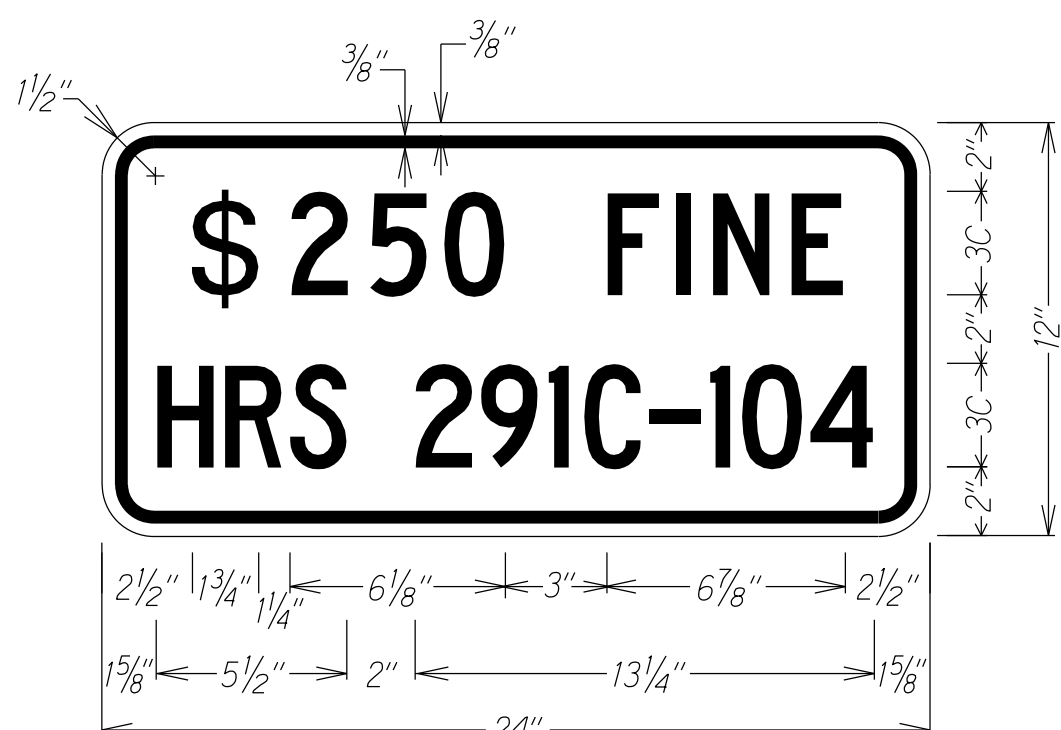
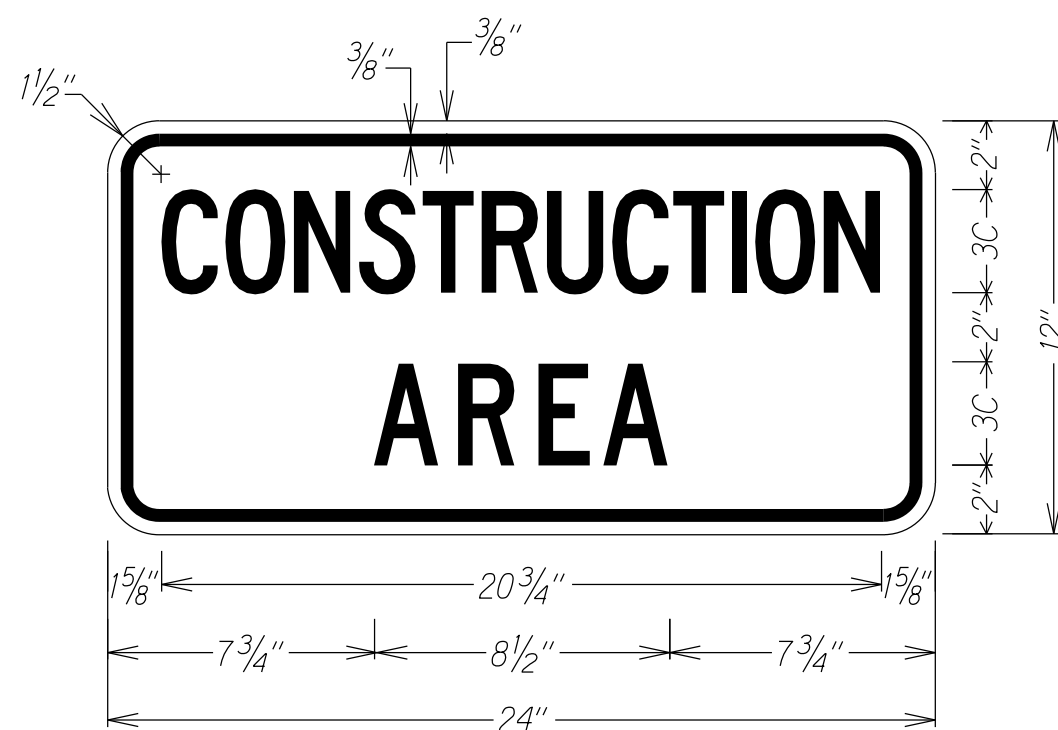

2/11/21	Change sign assemblies to show two posts.
DATE	REVISION
STATE OF HAWAII DEPARTMENT OF TRANSPORTATION HIGHWAYS DIVISION LOW SPEED UNDIVIDED HIGHWAY WORK ZONE SIGNING PLAN, NOTES & DETAILS NIMITZ HIGHWAY & ALA MOANA BOULEVARD RESURFACING Sand Island Access Rd. to Vic of Piikoi St. Federal-Aid Project No. NH-092-1(030) Scale: As Shown Date: August, 2020	
SHEET No. T4 OF 20 SHEETS	