

FED. ROAD DIST. NO.	STATE	PROJ. NO.	FISCAL YEAR	SHEET NO.	TOTAL SHEETS
HAWAII	HAW.	92A-01-11M	2011	8	42

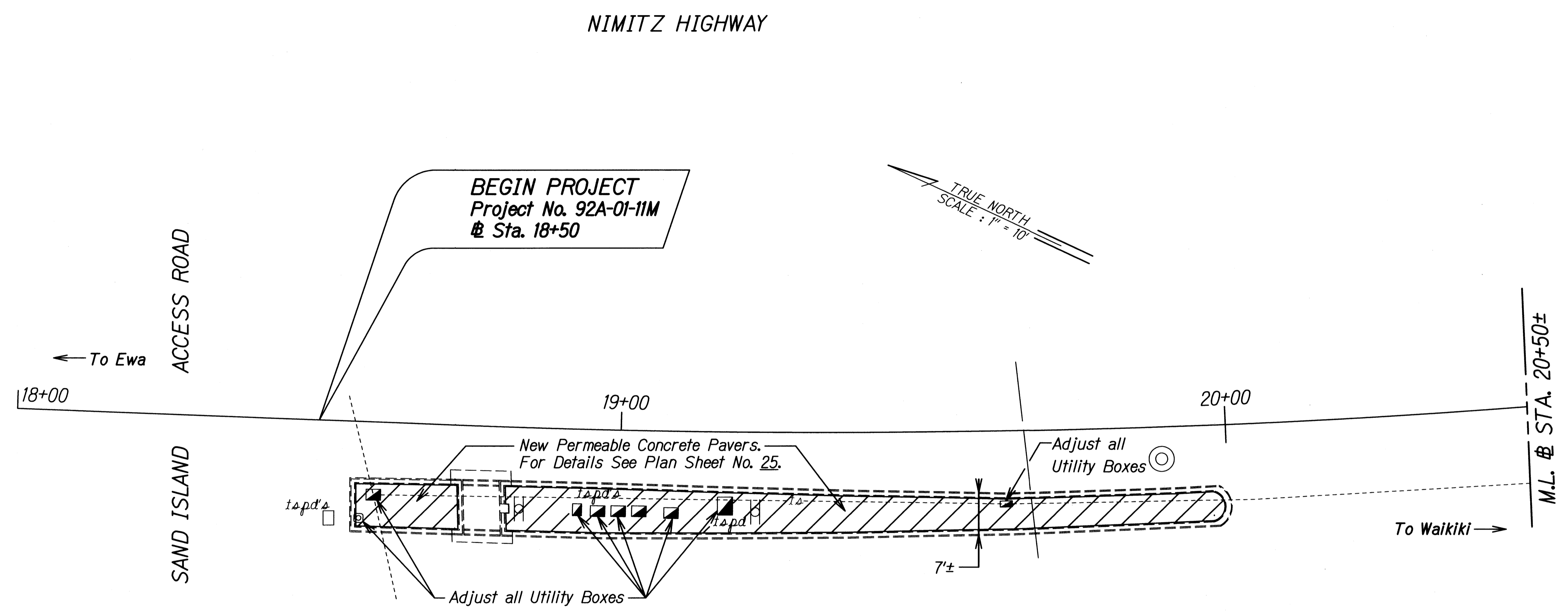

@ STA. 18+50 to @ STA. 20+00 Median  
 Clear & Grub all Median Grass. Remove Subgrade Sufficient for New Permeable Concrete Pavers. Adjust all Utility Boxes to Finish Grade Matching Top of Curb. Install New Permeable Concrete Pavers.

SURVEY PLOTTED BY	DATE
DRAWN BY	
DESIGNED BY	
CHECKED BY	
ORIGINAL PLAN	
NOTE BOOK	
No.	

STATE OF HAWAII  
 DEPARTMENT OF TRANSPORTATION  
 HIGHWAYS DIVISION

**LANDSCAPE PLAN**

**NIMITZ HWY. MEDIAN IMPROVEMENTS**  
 Sand Island Access Road  
 to Vicinity of Alakawa Street  
 Project No. 92A-01-11M

Scale: 1"=10' Date: March, 2011

SHEET No. 1 OF 14 SHEETS

FED. ROAD DIST. NO.	STATE	PROJ. NO.	FISCAL YEAR	SHEET NO.	TOTAL SHEETS
HAWAII	HAW.	92A-01-11M	2011	9	42

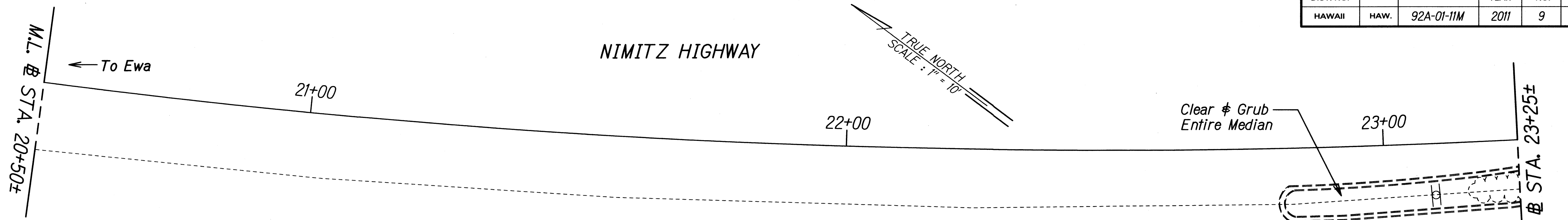

Clear & Grub Entire Median

23+00

M.L. @ STA. 23+25±

Existing Irrigation Mainline

Remove & Dispose Existing Backflow Preventer & Gate Valve @ STA. 22+80 Makai Sidewalk

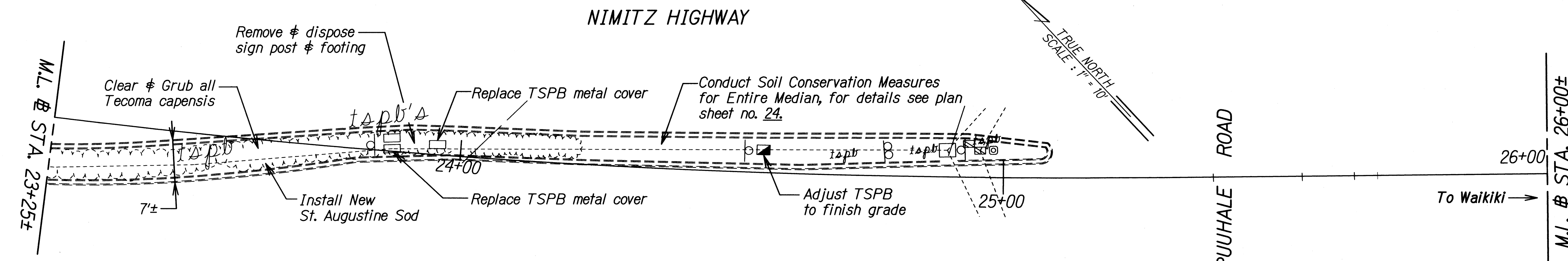
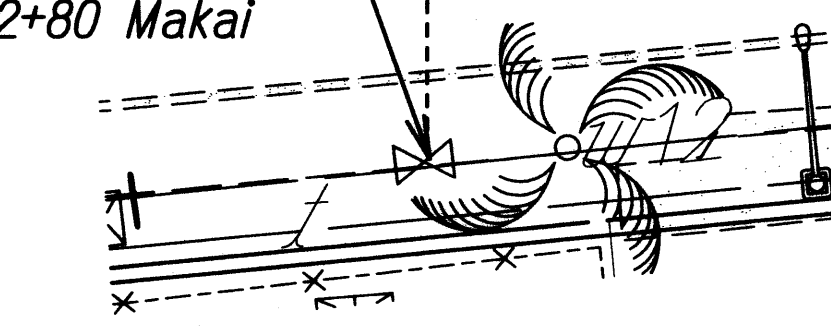

Remove & dispose sign post & footing

Clear & Grub all Tecoma capensis

Replace TSPB metal cover

Conduct Soil Conservation Measures for Entire Median, for details see plan sheet no. 24.

Install New St. Augustine Sod

Replace TSPB metal cover

Adjust TSPB to finish grade

PUUHALE ROAD

26+00

M.L. @ STA. 26+00±

To Waikiki →

@ STA. 22+50 to @ STA. 25+50 Median & Sidewalk  
 Remove & Dispose existing irrigation. Clear & Grub Entire Median. Clear & Grub all Tecoma capensis, Conduct Soil Conservation Measures for Entire Median. Install New Irrigation System & St. Augustine Grass Sod.

SURVEY PLOTTED BY	DATE
DRAWN BY	
TRACED BY	
DESIGNED BY	
CHECKED BY	
ORIGINAL PLAN	
NOTE BOOK	

STATE OF HAWAII  
 DEPARTMENT OF TRANSPORTATION  
 HIGHWAYS DIVISION

**LANDSCAPE PLAN**

**NIMITZ HWY. MEDIAN IMPROVEMENTS**  
 Sand Island Access Road  
 to Vicinity of Alakawa Street  
 Project No. 92A-01-11M

Scale: 1"=10'      Date: March, 2011

SHEET No. 2 OF 14 SHEETS

FED. ROAD DIST. NO.	STATE	PROJ. NO.	FISCAL YEAR	SHEET NO.	TOTAL SHEETS
HAWAII	HAW.	92A-01-11M	2011	ADD.10	42

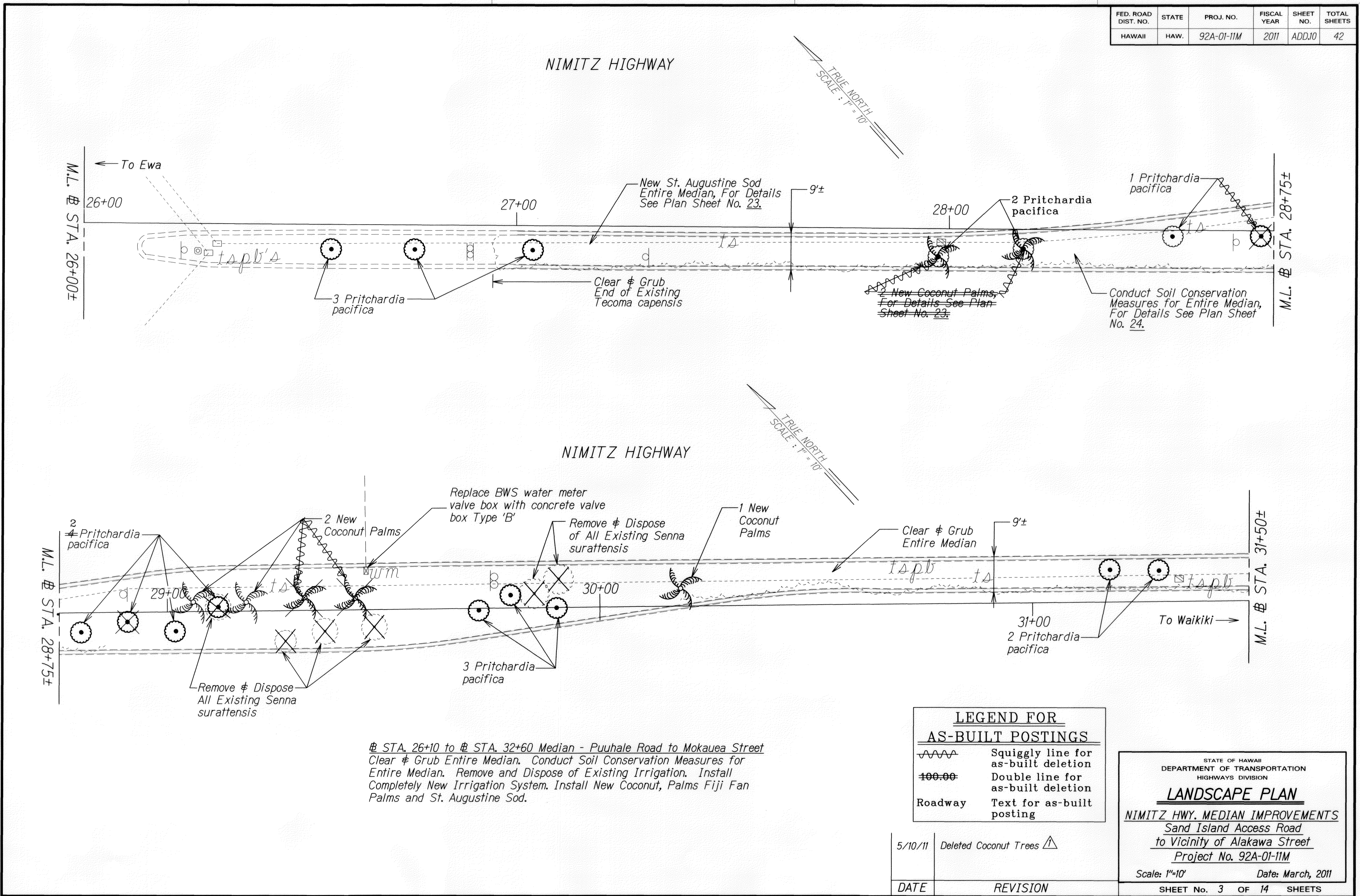

From STA. 26+10 to STA. 32+60 Median - Puuhale Road to Mokauea Street  
 Clear & Grub Entire Median. Conduct Soil Conservation Measures for Entire Median. Remove and Dispose of Existing Irrigation. Install Completely New Irrigation System. Install New Coconut, Palms Fiji Fan Palms and St. Augustine Sod.

LEGEND FOR AS-BUILT POSTINGS	
	Squiggly line for as-built deletion
	Double line for as-built deletion
Roadway	Text for as-built posting

DATE	REVISION
5/10/11	Deleted Coconut Trees

STATE OF HAWAII  
 DEPARTMENT OF TRANSPORTATION  
 HIGHWAYS DIVISION

**LANDSCAPE PLAN**  
 NIMITZ HWY. MEDIAN IMPROVEMENTS  
 Sand Island Access Road  
 to Vicinity of Alakawa Street  
 Project No. 92A-01-11M

Scale: 1"=10' Date: March, 2011

SHEET No. 3 OF 14 SHEETS

SURVEY PLOTTED BY	DATE
DRAWN BY	
TRACED BY	
NOTED BY	
DESIGNED BY	
CHECKED BY	
ORIGINAL PLAN	
NOTE BOOK	
No. 9110/03	
No. 2011	

"AS-BUILT"

ADD.10

FED. ROAD DIST. NO.	STATE	PROJ. NO.	FISCAL YEAR	SHEET NO.	TOTAL SHEETS
HAWAII	HAW.	92A-01-11M	2011	11	42

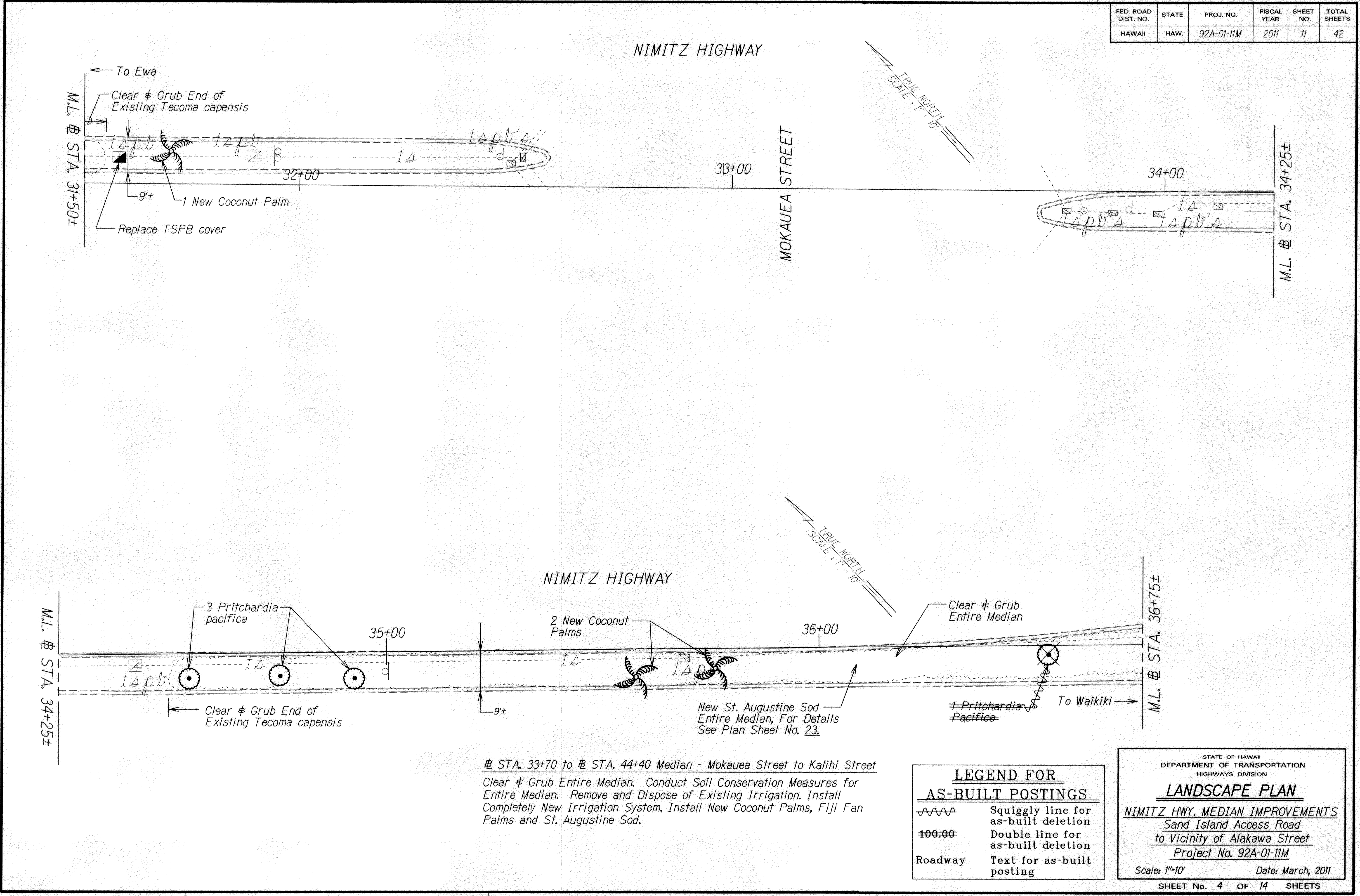

SURVEY PLOTTED BY	DATE
DRAWN BY	
TRACED BY	
NOTE BOOK NO.	
DATE OF SURVEY	
DESIGNED BY	
CHECKED BY	
NO. _____	_____

# STA. 33+70 to # STA. 44+40 Median - Mokauea Street to Kalihi Street  
 Clear & Grub Entire Median. Conduct Soil Conservation Measures for Entire Median. Remove and Dispose of Existing Irrigation. Install Completely New Irrigation System. Install New Coconut Palms, Fiji Fan Palms and St. Augustine Sod.

LEGEND FOR AS-BUILT POSTINGS	
	Squiggly line for as-built deletion
	Double line for as-built deletion
Roadway	Text for as-built posting

STATE OF HAWAII  
 DEPARTMENT OF TRANSPORTATION  
 HIGHWAYS DIVISION  
**LANDSCAPE PLAN**  
 NIMITZ HWY. MEDIAN IMPROVEMENTS  
 Sand Island Access Road  
 to Vicinity of Alakawa Street  
 Project No. 92A-01-11M  
 Scale: 1"=10' Date: March, 2011  
 SHEET No. 4 OF 14 SHEETS

"AS-BUILT"

FED. ROAD DIST. NO.	STATE	PROJ. NO.	FISCAL YEAR	SHEET NO.	TOTAL SHEETS
HAWAII	HAW.	92A-01-11M	2011	ADD.12	42

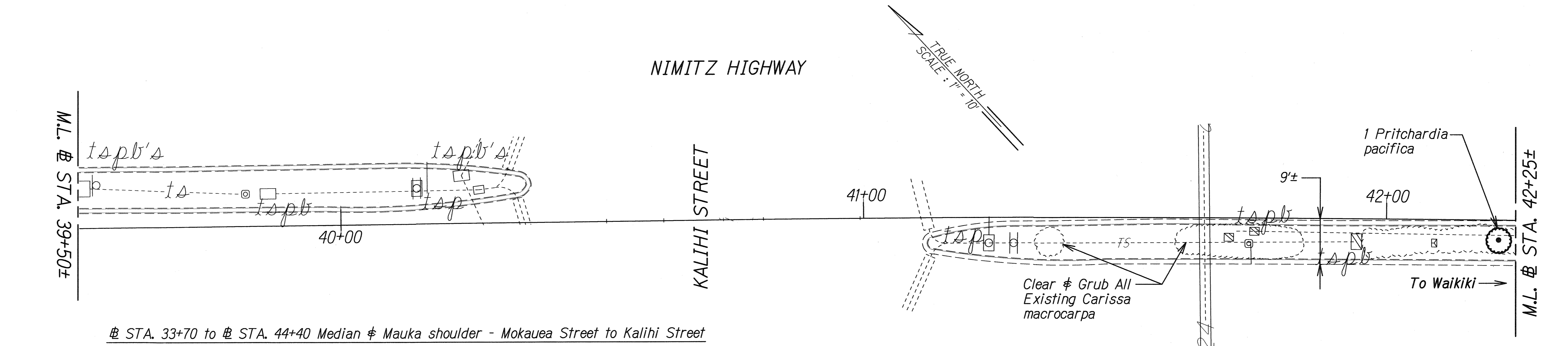
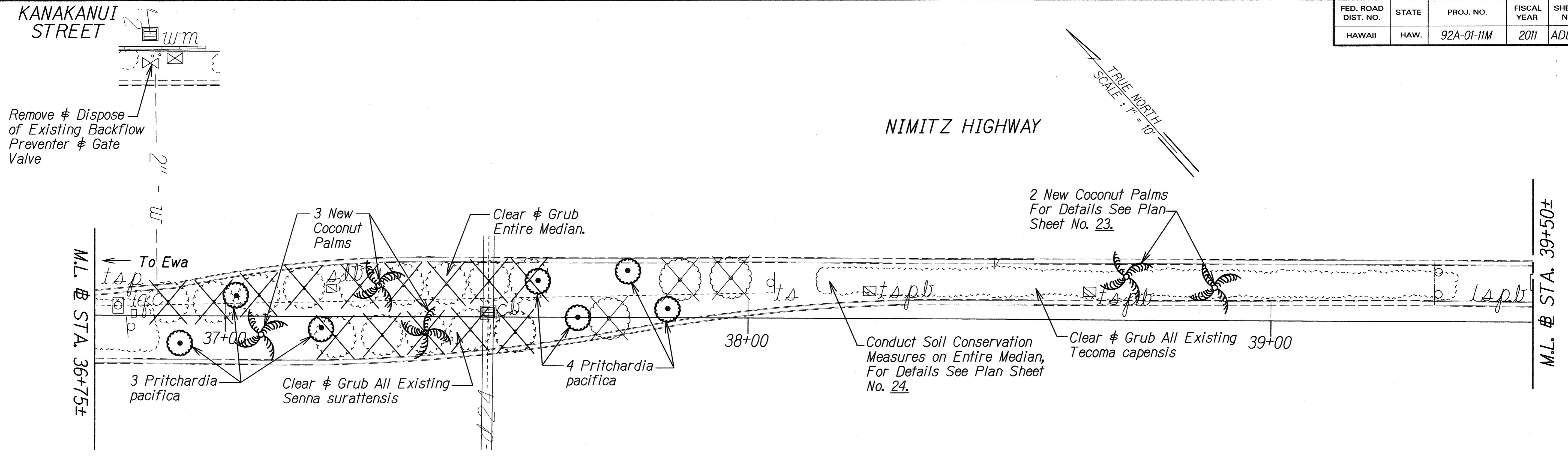

From STA. 33+70 to STA. 44+40 Median & Mauka shoulder - Mokauea Street to Kalihi Street  
 Clear & Grub Entire Median. Conduct Soil Conservation Measures for Entire Median.  
 Remove and Dispose of Existing Irrigation. Install Completely New Irrigation System.  
 Install New Coconut Palms, Fiji Fan Palms and St. Augustine Sod.

SURVEY PLOTTED BY	DATE
DRAWN BY	
TRACED BY	
NOTE BOOK	
QUANTITIES BY	
CHECKED BY	

5/10/11	Deleted Coconut Trees
DATE	REVISION

STATE OF HAWAII  
 DEPARTMENT OF TRANSPORTATION  
 HIGHWAYS DIVISION

**LANDSCAPE PLAN**

**NIMITZ HWY. MEDIAN IMPROVEMENTS**  
 Sand Island Access Road  
 to Vicinity of Alakawa Street  
 Project No. 92A-01-11M

Scale: 1"=10' Date: March, 2011

SHEET No. 5 OF 16 SHEETS

FED. ROAD DIST. NO.	STATE	PROJ. NO.	FISCAL YEAR	SHEET NO.	TOTAL SHEETS
HAWAII	HAW.	92A-01-11M	2011	ADD13	42

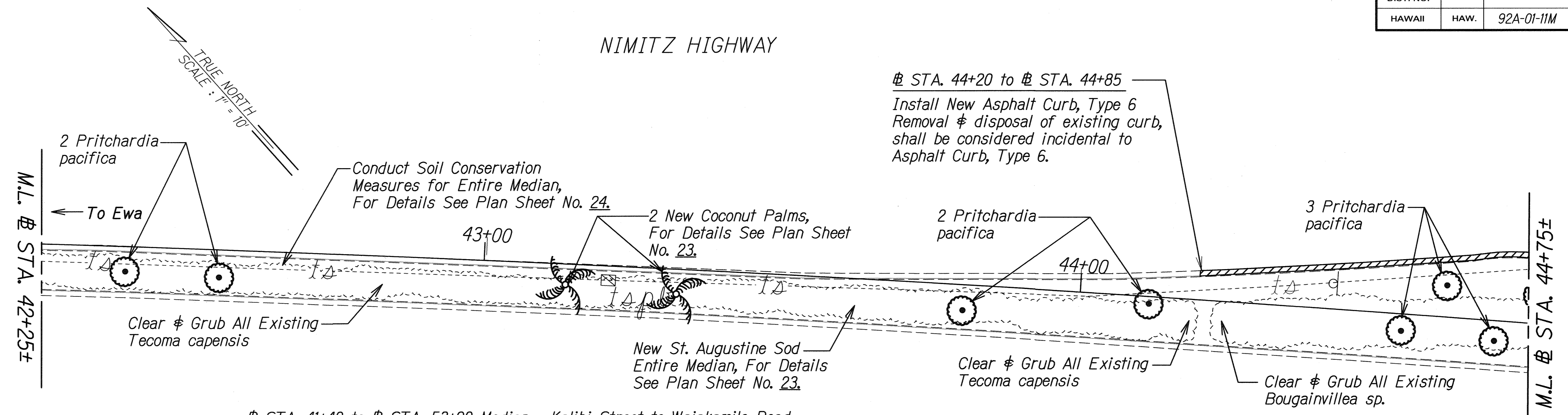

Sta. 41+40 to Sta. 53+90 Median - Kalihi Street to Waiakamilo Road  
 Clear & Grub Entire Median. Conduct Soil Conservation Measures for Entire Median. Remove and Dispose of Existing Irrigation. Install Completely New Irrigation System. Install New Coconut Palms, Fiji Fan Palms and St. Augustine Sod.

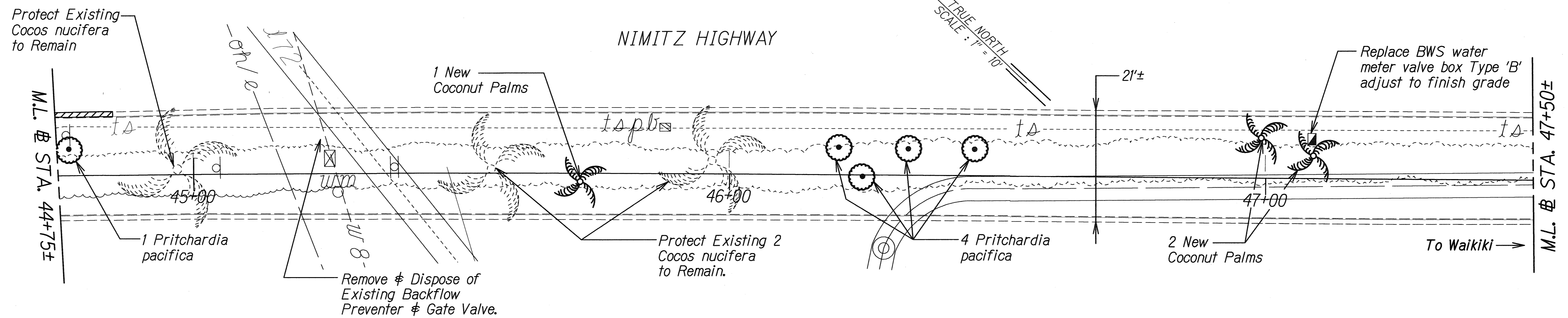

ORIGINAL PLAN	DATE
SURVEY PLOTTED BY	
DRAWN BY	
DESIGNED BY	
NOTE BOOK	
QUANTITIES BY	
CHECKED BY	

5/10/11	Deleted Coconut Trees
DATE	REVISION

STATE OF HAWAII  
 DEPARTMENT OF TRANSPORTATION  
 HIGHWAYS DIVISION

**LANDSCAPE PLAN**

**NIMITZ HWY. MEDIAN IMPROVEMENTS**  
 Sand Island Access Road  
 to Vicinity of Alakawa Street  
 Project No. 92A-01-11M

Scale: 1"=10' Date: March, 2011

SHEET No. 6 OF 14 SHEETS



FED. ROAD DIST. NO.	STATE	PROJ. NO.	FISCAL YEAR	SHEET NO.	TOTAL SHEETS
HAWAII	HAW.	92A-01-11M	2011	ADD.15	42

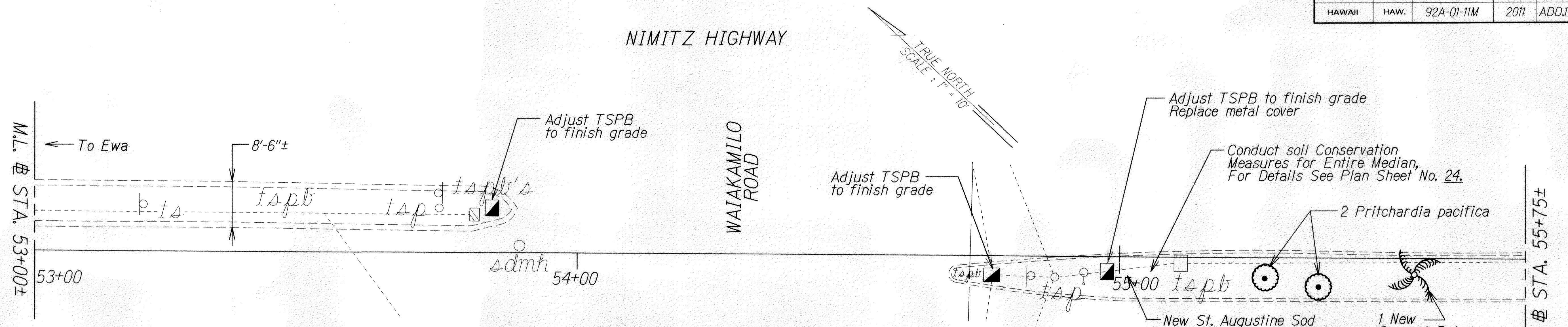

# STA. 54+70 to # STA. 56+00 Median  
 Clear & Grub Entire Median. Conduct Soil Conservation Measures for Entire Median. Remove and Dispose of Existing Irrigation. Install Completely New Irrigation System. Install New Coconut Palms Fiji Fan Palms and St. Augustine Sod.

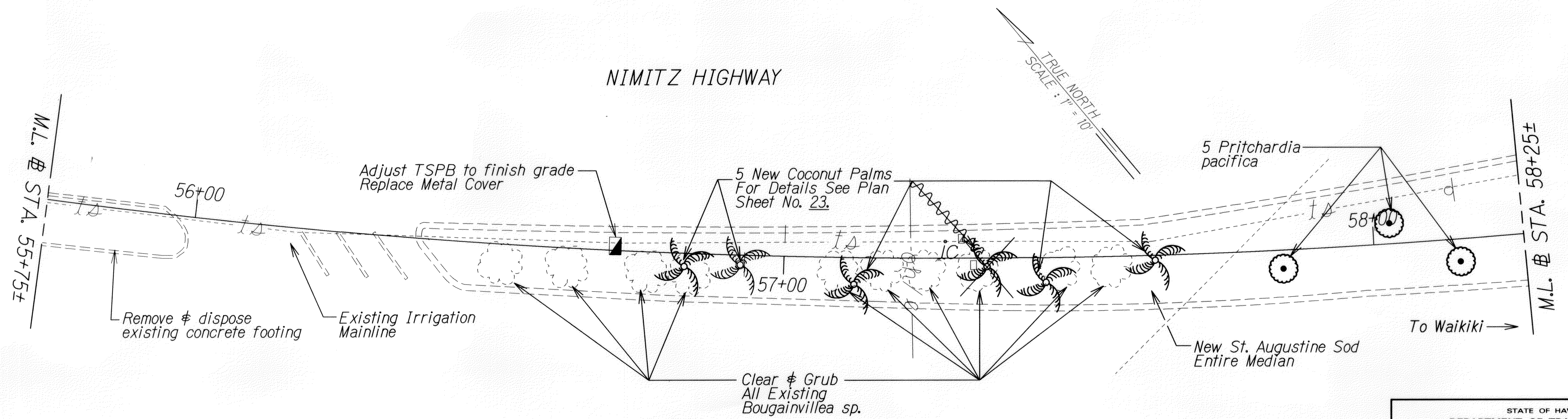

ORIGINAL PLAN	DATE
SURVEY PLOTTED BY	
TRACED BY	
DESIGNED BY	
QUANTITIES BY	
CHECKED BY	

LEGEND FOR AS-BUILT POSTINGS	
	Squiggly line for as-built deletion
	Double line for as-built deletion
Roadway	Text for as-built posting

DATE	REVISION
5/10/11	Deleted Coconut Trees

STATE OF HAWAII  
 DEPARTMENT OF TRANSPORTATION  
 HIGHWAYS DIVISION  
**LANDSCAPE PLAN**  
 NIMITZ HWY. MEDIAN IMPROVEMENTS  
 Sand Island Access Road  
 to Vicinity of Alakawa Street  
 Project No. 92A-01-11M  
 Scale: 1"=10' Date: March, 2011  
 SHEET No. 8 OF 14 SHEETS

"AS-BUILT"

ADD.15

FED. ROAD DIST. NO.	STATE	PROJ. NO.	FISCAL YEAR	SHEET NO.	TOTAL SHEETS
HAWAII	HAW.	92A-01-11M	2011	ADD.16	42

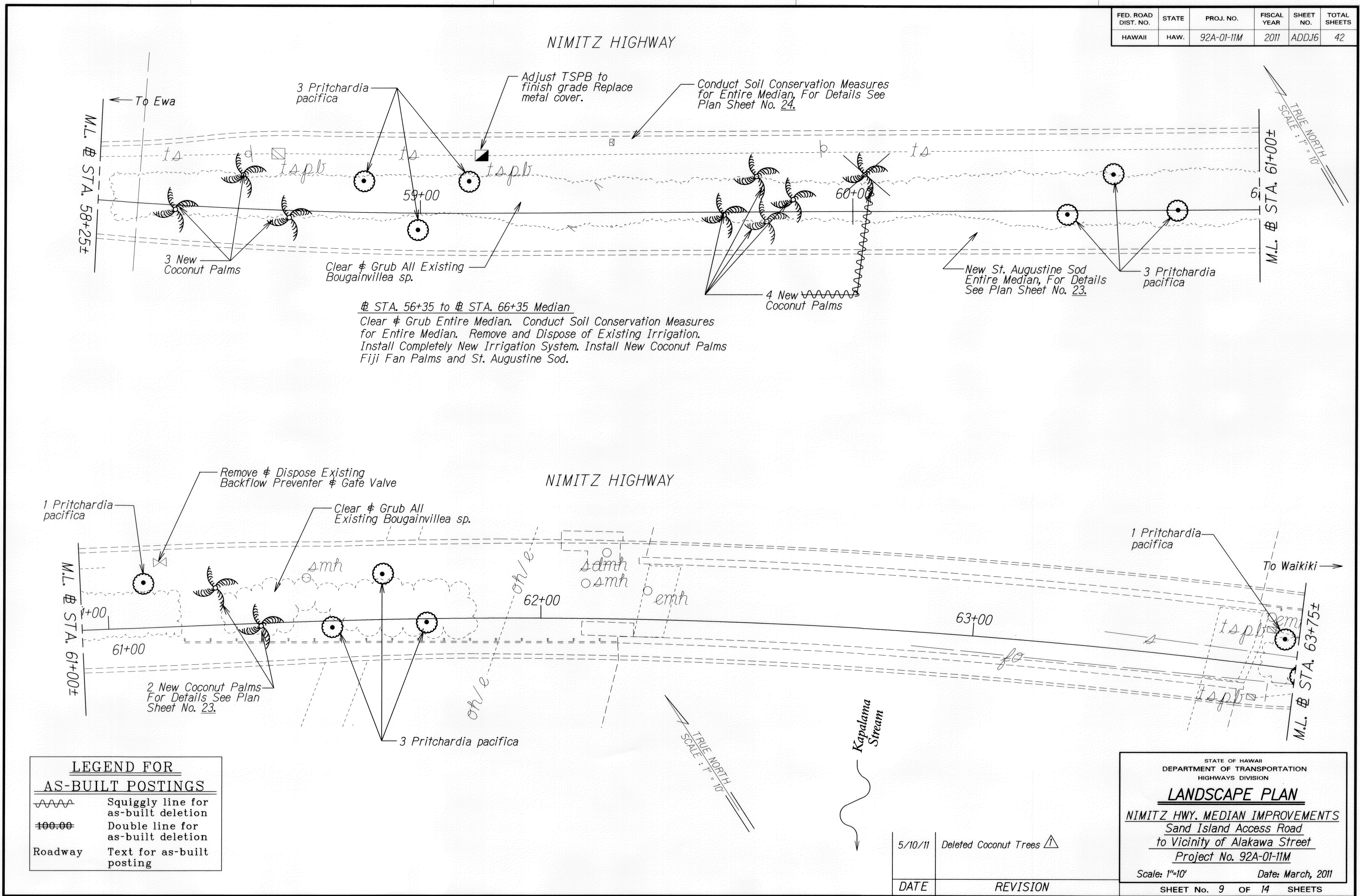

# STA. 56+35 to # STA. 66+35 Median  
 Clear & Grub Entire Median. Conduct Soil Conservation Measures for Entire Median. Remove and Dispose of Existing Irrigation. Install Completely New Irrigation System. Install New Coconut Palms Fiji Fan Palms and St. Augustine Sod.

**LEGEND FOR AS-BUILT POSTINGS**

	Squiggly line for as-built deletion
	Double line for as-built deletion
Roadway	Text for as-built posting

DATE	_____
DESIGNED BY	_____
DRAWN BY	_____
CHECKED BY	_____
ORIGINAL PLAN No.	_____

DATE	REVISION
5/10/11	Deleted Coconut Trees

STATE OF HAWAII  
 DEPARTMENT OF TRANSPORTATION  
 HIGHWAYS DIVISION  
**LANDSCAPE PLAN**  
 NIMITZ HWY. MEDIAN IMPROVEMENTS  
 Sand Island Access Road  
 to Vicinity of Alakawa Street  
 Project No. 92A-01-11M  
 Scale: 1"=10' Date: March, 2011  
 SHEET No. 9 OF 14 SHEETS

"AS-BUILT"

ADD.16

FED. ROAD DIST. NO.	STATE	PROJ. NO.	FISCAL YEAR	SHEET NO.	TOTAL SHEETS
HAWAII	HAW.	92A-01-11M	2011	17	42

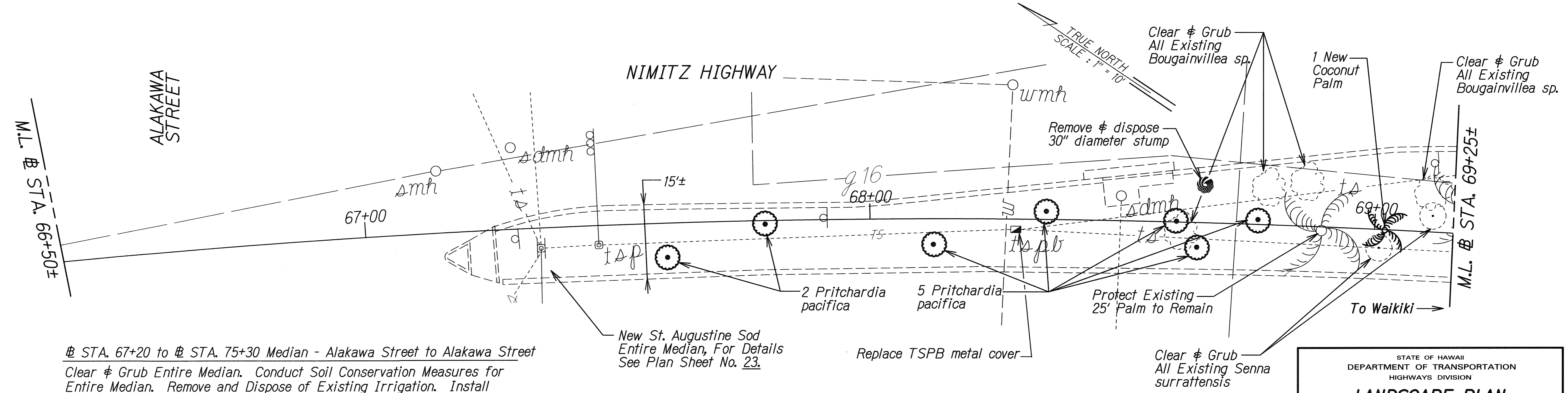
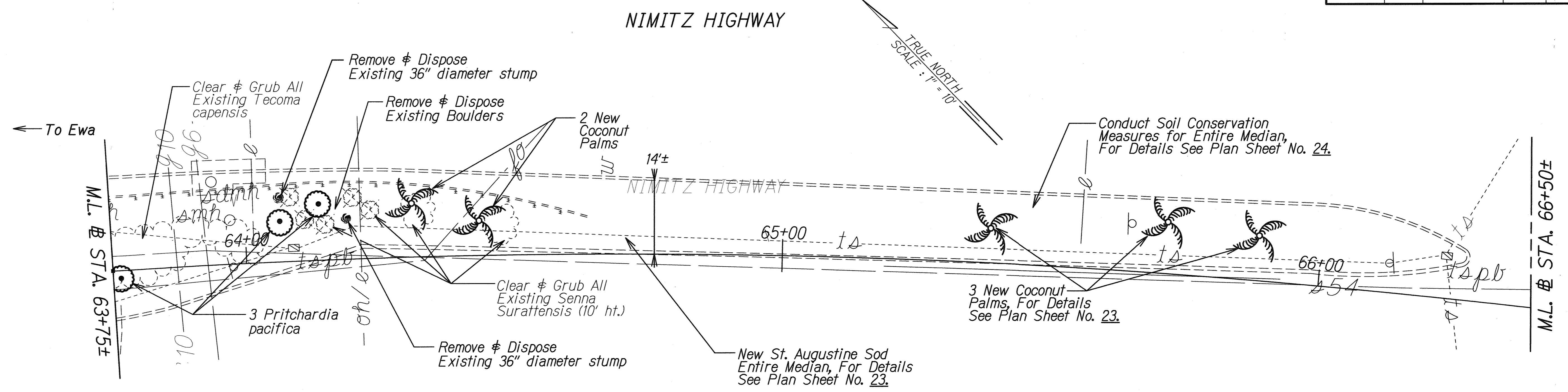

@ STA. 67+20 to @ STA. 75+30 Median - Alakawa Street to Alakawa Street  
 Clear & Grub Entire Median. Conduct Soil Conservation Measures for Entire Median. Remove and Dispose of Existing Irrigation. Install Completely New Irrigation System. Install New Coconut Palms, Fiji Fan Palms and St. Augustine Sod.

SURVEY PLOTTED BY	DATE
DRAWN BY	
NOTE BOOK	
DESIGNED BY	
QUANTITIES BY	
CHECKED BY	

5/10/11	Deleted Coconut Trees
DATE	REVISION

STATE OF HAWAII  
 DEPARTMENT OF TRANSPORTATION  
 HIGHWAYS DIVISION  
**LANDSCAPE PLAN**  
 NIMITZ HWY. MEDIAN IMPROVEMENTS  
 Sand Island Access Road  
 to Vicinity of Alakawa Street  
 Project No. 92A-01-11M  
 Scale: 1"=10' Date: March, 2011  
 SHEET No. 10 OF 14 SHEETS

ADD.17

FED. ROAD DIST. NO.	STATE	PROJ. NO.	FISCAL YEAR	SHEET NO.	TOTAL SHEETS
HAWAII	HAW.	92A-01-11M	2011	ADD.18	42

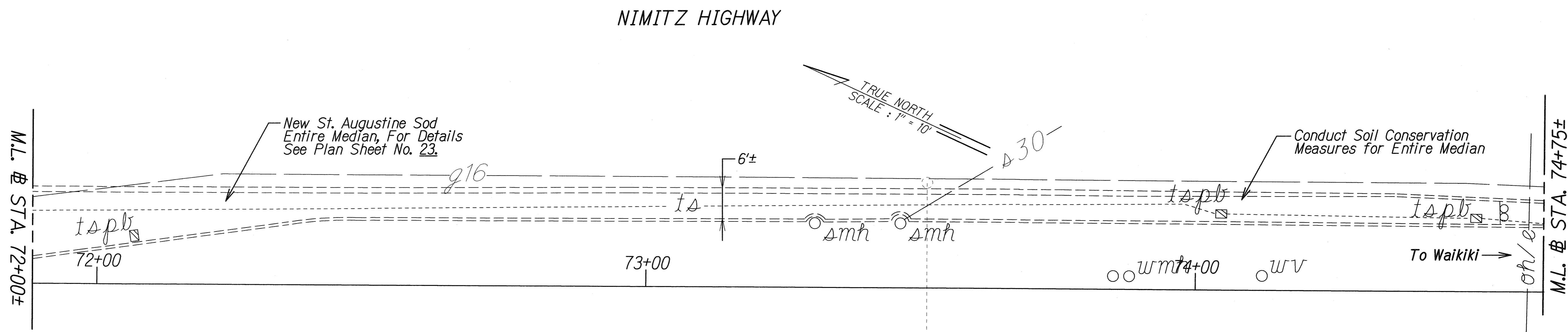
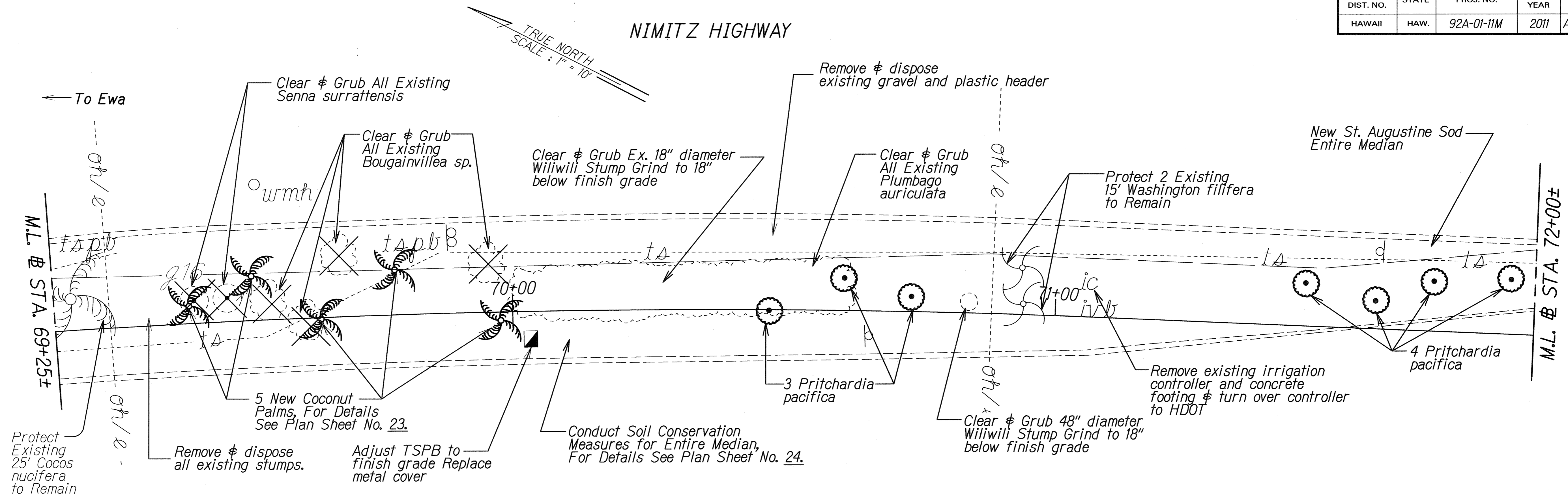

Sta. 67+20 to Sta. 75+30 Median - Alakawa Street to Alakawa Street  
 Clear & Grub Entire Median. Conduct Soil Conservation Measures for Entire Median. Remove and Dispose of Existing Irrigation. Install Completely New Irrigation System. Install New Coconut Palms, Fiji Fan Palms and St. Augustine Sod.

SURVEY PLOTTED BY	DATE
DRAWN BY	
DESIGNED BY	
NOTE BOOK	
QUANTITIES BY	
CHECKED BY	

DATE	REVISION
5/10/11	Deleted Coconut Trees

STATE OF HAWAII  
 DEPARTMENT OF TRANSPORTATION  
 HIGHWAYS DIVISION

**LANDSCAPE PLAN**

**NIMITZ HWY. MEDIAN IMPROVEMENTS**  
 Sand Island Access Road  
 to Vicinity of Alakawa Street  
 Project No. 92A-01-11M

Scale: 1"=10' Date: March, 2011

SHEET No. 11 OF 14 SHEETS

FED. ROAD DIST. NO.	STATE	PROJ. NO.	FISCAL YEAR	SHEET NO.	TOTAL SHEETS
HAWAII	HAW.	92A-01-11M	2011	ADD.19	42

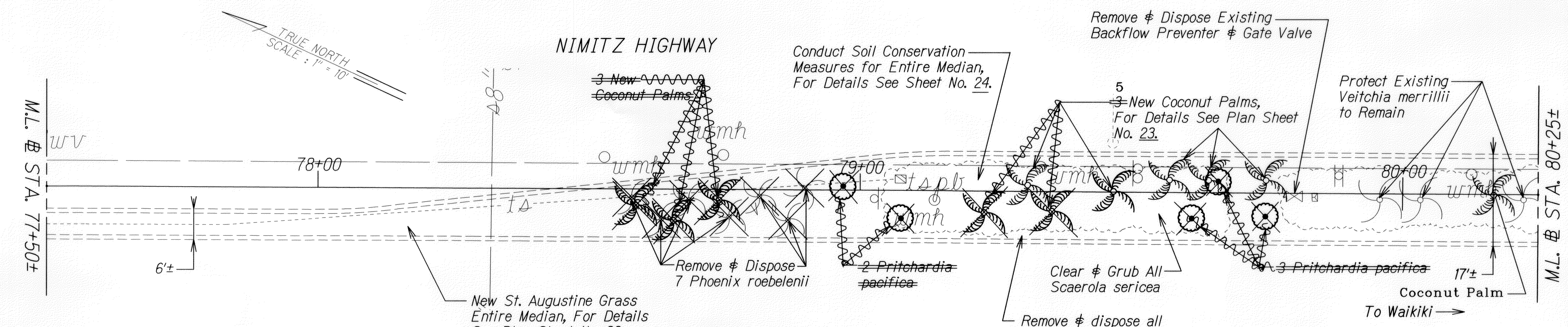
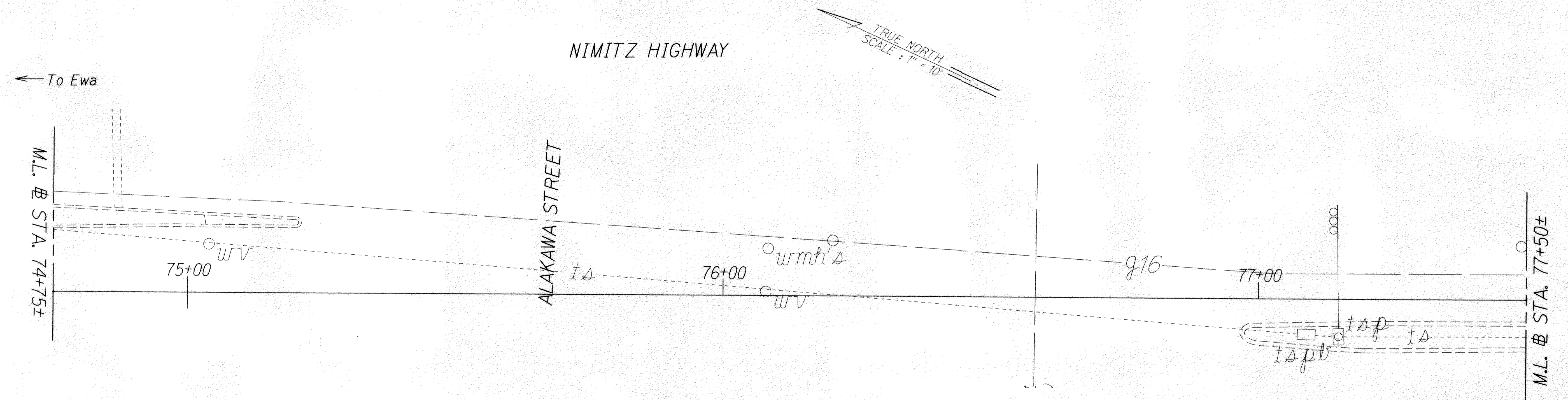

From STA. 83+90 to STA. 86+40 median  
 Clear and Grub Entire Median. Remove & Dispose Asphalt Paving Below Grass. Conduct Soil Conservation Measures for Entire Median. Remove and Dispose of Existing Irrigation. Install Completely New Irrigation System. Install New Coconut Palms, Fiji Fan Palms and St. Augustine Sod.

New St. Augustine Grass Entire Median, For Details See Plan Sheet No. 23.

**LEGEND FOR AS-BUILT POSTINGS**

	Squiggly line for as-built deletion
	Double line for as-built deletion
Roadway	Text for as-built posting

5/10/11	Deleted Coconut Trees
DATE	REVISION

STATE OF HAWAII  
 DEPARTMENT OF TRANSPORTATION  
 HIGHWAYS DIVISION

**LANDSCAPE PLAN**

NIMITZ HWY. MEDIAN IMPROVEMENTS  
 Sand Island Access Road  
 to Vicinity of Alakawa Street  
 Project No. 92A-01-11M

Scale: 1"=10' Date: March, 2011

SHEET No. 12 OF 14 SHEETS

DESIGNED BY	DATE
DRAWN BY	
CHECKED BY	
APPROVED BY	

"AS-BUILT"

ADD.19

FED. ROAD DIST. NO.	STATE	PROJ. NO.	FISCAL YEAR	SHEET NO.	TOTAL SHEETS
HAWAII	HAW.	92A-01-11M	2011	ADD.20	42

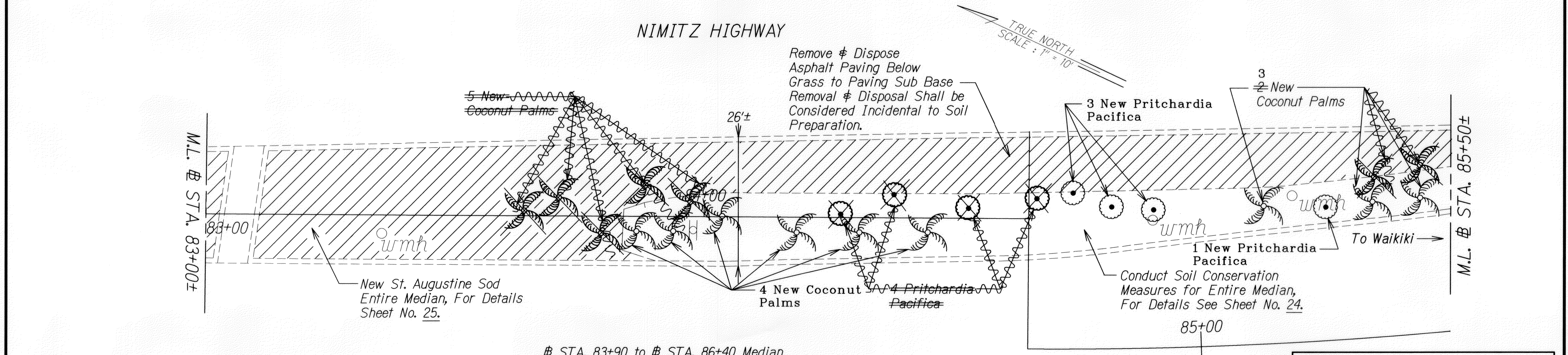
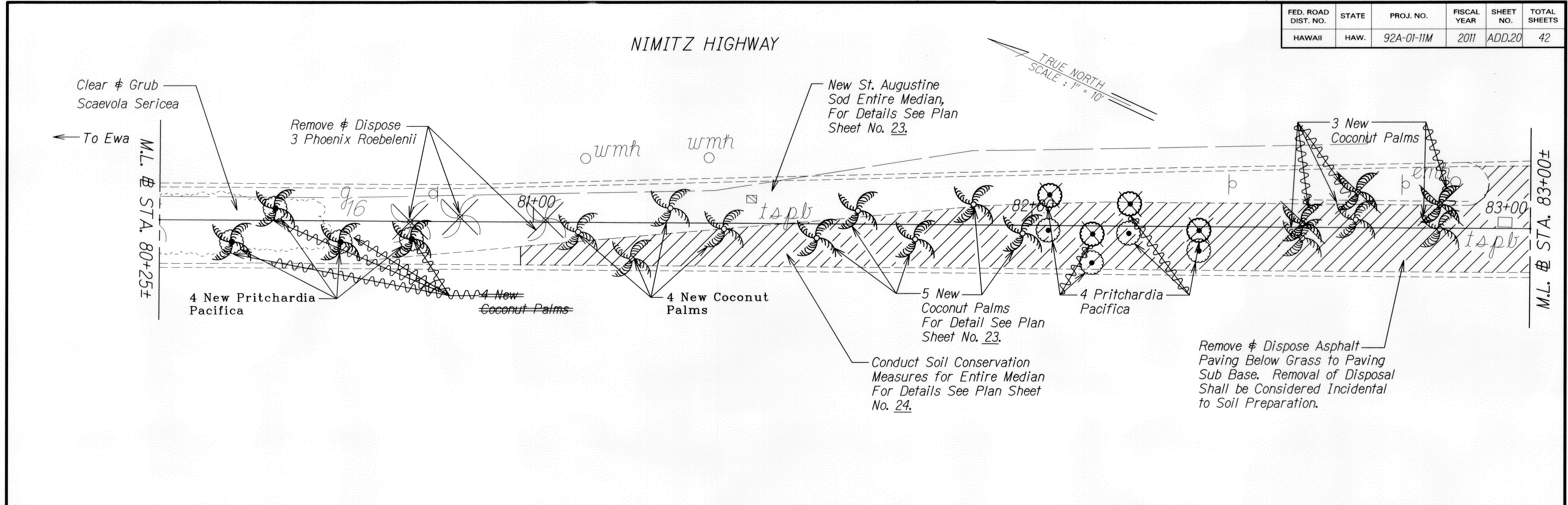

**LEGEND FOR AS-BUILT POSTINGS**

	Squiggly line for as-built deletion
	Double line for as-built deletion
Roadway	Text for as-built posting

Sta. 83+90 to Sta. 86+40 Median  
 Clear and Grub Entire Median. Remove & Dispose Asphalt Paving Below Grass to Paving Sub Base. Conduct Soil Conservation Measures for Entire Median. Remove and Dispose of Existing Irrigation. Install Completely New Irrigation System. Install New Coconut Palms, Fiji Fan Palms and St. Augustine Sod.

5/10/11	Deleted Coconut Trees
DATE	REVISION

STATE OF HAWAII  
 DEPARTMENT OF TRANSPORTATION  
 HIGHWAYS DIVISION

**LANDSCAPE PLAN**

NIMITZ HWY. MEDIAN IMPROVEMENTS  
 Sand Island Access Road  
 to Vicinity of Alakawa Street  
 Project No. 92A-01-11M

Scale: 1"=10' Date: March, 2011  
 SHEET No. 13 OF 14 SHEETS

"AS-BUILT"

ADD.20

ORIGINAL PLAN	SURVEY PLOTTED BY	DATE
NOTE BOOK	TRACED BY	
No. 310103	DESIGNED BY	
	CHECKED BY	

FED. ROAD DIST. NO.	STATE	PROJ. NO.	FISCAL YEAR	SHEET NO.	TOTAL SHEETS
HAWAII	HAW.	92A-01-11M	2011	21	42

TRUE NORTH  
SCALE: 1" = 10'

NIMITZ HIGHWAY

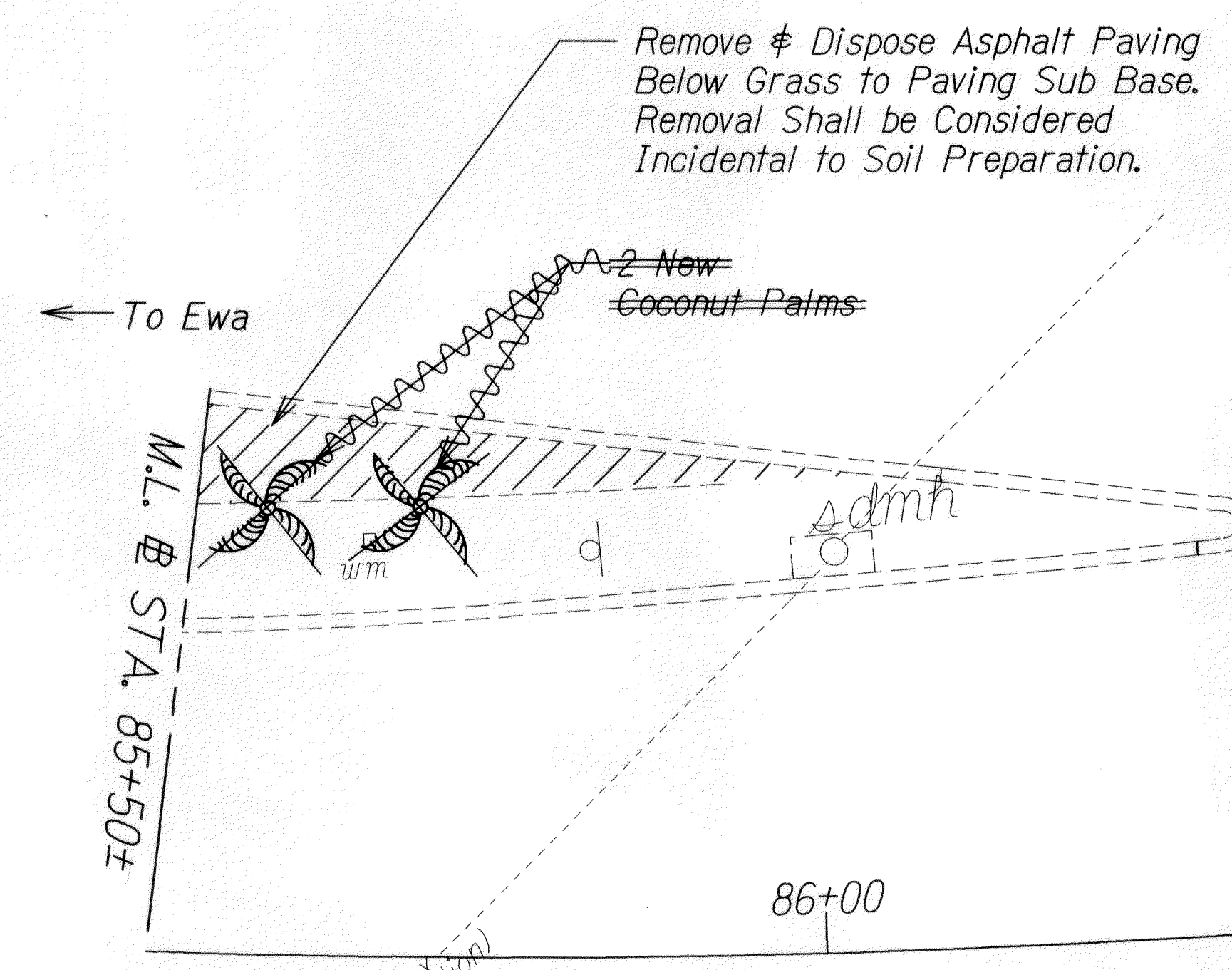

From STA. 83+90 to STA. 86+40 median  
Clear and Grub Entire Median. Remove Asphalt Paving Below Soil to Paving Sub Base. Conduct Soil Conservation Measures for Entire Median. Remove and Dispose of Existing Irrigation. Install Completely New Irrigation System. Install New Coconut Palms, Fiji Fan Palms and St. Augustine Sod.

**LEGEND FOR AS-BUILT POSTINGS**

	Squiggly line for as-built deletion
	Double line for as-built deletion
Roadway	Text for as-built posting

STATE OF HAWAII  
DEPARTMENT OF TRANSPORTATION  
HIGHWAYS DIVISION

**LANDSCAPE PLAN**

*NIMITZ HWY. MEDIAN IMPROVEMENTS  
Sand Island Access Road  
to Vicinity of Alakawa Street  
Project No. 92A-01-11M*

Scale: 1"=10' Date: March, 2011

SHEET No. 14 OF 14 SHEETS

DESIGNED BY	DATE
DRAWN BY	
CHECKED BY	
APPROVED BY	
DATE	

"AS-BUILT"