

FED. ROAD DIST. NO.	STATE	PROJ. NO.	FISCAL YEAR	SHEET NO.	TOTAL SHEETS
HAWAII	HAW.	92A-01-11M	2011	26	42

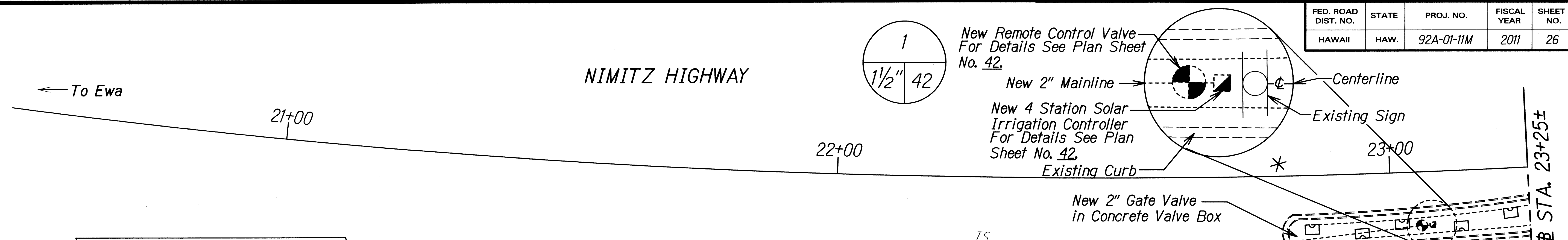

* **BEGIN IRRIGATION**
Project No. 92A-01-11M
@ Sta. 22+80±

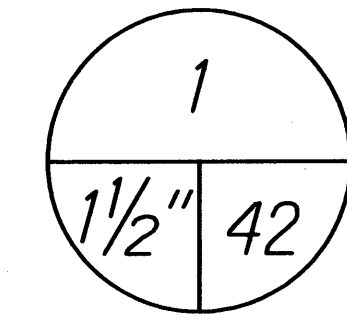
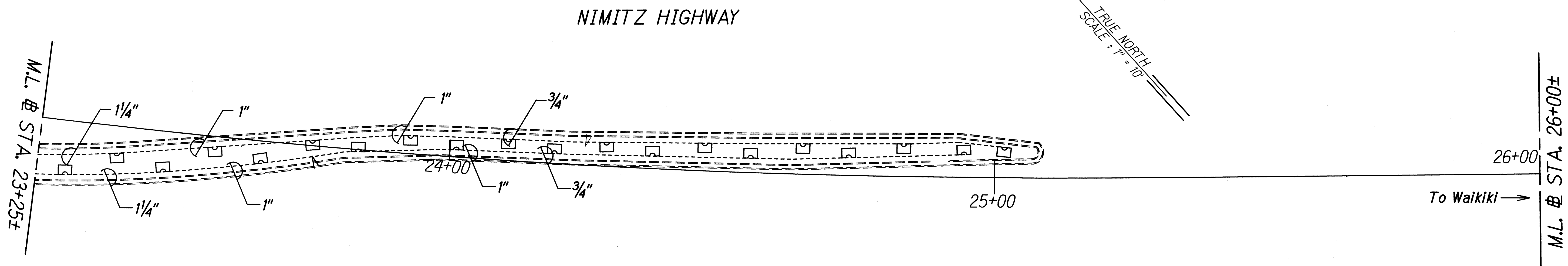
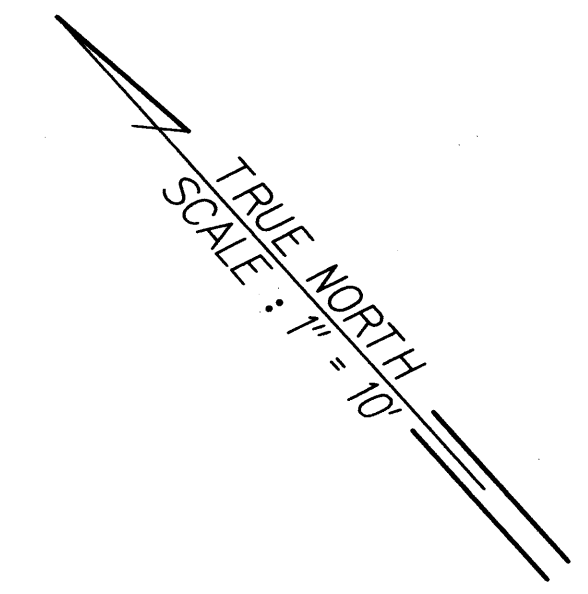
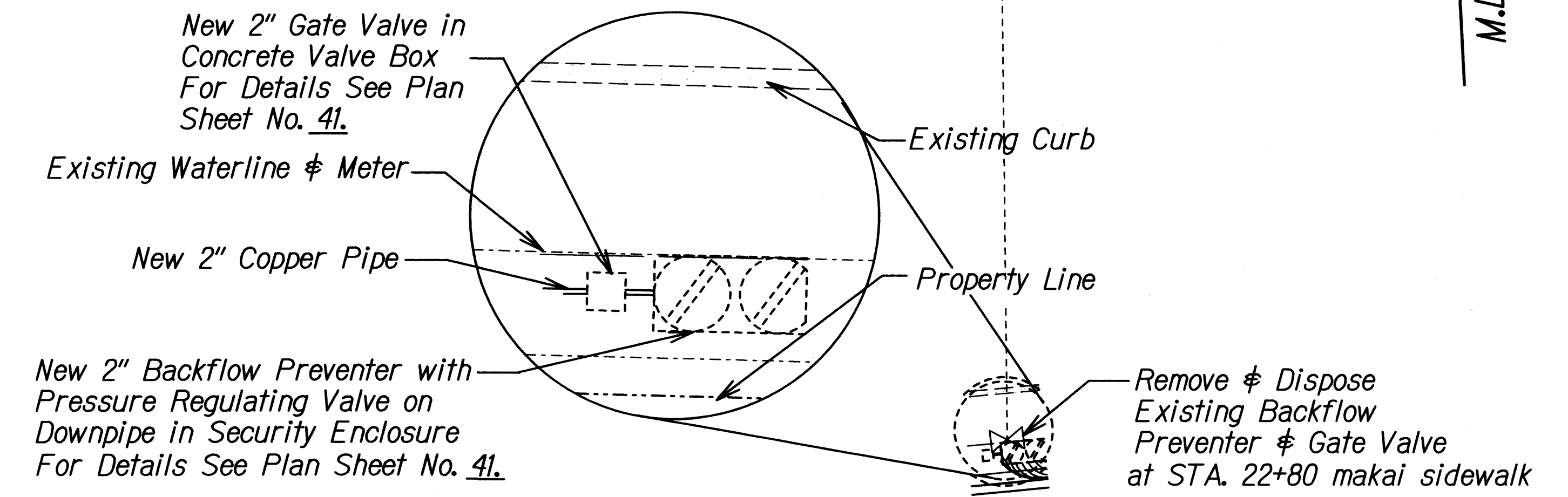
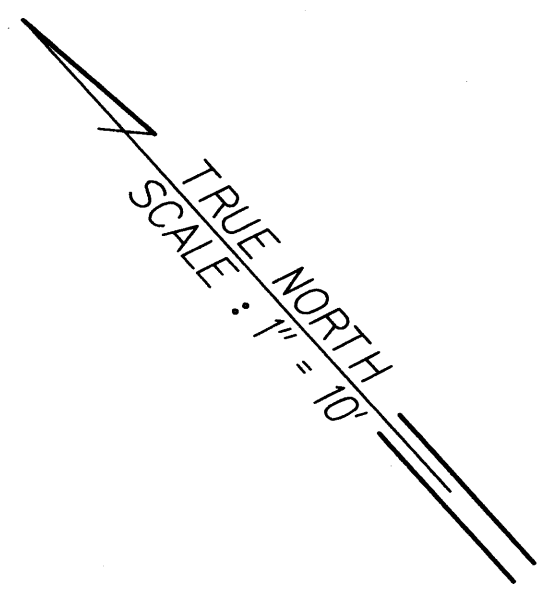

SURVEY PLOTTED BY	DATE
DRAWN BY	
DESIGNED BY	
CHECKED BY	
APPROVED BY	
REVISIONS	

STATE OF HAWAII
DEPARTMENT OF TRANSPORTATION
HIGHWAYS DIVISION

IRRIGATION PLAN
NIMITZ HWY. MEDIAN IMPROVEMENTS
Sand Island Access Road
to Vicinity of Alakawa Street
Project No. 92A-01-11M

Scale: 1"=10' Date: March, 2011

SHEET No. 1 OF 13 SHEETS

FED. ROAD DIST. NO.	STATE	PROJ. NO.	FISCAL YEAR	SHEET NO.	TOTAL SHEETS
HAWAII	HAW.	92A-01-11M	2011	28	42

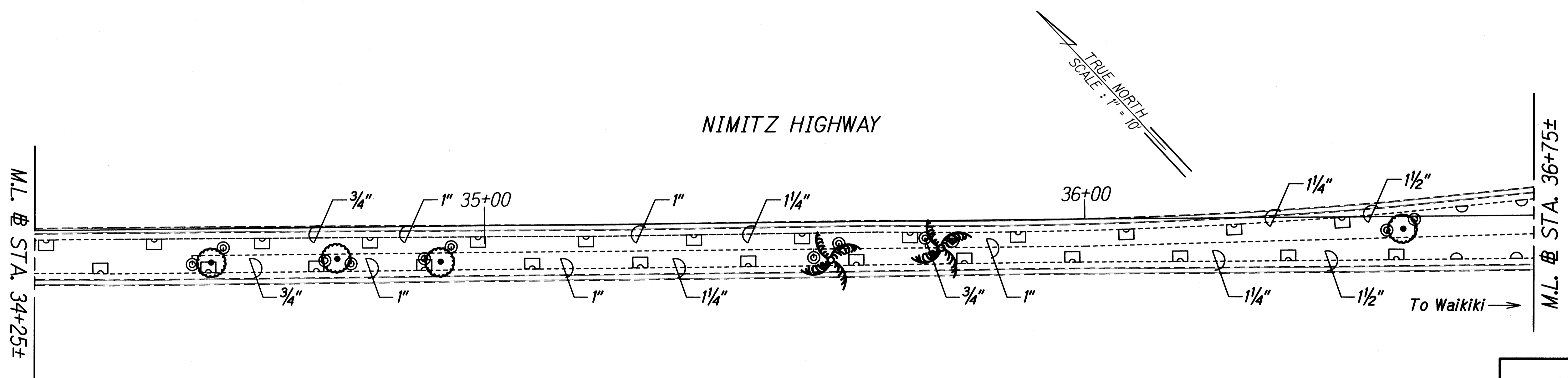
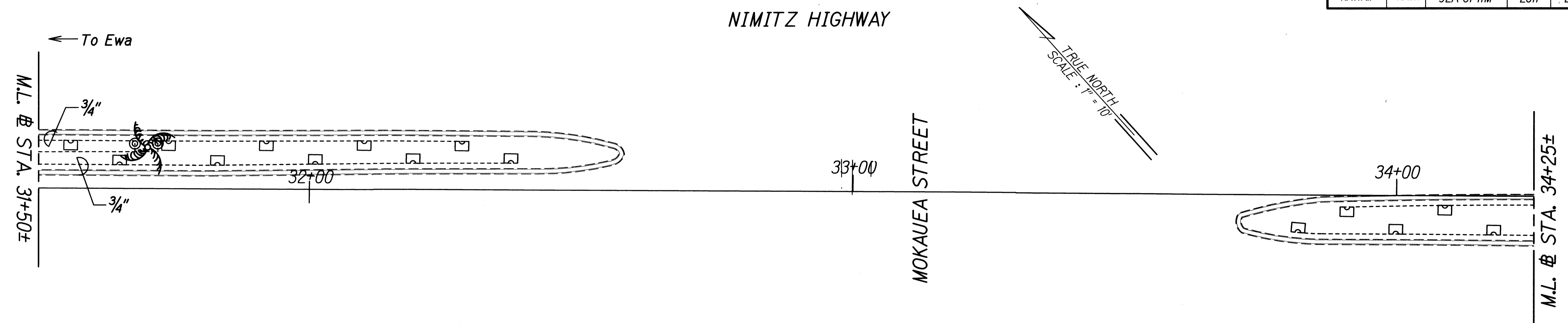

SURVEY PLOTTED BY	DATE
DRAWN BY	
TRACED BY	
QUANTITIES BY	
CHECKED BY	
ORIGINAL PLAN	
NOTE BOOK	
9/21/11/1004	
N.	

STATE OF HAWAII
DEPARTMENT OF TRANSPORTATION
HIGHWAYS DIVISION

IRRIGATION PLAN

NIMITZ HWY. MEDIAN IMPROVEMENTS
Sand Island Access Road
to Vicinity of Alakawa Street
Project No. 92A-01-11M

Scale: 1"=10' Date: March, 2011

SHEET No. 3 OF 13 SHEETS

FED. ROAD DIST. NO.	STATE	PROJ. NO.	FISCAL YEAR	SHEET NO.	TOTAL SHEETS
HAWAII	HAW.	92A-01-11M	2011	ADD.29	42

KANAKANUI STREET

POINT OF CONNECTION - 2

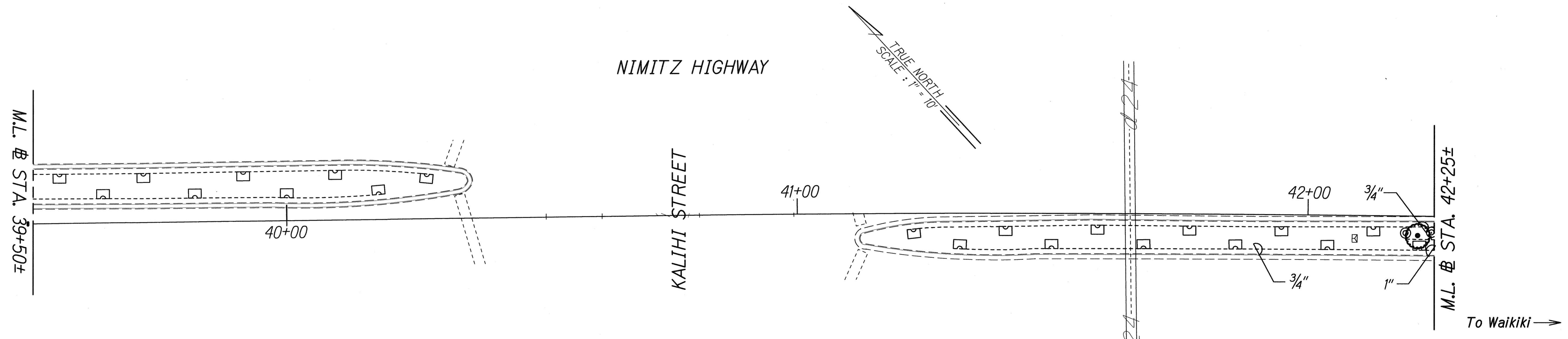
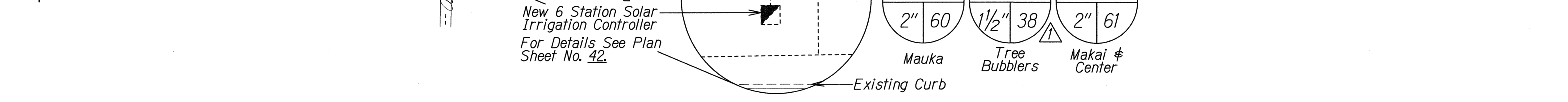
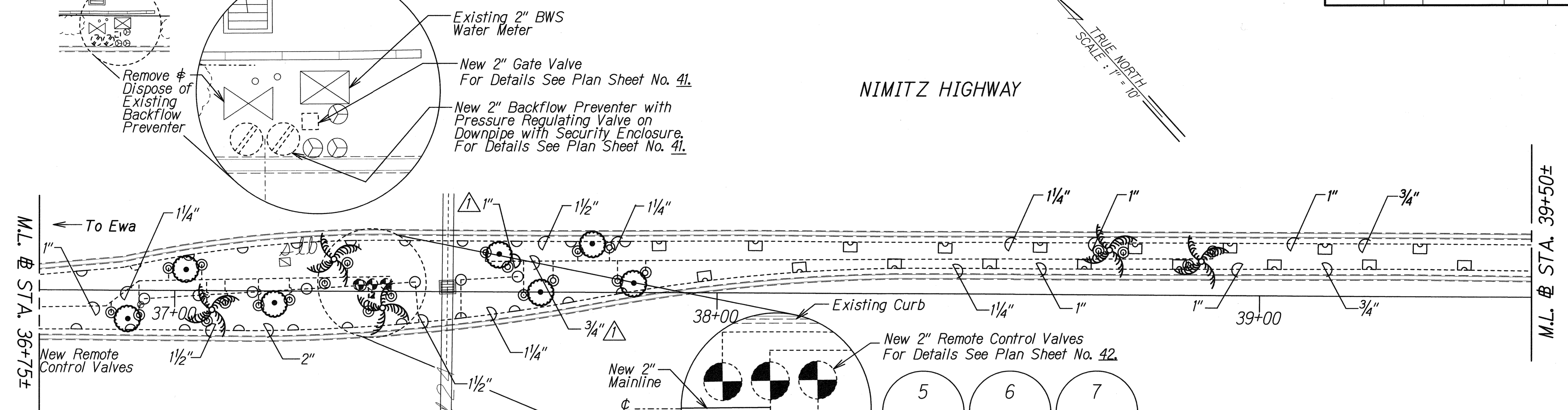

SURVEY PLOTTED BY	DATE
DRAWN BY	
TRACED BY	
NOTE BOOK	
QUANTITIES BY	
CHECKED BY	

5/10/11	Deleted Coconut Trees, and Adjusted Appropriate Irrigation. Δ
DATE	REVISION

STATE OF HAWAII
DEPARTMENT OF TRANSPORTATION
HIGHWAYS DIVISION

IRRIGATION PLAN
NIMITZ HWY. MEDIAN IMPROVEMENTS
Sand Island Access Road
to Vicinity of Alakawa Street
Project No. 92A-01-11M

Scale: 1"=10' Date: March, 2011

SHEET No. 4 OF 13 SHEETS

FED. ROAD DIST. NO.	STATE	PROJ. NO.	FISCAL YEAR	SHEET NO.	TOTAL SHEETS
HAWAII	HAW.	92A-01-11M	2011	ADD.30	42

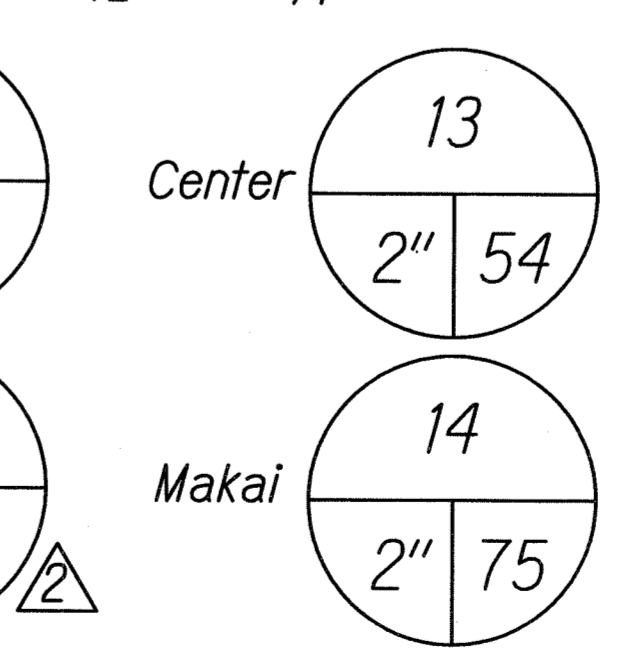
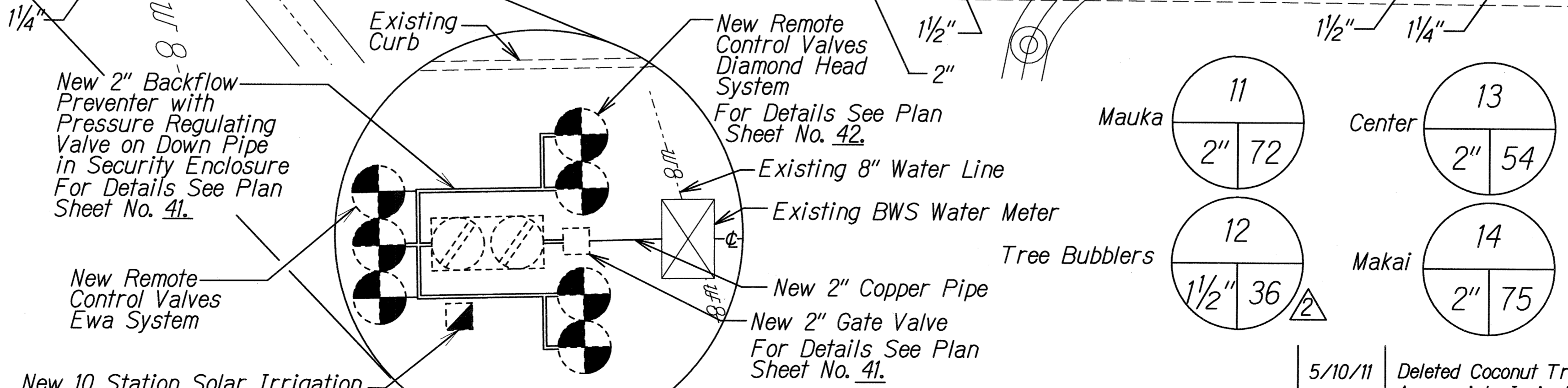
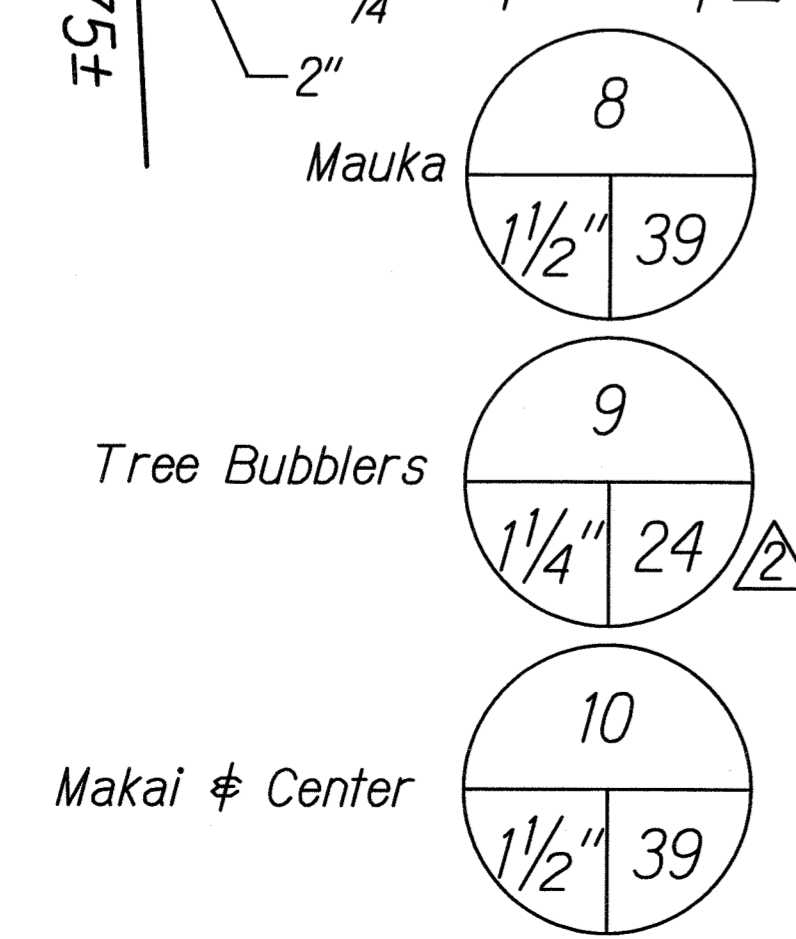
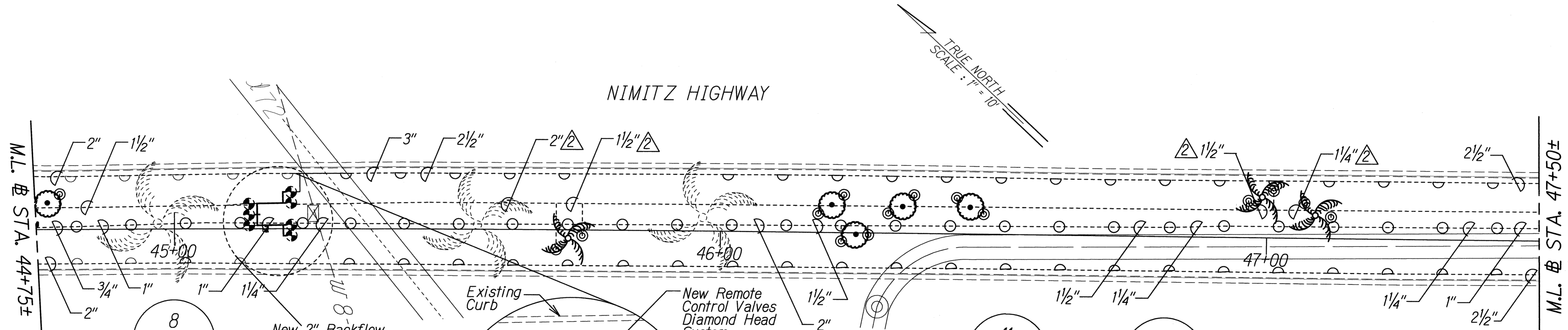
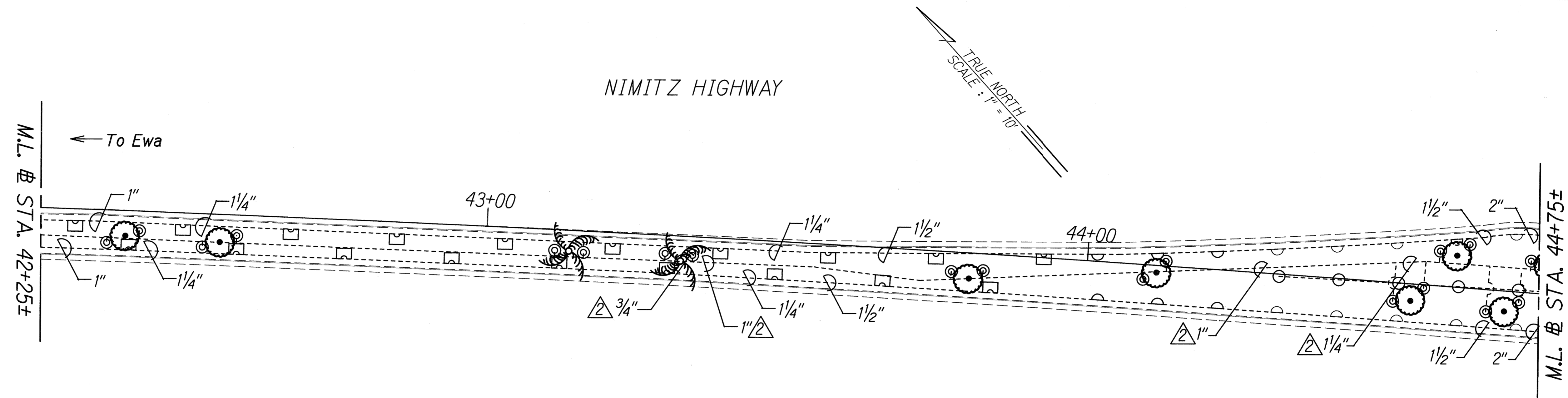

ORIGINAL PLAN	DATE
DESIGNED BY	
DRAWN BY	
CHECKED BY	
DATE	

DATE	REVISION
5/10/11	Deleted Coconut Trees, and Adjusted Appropriate Irrigation. Δ

STATE OF HAWAII
DEPARTMENT OF TRANSPORTATION
HIGHWAYS DIVISION

IRRIGATION PLAN
NIMITZ HWY. MEDIAN IMPROVEMENTS
Sand Island Access Road
to Vicinity of Alakawa Street
Project No. 92A-01-11M

Scale: 1"=10' Date: March, 2011

SHEET No. 5 OF 13 SHEETS

POINT OF CONNECTION - 3

FED. ROAD DIST. NO.	STATE	PROJ. NO.	FISCAL YEAR	SHEET NO.	TOTAL SHEETS
HAWAII	HAW.	92A-01-11M	2011	ADD.31	42

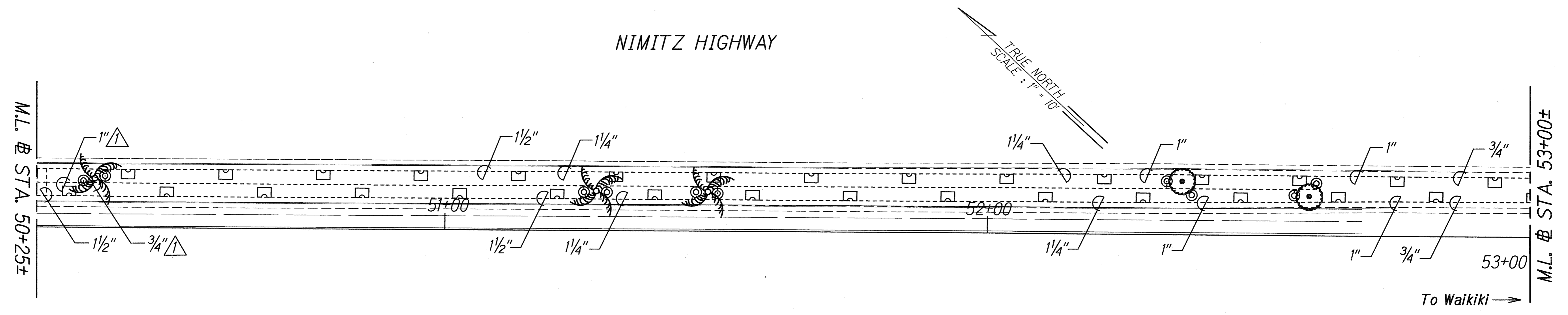
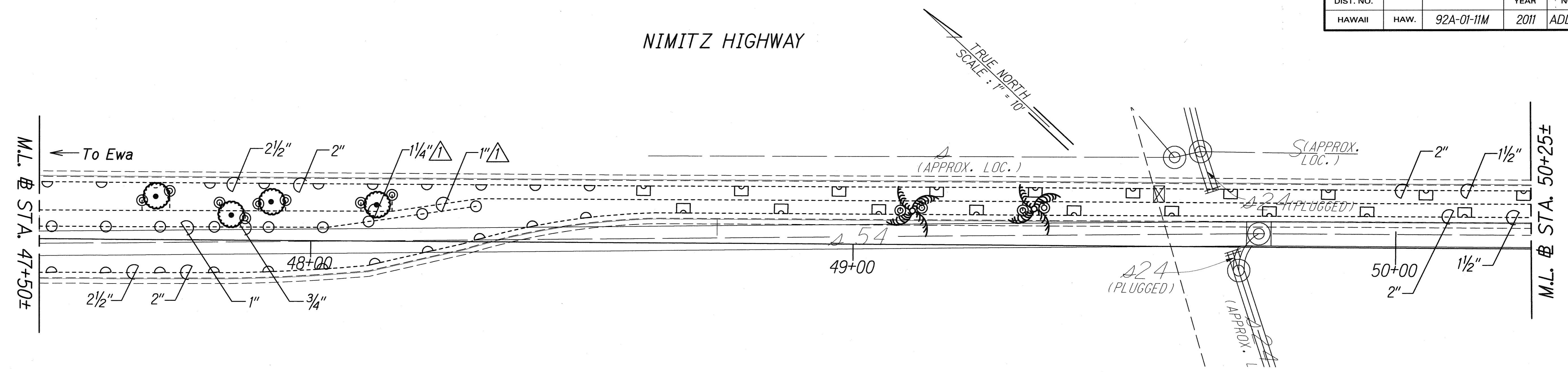

ORIGINAL PLAN	DATE
SURVEY PLOTTED BY	
DRAWN BY	
DESIGNED BY	
NOTE BOOK	
QUANTITIES BY	
CHECKED BY	

5/10/11	Deleted Coconut Trees, and Adjusted Appropriate Irrigation. Δ
DATE	REVISION

STATE OF HAWAII
DEPARTMENT OF TRANSPORTATION
HIGHWAYS DIVISION

IRRIGATION PLAN

NIMITZ HWY. MEDIAN IMPROVEMENTS
Sand Island Access Road
to Vicinity of Alakawa Street
Project No. 92A-01-11M

Scale: 1"=10' Date: March, 2011

SHEET No. 6 OF 13 SHEETS

ADD.31

FED. ROAD DIST. NO.	STATE	PROJ. NO.	FISCAL YEAR	SHEET NO.	TOTAL SHEETS
HAWAII	HAW.	92A-01-11M	2011	ADD.32	42

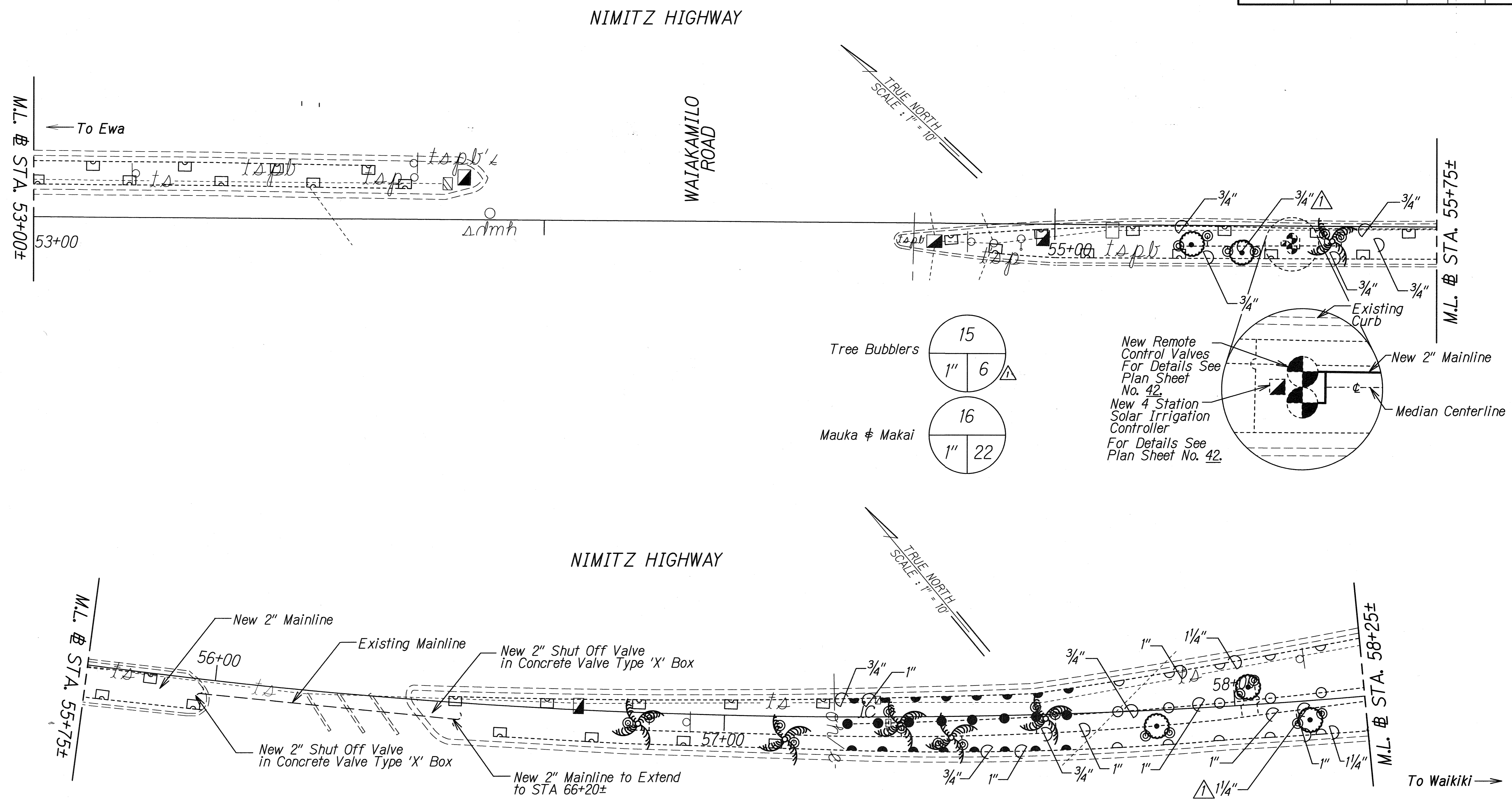

DATE	
SURVEY PLOTTED BY	
DRAWN BY	
TRACED BY	
NOTE BOOK	9/10/11/08
QUANTITIES BY	
CHECKED BY	

5/10/11	Deleted Coconut Trees, and Adjusted Appropriate Irrigation. Δ
DATE	REVISION

STATE OF HAWAII
DEPARTMENT OF TRANSPORTATION
HIGHWAYS DIVISION

IRRIGATION PLAN
NIMITZ HWY. MEDIAN IMPROVEMENTS
Sand Island Access Road
to Vicinity of Alakawa Street
Project No. 92A-01-11M

Scale: 1"=10' Date: March, 2011

SHEET No. 7 OF 13 SHEETS

FED. ROAD DIST. NO.	STATE	PROJ. NO.	FISCAL YEAR	SHEET NO.	TOTAL SHEETS
HAWAII	HAW.	92A-01-11M	2011	ADD.33	42

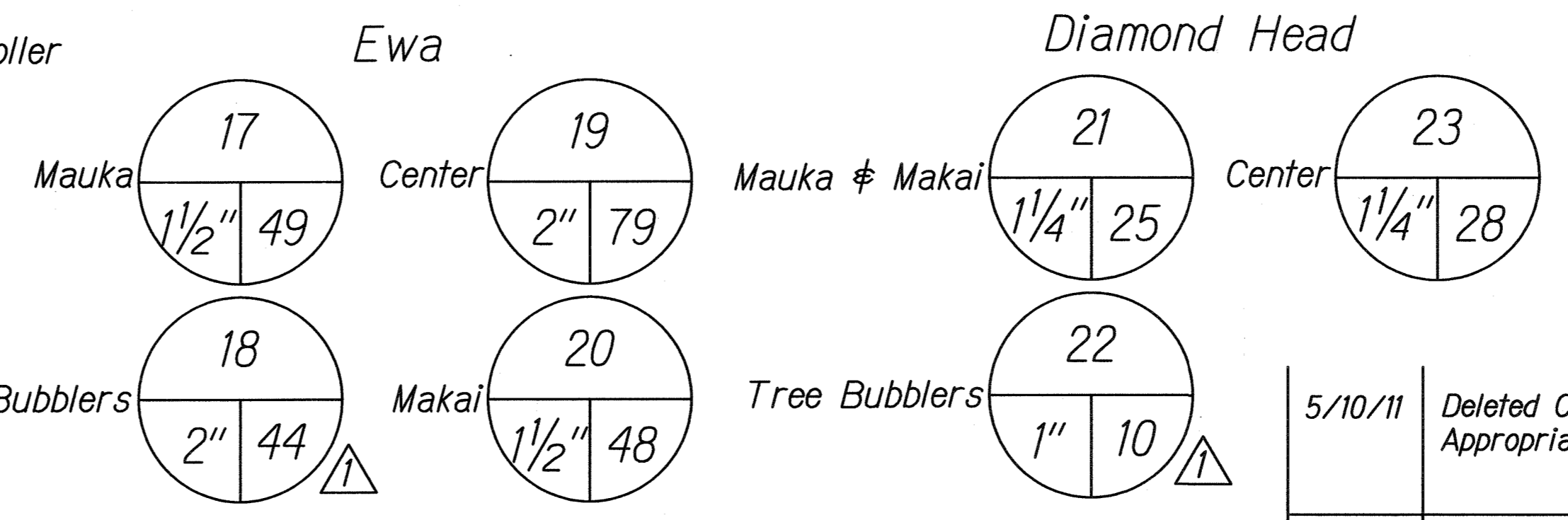
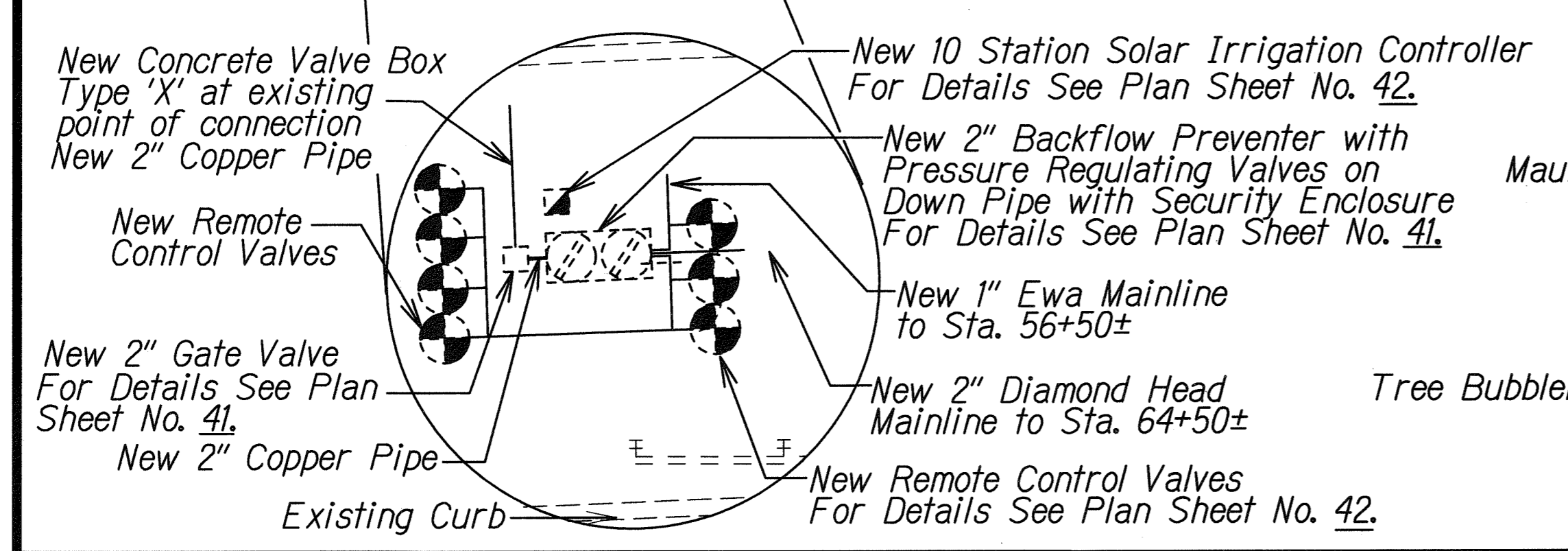
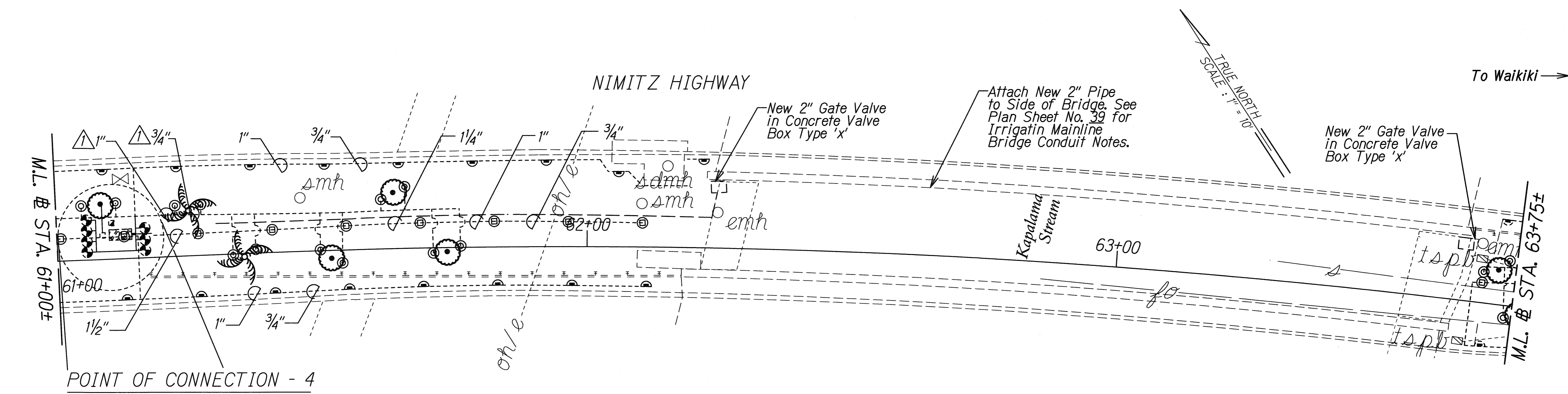
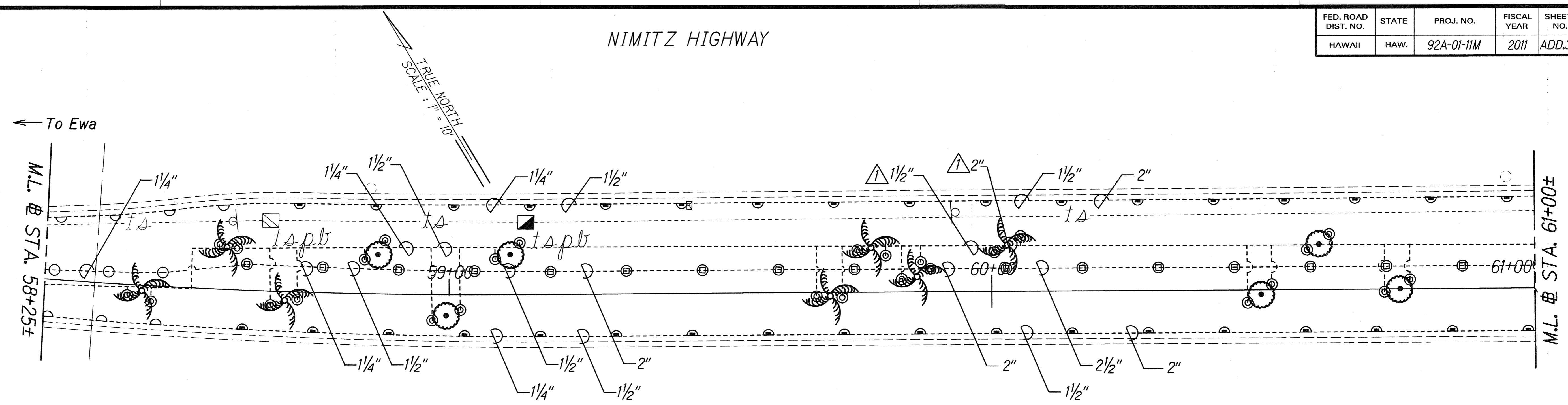

DATE	REVISION
5/10/11	Deleted Coconut Trees, and Adjusted Appropriate Irrigation. (A)

STATE OF HAWAII
DEPARTMENT OF TRANSPORTATION
HIGHWAYS DIVISION

IRRIGATION PLAN
NIMITZ HWY. MEDIAN IMPROVEMENTS
Sand Island Access Road
to Vicinity of Alakawa Street
Project No. 92A-01-11M

Scale: 1"=10' Date: March, 2011

SHEET No. 8 OF 13 SHEETS

ORIGINAL PLAN
DATE
SURVEY PLOTTED BY
DRAWN BY
TRACED BY
NOTE BOOK
QUANTITIES BY
CHECKED BY

FED. ROAD DIST. NO.	STATE	PROJ. NO.	FISCAL YEAR	SHEET NO.	TOTAL SHEETS
HAWAII	HAW.	92A-01-11M	2011	ADD.34	42

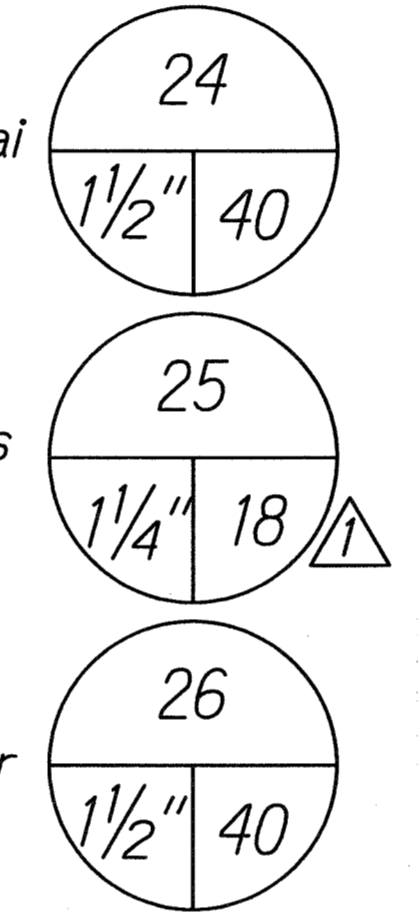
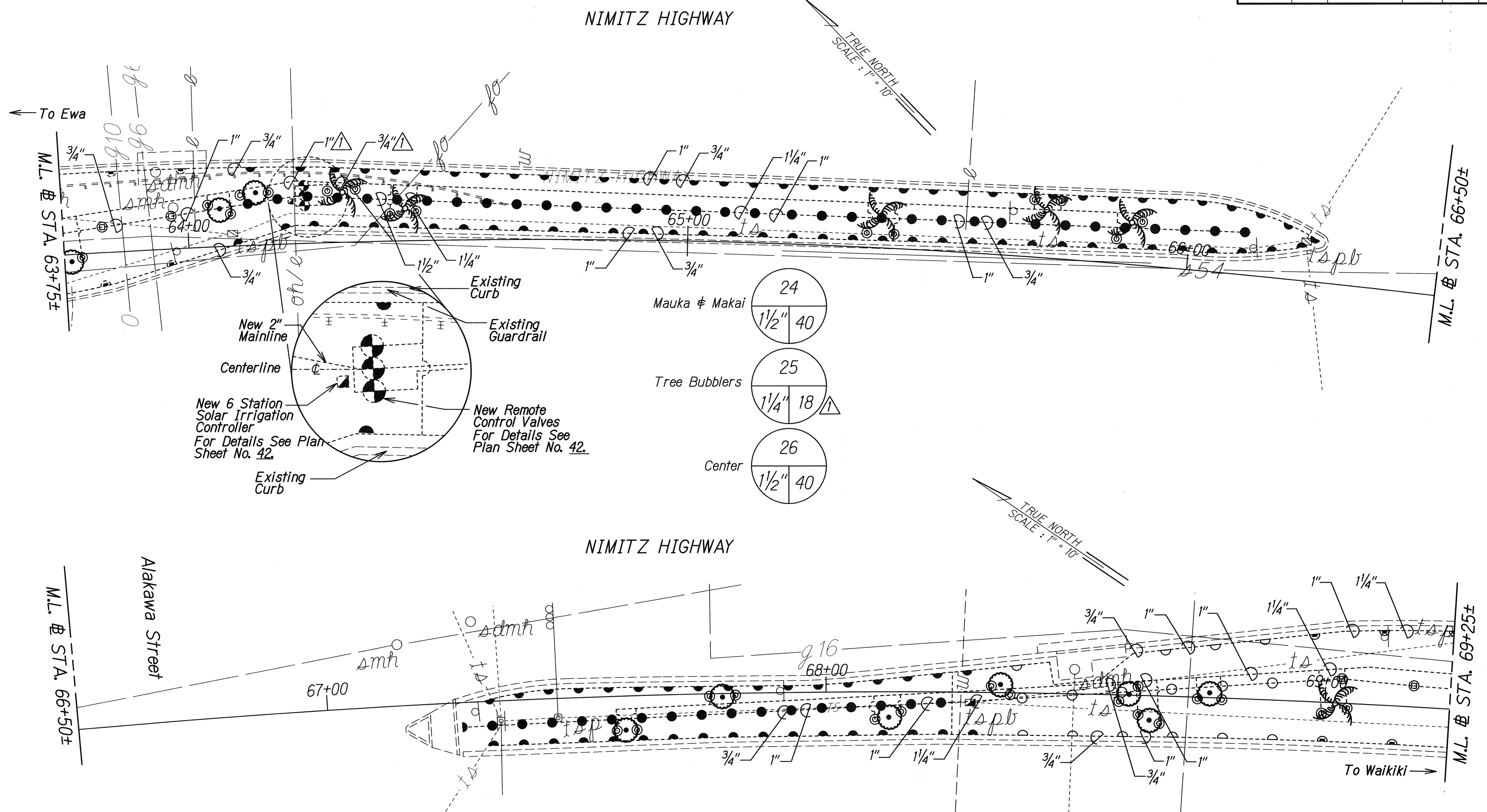

ORIGINAL PLAN	DATE
DRAWN BY	
TRACED BY	
NOTE BOOK	
QUANTITIES BY	
CHECKED BY	

5/10/11	Deleted Coconut Trees, and Adjusted Appropriate Irrigation. Δ
DATE	REVISION

STATE OF HAWAII
DEPARTMENT OF TRANSPORTATION
HIGHWAYS DIVISION

IRRIGATION PLAN
NIMITZ HWY. MEDIAN IMPROVEMENTS
Sand Island Access Road
to Vicinity of Alakawa Street
Project No. 92A-01-11M

Scale: 1"=10' Date: March, 2011

SHEET No. 9 OF 13 SHEETS

ADD.34

FED. ROAD DIST. NO.	STATE	PROJ. NO.	FISCAL YEAR	SHEET NO.	TOTAL SHEETS
HAWAII	HAW.	92A-01-11M	2011	ADD.35	42

NIMITZ HIGHWAY

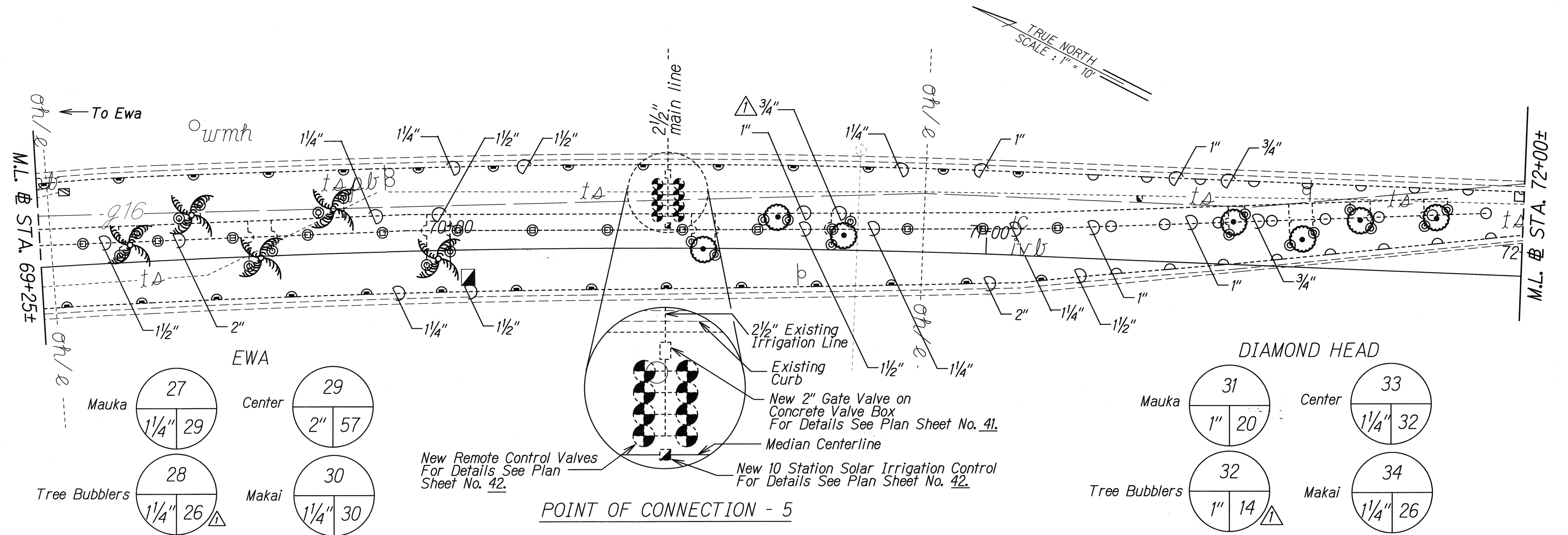

NIMITZ HIGHWAY

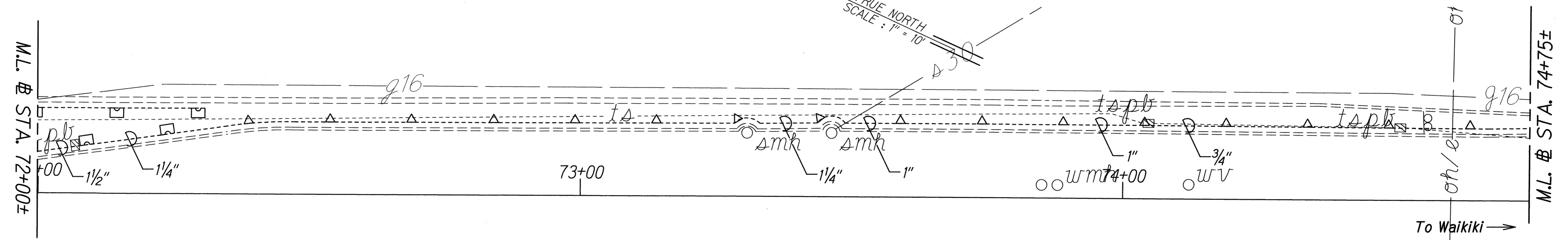

DATE	
SURVEY PLOTTED BY	
DRAWN BY	
DESIGNED BY	
NOTE BOOK	
QUANTITIES BY	
CHECKED BY	

5/10/11	Deleted Coconut Trees, and Adjusted Appropriate Irrigation. Δ
DATE	REVISION

STATE OF HAWAII
DEPARTMENT OF TRANSPORTATION
HIGHWAYS DIVISION

IRRIGATION PLAN

NIMITZ HWY. MEDIAN IMPROVEMENTS
Sand Island Access Road
to Vicinity of Alakawa Street
Project No. 92A-01-11M

Scale: 1"=10' Date: March, 2011

SHEET No. 10 OF 13 SHEETS

FED. ROAD DIST. NO.	STATE	PROJ. NO.	FISCAL YEAR	SHEET NO.	TOTAL SHEETS
HAWAII	HAW.	92A-01-11M	2011	ADD.36	42

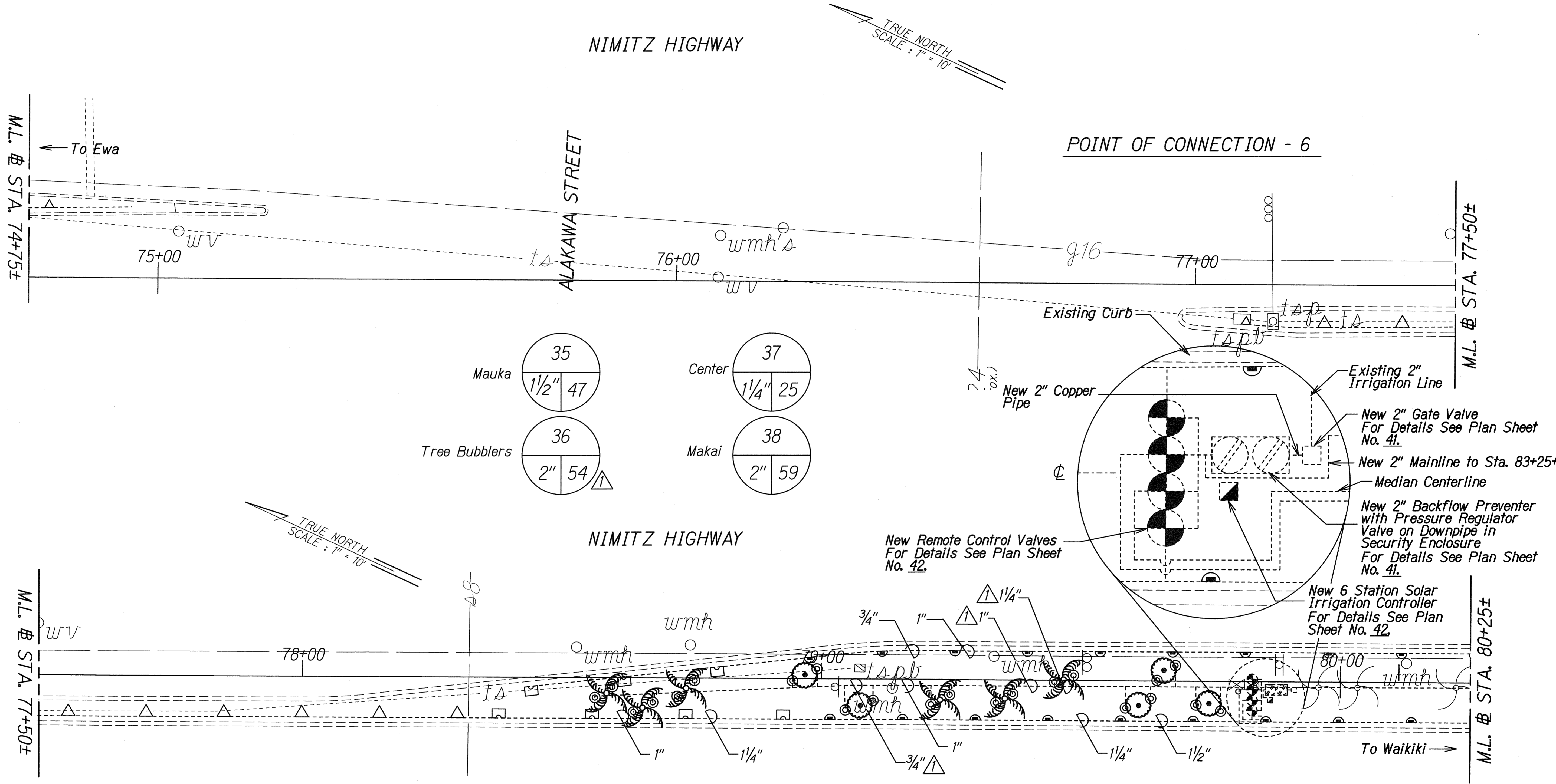

DATE	SURVEY PLOTTED BY
DATE	DRAWN BY
DATE	DESIGNED BY
DATE	CHECKED BY
DATE	NOTED BY

DATE	REVISION
5/10/11	Deleted Coconut Trees, and Adjusted Appropriate Irrigation. Δ

STATE OF HAWAII
DEPARTMENT OF TRANSPORTATION
HIGHWAYS DIVISION

IRRIGATION PLAN
NIMITZ HWY. MEDIAN IMPROVEMENTS
Sand Island Access Road
to Vicinity of Alakawa Street
Project No. 92A-01-11M

Scale: 1"=10' Date: March, 2011

SHEET No. 11 OF 13 SHEETS

FED. ROAD DIST. NO.	STATE	PROJ. NO.	FISCAL YEAR	SHEET NO.	TOTAL SHEETS
HAWAII	HAW.	92A-01-11M	2011	ADD.37	42

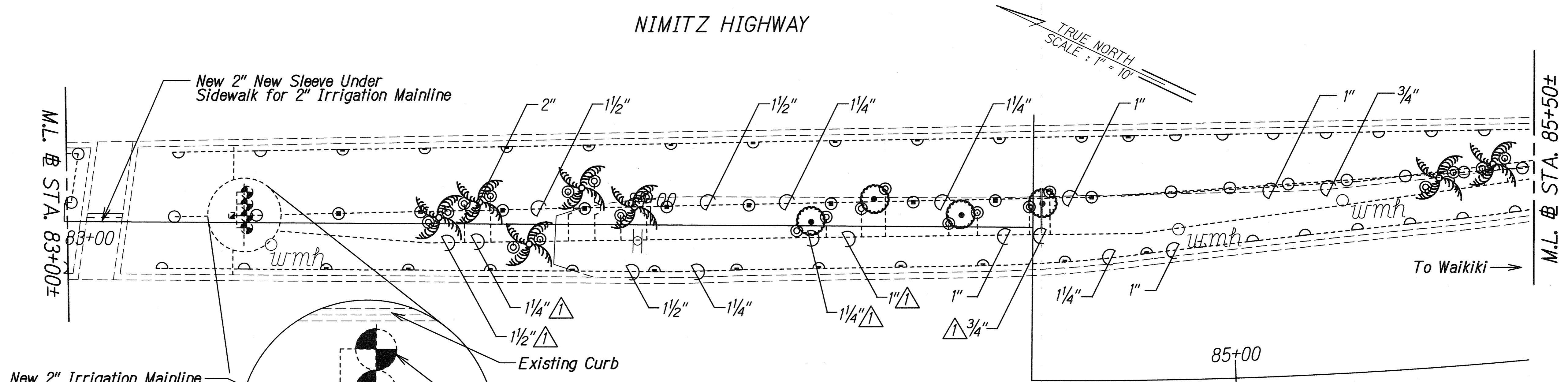
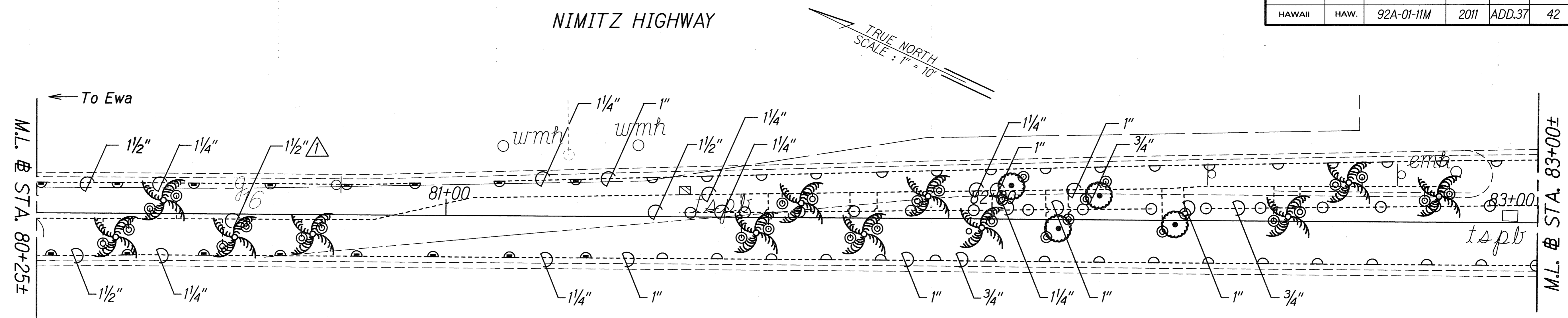

New 2" Irrigation Mainline from Sta. 83+90±

New Remote Control Valve For Details See Plan Sheet No. 42.

New 6 Station Solar Irrigation Controller For Details See Plan Sheet No. 42.

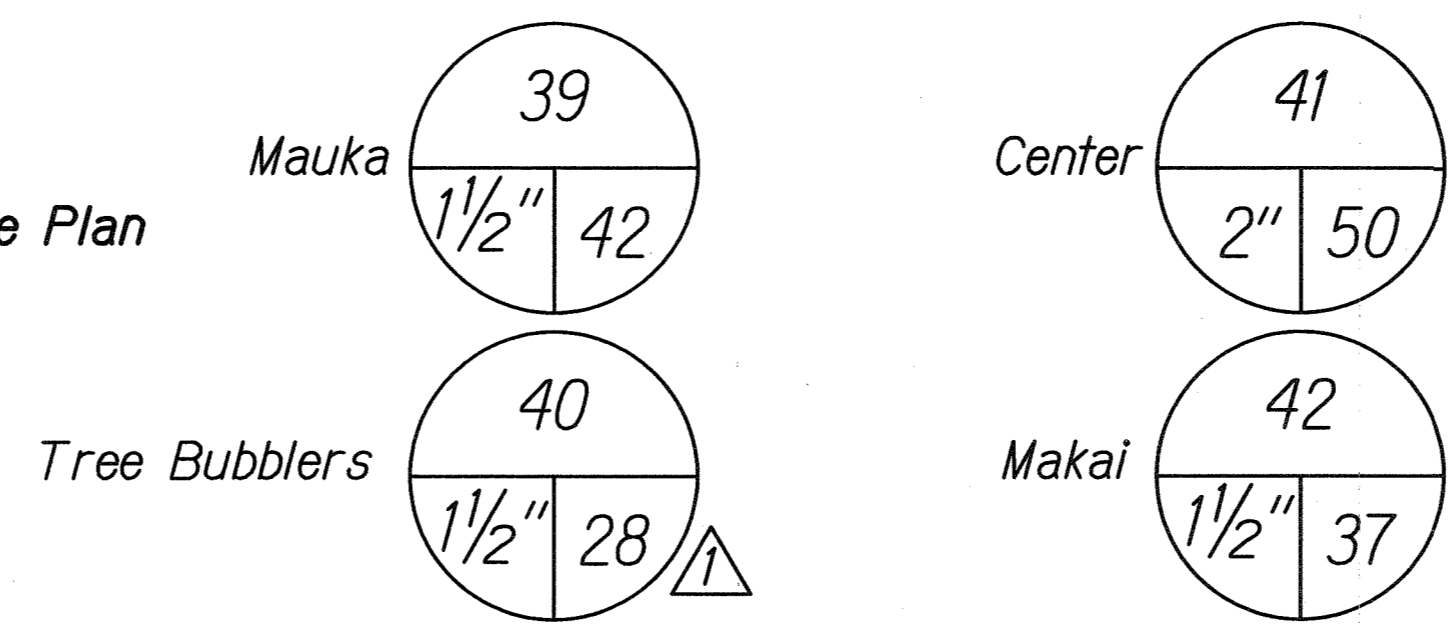

DATE	REVISION
5/10/11	Deleted Coconut Trees, and Adjusted Appropriate Irrigation. Δ

STATE OF HAWAII
DEPARTMENT OF TRANSPORTATION
HIGHWAYS DIVISION

IRRIGATION PLAN
NIMITZ HWY. MEDIAN IMPROVEMENTS
Sand Island Access Road
to Vicinity of Alakawa Street
Project No. 92A-01-11M

Scale: 1"=10' Date: March, 2011

SHEET No. 12 OF 13 SHEETS

SURVEY PLOTTED BY	DATE
DRAWN BY	
TRACED BY	
NOTE BOOK	
QUANTITIES BY	
CHECKED BY	

FED. ROAD DIST. NO.	STATE	PROJ. NO.	FISCAL YEAR	SHEET NO.	TOTAL SHEETS
HAWAII	HAW.	92A-01-11M	2011	38	42

POINT OF CONNECTION - 7

NIMITZ HIGHWAY

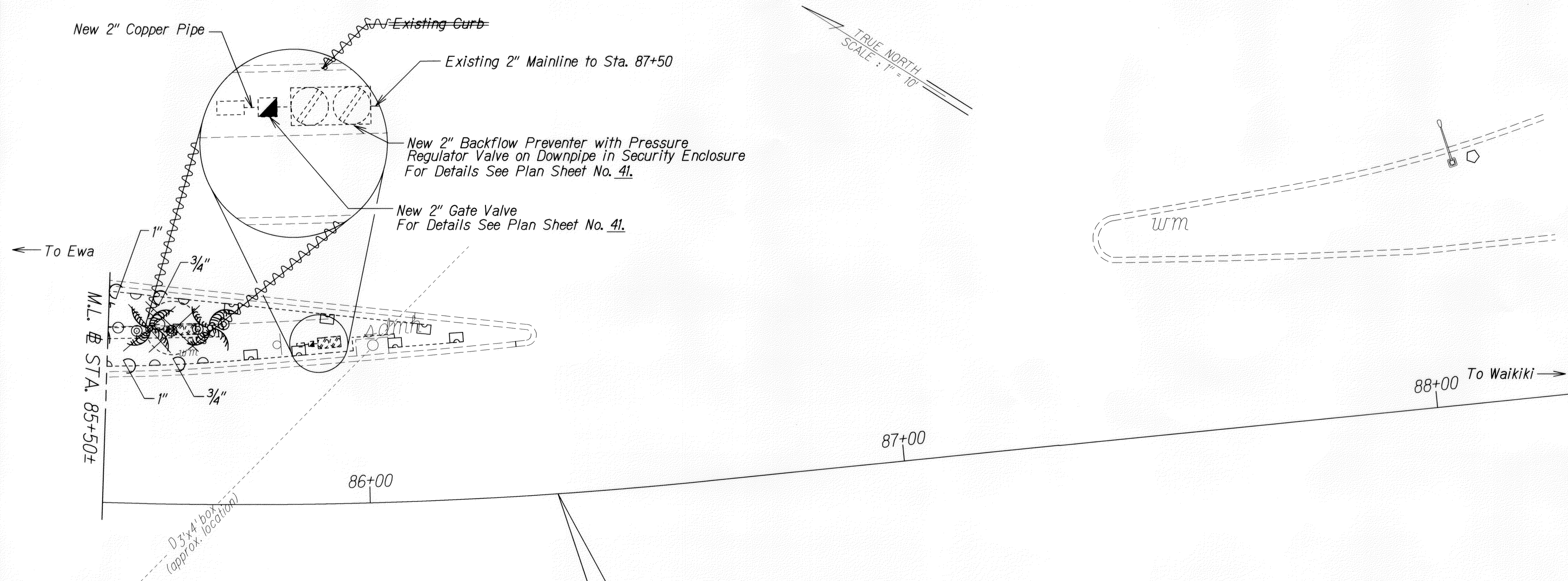

← To Ewa

M.L. @ STA. 85+50±

D 3/4" box (approx. location)

86+00

87+00

88+00 To Waikiki →

END OF IRRIGATION
Project No. 92A-01-11M
@ Sta. 86+35±

LEGEND FOR AS-BUILT POSTINGS

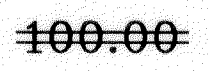
	Squiggly line for as-built deletion
	Double line for as-built deletion
Roadway	Text for as-built posting

STATE OF HAWAII
DEPARTMENT OF TRANSPORTATION
HIGHWAYS DIVISION

IRRIGATION PLAN

*NIMITZ HWY. MEDIAN IMPROVEMENTS
Sand Island Access Road
to Vicinity of Alakawa Street
Project No. 92A-01-11M*

Scale: 1"=10' Date: March, 2011

SHEET No. 13 OF 13 SHEETS

ORIGINAL PLAN	SURVEY PLOTTED BY	DATE
NOTE BOOK	TRACED BY	
NO. 100	DESIGNED BY	
	QUANTITIES BY	
	ENGINEER BY	

"AS-BUILT"