

FED. ROAD DIST. NO.	STATE	PROJ. NO.	FISCAL YEAR	SHEET NO.	TOTAL SHEETS
HAWAII	HAW.	92A-01-11M	2011	ADD.10	42

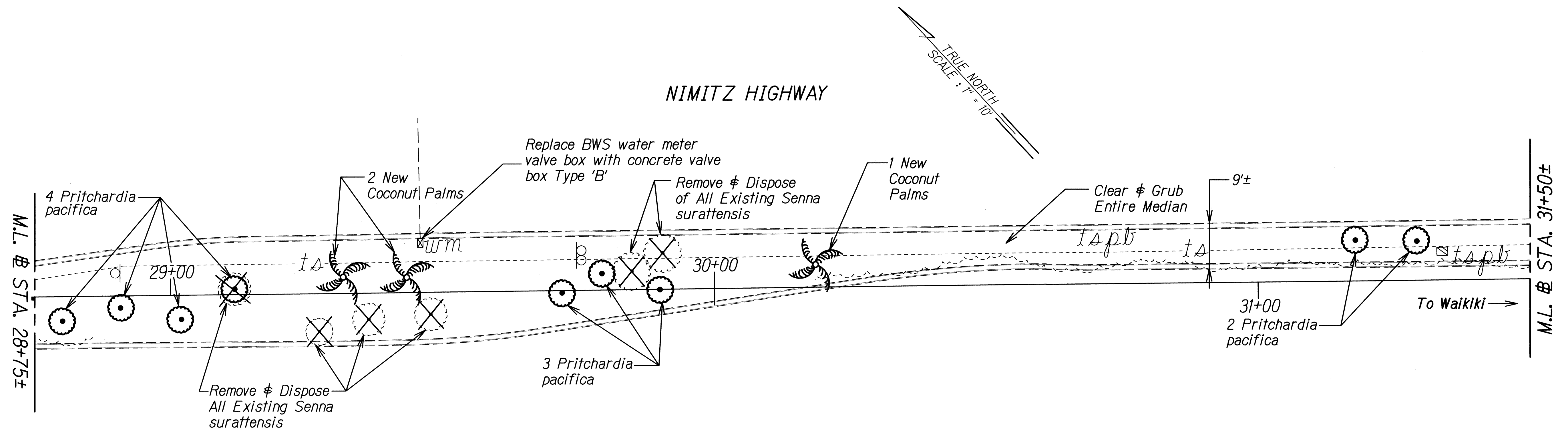
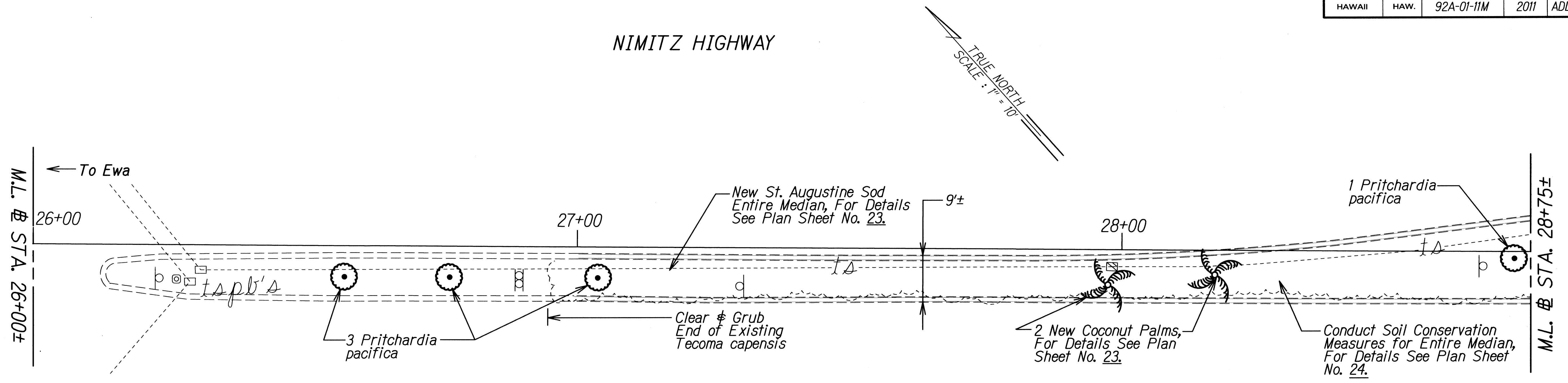

STA. 26+10 to # STA. 32+60 Median - Puuhale Road to Mokauea Street
 Clear & Grub Entire Median. Conduct Soil Conservation Measures for Entire Median. Remove and Dispose of Existing Irrigation. Install Completely New Irrigation System. Install New Coconut, Palms Fiji Fan Palms and St. Augustine Sod.

SURVEY PLOTTED BY	DATE
DESIGNED BY	
TRACED BY	
NOTE BOOK	
QUANTITIES BY	
CHECKED BY	
N. 2501	

5/10/11	Deleted Coconut Trees
DATE	REVISION

STATE OF HAWAII
 DEPARTMENT OF TRANSPORTATION
 HIGHWAYS DIVISION

LANDSCAPE PLAN

NIMITZ HWY. MEDIAN IMPROVEMENTS
 Sand Island Access Road
 to Vicinity of Alakawa Street
 Project No. 92A-01-11M

Scale: 1"=10' Date: March, 2011

SHEET No. 3 OF 14 SHEETS

FED. ROAD DIST. NO.	STATE	PROJ. NO.	FISCAL YEAR	SHEET NO.	TOTAL SHEETS
HAWAII	HAW.	92A-01-11M	2011	ADD.12	42

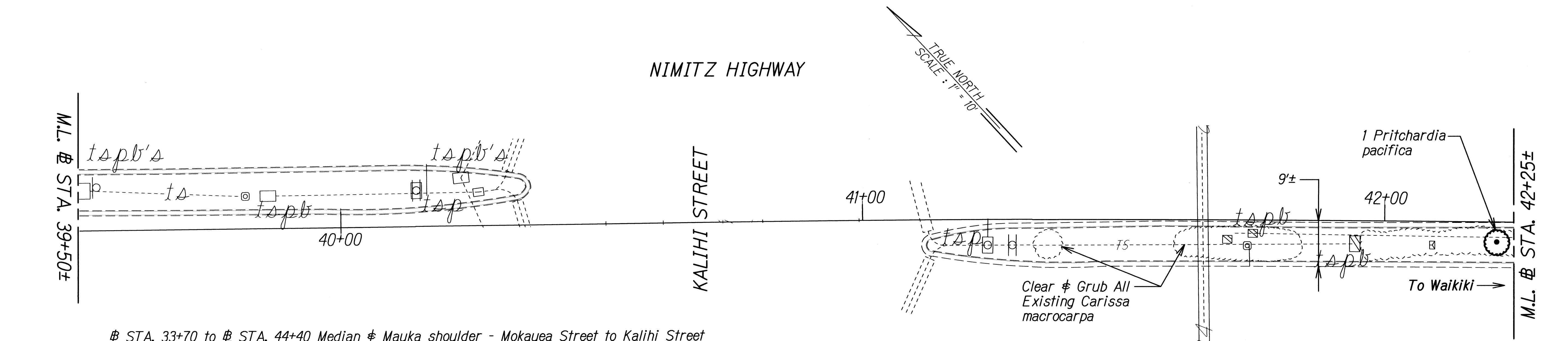
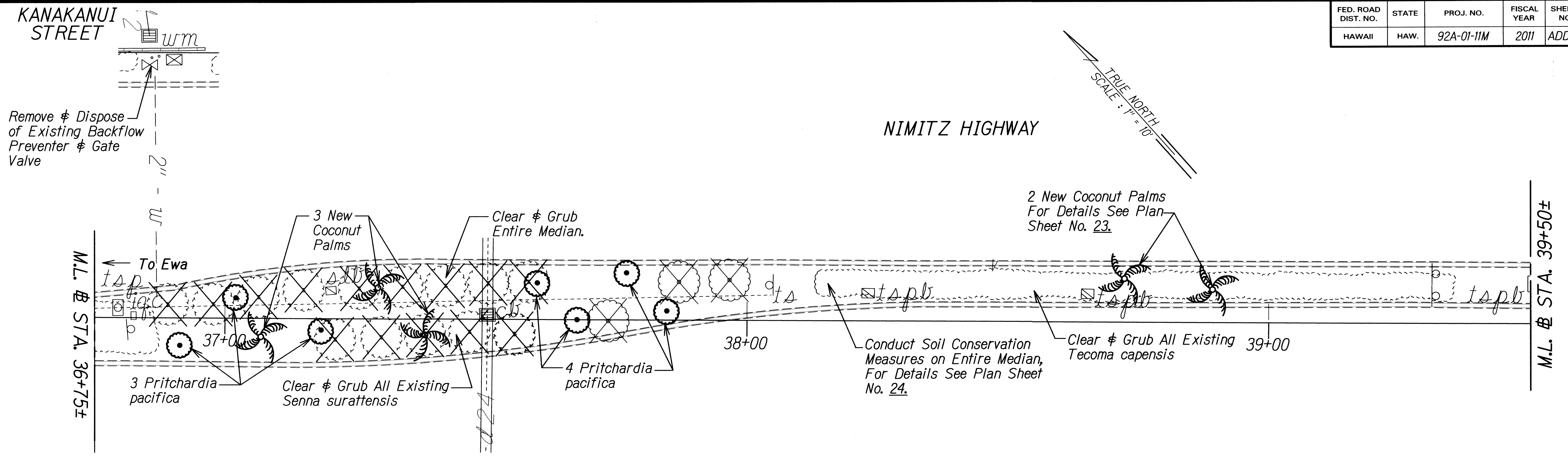

From STA. 33+70 to STA. 44+40 Median & Mauka shoulder - Mokauea Street to Kalihi Street
 Clear & Grub Entire Median. Conduct Soil Conservation Measures for Entire Median.
 Remove and Dispose of Existing Irrigation. Install Completely New Irrigation System.
 Install New Coconut Palms, Fiji Fan Palms and St. Augustine Sod.

ORIGINAL PLAN	DATE
DESIGNED BY	
QUANTITIES BY	
CHECKED BY	

5/10/11	Deleted Coconut Trees
DATE	REVISION

STATE OF HAWAII
 DEPARTMENT OF TRANSPORTATION
 HIGHWAYS DIVISION

LANDSCAPE PLAN

NIMITZ HWY. MEDIAN IMPROVEMENTS
 Sand Island Access Road
 to Vicinity of Alakawa Street
 Project No. 92A-01-11M

Scale: 1"=10' Date: March, 2011

SHEET No. 5 OF 16 SHEETS

FED. ROAD DIST. NO.	STATE	PROJ. NO.	FISCAL YEAR	SHEET NO.	TOTAL SHEETS
HAWAII	HAW.	92A-01-11M	2011	ADD.14	42

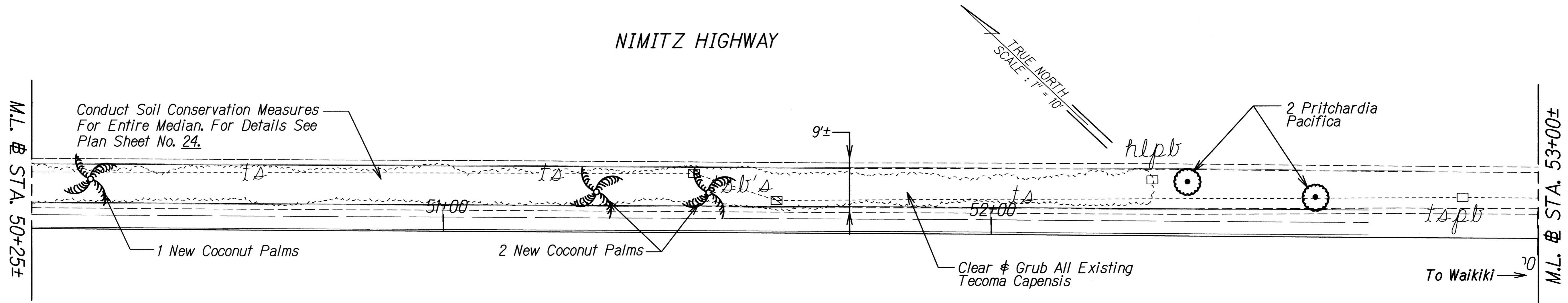
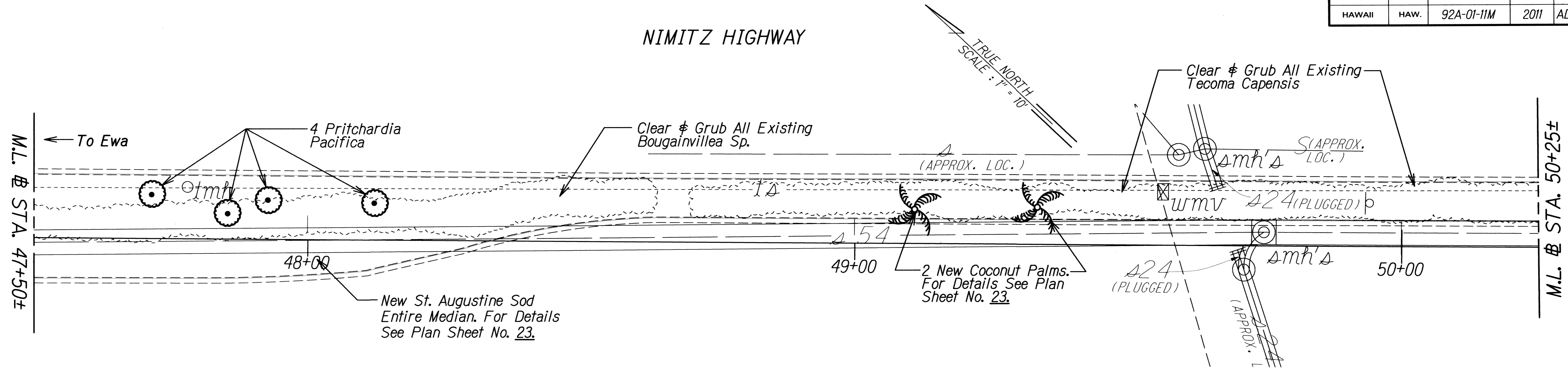

ORIGINAL PLAN	DATE
DESIGNED BY	
DRAWN BY	
CHECKED BY	
QUANTITIES BY	
NOTED BY	
DATE	

5/10/11	Deleted Coconut Trees
DATE	REVISION

STATE OF HAWAII
DEPARTMENT OF TRANSPORTATION
HIGHWAYS DIVISION

LANDSCAPE PLAN

NIMITZ HWY. MEDIAN IMPROVEMENTS
Sand Island Access Road
to Vicinity of Alakawa Street
Project No. 92A-01-11M

Scale: 1"=10' Date: March, 2011

SHEET No. 7 OF 14 SHEETS

FED. ROAD DIST. NO.	STATE	PROJ. NO.	FISCAL YEAR	SHEET NO.	TOTAL SHEETS
HAWAII	HAW.	92A-01-11M	2011	ADD.16	42

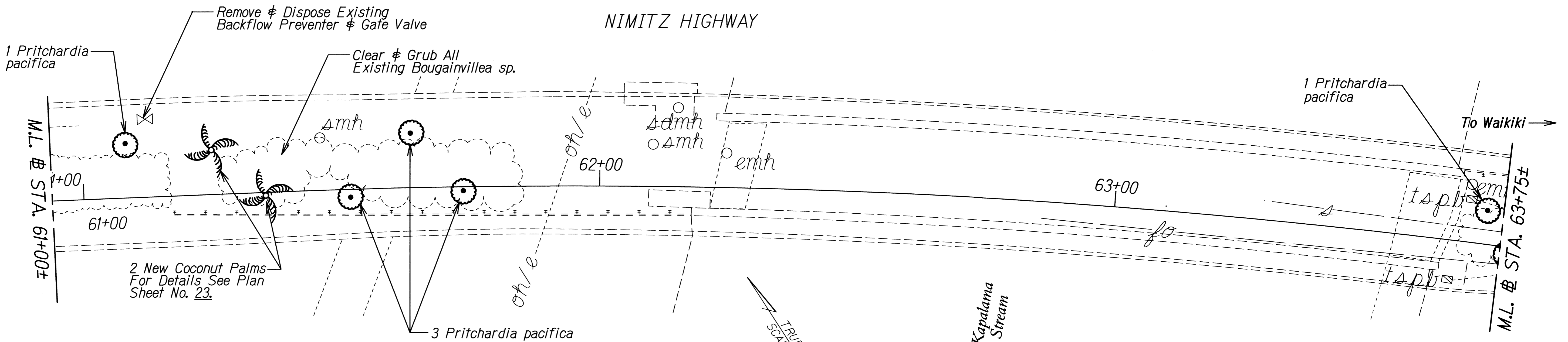
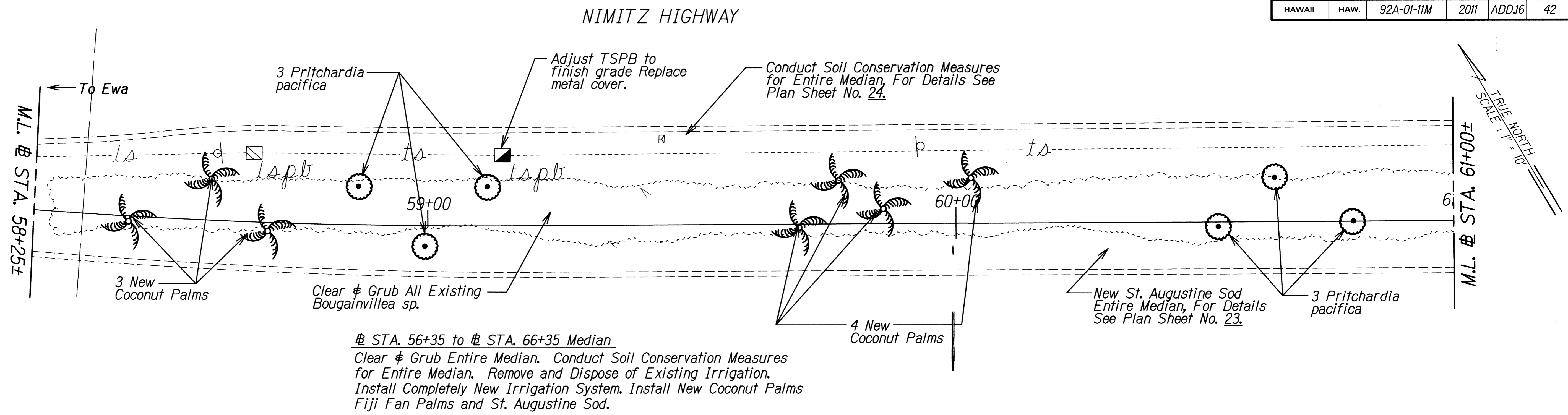

DESIGNED BY	DATE
TRACED BY	
DESIGNED BY	
QUANTITIES BY	
CHECKED BY	
ORIGINAL PLAN	
NOTE BOOK	
NO.	

5/10/11	Deleted Coconut Trees
DATE	REVISION

STATE OF HAWAII
DEPARTMENT OF TRANSPORTATION
HIGHWAYS DIVISION

LANDSCAPE PLAN

NIMITZ HWY. MEDIAN IMPROVEMENTS
Sand Island Access Road
to Vicinity of Alakawa Street
Project No. 92A-01-11M

Scale: 1"=10' Date: March, 2011

SHEET No. 9 OF 14 SHEETS

FED. ROAD DIST. NO.	STATE	PROJ. NO.	FISCAL YEAR	SHEET NO.	TOTAL SHEETS
HAWAII	HAW.	92A-01-11M	2011	17	42

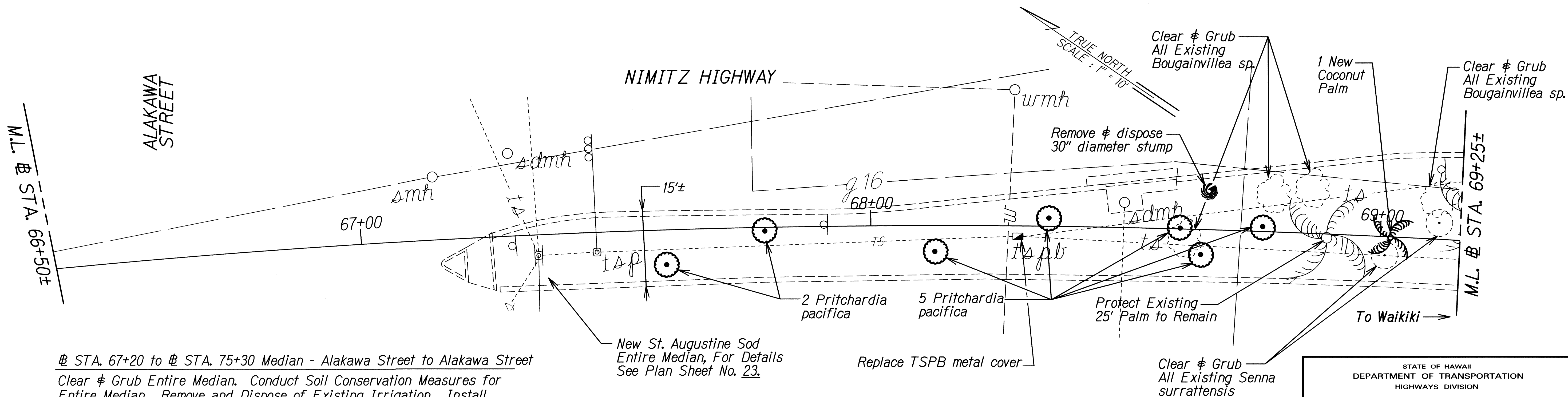
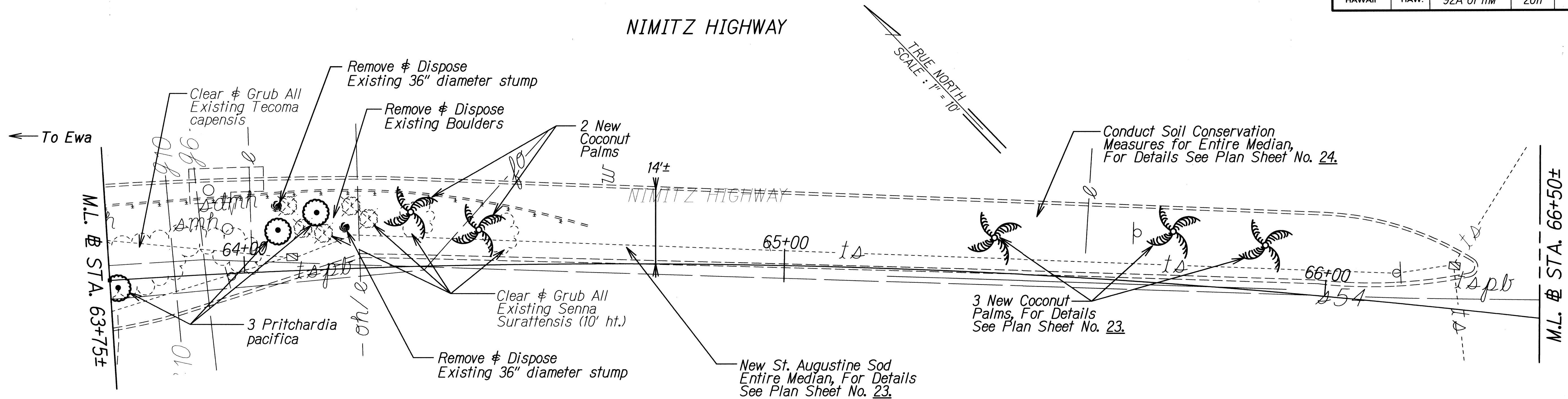

@ STA. 67+20 to @ STA. 75+30 Median - Alakawa Street to Alakawa Street
 Clear & Grub Entire Median. Conduct Soil Conservation Measures for Entire Median. Remove and Dispose of Existing Irrigation. Install Completely New Irrigation System. Install New Coconut Palms, Fiji Fan Palms and St. Augustine Sod.

New St. Augustine Sod Entire Median, For Details See Plan Sheet No. 23.

Replace TSPB metal cover

Clear & Grub All Existing Senna surrattensis

DATE	BY
DATE	BY
DATE	BY
DATE	BY
DATE	BY

5/10/11	Deleted Coconut Trees
DATE	REVISION

STATE OF HAWAII
 DEPARTMENT OF TRANSPORTATION
 HIGHWAYS DIVISION
LANDSCAPE PLAN
NIMITZ HWY. MEDIAN IMPROVEMENTS
Sand Island Access Road
to Vicinity of Alakawa Street
Project No. 92A-01-11M
 Scale: 1"=10' Date: March, 2011
 SHEET No. 10 OF 14 SHEETS

FED. ROAD DIST. NO.	STATE	PROJ. NO.	FISCAL YEAR	SHEET NO.	TOTAL SHEETS
HAWAII	HAW.	92A-01-11M	2011	ADD.19	42

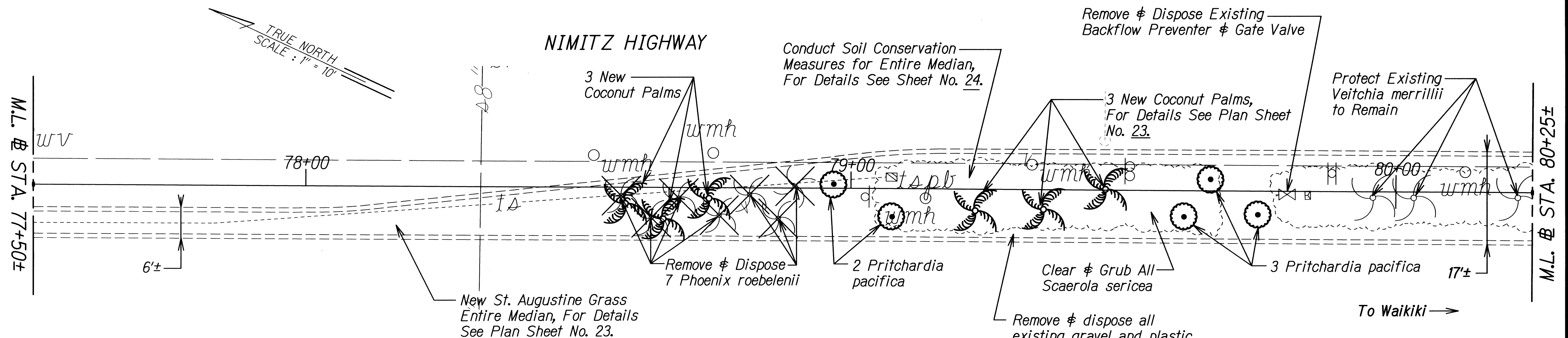
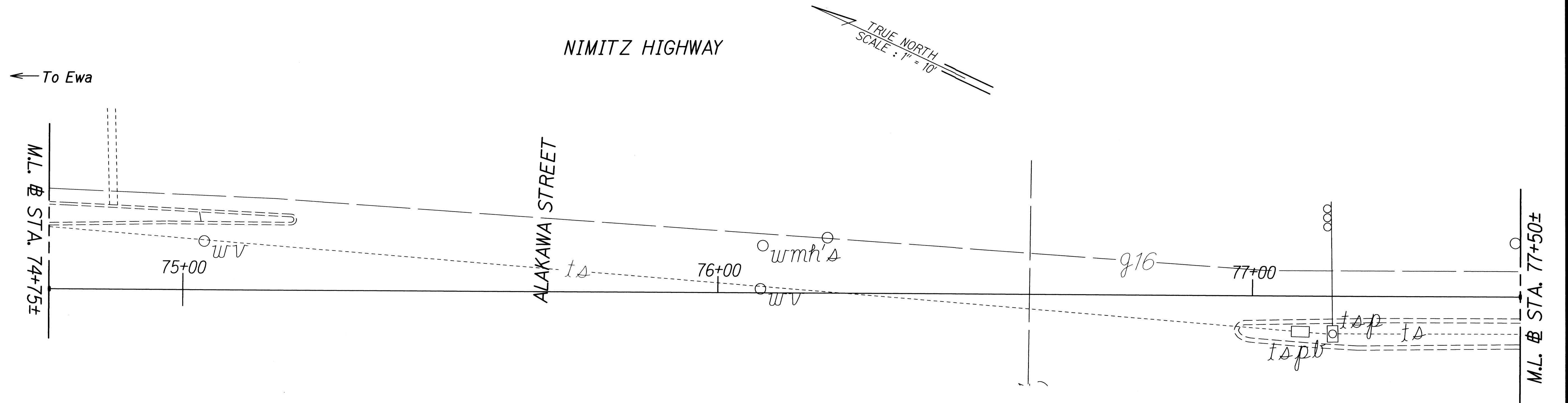

Between STA. 83+90 to STA. 86+40 median
 Clear and Grub Entire Median. Remove & Dispose Asphalt Paving Below Grass. Conduct Soil Conservation Measures for Entire Median. Remove and Dispose of Existing Irrigation. Install Completely New Irrigation System. Install New Coconut Palms, Fiji Fan Palms and St. Augustine Sod.

New St. Augustine Grass Entire Median, For Details See Plan Sheet No. 23.

Conduct Soil Conservation Measures for Entire Median, For Details See Sheet No. 24.

Remove & Dispose Existing Backflow Preventer & Gate Valve

3 New Coconut Palms, For Details See Plan Sheet No. 23.

Protect Existing Veitchia merrillii to Remain

Remove & Dispose 7 Phoenix roebelenii

2 Pritchardia pacifica

Clear & Grub All Scaerola sericea

3 Pritchardia pacifica

Remove & dispose all existing gravel and plastic & metal headers.

ORIGINAL PLAN	SURVEY PLOTTED BY	DATE
NOTE BOOK	DESIGNED BY	
9/10/10	QUANTITIES BY	
2011	CHECKED BY	

5/10/11	Deleted Coconut Trees
DATE	REVISION

STATE OF HAWAII
 DEPARTMENT OF TRANSPORTATION
 HIGHWAYS DIVISION

LANDSCAPE PLAN

NIMITZ HWY. MEDIAN IMPROVEMENTS
 Sand Island Access Road
 to Vicinity of Alakawa Street
 Project No. 92A-01-11M

Scale: 1"=10' Date: March, 2011

SHEET No. 12 OF 14 SHEETS

FED. ROAD DIST. NO.	STATE	PROJ. NO.	FISCAL YEAR	SHEET NO.	TOTAL SHEETS
HAWAII	HAW.	92A-01-11M	2011	ADD.20	42

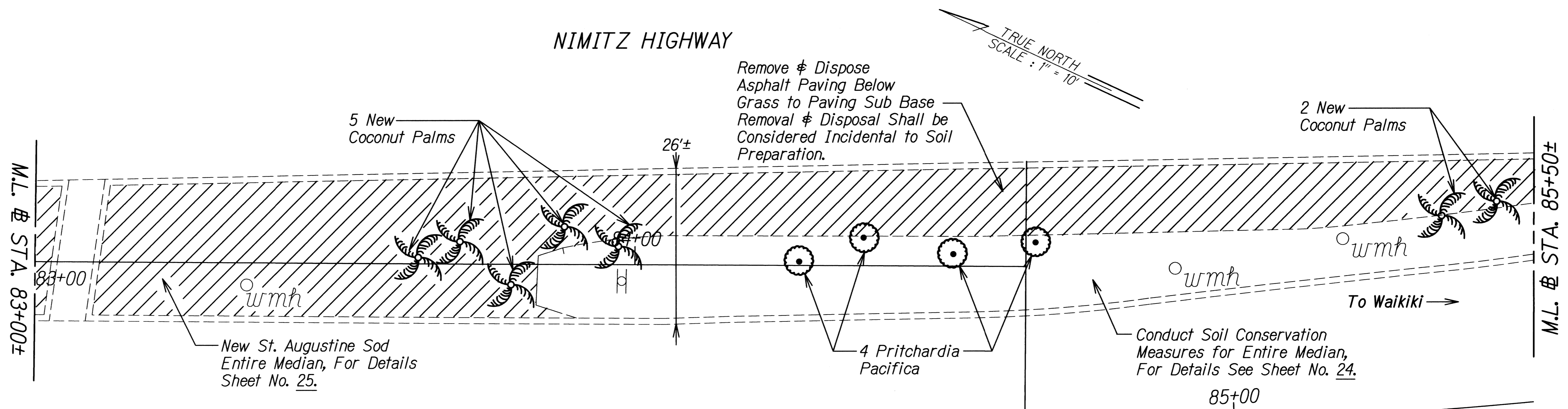
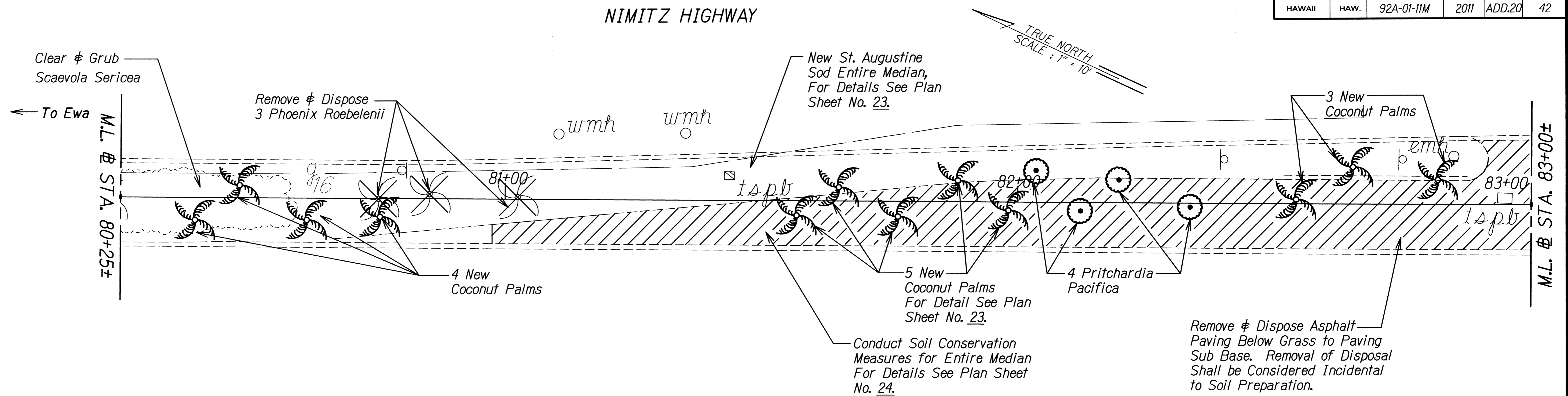

From STA. 83+90 to STA. 86+40 Median
 Clear and Grub Entire Median. Remove & Dispose Asphalt Paving Below Grass to Paving Sub Base. Conduct Soil Conservation Measures for Entire Median. Remove and Dispose of Existing Irrigation. Install Completely New Irrigation System. Install New Coconut Palms, Fiji Fan Palms and St. Augustine Sod.

DESIGNED BY	DATE
DRAWN BY	
CHECKED BY	
QUANTITIES BY	
NOTED BY	
ORIGINAL PLAN	

5/10/11	Deleted Coconut Trees
DATE	REVISION

STATE OF HAWAII
 DEPARTMENT OF TRANSPORTATION
 HIGHWAYS DIVISION

LANDSCAPE PLAN

NIMITZ HWY. MEDIAN IMPROVEMENTS
 Sand Island Access Road
 to Vicinity of Alakawa Street
 Project No. 92A-01-11M

Scale: 1"=10' Date: March, 2011

SHEET No. 13 OF 14 SHEETS

PLANTING NOTES:

FED. ROAD DIST. NO.	STATE	PROJ. NO.	FISCAL YEAR	SHEET NO.	TOTAL SHEETS
HAWAII	HAW.	92A-01-11M	2011	ADD.22	42

- Landscape Contractor shall field verify all plant quantities and dimensions prior to installation. Quantities shown on plant list are for reference only, verify actual quantities as shown on plan. If there is discrepancy, the planting plan shall take precedence.
- Landscape Contractor shall be responsible for location and protecting existing utilities.
- Prior to tree excavation, all planting locations shall be staked out by Contractor for approval by Engineer. Do not plant until ground has been prepared and free of stones greater than 1/2" diameter, pipes, debris, trash, stumps, shrubs; site is neat, orderly, and the Engineer accepts site for planting.
- Notify Engineer of any discrepancies in plant locations or insufficient plant quantities due to difference in plans and actual field conditions.
- Notify Engineer 30 days prior to planting operations for approval of all plant material at place of growth. All plant material not approved by the Engineer will be subject to rejection.
- The Engineer will inspect plants at the place of growth and after the delivery to the project. Each tree shall be tagged by the engineer with a consecutively numbered plastic tamper-resistant and self-locking seal. Seals shall remain on tree and only be removed by the engineer at the completion of the plant establishment period. Trees delivered to the project without engineers seal will be rejected.
- Plants shall meet size indicated by minimum height and spread. Plants shall be straight and uniformly shaped, unless unique or special characteristics are specified, and shall be undamaged, sound, healthy, vigorous and free of disease and insect infestation. Plants not conforming to these requirements on delivery to the project and at the end of the plant establishment period will be rejected.
- Contractor shall be solely responsible for the complete removal and damages resulting from planting any plant species listed on the Hawaii Department of Agriculture 'Noxious weed rules' as defined in the statute, Hawaii Administrative Rules 4:68:1 or the 'Federal Noxious Weed List' as defined in Title 7 of the code of Federal Regulations (CFR), parts 360 and 361.
- All tree work must adhere to American National Standard Institute (or ANSI)-A300 tree care standards and ANSI-Z133 safety standards for tree work. Work shall be contracted to Arborists that has been certified in good standings as an ISA certified Arborist for at least 5 years to assure that tree work is performed properly and trees are not damaged by practices such as topping, flush cuts, over-thinning, or climbing with spikes. Contractor shall submit a copy of the ISA Arborist certification of good standing if 5 years to the Engineer minimum 7 days prior to tree pruning.
- For the duration of construction within the drip line of trees to remain there must be: no changes, alterations or disturbance to the grade by adding fill, excavating or scraping except as noted on plans; no storage of construction material or equipment; no stockpiling of any construction material or any excavated material no disposal of any liquids (e.g. concrete sleuth, gas, oil paint); no vehicular traffic, equipment or excessive pedestrian traffic no attachment of any wires, ropes, lights, or any other such attachment other than those of protective nature to any tree to be preserved; and no cleaning of equipment or material under the canopy of any tree or group of trees to remain.
- If trees other than those specifically designated for removal are damaged beyond survival conditions as determined by engineer, the contractor shall remove such trees and replace the tree with a same specie and size and maintain for the duration of construction or 12 months whichever is greater at no cost to the state.
- Representative samples of soil from project site shall be submitted to the University of Hawaii Agricultural Extension Service or laboratory acceptable to the engineer for analysis of required soil amendments. Test results and fertilization schedule shall be presented to the engineer for review and acceptance before placing planting soil. Uniformly distribute fertilizer and amendments over planting areas as recommended by the soil analysis report. Rototill top four-inches of soil to evenly incorporate fertilizer and amendments. After completion of soil amendments, retest to meet soil analysis. Continue amending until test meets soil test recommendations. Provide copy of all soil tests to engineer.

- Guy wires, flagging, stakes, windbreakers, etc. shall be maintained and replaced if necessary by the Contractor until the tree or shrub is able to stand by itself. The Contractor shall remove and dispose at the end of plant establishment period.
- Any planting that obstructs sight distance, signs or traffic lights shall be relocated or removed as determined by the Engineer.
- All palms shall be set back a minimum of 30 inches from the face of the curb.
- The State of Hawaii owns the Fiji Fan Palms. The source of the Fiji Fan Palms shall be the City and County of Honolulu High Capacity Transit Corridor Project holding site which shall be within 25 miles of Waipahu. The contractor shall coordinate with the City and County of Honolulu for access to the holding site and transport the Fiji Fan Palms to the project. The contractor shall be solely responsible for replacing all Fiji Fan Palms that do not survive with same species and same heights.

QUANTITY	BOTANICAL NAME	COMMON NAME	SIZE	COMMENTS
89	<i>Pritchardia pacifica</i>	Fiji Fan Palm	25 - 30' Brown Trunk	
△ 76	<i>Cocos nucifera</i>	Coconut Palm	15 - 20' Brown Trunk	Field Specimen. Free of climbing spike holes.
90,000 sq. ft.	<i>Stenotaphrum secundatum</i>	St. Augustine Grass Sod	Sod	Sod

DESIGNED BY	DATE
CHECKED BY	
QUANTITIES BY	
DESIGNED BY	
TRACED BY	
DRAWN BY	
PLANTING	
ORIGINAL PLAN	

5/10/11	Adjusted total count of coconut trees △
DATE	REVISION

STATE OF HAWAII
DEPARTMENT OF TRANSPORTATION
HIGHWAYS DIVISION

LANDSCAPE DETAILS & NOTES

NIMITZ HWY. MEDIAN IMPROVEMENTS

Sand Island Access Road
to Vicinity of Alakawa Street
Project No. 92A-01-11M

Scale: Not to Scale Date: March, 2011

SHEET No. 1 OF 4 SHEETS

FED. ROAD DIST. NO.	STATE	PROJ. NO.	FISCAL YEAR	SHEET NO.	TOTAL SHEETS
HAWAII	HAW.	92A-01-11M	2011	ADD.27	42

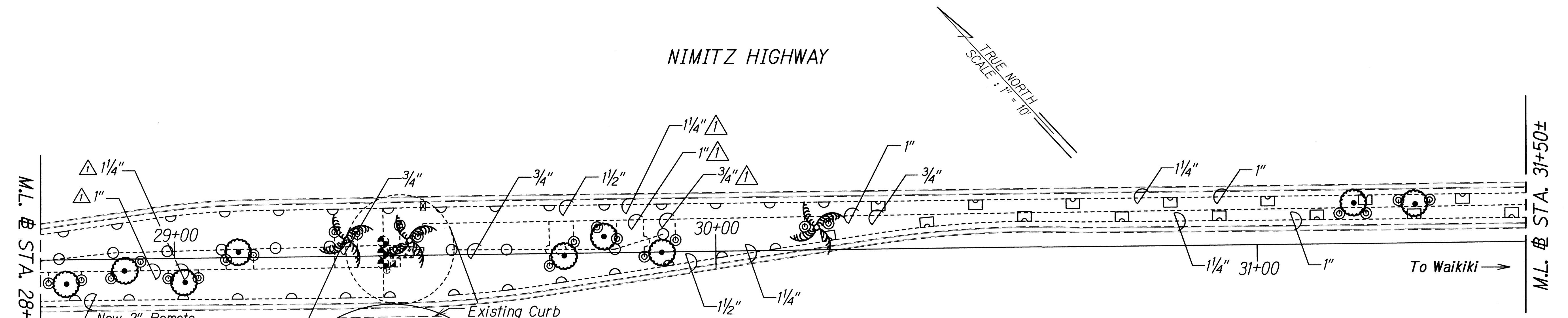
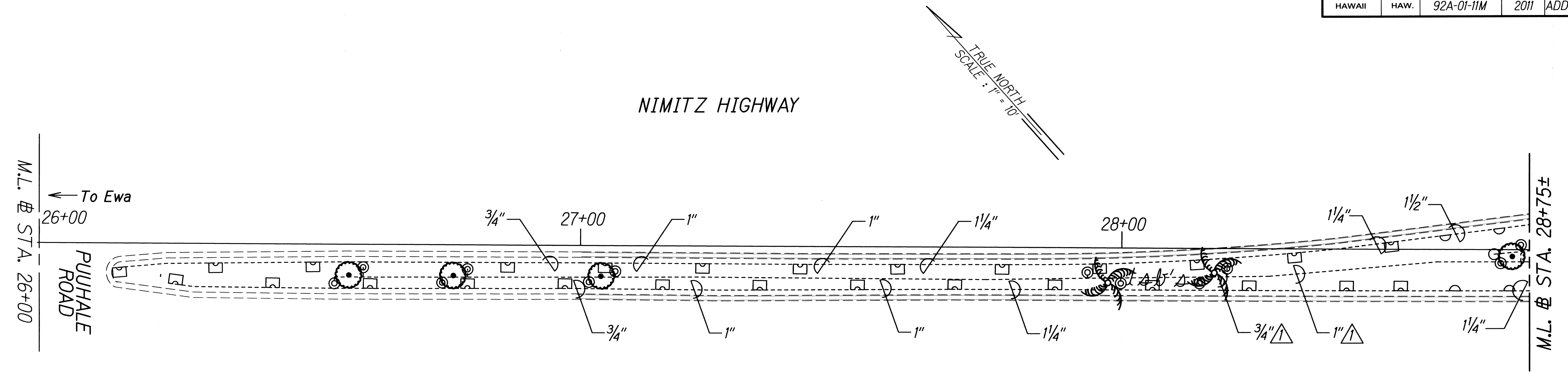

Mauka	2	2"	58
Tree Bubblers	3	1 1/2"	36
Makai & Center	4	2"	59

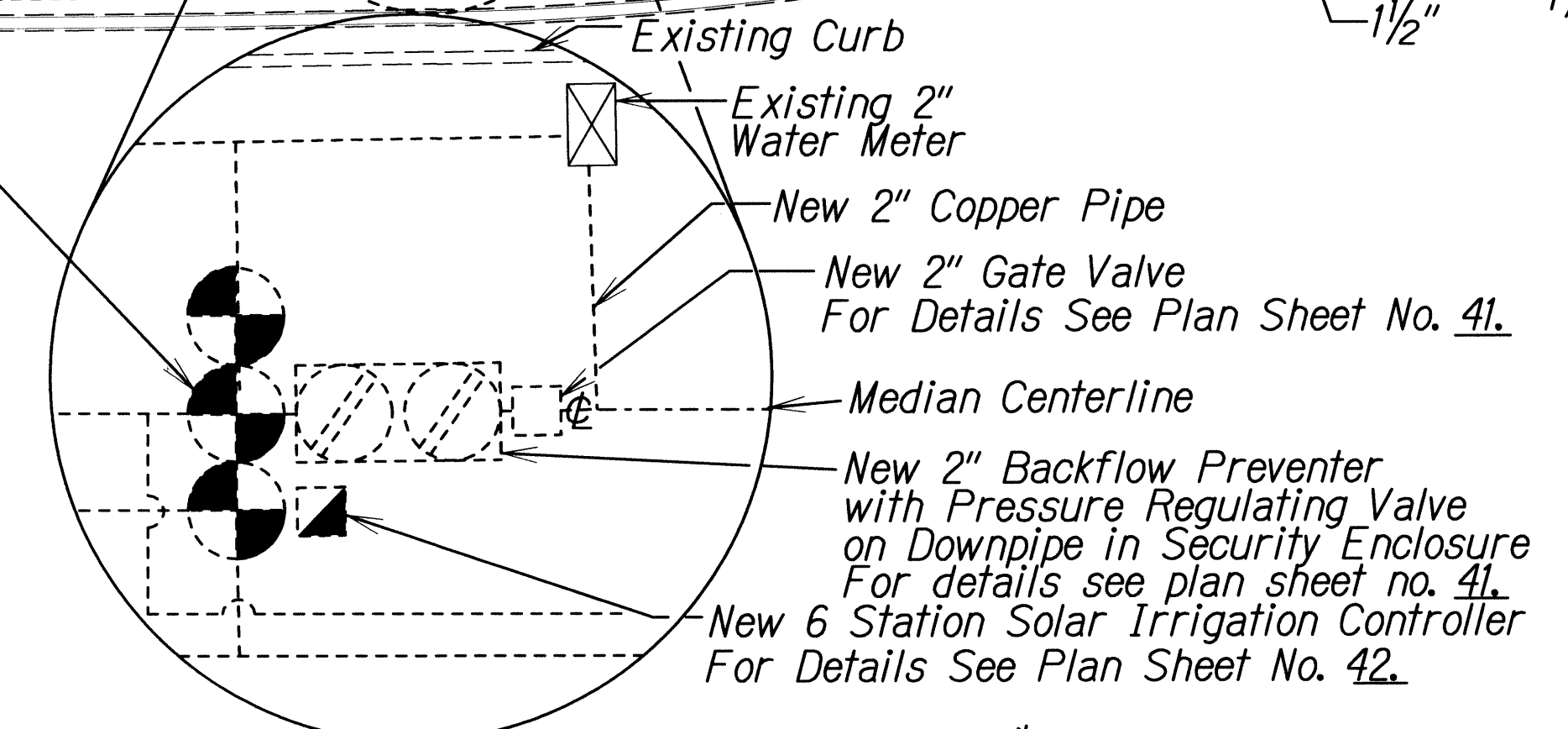

*For Details See Plan Sheet No. 42.

POINT OF CONNECTION - 1

DATE	_____
DESIGNED BY	_____
CHECKED BY	_____
DATE	_____
DESIGNED BY	_____
CHECKED BY	_____

DATE	REVISION
5/10/11	Deleted Coconut Trees, and Adjusted Appropriate Irrigation.

STATE OF HAWAII
DEPARTMENT OF TRANSPORTATION
HIGHWAYS DIVISION

IRRIGATION PLAN
NIMITZ HWY. MEDIAN IMPROVEMENTS
Sand Island Access Road
to Vicinity of Alakawa Street
Project No. 92A-01-11M

Scale: 1"=10' Date: March, 2011

SHEET No. 2 OF 13 SHEETS

KANAKANUI STREET

POINT OF CONNECTION - 2

FED. ROAD DIST. NO.	STATE	PROJ. NO.	FISCAL YEAR	SHEET NO.	TOTAL SHEETS
HAWAII	HAW.	92A-01-11M	2011	ADD.29	42

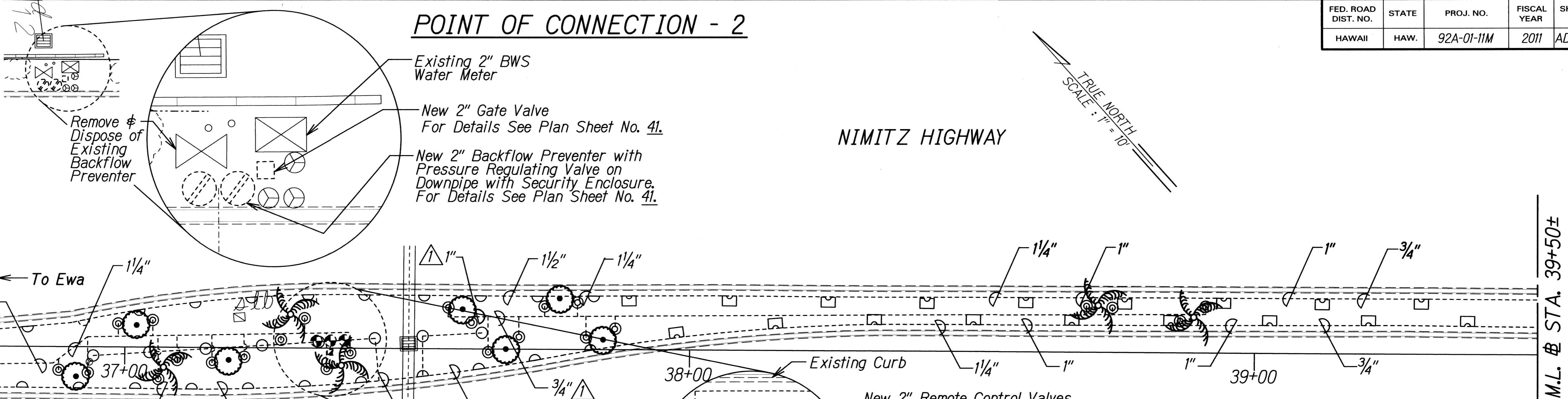

M.L. # STA. 36+75±
 ← To Ewa
 New Remote Control Valves

M.L. # STA. 39+50±

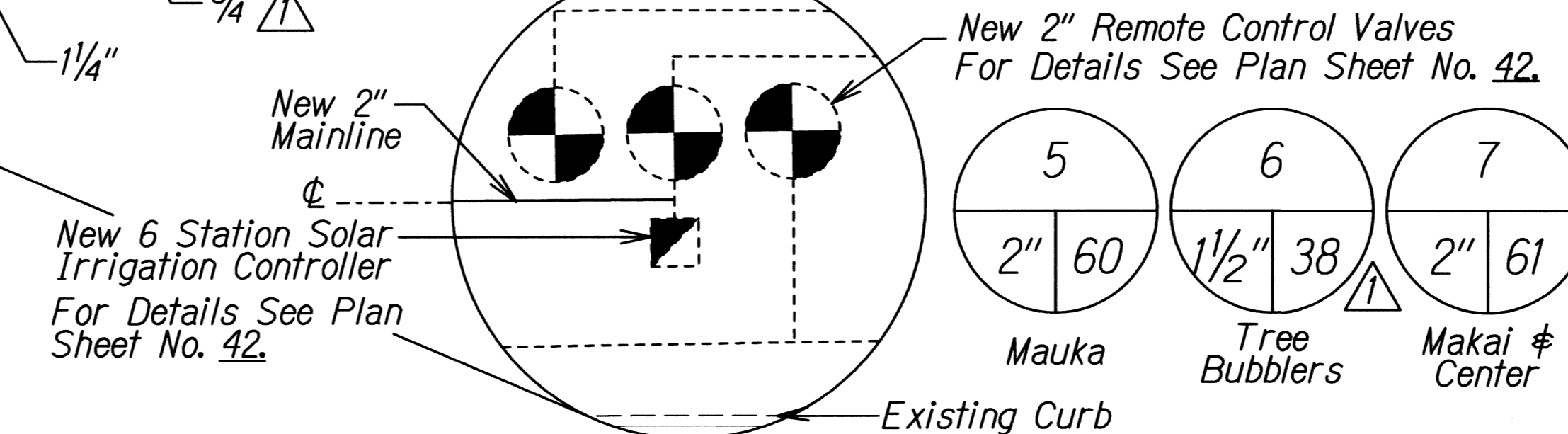

NIMITZ HIGHWAY

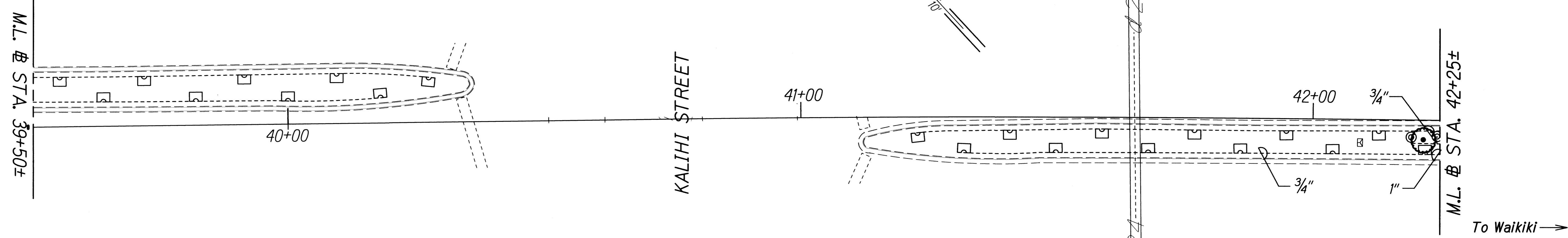

M.L. # STA. 39+50±

M.L. # STA. 42+25±

To Waikiki →

ORIGINAL PLAN	DATE
DESIGNED BY	
TRACED BY	
DESIGNED BY	
QUANTITIES BY	
CHECKED BY	

5/10/11	Deleted Coconut Trees, and Adjusted Appropriate Irrigation. △
DATE	REVISION

STATE OF HAWAII
 DEPARTMENT OF TRANSPORTATION
 HIGHWAYS DIVISION

IRRIGATION PLAN

NIMITZ HWY. MEDIAN IMPROVEMENTS
 Sand Island Access Road
 to Vicinity of Alakawa Street
 Project No. 92A-01-11M

Scale: 1"=10' Date: March, 2011

SHEET No. 4 OF 13 SHEETS

FED. ROAD DIST. NO.	STATE	PROJ. NO.	FISCAL YEAR	SHEET NO.	TOTAL SHEETS
HAWAII	HAW.	92A-01-11M	2011	ADD.31	42

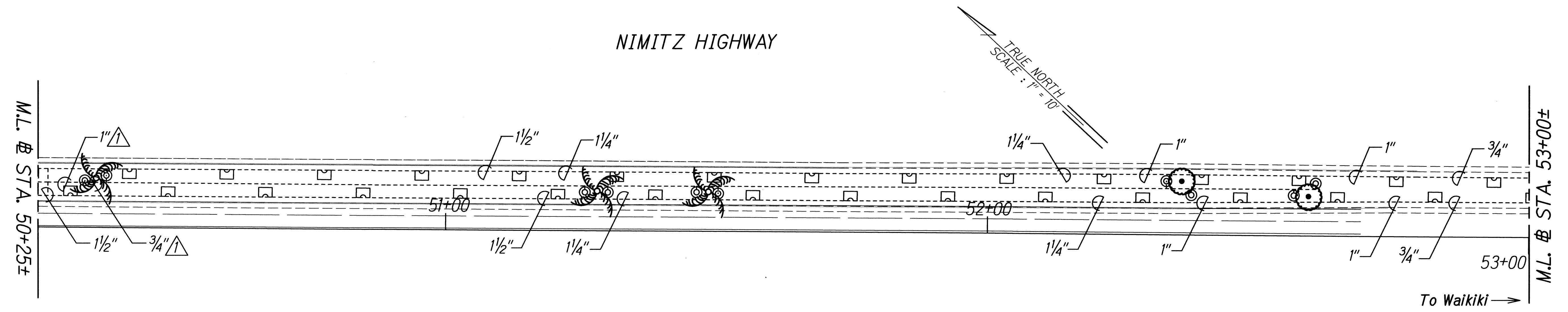
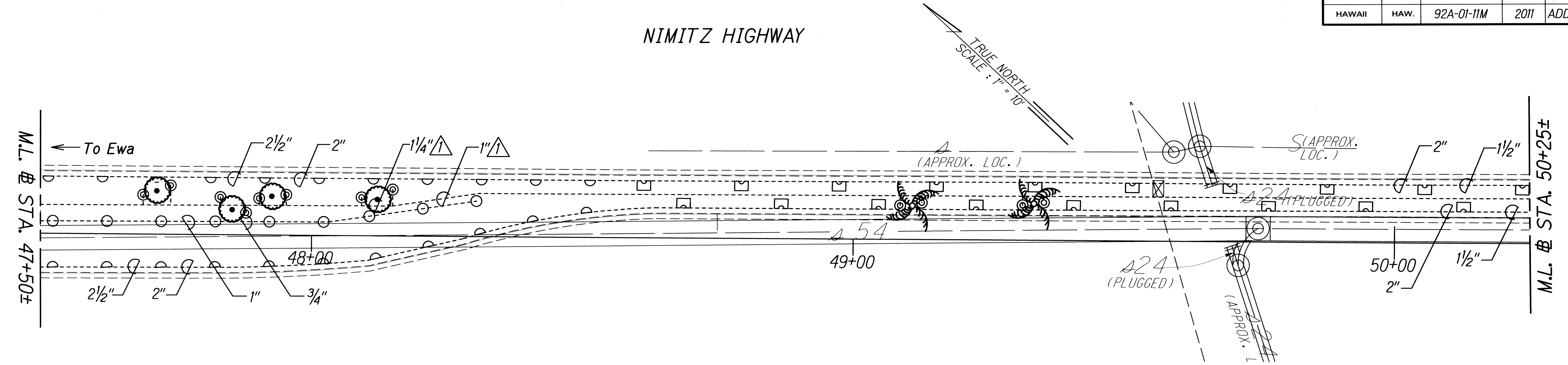

ORIGINAL PLAN	DATE
DESIGNED BY	
TRACED BY	
DESIGNED BY	
QUANTITIES BY	
CHECKED BY	

5/10/11	Deleted Coconut Trees, and Adjusted Appropriate Irrigation. Δ
DATE	REVISION

STATE OF HAWAII
DEPARTMENT OF TRANSPORTATION
HIGHWAYS DIVISION

IRRIGATION PLAN
NIMITZ HWY. MEDIAN IMPROVEMENTS
Sand Island Access Road
to Vicinity of Alakawa Street
Project No. 92A-01-11M

Scale: 1"=10' Date: March, 2011

SHEET No. 6 OF 13 SHEETS

FED. ROAD DIST. NO.	STATE	PROJ. NO.	FISCAL YEAR	SHEET NO.	TOTAL SHEETS
HAWAII	HAW.	92A-01-11M	2011	ADD.32	42

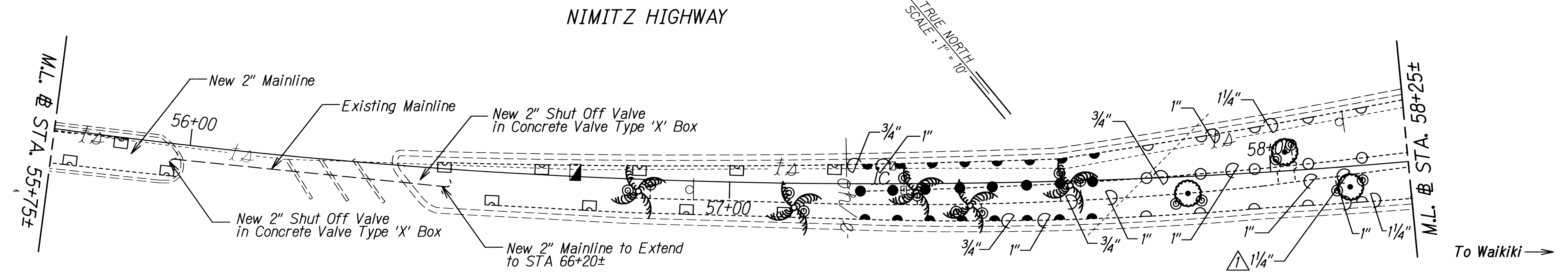
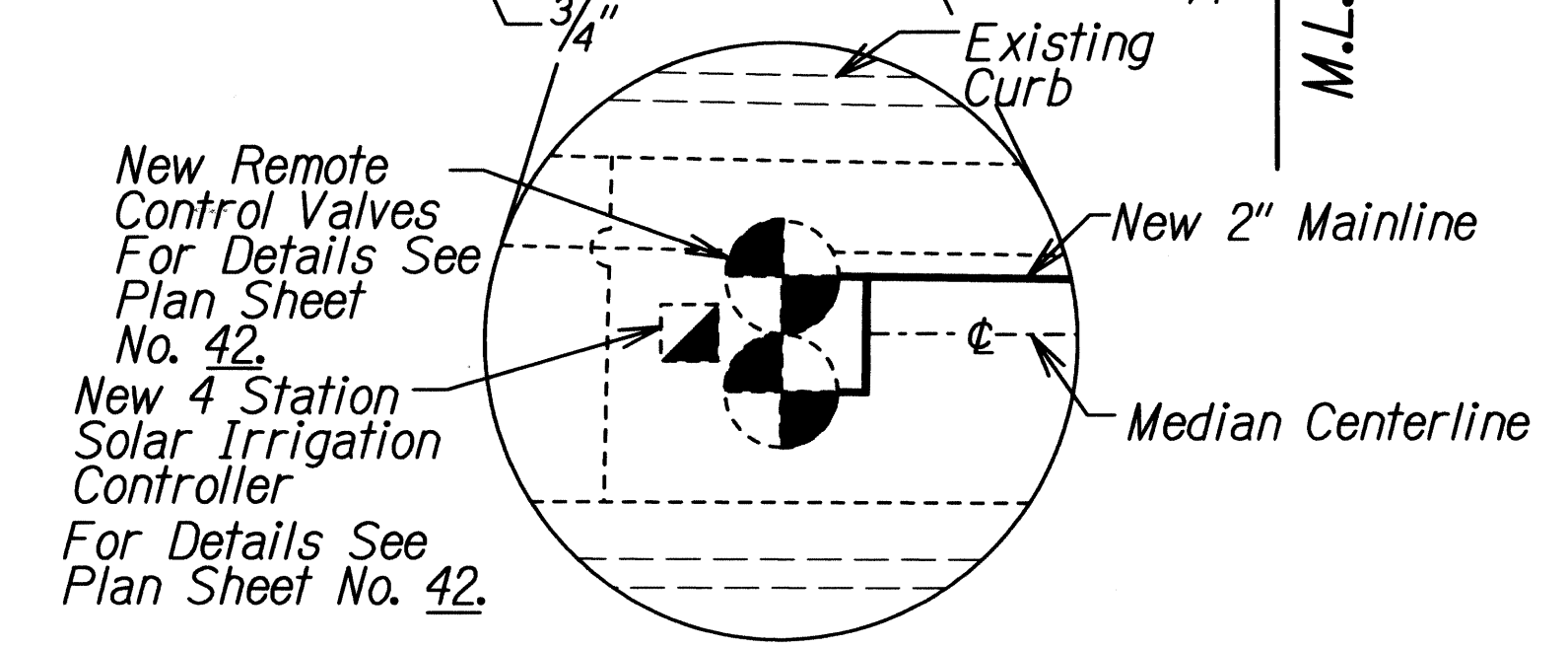
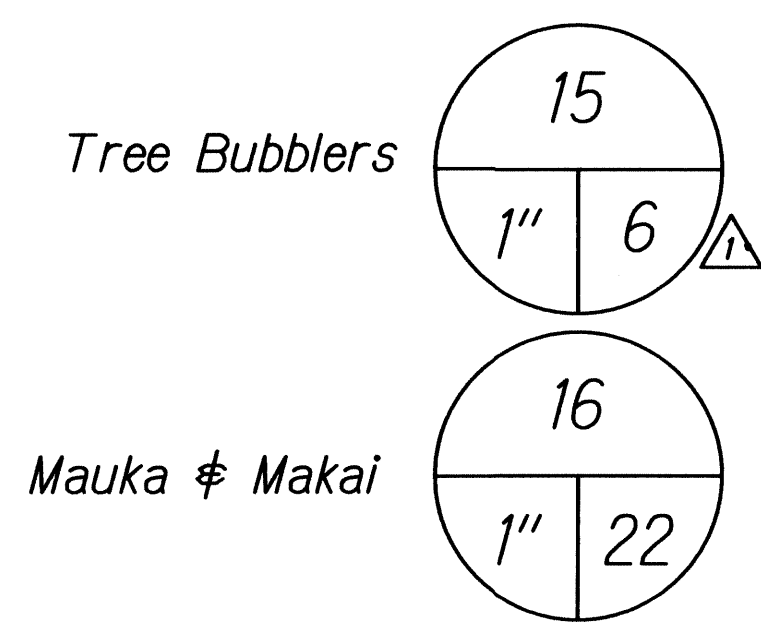
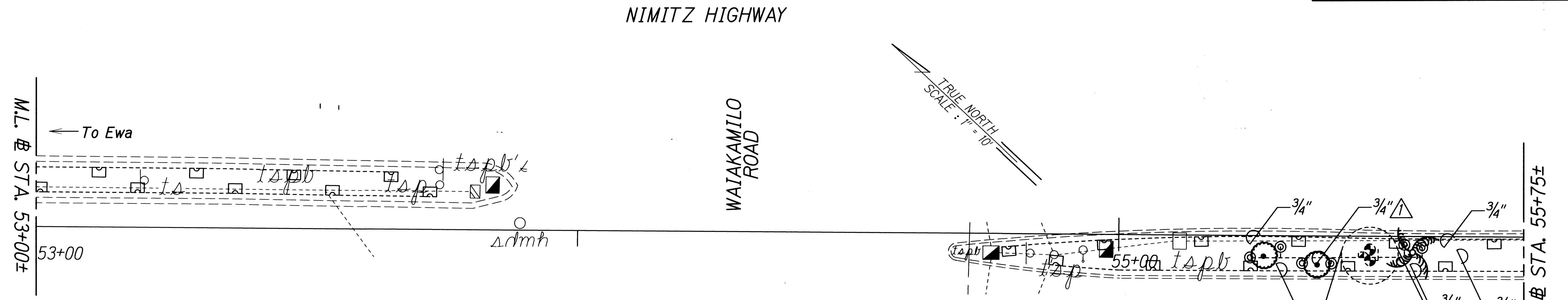

ORIGINAL PLAN	DATE
DESIGNED BY	
TRACED BY	
QUANTITIES BY	
CHECKED BY	

5/10/11	Deleted Coconut Trees, and Adjusted Appropriate Irrigation. Δ
DATE	REVISION

STATE OF HAWAII
DEPARTMENT OF TRANSPORTATION
HIGHWAYS DIVISION

IRRIGATION PLAN
NIMITZ HWY. MEDIAN IMPROVEMENTS
Sand Island Access Road
to Vicinity of Alakawa Street
Project No. 92A-01-11M

Scale: 1"=10' Date: March, 2011

SHEET No. 7 OF 13 SHEETS

FED. ROAD DIST. NO.	STATE	PROJ. NO.	FISCAL YEAR	SHEET NO.	TOTAL SHEETS
HAWAII	HAW.	92A-01-11M	2011	ADD.33	42

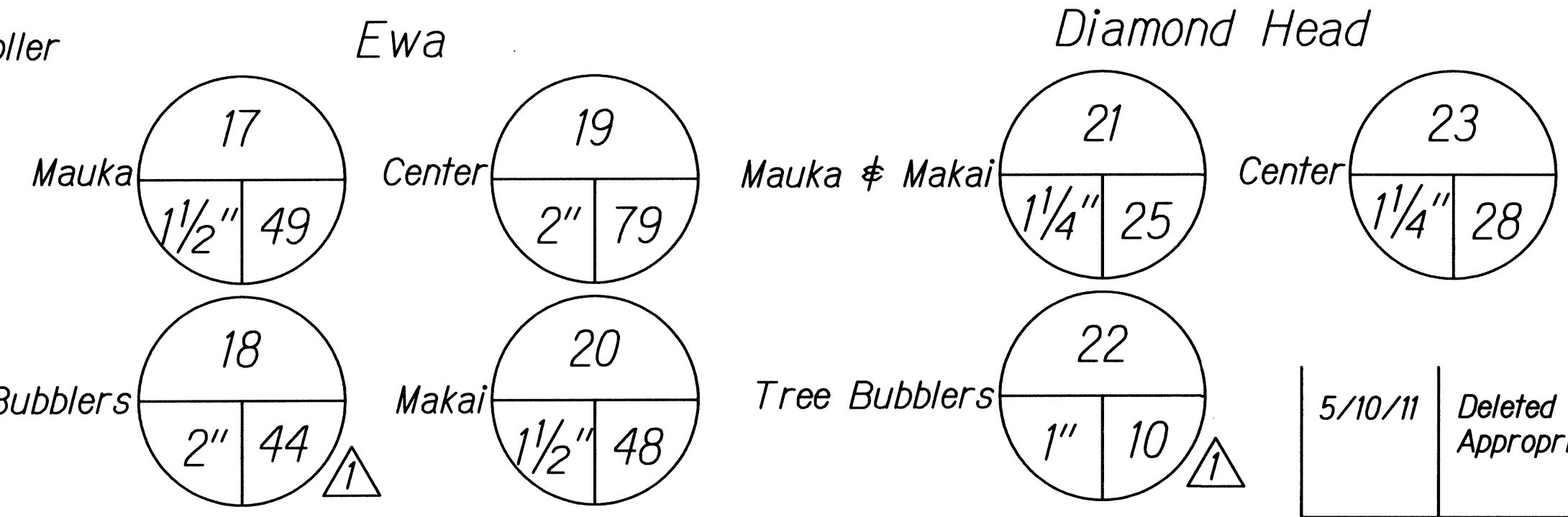
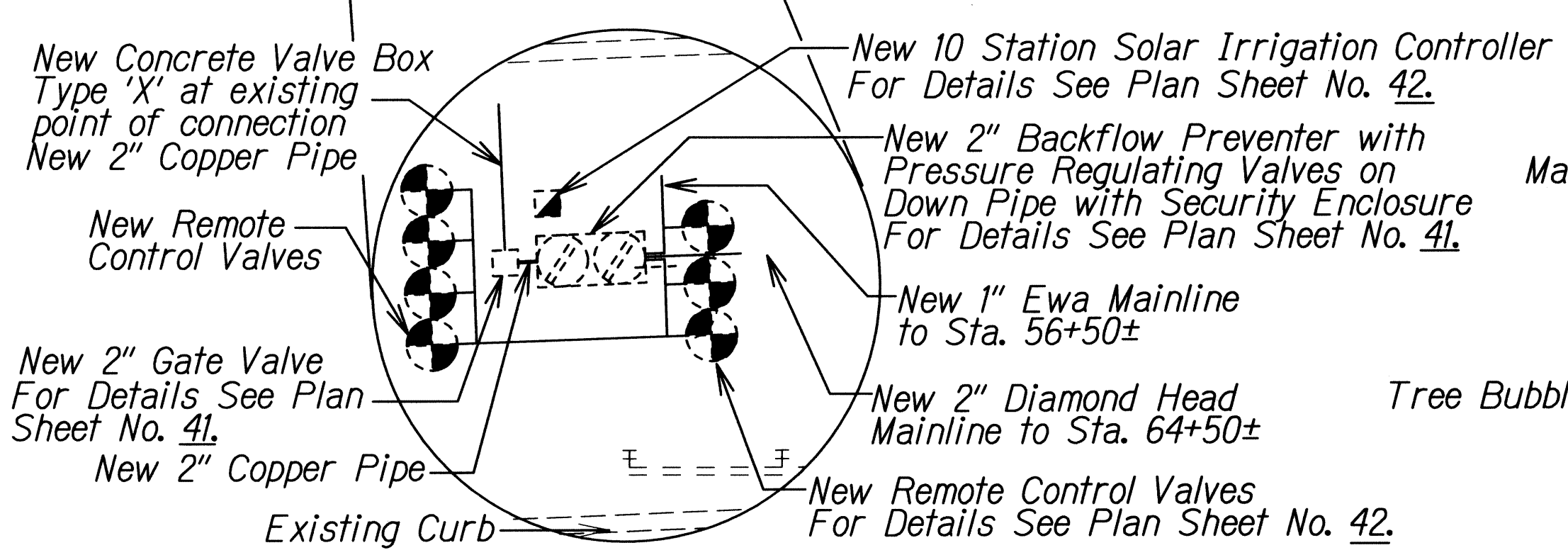
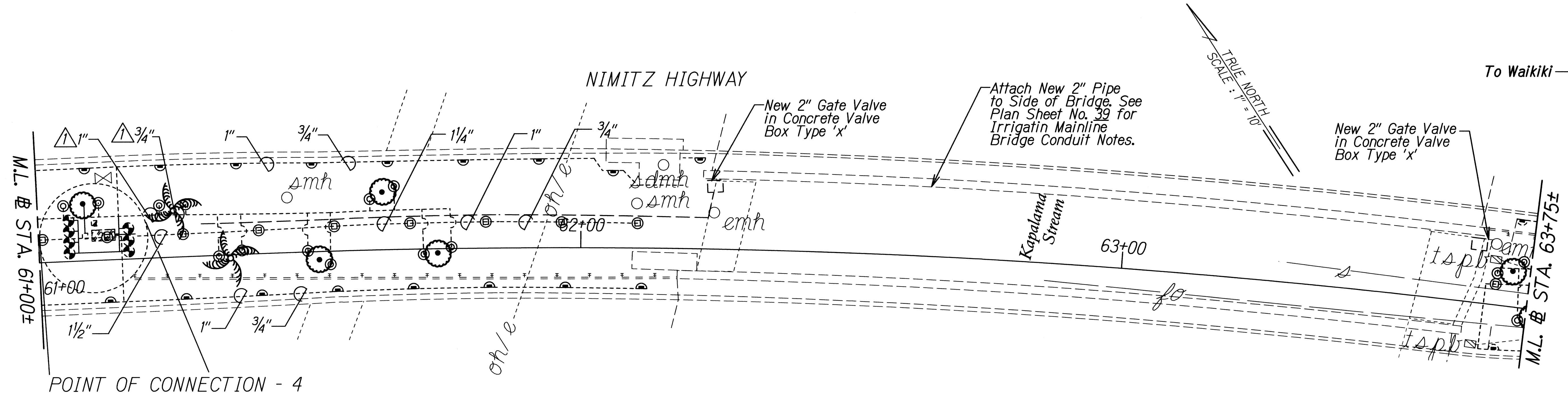
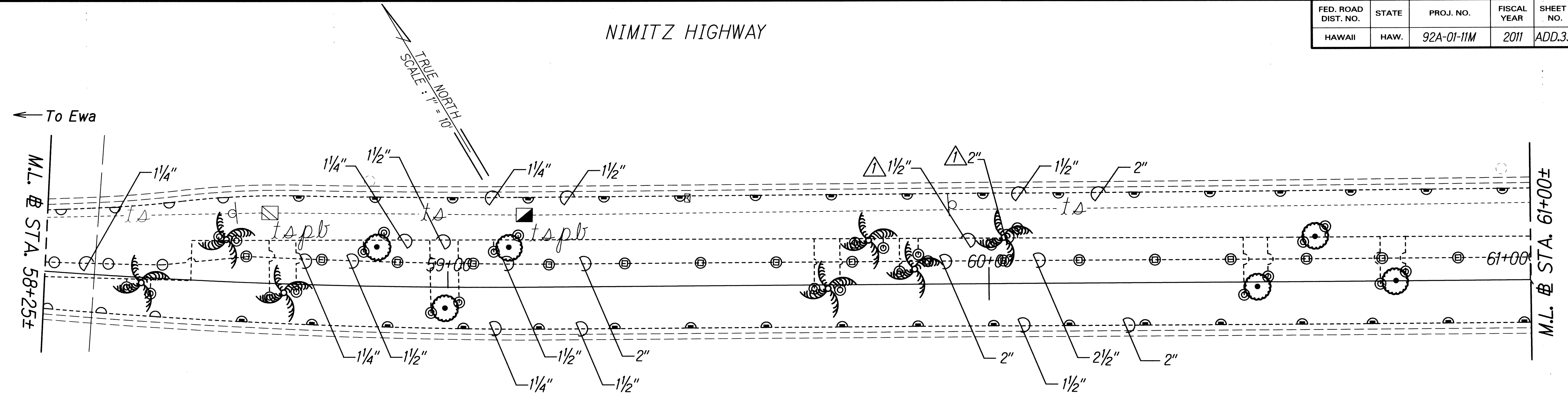

DATE	REVISION
5/10/11	Deleted Coconut Trees, and Adjusted Appropriate Irrigation.

ORIGINAL PLAN	DATE
DESIGNED BY	
TRACED BY	
NOTED BY	
QUANTITIES BY	
CHECKED BY	

STATE OF HAWAII
DEPARTMENT OF TRANSPORTATION
HIGHWAYS DIVISION

IRRIGATION PLAN
NIMITZ HWY. MEDIAN IMPROVEMENTS
Sand Island Access Road
to Vicinity of Alakawa Street
Project No. 92A-01-11M

Scale: 1"=10' Date: March, 2011

SHEET No. 8 OF 13 SHEETS

FED. ROAD DIST. NO.	STATE	PROJ. NO.	FISCAL YEAR	SHEET NO.	TOTAL SHEETS
HAWAII	HAW.	92A-01-11M	2011	ADD.34	42

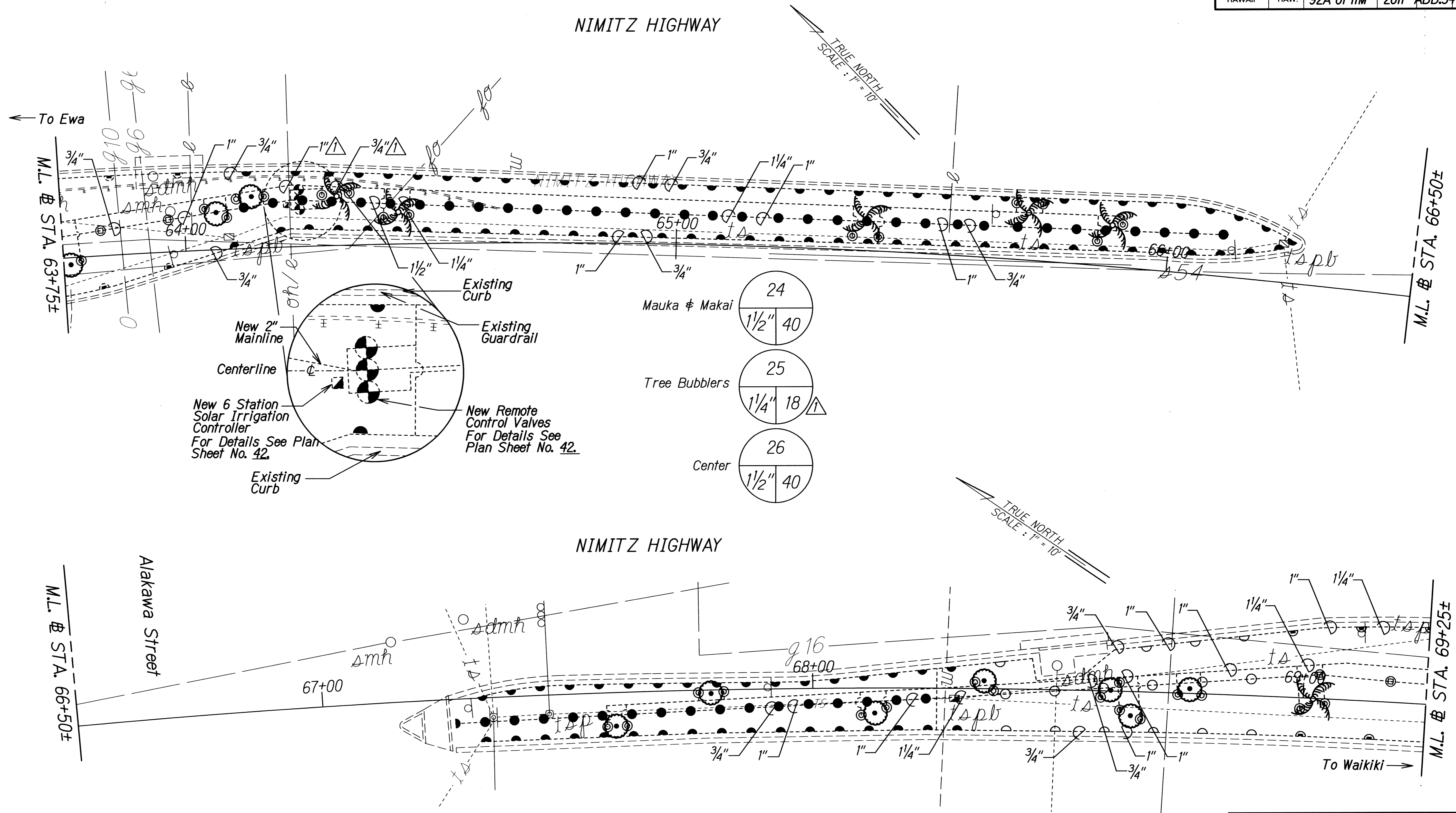

ORIGINAL PLAN	DATE
DESIGNED BY	
QUANTITIES BY	
CHECKED BY	

5/10/11	Deleted Coconut Trees, and Adjusted Appropriate Irrigation. Δ
DATE	REVISION

STATE OF HAWAII
DEPARTMENT OF TRANSPORTATION
HIGHWAYS DIVISION

IRRIGATION PLAN
NIMITZ HWY. MEDIAN IMPROVEMENTS
Sand Island Access Road
to Vicinity of Alakawa Street
Project No. 92A-01-11M

Scale: 1"=10' Date: March, 2011

SHEET No. 9 OF 13 SHEETS

FED. ROAD DIST. NO.	STATE	PROJ. NO.	FISCAL YEAR	SHEET NO.	TOTAL SHEETS
HAWAII	HAW.	92A-01-11M	2011	ADD.35	42

NIMITZ HIGHWAY

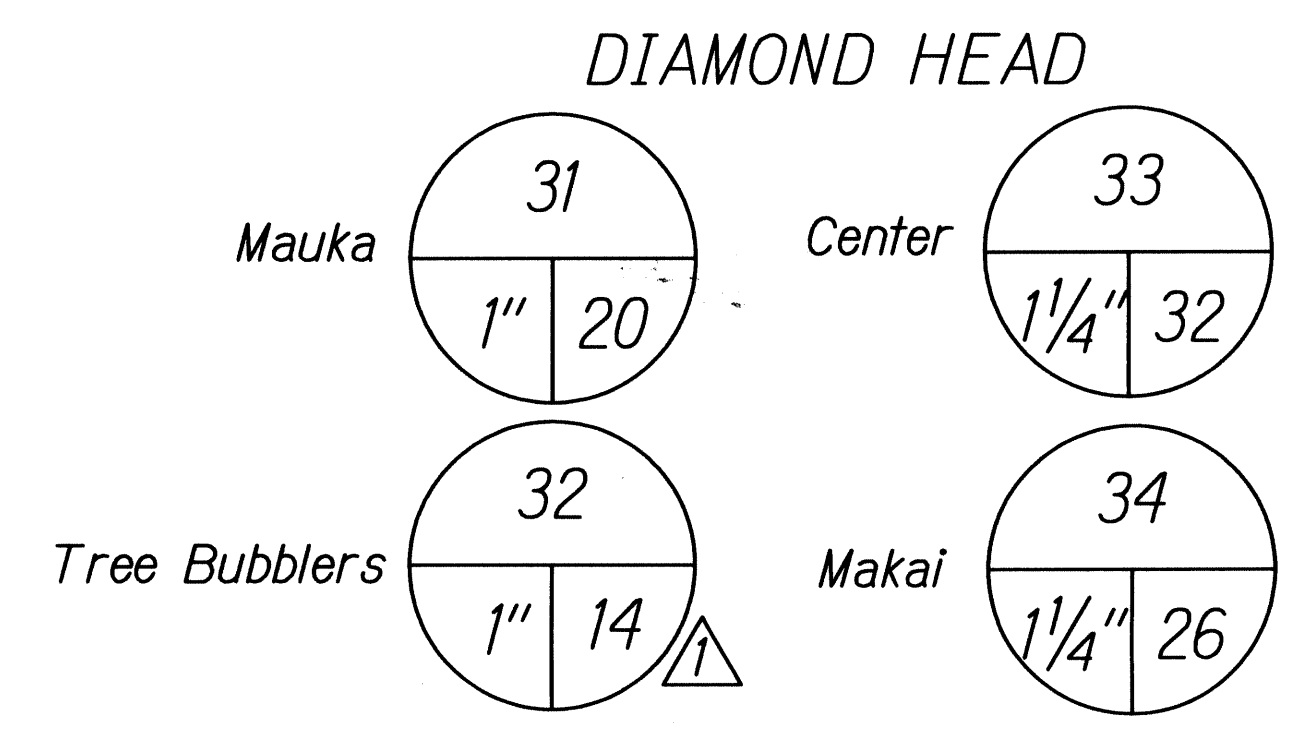
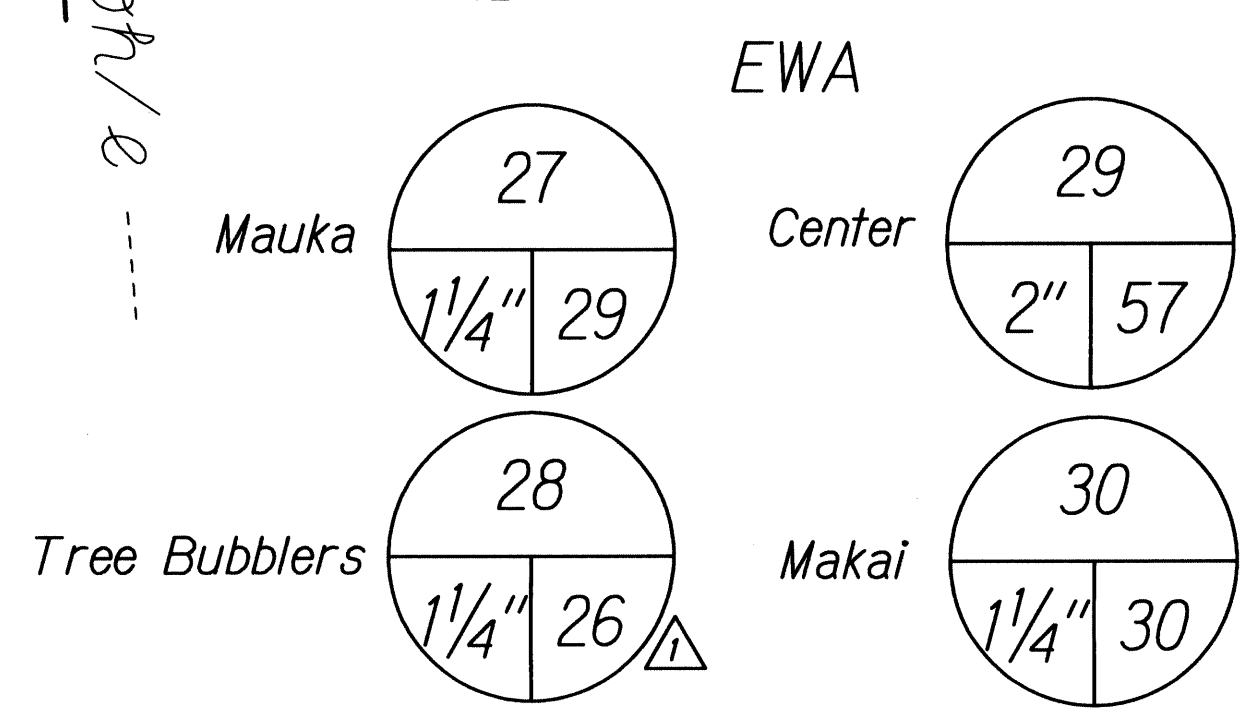
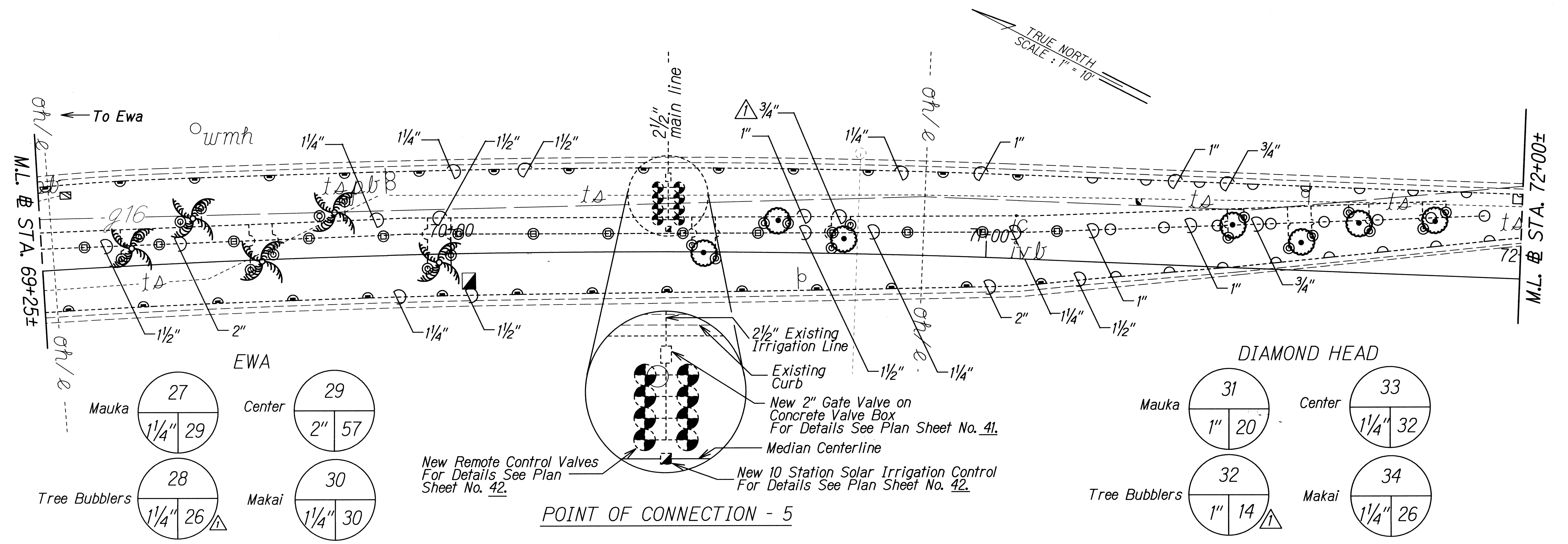

NIMITZ HIGHWAY

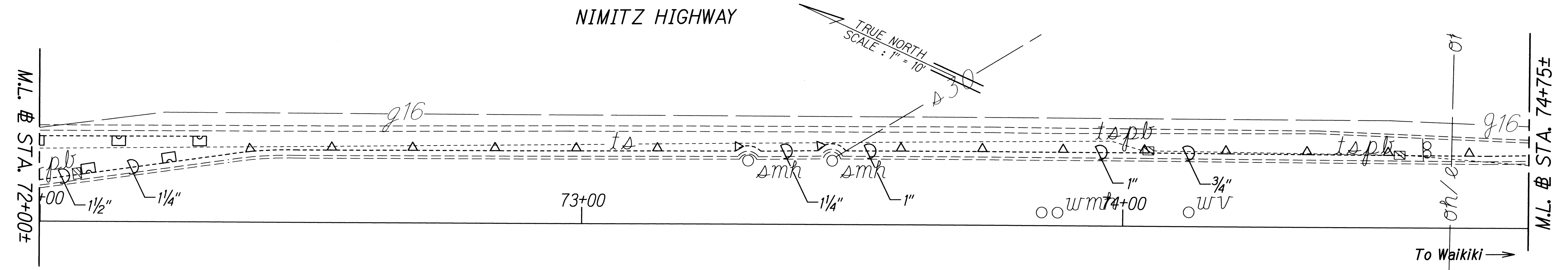

ORIGINAL PLAN	DATE
DESIGNED BY	
QUANTITIES BY	
CHECKED BY	

5/10/11	Deleted Coconut Trees, and Adjusted Appropriate Irrigation. Δ
DATE	REVISION

STATE OF HAWAII
DEPARTMENT OF TRANSPORTATION
HIGHWAYS DIVISION

IRRIGATION PLAN
NIMITZ HWY. MEDIAN IMPROVEMENTS
Sand Island Access Road
to Vicinity of Alakawa Street
Project No. 92A-01-11M

Scale: 1"=10' Date: March, 2011

SHEET No. 10 OF 13 SHEETS

FED. ROAD DIST. NO.	STATE	PROJ. NO.	FISCAL YEAR	SHEET NO.	TOTAL SHEETS
HAWAII	HAW.	92A-01-11M	2011	ADD.36	42

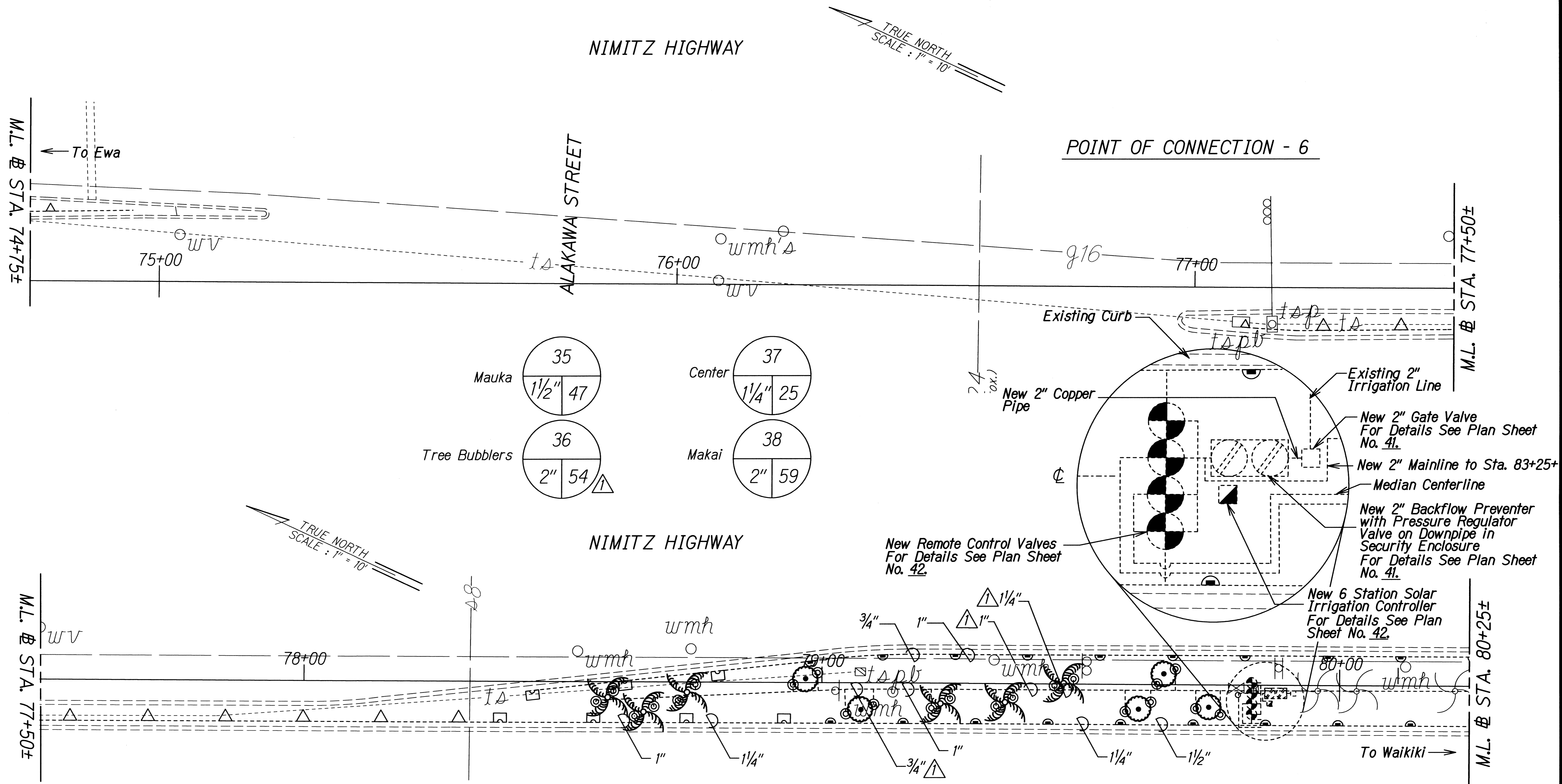

ORIGINAL PLAN	SURVEY PLOTTED BY	DATE
NOTE BOOK	TRACED BY	
5/10/11	DESIGNED BY	
	QUANTITIES BY	
	CHECKED BY	

5/10/11	Deleted Coconut Trees, and Adjusted Appropriate Irrigation. Δ
DATE	REVISION

STATE OF HAWAII
DEPARTMENT OF TRANSPORTATION
HIGHWAYS DIVISION

IRRIGATION PLAN
NIMITZ HWY. MEDIAN IMPROVEMENTS
Sand Island Access Road
to Vicinity of Alakawa Street
Project No. 92A-01-11M

Scale: 1"=10' Date: March, 2011

SHEET No. 11 OF 13 SHEETS

FED. ROAD DIST. NO.	STATE	PROJ. NO.	FISCAL YEAR	SHEET NO.	TOTAL SHEETS
HAWAII	HAW.	92A-01-11M	2011	ADD.37	42

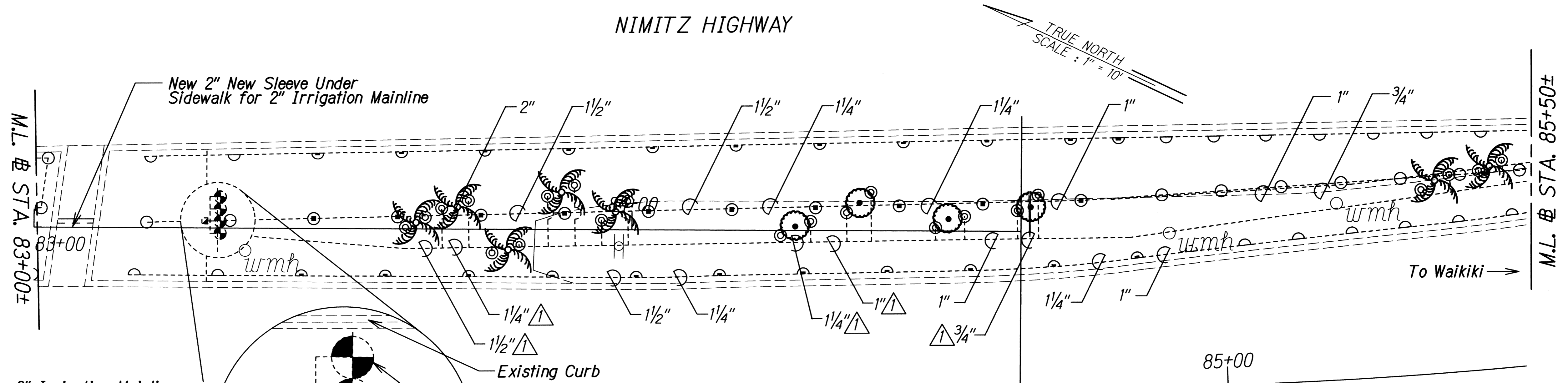
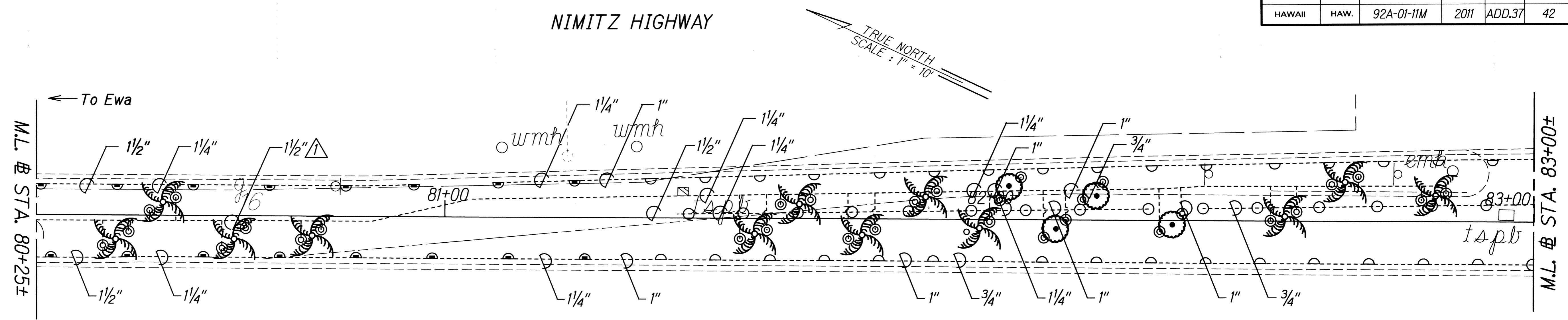

New 2" Irrigation Mainline From Sta. 83+90±

New 6 Station Solar Irrigation Controller For Details See Plan Sheet No. 42.

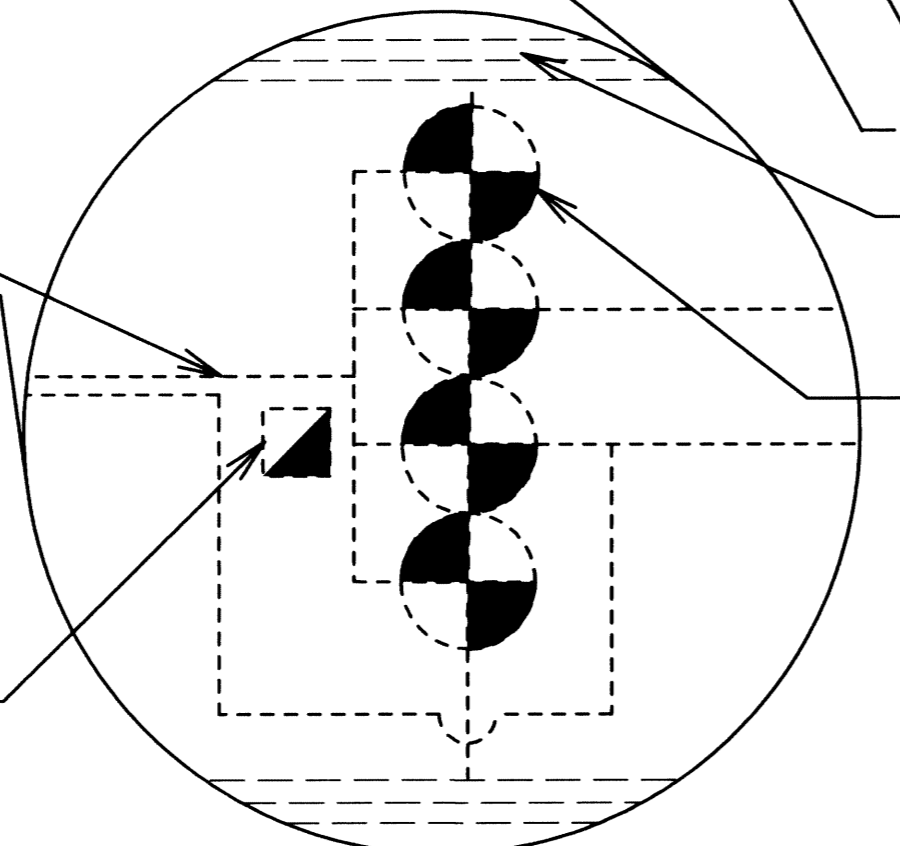

New Remote Control Valve For Details See Plan Sheet No. 42.

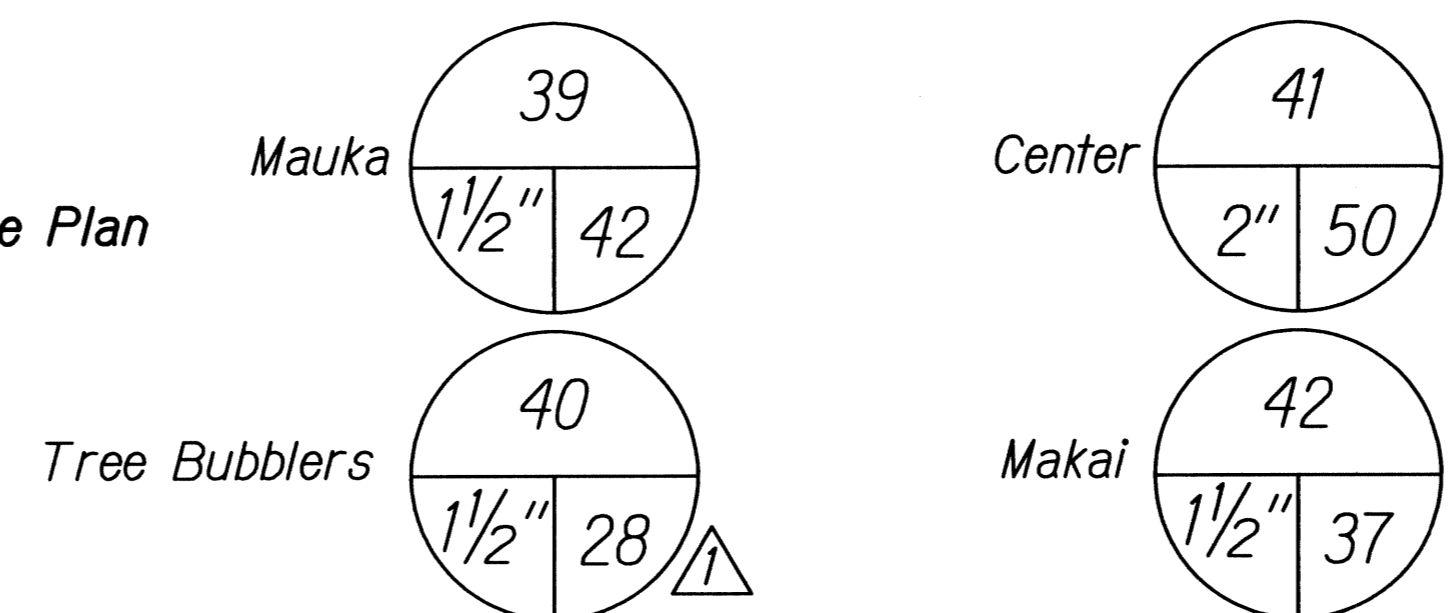

5/10/11	Deleted Coconut Trees, and Adjusted Appropriate Irrigation. Δ
DATE	REVISION

STATE OF HAWAII
DEPARTMENT OF TRANSPORTATION
HIGHWAYS DIVISION

IRRIGATION PLAN
NIMITZ HWY. MEDIAN IMPROVEMENTS
Sand Island Access Road
to Vicinity of Alakawa Street
Project No. 92A-01-11M

Scale: 1"=10' Date: March, 2011

SHEET No. 12 OF 13 SHEETS

SURVEY PLOTTED BY	DATE
DESIGNED BY	
TRACED BY	
NOTE BOOK	
QUANTITIES BY	
CHECKED BY	
ORIGINAL PLAN	
No. 290	