

NOTES FOR TRAFFIC CONTROL PLAN

1. The Permittee shall make minor adjustments at intersections, driveways, bridges, structures, etc. to fit field conditions.
2. Cones or delineators shall be extended to a point where they are visible to the approaching traffic.
3. Traffic control devices shall be installed such that the sign or device farthest from the work area shall be placed first. The others shall then be placed progressively toward the work area.
4. Regulatory and warning signs within the construction zone that are in conflict with the Traffic Control Plans shall be removed or covered. All signs shall be restored upon completion of the work.
5. Flaggers and/or Police Officers shall be in sight of each other or in direct communication at all times.
6. When required by the issuing office, the Permittee shall install a flashing arrow signal as shown on the traffic control plans.
7. All traffic lanes shall be a minimum of 10 feet wide.
8. All construction warning signs shall be promptly removed or covered whenever the message is not applicable or not in use.
9. The backs of all signs used for traffic control shall be appropriately covered to preclude the display of inapplicable sign messages (i.e., when the signs have messages on both faces).
10. At the end of each day's work, or as soon as the work is completed, the Permittee shall remove all traffic control devices no longer needed to permit free and safe passage of the public traffic. Removal shall be in the reverse order of installation. Replace existing faded or obliterated pavement markings that are necessary for safe traffic flow in the construction area with temporary or permanent markings before opening the roadway to public traffic each day.
11. Replace permanent pavement markings and traffic signs upon completion of each phase of work.

FED. ROAD DIST. NO.	STATE	PROJ. NO.	FISCAL YEAR	SHEET NO.	TOTAL SHEETS
HAWAII	HAW.	92A-01-10M	2010	22	44

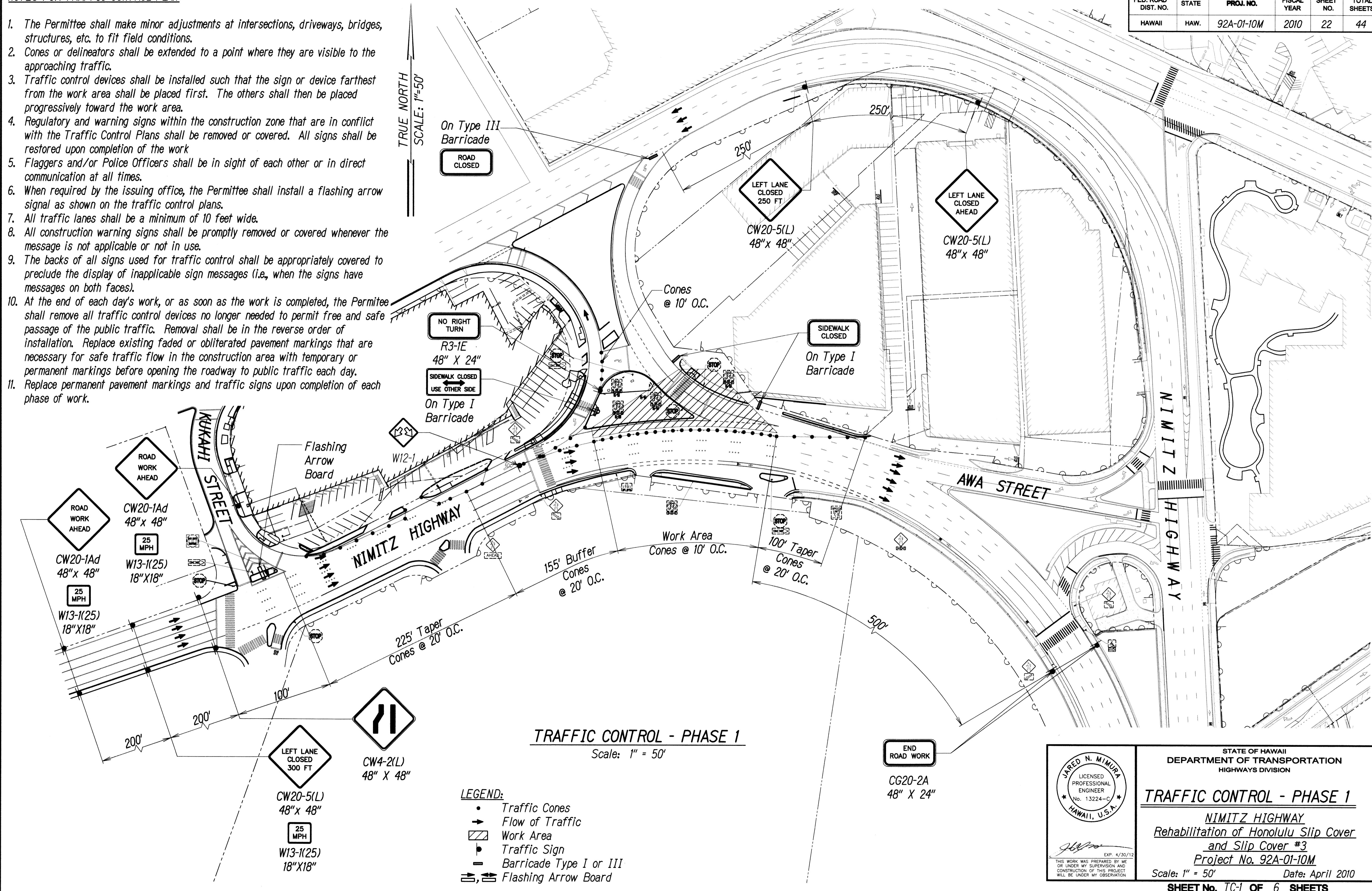

TRAFFIC CONTROL - PHASE 1
Scale: 1" = 50'

- LEGEND:**
- Traffic Cones
 - Flow of Traffic
 - ▨ Work Area
 - ▲ Traffic Sign
 - Barricade Type I or III
 - ⚡ Flashing Arrow Board

SURVEY PLOTTED BY	DATE
DESIGNED BY	
TRACED BY	
NOTED BY	
QUANTITIES BY	
CHECKED BY	
ORIGINAL PLAN	
NO.	

JARED N. MIMURA
LICENSED PROFESSIONAL ENGINEER
No. 13224-C
HAWAII, U.S.A.
EXP. 4/30/12

THIS WORK WAS PREPARED BY ME OR UNDER MY SUPERVISION AND CONSTRUCTION OF THIS PROJECT WILL BE UNDER MY OBSERVATION.

STATE OF HAWAII
DEPARTMENT OF TRANSPORTATION
HIGHWAYS DIVISION

TRAFFIC CONTROL - PHASE 1

NIMITZ HIGHWAY
Rehabilitation of Honolulu Slip Cover and Slip Cover #3
Project No. 92A-01-10M

Scale: 1" = 50' Date: April 2010

SHEET No. TC-1 OF 6 SHEETS

FED. ROAD DIST. NO.	STATE	PROJ. NO.	FISCAL YEAR	SHEET NO.	TOTAL SHEETS
HAWAII	HAW.	92A-01-10M	2010	23	44

TRUE NORTH
SCALE: 1"=50'

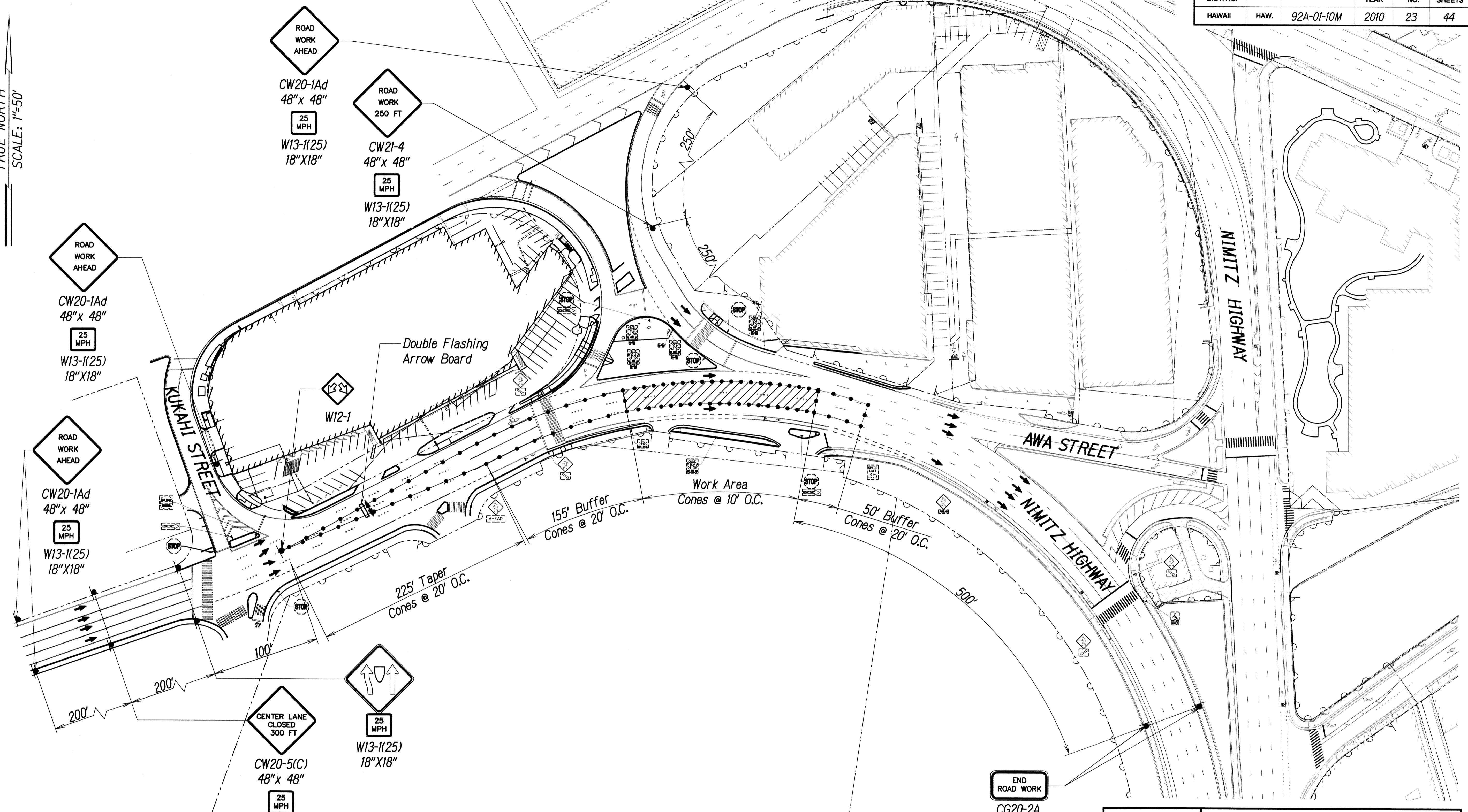

- LEGEND:**
- Traffic Cones
 - Flow of Traffic
 - ▨ Work Area
 - ▭ Traffic Sign
 - ▭ Barricade Type I or III
 - ▭ Flashing Arrow Board

TRAFFIC CONTROL - PHASE 2
Scale: 1" = 50'

DATE	_____
DESIGNED BY	_____
DRAWN BY	_____
CHECKED BY	_____
NOTED BY	_____
QUANTITIES BY	_____
NO.	_____

JARED N. MIMURA
LICENSED PROFESSIONAL ENGINEER
No. 13224-C
HAWAII, U.S.A.

EXP. 4/30/12
THIS WORK WAS PREPARED BY ME OR UNDER MY SUPERVISION AND CONSTRUCTION OF THIS PROJECT WILL BE UNDER MY OBSERVATION.

STATE OF HAWAII
DEPARTMENT OF TRANSPORTATION
HIGHWAYS DIVISION

TRAFFIC CONTROL - PHASE 2

*NIMITZ HIGHWAY
Rehabilitation of Honolulu Slip Cover
and Slip Cover #3
Project No. 92A-01-10M*

Scale: 1" = 50' Date: April 2010

SHEET No. TC-2 OF 6 SHEETS

FED. ROAD DIST. NO.	STATE	PROJ. NO.	FISCAL YEAR	SHEET NO.	TOTAL SHEETS
HAWAII	HAW.	92A-01-10M	2010	24	44

TRUE NORTH
SCALE: 1"=50'

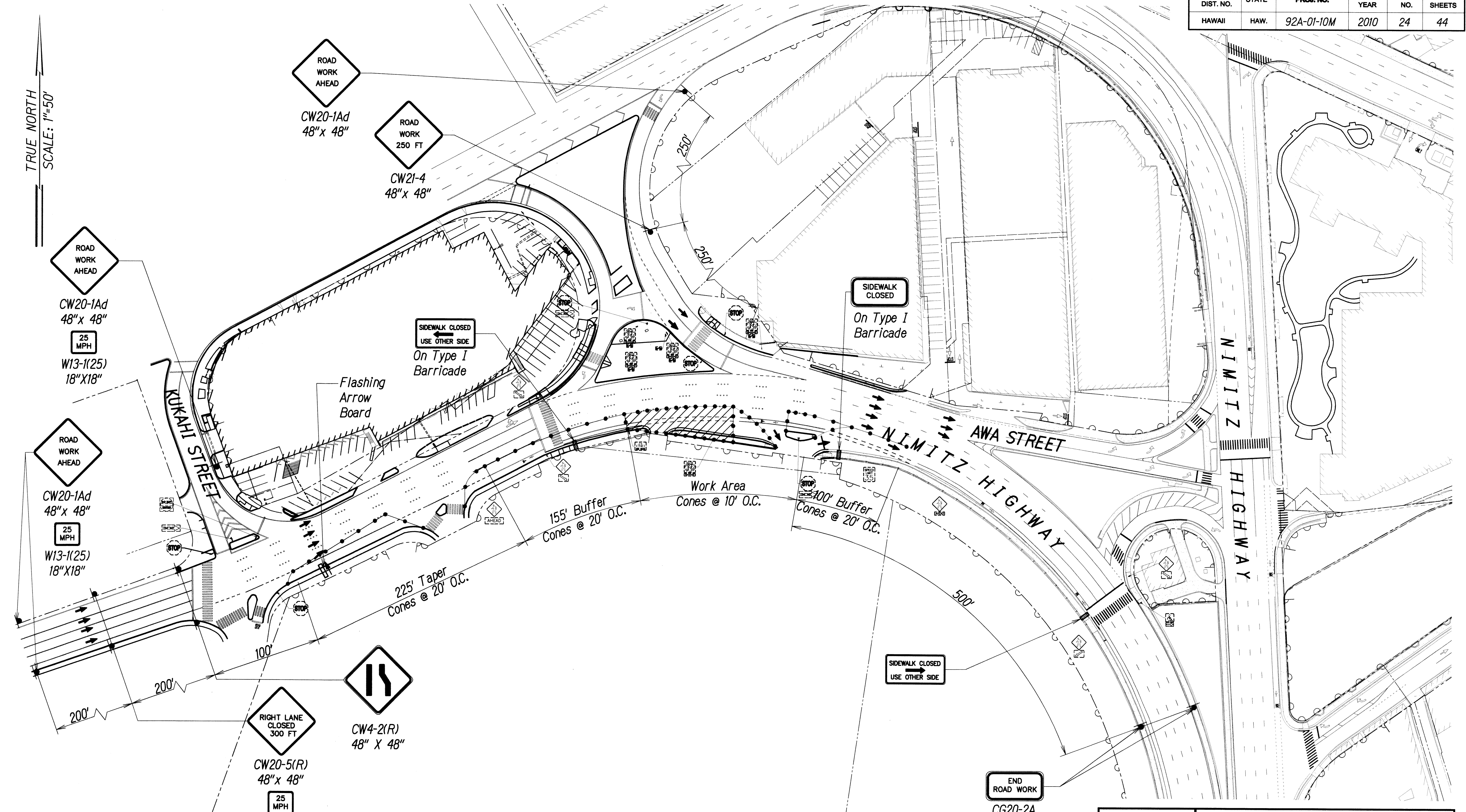

- LEGEND:**
- Traffic Cones
 - Flow of Traffic
 - ▨ Work Area
 - ⊙ Traffic Sign
 - ▬ Barricade Type I or III
 - ⚡ Flashing Arrow Board

NOTE:
Contractor shall keep harbor accessible to vehicle traffic at all times.

TRAFFIC CONTROL - PHASE 3A
Scale: 1" = 50'

SURVEY PLOTTED BY	DATE
DESIGNED BY	
QUANTITIES BY	
CHECKED BY	
ORIGINAL PLAN	
NOTEBOOK	
No.	

JARED N. MIMURA
LICENSED PROFESSIONAL ENGINEER
No. 13224-C
HAWAII, U.S.A.
EXP. 4/30/12
THIS WORK WAS PREPARED BY ME OR UNDER MY SUPERVISION AND CONSTRUCTION OF THIS PROJECT WILL BE UNDER MY OBSERVATION.

STATE OF HAWAII
DEPARTMENT OF TRANSPORTATION
HIGHWAYS DIVISION

TRAFFIC CONTROL - PHASE 3A

*NIMITZ HIGHWAY
Rehabilitation of Honolulu Slip Cover
and Slip Cover #3
Project No. 92A-01-10M*

Scale: 1" = 50' Date: April 2010

SHEET No. TC-3A OF 6 SHEETS

FED. ROAD DIST. NO.	STATE	PROJ. NO.	FISCAL YEAR	SHEET NO.	TOTAL SHEETS
HAWAII	HAW.	92A-01-10M	2010	25	44

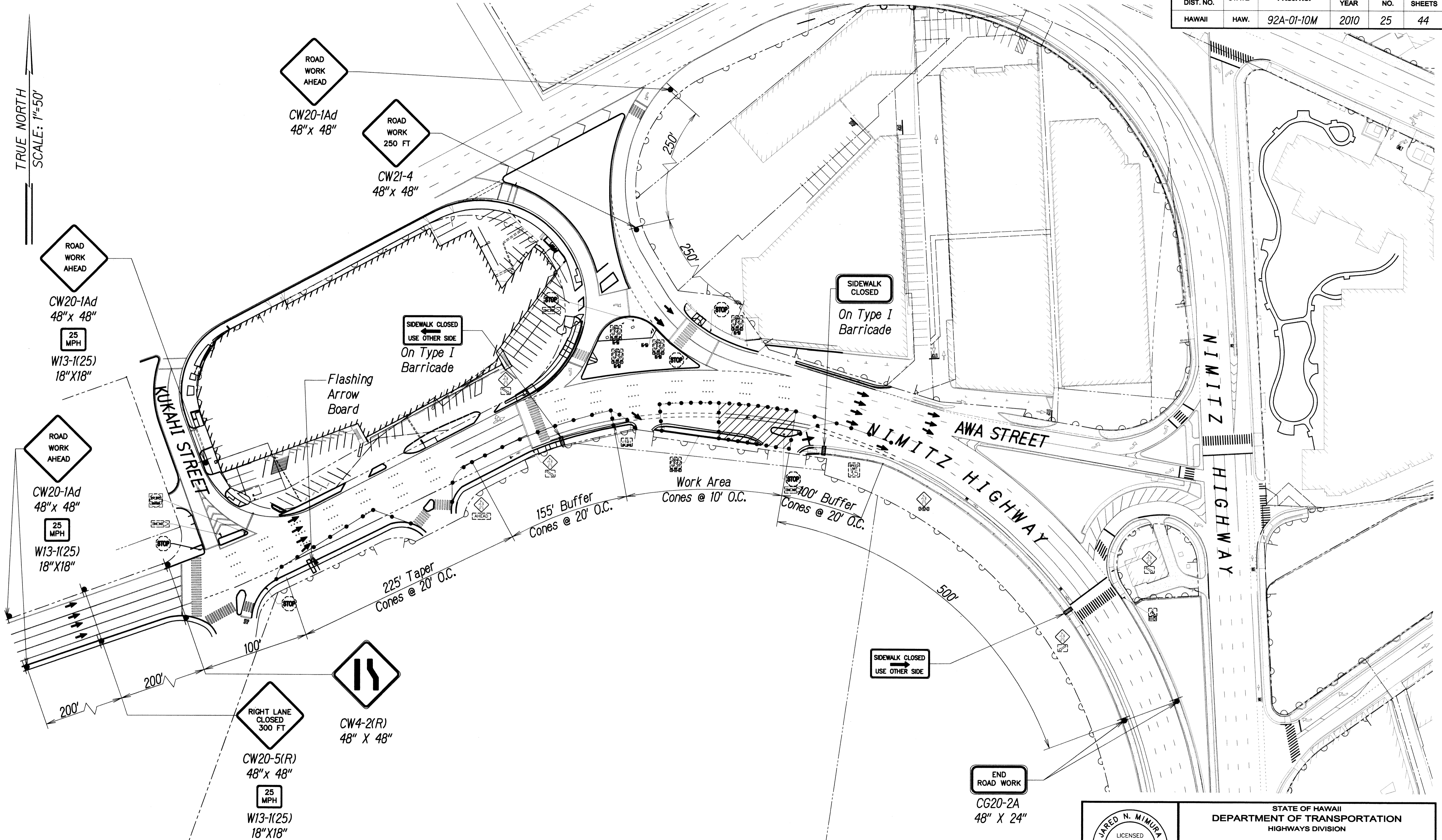

- LEGEND:**
- Traffic Cones
 - Flow of Traffic
 - ▨ Work Area
 - Traffic Sign
 - ▬ Barricade Type I or III
 - ⚡ Flashing Arrow Board

NOTE:
Contractor shall keep harbor accessible to vehicle traffic at all times.

TRAFFIC CONTROL - PHASE 3B
Scale: 1" = 50'

SURVEY PLOTTED BY	DATE
DESIGNED BY	
QUANTITIES BY	
CHECKED BY	
ORIGINAL PLAN	
NOTEBOOK	
No.	

JARED N. MIMURA
LICENSED PROFESSIONAL ENGINEER
No. 13224-C
HAWAII, U.S.A.
EXP. 4/30/12
THIS WORK WAS PREPARED BY ME OR UNDER MY SUPERVISION AND CONSTRUCTION OF THIS PROJECT WILL BE UNDER MY OBSERVATION.

STATE OF HAWAII
DEPARTMENT OF TRANSPORTATION
HIGHWAYS DIVISION

TRAFFIC CONTROL - PHASE 3B

*NIMITZ HIGHWAY
Rehabilitation of Honolulu Slip Cover
and Slip Cover #3
Project No. 92A-01-10M*

Scale: 1" = 50' Date: April 2010

SHEET No. TC-3B OF 6 SHEETS

FED. ROAD DIST. NO.	STATE	PROJ. NO.	FISCAL YEAR	SHEET NO.	TOTAL SHEETS
HAWAII	HAW.	92A-01-10M	2010	ADD. 26	44

TRUE NORTH
SCALE: 1"=50'

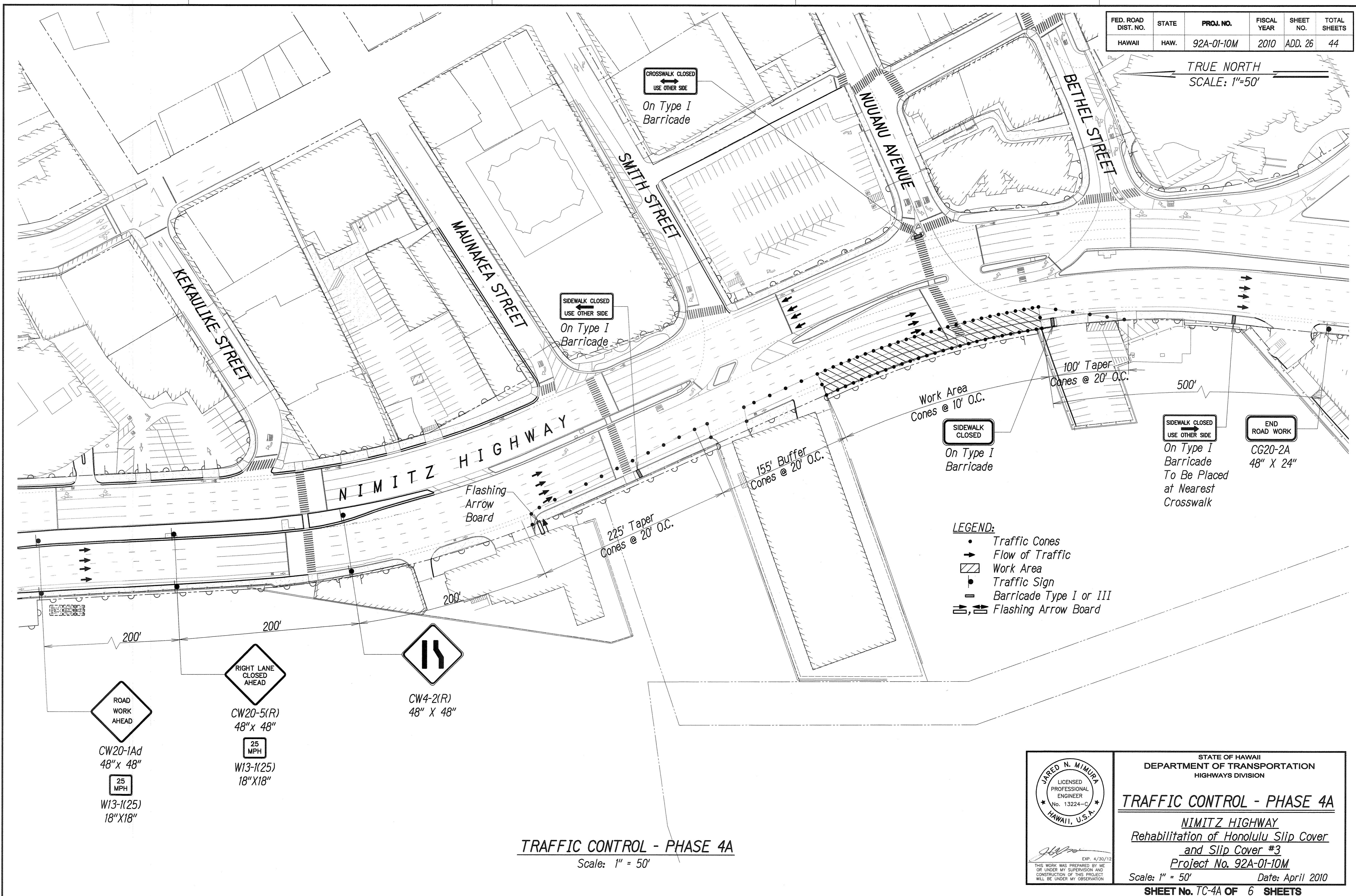

- LEGEND:**
- Traffic Cones
 - Flow of Traffic
 - ▨ Work Area
 - ⊙ Traffic Sign
 - Barricade Type I or III
 - ⚡ Flashing Arrow Board

SURVEY PLOTTED BY	DATE
DESIGNED BY	
QUANTITIES BY	
CHECKED BY	
ORIGINAL PLAN	
NO.	

ROAD WORK AHEAD
CW20-1Ad
48" x 48"
25 MPH
W13-1(25)
18" x 18"

RIGHT LANE CLOSED AHEAD
CW20-5(R)
48" x 48"
25 MPH
W13-1(25)
18" x 18"

CW4-2(R)
48" x 48"

TRAFFIC CONTROL - PHASE 4A
Scale: 1" = 50'

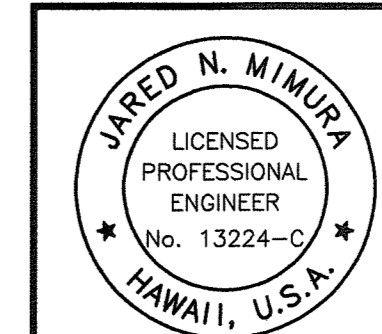

STATE OF HAWAII
DEPARTMENT OF TRANSPORTATION
HIGHWAYS DIVISION

TRAFFIC CONTROL - PHASE 4A

*NIMITZ HIGHWAY
Rehabilitation of Honolulu Slip Cover
and Slip Cover #3
Project No. 92A-01-10M*

Scale: 1" = 50' Date: April 2010

SHEET No. TC-4A OF 6 SHEETS

FED. ROAD DIST. NO.	STATE	PROJ. NO.	FISCAL YEAR	SHEET NO.	TOTAL SHEETS
HAWAII	HAW.	92A-01-10M	2010	ADD. 26S-1	44

TRUE NORTH
SCALE: 1"=50'

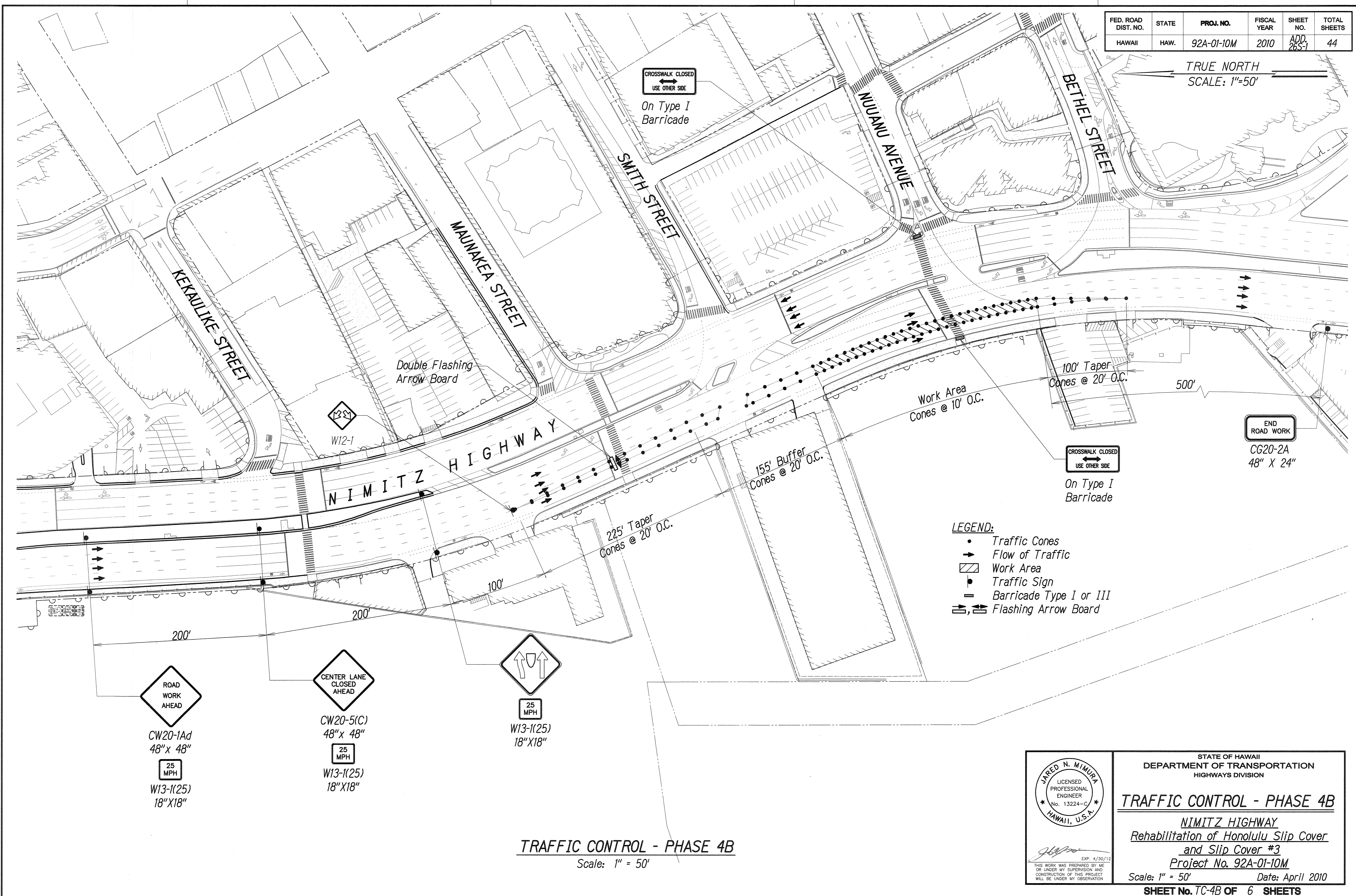

DESIGNED BY	DATE
TRACED BY	
DESIGNED BY	
QUANTITIES BY	
CHECKED BY	
NO.	

ROAD WORK AHEAD
CW20-1Ad
48" x 48"
25 MPH
W13-I(25)
18" x 18"

CENTER LANE CLOSED AHEAD
CW20-5(C)
48" x 48"
25 MPH
W13-I(25)
18" x 18"

25 MPH
W13-I(25)
18" x 18"

TRAFFIC CONTROL - PHASE 4B
Scale: 1" = 50'

- LEGEND:**
- Traffic Cones
 - Flow of Traffic
 - ▨ Work Area
 - ⊠ Traffic Sign
 - Barricade Type I or III
 - ⚡ Flashing Arrow Board

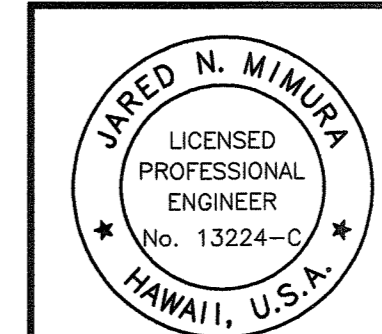

STATE OF HAWAII
DEPARTMENT OF TRANSPORTATION
HIGHWAYS DIVISION

TRAFFIC CONTROL - PHASE 4B

*NIMITZ HIGHWAY
Rehabilitation of Honolulu Slip Cover
and Slip Cover #3
Project No. 92A-01-10M*

Scale: 1" = 50' Date: April 2010

SHEET No. TC-4B OF 6 SHEETS

ADD. 26S-1

FED. ROAD DIST. NO.	STATE	PROJ. NO.	FISCAL YEAR	SHEET NO.	TOTAL SHEETS
HAWAII	HAW.	92A-01-10M	2010	ADD. 27	44

TRUE NORTH
SCALE: 1"=50'

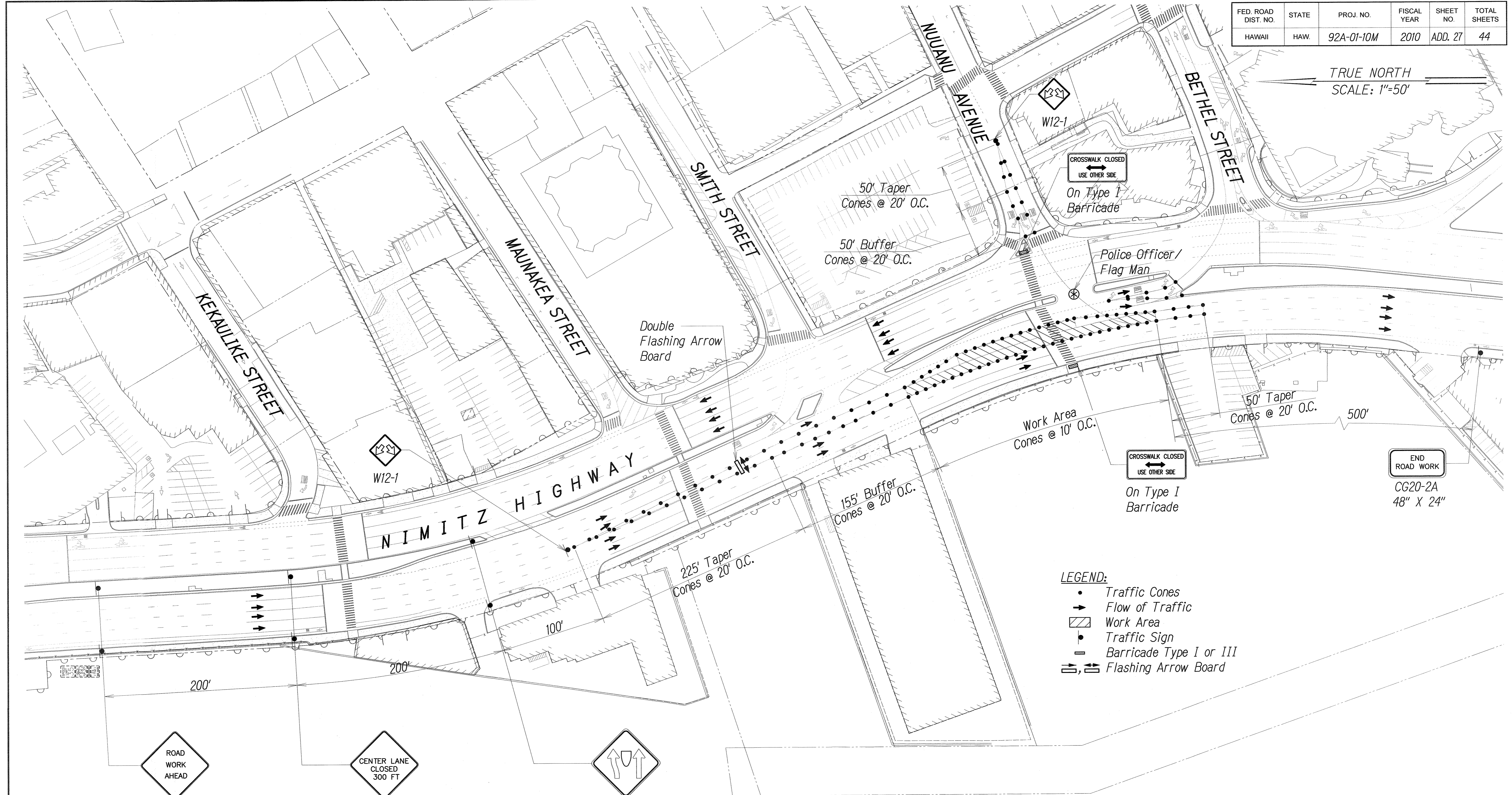

- LEGEND:**
- Traffic Cones
 - Flow of Traffic
 - ▨ Work Area
 - Traffic Sign
 - Barricade Type I or III
 - ⇄ Flashing Arrow Board

DESIGNED BY	DATE
DRAWN BY	
TRACED BY	
NOTED BY	
QUANTITIES BY	
CHECKED BY	

ROAD WORK AHEAD
CW20-1Ad
48" x 48"
25 MPH
W13-1(25)
18" x 18"

CENTER LANE CLOSED 300 FT
CW20-5(C)
48" x 48"
25 MPH
W13-1(25)
18" x 18"

25 MPH
W13-1(25)
18" x 18"

TRAFFIC CONTROL - PHASE 5
Scale: 1" = 50'

JARED N. MIMURA
LICENSED PROFESSIONAL ENGINEER
No. 13224-C
HAWAII, U.S.A.
EXP. 4/30/12
THIS WORK WAS PREPARED BY ME OR UNDER MY SUPERVISION AND CONTRIBUTION OF THIS PROJECT WILL BE UNDER MY OBSERVATION

STATE OF HAWAII
DEPARTMENT OF TRANSPORTATION
HIGHWAYS DIVISION
TRAFFIC CONTROL - PHASE 5
NIMITZ HIGHWAY
Rehabilitation of Honolulu Slip Cover and Slip Cover #3
Project No. 92A-01-10M
Scale: 1" = 50' Date: April 2010
SHEET No. TC-5 OF 6 SHEETS