

FED. ROAD DIST. NO.	STATE	FED. AID PROJ. NO.	FISCAL YEAR	SHEET NO.	TOTAL SHEETS
HAWAII	HAW.	920A-01-75	1979	2	8

# LEGEND

— TS —	EXISTING UNDERGROUND TRAFFIC SIGNAL LINES
— SL —	EXISTING UNDERGROUND STREET LIGHT LINES
— FA —	EXISTING UNDERGROUND FIRE ALARM LINES
— G —	EXISTING UNDERGROUND GAS LINES
— S —	EXISTING UNDERGROUND SEWER LINES
— SCC —	EXISTING UNDERGROUND SIGNAL CORPS CABLE LINES
— CPC —	EXISTING UNDERGROUND COMMERCIAL PACIFIC CABLE LINES
— W —	EXISTING UNDERGROUND WATER LINES
— T —	EXISTING UNDERGROUND TELEPHONE LINES
— E —	EXISTING UNDERGROUND ELECTRIC LINES
— TV —	EXISTING UNDERGROUND CATV LINES
□	EXISTING PULLBOX, MANHOLE OR HANDHOLE
THH	HAWAIIAN TELEPHONE HANDHOLE
TPB	HAWAIIAN TELEPHONE PULLBOX
TMH	HAWAIIAN TELEPHONE MANHOLE
FAPB	FIRE ALARM PULLBOX
WM	WATER METER
WV	WATER VALVE
FH	FIRE HYDRANT
SMH	SEWER MANHOLE
CMH	COMMERCIAL PACIFIC CABLE MANHOLE
SCC MH	SIGNAL CORPS CABLE MANHOLE
GM	GAS METER
TP	TELEPHONE POLE
EMH	HAWAIIAN ELECTRIC MANHOLE
EPB	HAWAIIAN ELECTRIC PULLBOX
SLPB	STREET LIGHT PULLBOX
○ TS	EXISTING TRAFFIC SIGNAL POLE
TSC	EXISTING TRAFFIC SIGNAL CONTROL ENCLOSURE
TSPB	TRAFFIC SIGNAL PULLBOX

SEE GENERAL NOTES ON SHEET NO. 3

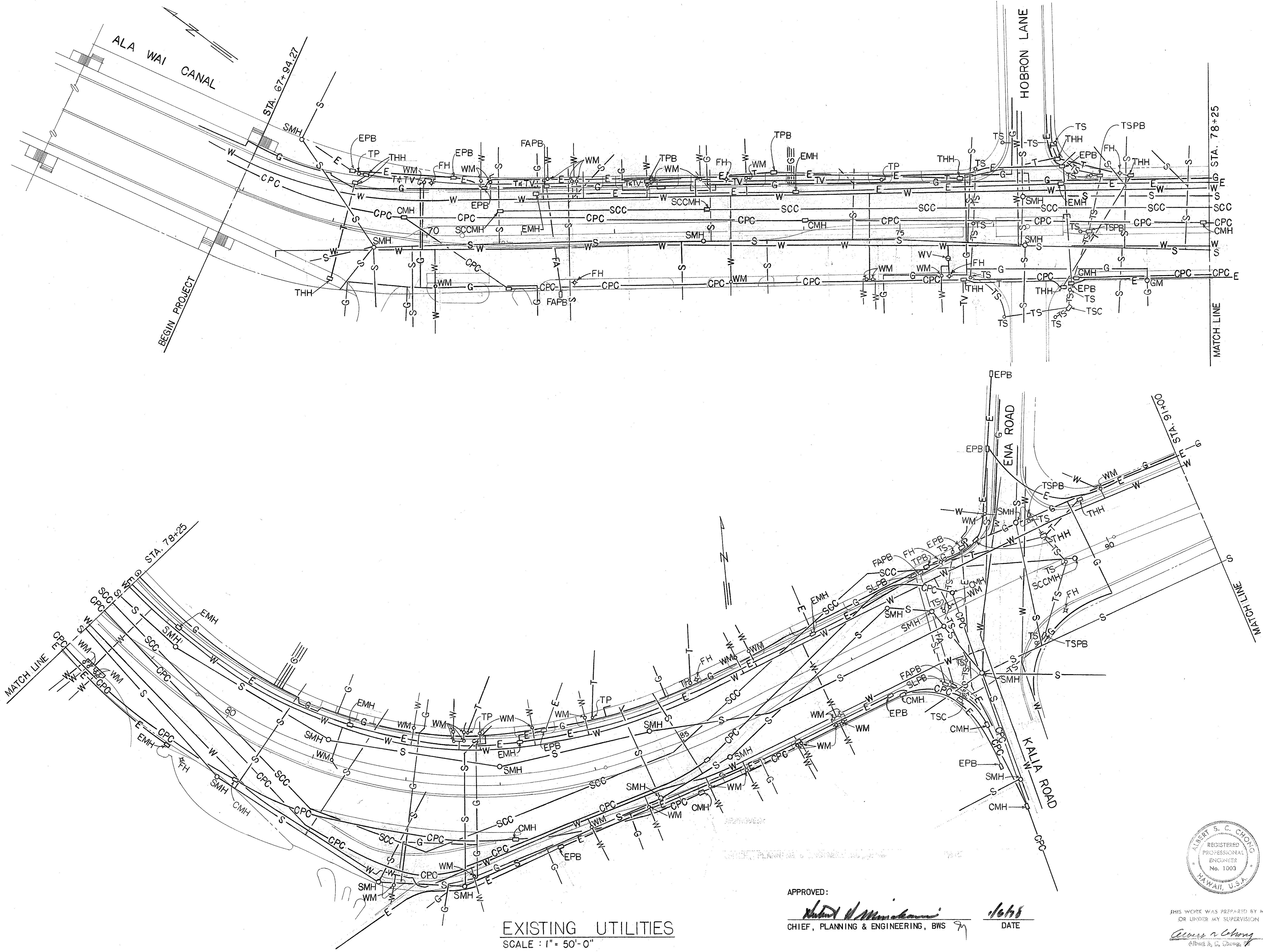

APPROVED: *[Signature]* 1/6/80  
CHIEF, PLANNING & ENGINEERING, BWS  
DATE



THIS WORK WAS PREPARED BY ME  
OR UNDER MY SUPERVISION  
*[Signature]*  
Albert S. C. Chong

STATE OF HAWAII  
DEPARTMENT OF TRANSPORTATION  
LAND TRANSPORTATION FACILITIES DIVISION

ALA MOANA BOULEVARD,  
HIGHWAY LIGHTING SYSTEM,  
ALA WAI CANAL TO KALAKAUA AVENUE

PROJECT NO. 920A-01-75

SHEET NO. 1 OF 4 SHEETS

DATE	...
SURVEY PLOTTED BY	...
DRAWN BY	...
DESIGNED BY	...
QUANTITIES BY	...
CHECKED BY	...
ORIGINAL PLAN	...
NOTE BOOK	...
NO.	...

EXISTING UTILITIES  
SCALE: 1" = 50'-0"

FED. ROAD DIST. NO.	STATE	FED-AID PROJ. NO.	FISCAL YEAR	SHEET NO.	TOTAL SHEETS
HAWAII	HAW.	920A-01-75	1979	3	8

# GENERAL WATER NOTES

- THE EXISTENCE AND LOCATION OF UNDERGROUND UTILITIES AND STRUCTURES AS SHOWN ON THE PLANS ARE FROM THE LATEST AVAILABLE DATA BUT ARE NOT GUARANTEED AS TO ACCURACY, OR THAT OTHER OBSTACLES MAY NOT BE ENCOUNTERED DURING THE COURSE OF THE WORK. THE CONTRACTOR SHALL BE RESPONSIBLE AND SHALL PAY FOR ALL DAMAGES TO THE EXISTING UTILITIES.
- UNLESS OTHERWISE SPECIFIED, ALL MATERIALS AND CONSTRUCTION OF WATER SYSTEM FACILITIES AND APPURTENANCES SHALL BE IN ACCORDANCE WITH THE HONOLULU BOARD OF WATER SUPPLY'S "WATER SYSTEM STANDARDS", DATED MARCH 1977, AND ALL SUBSEQUENT AMENDMENTS AND ADDITIONS.
- PRIOR TO EXCAVATING FOR THE NEW DUCTLINE, THE CONTRACTOR SHALL VERIFY THE LOCATION OF EXISTING WATER MAINS AND APPURTENANCES IN THE FIELD.
- THE CONTRACTOR SHALL READJUST WATER SERVICES AND/OR METERS TO FACILITATE THE DUCTLINE CONSTRUCTION, WITH THE BOARD OF WATER SUPPLY INSPECTOR COORDINATING THE WORK. THIS WORK SHALL BE CONSIDERED INCIDENTAL AND SHALL BE AT CONTRACTOR'S EXPENSE.
- ALL PLANS APPROVED BY THE BOARD OF WATER SUPPLY ARE BASED SOLELY ON THE ADEQUACY OF THE WATER SUPPLY. ALL OTHER FEATURES OF THE IMPROVEMENTS SHALL NOT BE THE RESPONSIBILITY OF THE BOARD OF WATER SUPPLY.
- THE CONTRACTOR SHALL NOTIFY THE BOARD OF WATER SUPPLY IN WRITING ONE WEEK PRIOR TO COMMENCING WORK ON THIS PROJECT.
- REAPPROVAL SHALL BE REQUIRED IF THIS PROJECT IS NOT UNDER CONSTRUCTION WITHIN A PERIOD OF ONE YEAR (SEE RULES AND REGULATIONS OF THE BOARD OF WATER SUPPLY).

# GENERAL NOTES

- NOT ALL UNDERGROUND UTILITY LINES SHOWN. CONTRACTOR SHALL VERIFY EXACT LOCATIONS OF ALL UTILITIES PRIOR TO ANY EXCAVATION WORK. REPAIR OF DAMAGES TO THESE UTILITIES CAUSED BY THE CONTRACTOR SHALL BE THE CONTRACTOR'S RESPONSIBILITY.
 

GAS LINES: CONTRACTOR TO CALL 548-2126 FOR FIELD LOCATIONS OF GAS LINES A MINIMUM OF 48 HOURS BEFORE STARTING PROJECT EXCAVATION.

TELEPHONE LINES: CONTRACTOR TO OBTAIN EXCAVATION CLEARANCE 3 WORKING DAYS PRIOR TO ANY EXCAVATION WORK. USE EXTREME CAUTION DURING EXCAVATION.

WATER LINES: CONTRACTOR TO CALL BOARD OF WATER SUPPLY, CITY & COUNTY OF HONOLULU FOR FIELD LOCATIONS OF WATER MAINS AND APPURTENANCES A MINIMUM OF 48 HOURS BEFORE STARTING PROJECT EXCAVATION.

SEWER LINES: CONTRACTOR TO CALL DIVISION OF SEWERS, CITY & COUNTY OF HONOLULU FOR FIELD LOCATIONS OF SEWER LINES AND LATERALS A MINIMUM OF 48 HOURS BEFORE STARTING PROJECT EXCAVATION.
- THE CONTRACTOR SHALL KEEP EXISTING LIGHTS OPERABLE UNTIL NEW LIGHTS ARE IN FULL OPERATION. SALVAGED LIGHTING EQUIPMENT SHALL BE HAULED TO PEARL CITY BASEYARD ON LEHUA AVENUE AS DIRECTED BY ENGINEER.

SEE LEGEND ON SHEET 2

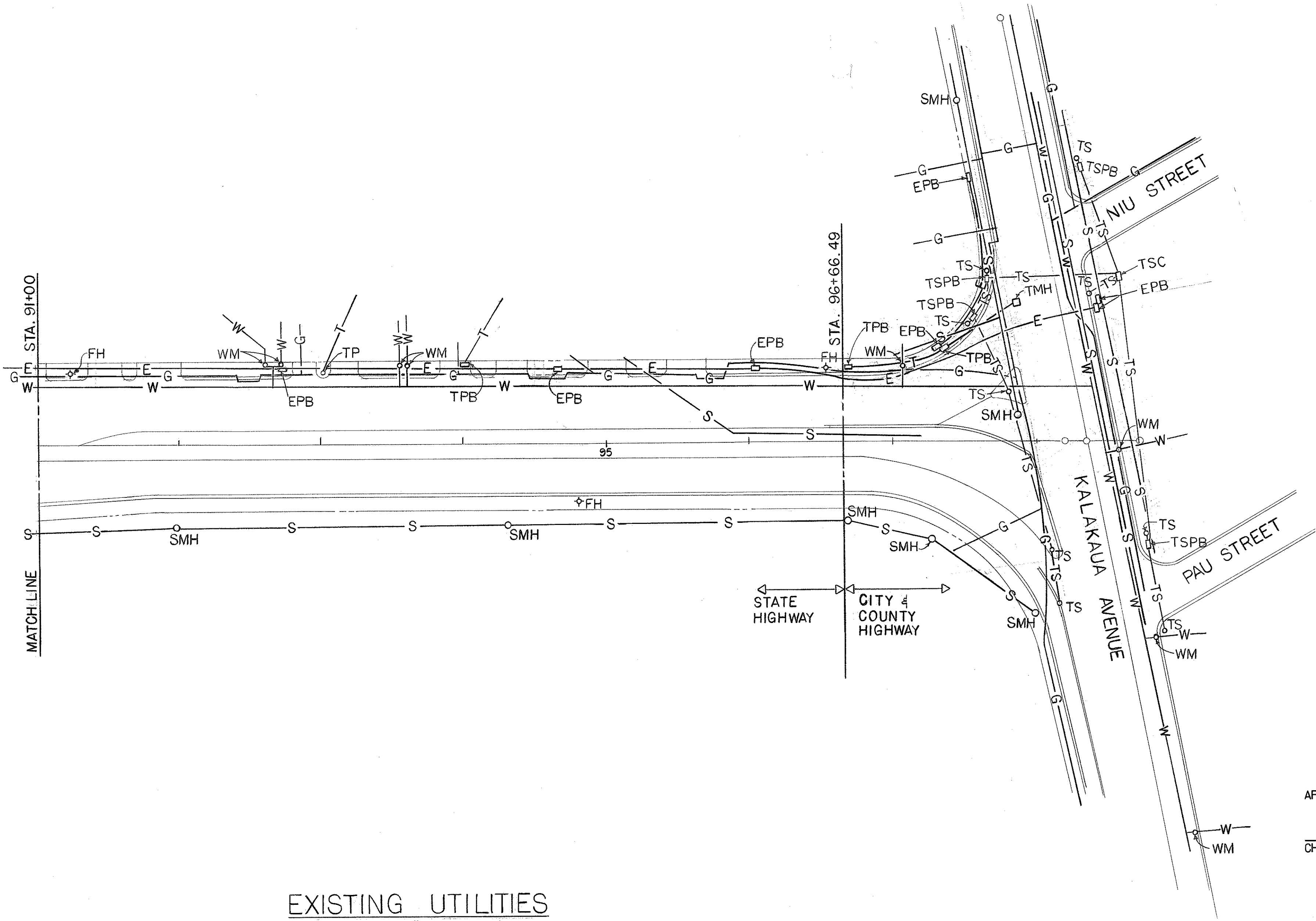

EXISTING UTILITIES  
SCALE: 1 = 50'-0"

APPROVED:  
*Albert S. C. Chong*  
CHIEF, PLANNING & ENGINEERING, BWS  
DATE: 1/6/78

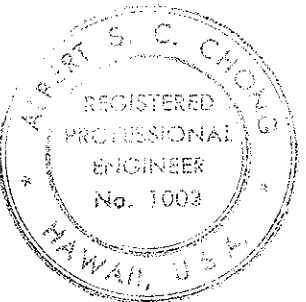

THIS WORK WAS PREPARED BY ME  
OR UNDER MY SUPERVISION  
*Albert S. C. Chong*  
Albert S. C. Chong, P.E.

STATE OF HAWAII  
DEPARTMENT OF TRANSPORTATION  
LAND TRANSPORTATION FACILITIES DIVISION

ALA MOANA BOULEVARD.  
HIGHWAY LIGHTING SYSTEM.  
ALA WAI CANAL TO KALAKAUA AVENUE

PROJECT NO. 920A-01-75

SHEET No. 1 OF 1 SHEETS

SURVEY PLOTTED BY	DATE
DRAWN BY	
DESIGNED BY	
CHECKED BY	
ORIGINAL PLAN	
NOTE BOOK	
NO.	