

GENERAL WATER NOTES

1. Unless otherwise specified, all materials and construction of water system facilities and appurtenances shall be in accordance with the STANDARD SPECIFICATIONS FOR ROAD AND BRIDGE CONSTRUCTION, dated 1976, as amended of the Hawaii Highways Division, Department of Transportation.
2. Prior to excavating for new drain, sewer and other utility lines, the Contractor shall verify in the field the location of existing Water Mains and appurtenances. Where the installation of new drain, sewer and other utility lines are to cross over or under existing water mains, the Contractor shall expose the existing water mains prior to trenching. Excavation around water mains shall be done by hand.
3. Items indicated as "relocate" on the plans shall be removed, cleaned, painted and reinstalled at the new location by the Contractor unless otherwise specified.
4. The minimum clearance between fire hydrant and utility poles or light standard shall be 3.0 feet.
5. The Contractor shall notify the Board of Water Supply in writing one week prior to commencing work on the main.
6. Approval by the Board of Water Supply is based solely on the adequacy of the water supply. Discrepancies, if any of alignments, grades, fittings, etc., shall be the responsibility of the Engineer who prepared the plans.
7. The existence and location of underground utilities and structures as shown on the plans are from the latest available data but is not guaranteed as to accuracy or the encountering of other obstacles during the course of the work. The Contractor shall be responsible and shall pay for damages to existing utilities.
8. Unless otherwise specified, connections to existing water mains and chlorination of new mains shall be done by the Contractor, with the BWS Inspector coordinating the work. For details, contact BWS Engineering Division, Construction Section.
9. Reapproval shall be required if this project is not under construction within a period of one year (see rules and regulation of the Board of Water Supply).

FED. ROAD DIST. NO.	STATE	FED. AID PROJ. NO.	FISCAL YEAR	SHEET NO.	TOTAL SHEETS
HAWAII	HAW.	HHS-092-1(12)	1978	54	59

TRUE NORTH
Scale: 1" = 20'

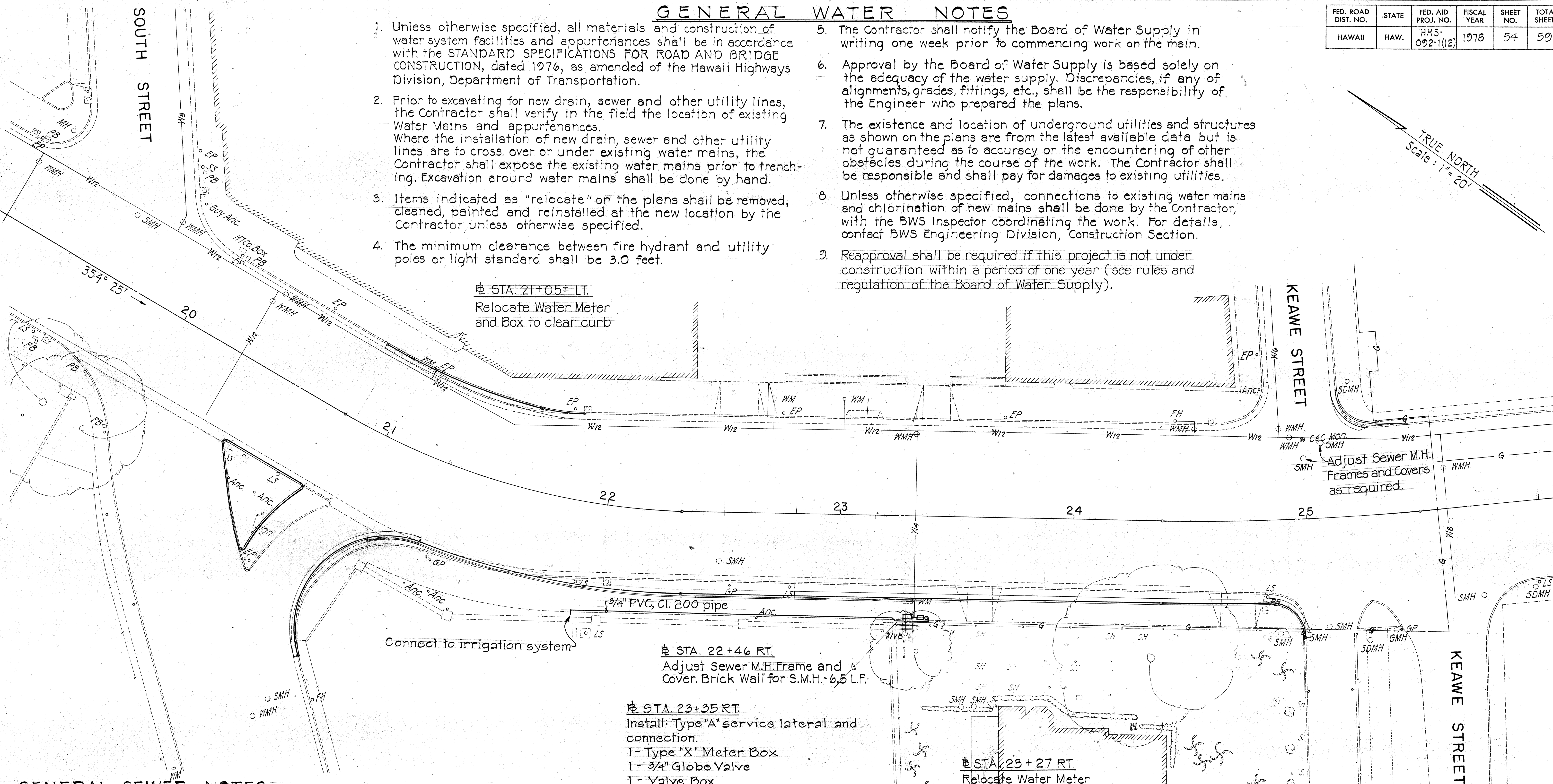

GENERAL SEWER NOTES:

1. Contractor shall notify the Division of Sewers seven days prior to commencement of sewer work.
2. Existing sewer lines shown on the plans are based on existing records of varying degrees of accuracy. The Contractor shall verify the locations and inverts of existing lines wherever directed by the Engineer. Adjustment to any new or existing sewer system shall be in accordance with the verified information.
3. All sewer work shall be performed in accordance with City & County Standard Specifications approved by the Chief Engineer, May, 1975, and the latest Department of Public Works Standard Details, August 1976 and the

Revised Ordinance of Honolulu, 1969.

APPROVED:

[Signature] 3/17/78
CHIEF, DIVISION OF
WASTEWATER MANAGEMENT

APPROVED:

[Signature] 4/13/78
CHIEF, PLANNING & ENGINEERING BWS DATE

STATE OF HAWAII
DEPARTMENT OF TRANSPORTATION
HIGHWAYS DIVISION

SEWER & WATER SYSTEM

ALA MOANA BLVD
SAFETY IMPROVEMENTS
PROJ. NO. HHS-092-1(12)

Scale: as noted

SHEET No. 1 OF 1 SHEETS