

FED. ROAD DIST. NO.	STATE	FED. AID PROJ. NO.	FISCAL YEAR	SHEET NO.	TOTAL SHEETS
HAWAII	HAW.	STP-0001 (30)	2007	52	89

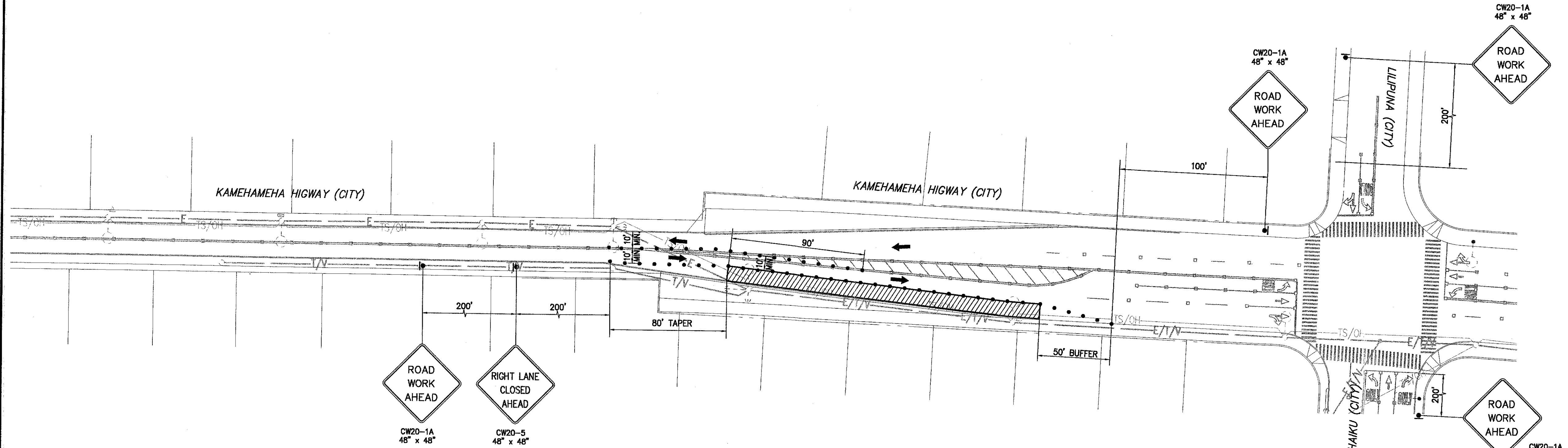

TRAFFIC CONTROL PLAN
(KAMEHAMEHA HWY.)-3

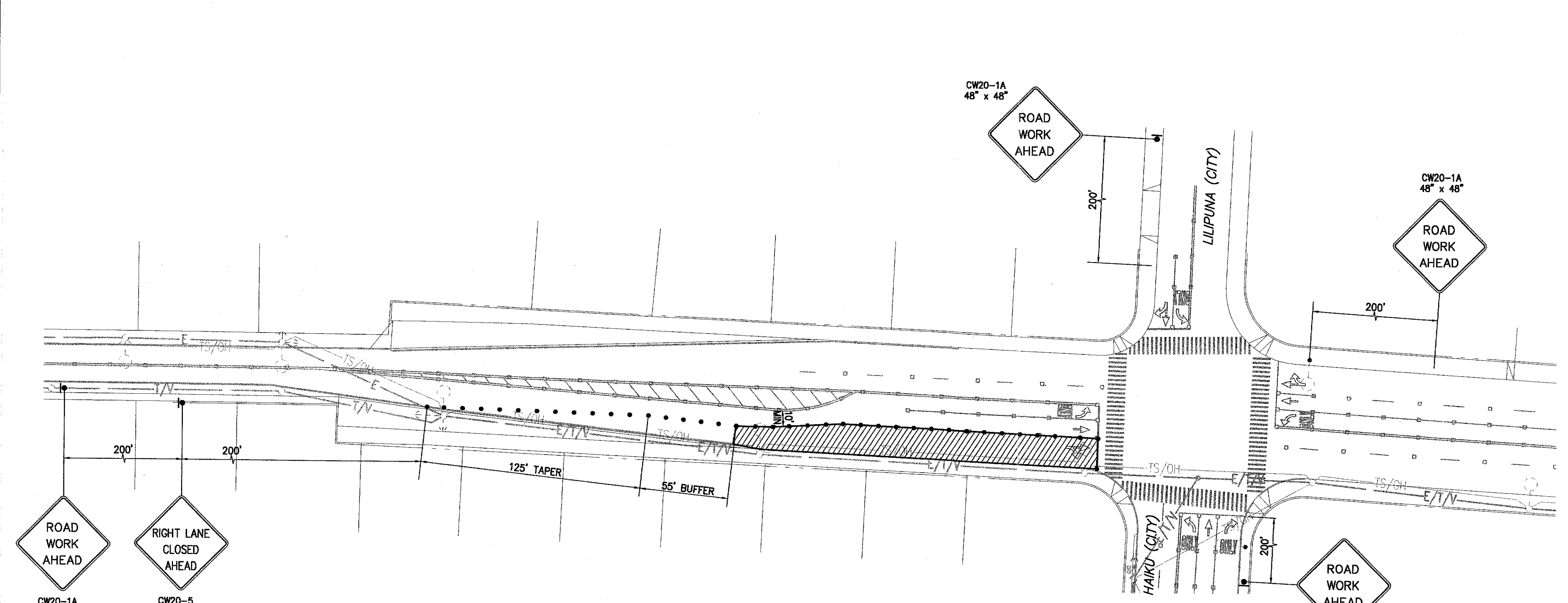

TRAFFIC CONTROL PLAN
(KAMEHAMEHA HWY.)-4

- LEGEND:
- ◊ CONSTRUCTION SIGN
 - CONES OR FLEXIBLE TUBULAR MARKERS
 - WORK AREA
 - ← DIRECTION OF TRAFFIC
 - FLAGMAN
 - POLICE OFFICER
 - FLASHING ARROW SIGNAL

APPROVED: _____ DATE: _____
CHIEF, TRAFFIC REVIEW BRANCH, DPP

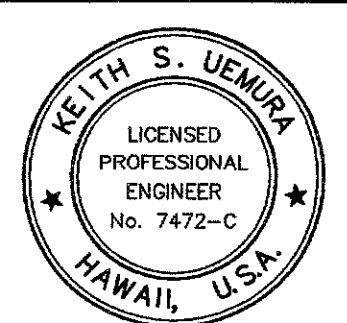

THIS WORK WAS PREPARED BY ME OR UNDER MY SUPERVISION AND CONSTRUCTION OF THIS PROJECT WILL BE UNDER MY OBSERVATION.
Keith S. Uemura
P.O.E.N. INC.
dba PARK ENGINEERING
EXPIRES 4/30/08

REVISION	DATE	BRIEF	BY	APPROVED

DEPARTMENT OF TRANSPORTATION SERVICES
CITY AND COUNTY OF HONOLULU
JOB NO.
COMPUTERIZED TRAFFIC CONTROL SYSTEM
PHASE 9
TRAFFIC CONTROL PLAN
KAMEHAMEHA HWY. - HEEIA TO LILIPUNA/HAIKU-2

ENGINEER: TSW DATE: MARCH 2007
DRAFTSMAN: TSW SCALE: _____
CHK. BY: KSU REF: _____
APPROVED: _____
DIRECTOR: _____ DIVISION ENGINEER: _____