

FED. ROAD DIST. NO.	STATE	FED. AID PROJ. NO.	FISCAL YEAR	SHEET NO.	TOTAL SHEETS
HAWAII	HAW.	STP-0001 (30)	2007	87	89

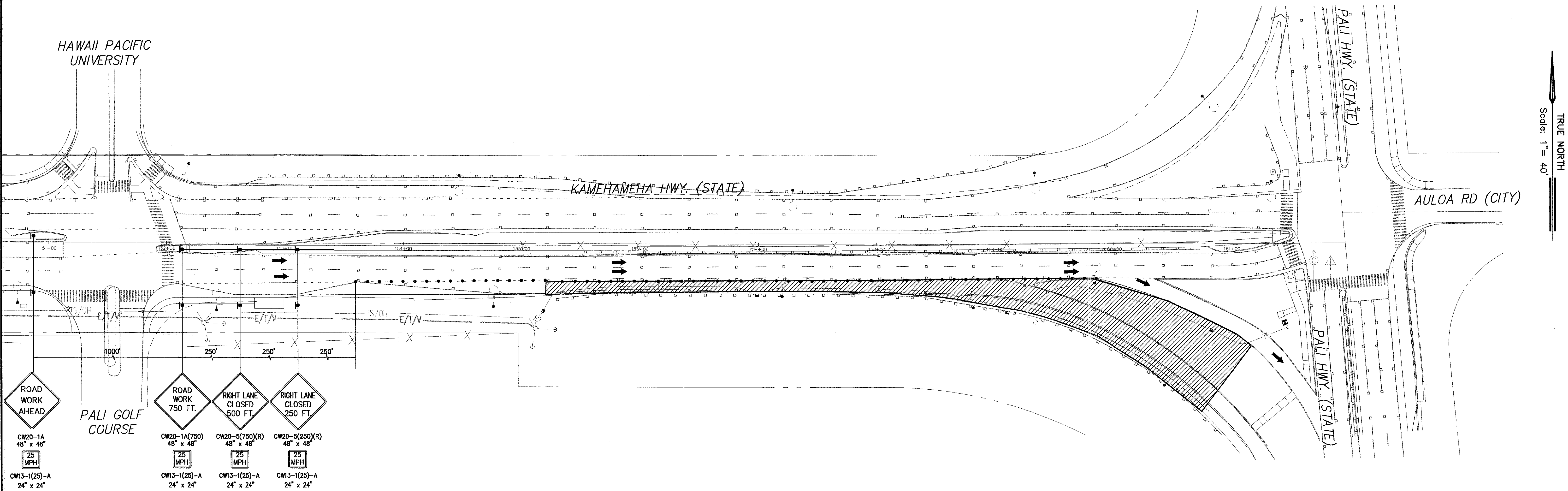

TRAFFIC CONTROL PLAN  
(KAMEHAMEHA HWY - PALI HWY. INTERSECTION)-1

- LEGEND:
- CONSTRUCTION SIGN
  - CONES OR FLEXIBLE TUBULAR MARKERS
  - WORK AREA
  - DIRECTION OF TRAFFIC
  - FLAGMAN
  - POLICE OFFICER
  - FLASHING ARROW SIGNAL

REVISION	DATE	BRIEF	BY	APPROVED

THIS WORK WAS PREPARED BY ME OR UNDER MY SUPERVISION AND CONSTRUCTION OF THIS PROJECT WILL BE UNDER MY OBSERVATION

*Keith S. Uemura*  
Keith S. Uemura  
Professional Engineer  
EXPIRES 4/30/08

DEPARTMENT OF TRANSPORTATION SERVICES  
CITY AND COUNTY OF HONOLULU  
JOB NO.

COMPUTERIZED TRAFFIC CONTROL SYSTEM  
PHASE 9

TRAFFIC CONTROL PLAN  
KAMEHAMEHA - PALI INTERSECTION-1

ENGINEER: TSW DATE: MARCH 2007  
DRAFTSMAN: TSW SCALE: \_\_\_\_\_  
CHK. BY: KSU REF: \_\_\_\_\_  
APPROVED: \_\_\_\_\_  
DIRECTOR: \_\_\_\_\_ DIVISION ENGINEER: \_\_\_\_\_

FED. ROAD DIST. NO.	STATE	FED. AID PROJ. NO.	FISCAL YEAR	SHEET NO.	TOTAL SHEETS
HAWAII	HAW.	STP-0001 (30)	2007	88	89

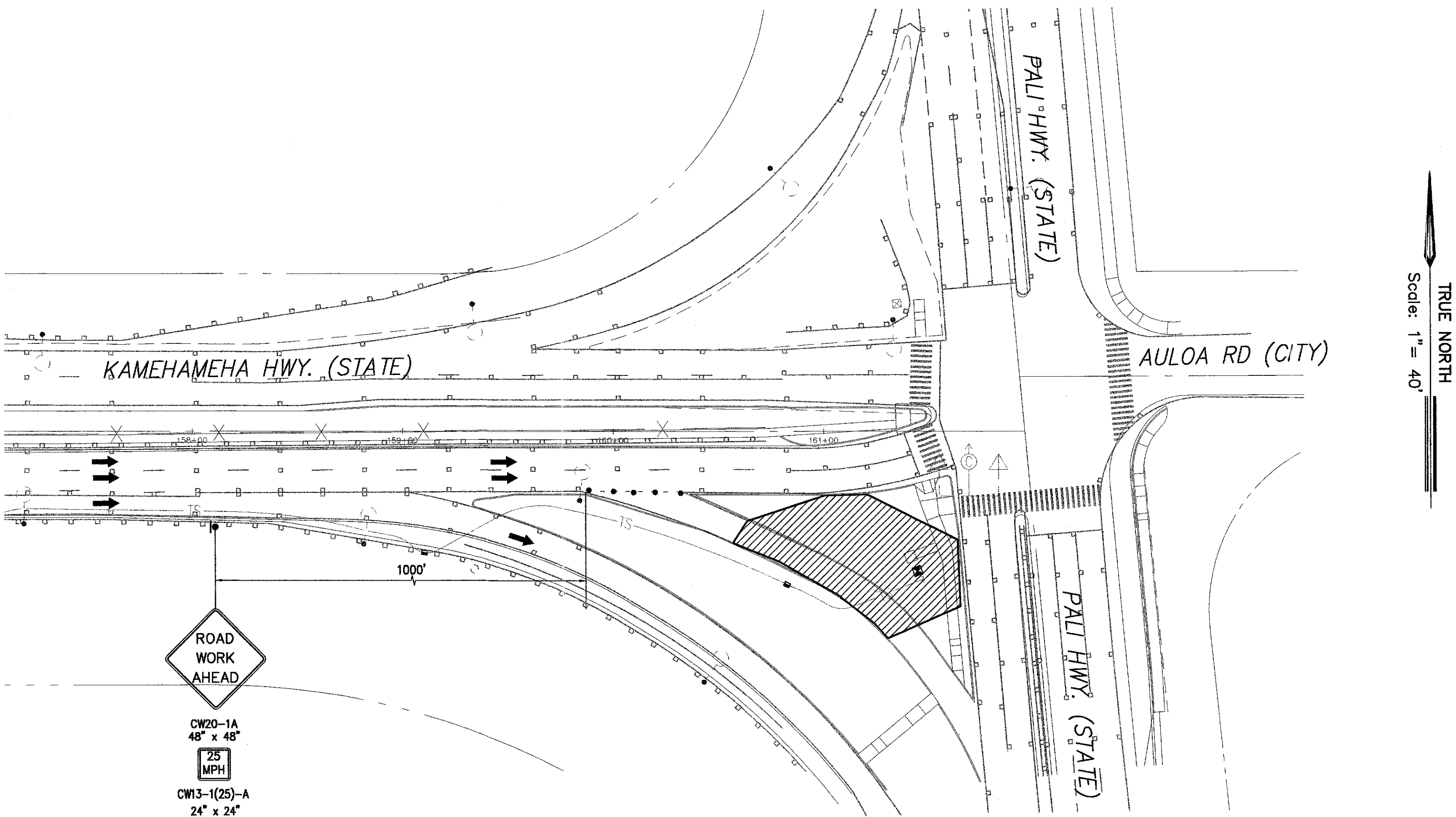

TRAFFIC CONTROL PLAN  
(KAMEHAMEHA HWY - PALI HWY. INTERSECTION)-2

- LEGEND:
- CONSTRUCTION SIGN
  - CONES OR FLEXIBLE TUBULAR MARKERS
  - WORK AREA
  - DIRECTION OF TRAFFIC
  - FLAGMAN
  - POLICE OFFICER
  - FLASHING ARROW SIGNAL

REVISION	DATE	BRIEF	BY	APPROVED

THIS WORK WAS PREPARED BY ME OR UNDER MY SUPERVISION AND CONSTRUCTION OF THIS PROJECT WILL BE UNDER MY OBSERVATION  
PIUES, INC. dba PARK ENGINEERING EXPIRES 4/30/08

DEPARTMENT OF TRANSPORTATION SERVICES  
 CITY AND COUNTY OF HONOLULU  
 JOB NO.  
 COMPUTERIZED TRAFFIC CONTROL SYSTEM  
 PHASE 9  
 TRAFFIC CONTROL PLAN  
 KAMEHAMEHA - PALI INTERSECTION-2

ENGINEER: TSW      DATE: MARCH 2007  
 DRAFTSMAN: TSW      SCALE:  
 CHK. BY: KSU      REF.:  
 APPROVED:      APPROVED:  
 DIRECTOR:      DIVISION ENGINEER:

FILE	PROJECT	PLANNER	INL

FED. ROAD DIST. NO.	STATE	FED. AID PROJ. NO.	FISCAL YEAR	SHEET NO.	TOTAL SHEETS
HAWAII	HAW.	STP-0001 (30)	2007	89	89

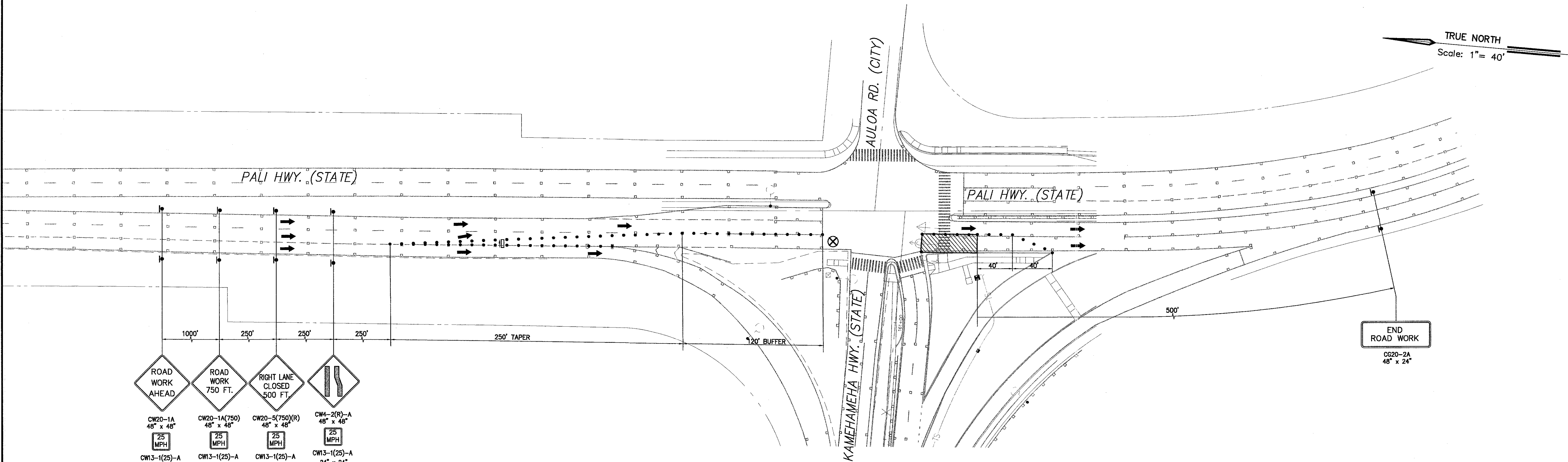

TRAFFIC CONTROL PLAN  
(KAMEHAMEHA HWY - PALI HWY. INTERSECTION)-3

- LEGEND:
- Construction sign
  - Cones or flexible tubular markers
  - Work area
  - Direction of traffic
  - Flagman
  - Police officer
  - Flashing arrow signal

REVISION	DATE	BRIEF	BY	APPROVED

THIS WORK WAS PREPARED BY ME OR UNDER MY SUPERVISION AND CONSTRUCTION OF THIS PROJECT WILL BE UNDER MY OBSERVATION  
  
ParEn, Inc. dba PARK ENGINEERING EXPIRES 4/30/08

DEPARTMENT OF TRANSPORTATION SERVICES  
CITY AND COUNTY OF HONOLULU  
JOB NO.  
COMPUTERIZED TRAFFIC CONTROL SYSTEM  
PHASE 9  
TRAFFIC CONTROL PLAN  
KAMEHAMEHA - PALI INTERSECTION-3

ENGINEER TSW DATE MARCH 2007  
DRAFTSMAN TSW SCALE  
CHK. BY KSU REF.  
APPROVED: APPROVED:  
DIRECTOR DIVISION ENGINEER

FILE	PROJECT	FOUNDER	NO.