

FED. ROAD DIST. NO.	STATE	FED. AID PROJ. NO.	FISCAL YEAR	SHEET NO.	TOTAL SHEETS
HAWAII	HAW.	STP-0001 (30)	2007	72	89

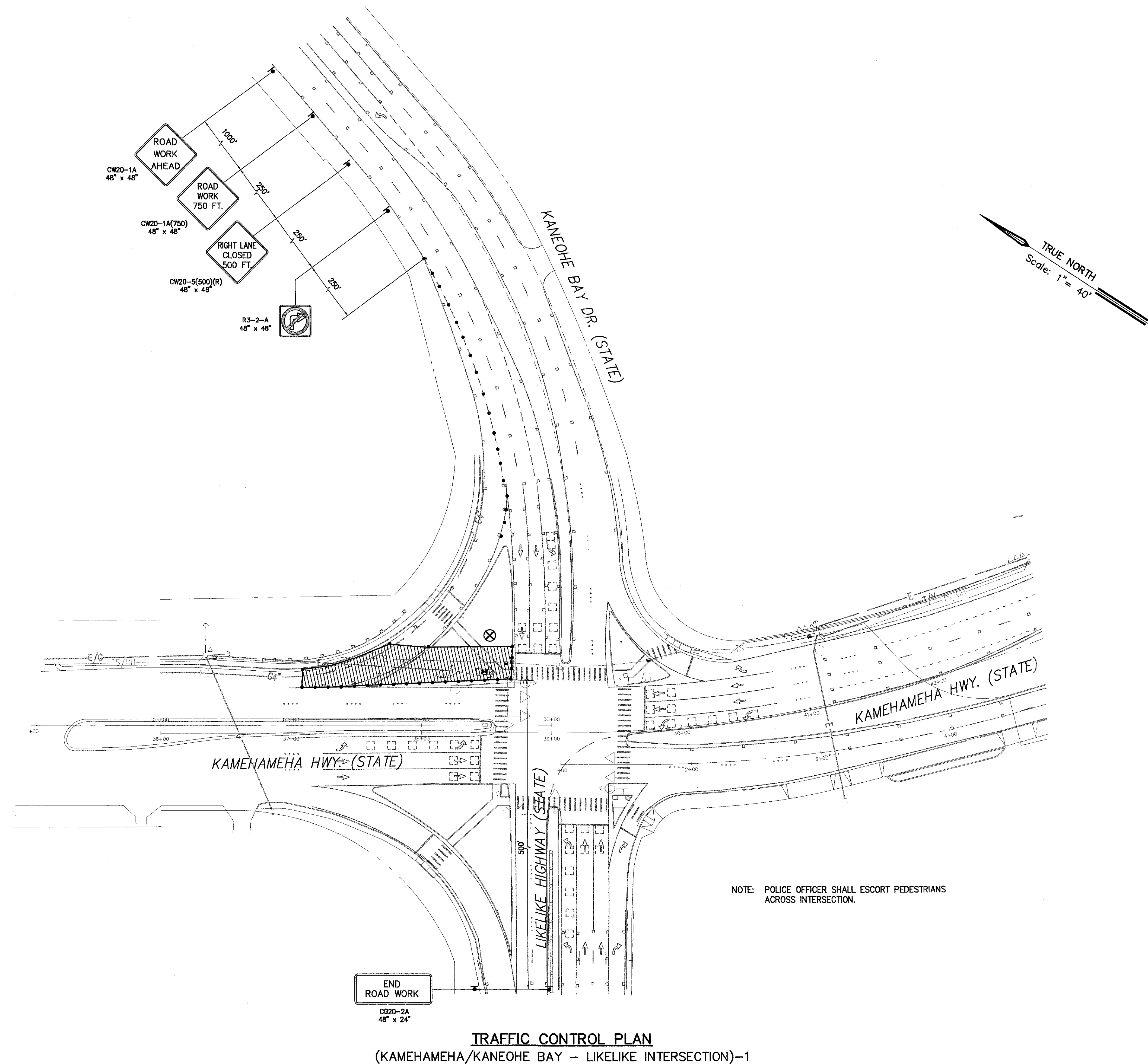

- LEGEND:**
- CONSTRUCTION SIGN
  - CONES OR FLEXIBLE TUBULAR MARKERS
  - ▨ WORK AREA
  - ← DIRECTION OF TRAFFIC
  - ⋈ FLAGMAN
  - ⊗ POLICE OFFICER
  - ⏏ FLASHING ARROW SIGNAL

NOTE: POLICE OFFICER SHALL ESCORT PEDESTRIANS ACROSS INTERSECTION.

**TRAFFIC CONTROL PLAN**  
(KAMEHAMEHA/KANEOHE BAY - LIKELIKE INTERSECTION)-1

REVISION	DATE	BRIEF	BY	APPROVED

THIS WORK WAS PREPARED BY ME OR UNDER MY SUPERVISION AND CONSTRUCTION OF THIS PROJECT WILL BE UNDER MY OBSERVATION.

*Keith S. Uemura*  
Keith S. Uemura, Inc.  
dba PARK ENGINEERING  
EXPIRES 4/30/08

DEPARTMENT OF TRANSPORTATION SERVICES  
CITY AND COUNTY OF HONOLULU  
JOB NO. \_\_\_\_\_  
**COMPUTERIZED TRAFFIC CONTROL SYSTEM**  
**PHASE 9**  
**TRAFFIC CONTROL PLAN**  
**KAMEHAMEHA/KANEOHE BAY - LIKELIKE INTERSECTION-1**

ENGINEER TSW DATE MARCH 2007  
DRAFTSMAN TSW SCALE \_\_\_\_\_  
CHK. BY KSU REF. \_\_\_\_\_  
APPROVED: \_\_\_\_\_  
DIRECTOR \_\_\_\_\_ DIVISION ENGINEER \_\_\_\_\_

FED. ROAD DIST. NO.	STATE	FED. AID PROJ. NO.	FISCAL YEAR	SHEET NO.	TOTAL SHEETS
HAWAII	HAW.	STP-0001 (30)	2007	73	89

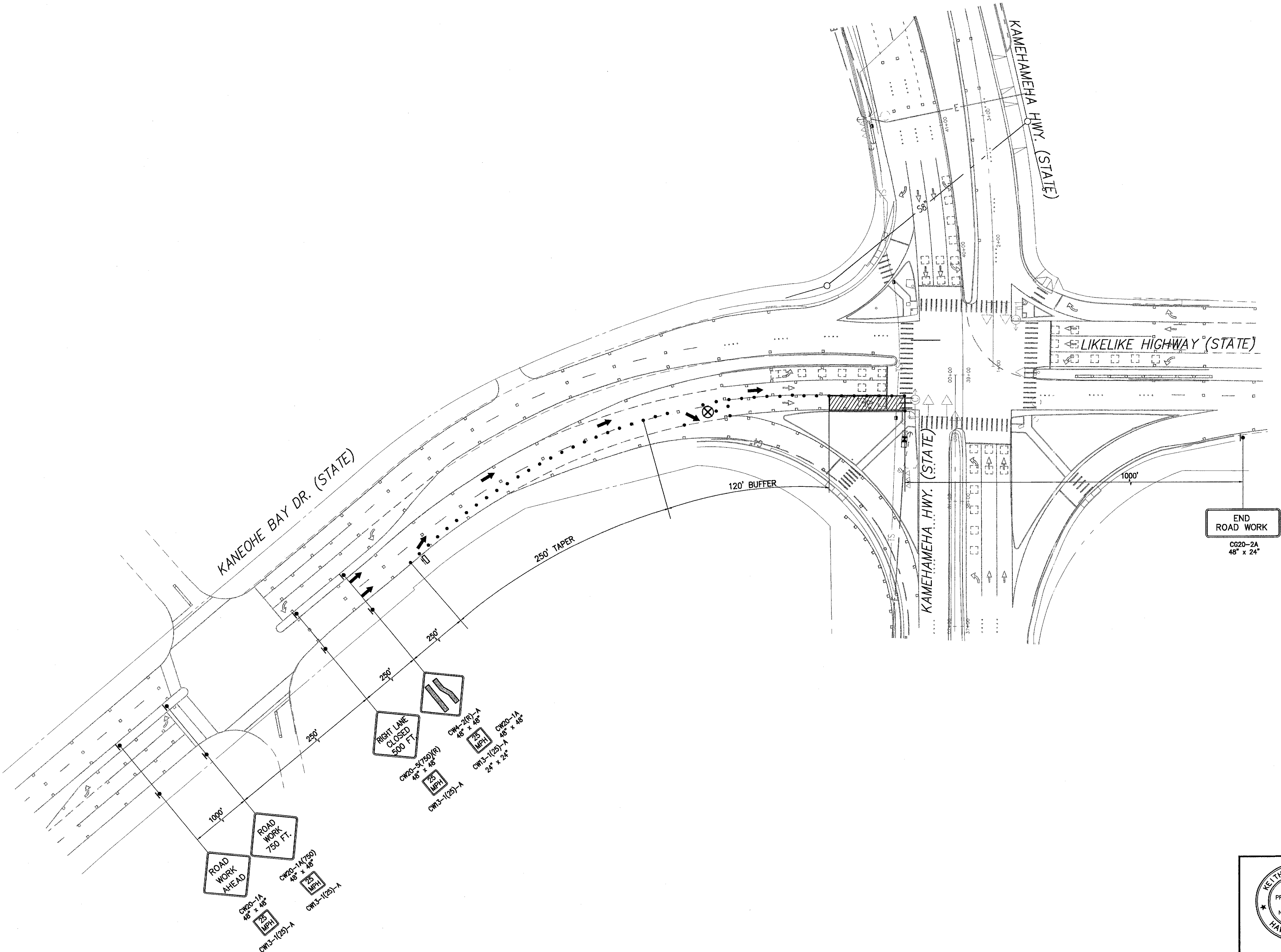
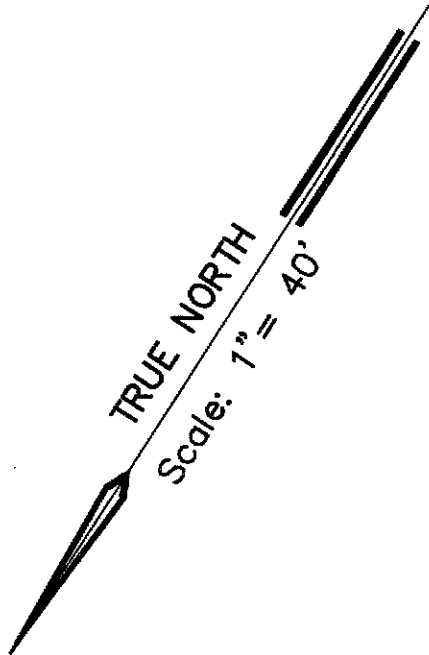

- LEGEND:**
- ◻ CONSTRUCTION SIGN
  - CONES OR FLEXIBLE TUBULAR MARKERS
  - ▨ WORK AREA
  - ← DIRECTION OF TRAFFIC
  - 🚧 FLAGMAN
  - ⊗ POLICE OFFICER
  - ⏏ FLASHING ARROW SIGNAL

REVISION	DATE	BRIEF	BY	APPROVED

THIS WORK WAS PREPARED BY ME OR UNDER MY SUPERVISION AND CONSTRUCTION OF THIS PROJECT WILL BE UNDER MY OBSERVATION  
*Keith S. Uemura*  
For Engr. Inc. dsg PARK ENGINEERING EXPIRES 4/30/08

DEPARTMENT OF TRANSPORTATION SERVICES  
 CITY AND COUNTY OF HONOLULU  
 JOB NO.  
**COMPUTERIZED TRAFFIC CONTROL SYSTEM**  
 PHASE 9  
**TRAFFIC CONTROL PLAN**  
 KAMEHAMEHA/KANEOHE BAY - LIKELIKE INTERSECTION-2

ENGINEER	TSW	DATE	MARCH 2007
DRAFTSMAN	TSW	SCALE	
CHK. BY	KSU	REF.	
APPROVED:		APPROVED:	
DIRECTOR		DIVISION ENGINEER	

**TRAFFIC CONTROL PLAN**  
(KAMEHAMEHA - LIKELIKE INTERSECTION)-2

FED. ROAD DIST. NO.	STATE	FED. AID PROJ. NO.	FISCAL YEAR	SHEET NO.	TOTAL SHEETS
HAWAII	HAW.	STP-0001 (30)	2007	74	89

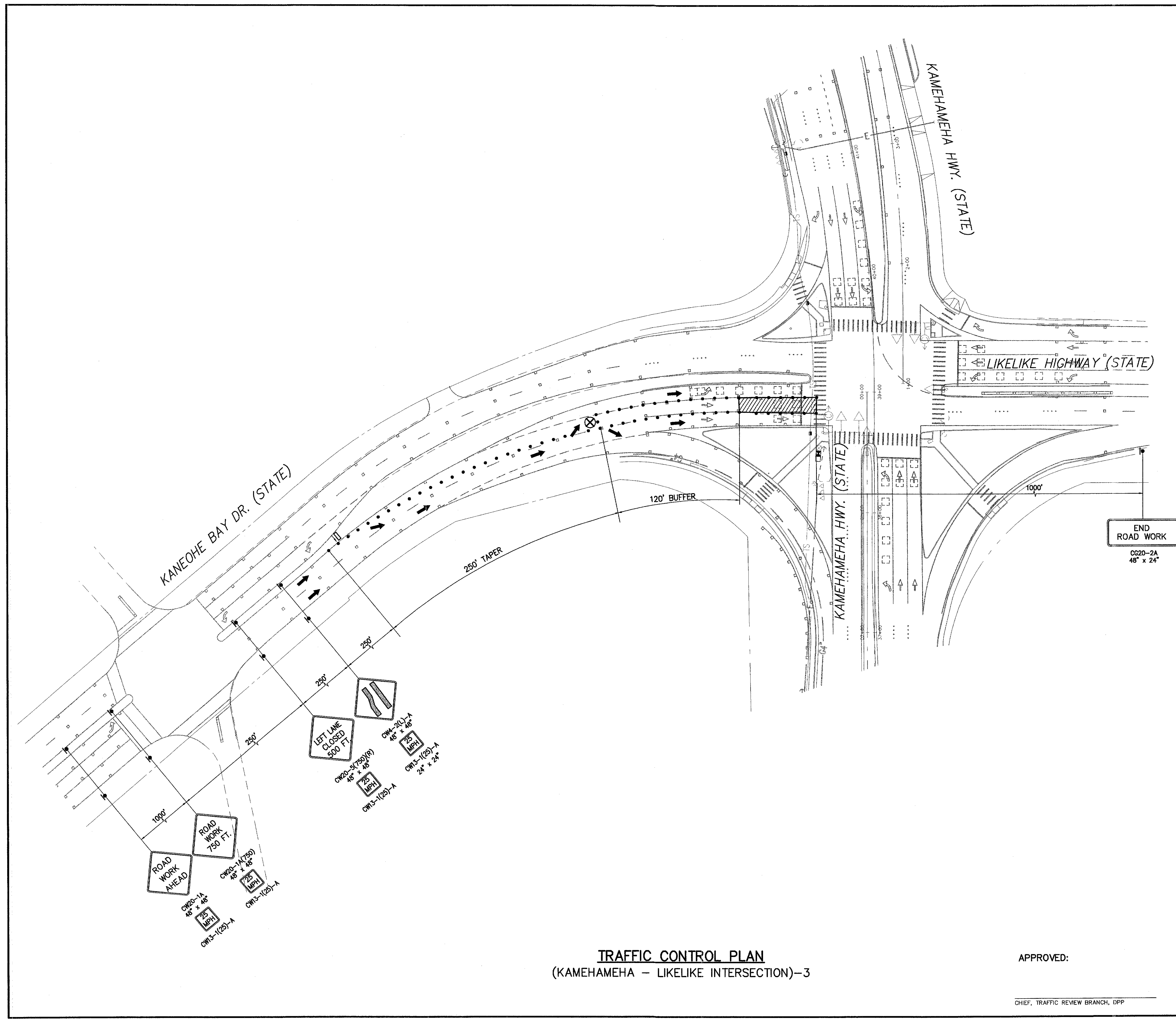

TRUE NORTH  
Scale: 1" = 40'

- LEGEND:**
- CONSTRUCTION SIGN
  - CONES OR FLEXIBLE TUBULAR MARKERS
  - WORK AREA
  - DIRECTION OF TRAFFIC
  - FLAGMAN
  - POLICE OFFICER
  - FLASHING ARROW SIGNAL

**TRAFFIC CONTROL PLAN**  
(KAMEHAMEHA - LIKELIKE INTERSECTION)-3

APPROVED: \_\_\_\_\_ DATE: \_\_\_\_\_  
CHIEF, TRAFFIC REVIEW BRANCH, DPP

REVISION	DATE	BRIEF	BY	APPROVED

THIS WORK WAS PREPARED BY ME OR UNDER MY SUPERVISION AND CONSTRUCTION OF THIS PROJECT WILL BE UNDER MY OBSERVATION

*Keith S. Uemura*  
Keith S. Uemura  
Professional Engineer  
EXPIRES 4/30/08

DEPARTMENT OF TRANSPORTATION SERVICES  
CITY AND COUNTY OF HONOLULU  
JOB NO. \_\_\_\_\_  
COMPUTERIZED TRAFFIC CONTROL SYSTEM  
PHASE 9  
TRAFFIC CONTROL PLAN  
KAMEHAMEHA/KANEOHE BAY - LIKELIKE INTERSECTION-3

ENGINEER	TSW	DATE	MARCH 2007
DRAFTSMAN	TSW	SCALE	
CHK. BY	KSU	REF.	
APPROVED:		APPROVED:	
DIRECTOR		DIRECTOR	



FED. ROAD DIST. NO.	STATE	FED. AID PROJ. NO.	FISCAL YEAR	SHEET NO.	TOTAL SHEETS
HAWAII	HAW.	STP-0001 (30)	2007	75	89

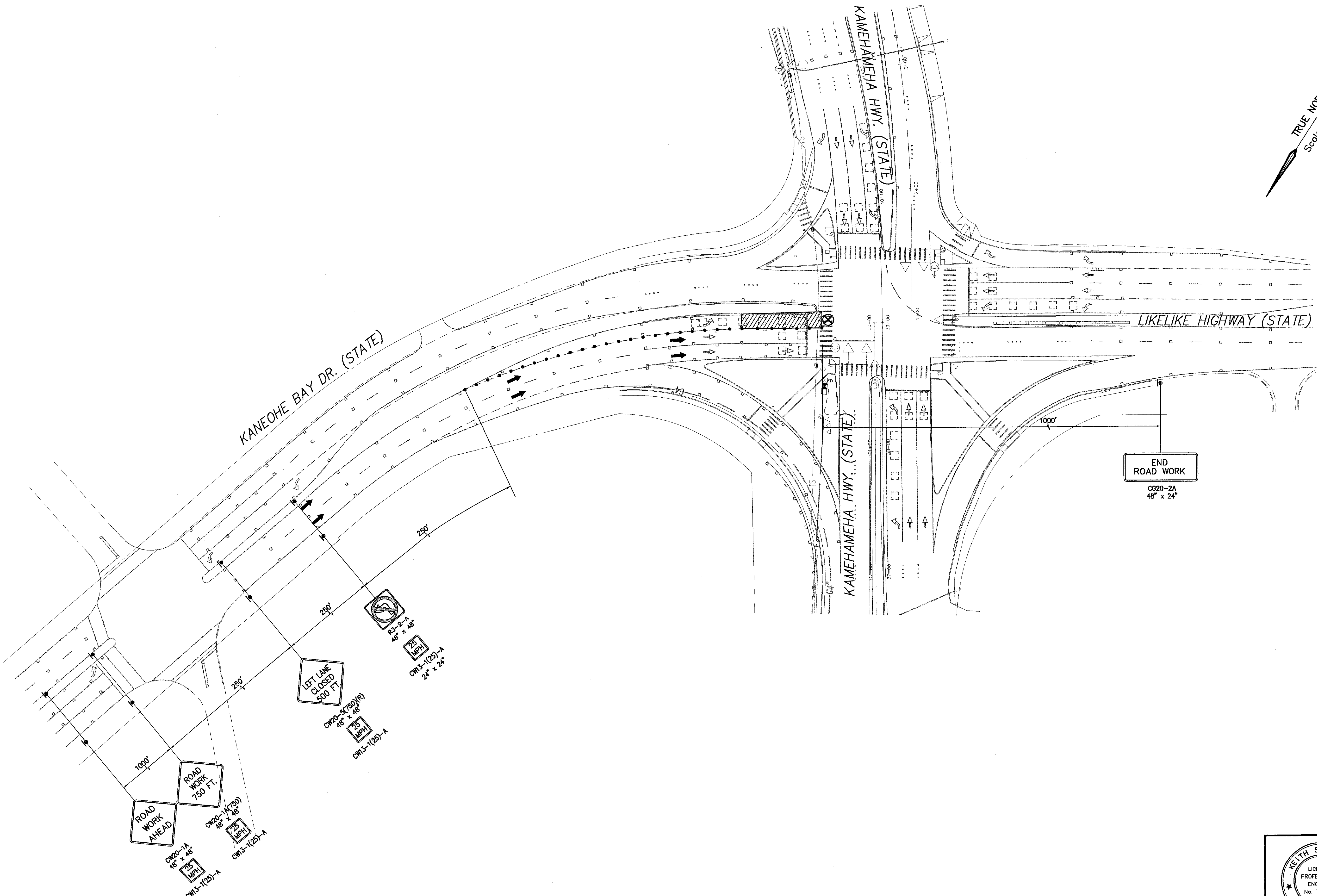
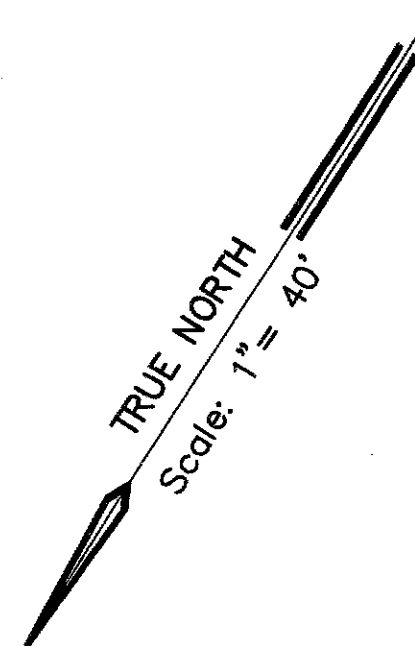

- LEGEND:**
- CONSTRUCTION SIGN
  - CONES OR FLEXIBLE TUBULAR MARKERS
  - ▨ WORK AREA
  - ← DIRECTION OF TRAFFIC
  - ⚓ FLAGMAN
  - ⊗ POLICE OFFICER
  - ⚡ FLASHING ARROW SIGNAL

**TRAFFIC CONTROL PLAN**  
(KAMEHAMEHA - LIKELIKE INTERSECTION)-4

REVISION	DATE	BRIEF	BY	APPROVED

DEPARTMENT OF TRANSPORTATION SERVICES  
CITY AND COUNTY OF HONOLULU  
JOB NO. \_\_\_\_\_  
**COMPUTERIZED TRAFFIC CONTROL SYSTEM**  
PHASE 9  
**TRAFFIC CONTROL PLAN**  
KAMEHAMEHA/KANEOHE BAY - LIKELIKE INTERSECTION-4

ENGINEER	TSW	DATE	MARCH 2007
DRAFTSMAN	TSW	SCALE	
CHK. BY	KSU	REF.	
APPROVED:		APPROVED:	
DIRECTOR		DIVISION ENGINEER	

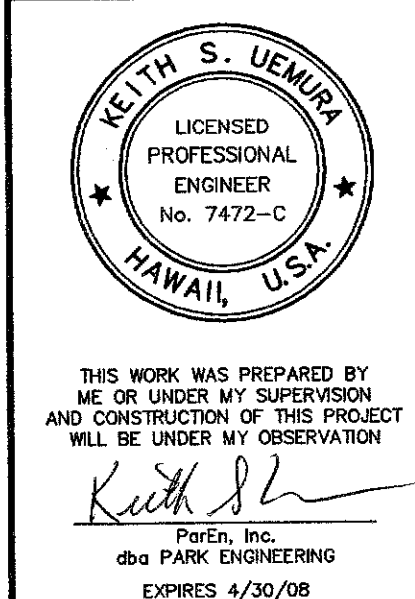

FED. ROAD DIST. NO.	STATE	FED. AID PROJ. NO.	FISCAL YEAR	SHEET NO.	TOTAL SHEETS
HAWAII	HAW.	STP-0001 (30)	2007	76	89

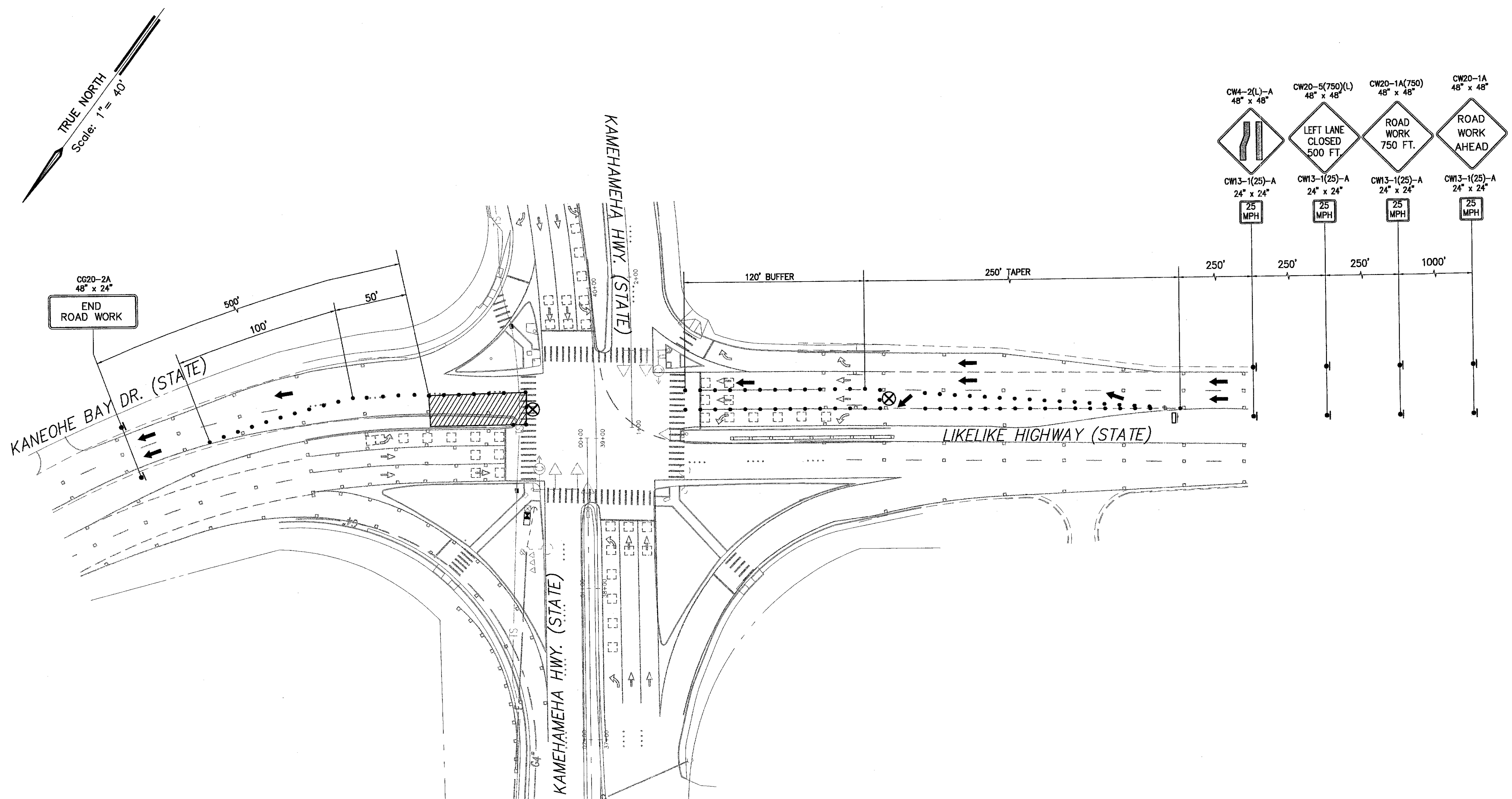

**TRAFFIC CONTROL PLAN**  
(KAMEHAMEHA - LIKELIKE INTERSECTION)-5

- LEGEND:**
- ◻ CONSTRUCTION SIGN
  - CONES OR FLEXIBLE TUBULAR MARKERS
  - ▨ WORK AREA
  - DIRECTION OF TRAFFIC
  - ♢ FLAGMAN
  - ⊗ POLICE OFFICER
  - ▮ FLASHING ARROW SIGNAL

REVISION	DATE	BRIEF	BY	APPROVED

THIS WORK WAS PREPARED BY ME OR UNDER MY SUPERVISION AND CONSTRUCTION OF THIS PROJECT WILL BE UNDER MY OBSERVATION

*Keith S. Uemura*

KEITH S. UEMURA  
P.E. INC.  
dba PARK ENGINEERING  
EXPIRES 4/30/08

DEPARTMENT OF TRANSPORTATION SERVICES  
CITY AND COUNTY OF HONOLULU  
JOB NO. \_\_\_\_\_  
**COMPUTERIZED TRAFFIC CONTROL SYSTEM  
PHASE 9**  
**TRAFFIC CONTROL PLAN**  
**KAMEHAMEHA/KANEOHE BAY - LIKELIKE INTERSECTION-5**

ENGINEER: TSW      DATE: MARCH 2007  
DRAFTSMAN: TSW      SCALE: \_\_\_\_\_  
CHK. BY: KSU      REF: \_\_\_\_\_  
APPROVED: \_\_\_\_\_  
DIRECTOR: \_\_\_\_\_ DIVISION ENGINEER

FED. ROAD DIST. NO.	STATE	FED. AID PROJ. NO.	FISCAL YEAR	SHEET NO.	TOTAL SHEETS
HAWAII	HAW.	STP-0001 (30)	2007	77	89

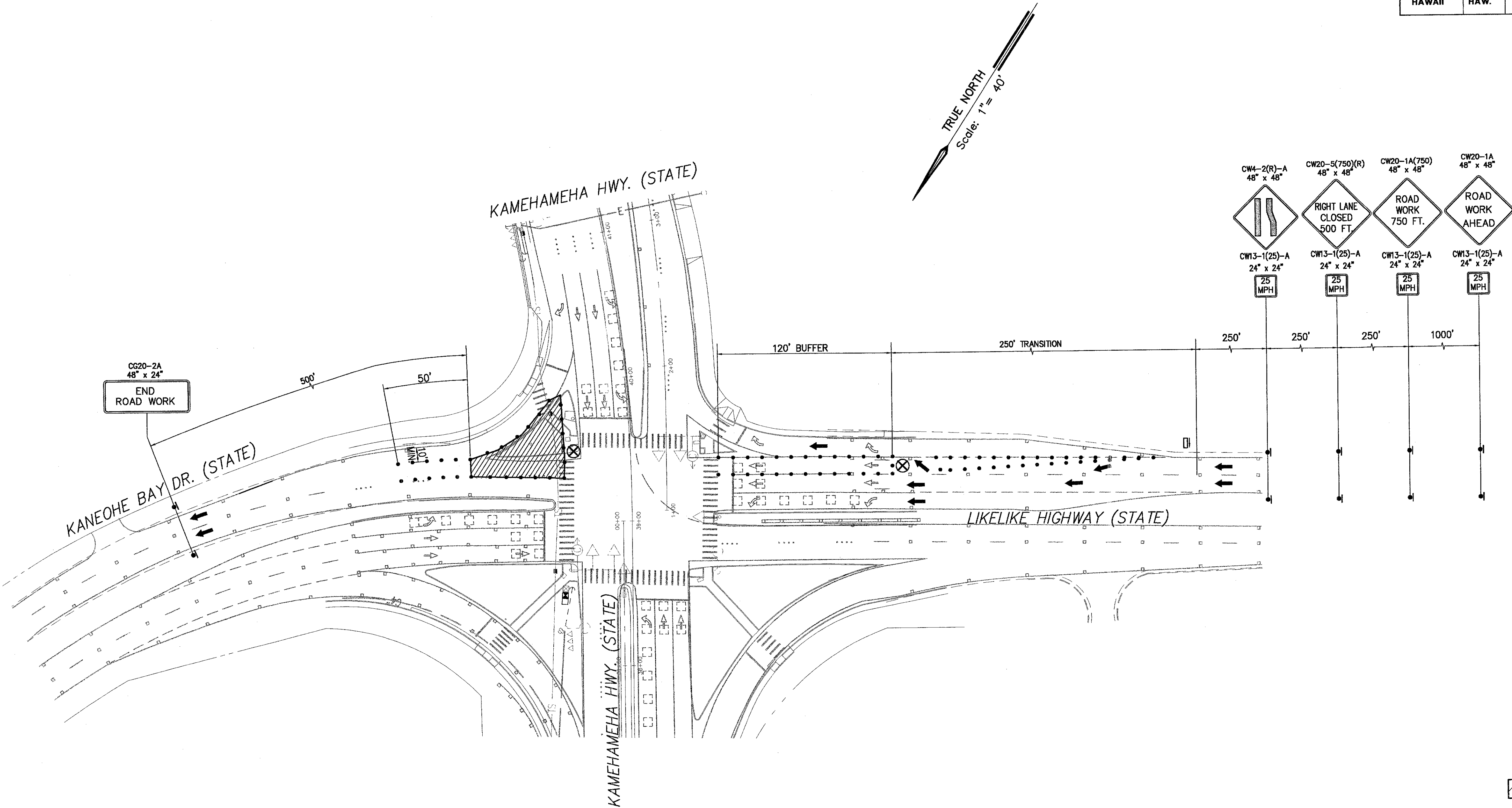

TRAFFIC CONTROL PLAN  
(KAMEHAMEHA - LIKELIKE INTERSECTION)-6

- LEGEND:
- Construction Sign
  - Cones or Flexible Tubular Markers
  - Work Area
  - Direction of Traffic
  - Flagman
  - Police Officer
  - Flashing Arrow Signal

REVISION

DATE

BRIEF

BY

APPROVED

DEPARTMENT OF TRANSPORTATION SERVICES  
CITY AND COUNTY OF HONOLULU  
JOB NO.  
COMPUTERIZED TRAFFIC CONTROL SYSTEM  
PHASE 9  
TRAFFIC CONTROL PLAN  
KAMEHAMEHA/KANEOHE BAY - LIKELIKE INTERSECTION-6

ENGINEER

TSW

DATE

MARCH 2007

DRAFTSMAN

TSW

SCALE

CHK. BY

KSU

REF.

APPROVED:

DIRECTOR

DIVISION ENGINEER

KEITH S. UEMURA  
LICENSED PROFESSIONAL ENGINEER  
No. 7472-C  
HAWAII, U.S.A.

THIS WORK WAS PREPARED BY ME OR UNDER MY SUPERVISION AND CONSTRUCTION OF THIS PROJECT WILL BE UNDER MY OBSERVATION

*Keith S. Uemura*  
PAPER, INC.  
dba PARK ENGINEERING  
EXPIRES 4/30/08

Sheet No. 29 of 41 Sheets C-29



FED. ROAD DIST. NO.	STATE	FED. AID PROJ. NO.	FISCAL YEAR	SHEET NO.	TOTAL SHEETS
HAWAII	HAW.	STP-0001 (30)	2007	78	89

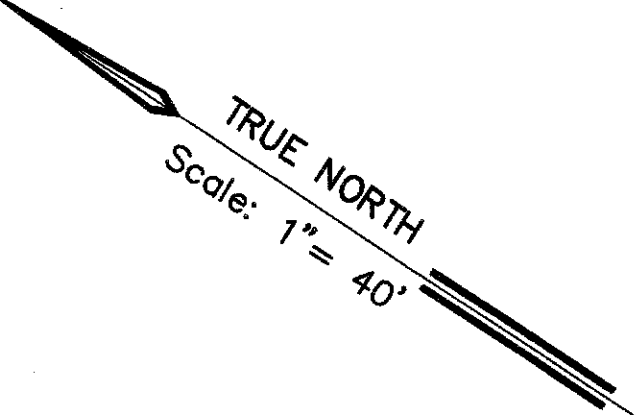
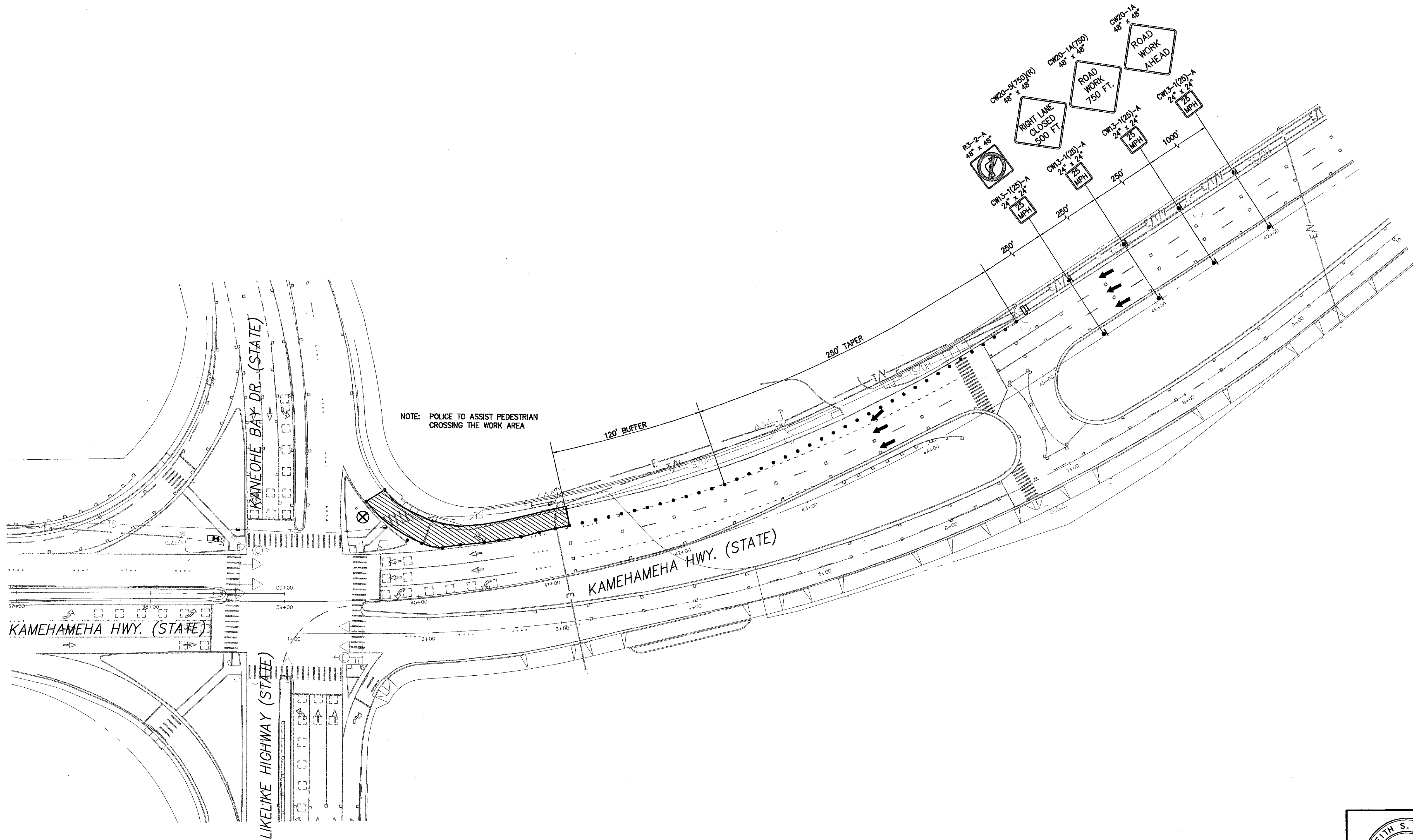

- LEGEND:
- CONSTRUCTION SIGN
  - CONES OR FLEXIBLE TUBULAR MARKERS
  - WORK AREA
  - DIRECTION OF TRAFFIC
  - FLAGMAN
  - POLICE OFFICER
  - FLASHING ARROW SIGNAL

TRAFFIC CONTROL PLAN  
(KAMEHAMEHA - LIKELIKE INTERSECTION)-7

REVISION	DATE	BRIEF	BY	APPROVED

THIS WORK WAS PREPARED BY ME OR UNDER MY SUPERVISION AND CONSTRUCTION OF THIS PROJECT WILL BE UNDER MY OBSERVATION

Keith S. Uemura  
Professional Engineer  
No. 7472-C  
HAWAII, U.S.A.

DEPARTMENT OF TRANSPORTATION SERVICES  
CITY AND COUNTY OF HONOLULU  
JOB NO.  
COMPUTERIZED TRAFFIC CONTROL SYSTEM  
PHASE 9  
TRAFFIC CONTROL PLAN  
KAMEHAMEHA/KANEOHE BAY - LIKELIKE INTERSECTION-7

ENGINEER TSW DATE MARCH 2007  
DRAFTSMAN TSW SCALE  
CHK. BY KSU REF.  
APPROVED: APPROVED  
DIRECTOR DIVISION ENGINEER

FILE	PROJECT	FOLDER	FILE