

FED. ROAD DIST. NO.	STATE	FED. AID PROJ. NO.	FISCAL YEAR	SHEET NO.	TOTAL SHEETS
HAWAII	HAW.	STP-0001 (30)	2007	62	89

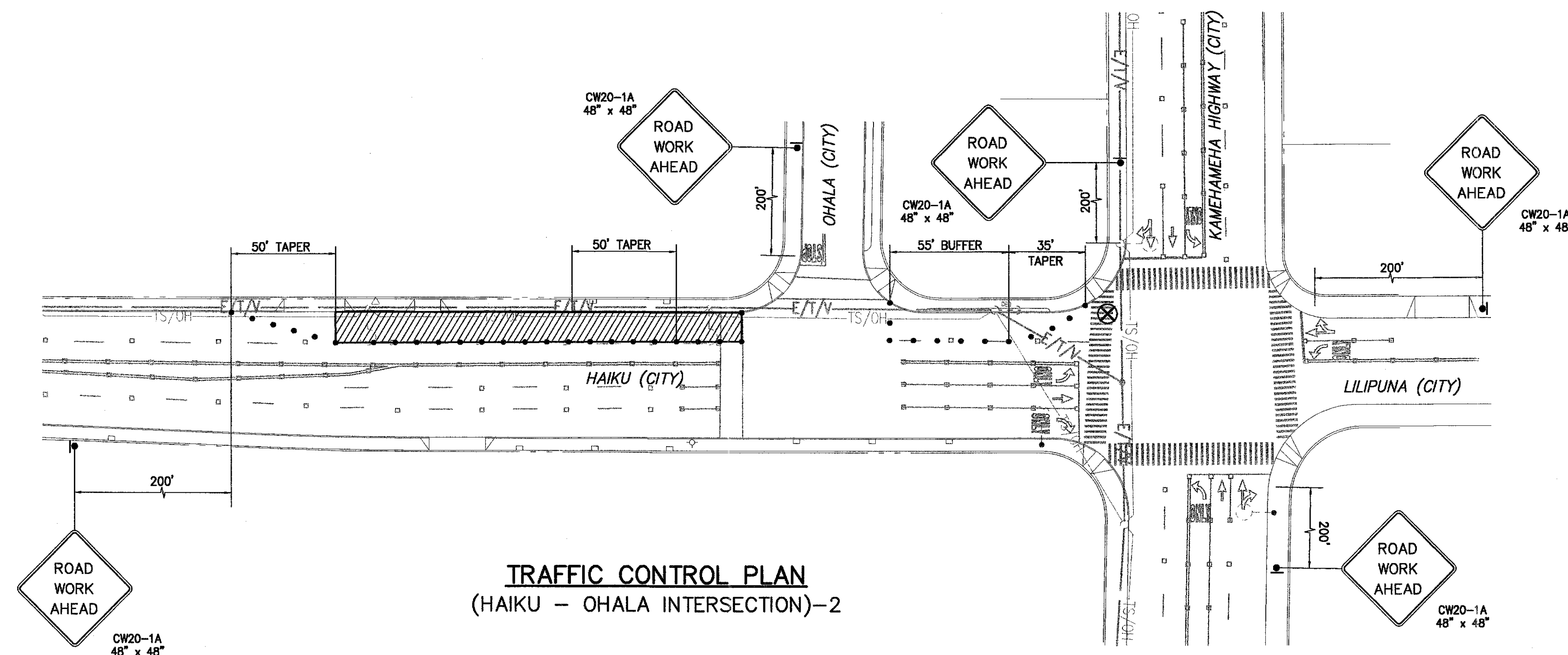

TRUE NORTH
Scale: 1" = 40'

- LEGEND:**
- ◻ CONSTRUCTION SIGN
 - CONES OR FLEXIBLE TUBULAR MARKERS
 - ▨ WORK AREA
 - ← DIRECTION OF TRAFFIC
 - ⚓ FLAGMAN
 - ⊗ POLICE OFFICER
 - ⏏ FLASHING ARROW SIGNAL

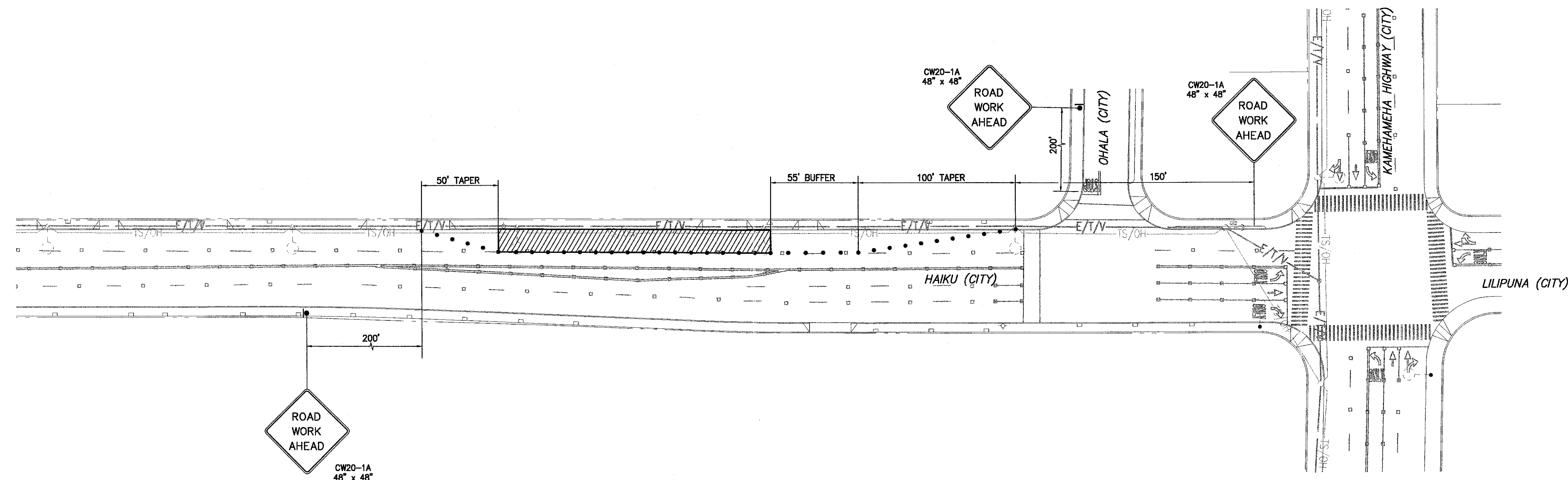

TRUE NORTH
Scale: 1" = 40'

TRAFFIC CONTROL PLAN
(HAIKU)-1

APPROVED:

DATE:

CHIEF, TRAFFIC REVIEW BRANCH, DPP

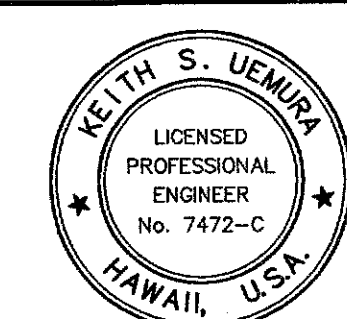

THIS WORK WAS PREPARED BY ME OR UNDER MY SUPERVISION AND CONSTRUCTION OF THIS PROJECT WILL BE UNDER MY OBSERVATION
Keith S. Uemura
P.E., Inc.
380 PARK ENGINEERING
EXPIRES 4/30/08

DEPARTMENT OF TRANSPORTATION SERVICES
CITY AND COUNTY OF HONOLULU
JOB NO.
COMPUTERIZED TRAFFIC CONTROL SYSTEM
PHASE 9
TRAFFIC CONTROL PLAN
HAIKU - OHALA INTERSECTION

ENGINEER: TSW DATE: MARCH 2007
DRAFTSMAN: TSW SCALE:
CHK. BY: KSU REF.
APPROVED: APPROVED:
DIRECTOR: DIVISION ENGINEER