

FED. ROAD DIST. NO.	STATE	FED. AID PROJ. NO.	FISCAL YEAR	SHEET NO.	TOTAL SHEETS
HAWAII	HAW.	STP-0001 (30)	2007	46	89

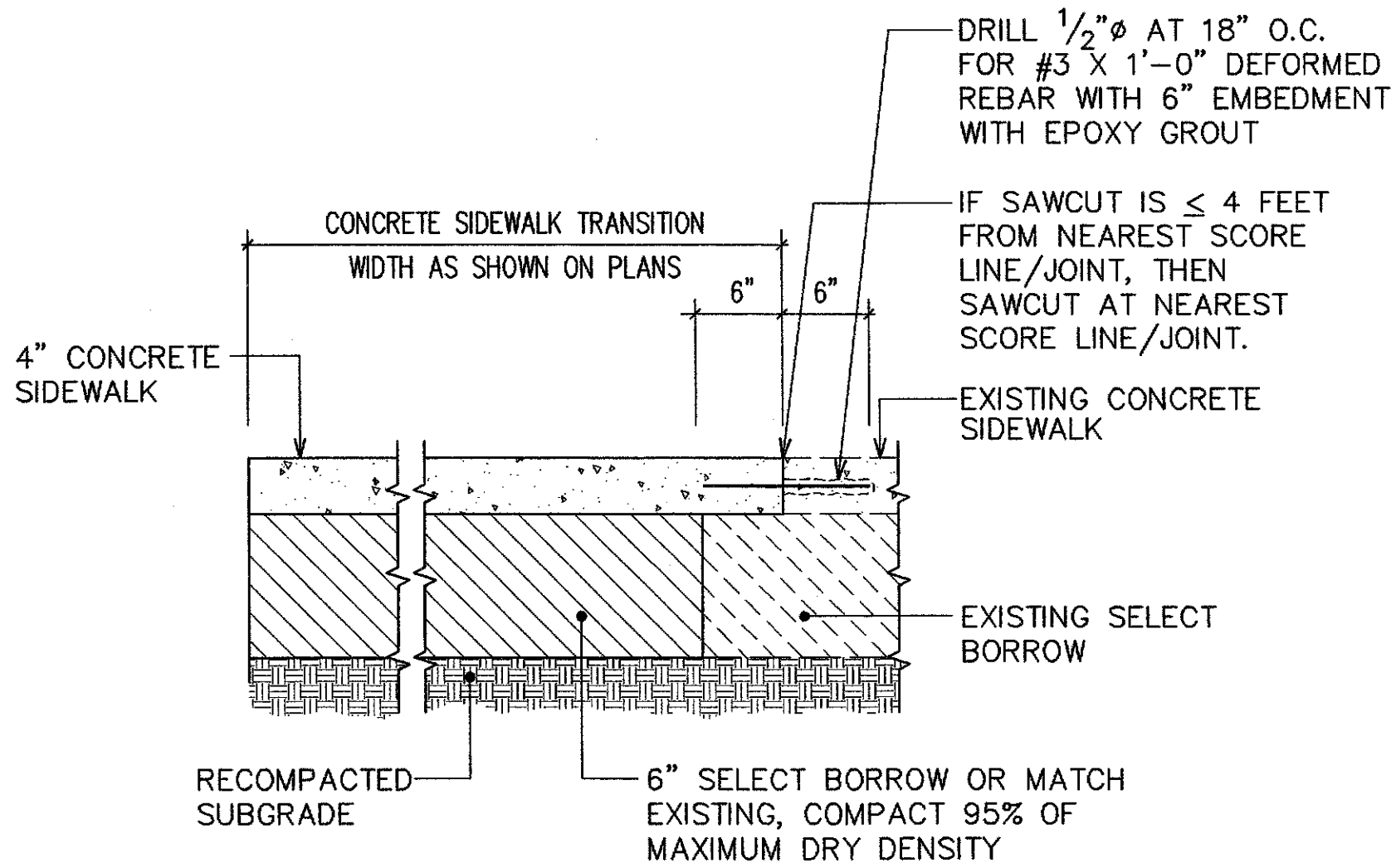

NOTES:

1. FOLLOW DOT STANDARD PLAN D-14, CONCRETE SIDEWALK.

CONCRETE SIDEWALK TRANSITION  
(WITHIN STATE RIGHT OF WAY)

NOT TO SCALE

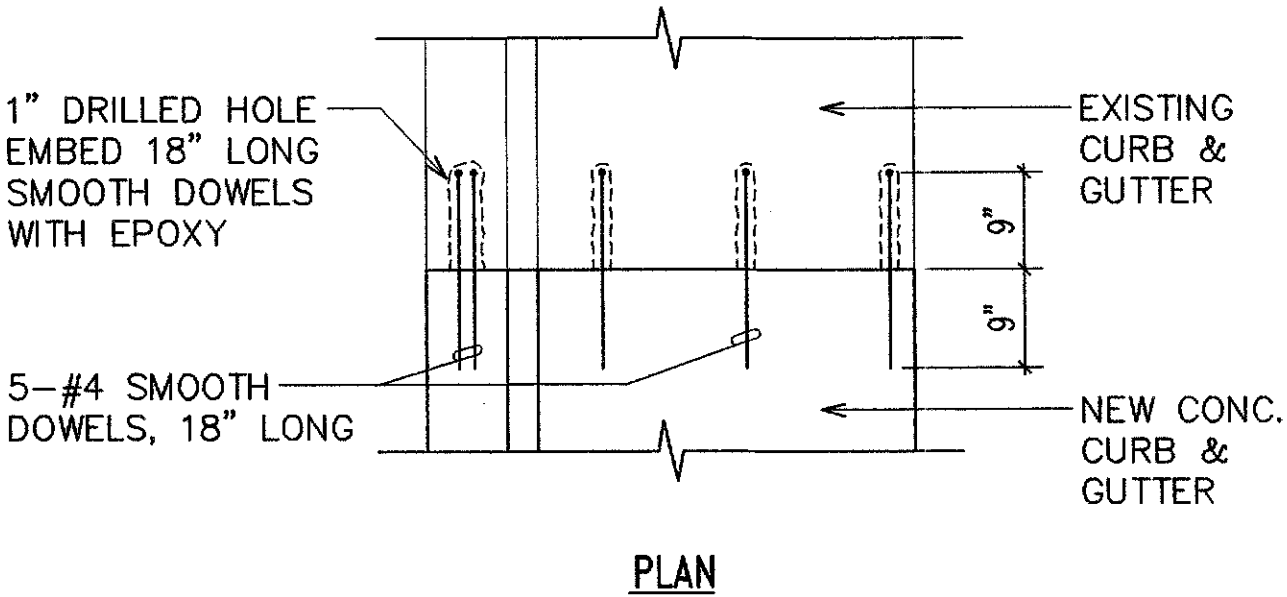

NOTES:

1. FOR ROAD GRADES 0% TO 7.99% AND PRIME COAT UNAVAILABLE, NONE REQUIRED. IF PRIME COAT AVAILABLE, USE IT.
2. FOR RESTORATION OF MEDIAN CURB, FOLLOW THE SAME DETAIL WITHOUT GUTTER.
3. FOLLOW DOT STANDARD PLAN D-04, TYPICAL DETAILS OF CURBS AND/OR GUTTERS.

RESTORATION OF REINFORCED CURB & GUTTER  
(WITHIN STATE RIGHT OF WAY)

NOT TO SCALE

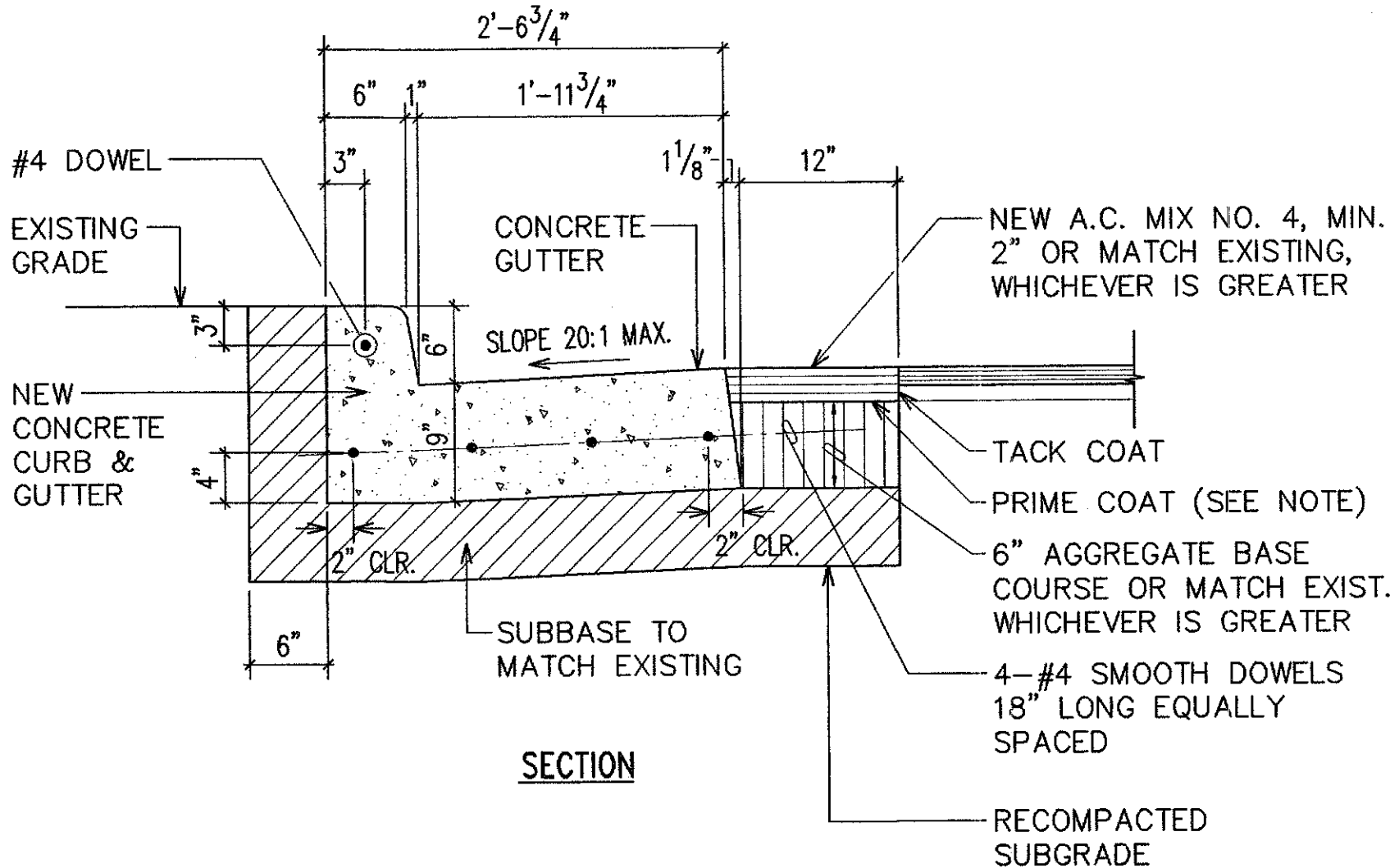

INSTALLATION NOTES:

1. ALL WORK PERFORMED SHALL BE SBUJECT TO INSPECTION BY THE STATE AND SHALL BE TO THE STATE'S SATISFACTION.
2. CONSTRUCT THE TRENCH RESTORATION IN ACCORDANCE WITH TH THE HAWAII STANDARD SPECIFICATIONS FOR ROAD, BRIDGE, AND PUBLIC WORKS CONSTRUCTION AND ITS SPECIAL PROVISIONS, AND THE SPECIFICATION OF INSTALLATION OF MISCELLANEOUS IMPROVEMENTS WITHIN STATE HIGHWAYS.
3. PAVEMENT SMOOTHNESS:
  - a. OBTAIN A PROFILE OF THE EXISTING ROADWAY SURFACE THAT IS TO HAVE A NEW SURFACE AS A RESULT OF THE RESTORATION OF THE TRENCH EXCAVATION AND SUBMIT THE PROFILE TO DISTRICT ENGINEER BEFORE ANY WORK FOR TRENCH EXCAVATION BEGINS.
  - b. OBTAIN A PROFILE OF THE ROADWAY SURFACE AFTER THE ROADWAY SURFACE HAS BEEN REPAVED AND SUBMIT THE PROFILE TO THE DISTRICT ENGINEER. THE PROFILE OF THE ROADWAY SURFACE AFTER REPAVING SHALL BE EQUAL TO OR SMOOTHER THAN THE PROFILE OBTAINED BEFORE TRENCH EXCAVATION BEGAN.
  - c. THE DISTANCE FROM THE PAVED SURFACE TO THE TESTING EDGE OF A TEN-FOOT LONG STRAIGHT EDGE BETWEEN TWO POINTS OF CONTACT SHALL NOT EXCEED 3/16 INCH.
4. PLACE ALL UNBOUND MATERIALS IN THE TRENCH AS FOLLOWS:
  - a. COMPACTION BY WATER JETTING OR PONDING IS NOT PERMITTED.
  - b. ALL UNBOUND MATERIALS, EXCEPT THE PERMEABLE BASE AND ASTM C-33 SIZE 67 SHALL BE PLACED IN ACCORDANCE WITH SUBSECTION 206.03(E) STRUCTURE AND TRENCH BACKFILL OF THE HAWAII STANDARD SPECIFICATIONS FOR ROAD, BRIDGE, AND PUBLIC WORKS CONSTRUCTION. TAKE ONE COMPACTION TEST FOR EACH 300 LINEAL FEET OF TRENCH. SUBMIT COMPACTION TEST RESULTS TO THE DISTRICT ENGINEER.
  - c. PERMEABLE BASE: PLACE PERMEABLE MATERIAL IN UNIFORM LAYER NOT EXCEEDING 9 INCHES IN COMPACTED THICKNESS. COMPACT EACH LAYER WITH 8 PASSES OF A VIBRATING PLATE COMPACTOR. USE HAND TAMPER IF TRENCH IS TOO NARROW TO ACCOMODATE THE VIBRATING PLATE COMPACTOR.
  - d. ASM C-33, SIZE 67: MATERIAL PLACED UNDER WATER NEED NOT BE COMPACTED. MATERIAL PLACED ABOVE WATER SHALL BE PLACED IN A UNIFORM HORIZONTAL LAYER NOT EXCEEDING 9 INCHES IN LOOSE THICKNESS. COMPACT EACH LAYER WITH 8 PASSES OF A VIBRATING PLATE COMPACTOR. USE HAND TAMPER IF TRENCH IS TOO NARROW TO ACCOMODATE THE VIBRATING PLATE COMPACTOR.

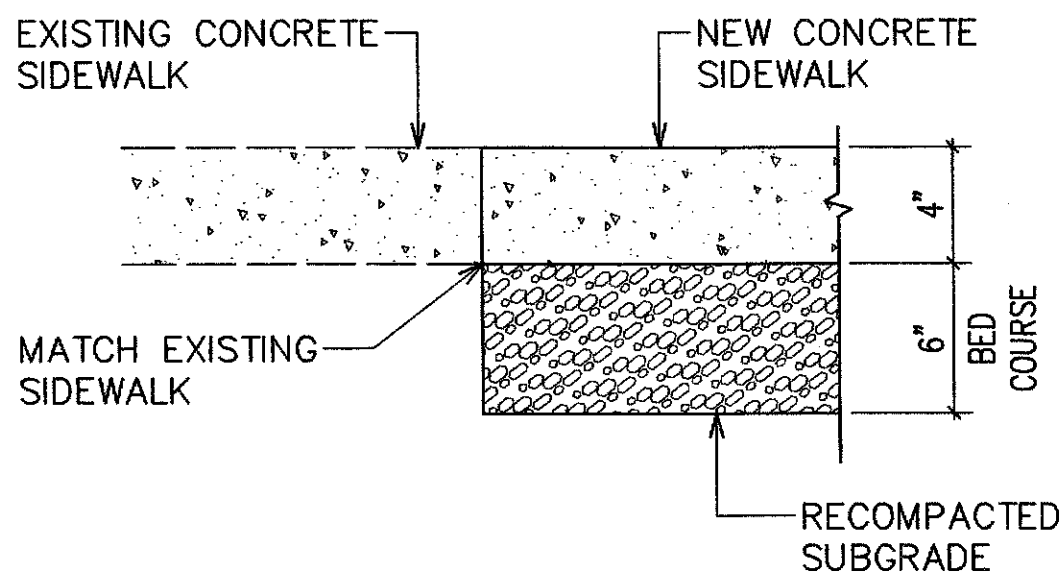

TYPICAL CONSTRUCTION JOINT  
AT EXISTING SIDEWALK  
(WITHIN CITY RIGHT OF WAY)

NOT TO SCALE

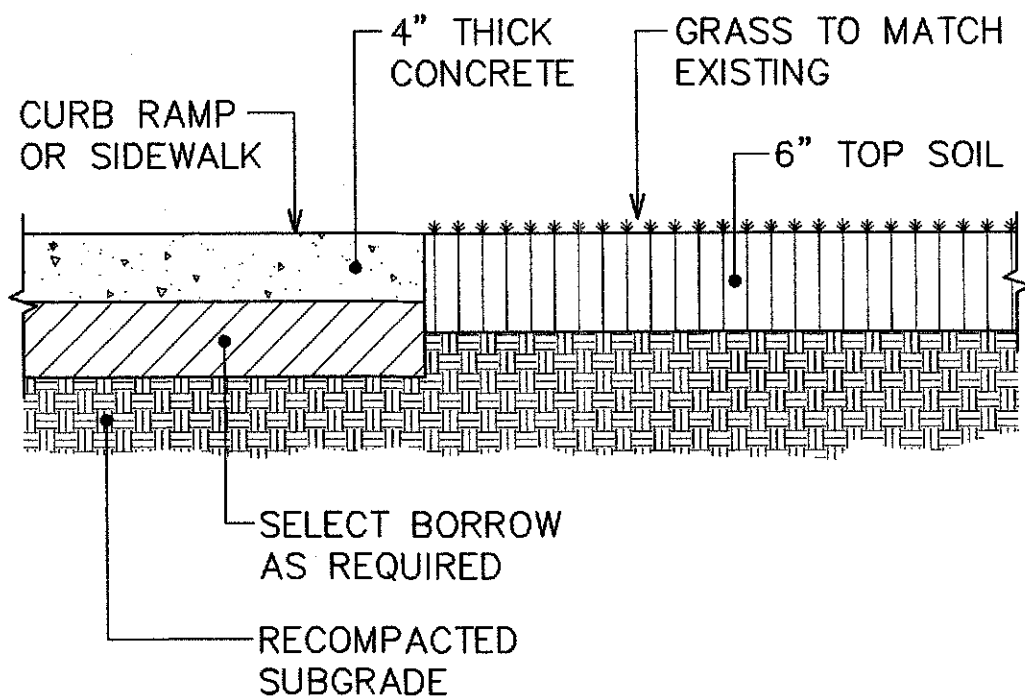

TYPICAL GRASS RESTORATION

NOT TO SCALE

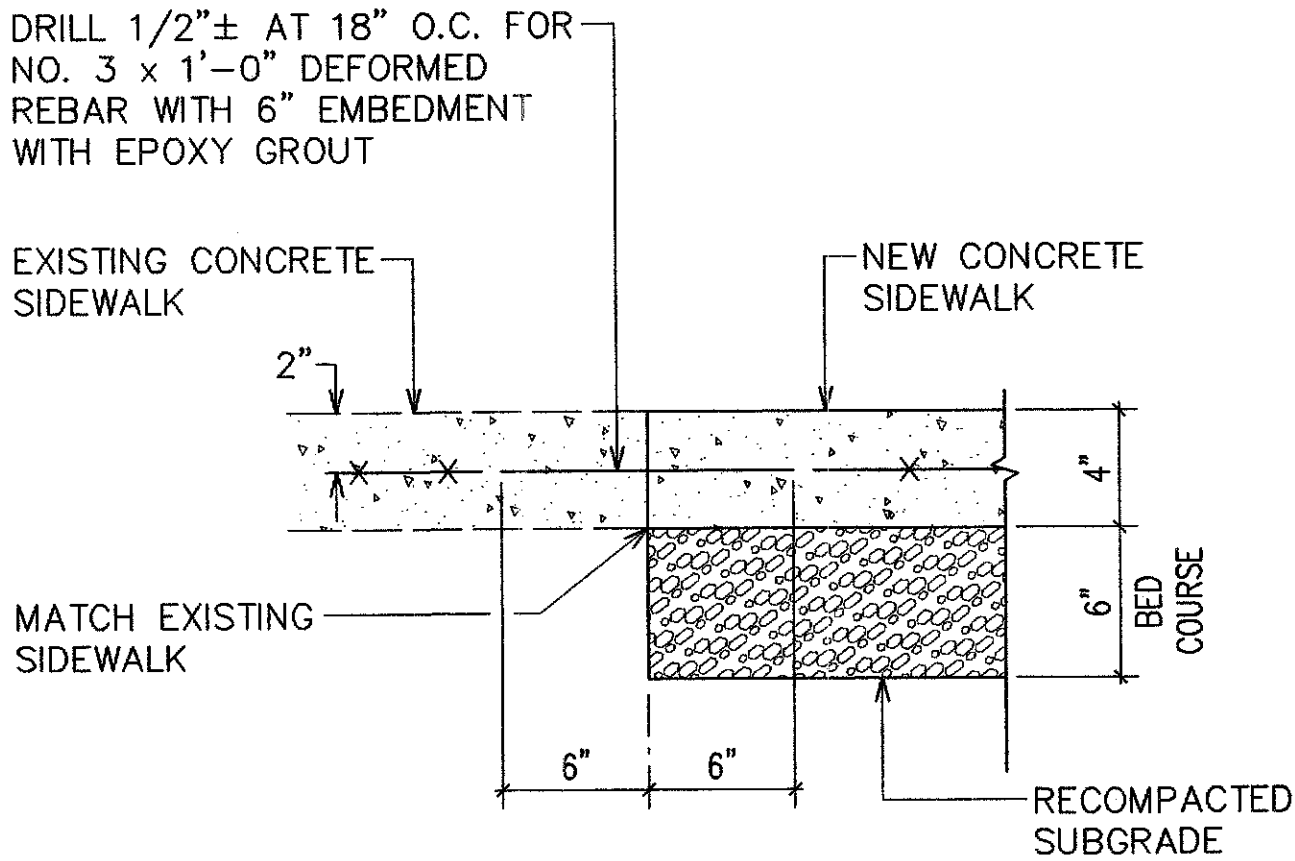

TYPICAL CONSTRUCTION JOINT  
AT EXISTING SIDEWALK  
(WITHIN STATE RIGHT OF WAY)

NOT TO SCALE

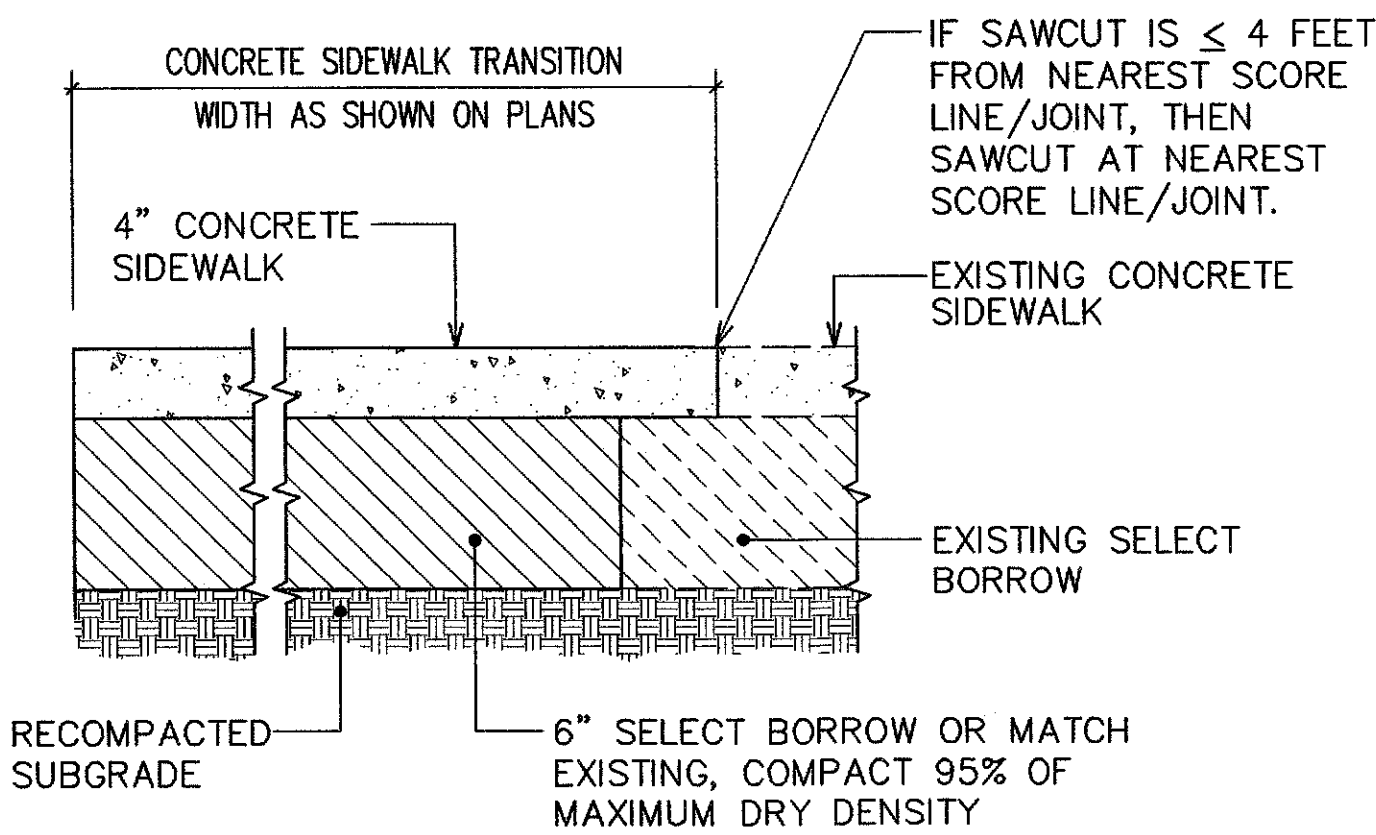

CONCRETE SIDEWALK TRANSITION  
(WITHIN CITY RIGHT OF WAY)

NOT TO SCALE

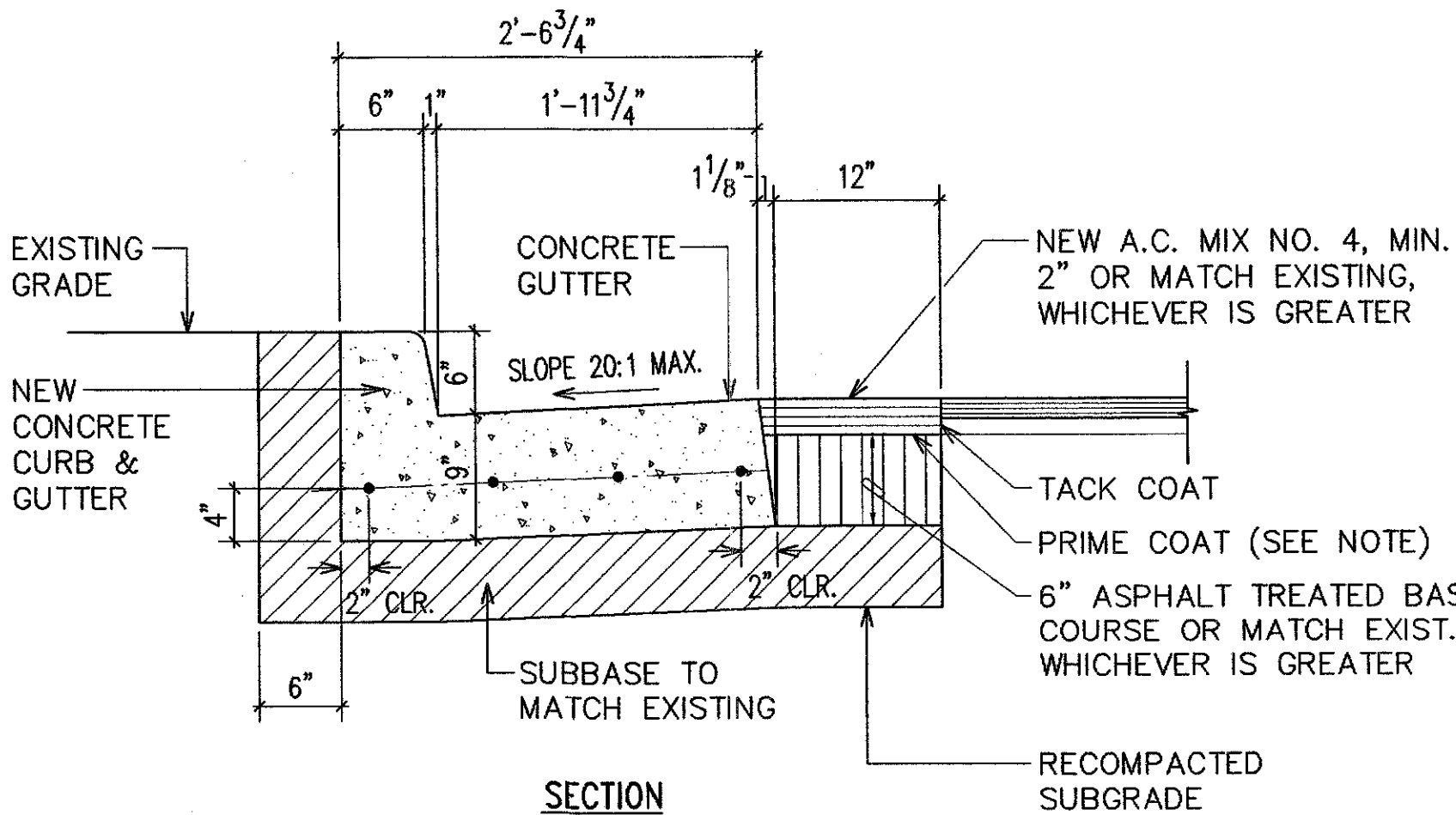

RESTORATION OF REINFORCED CURB & GUTTER  
(WITHIN CITY RIGHT OF WAY)

NOT TO SCALE

REVISION	DATE	BRIEF	BY	APPROVED

THIS WORK WAS PREPARED BY ME OR UNDER MY SUPERVISION

*Steven H. Saki*

LIC. EXPIRATION: 4/30/08

DEPARTMENT OF TRANSPORTATION SERVICES  
CITY AND COUNTY OF HONOLULU  
FEDERAL AID NO. STP-0001(30)  
COMPUTERIZED TRAFFIC CONTROL SYSTEM  
PHASE 9

RESTORATION DETAILS

ENGINEER: GTN DATE: MARCH 2007  
DRAFTSMAN: SS SCALE: AS NOTED  
CHK. BY: REF:  
APPROVED: APPROVED:  
DIVISION ENGINEER: