

FED. ROAD DIST. NO.	STATE	PROJ. NO.	FISCAL YEAR	SHEET NO.	TOTAL SHEETS
HAWAII	HAW.	HWY-0-03-97	2000	7	110

KANEOHE DISTRICT PARK
OWNER: C&C OF HONOLULU
TMK: 4-5-23:10

TRUE NORTH
SCALE: 1" = 20'

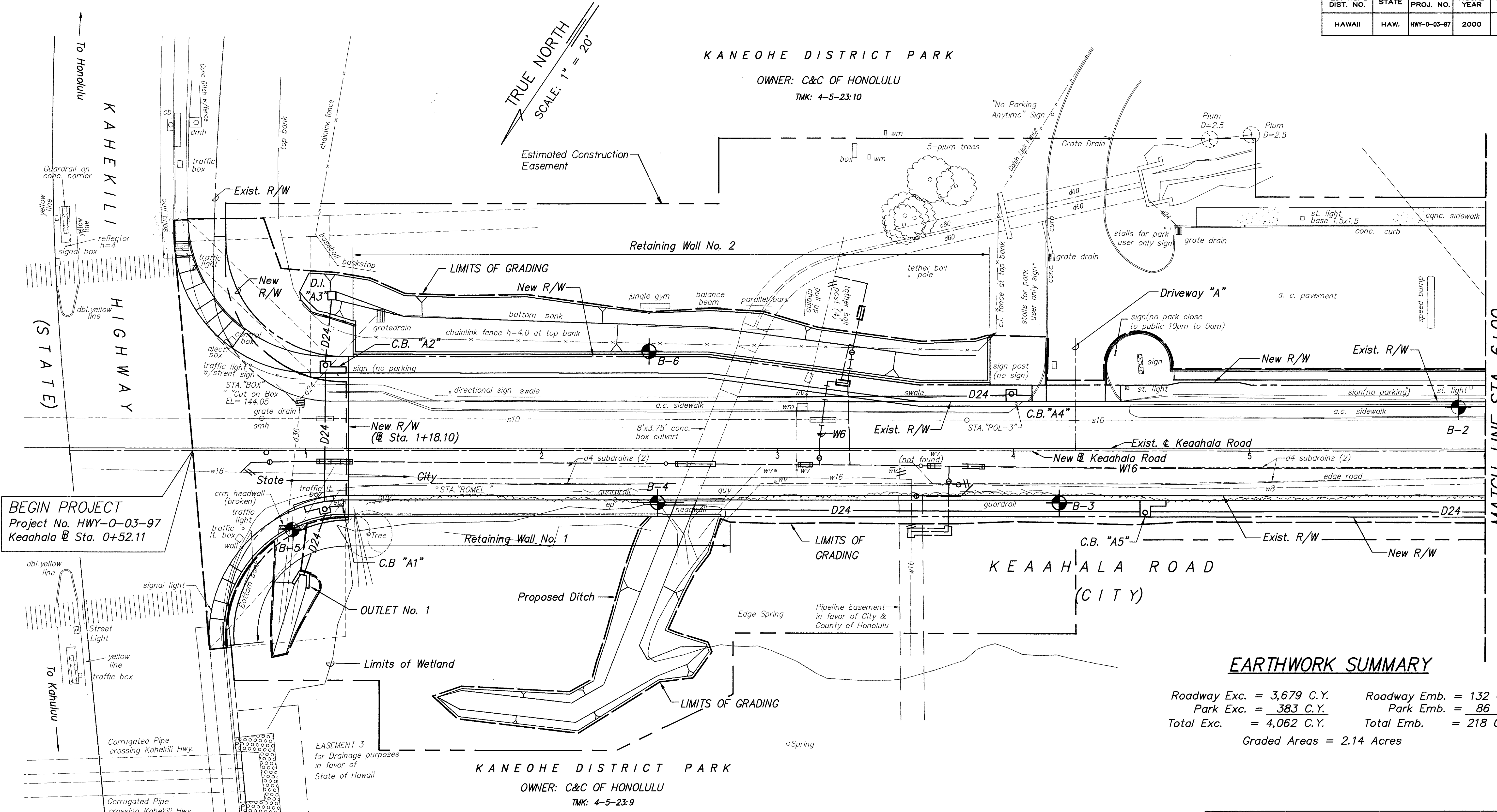

BEGIN PROJECT
Project No. HWY-0-03-97
Kealahala @ Sta. 0+52.11

EARTHWORK SUMMARY

Roadway Exc. = 3,679 C.Y.	Roadway Emb. = 132 C.Y.
Park Exc. = 383 C.Y.	Park Emb. = 86 C.Y.
Total Exc. = 4,062 C.Y.	Total Emb. = 218 C.Y.
Graded Areas = 2.14 Acres	

KANEOHE DISTRICT PARK
OWNER: C&C OF HONOLULU
TMK: 4-5-23:9

LEGEND

- Boring Locations (see Sheet 9 for boring logs)
- Limits of Grading

GENERAL PLAN

SCALE: 1" = 20'

APPROVED:

Chief, Civil Engineering Branch
Department of Planning & Permitting
City & County of Honolulu

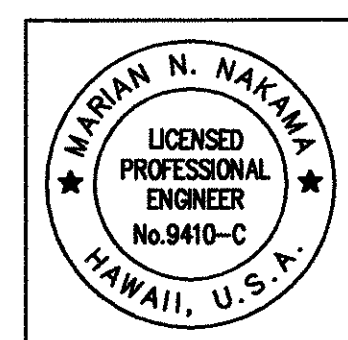
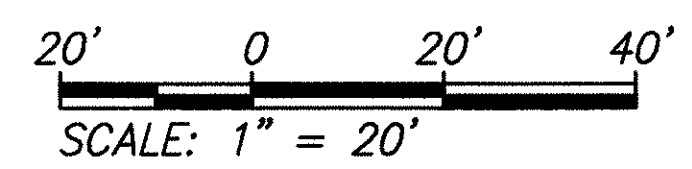

STATE OF HAWAII
DEPARTMENT OF TRANSPORTATION
HIGHWAYS DIVISION
GENERAL PLAN
BEGIN TO STA. 6+00
KEAAHALA ROAD WIDENING
KAHEKILII HIGHWAY TO PO'OKELA STREET
State Project No. HWY-0-03-97
Scale: As shown Date: April 2000
SHEET NO. C-7 OF C-55 SHEETS

FILE: DOT95110
SCALE: 1"=20'
DATE: 5/3/97

DATE: _____
DRAWN BY: _____
CHECKED BY: _____

DATE	_____
DRAWN BY	_____
CHECKED BY	_____
ORIGINAL PLAN	_____
NO.	_____

MATCH-LINE STA. 6+00

FED. ROAD DIST. NO.	STATE	PROJ. NO.	FISCAL YEAR	SHEET NO.	TOTAL SHEETS
HAWAII	HAW.	HWY-0-03-97	2000	8	110

TRUE NORTH
SCALE: 1" = 20'

KANEOHE DISTRICT PARK
OWNER: C&C OF HONOLULU
TMK: 4-5-23:10

KANEOHE STATE HOSPITAL
OWNER: STATE OF HAWAII
PARCEL 3
TMK: 4-5-23:2

STATE OF HAWAII
OWNER: (WINDWARD COMMUNITY COLLEGE)
TMK: 4-5-23:14

MATCH-LINE STA. 6+00

PM: STY 146'
OPER: SAI *RCGMN/MSM
REVISED: 04/26/00

FILE: DOT95149
SCALE: 1"=20'
BEG: 5/3/97

DATE	
SURVEY PLOTTED BY	
TRACES BY	
DESIGNED BY	
QUANTITIES BY	
CHECKED BY	
ORIGINAL PLAN	
NOTEBOOK	
No.	

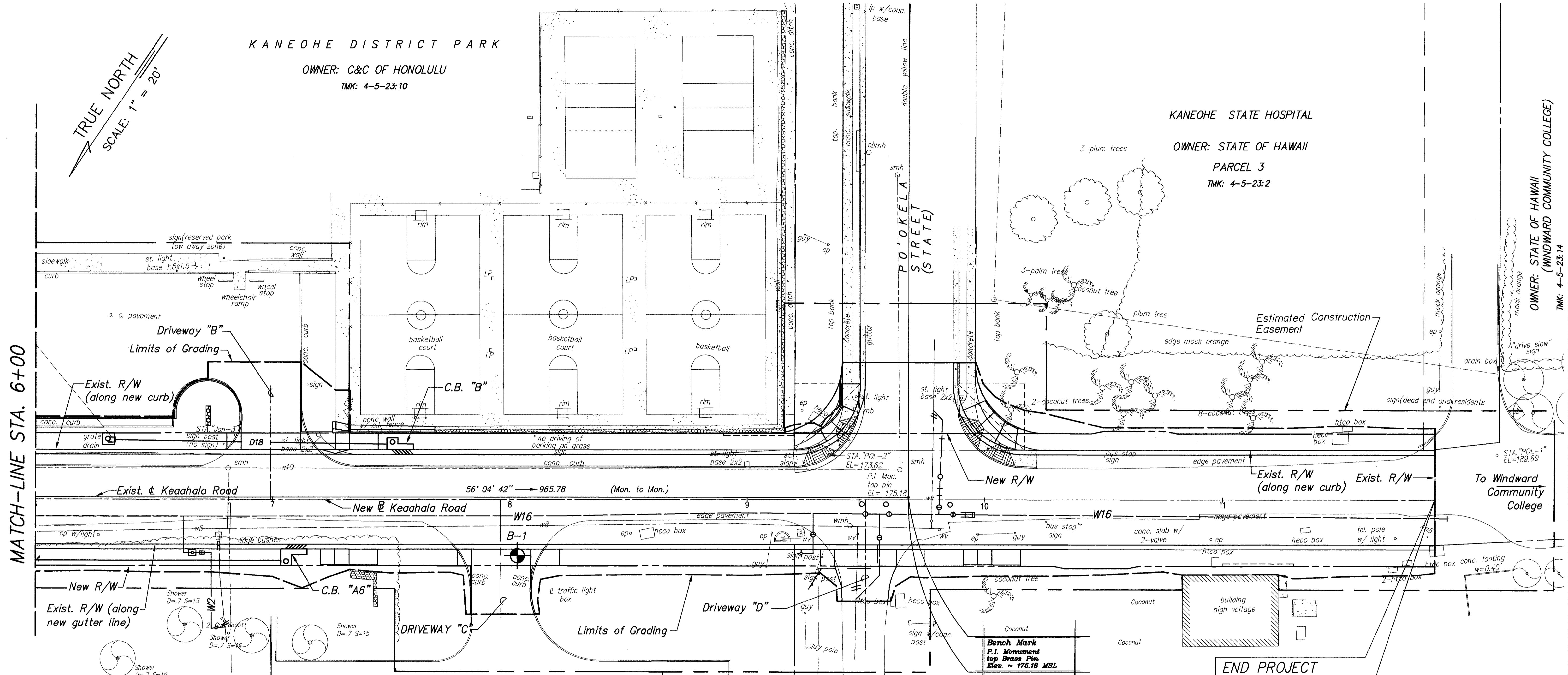

GENERAL PLAN
SCALE: 1" = 20'

KANEOHE DISTRICT PARK
OWNER: C&C OF HONOLULU
TMK: 4-5-23:9

END PROJECT
Project No. HWY-0-03-97
Keahala Sta. 11+89.54

OWNER: STATE OF HAWAII
TMK: 4-5-23:15

LEGEND

- Boring Locations (see Sheet 9 for boring logs)
- Limits of Grading

APPROVED:
M. [Signature] 5/4/00
Chief, Civil Engineering Branch
Department of Planning & Permitting
City & County of Honolulu

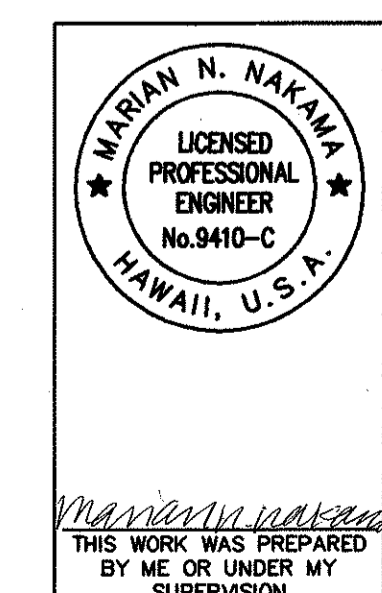
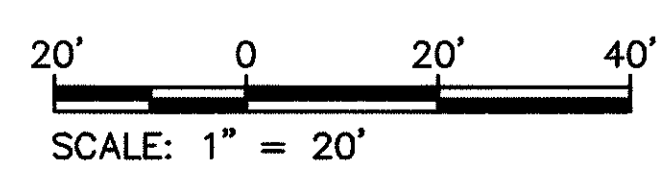

STATE OF HAWAII
DEPARTMENT OF TRANSPORTATION
HIGHWAYS DIVISION
GENERAL PLAN
STA. 6+00 TO END
KAAHALA ROAD WIDENING
KAHEKILI HIGHWAY TO PO'OKELA STREET
State Project No. HWY-0-03-97
Scale: As shown Date: April 2000
SHEET NO. C-8 OF C-55 SHEETS