

FED. ROAD DIST. NO.	STATE	FED. AID PROJ. NO.	FISCAL YEAR	SHEET NO.	TOTAL SHEETS
HAWAII	HAW.	NH-083-1(60)	2007	34	90

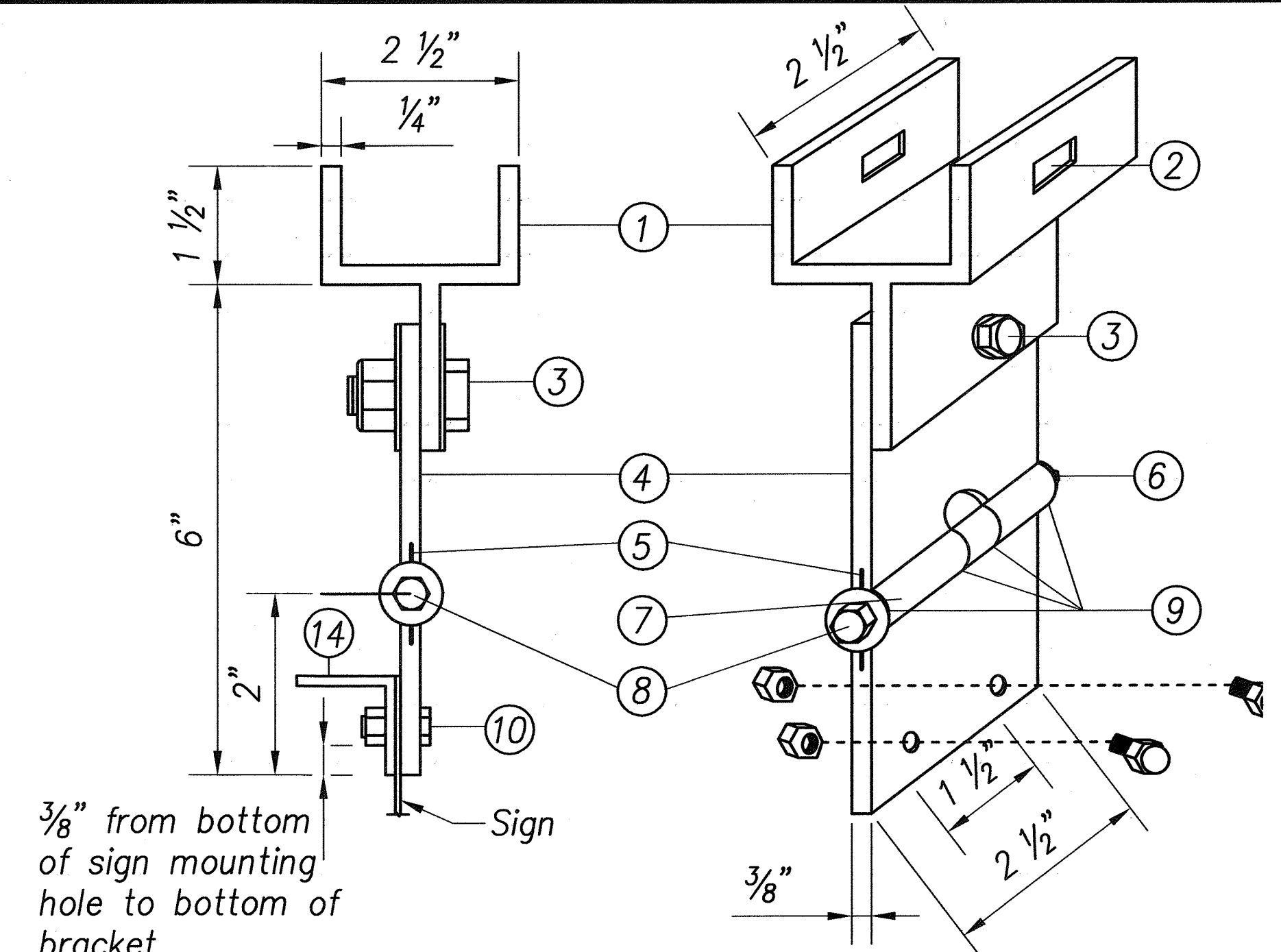

- ① Pivotal Upper Bracket
- ② 1 5/8" x 1/4" Slat for double strapping to electrolier mast arm (M2G-34S(HD) .030" x 3/4" Heavy Duty Stainless Steel Strap with M2G-34B(HD) Buckle recommended)
- ③ 1/2" - 13 x 1 1/2" Stainless Steel Hex Head Bolt with Stainless Steel Hex Lock Nut and 1/16" Stainless Steel Washer (both sides). Allows upper bracket to pivot and align with electrolier mast arm.
- ④ 6" Overall drop with Fixed Length Sign Bracket
- ⑤ Stainless Steel Damper Spring (Removable).
- ⑥ Stainless Steel Hex Lock Nut with 1/16" Stainless Steel Washer.
- ⑦ 1" O.D. Axle Housing
- ⑧ 1/2" - 13 x 4" Stainless Steel Hex Head Bolt with 1/16" Stainless Steel Washer.
- ⑨ Ollite Bushing
- ⑩ Sign Mounting Sets, consisting of two each 5/16" - 18 x 1" Stainless Steel Hex Head Bolt with Stainless Steel Hex lock Nut. Two holes on 1 1/2" centers provide positive lock sign mounting to brackets
- ⑪ 8 1/4" overall length Upper Adjustable Sign Bracket section.
- ⑫ 9" overall length Lower Adjustable Sign Bracket section including Axle Housing (8" overall length to top of Axle Housing).
- ⑬ 1/2" - 13 x 1 1/2" Stainless Steel Hex Bolt with Stainless Steel Hex Lock Nut and 1/16" Stainless Steel Washers (both sides). Loosen lock nut, adjust bracket teeth to level sign.
- ⑭ 1 1/4" x 1 1/4" x 1/8" Aluminum Angle.

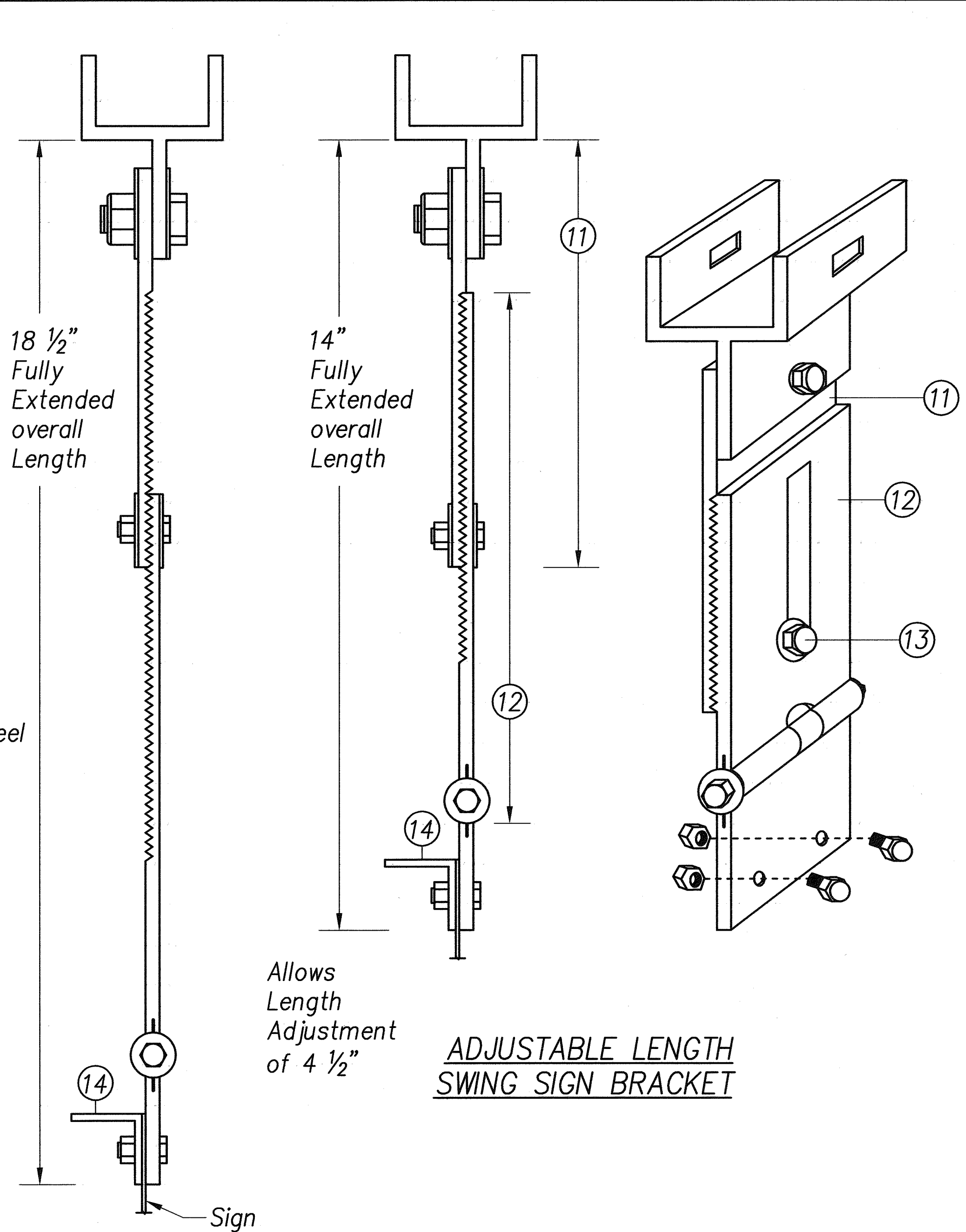

The contractor shall install new swing sign bracket at the midpoint of the two existing swing sign brackets

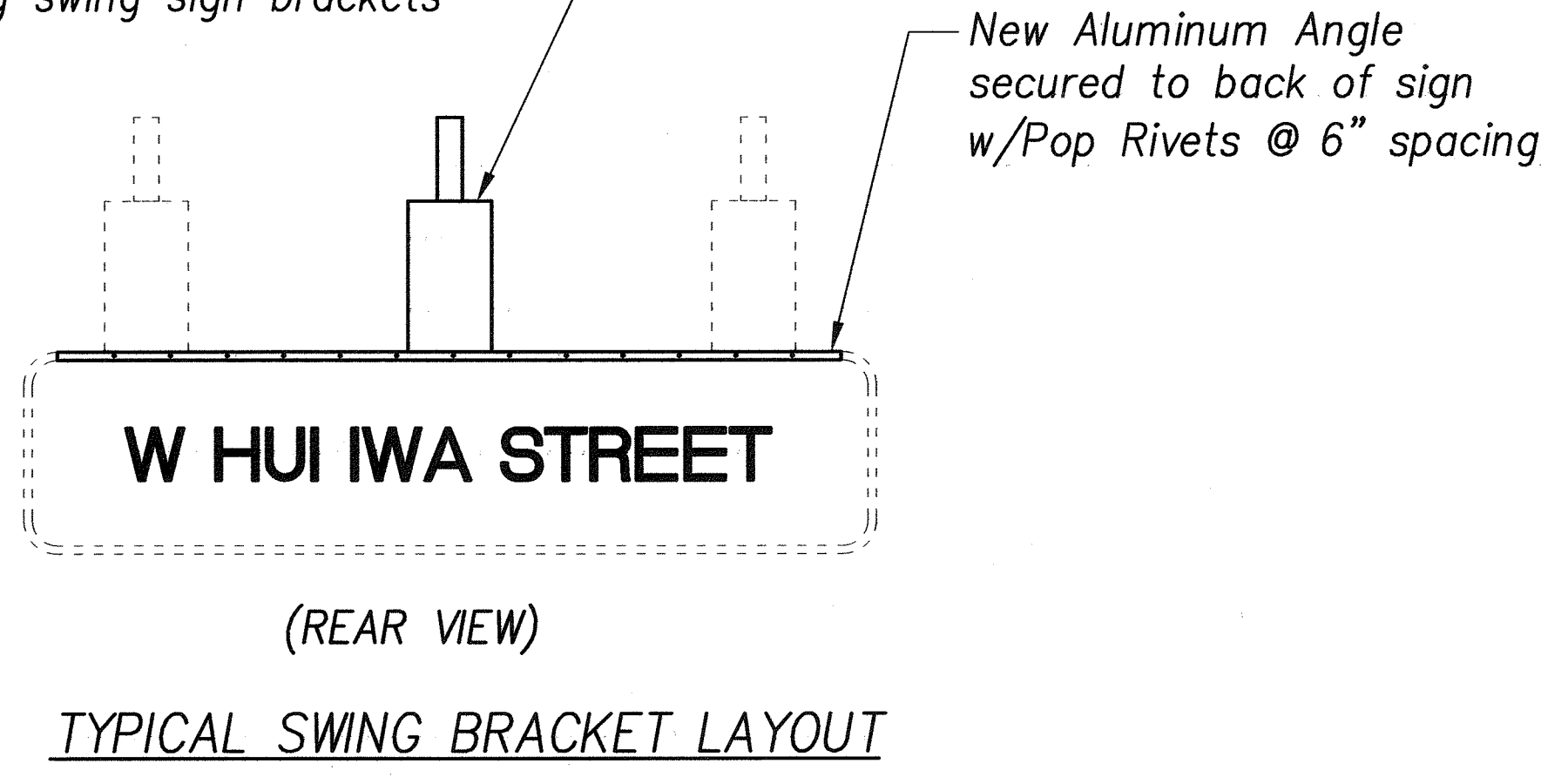

NOTES:

1. The Contractor shall relocate the existing Street Name Sign onto the new Traffic Signal Mast Arm using the two (2) existing Swing Sign Brackets and an additional Swing Sign Bracket with Aluminum Angle on the following existing Street Name Sign. Each relocated sign shall have three (3) Swing Sign Brackets (2 existing & 1 new).
2. The Swing Sign Brackets w/Aluminum Angle shall be paid under Item No. 630.0150 Relocating Existing Street Name Sign on Traffic Signal Mast Arm.

Street Name	No. of Signs	No. of Brackets w/Aluminum Angle
HUI IWA STREET (West)	2	2

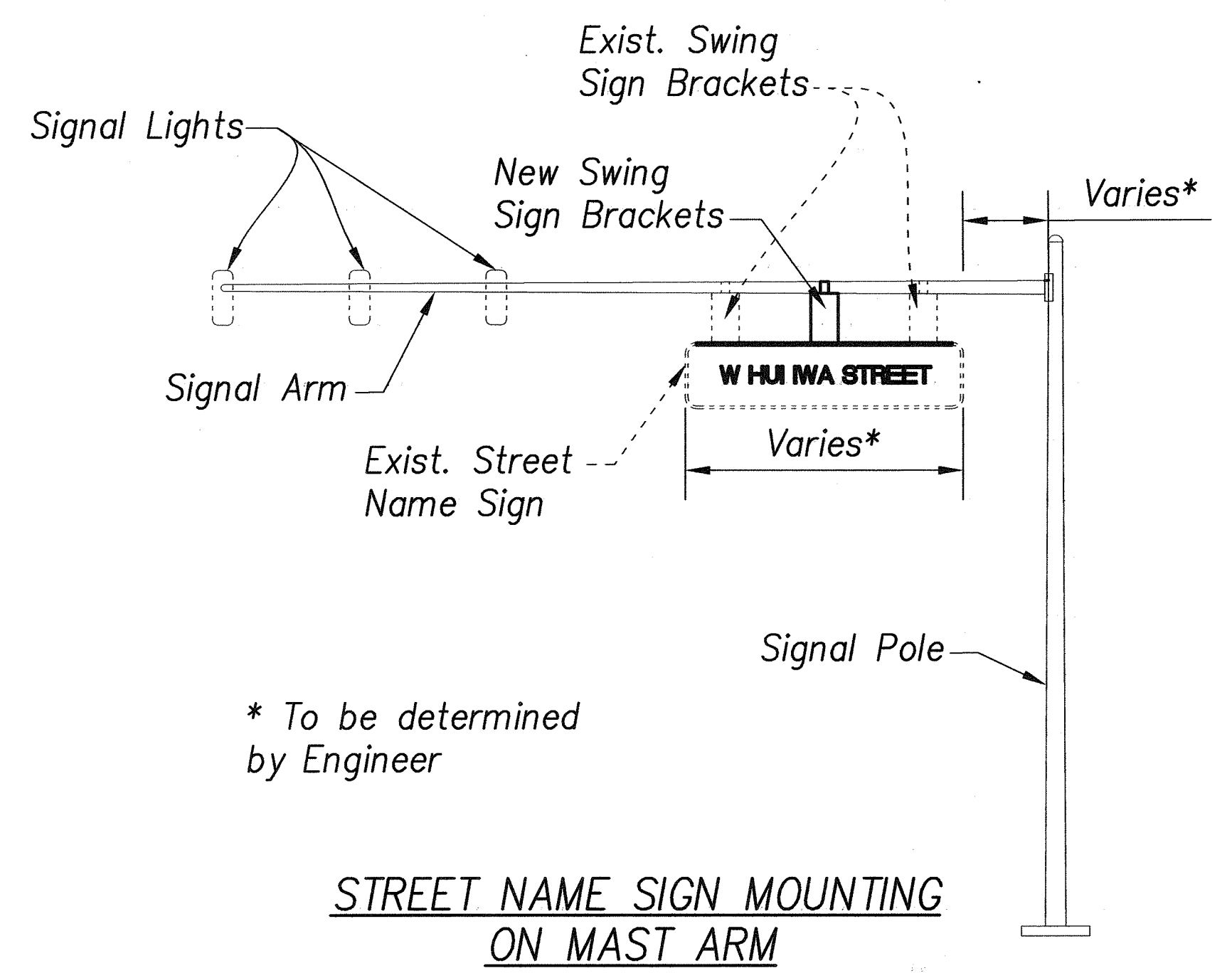

DESIGNED BY	DATE
CHECKED BY	
NOTED BY	
ORIGINAL PLAN	

KENNETH O. MACAL
LICENSED PROFESSIONAL ENGINEER
No. 3265-C
HAWAII, U.S.A.
APRIL 30, 2008
EXPIRATION DATE OF LICENSE
THIS WORK WAS PREPARED BY ME OR UNDER MY SUPERVISION

STATE OF HAWAII
DEPARTMENT OF TRANSPORTATION
HIGHWAYS DIVISION
SWING SIGN BRACKET DETAIL
KAHEKILI HIGHWAY INTERSECTION IMPROVEMENTS
VICINITY OF HUI IWA STREET
FEDERAL-AID PROJECT NO. NH-083-1(60)
SCALE: Not to Scale
DATE: April 2007
SHEET No. C-32 OF 90 SHEETS

34