

FED. ROAD DIST. NO.	STATE	PROJ. NO.	FISCAL YEAR	SHEET NO.	TOTAL SHEETS
HAWAII	HAW.	83F-01-99	2006	ADD.25	28

**LEGEND**

- 4 each Type A Raised Pavement Markers  
Type C Raised Pavement Markers @ 40'-0" o.c.
- 4 each Type J Raised Pavement Markers  
Type D Raised Pavement Markers @ 40'-0" o.c.
- 8" White Stripe with Type C Raised Pavement Markers @ 20'-0" o.c. (Tape, Type I or Thermoplastic Extrusion)
- 4" Double Solid Yellow with Type D Raised Pavement Markers @ 20'-0" o.c. (Tape, Type I or Thermoplastic Extrusion)
- 4" Double Solid Yellow Stripes with Type H Raised Pavement Markers @ 20'-0" o.c. (Tape, Type II or Thermoplastic Extrusion)
- 4" Yellow Edge Stripe with Type H Raised Pavement Markers @ 40'-0" o.c. (Tape, Type II or Thermoplastic Extrusion)
- 4" Double Solid White Stripes with Type C Raised Pavement Markers @ 20'-0" o.c. (Tape, Type I or Thermoplastic Extrusion)
- Lane Change Restriction Marking  
4 each Type A Raised Pavement Markers  
Type C Raised Pavement Markers @ 20'-0" o.c.  
4" White Stripe (Tape, Type I or Thermoplastic Extrusion)
- 4" or 8" White Edge Stripe with Type C Raised Pavement Markers @ 40'-0" o.c. (Tape, Type II or Thermoplastic Extrusion)
- 4" White Guide Lines (Tape, Type III or Thermoplastic Extrusion except for bus bays)
- Transverse Median Marking (Tape, Type II or Thermoplastic Extrusion)
- Transverse Shoulder Marking (Tape, Type II or Thermoplastic Extrusion)
- Channelizing Island or Deceleration Lane Gore (Tape, Type II or Thermoplastic Extrusion)
- Crosswalk and Stop Line. All Stop Lines shall be 10'-0" from Crosswalk unless otherwise noted. The circled number indicates the number of lanes for payment (Tape, Type III or Thermoplastic Extrusion)
- Pavement Arrow (Tape, Type III or Thermoplastic Extrusion)
- Pavement Word (Tape, Type III or Thermoplastic Extrusion)
- 4 Each Type J Raised Pavement Markers  
Type D Raised Pavement Markers @ 40'-0" o.c.  
Type H Raised Pavement Markers (Reflective Surface facing no-passing direction)  
4" Single Solid Yellow Stripe (Tape, Type I or Thermoplastic Extrusion)
- Extension of Edge Line, 4" Wide x 2'-0" Long White Stripe @ 10'-0" o.c. w/Type C Markers @ 40'-0" o.c. (Tape, Type III or Thermoplastic Extrusion)

**NOTES**

1. Layout of pavement markings and striping shall be done by the Contractor and approved by the Engineer prior to any installation work.
2. Existing pavement markings not incorporated in the final traffic pattern shall be removed as directed by the Engineer. Costs shall be incidental to the various pavement marking items.
3. Raised pavement markers shall not be installed within crosswalks.
4. Final locations of all signs shall be approved by the Engineer prior to any installation work.
5. Existing signs not shown on these plans shall remain as posted unless otherwise directed by the Engineer. Removal and disposal of existing signs and/or posts as designated on these plans shall be incidental to the various signing items.
6. Final locations of all Stop Lines shall be approved by the Engineer prior to installation.
7. All pavement striping shall be as noted on the legend or plans.
8. All preformed pavement marking tapes over existing pavement shall be applied with an approved primer as recommended by the tape manufacturer and as approved by the Engineer. The primer shall be allowed to dry to the tacky stage prior to tape application.
9. The Contractor shall erect at the beginning of the project and at the end of the project advance construction warning signs placed as indicated on the plans or as directed by the Engineer for the duration of the highway project and shall be maintained by the Contractor. These signs shall be placed in addition to the required traffic control signs called for in Section 645 - Traffic Control. The advance construction warning signs shall be new and become the property of the State. The Contractor shall remove, clean, and deliver the signs and posts to the District Baseyard, or as directed by the Engineer, upon the completion of the project.

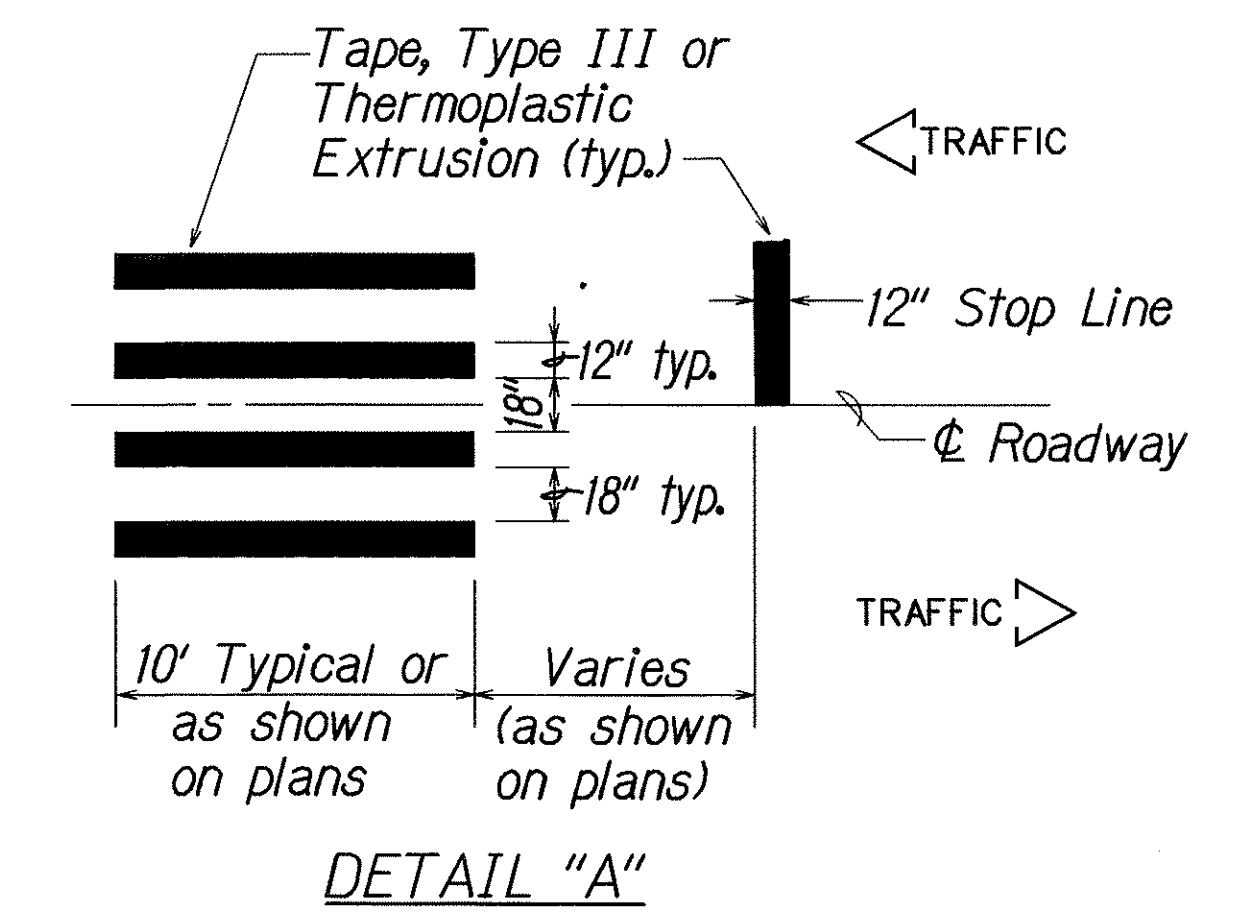

**DETAIL "A"**  
**CROSSWALK STRIPING DETAIL**

Not to Scale

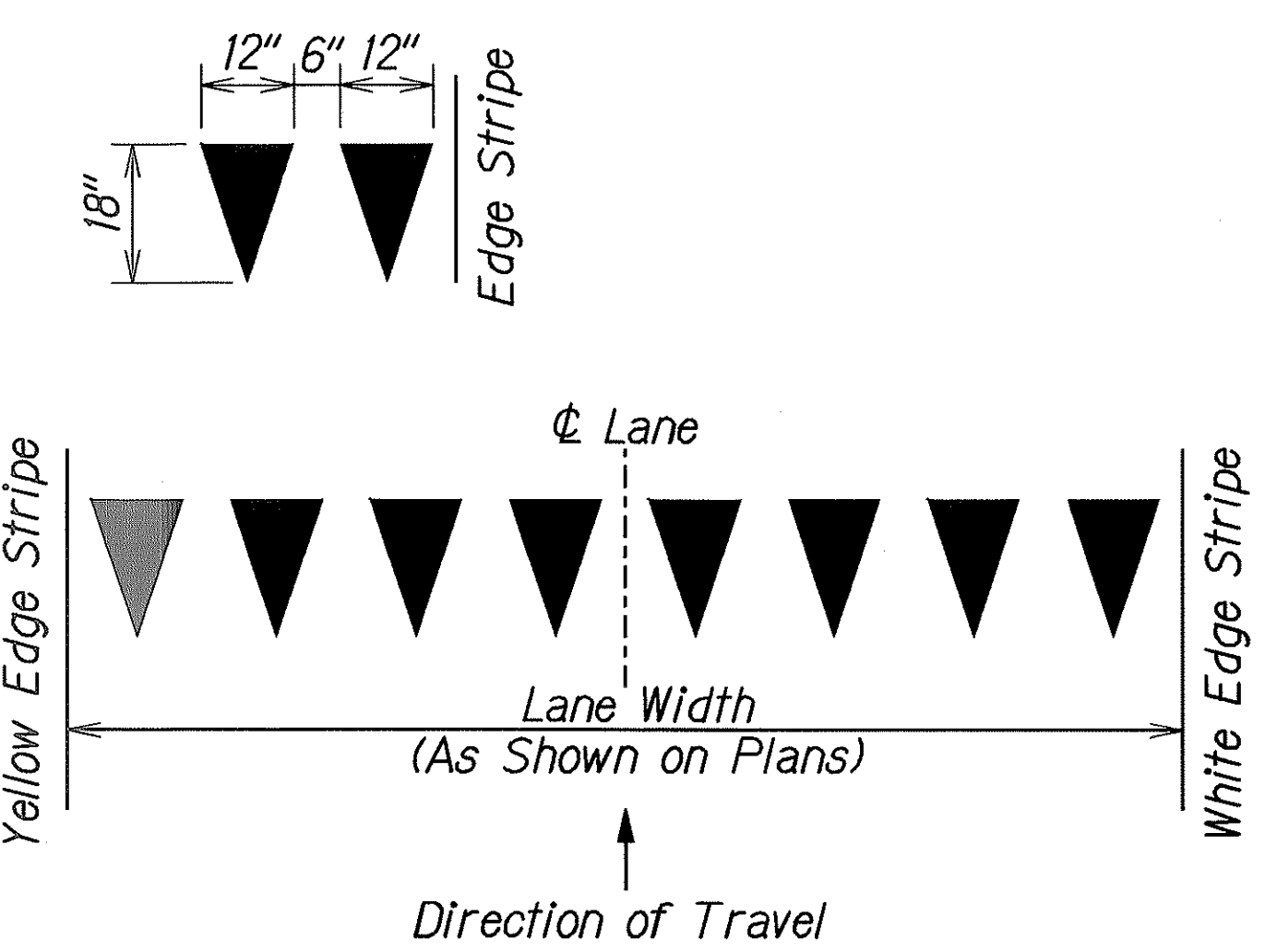

**YIELD LINE DETAIL (R1-5)**

Not to Scale

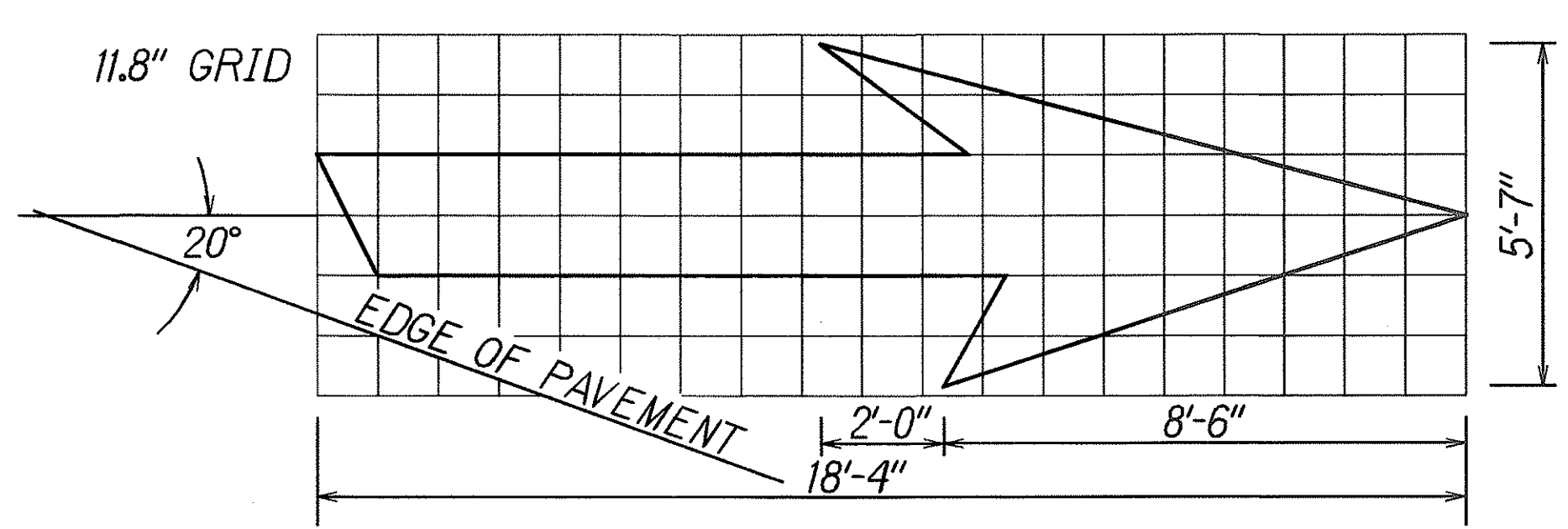

**TYPE VI ARROW**  
**RIGHT LANE DROP ARROW**  
(FOR LEFT LANE, USE MIRROR IMAGE)

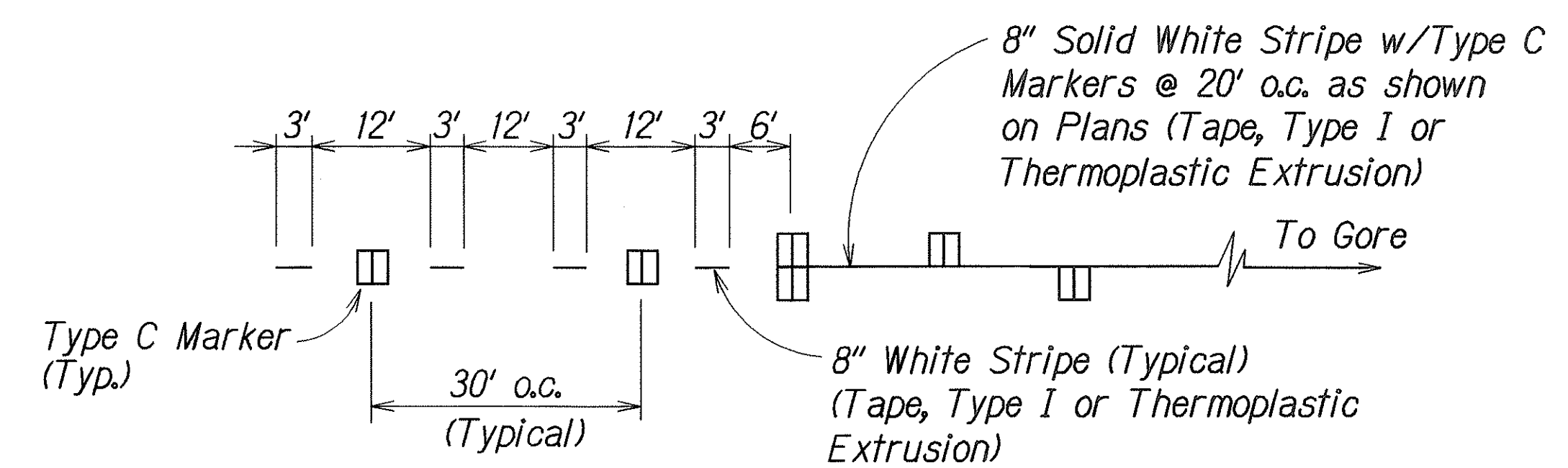

**LANE DROP MARKING**

Not to Scale

ORIGINAL PLANS	DATE
REVISIONS	
DESIGNED BY	
CHECKED BY	
DATE	

6/19/06	Added Type VI Arrow Detail.
DATE	REVISION
STATE OF HAWAII DEPARTMENT OF TRANSPORTATION HIGHWAYS DIVISION <b>PAVEMENT MARKING</b> <b>LEGEND, DETAILS &amp; NOTES</b> KAMEHAMEHA HIGHWAY Intersection Improvements At Kahekili Highway Project No. 83F-01-99 Scale: As Noted Date: April, 2006	
SHEET No. 21 OF 4 SHEETS	

FED. ROAD DIST. NO.	STATE	PROJ. NO.	FISCAL YEAR	SHEET NO.	TOTAL SHEETS
HAWAII	HAW.	83F-01-99	2006	ADD.25S-1	28

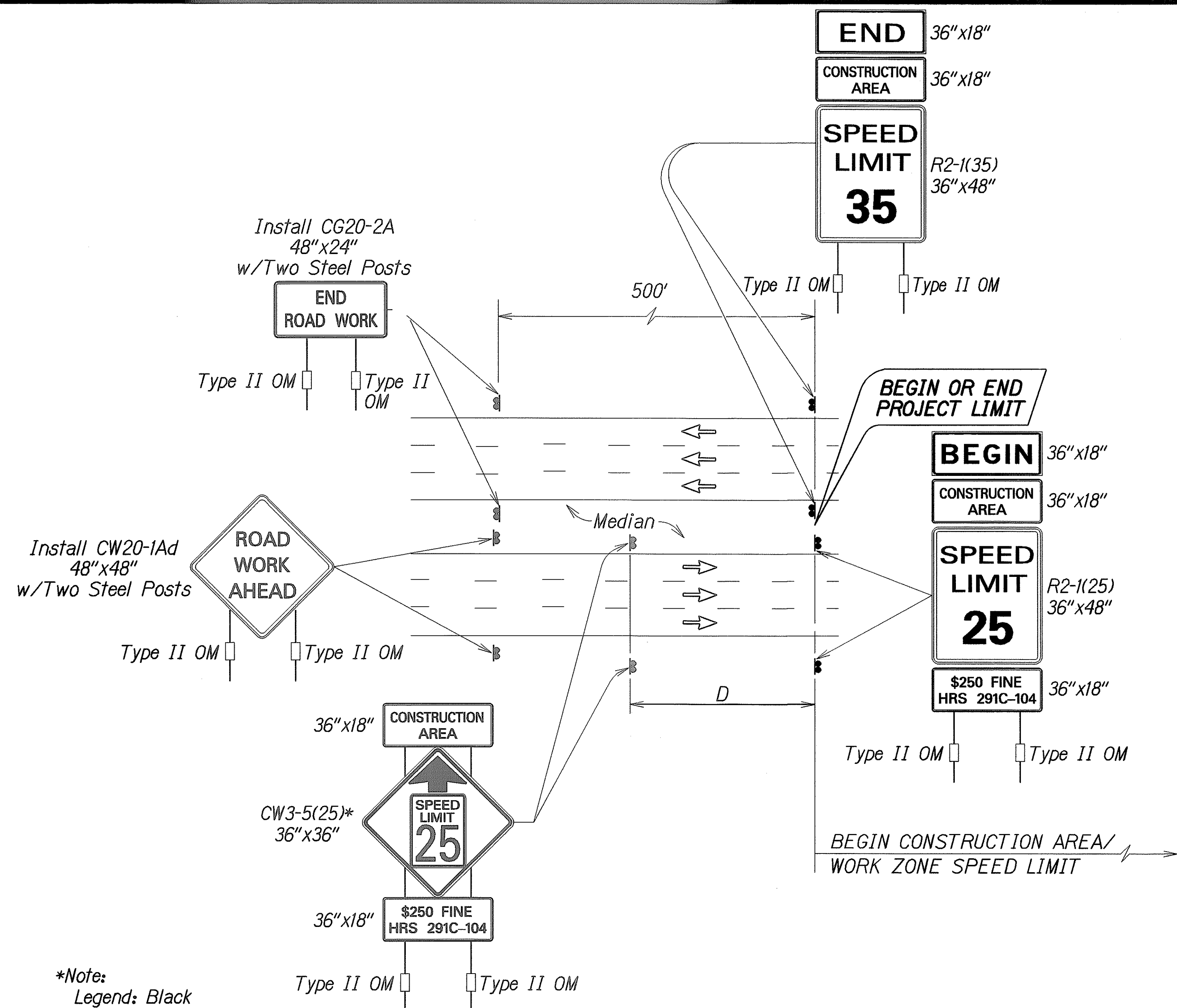

\*Note:  
 Legend: Black  
 Background: Orange  
 Speed Limit: Black on White

TYPICAL DETAIL FOR CONSTRUCTION SIGNS  
 ON MULTILANE DIVIDED HIGH SPEED HIGHWAY

Work Zone Notes:

1. This Work Zone Sign Plan is intended for use on long-term stationary work zones/construction phases (3 days or more). All work zones or construction phases less than 3 days duration will use Traffic Control Plans shown in Section 645 of the Special Provisions.
2. All existing regulatory speed limit signs with posts within the work zone/project limits shall be removed and replaced with work zone speed limit sign assemblies (R2-1(25) and CW3-5(25) with "CONSTRUCTION AREA" and "\$250 FINE HRS 291C-104" Supplemental Signs).
3. Construction sign assemblies shall be installed on both the approaching and trailing ends of each work zone as shown on this plan.
4. Each construction warning sign and work zone speed limit assembly shall have a minimum of two (2) Type II OM. Installation of each Type II OM shall be considered incidental to Item No. 645.0100, Traffic Control.
5. Upon the completion of all physical work or as directed by the Engineer, all construction signs and work zone speed limit assemblies shall be removed. All speed limit signs and posts that were existing at the start of the project within the work zone/project limits shall be restored back to their original locations and configurations.
6. Placement of construction signs shall not obstruct the path of pedestrians and bicyclists.
7. The removal and restoration of existing regulatory speed limit signs with new posts along with the installation, maintenance and removal of work zone speed limit sign assemblies shall be considered incidental to Item No. 645.0100 Traffic Control.

SURVEY PLOTTED BY	DATE
DRAWN BY	
TRACED BY	
QUANTITIES BY	
CHECKED BY	
ORIGINAL PLAN	
NOTE BOOK	
NO.	

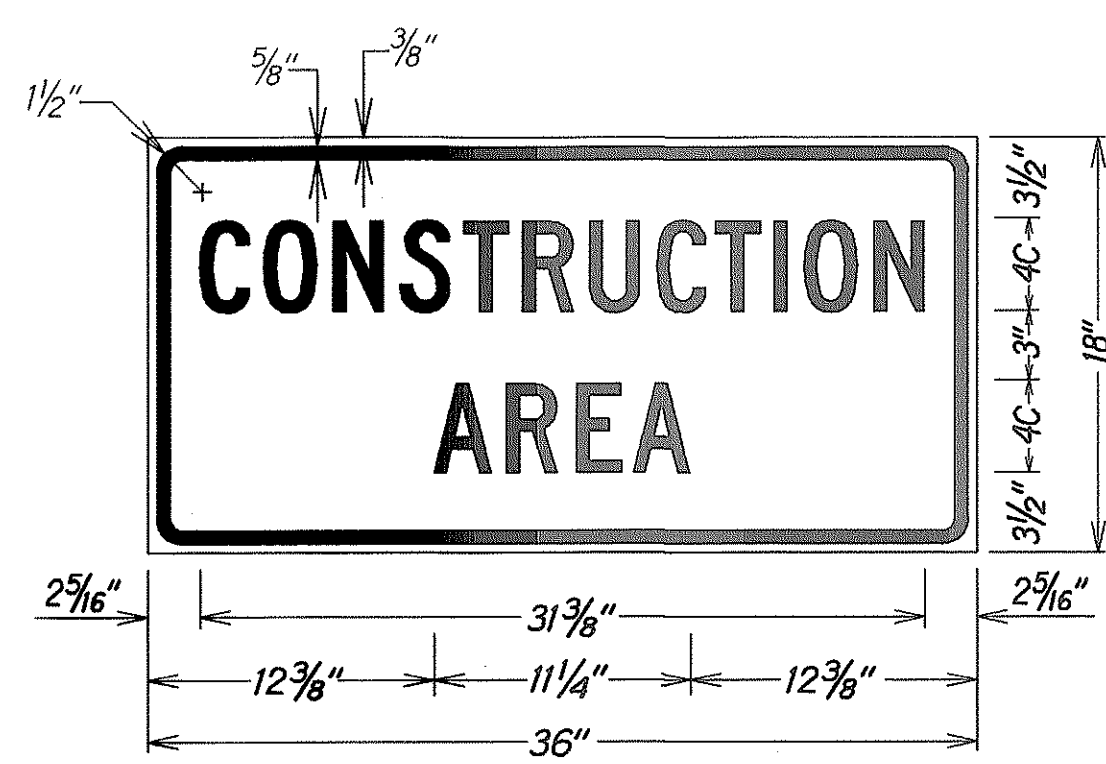

LEGEND: BLACK  
 BACKGROUND: ORANGE

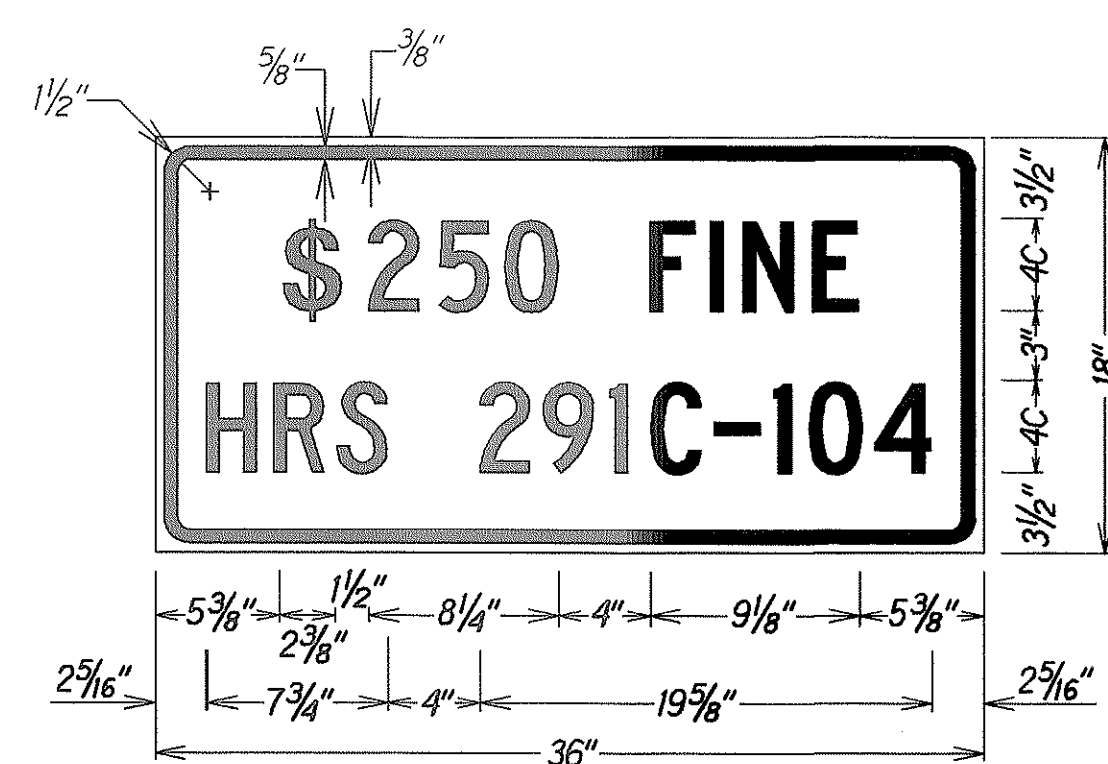

LEGEND: BLACK  
 BACKGROUND: WHITE



LEGEND: BLACK  
 BACKGROUND: ORANGE

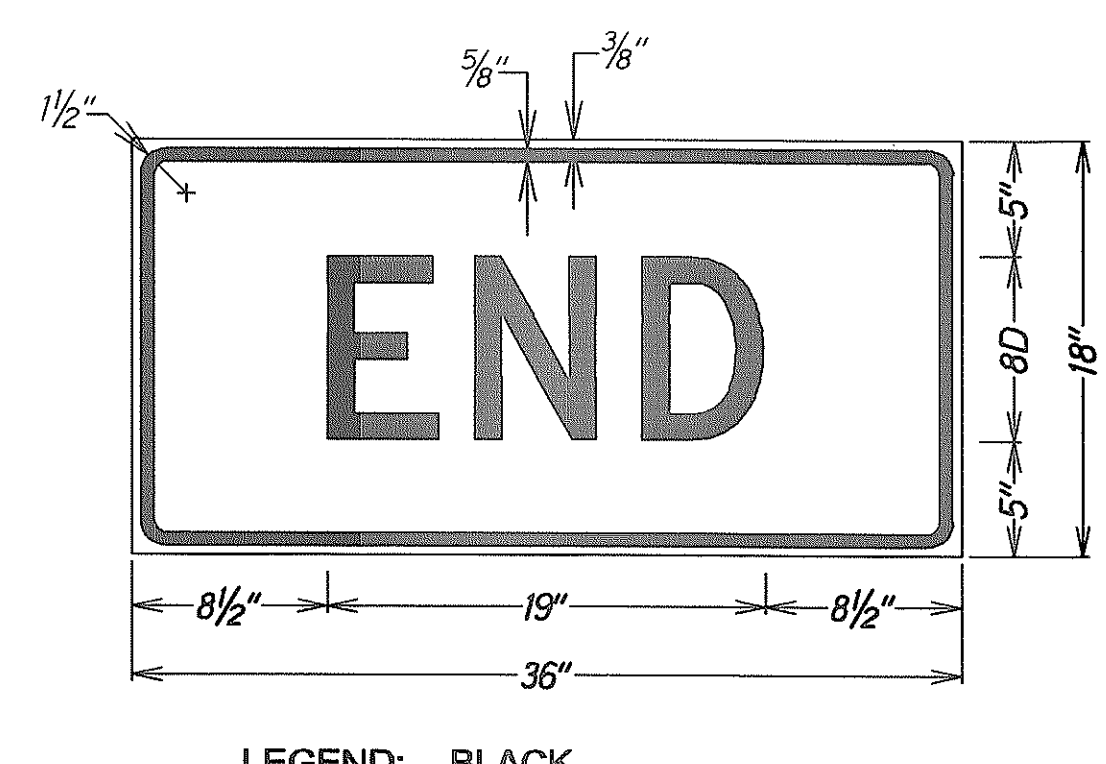

LEGEND: BLACK  
 BACKGROUND: ORANGE

6/19/06	Added New Sheet.
DATE	REVISION
STATE OF HAWAII DEPARTMENT OF TRANSPORTATION HIGHWAYS DIVISION	
<b>HIGH SPEED DIVIDED HIGHWAY</b>	
<b>WORK ZONE SIGNING PLAN, NOTES&amp;DETAILS</b>	
Kamehameha Highway Intersection Improvements At Kahekili Highway	
Project No. 83F-01-99	
Not To Scale Date: June, 2006	
SHEET No. 1 OF 1 SHEETS	

FED. ROAD DIST. NO.	STATE	PROJ. NO.	FISCAL YEAR	SHEET NO.	TOTAL SHEETS
HAWAII	HAW.	83F-01-99	2006	ADD.26	28

**KEY:**

- ① Exist. Sign(s) & Post(s) to Remain
- ② Remove Exist. Sign(s) w/Post(s)
- ③ Remove Exist. Sign(s) w/Post(s) & Install New Sign(s) w/Post(s)
- ④ Install New Sign(s) w/Post(s)
- ⑤ Remove Exist. Sign(s) & Reinstall on New Post(s)
- ⑥ Remove Exist. Sign(s) on Exist. Joint Pole or Structure

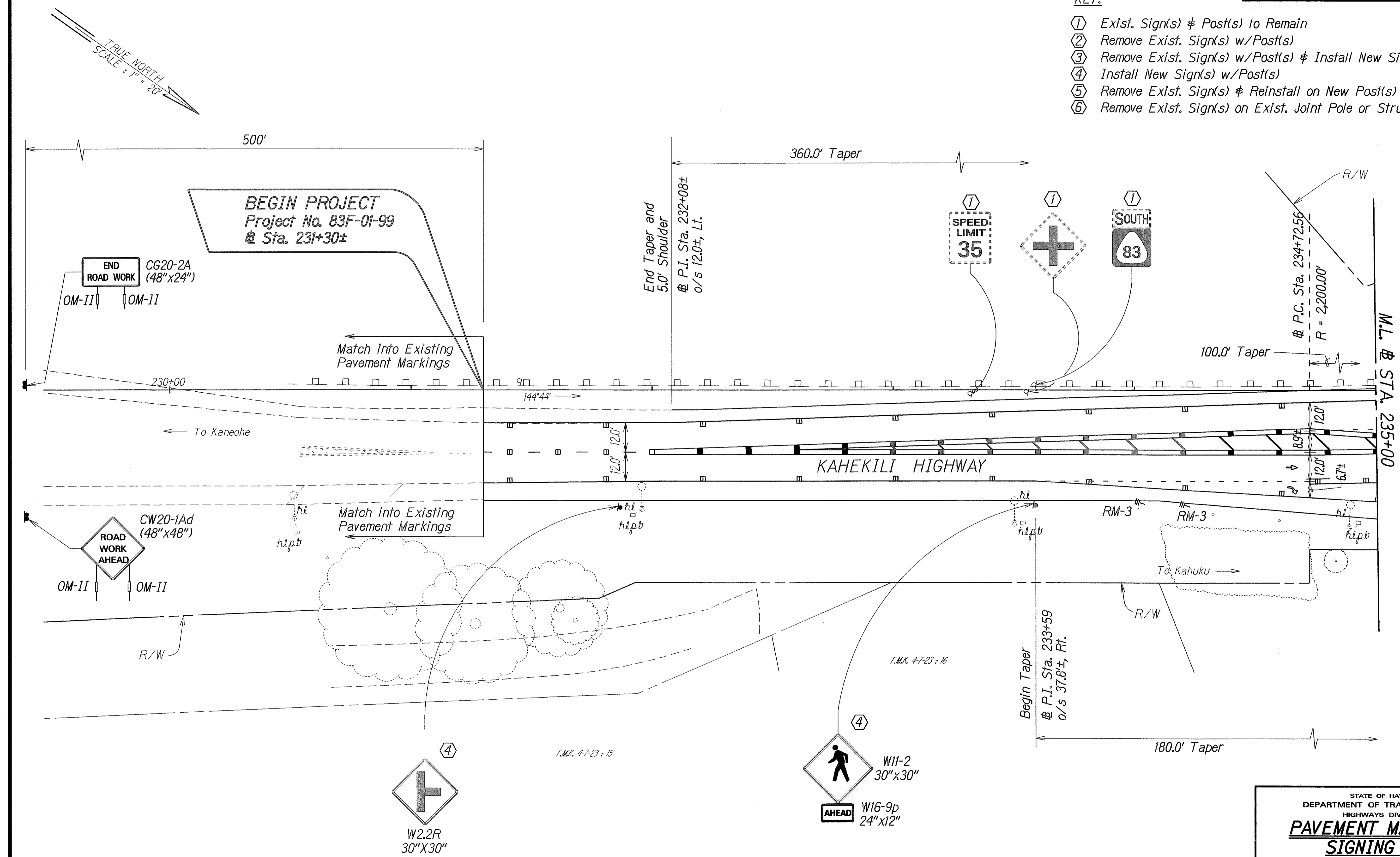

DESIGNED BY	DATE
DRAWN BY	
TRACED BY	
DESIGNED BY	
QUANTITIES BY	
CHECKED BY	
ORIGINAL PLAN	
NOTE BOOK	
No.	

DATE	REVISION
6/19/06	Revise Sign Size for W16-9p and Pavement Markings and Striping.

STATE OF HAWAII  
DEPARTMENT OF TRANSPORTATION  
HIGHWAYS DIVISION

**PAVEMENT MARKING & SIGNING PLAN**

**KAMEHAMEHA HIGHWAY  
Intersection Improvements  
At Kahekili Highway  
Project No. 83F-01-99**

Scale: 1"=20'      Date: April, 2006

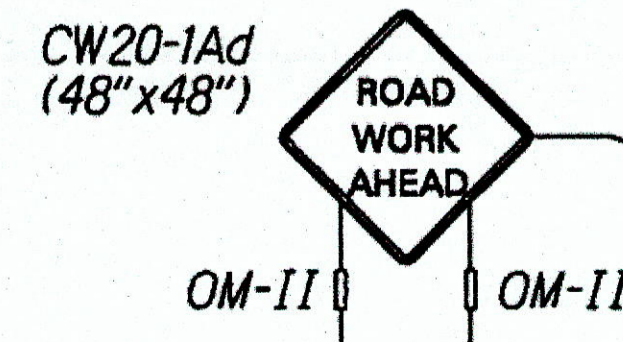
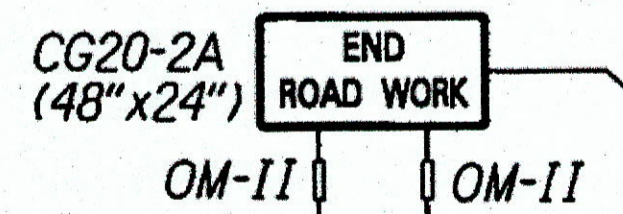
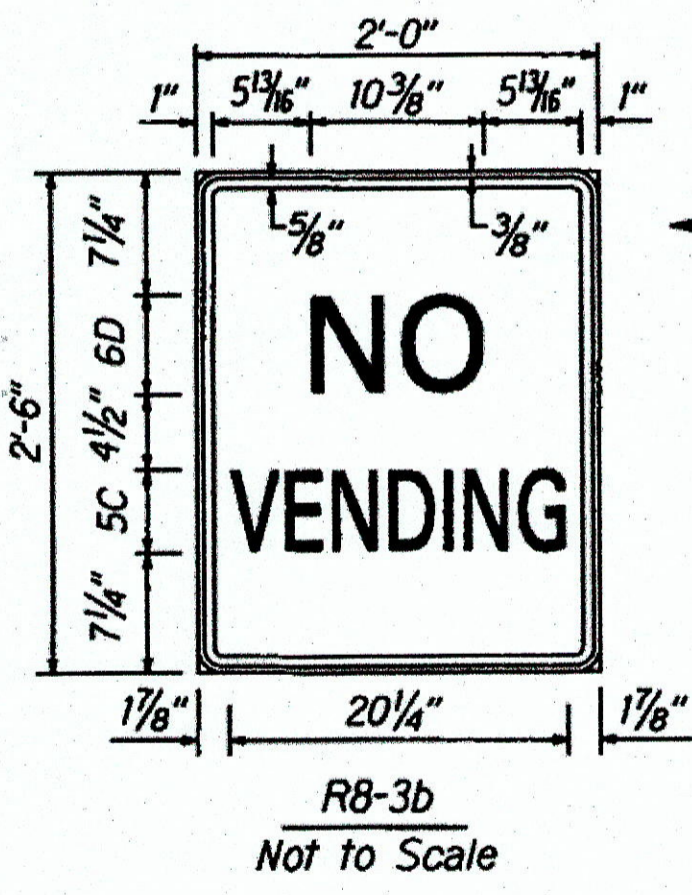
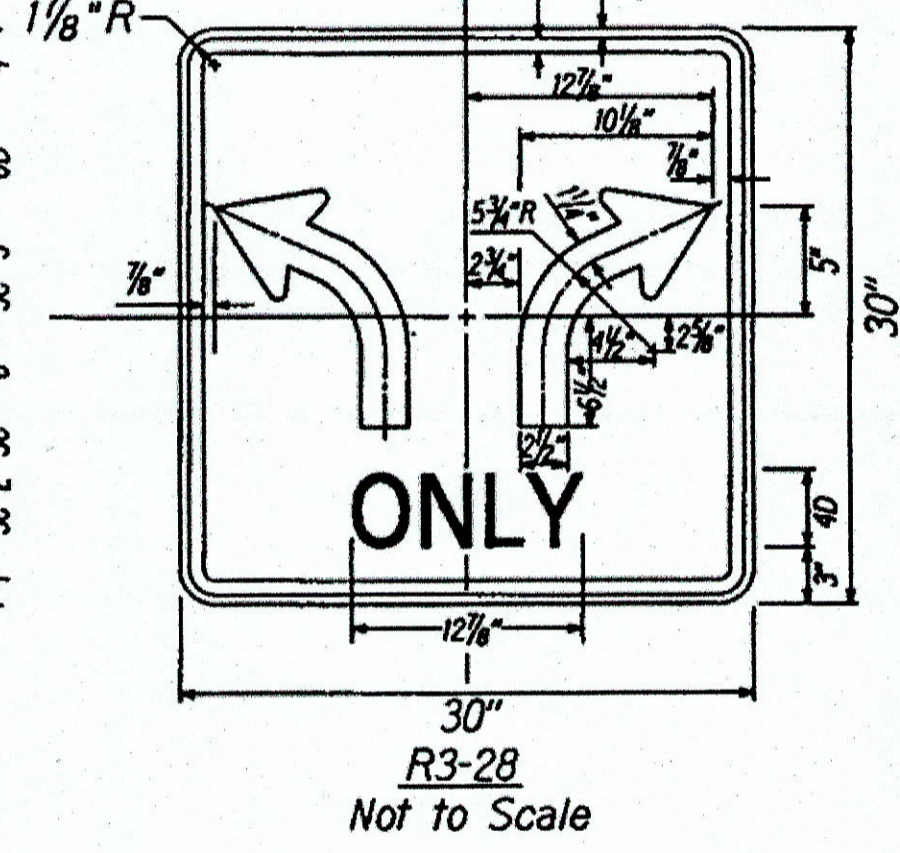
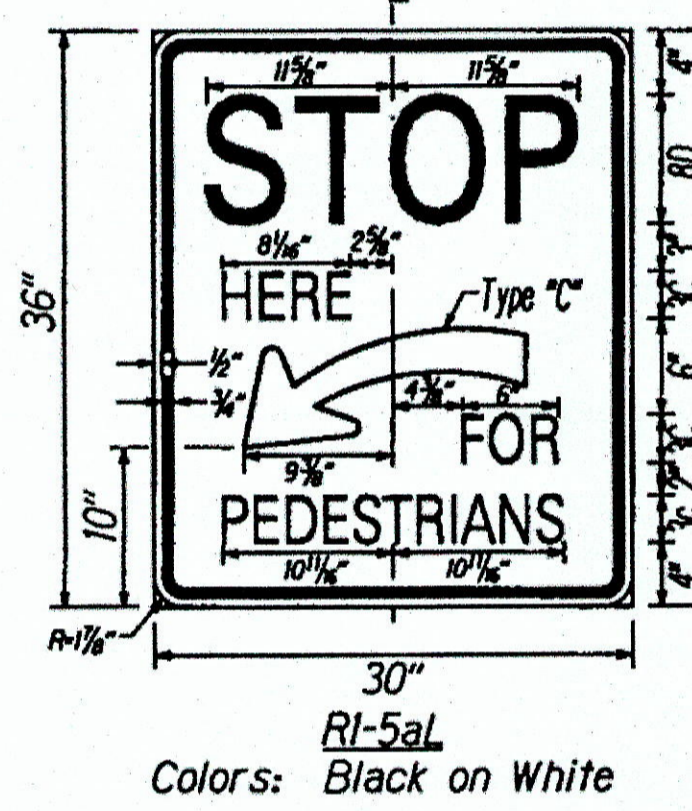
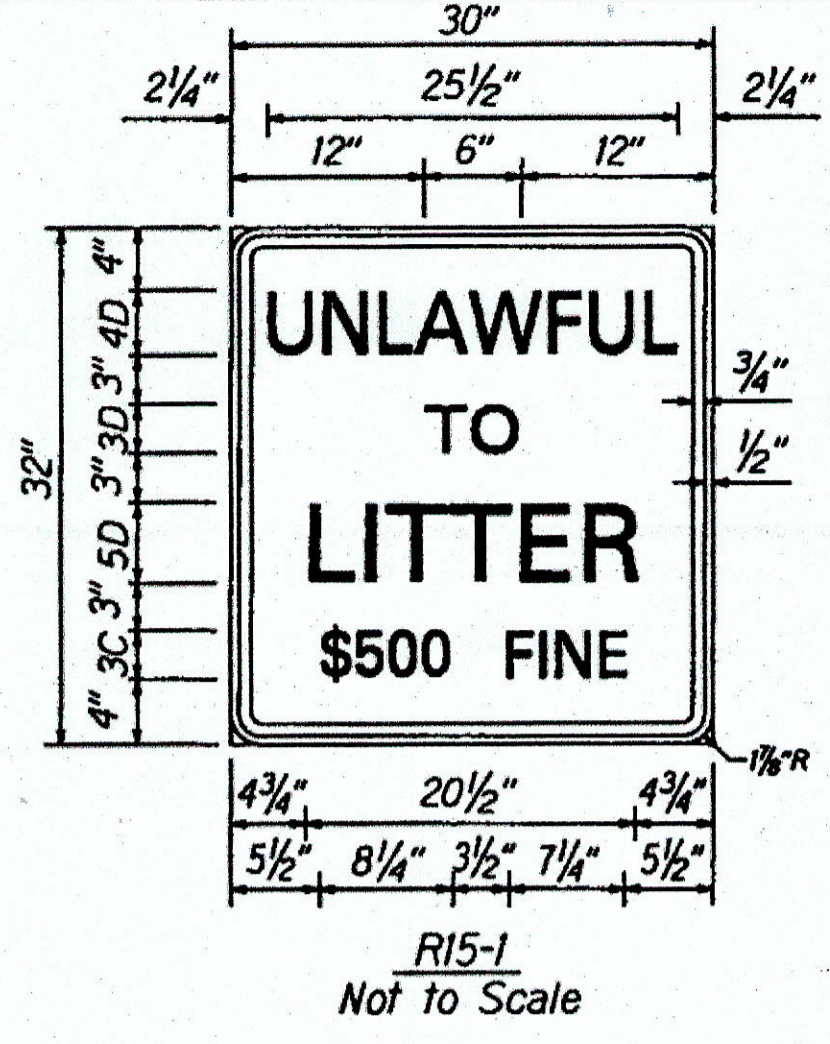
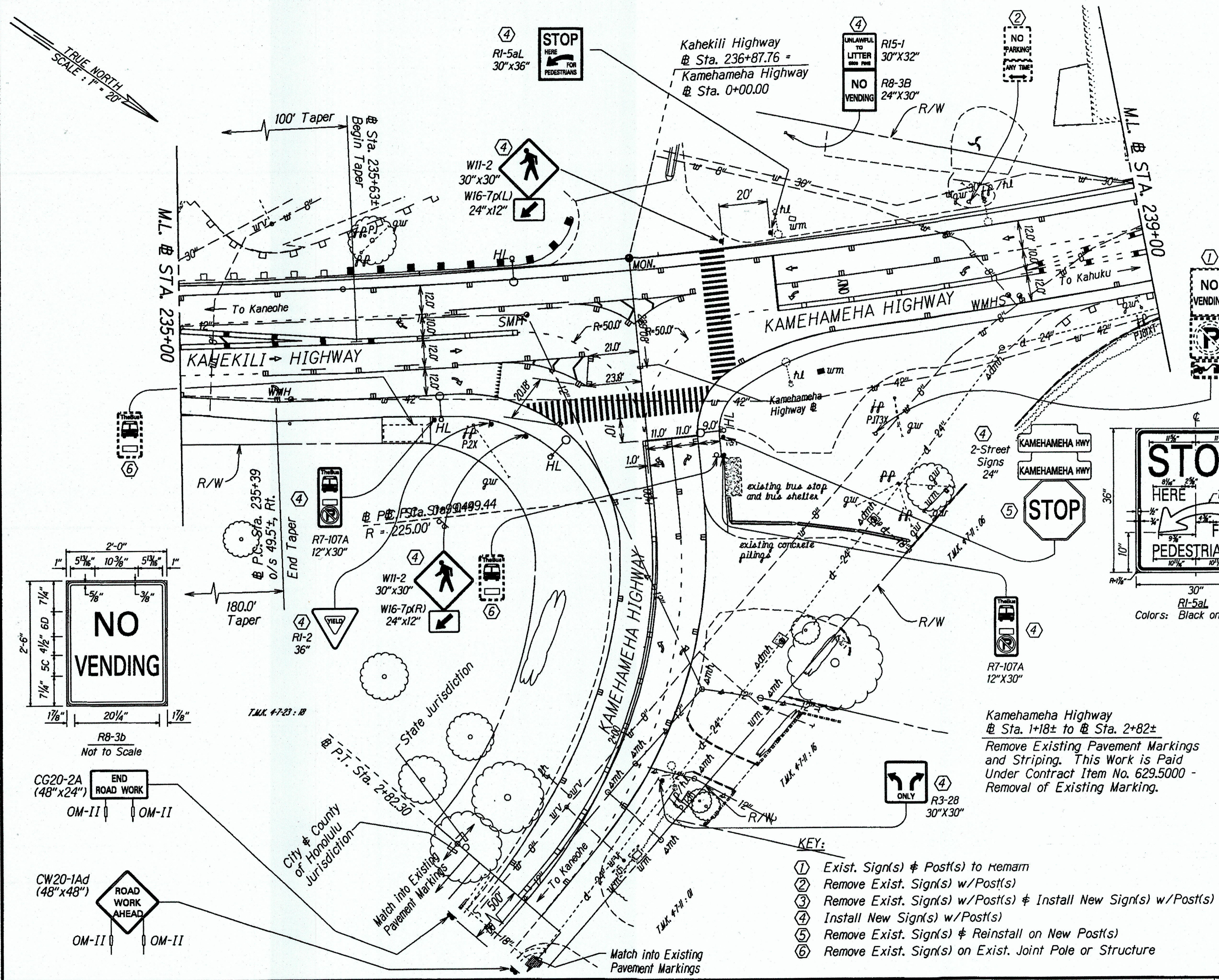

- KEY:**
- ① Exist. Sign(s) & Post(s) to Remain
  - ② Remove Exist. Sign(s) w/Post(s)
  - ③ Remove Exist. Sign(s) w/Post(s) & Install New Sign(s) w/Post(s)
  - ④ Install New Sign(s) w/Post(s)
  - ⑤ Remove Exist. Sign(s) & Reinstall on New Post(s)
  - ⑥ Remove Exist. Sign(s) on Exist. Joint Pole or Structure

DATE	REVISION
11/30/18	Revise Pavement Striping, Markings, and Arrows. Added New RI-5aL Sign.
11/3/06	Revise Pavement Striping, Markings, Symbols and Wording. Added New Signs to be Installed (RI5-1 and R3-8).
6/19/06	Revise Sign Size for W16-9p and Pavement Markings and Striping. Added Sign Detail for R3-28.

STATE OF HAWAII  
DEPARTMENT OF TRANSPORTATION  
HIGHWAYS DIVISION

**PAVEMENT MARKING & SIGNING PLAN**

**KAMEHAMEHA HIGHWAY**  
**Intersection Improvements**  
**At Kahekili Highway**  
**Project No. 83F-01-99**

Scale: 1"=20' Date: April, 2006  
SHEET No. T3 OF 4 SHEETS

**"AS-BUILT"**

**C.O.ADD.27**

DATE: 04/04/06  
DRAWN BY: [Signature]  
CHECKED BY: [Signature]  
ORIGINAL PLAN: [Signature]  
NOTES: [Signature]

