

FED. ROAD DIST. NO.	STATE	PROJ. NO.	FISCAL YEAR	SHEET NO.	TOTAL SHEETS
HAWAII	HAW.	83G-01-03M	2005	8	47

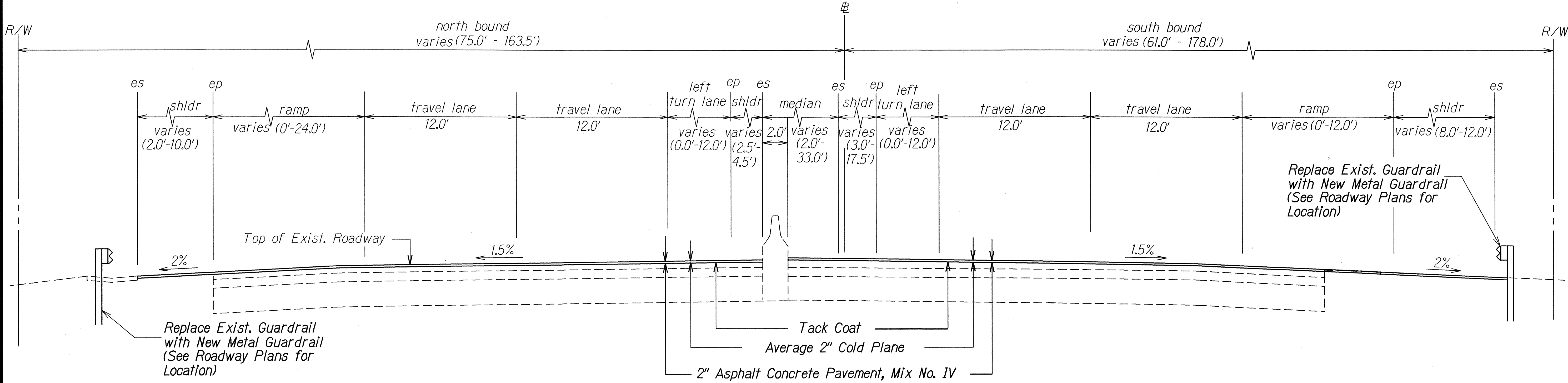

TYPICAL SECTION (# STA. 96+70 TO # STA. 127+20)
Scale: 1/4" = 1'-0"

ORIGINAL PLAN	SURVEY PLOTTED BY	DATE
NOTED	DRAWN BY	
DESIGNED BY	CHECKED BY	
APPROVED BY		

STATE OF HAWAII
DEPARTMENT OF TRANSPORTATION
HIGHWAYS DIVISION

TYPICAL SECTION

KAMEHAMEHA HIGHWAY RESURFACING
Kahiko Street to Pali Highway
Project No. 83G-01-03M

Scale: 1/4" = 1'-0" Date: January, 2005

SHEET No. 1 OF 1 SHEETS

FED. ROAD DIST. NO.	STATE	PROJ. NO.	FISCAL YEAR	SHEET NO.	TOTAL SHEETS
HAWAII	HAW.	83G-01-03M	2005	ADD. 9	47

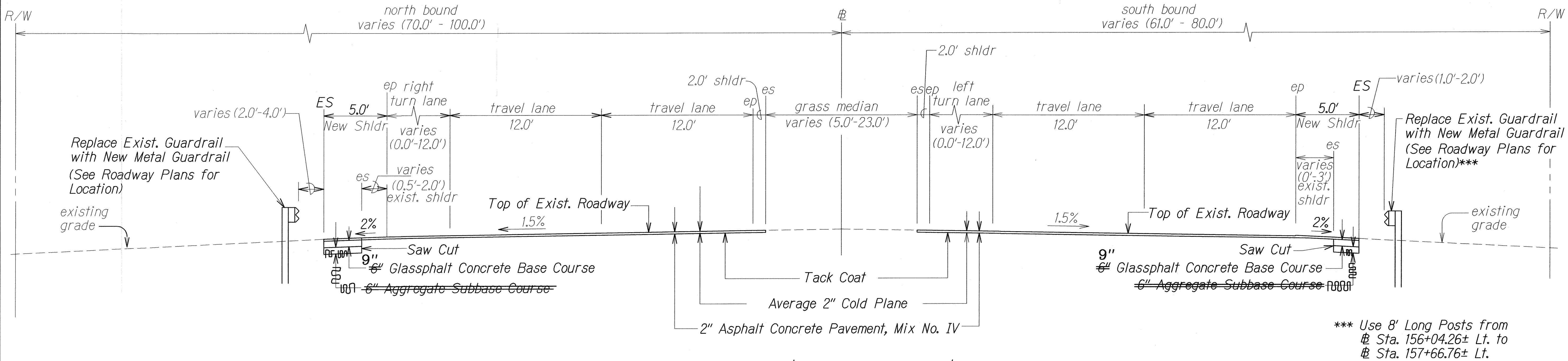

TYPICAL SECTION (# STA. 127+20 TO # STA. 161+60)
Scale: 1/4" = 1'-0"

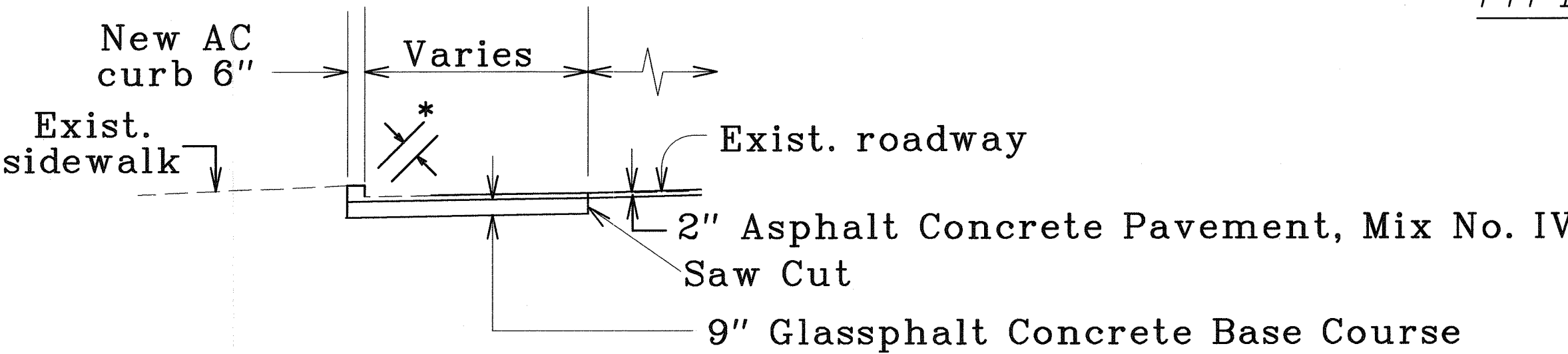

PARTIAL TYPICAL SECTION
STA. 149+20.63 TO # STA. 150+68.23 (North Bound)
150+48 Scale: 1/4" = 1'-0"

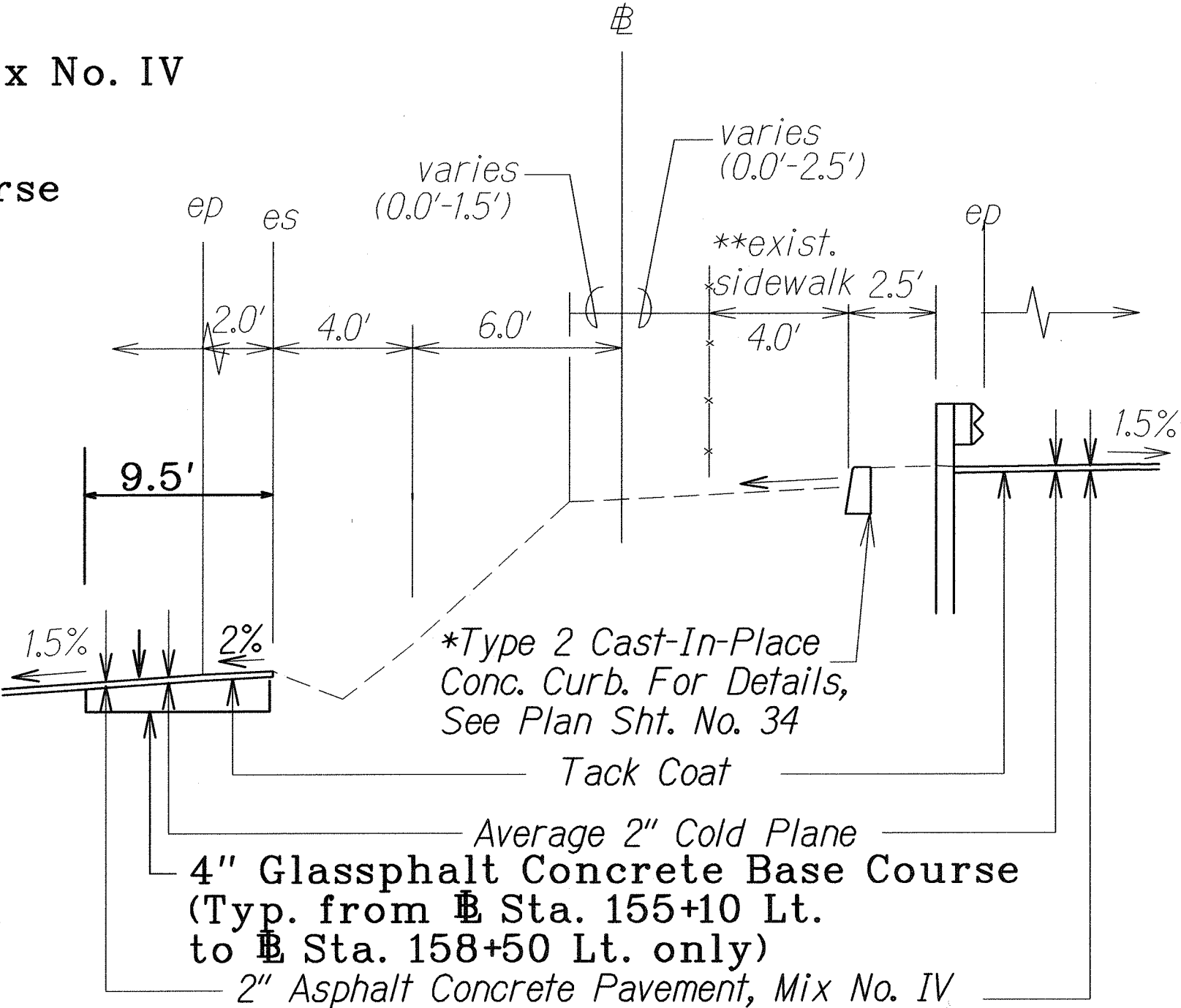

PARTIAL TYPICAL SECTION
STA. 151+90 TO # STA. 161+60 (Median)
Scale: 1/4" = 1'-0"

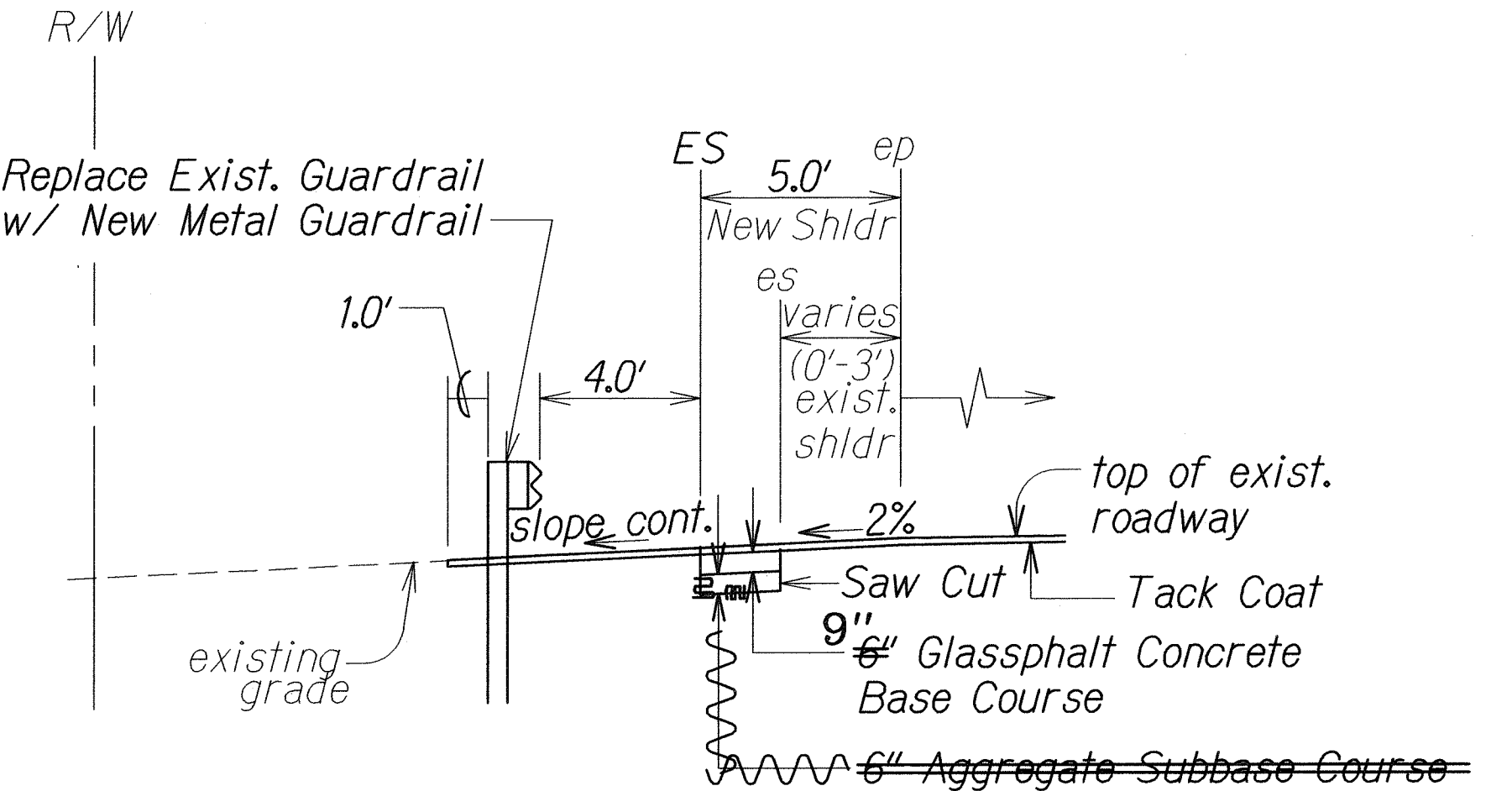

PARTIAL TYPICAL SECTION
STA. 130+00 TO # STA. 135+75 (North Bound)
Scale: 1/4" = 1'-0"

LEGEND FOR AS-BUILT POSTINGS	
	Squiggly line for as-built deletion
	Double line for as-built deletion
Roadway	Text for as-built posting

*Removal of Wood Blocking is considered incidental to installing of Type 2 Cast-In-Place Conc. Curb.

**For Passing Area Location and Details, See Plan Sht. Nos. 23 & 34

6/16/05 Revised Partial typical section # Sta. 149+20.63 to # Sta. 150+68.23 (North Bound)
Revised Partial typical section # Sta. 151+90 to # Sta. 161+60 (median)

DATE REVISION

TYPICAL SECTION	
KAMEHAMEHA HIGHWAY RESURFACING	
Kahiko Street to Pali Highway	
Project No. 83G-01-03M	
Scale: 1/4" = 1'-0"	Date: January, 2005
SHEET No. 2	OF 2 SHEETS

"AS-BUILT"

ADD. 9

FED. ROAD DIST. NO.	STATE	PROJ. NO.	FISCAL YEAR	SHEET NO.	TOTAL SHEETS
HAWAII	HAW.	83G-01-03M	2005	10	47

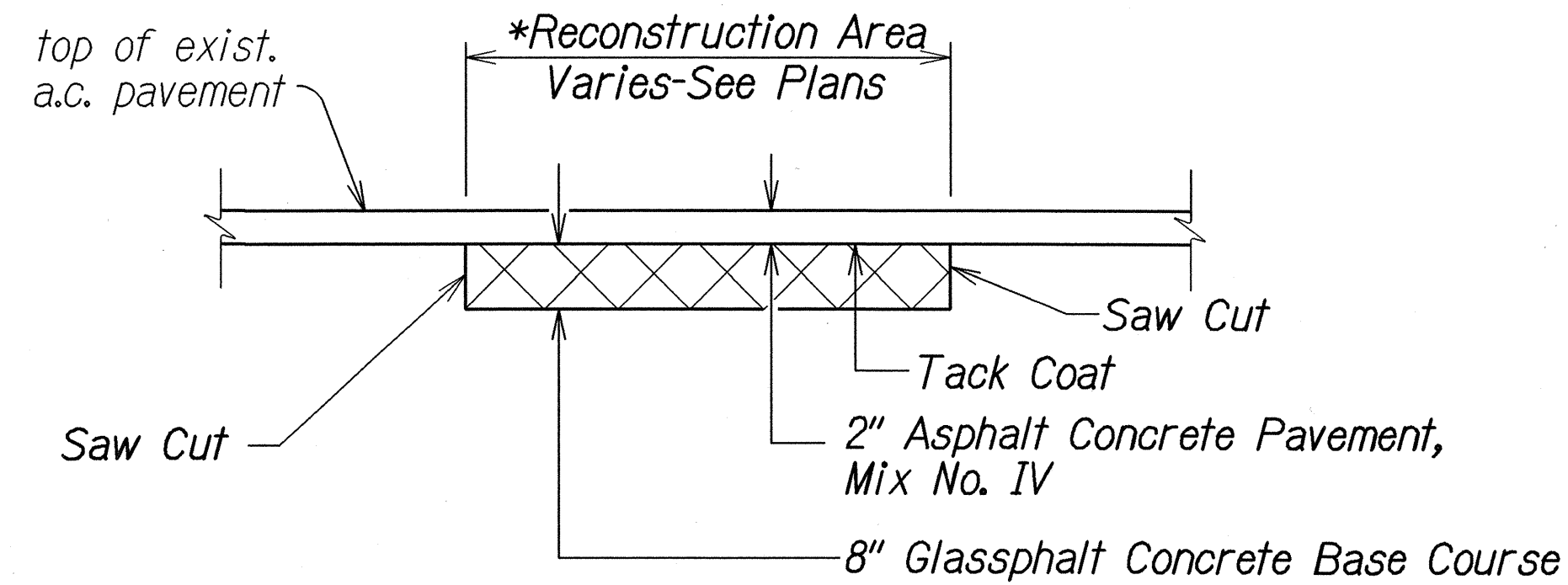

*For Reconstruction Area Location, See Roadway Plans

A.C. PAVEMENT RECONSTRUCTION DETAIL A (TYPICAL)
Not to Scale

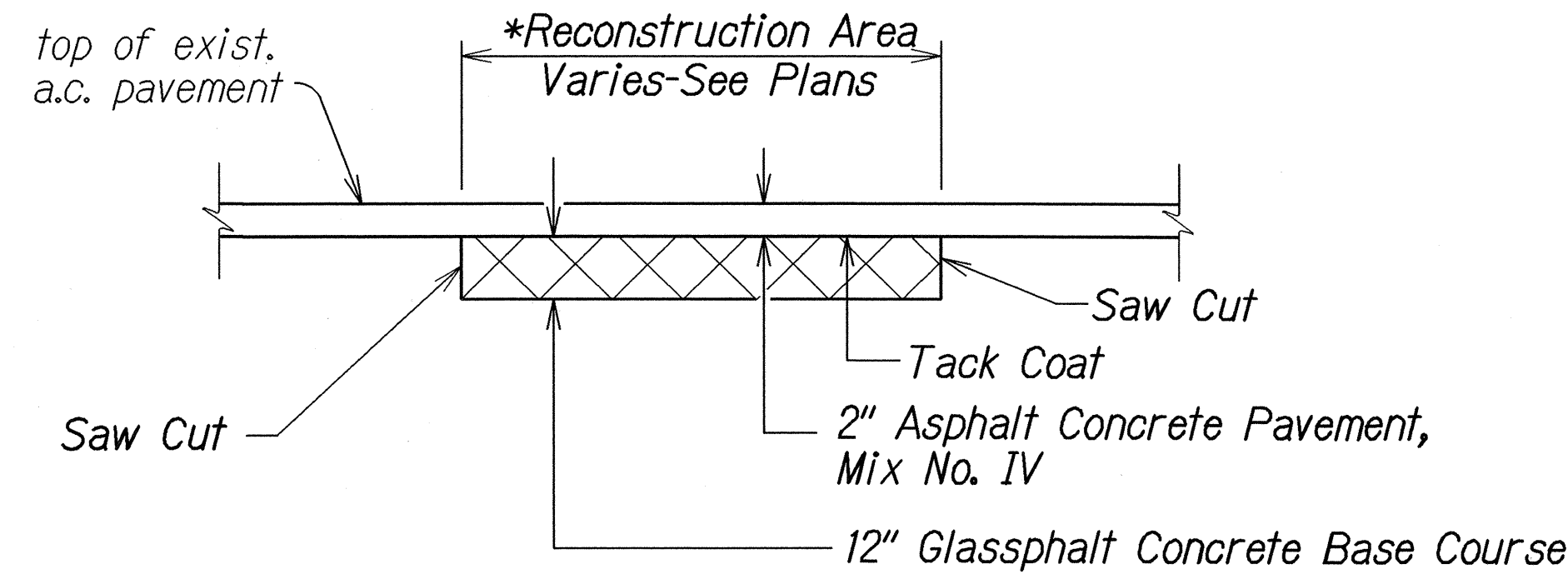

*Reconstruction Area Location See Roadway Plan Sheet No. 23

A.C. PAVEMENT RECONSTRUCTION DETAIL B
STA. 156+50.00 RT. TO # STA. 160+00.00 RT.
Not to Scale

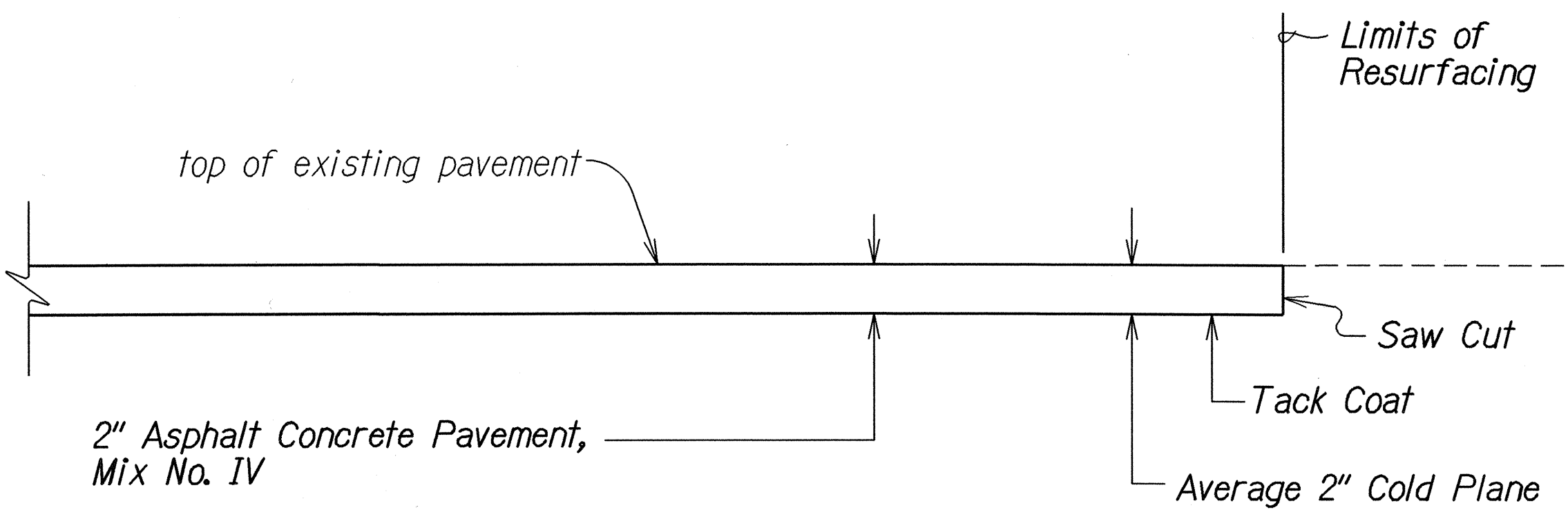

TRANSITION TO EXISTING A.C. PAVEMENT
BEGIN AND END PROJECT
Not to Scale

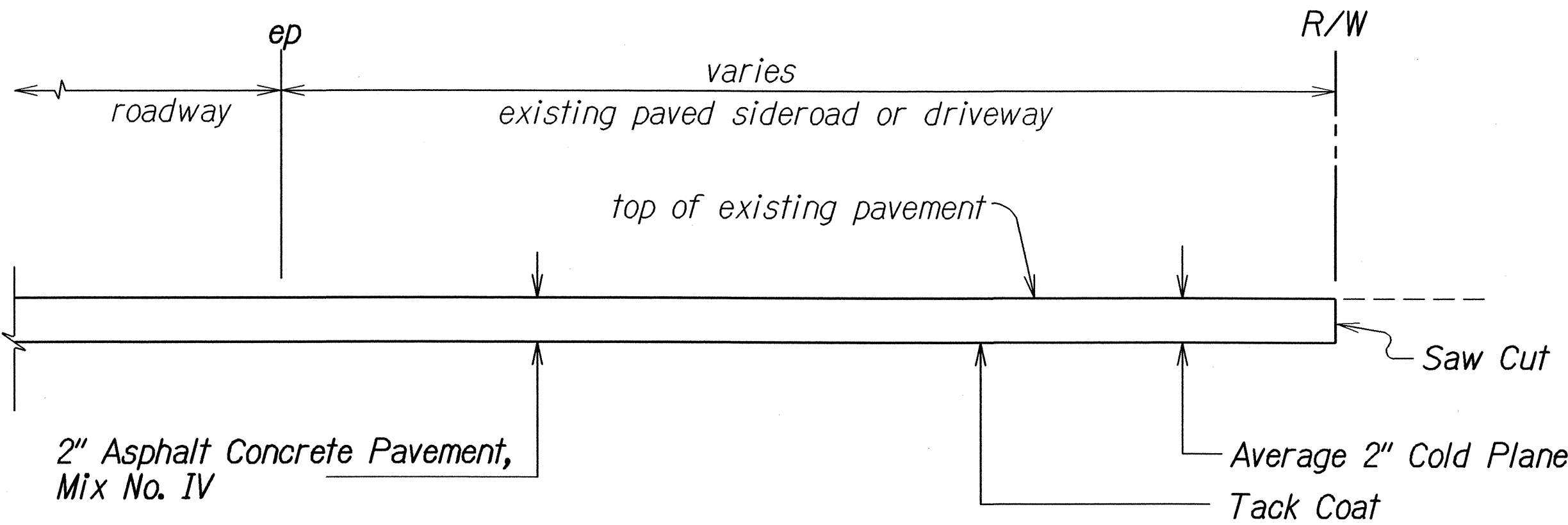

A.C. RESURFACING AT PAVED SIDEROAD DETAIL
Not to Scale

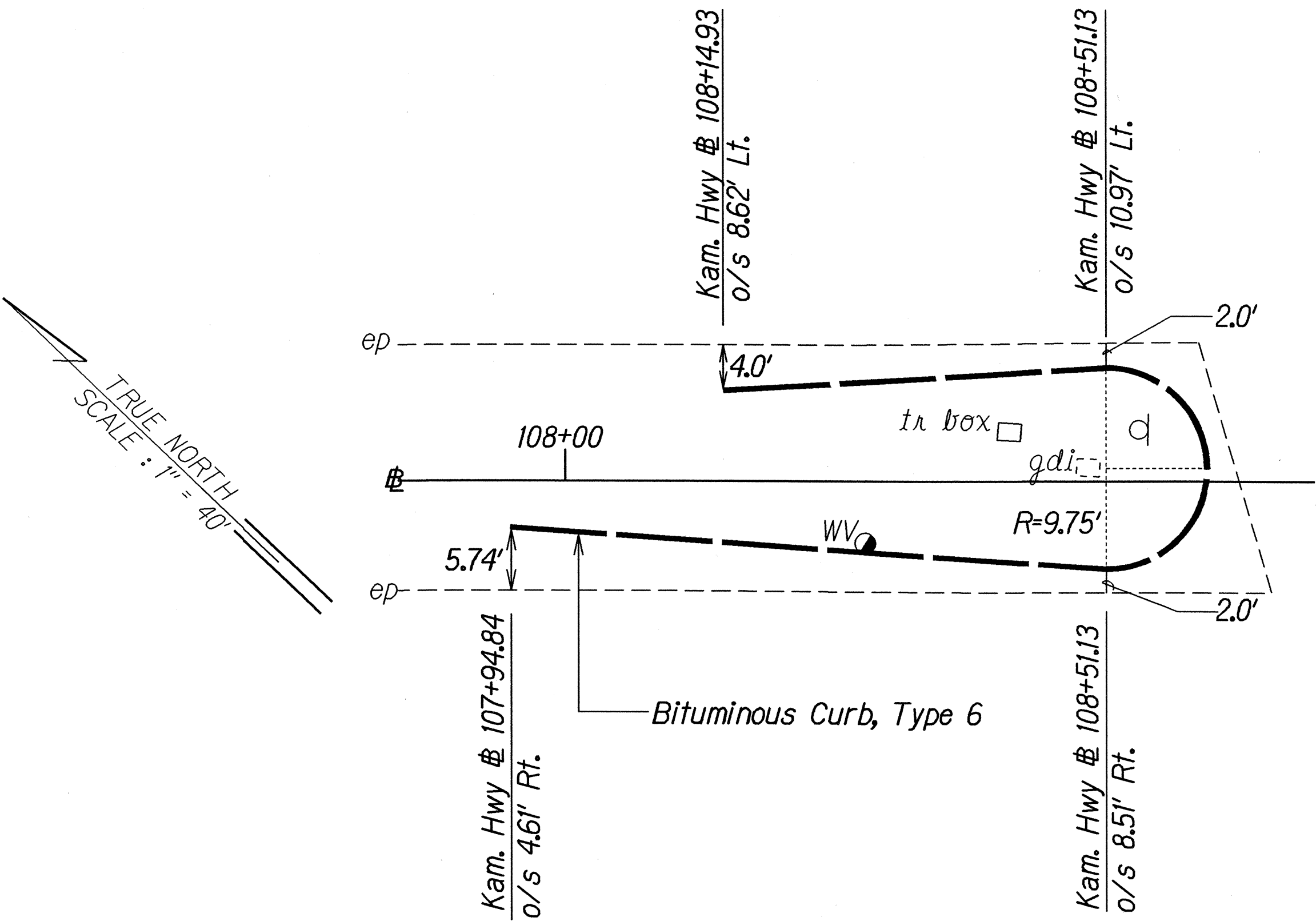

CURB MEDIAN DETAIL
Not to Scale

STATE OF HAWAII

DEPARTMENT OF TRANSPORTATION

HIGHWAYS DIVISION

TYPICAL DETAILS

KAMEHAMEHA HIGHWAY RESURFACING

Kahiko Street to Pali Highway

Project No. 83G-01-03M

Scale: 1/4" = 1'-0" Date: January, 2005

SHEET No. 1 OF 1 SHEETS

ORIGINAL PLAN	SURVEY PLOTTED BY	DATE
NOTE BOOK	DRAWN BY	
REVISIONS	CHECKED BY	
APPROVED BY		

FED. ROAD DIST. NO.	STATE	PROJ. NO.	FISCAL YEAR	SHEET NO.	TOTAL SHEETS
HAWAII	HAW.	83G-01-03M	2005	11	47

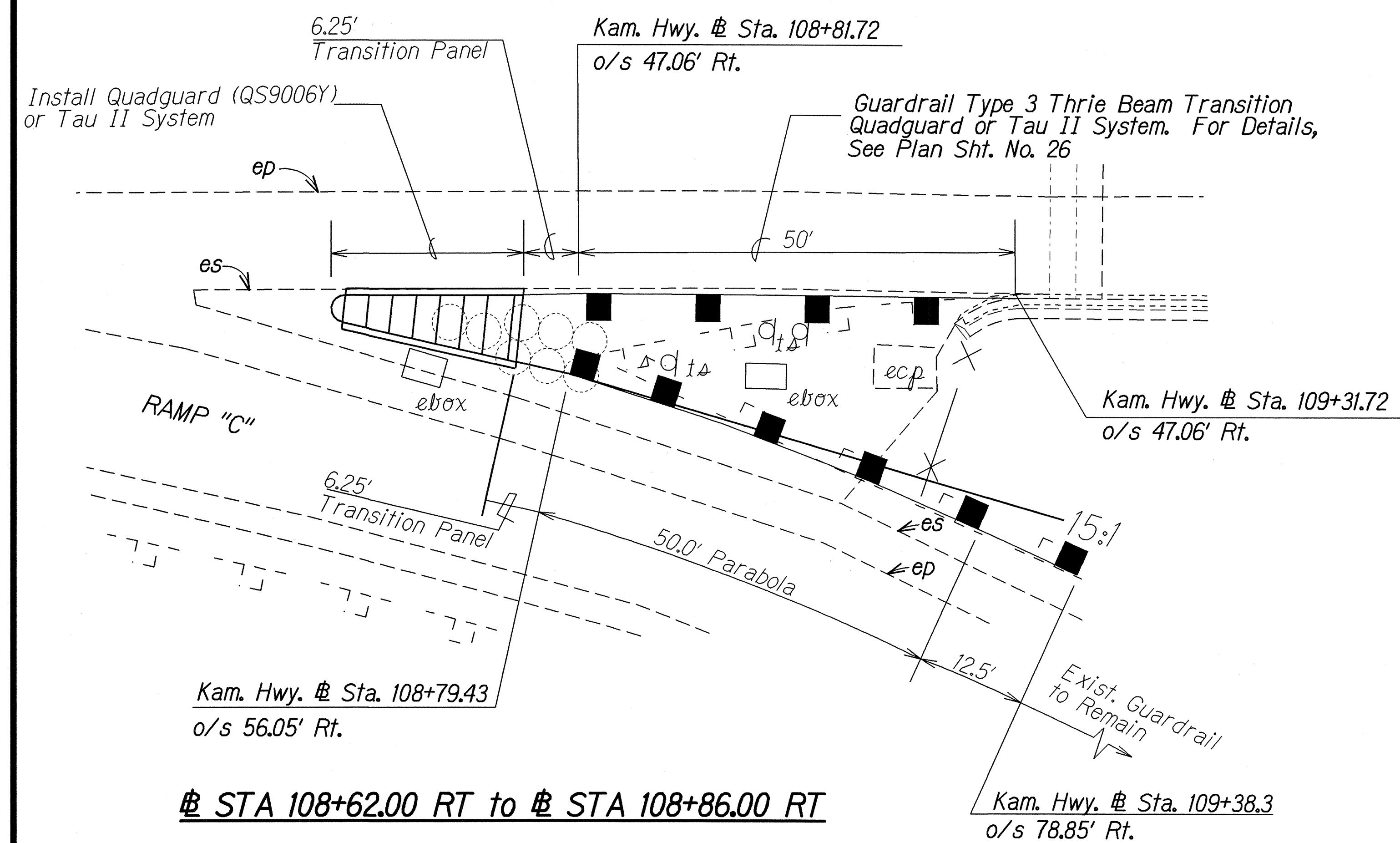

STA 108+62.00 RT to # STA 108+86.00 RT

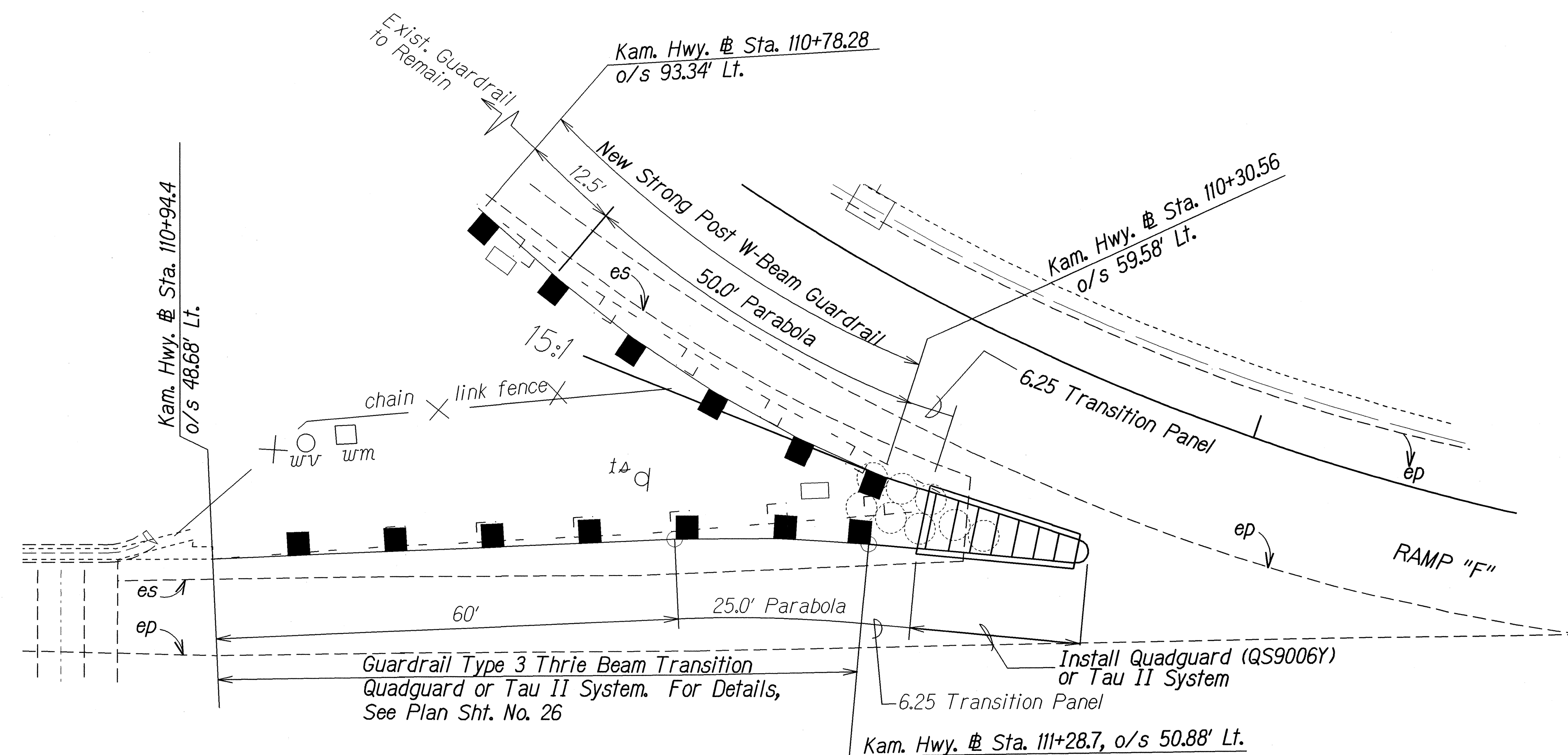

STA 111+26.00 LT to # STA 111+50.00 LT

NOTES

1. All work associated with the Quadguard System shall be as directed by the Engineer.
2. The transition panels required for the Quadguard System shall be considered incidental to the Quadguard System.
3. Removal and disposal of existing guardrail shall be considered incidental to the Quadguard System.

ORIGINAL	SURVEY PLOTTED BY	DATE
PLAN	DRAWN BY	
NOTE BOOK	DESIGNED BY	
001.kerachim	CHECKED BY	
001.kerachim		

STATE OF HAWAII
DEPARTMENT OF TRANSPORTATION
HIGHWAYS DIVISION

GUARDRAIL & QUADGUARD DETAILS

KAMEHAMEHA HIGHWAY RESURFACING
Kahiko Street to Pali Highway
Project No. 83G-01-03M

Scale: 1"=10' Date: January, 2005

SHEET No. 1 OF 1 SHEETS