

INDEX TO DRAWINGS	
SHEET NO.	DESCRIPTION
1	TITLE SHEET
2	STANDARD PLANS SUMMARY
3 - 5	CONSTRUCTION NOTES
6 - 7	WATER POLLUTION AND EROSION CONTROL NOTES
8	LEGEND
9 - 10	TYPICAL SECTIONS
11 - 12	GENERAL LAYOUT PLAN
13 - 21	ROADWAY PLANS
22	PAVEMENT MARKING LEGEND, DETAILS AND NOTES
23 - 27	PAVEMENT MARKING AND SIGNING PLANS
28	ROADWAY DETAILS
29	SIDEWALK DETAILS AND NOTES
30 - 33	DRAINAGE DETAILS
34 - 35	SITE SPECIFIC CURB RAMP DETAILS
36 - 41	CURB RAMP DETAILS
42 - 48	GUARDRAIL DETAILS
49	FLEAT-350 DETAILS
50 - 51	EROSION CONTROLS PLANS
52 - 53	CONSTRUCTION PHASING PLANS
54 - 63	TRAFFIC CONTROL PLANS
64	ELECTRICAL SYMBOLS, GENERAL NOTES
65	HECO NOTES
66 - 71	ELECTRICAL DEMOLITION PLANS
72 - 77	ELECTRICAL PLANS
78	ELECTRICAL SERVICE EQUIPMENT PLANS
79	TRAFFIC SIGNAL LOOP DETECTOR PLAN
80 - 81	PEDESTRIAN PUSHBUTTON PLAN
82	ELECTRICAL DIAGRAMS
83	ROADWAY LIGHTING FEEDERS AND TRAFFIC SIGNAL TIE CABLE DIAGRAMS
84	DUCT SECTIONS
85	EXCAVATION AND BACKFILLING SECTIONS
86	PULLBOX
87	ROADWAY LIGHT STANDARD
88	ROADWAY LIGHT ON UTILITY POLE, SCHOOL WARNING LIGHT
89	LIGHT STANDARD SETBACK CONDITIONS
90	RAISED HANDHOLE ADJUSTMENT, DUCT SECTION, LIGHT STANDARD PLAN
91	ELECTRICAL EQUIPMENT ELEVATIONS, POST BARRIER
92	ELECTRICAL EQUIPMENT CABINETS
93	PEDESTRIAN PUSHBUTTON
94	LOOP DETECTOR DETAILS
95	BORING LOG LEGEND, GEOTECHNICAL NOTES
96 - 98	BORING LOGS

STATE OF HAWAII  
DEPARTMENT OF TRANSPORTATION  
HIGHWAYS DIVISION  
HONOLULU, HAWAII  
**"AS-BUILT"**  
PLANS FOR  
**KAHEKILI HIGHWAY  
LIGHTING IMPROVEMENTS  
HAIKU ROAD TO AHUIMANU PLACE**  
**PROJECT NO. 83F-02-00M**  
DISTRICT OF KOOLAUPOKO  
ISLAND OF OAHU

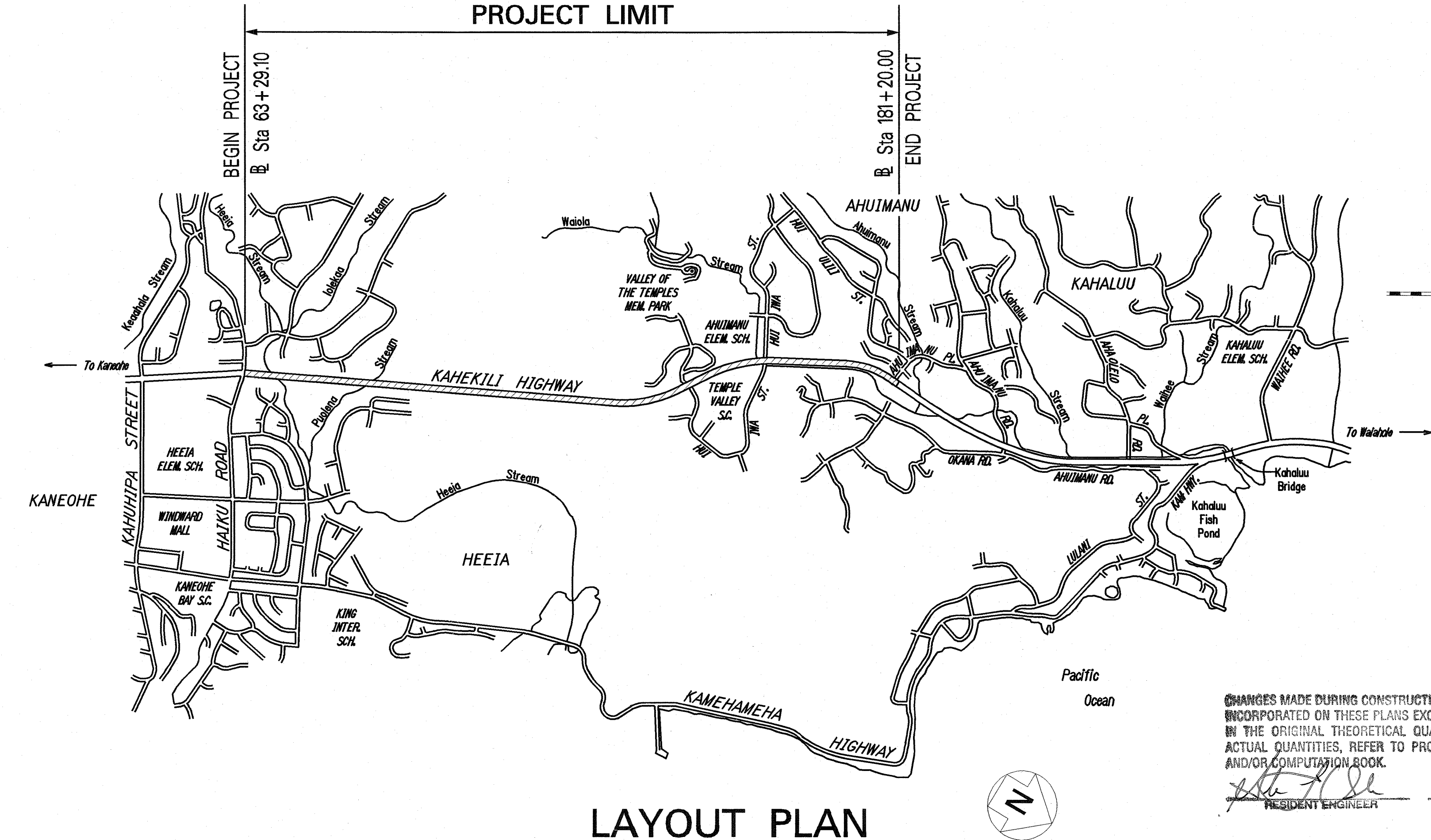

LAYOUT PLAN

LENGTH OF PROJECT ..... 2.23 MILES

FED. ROAD DIST. NO.	STATE	PROJ. NO.	FISCAL YEAR	SHEET NO.	TOTAL SHEETS
HAWAII	HAW.	83F-02-00M	2004	1	98

LOCATION OF PROJECT

SCALE IN MILES

MILE POST 39.59 TO MILE POST 37.36

CHANGES MADE DURING CONSTRUCTION HAVE BEEN INCORPORATED ON THESE PLANS EXCEPT CHANGES IN THE ORIGINAL THEORETICAL QUANTITIES. FOR ACTUAL QUANTITIES, REFER TO PROJECT LEDGER AND/OR COMPUTATION BOOK.

RESIDENT ENGINEER

DATE

DEPARTMENT OF TRANSPORTATION  
STATE OF HAWAII

APPROVED:   
DIR. OF TRANSPORTATION

9/5/03  
DATE

RONALD N.S. HO & ASSOC. DESIGNED BY  
HWY-DD MANAGED BY  
692-7570 PHONE  
AUGUST, 2003 DATE