

FED. ROAD DIST. NO.	STATE	PROJ. NO.	FISCAL YEAR	SHEET NO.	TOTAL SHEETS
HAWAII	HAW.	83F-02-00M	2004	50	98

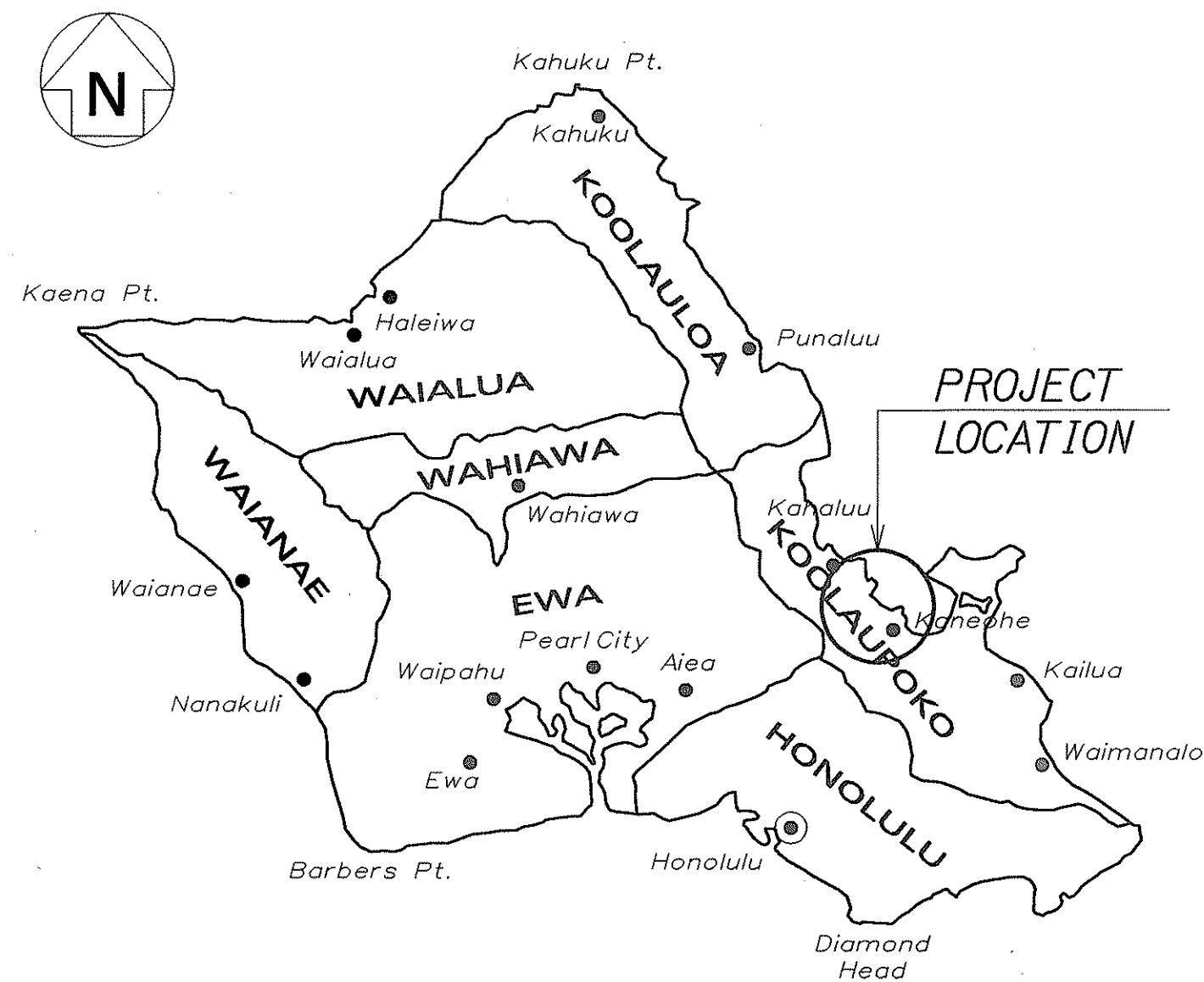

### ISLAND OF OAHU

**VICINITY MAP**  
Not to Scale

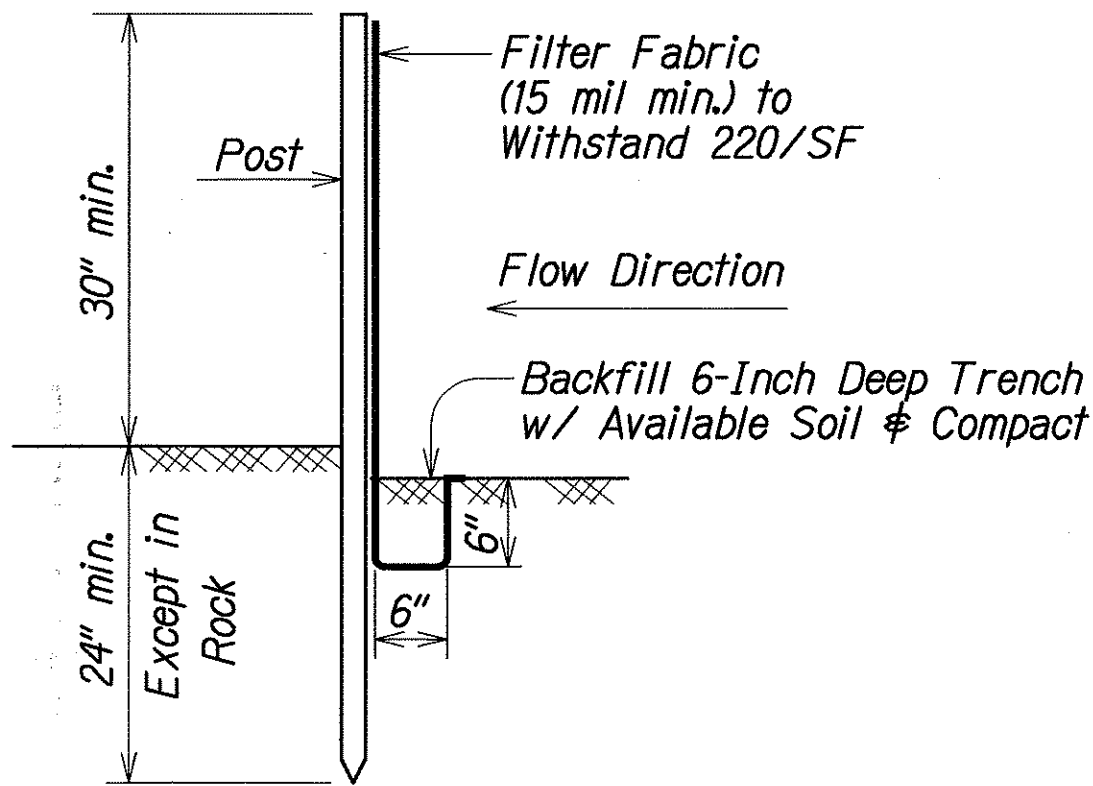

**SILT FENCE DETAIL**  
Not to Scale

#### Silt Fence Notes:

1. Fabric shall be of the type specified and installed in combination with support a net of polyester netting or approved equal. The fabric shall be a minimum of 36" wide and the support net a minimum of 30 inches.
  2. If silt fence is obtained from manufacturer as a package (i.e. fabric attached to posts) the manufacturer's installation instructions shall be adhered to.
  3. Posts shall be metal (\*) wherever possible. Cross section of post shall be substantial enough to support a loaded silt fence without bending. Post spacing shall be 4' to 8' depending on post size.
- (\*) Some manufacturers only supply silt fence with wooden posts. Precautions shall be taken to avoid damages from driving the posts into hard ground or from termites.

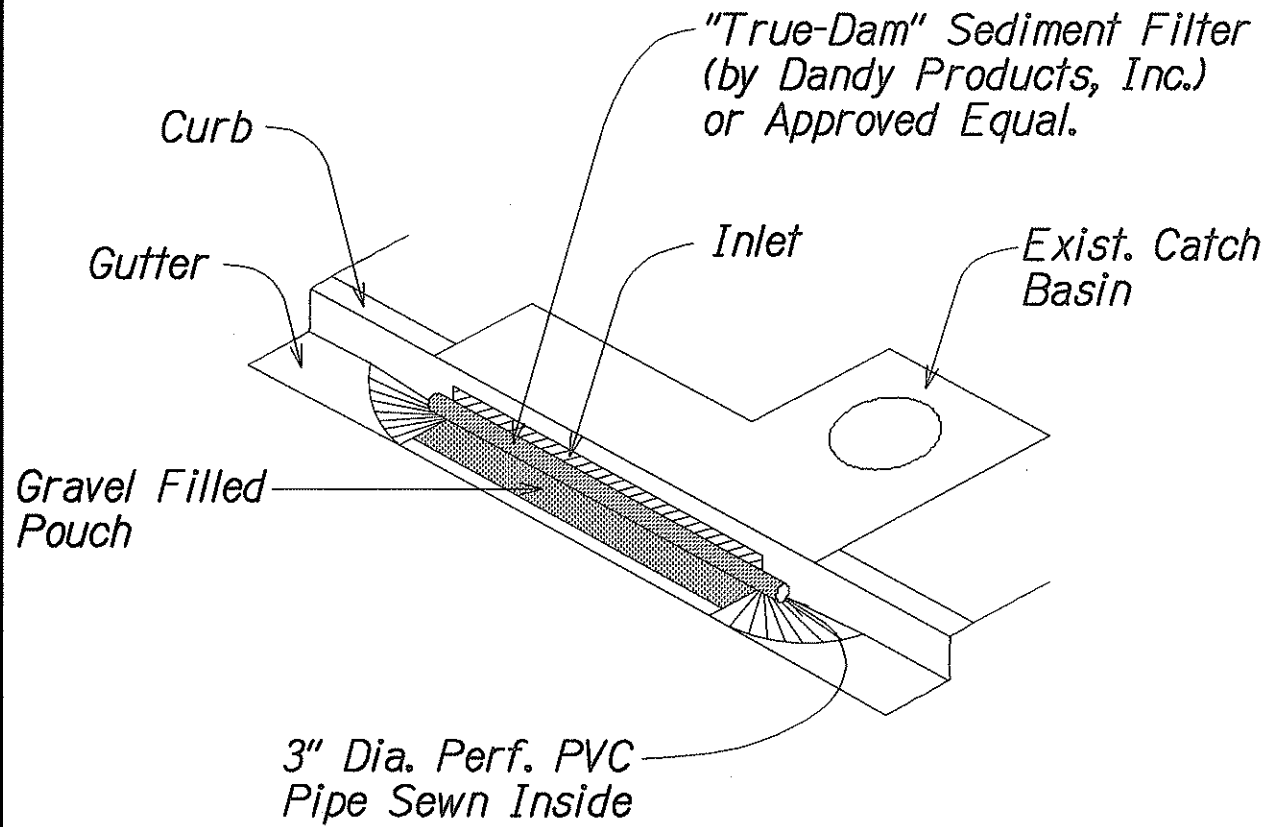

#### Note:

Sediment control filters shall be installed and maintained on all new and existing catch basins within the vicinity of the project until permanent ground cover is established.

**SILT BARRIER AT CATCH BASIN**  
Not to Scale

#### Best Management Practices (BMP's):

1. Silt fence shall be installed at the locations shown and/or as directed by the Engineer.
2. Dust control by means of frequent watering shall be employed to reduce dust emissions.
3. All storm drain inlets within the project limits, and those off site which may receive runoff from the site shall be protected with an inlet protective device.
4. All Best Management Practices (BMP's) facilities shall not be removed until all permanent erosion controls or ground cover is in place and established.
5. Install pollution control measures at other locations when necessary, including staging area/yard.
6. Measures shown on the plans are minimum requirements.
7. Contractor is directed to Water Pollution and Erosion Control Notes and BMP requirements.

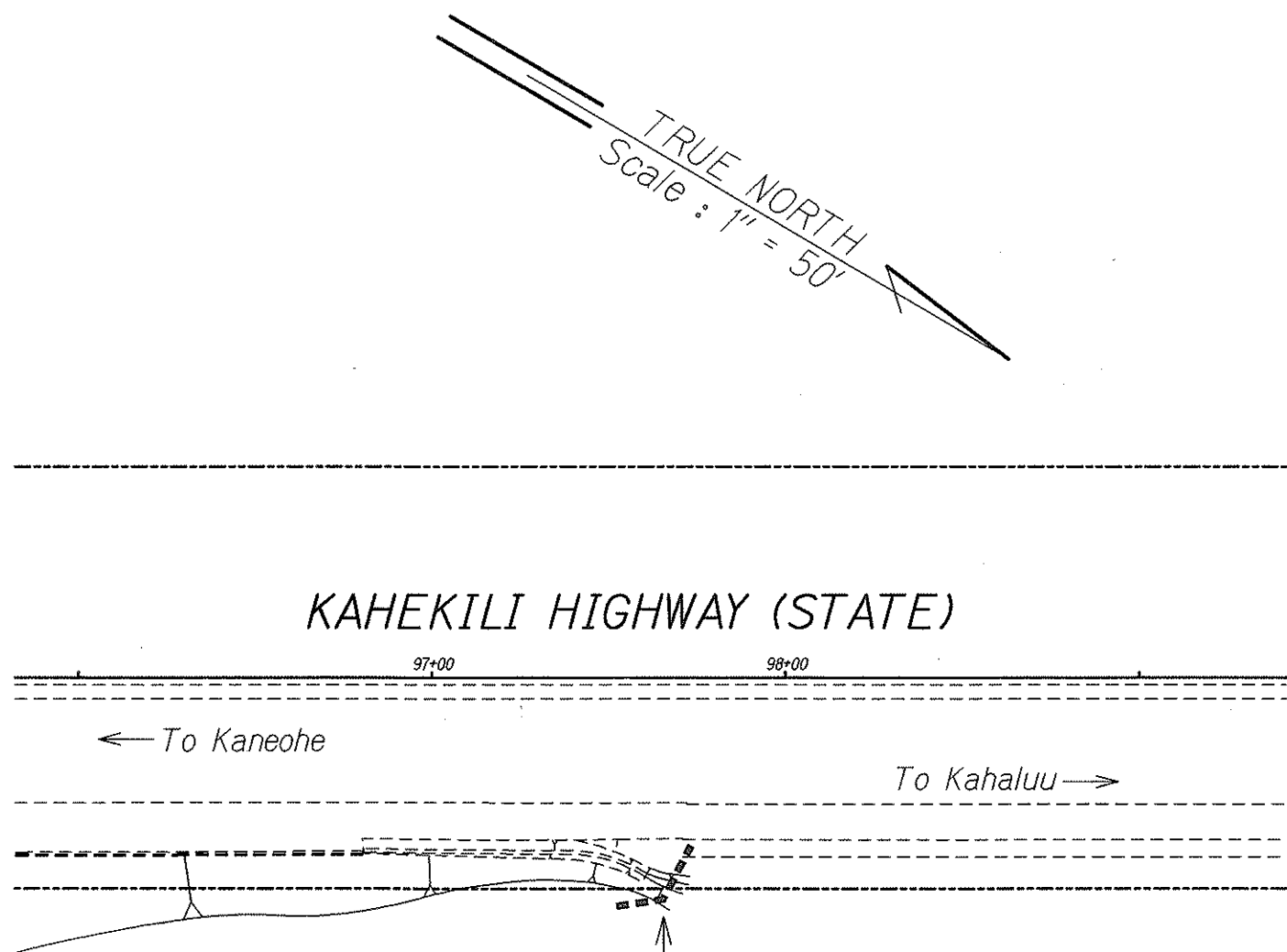

⊕ Sta. 97+65± Rt.  
Install Silt Fence at  
Bottom of Concrete Swale

**EROSION CONTROL PLAN**  
Scale: 1" = 50'

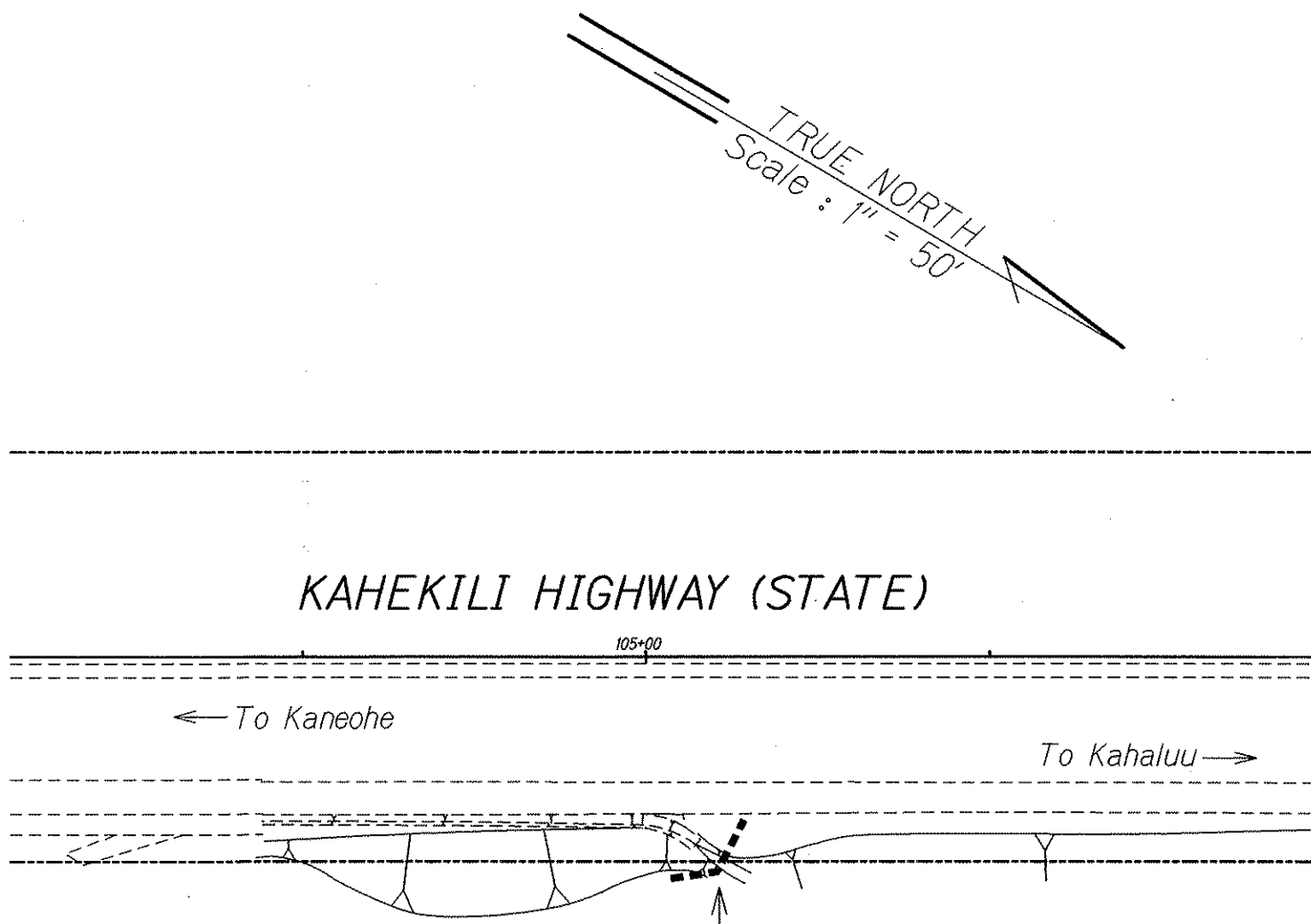

⊕ Sta. 105+20± Rt.  
Install Silt Fence at  
Bottom of Concrete Swale

**EROSION CONTROL PLAN**  
Scale: 1" = 50'

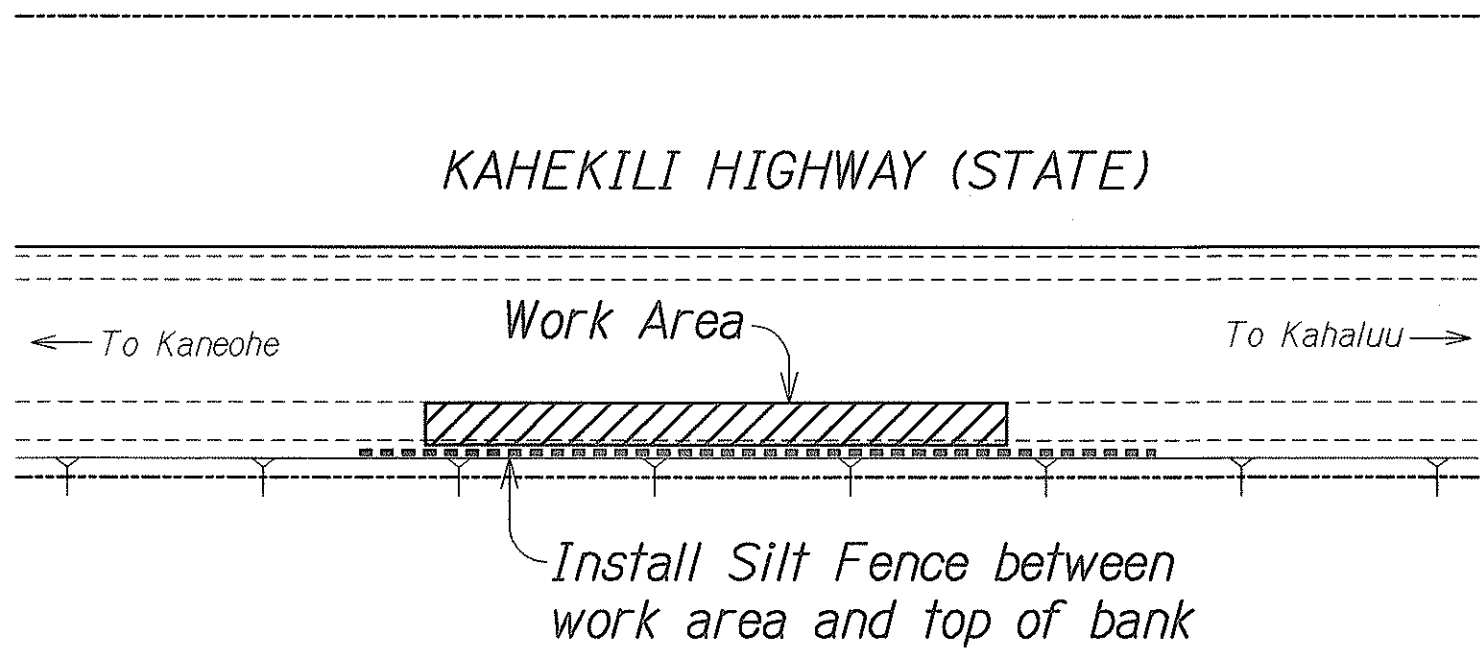

**TYPICAL EROSION CONTROL PLAN**  
WHERE WORK AREAS ARE ADJACENT TO FILL SLOPE  
Not to Scale



THIS WORK WAS PREPARED BY ME  
OR UNDER MY SUPERVISION AND  
CONSTRUCTION OF THIS PROJECT  
WILL BE UNDER MY OBSERVATION  
  
Glenn K. Ikeda  
Professional Engineer  
License Expires: 4-30-04

STATE OF HAWAII  
DEPARTMENT OF TRANSPORTATION  
HIGHWAYS DIVISION

### EROSION CONTROL PLAN

**KAHEKILI HIGHWAY LIGHTING IMPROVEMENTS**  
Haiku Road to Ahuimanu Place  
Project No. 83F-02-00M

Scale: As Noted Date: Sept. 2002

SHEET No. 1 OF 2 SHEETS

FED. ROAD DIST. NO.	STATE	PROJ. NO.	FISCAL YEAR	SHEET NO.	TOTAL SHEETS
HAWAII	HAW.	83F-02-00M	2004	51	98

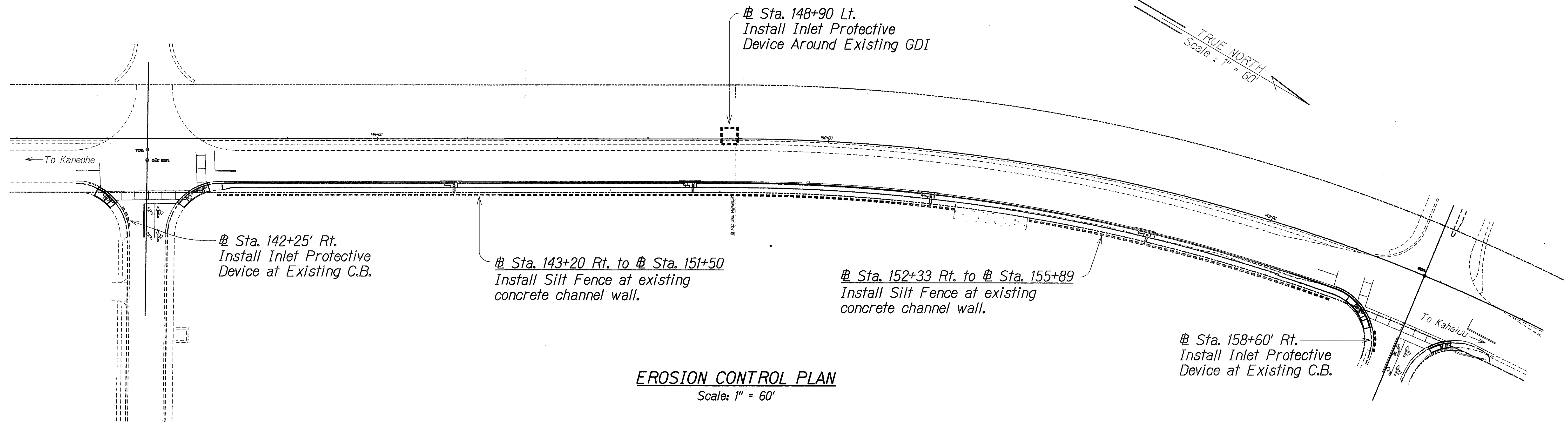

**EROSION CONTROL PLAN**  
Scale: 1" = 60'

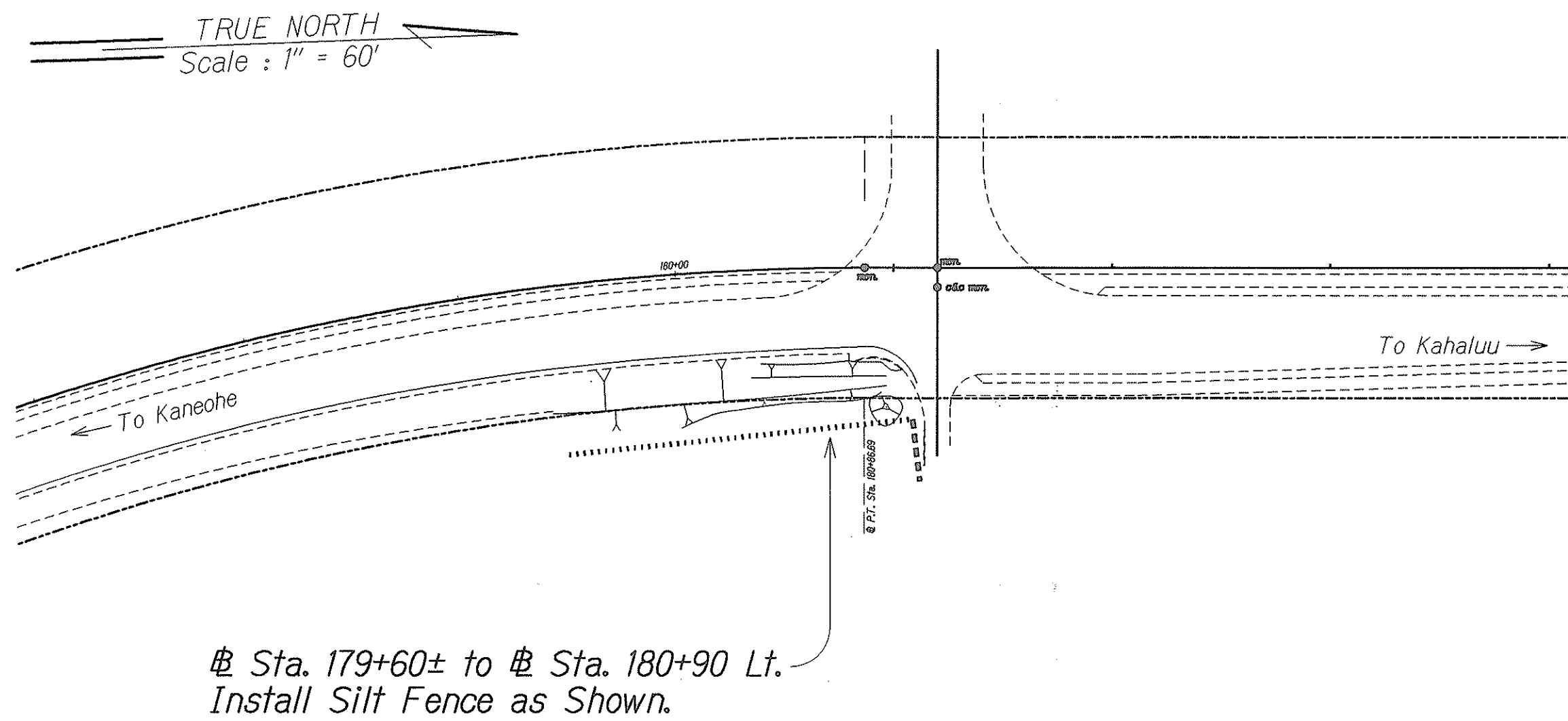

**EROSION CONTROL PLAN**  
Scale: 1" = 60'

ORIGINAL PLAN	SURVEY PLOTTED BY	DATE
NOTE BOOK	DRAWN BY	
	DESIGNED BY	
	QUANTITIES BY	
	CHECKED BY	



THIS WORK WAS PREPARED BY ME  
OR UNDER MY SUPERVISION AND  
CONSTRUCTION OF THIS PROJECT  
WILL BE UNDER MY OBSERVATION  
  
*Glenn K. Ikeda*  
Glenn K. Ikeda, Inc.  
400 PARK ENGINEERING  
LICENSE EXPIRES: 4-30-04

STATE OF HAWAII  
DEPARTMENT OF TRANSPORTATION  
HIGHWAYS DIVISION  
**EROSION CONTROL PLAN**  
  
KAHEKILI HIGHWAY LIGHTING IMPROVEMENTS  
Haiku Road to Ahuimanu Place  
Project No. 83F-02-00M  
Scale: As Noted Date: Sept. 2002  
SHEET No. 2 OF 2 SHEETS