

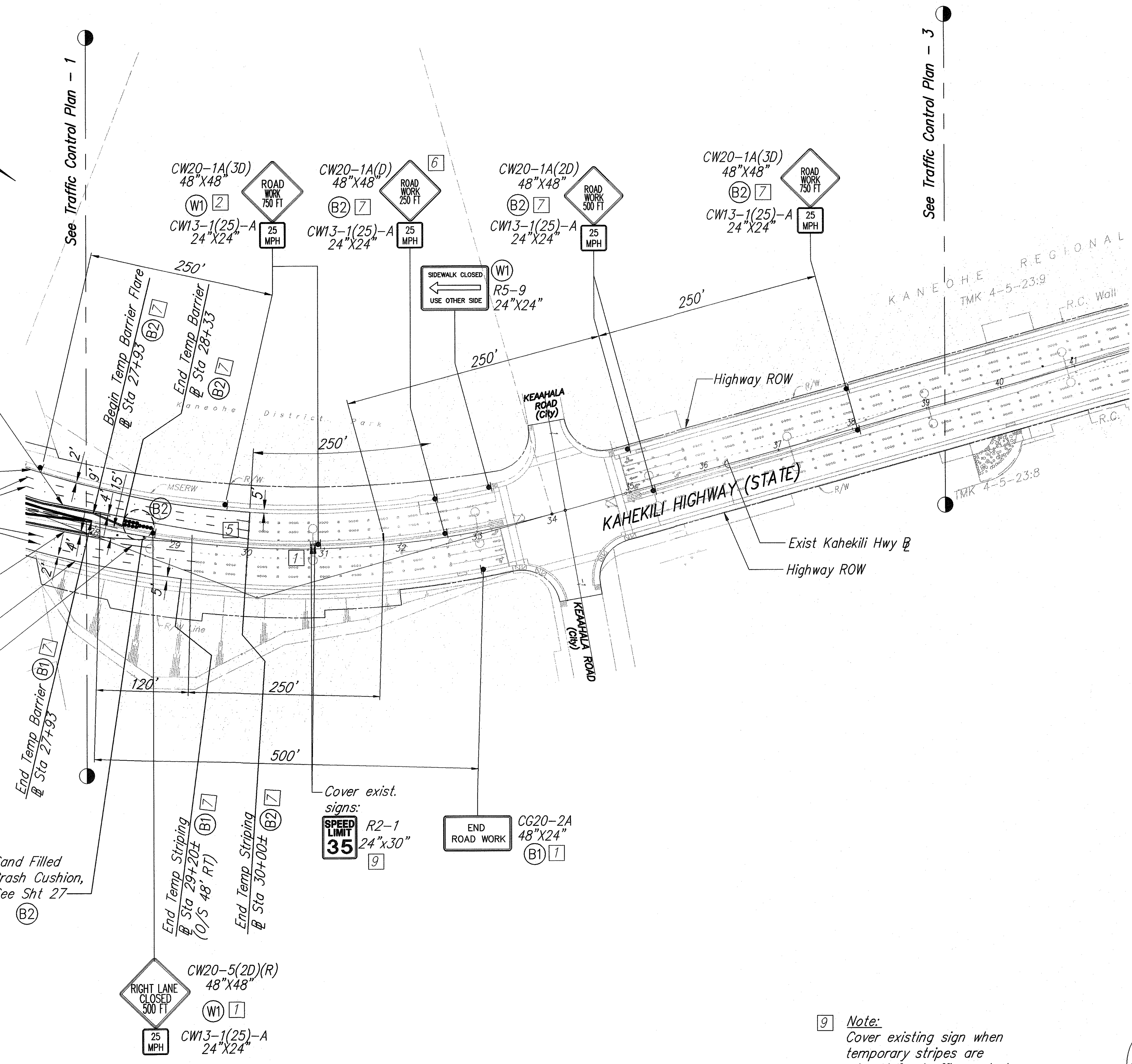

FED. ROAD DIST. NO.	STATE	FED. AID PROJ. NO.	FISCAL YEAR	SHEET NO.	TOTAL SHEETS
HAWAII	HAWAII	NH-083-1(49)	2003	C.O. 24	78

- 4" Solid Yellow Stripe o/s 2' From Face of Concrete Barrier
- 4" Solid White Stripe o/s 2' (Min.) From Face of Curb
- 4" White Stripe 10' Feet Long at 30' Spacing w/ Type C Pavement Markers @ 40'-0" O.C.
- 4" Solid Yellow Stripe o/s 2' From Face of Concrete Barrier
- 4" Solid White Stripe o/s 2' (Min.) From Face of Curb
- 4" White Guide Lines



9 Note:  
Cover existing sign when temporary stripes are placed for traffic control.



This work was prepared by me or under my supervision and construction of this project will be under my observation. (Observation of construction as defined in Chapter 16-115, Subchapter 1, Definitions of the Hawaii Administrative Rules, "Professional Engineers, Architects, Surveyors, and Landscape Architects.")

Signature: *Edward H. Iida*  
Date: 4/30/2004  
Expiration date of the license

NOTE: Contractor to check and verify dimensions at job before proceeding with work.

TRAFFIC CONTROL PLAN - 2  
Scale: 1" = 80'

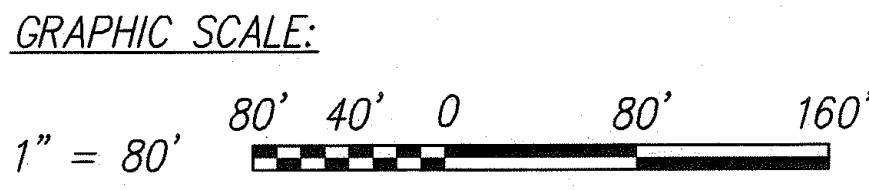

DATE	REVISIONS
02/18/05	9 Added note
12/17/04	8 Added Signs and moved Traffic Notes and Legend to Sht. C.O.-28
09/08/04	7 Revised Signs, Revised Conc. Barrier Locations, Added Striping
	6 Revised sign
	5 Replaced cones with barricades
	4 Added to Legend
	3 Added note
	2 Revised sign
05/07/03	1 Added sign

STATE OF HAWAII  
DEPARTMENT OF TRANSPORTATION  
HIGHWAYS DIVISION

**TRAFFIC CONTROL PLAN - 2**

**KAHEKILI HIGHWAY LANDSCAPING**  
Kulukee Street to Vicinity of Haiku Road  
Federal Aid Project No. NH-083-1(49)  
Scale: As Noted Date: Apr. 2002

SHEET No. 2 OF 6 SHEETS

ORIGINAL PLAN	DATE
DESIGNED BY E. IIDA	12/02
DRAWN BY J. BACULAR	12/02
CHECKED BY E. IIDA	12/02
NOTED BY	
DATE	





FED. ROAD DIST. NO.	STATE	FED. AID PROJ. NO.	FISCAL YEAR	SHEET NO.	TOTAL SHEETS
HAWAII	HAWAII	NH-083-1(49)	2003	C.O. 26	78

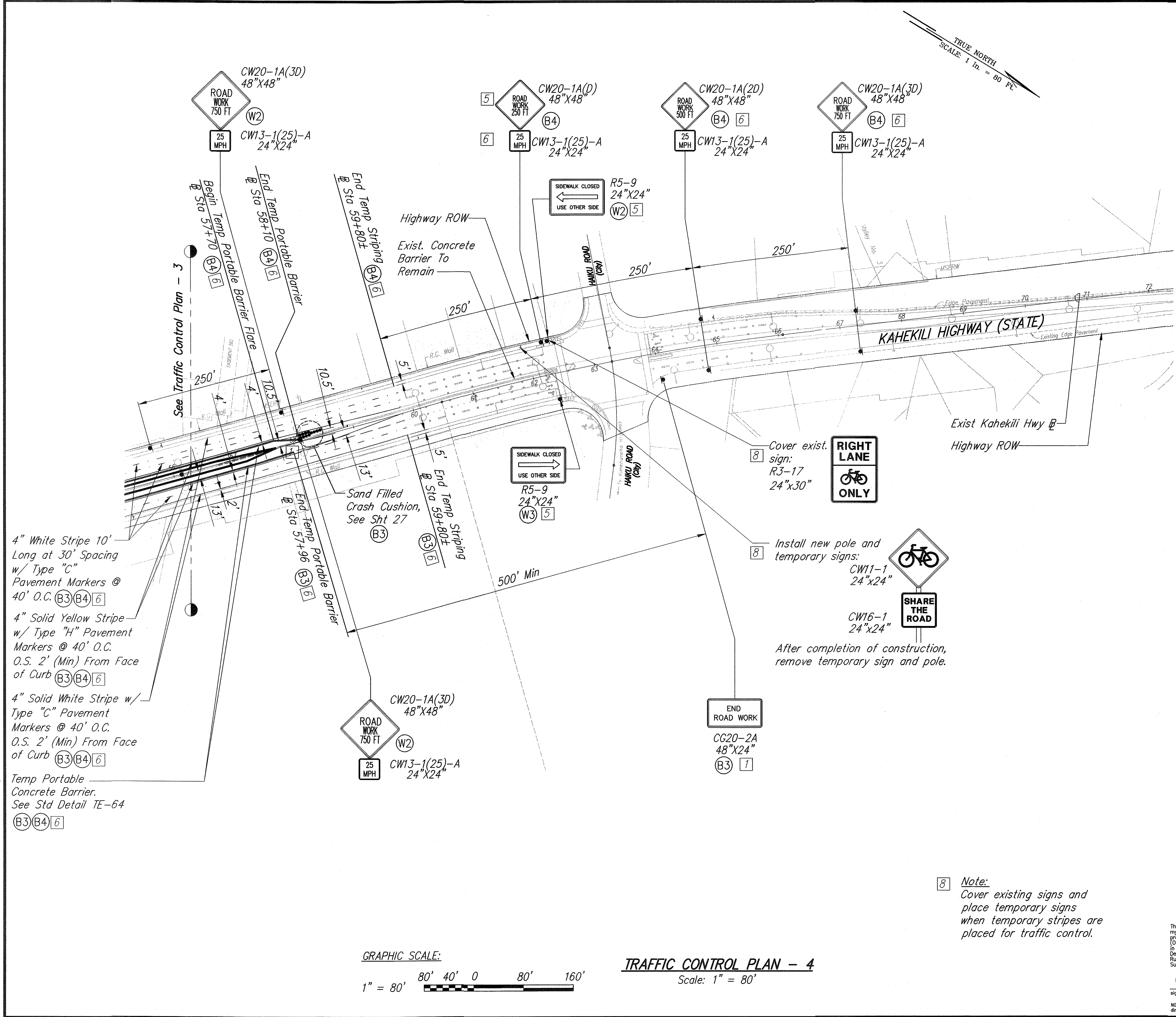

DESIGNED BY	12/02
TRACED BY	12/02
QUANTITIES BY	12/02
CHECKED BY	12/02

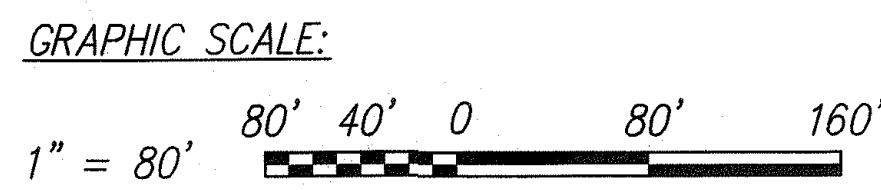

**TRAFFIC CONTROL PLAN - 4**  
Scale: 1" = 80'

**Note:**  
Cover existing signs and place temporary signs when temporary stripes are placed for traffic control.

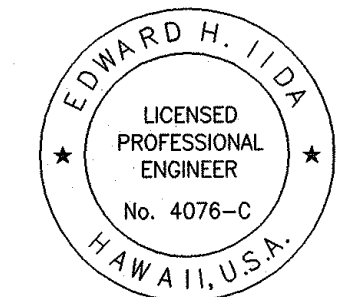

This work was prepared by me or under my supervision and construction of this project will be under my observation. (Observation of construction as defined in Chapter 16-115, Subchapter 1, Definitions of the Hawaii Administrative Rules, "Professional Engineers, Architects, Surveyors, and Landscape Architects.")  
signature  
expiration date of the license

DATE	REVISIONS
02/18/05	[8] Revised signs and added note
12/17/04	[7] Added Signs and moved Traffic Notes and Legend to Sht. C.O.-28
09/08/04	[6] Revised Signs, Revised Conc. Barrier Locations, Added Striping
	[5] Revised sign
	[4] Replaced cones with barricades
	[3] Added to Legend
	[2] Added note
05/07/03	[1] Added sign
STATE OF HAWAII DEPARTMENT OF TRANSPORTATION HIGHWAYS DIVISION  <b>TRAFFIC CONTROL PLAN - 4</b>  <b>KAHEKILI HIGHWAY LANDSCAPING</b> <b>Kulukee Street to Vicinity of Haiku Road</b> <b>Federal Aid Project No. NH-083-1(49)</b> <b>Scale: As Noted Date: Apr. 2002</b>	
SHEET No. <b>4</b> OF <b>6</b> SHEETS	



FED. ROAD DIST. NO.	STATE	FED. AID PROJ. NO.	FISCAL YEAR	SHEET NO.	TOTAL SHEETS
HAWAII	HAWAII	NH-083-1(49)	2003	C.O. 27	78

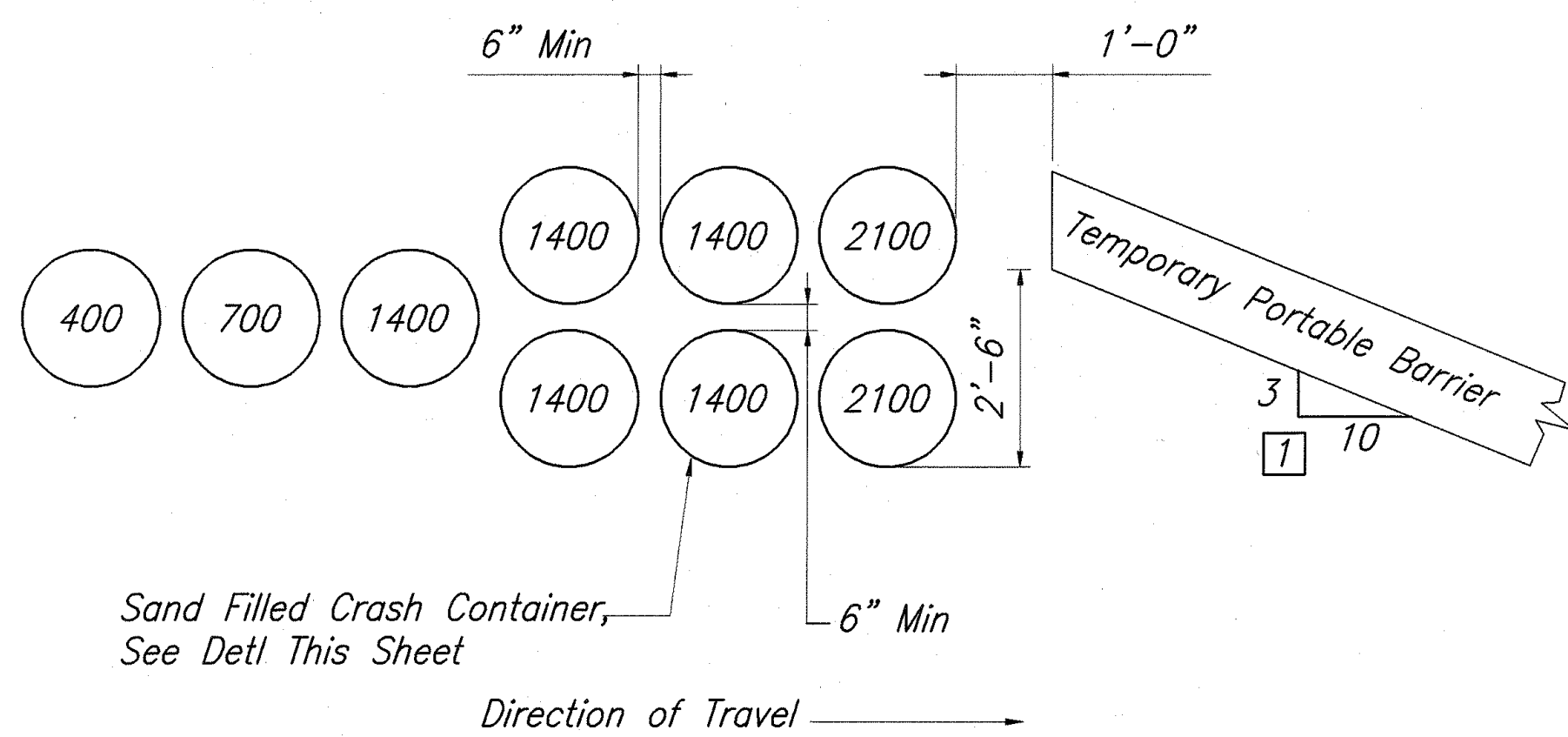

CRASH CUSHION ARRAY DETAIL  
(Approach Speed 45 MPH Or Greater)  
NCHRP 350 Compliant Attenuator Array  
Not To Scale

- Notes:
1. (xxx) indicates module location and weight of sand in pounds for each module.
  2. All sand weights are nominal.
  3. Each module is to contain amount of sand indicated, supported according to the manufacturer's instructions.
  4. Modules shall be placed on asphalt concrete, epoxy mortar or concrete surface.
  5. Weight of sand and outline of each module shall be painted on the surface of each module location.
  6. Modules shall be Energy Absorption Systems Energite III or approved equivalent.

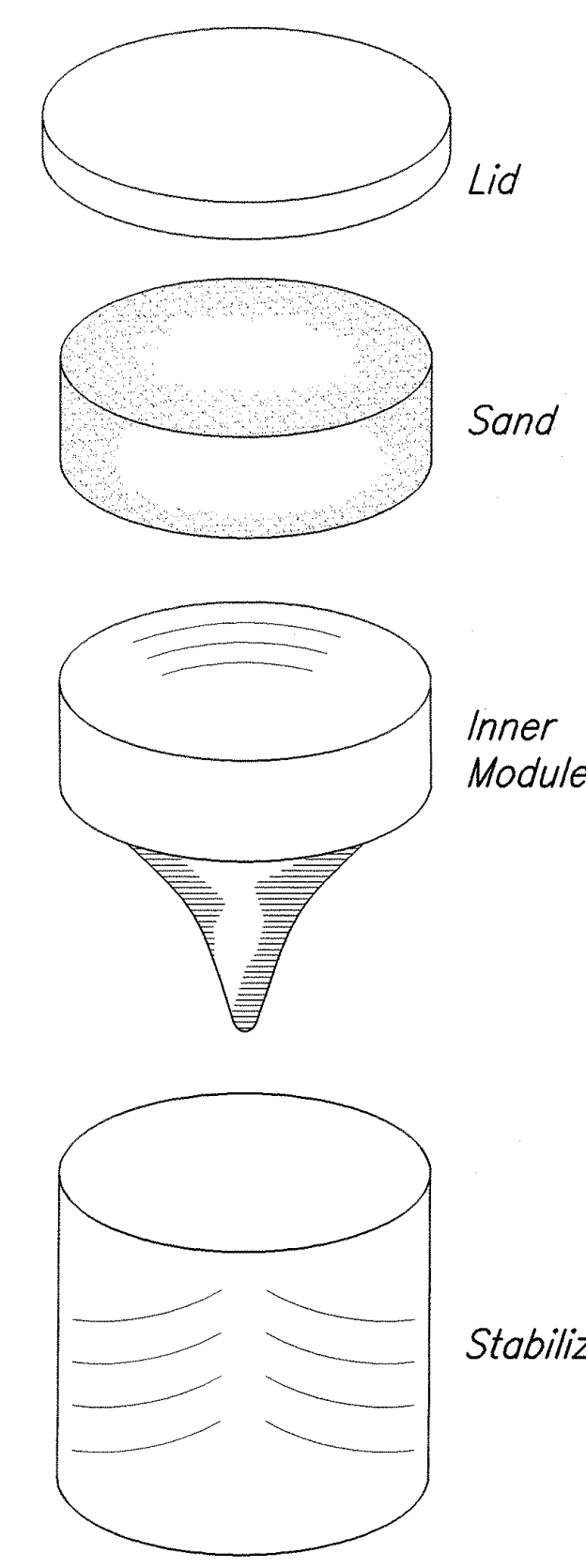

- Notes:
1. Standard size of stabilizer: 36" diameter top, 32" diameter base with 35 3/4" height.
  2. Standard weights of modules are 200, 400, 700 and 1400 pounds.
  3. Design vehicle weights are 2250 pounds and 4500 pounds. (1021 kg and 2041 kg respectively)
  4. Design initial impact speed is 45 m.p.h. (72.45 km/h)
  5. Payment for relocations of temporary inertial barriers for the different construction phases shall be incidental to Contract Item No. 645.0200, Additional Traffic Control Devices.

SAND FILLED CRASH CONTAINER DETAIL  
Not To Scale

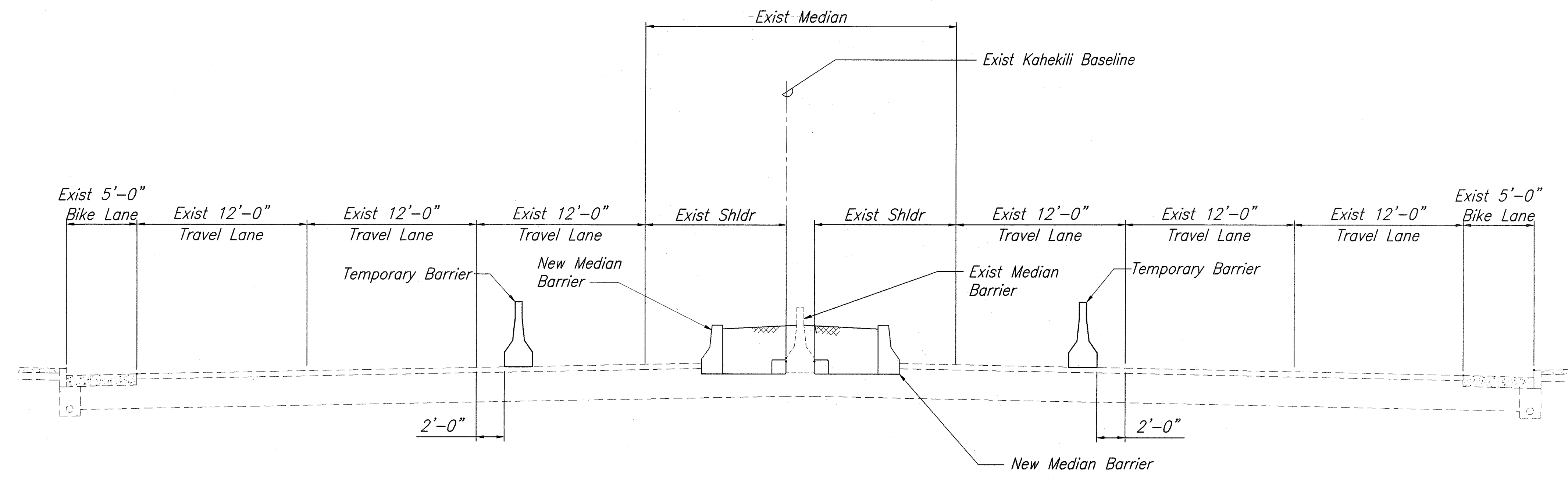

Typ Cross Section - Traffic Control For Median Barrier Construction  
Scale: 1" = 5'-0"

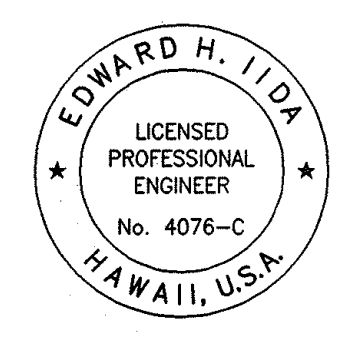

THIS WORK WAS PREPARED BY ME OR UNDER MY SUPERVISION  
Date: Apr. 2002  
MITSUNAGA & ASSOCIATES

05/07/03	1 Added taper rate
DATE	REVISIONS
STATE OF HAWAII DEPARTMENT OF TRANSPORTATION HIGHWAYS DIVISION <b>TRAFFIC CONTROL PLAN - 5</b> <b>CRASH CUSHION DETAIL</b> KAHEKILI HIGHWAY LANDSCAPING Kulukee Street to Vicinity of Haiku Road Federal Aid Project No. NH-083-1(49) Scale: As Noted SHEET No. 5 OF 5 SHEETS	

SURVEY PLOTTED BY	DATE
DESIGNED BY	12/02
TRACED BY	12/02
NOTE BOOK	12/02
CHECKED BY	12/02