

FED. ROAD DIST. NO.	STATE	FED. AID PROJ. NO.	FISCAL YEAR	SHEET NO.	TOTAL SHEETS
HAWAII	HAW.	NH-083-1(46)	2002	14	89

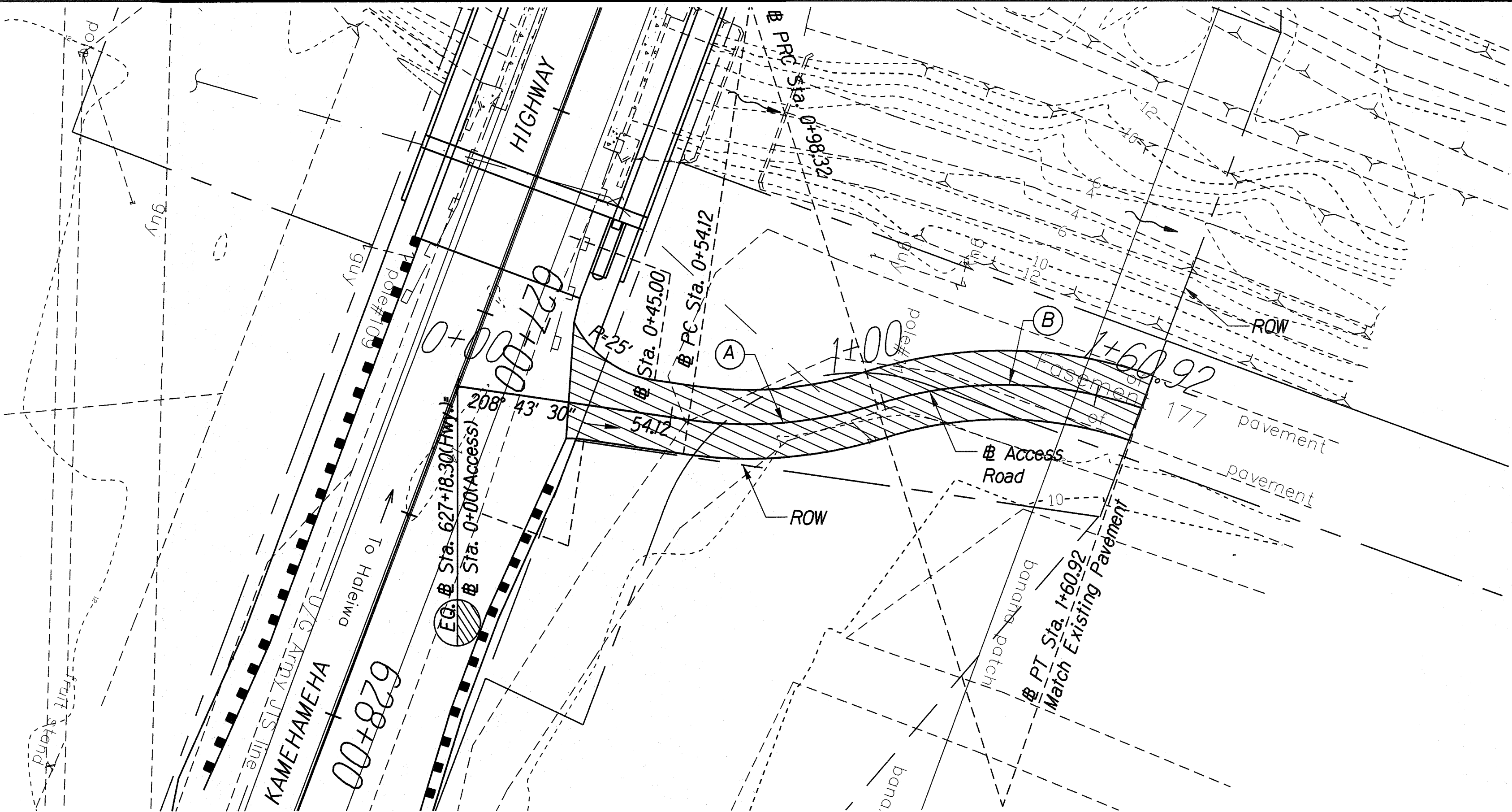

PLAN
Scale: 1"=20'

(A) CURVE DATA

Δ = 25° 50' 38"
Δ/2 = 12° 55' 19"
R = 98.00
T = 22.48
Ch = 43.83
Lc = 44.20

(B) CURVE DATA

Δ = 36° 35' 57"
Δ/2 = 18° 17' 58.5"
R = 98.00
T = 32.41
Ch = 61.54
Lc = 62.60

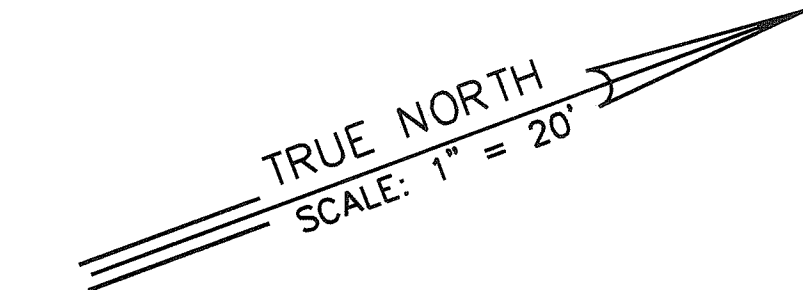

NOTE
All Kamehameha Highway Stationing Shown on this Sheet is Off by 3.23'. To Obtain Current D.O.T. Highways Stationing, Subtract 3.23' from any Station Shown.

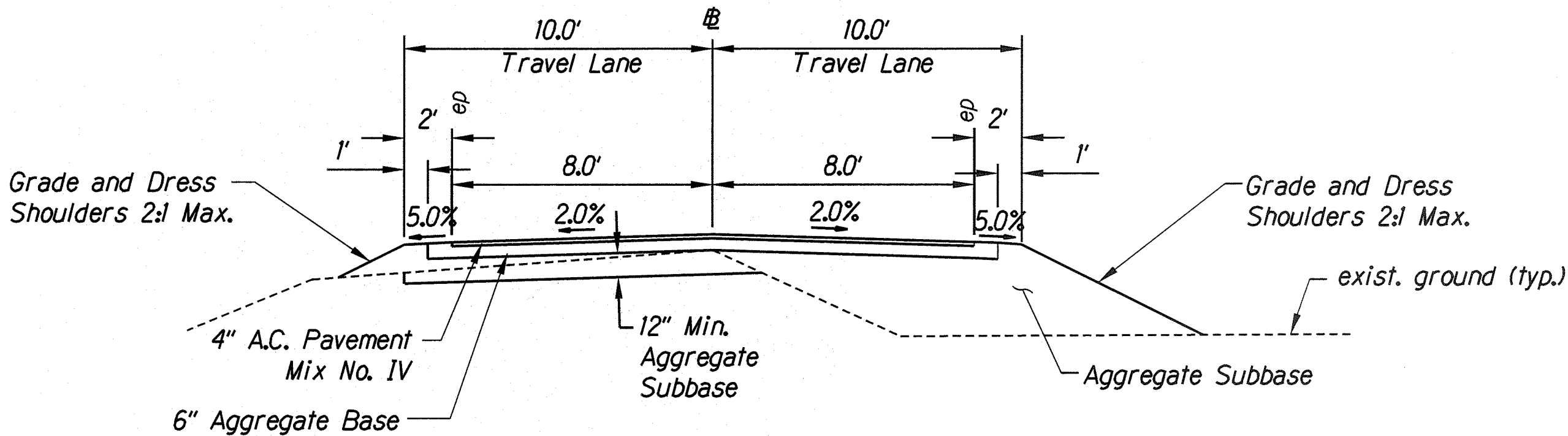

TYPICAL WWTP ACCESS ROAD SECTION
Not to Scale

ORIGINAL PLAN	SURVEY PLOTTED BY	DATE
NOTE BOOK	DRAWN BY	
	DESIGNED BY	
	QUANTITIES BY	
	CHECKED BY	

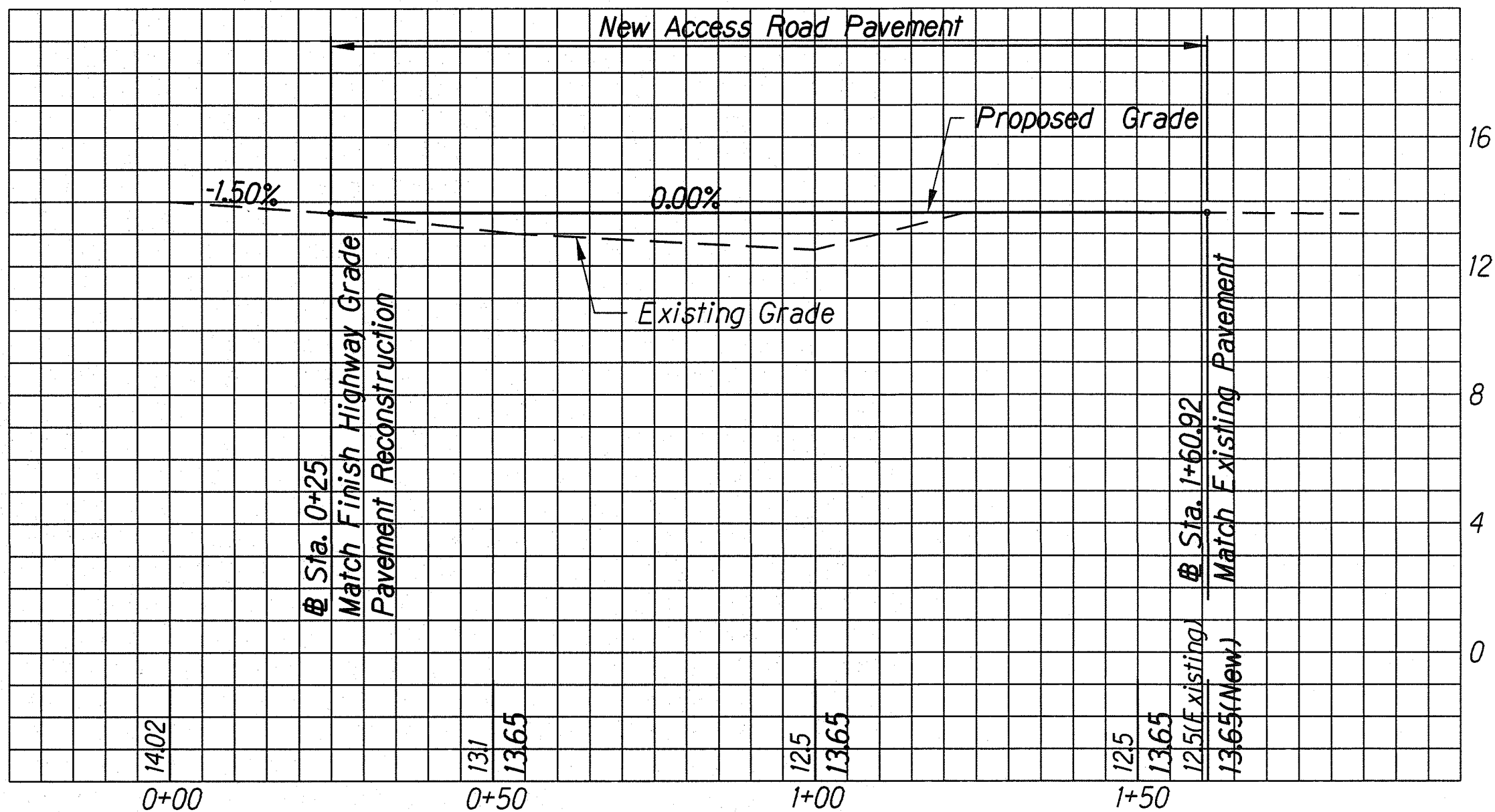

PROFILE
Scale: Horiz. 1"=20'
Vert. 1"=4'

Director, Dept. of Environmental Services Date

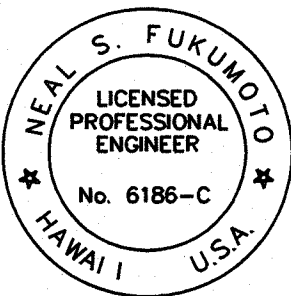

This work was prepared by me or under my supervision.
Exp. 04-30-10
Neal S. Fukumoto
Wesley R. Segawa & Associates, Inc.

STATE OF HAWAII
DEPARTMENT OF TRANSPORTATION
HIGHWAYS DIVISION
**WWTP ACCESS ROAD
PLAN, PROFILE & SECTION**
KAMEHAMEHA HIGHWAY DRAINAGE IMPROVEMENTS
Vicinity of Kahuku Hospital and Replacement of Kii Bridge
Federal Aid Project No. NH-083-1(46)
Scale: As Noted Date: April 2004
SHEET NO. 1 OF 1 SHEETS

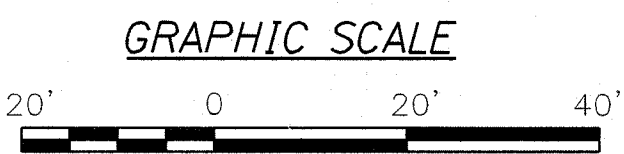

AS-BUILT