

FED. ROAD DIST. NO.	STATE	FED. AID PROJ. NO.	FISCAL YEAR	SHEET NO.	TOTAL SHEETS
HAWAII	HAW.	NH-083-1(46)	2002	83	89

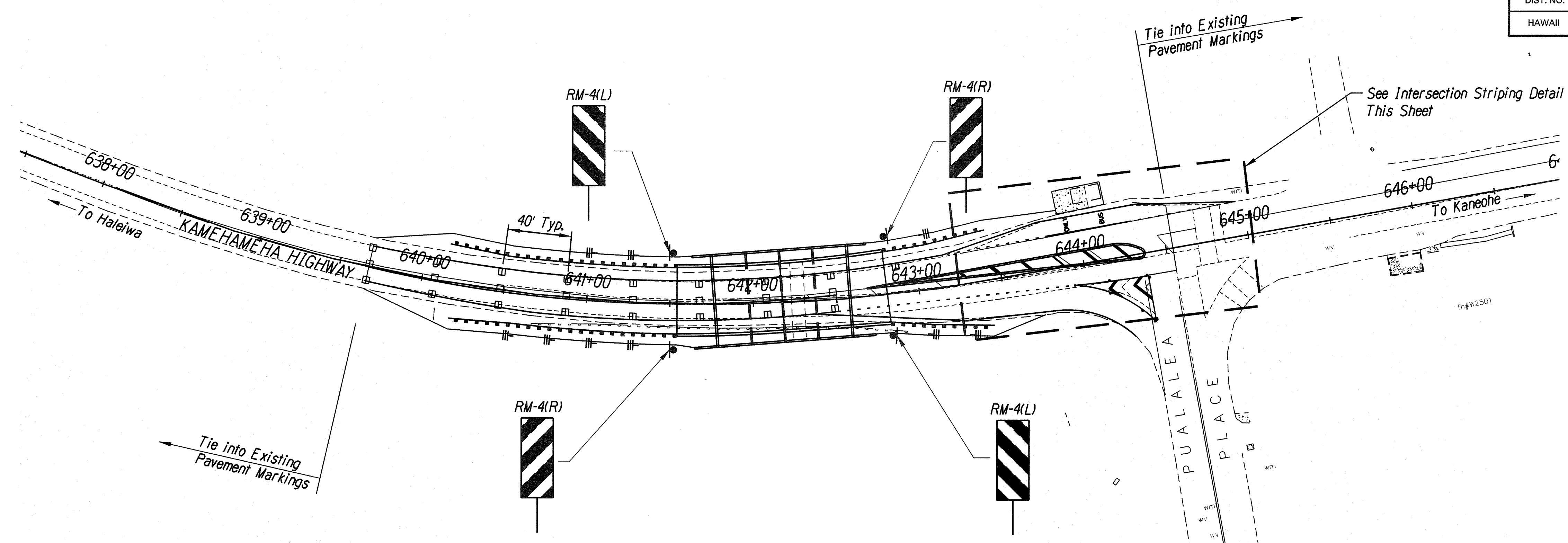

**HOSPITAL CULVERT SIGNING AND STRIPING PLAN**  
SCALE: 1"=40'

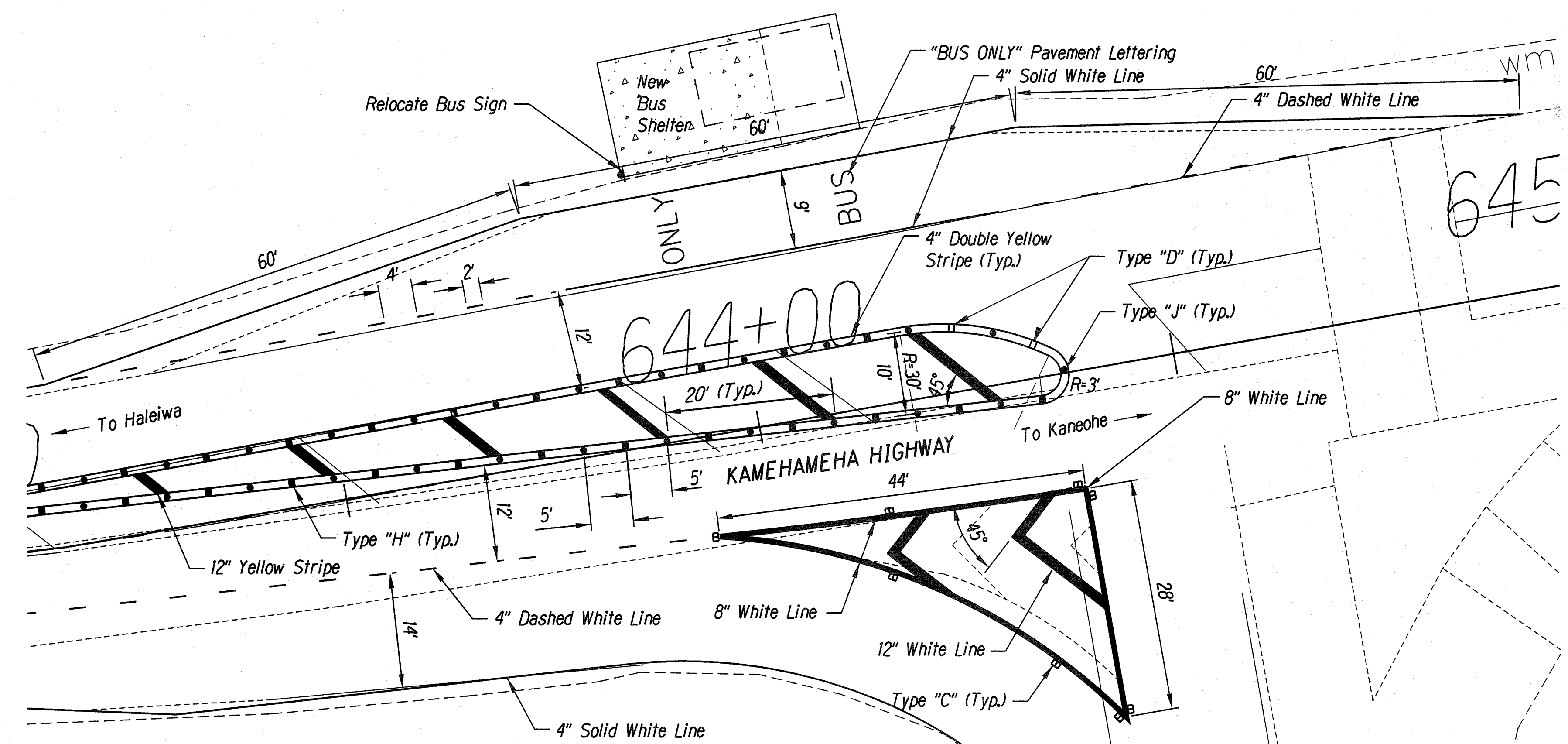
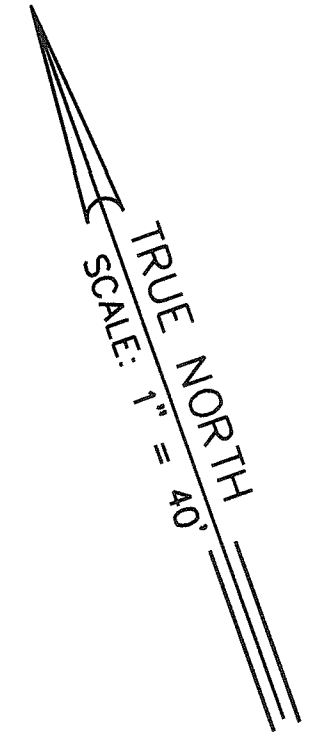

**INTERSECTION STRIPING DETAIL**  
SCALE: 1"=10'

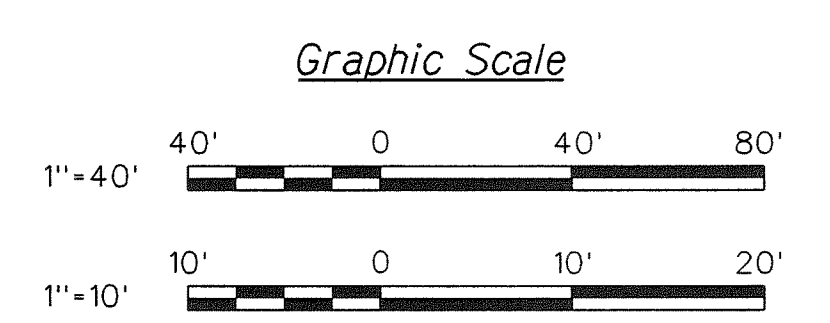

Director, Dept. of Transportation Services \_\_\_\_\_ Date \_\_\_\_\_

SURVEY PLOTTED BY	DATE
DRAWN BY	
DESIGNED BY	
QUANTITIES BY	
CHECKED BY	
ORIGINAL PLAN	
NOTE BOOK	
NO.	

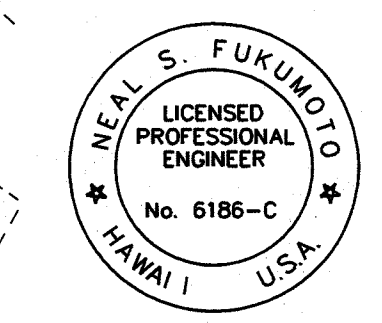

This work was prepared by me or under my supervision.  
Exp. 04-30-10  
*Neal S. Fukumoto*  
Wesley R. Segawa & Associates, Inc.

STATE OF HAWAII  
DEPARTMENT OF TRANSPORTATION  
HIGHWAYS DIVISION

**HOSPITAL CULVERT  
SIGNING & STRIPING PLAN**

KAMEHAMEHA HIGHWAY DRAINAGE IMPROVEMENTS  
Vicinity of Kahuku Hospital and Replacement of Kii Bridge  
Federal Aid Project No. NH-083-1(46)

Scale: As Noted Date: April 2004

SHEET No. 1 OF 1 SHEETS