

FED. ROAD DIST. NO.	STATE	FED. AID PROJ. NO.	FISCAL YEAR	SHEET NO.	TOTAL SHEETS
HAWAII	HAW.	NH-083-II(46)	2002	18	89

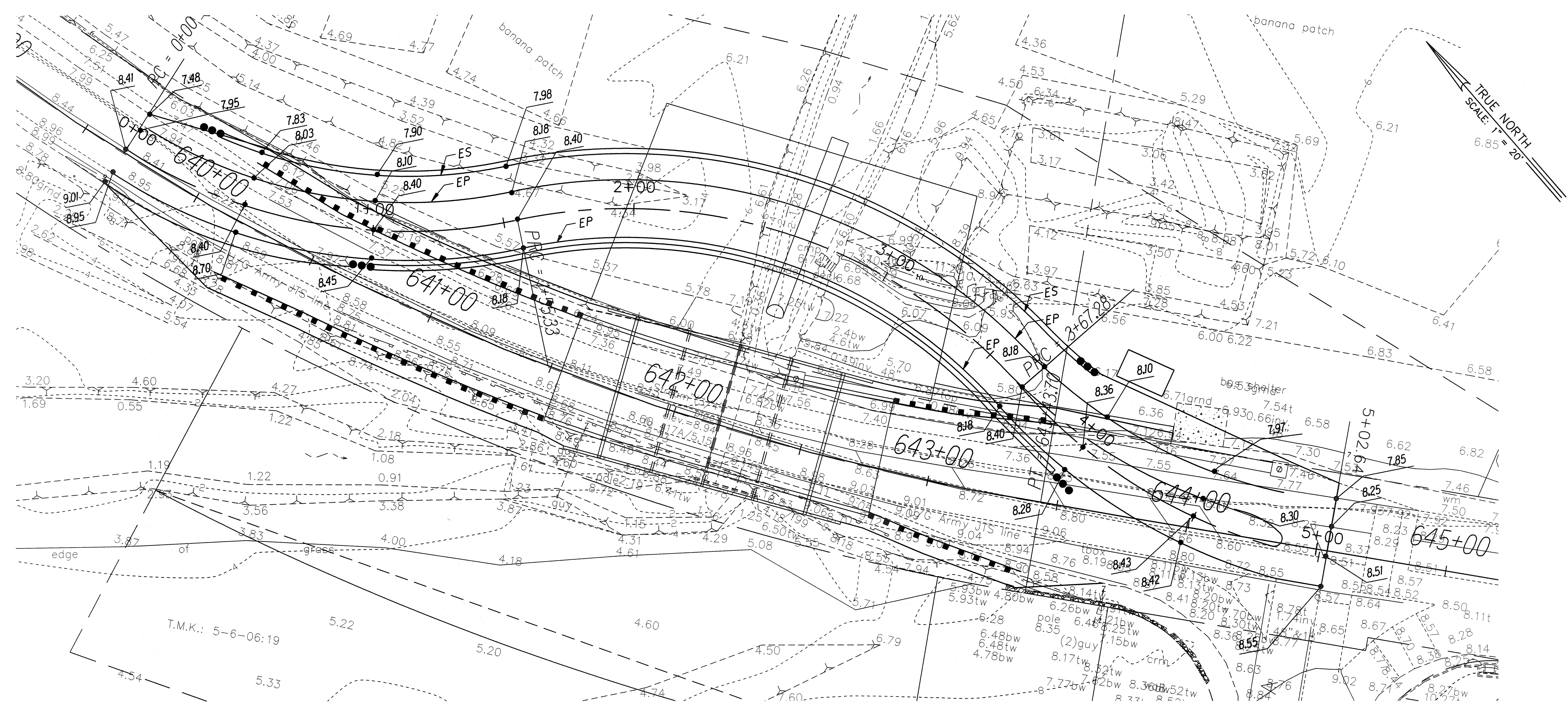

HOSPITAL CULVERT DETOUR ROAD SUPERELEVATION PLAN
 Scale: 1"=20'

- NOTES**
1. Spot Elevations Shown at Even 50' Stations or at End of Pavement as Shown.
 2. Spot Elevation Locations Based on Finished Paint Striping as Shown.
 3. Standard Cross Section to Apply (No Superelevation) from Station 1+55.33 to Station 3+67.28.

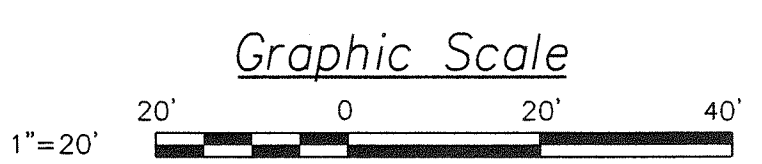

SURVEY PLOTTED BY	DATE
DRAWN BY	
DESIGNED BY	
QUANTITIES BY	
CHECKED BY	

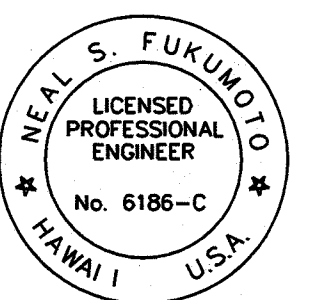

This work was prepared by me or under my supervision.
 Exp. 04-30-10
Wesley R. Segowa
 Wesley R. Segowa & Associates, Inc.

STATE OF HAWAII
DEPARTMENT OF TRANSPORTATION
HIGHWAYS DIVISION

**HOSPITAL CULVERT DETOUR ROAD
 SUPERELEVATION PLAN**
 KAMEHAMEHA HIGHWAY DRAINAGE IMPROVEMENTS
 Vicinity of Kahuku Hospital and Replacement of Kii Bridge
 Federal Aid Project No. NH-083-II(46)
 Scale: 1" = 20' Date: April 2004

AS-BUILT