

FED. ROAD DIST. NO.	STATE	PROJ. NO.	FISCAL YEAR	SHEET NO.	TOTAL SHEETS
HAWAII	HAW.	NH-083-1(41)	2000	55	90

TRAFFIC CONTROL NOTES: (For work within State Right-of-Way)

- The Permittee shall make minor adjustments at ramp junctions, bridges, structures, etc., to fit field conditions at no additional cost to the State. This work shall be incidental to the various contract items.
- Cones or delineators shall be extended to a point where they are visible to approaching traffic.
- Traffic control devices shall be installed such that the sign or device farthest from the work area shall be placed first. The others shall then be placed progressively toward the work area.
- Regulatory and warning signs within the Construction Zone that are in conflict with the traffic control plans shall be moved or covered.
- Flaggers and/or Police officers shall be in sight of each other or in direct communication at all times.
- When required by the issuing officer, the permittee shall install a flashing arrow signal as shown on the traffic control plans.
- Sign spacings (L), Taper lengths (T) and spacing of cones or delineators shall be as shown in Table 1, unless otherwise noted on the traffic control plans.
- All freeway traffic lanes shall be a minimum of 11 feet wide. Ramps and other roadway lanes shall be a minimum of 10 feet wide.
- All construction warning signs shall be promptly removed or covered whenever the message is not applicable or not in use.
- The backs of all signs used for traffic control shall be appropriately covered to preclude the display of inapplicable sign messages (i.e., when signs have messages on both faces).
- At the end of each day's work or as soon as the work is completed, the permittee shall remove all traffic control devices no longer needed to permit free and safe passage of public traffic. Removal shall be in the reverse order of installation.
- Replace permanent pavement markings and traffic signs upon completion of each phase of work.
- Existing conflicting pavement markings shall be removed and temporary markings shall be installed before traffic patterns are changed. After completion of the work, temporary markings shall be removed.
- Cones and signs for night work shall be retroreflective.

Posted Speed Limit (M.P.H.)	Sign Spacing (D) (Feet)	Taper Length (T) (Feet)		Longitudinal Buffer Space (B) (Feet)	Spacing of Cones or Delineators (Feet)		
		*W=12' or Less	*W=Greater Than 12'		Taper	Tangent	Work Area
20	250	200	W x 17	35	20	20	10
25	250	200	W x 17	55	25	25	10
30	250	250	W x 20	85	30	30	10
35	250	250	W x 20	120	35	35	10
40	500	350	W x 30	170	40	40	10
45	500	550	W x 45	220	45	45	10
50	1000	600	W x 50	280	50	50	10
55	1000	700	W x 55	335	55	55	10

\* W = Width of Lane, Shoulder or Offset

TRAFFIC CONTROL PLAN CONCEPTS:

- Work on certain ramps, frontage roads and cross streets are indicated under independent phases.
  - Unless otherwise indicated, work on the frontage roads and cross streets shall be scheduled during the weekday hours from 9:00 am to 3:00 pm, Mondays thru Fridays, except holidays. Unless otherwise indicated, only single lane closures will be allowed in each direction
  - Work on certain ramps may require full ramp closures and will be scheduled for Sunday work, where indicated.
- Lane closures shall be allowed only to the extent of accomplishing each day (or night) work and shall be subject to the approval of the Engineer.

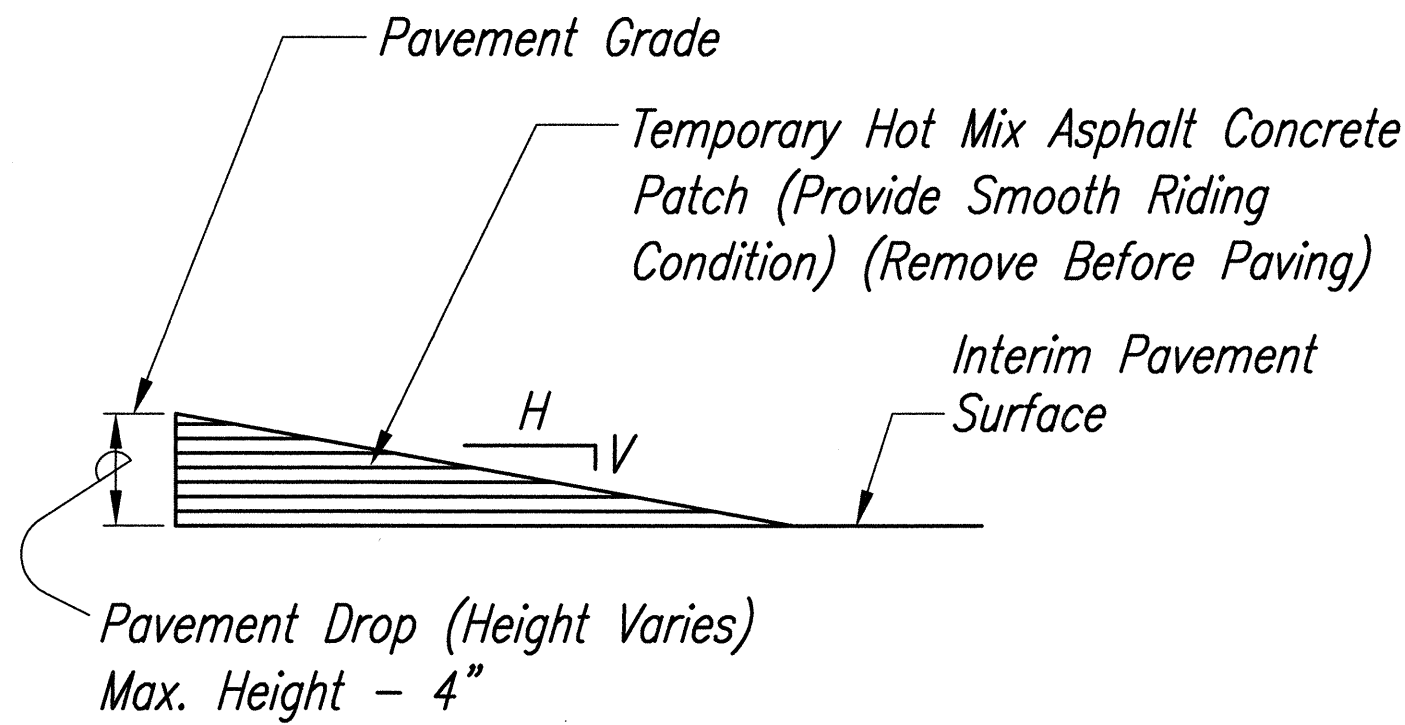

TRANSITION TAPER  
Not to Scale

When removal of existing pavement is required in roadways open to traffic, the Contractor shall remove to full travelway width of roadway each day so as not to leave a hazardous longitudinal pavement drop between lane passes of the removed pavement. The engineer may allow the Contractor to construct a transition taper at the longitudinal pavement drop so as not to leave a vertical face. The transition taper shall be along the lane line and should produce a wedge with a minimum slope of 6:1. The transverse taper should produce a wedge with a minimum slope of 48:1. The Contractor shall submit the type of materials and construction of the transition taper for acceptance by the Engineer. The Contractor shall remove and dispose of the removed material. This work shall be incidental to the various asphaltic concrete pavement items.

LEGEND:

- Work Zone
- Cones
- Sign
- Direction of Travel
- Policeman
- Flashing Arrow Board
- Message Board

SURVEY PLOTTED BY	DATE
DRAWN BY	
TRACED BY	
DESIGNED BY	
QUANTITIES BY	
CHECKED BY	
ORIGINAL PLAN	
NOTE BOOK	
No.	



THIS WORK WAS PREPARED BY ME  
OR UNDER MY SUPERVISION.

Alan Y. Tomita

STATE OF HAWAII  
DEPARTMENT OF TRANSPORTATION  
HIGHWAYS DIVISION  
**TRAFFIC CONTROL NOTES & LEGEND**  
**KAMEHAMEHA HIGHWAY RESURFACING**  
**Kaneohe Bay Drive to Kahiko Street**  
**F. A. Project No. NH-083-1(41)**  
Scale: As Shown Date: June, 1999  
SHEET No. 1 OF 5 SHEETS

FED. ROAD DIST. NO.	STATE	PROJ. NO.	FISCAL YEAR	SHEET NO.	TOTAL SHEETS
HAWAII	HAW.	NH-083-1(41)	2000	56	90

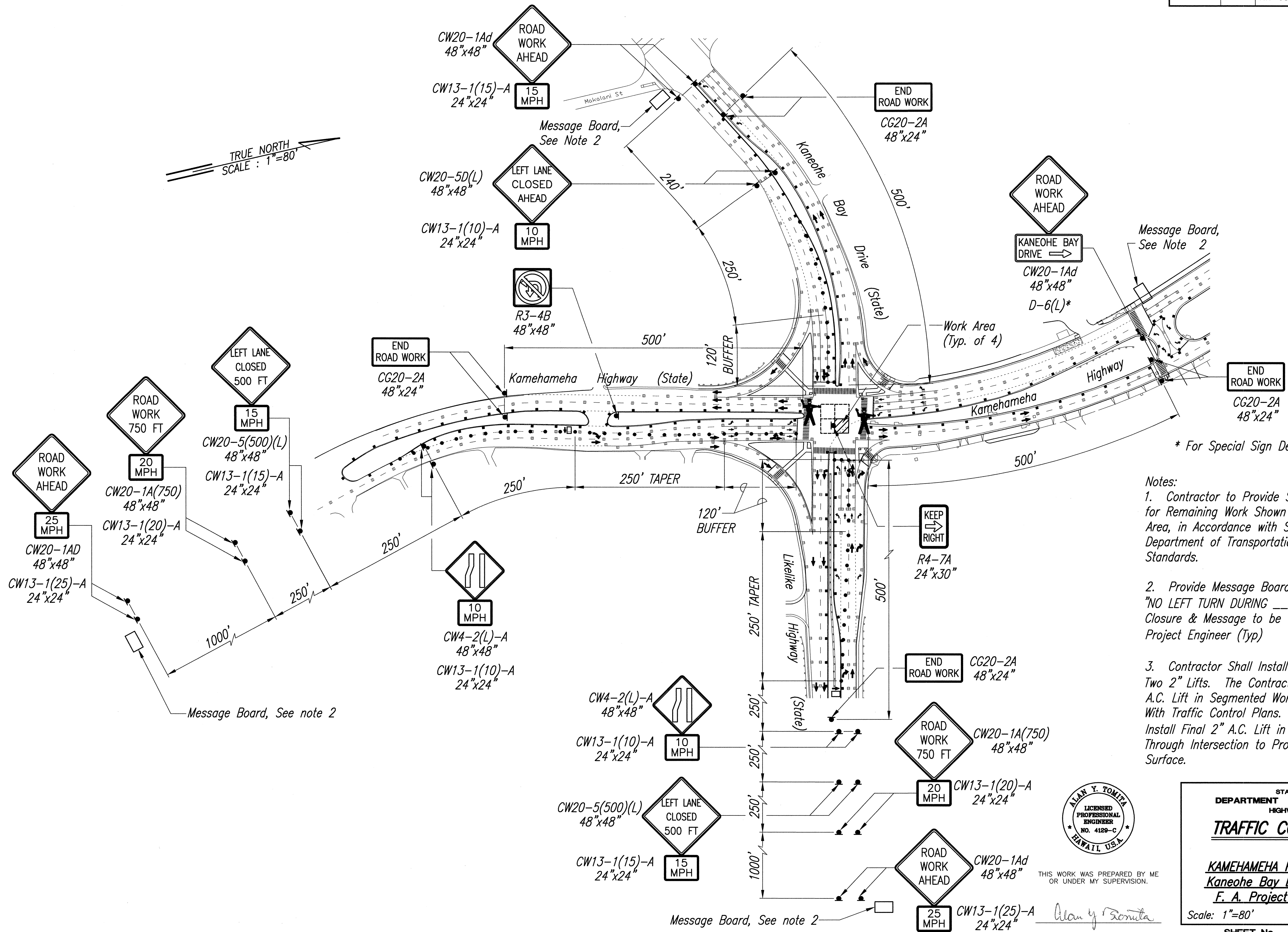

\* For Special Sign Details See Sheet 54.

- Notes:
- Contractor to Provide Similar Traffic Controls for Remaining Work Shown within Each Dashed Area, in Accordance with State of Hawaii Department of Transportation Traffic Control Standards.
  - Provide Message Board on All Four Approaches "NO LEFT TURN DURING \_\_\_\_\_", Time of Closure & Message to be Coordinated with DOT Project Engineer (Typ)
  - Contractor Shall Install 4" A.C. Pavement in Two 2" Lifts. The Contractor Can Install First 2" A.C. Lift in Segmented Work Areas in Accordance With Traffic Control Plans. The Contractor Shall Install Final 2" A.C. Lift in Continuous Lanes Through Intersection to Provide Smooth Riding Surface.

SURVEY PLOTTED BY	DATE
DRAWN BY	
TRACED BY	
QUANTITIES BY	
CHECKED BY	
ORIGINAL PLAN	
NOTE BOOK	
No.	

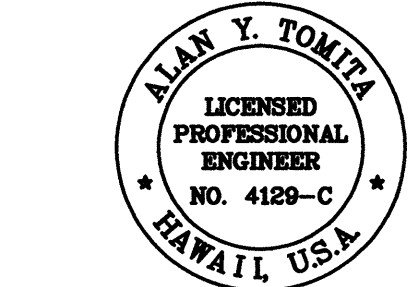

THIS WORK WAS PREPARED BY ME OR UNDER MY SUPERVISION.

Alan Y. Tomita

STATE OF HAWAII  
DEPARTMENT OF TRANSPORTATION  
HIGHWAYS DIVISION  
**TRAFFIC CONTROL PLAN-1**  
**KAMEHAMEHA HIGHWAY RESURFACING**  
**Kaneohe Bay Drive to Kahiko Street**  
**F. A. Project No. NH-083-1(41)**  
Scale: 1"=80'

Date: June, 1999  
SHEET No. 2 OF 5 SHEETS



FED. ROAD DIST. NO.	STATE	PROJ. NO.	FISCAL YEAR	SHEET NO.	TOTAL SHEETS
HAWAII	HAW.	NH-083-1(41)	2000	57	90

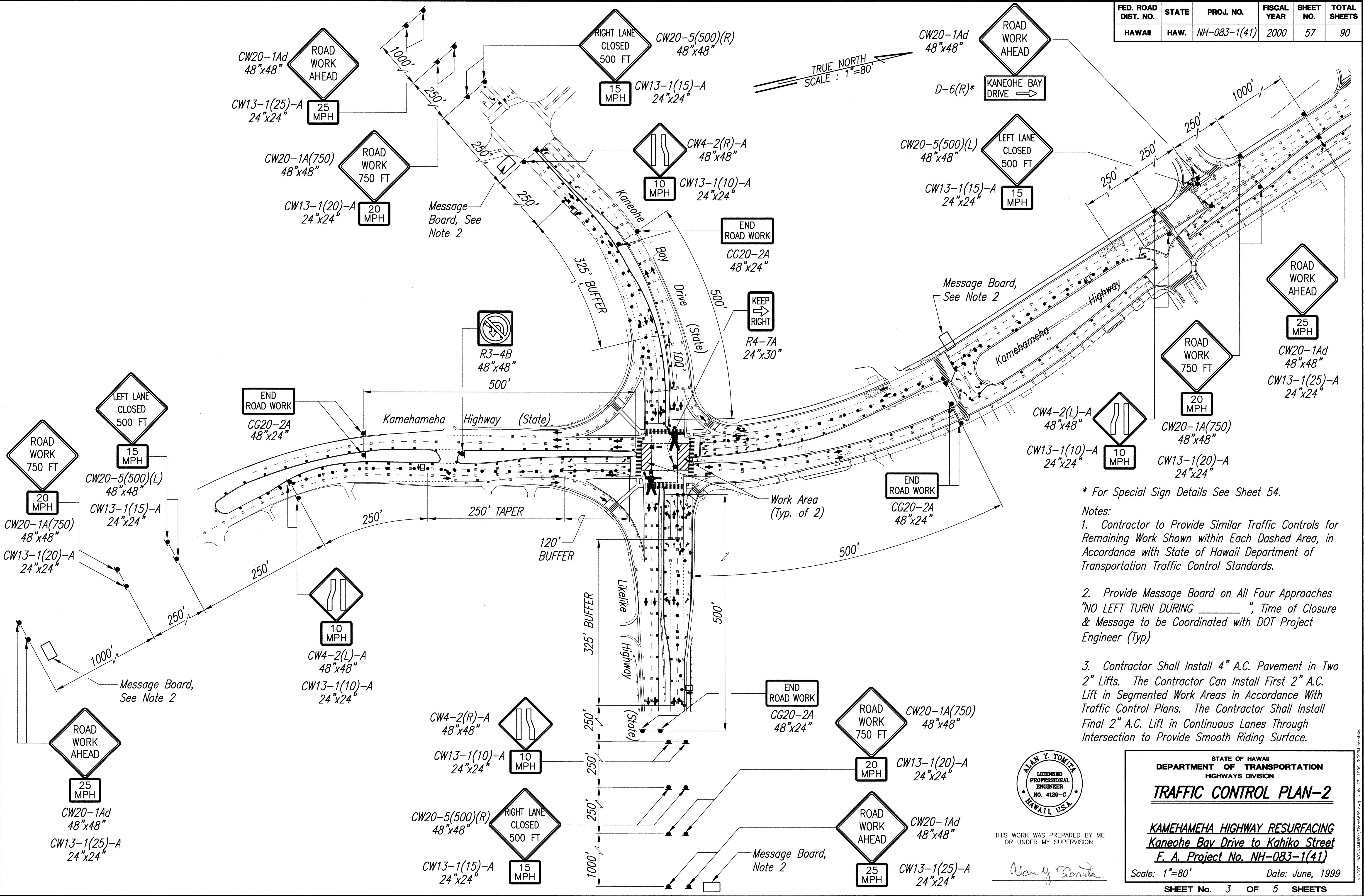

- \* For Special Sign Details See Sheet 54.
- Notes:
- Contractor to Provide Similar Traffic Controls for Remaining Work Shown within Each Dashed Area, in Accordance with State of Hawaii Department of Transportation Traffic Control Standards.
  - Provide Message Board on All Four Approaches "NO LEFT TURN DURING \_\_\_\_\_", Time of Closure & Message to be Coordinated with DOT Project Engineer (Typ)
  - Contractor Shall Install 4" A.C. Pavement in Two 2" Lifts. The Contractor Can Install First 2" A.C. Lift in Segmented Work Areas in Accordance With Traffic Control Plans. The Contractor Shall Install Final 2" A.C. Lift in Continuous Lanes Through Intersection to Provide Smooth Riding Surface.

DATE: \_\_\_\_\_

SURVEY PLOTTED BY: \_\_\_\_\_

DRAWN BY: \_\_\_\_\_

TRACED BY: \_\_\_\_\_

QUANTITIES BY: \_\_\_\_\_

CHECKED BY: \_\_\_\_\_

ORIGINAL PLAN: \_\_\_\_\_

NOTE BOOK: \_\_\_\_\_

No. \_\_\_\_\_

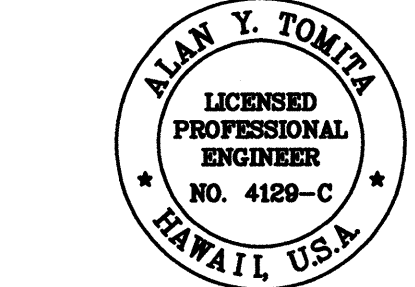

THIS WORK WAS PREPARED BY ME OR UNDER MY SUPERVISION.

Alan Y. Tomita

STATE OF HAWAII  
DEPARTMENT OF TRANSPORTATION  
HIGHWAYS DIVISION

**TRAFFIC CONTROL PLAN-2**

**KAMEHAMEHA HIGHWAY RESURFACING**  
**Kaneohe Bay Drive to Kahiko Street**  
**F. A. Project No. NH-083-1(41)**

Scale: 1"=80' Date: June, 1999

SHEET No. 3 OF 5 SHEETS

FED. ROAD DIST. NO.	STATE	PROJ. NO.	FISCAL YEAR	SHEET NO.	TOTAL SHEETS
HAWAII	HAW.	NH-083-1(41)	2000	58	90

