

FED. ROAD DIST. NO.	STATE	FED. AID PROJ. NO.	FISCAL YEAR	SHEET NO.	TOTAL SHEETS
HAWAII	HAW.	BR-083-1(27)	1998	ADD.18	58

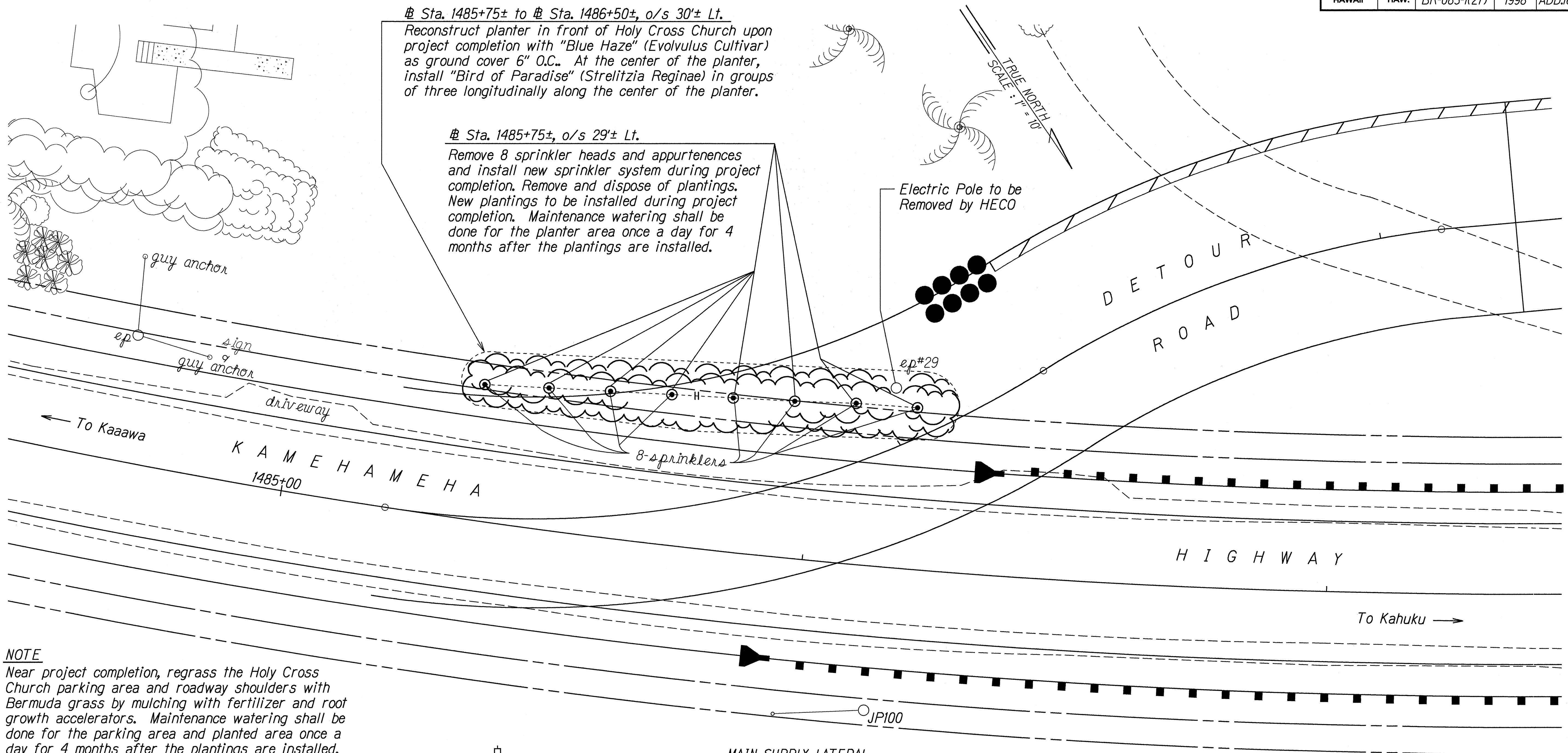

NOTE

Near project completion, regrass the Holy Cross Church parking area and roadway shoulders with Bermuda grass by mulching with fertilizer and root growth accelerators. Maintenance watering shall be done for the parking area and planted area once a day for 4 months after the plantings are installed.

LEGEND

● New Sprinkler Head with End Lateral

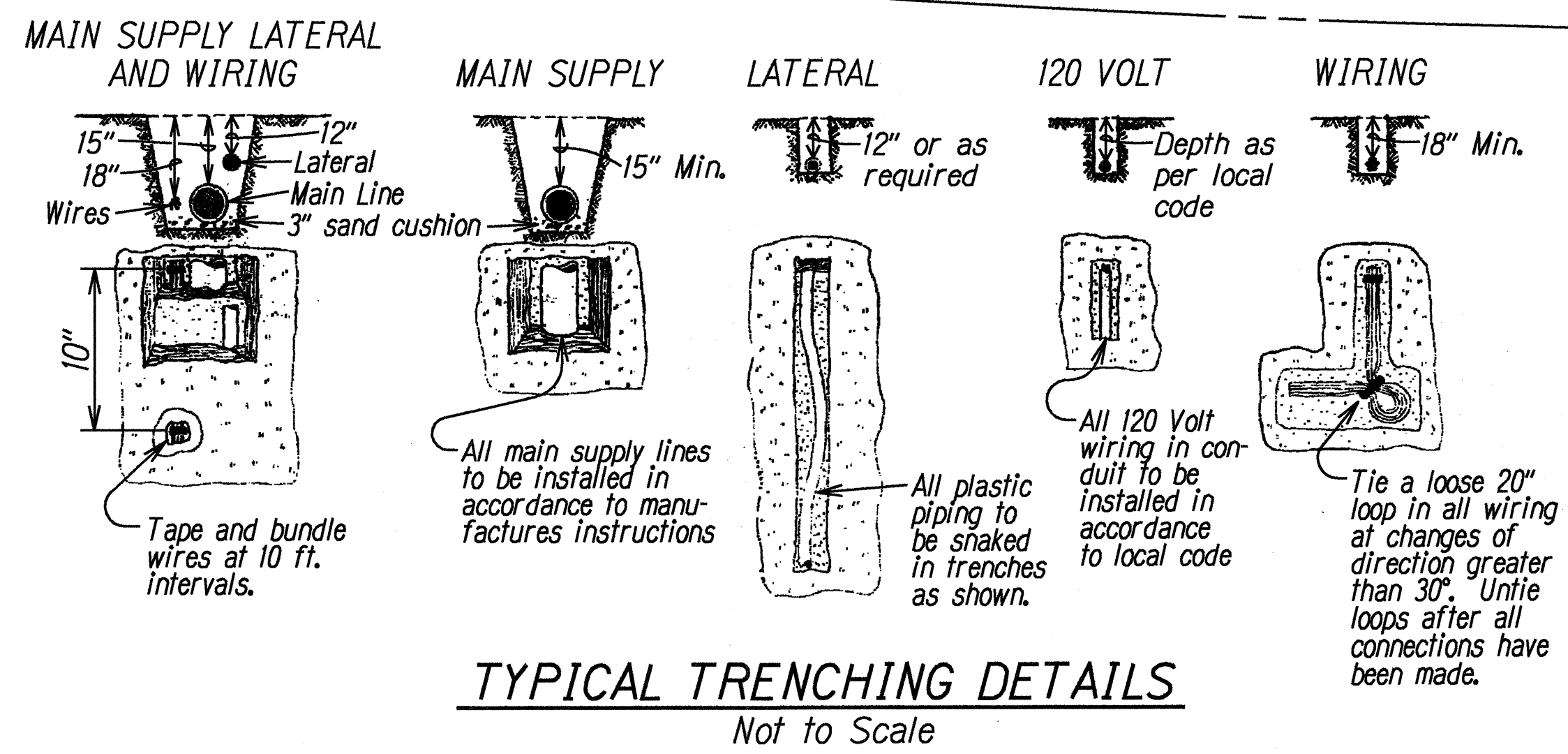
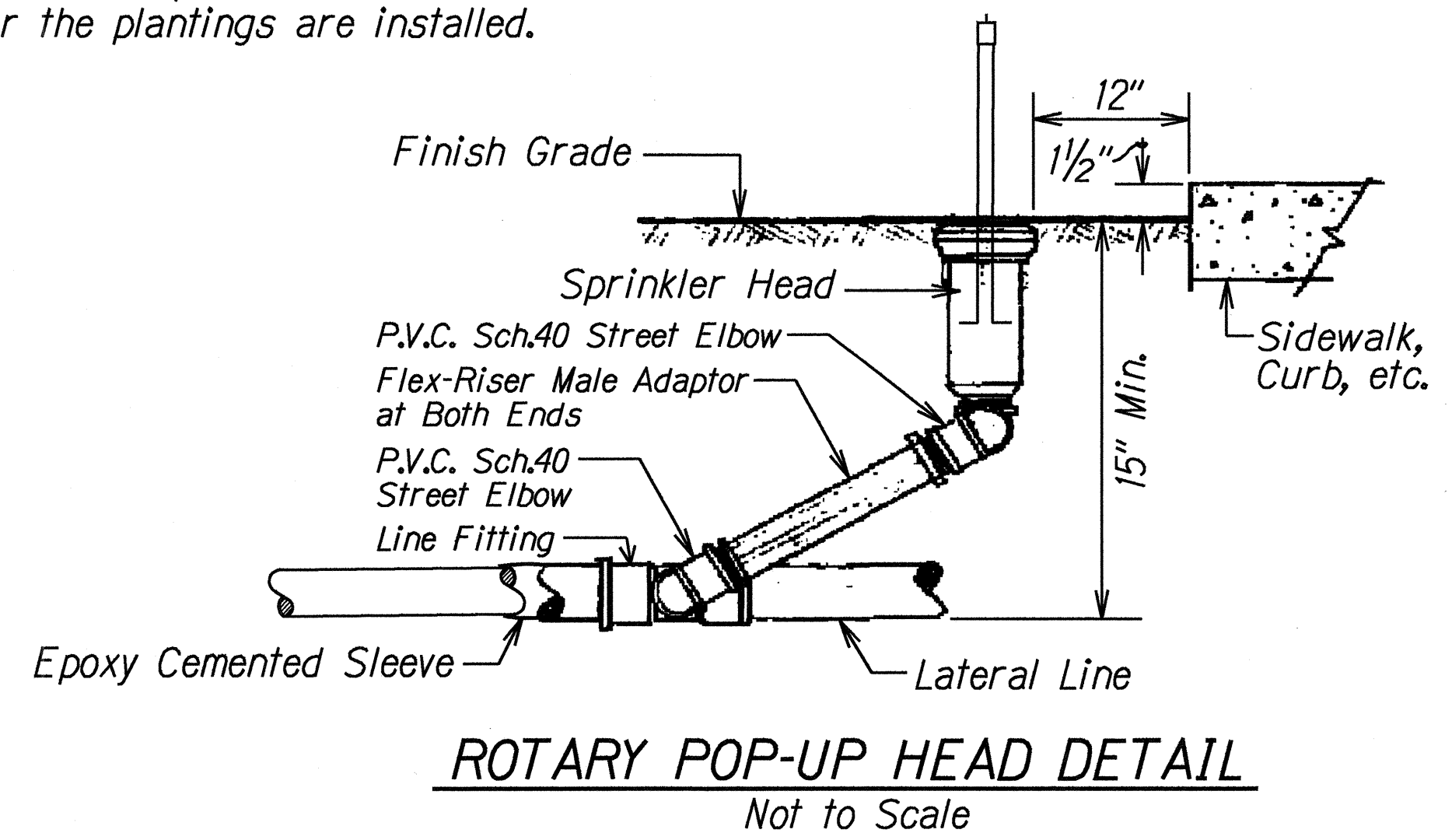

3/23/98	Revised Notes for New Sprinkler System and Regrass of Roadway Shoulders.
DATE	REVISION
STATE OF HAWAII DEPARTMENT OF TRANSPORTATION HIGHWAYS DIVISION HOLY CROSS CHURCH REPLANTING PLAN KAMEHAMEHA HIGHWAY REPLACEMENT OF MALAEKAHANA BRIDGE Federal Aid Project No. BR-083-1(27) Scale: 1"=10' Date: Feb., 1998	
SHEET No. 1 OF 1 SHEETS	

ORIGINAL	SURVEY PLOTTED BY	DATE
PLAN	DRAWN BY G. Attwood	12-23-98
BOOK	TRACED BY - E. L. M. L. L. L.	
NOTES	NOTES BY - E. L. M. L. L. L.	
QUANTITIES	QUANTITIES BY - E. L. M. L. L. L.	
CHECKED BY	CHECKED BY - E. L. M. L. L. L.	