

FED. ROAD DIST. NO.	STATE	FED. AID PROJ. NO.	FISCAL YEAR	SHEET NO.	TOTAL SHEETS
HAWAII	HAW.	BR-080-1(012)	2014	11	82

**NOTES FOR TRAFFIC CONTROL PLAN**

- The contractor shall make minor adjustments at intersections, driveways, bridges, structures, etc. to fit field conditions.
- Cones or delineators shall be extended to a point where they are visible to the approaching traffic.
- Traffic control devices shall be installed such that the sign or device farthest from the work area shall be placed first. The others shall then be placed progressively toward the work area.
- Regulatory and warning signs within the construction zone that are in conflict with the Traffic Control Plans shall be removed or covered. All signs shall be restored upon completion of the work.
- Flaggers and/or Police Officers shall be in sight of each other or in direct communication at all times.
- When required by the issuing office, the contractor shall install a flashing arrow signal as shown on the traffic control plans.
- All traffic lanes shall be a minimum of 10 feet wide.
- All construction warning signs shall be promptly removed or covered whenever the message is not applicable or not in use.
- The backs of all signs used for traffic control shall be appropriately covered to preclude the display of inapplicable sign messages (i.e., when the signs have messages on both faces).
- At the end of each day's work, or as soon as the work is completed, the contractor shall remove all traffic control devices no longer needed to permit free and safe passage of the public traffic. Removal shall be in the reverse order of installation. Replace existing faded or obliterated pavement markings that are necessary for safe traffic flow in the construction area with temporary or permanent markings before opening the roadway to public traffic each day.
- Replace permanent pavement markings and traffic signs upon completion of each phase of work.
- Police officer/flagger's shall be in communication at all times. Police officer/flagger's shall stop traffic to allow safe passage/crossing of construction equipment/vehicles.
- Lane closures shall be allowed between the hours of 9:00 p.m. to 5:00 a.m., Sunday thru Thursday.
- Contractor shall coordinate all lane closures and traffic control phasing with the State Department of Transportation.
- The contractor shall provide, install and maintain all necessary signs, lights, flares, barricades, markers, cones and other protective facilities and shall take all necessary precautions for the protection and for the convenience and safety of public traffic. All such protective facilities and precautions to be taken shall conform with the "Administrative Rules of Hawaii Governing the use of Traffic Control Devices at Work Sites on or adjacent to Public Streets and Highways" adopted by the Director of Transportation, and the current U.S. Federal Highway Administration's "Manual on Uniform Traffic Control Devices for Streets and Highways, Part VI - Traffic Control for Street and Highway Construction and Maintenance Operations".
- Stationary construction lasting three (3) days or longer throughout the project corridor shall require long-term construction warning signs and regulatory warning signs, see the HDOT Work Zone Signing Plan, Notes & Details.
- The Contractor shall notify Lance Santos (848-4571) or Tracie Coelho (772-7020) Oahu Transit Services Roads Supervision Office, Department of Transportation Services Public Transit Division (768-8396), Major Moana Heu (723-8703) Honolulu Police Department - Wahiawa, Jeffery Farris (723-7182) Honolulu Fire Department, Frederick Makinney (656-6750) Directorate of emergency Services Operations Branch at Schofield Barracks, Gareth Sakakida (833-6628) Hawaii Transportation Association, Dara Young (dara\_young@hawaiidoe.org) State Department of Education, Melvin Kaku (723-8951) City and County of Honolulu Department of Emergency Management, and Patty Dukes pdukes@honolulu.gov or Wayne Kruse (723-7809) wkruse@honolulu.gov Emergency Services of the scope of work, location, proposed closure of any streets, traffic lanes, walkways, bus stops, vehicle height clearance and duration of project at least fourteen (14) days prior to construction and at least fourteen (14) days prior to full bridge closure dates.
- Contractor shall install the Variable Message Boards informing the public of the start of construction two (2) weeks prior to the start of construction, Variable Message Boards shall be installed in advance of work area as indicated on the Detour Plans.

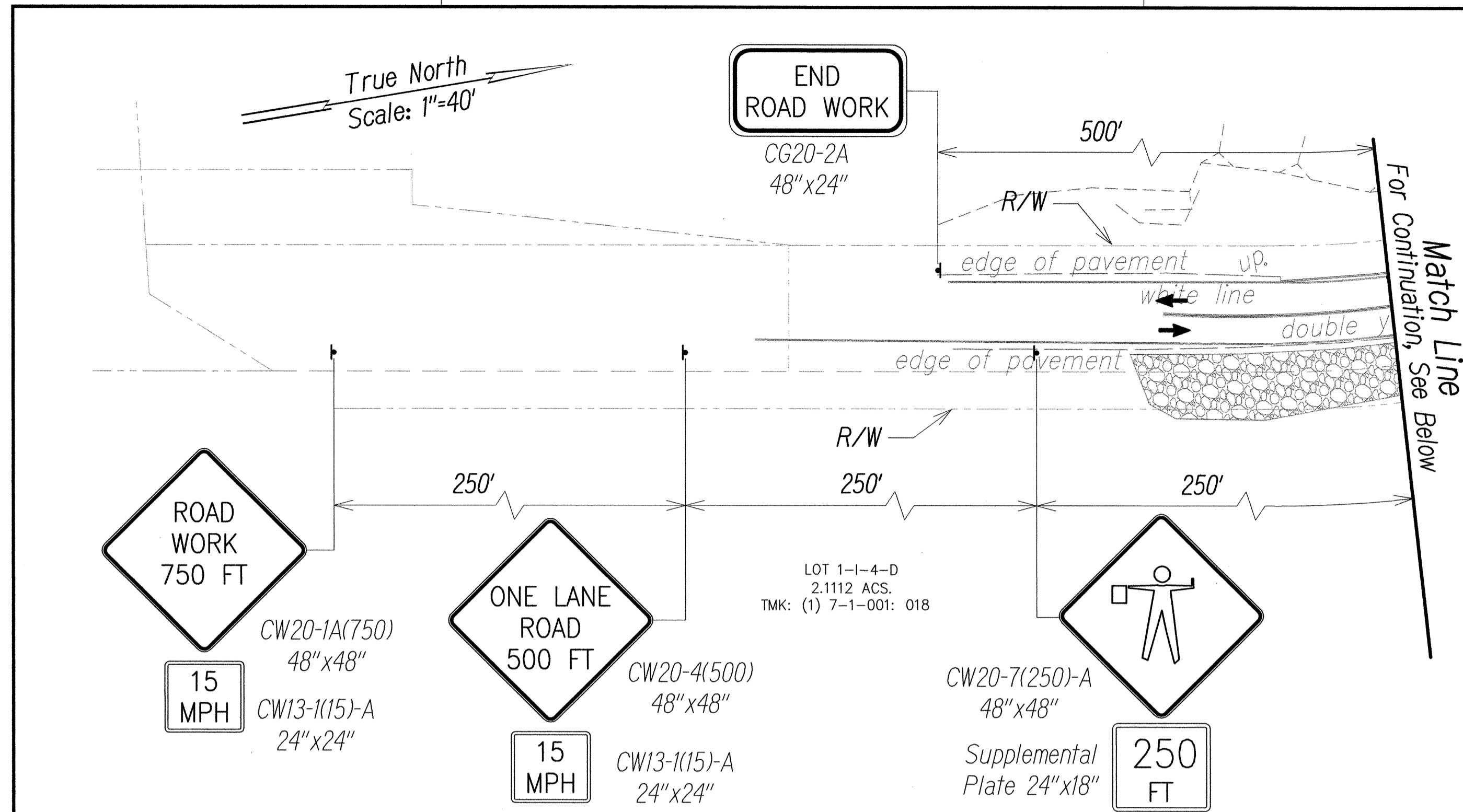

**LEGEND**

- ▾ Sign
- Cone or Delineator
- ← Direction of Traffic
- ⊗ Police Officer
- ▨ Work Area

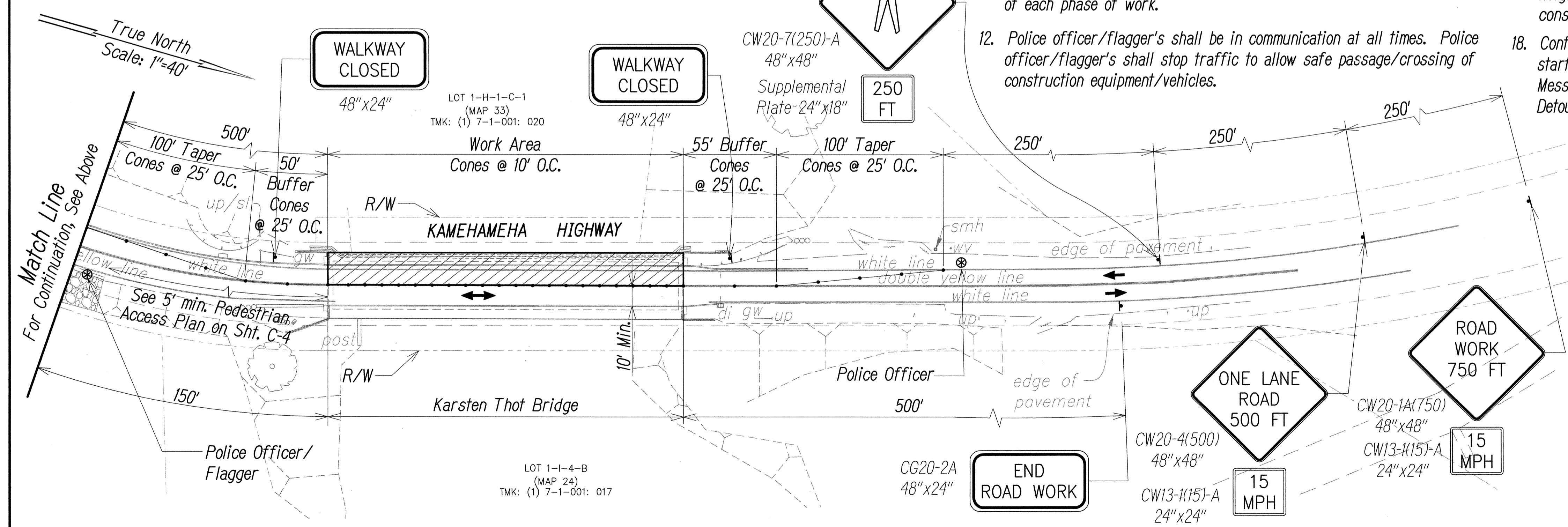

**GENERAL NOTES**

- For Detour Route, See Sheet C-5.
- Existing bridge has posted load limit. Refer to Structural Drawings General Notes for posted load.
- During concrete casting, the speed limit shall be reduced to 5 mph. 60 minutes minimum after the last concrete load is completed, the speed limit shall return to 15 mph for the remainder of the construction period for the day.
- Concrete work shall be completed a minimum 60 minutes prior to end of Traffic Control for that day.

DATE	BY
DESIGNED BY	DATE
TRACED BY	DATE
DESIGNED BY	DATE
QUANTITIES BY	DATE
CHECKED BY	DATE

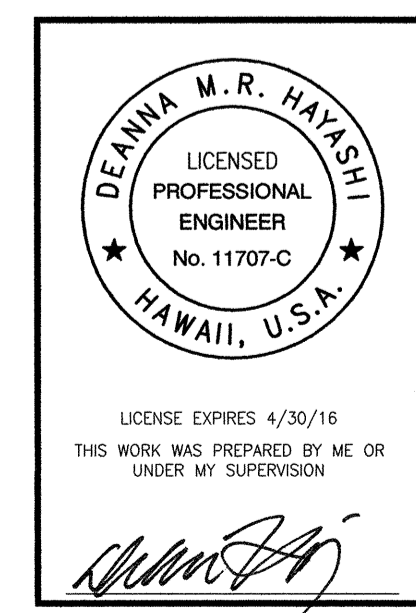

STATE OF HAWAII  
DEPARTMENT OF TRANSPORTATION  
HIGHWAYS DIVISION

**TRAFFIC CONTROL PLAN - 1  
(NIGHT TIME)**

**KAMEHAMEHA HIGHWAY  
Repair and Paint Karsten Thot Bridge  
Federal Aid Project No. BR-080-1(012)**

Scale: AS NOTED Date: September 2014  
SHEET No. C-1 OF 9 SHEETS

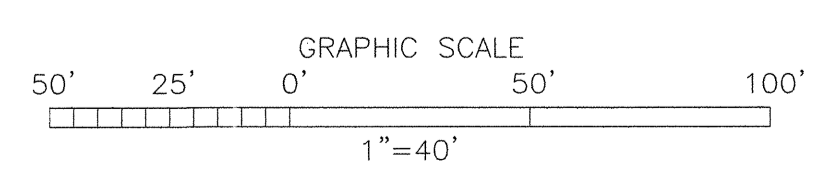



FED. ROAD DIST. NO.	STATE	FED. AID PROJ. NO.	FISCAL YEAR	SHEET NO.	TOTAL SHEETS
HAWAII	HAW.	BR-080-1(012)	2014	13	82

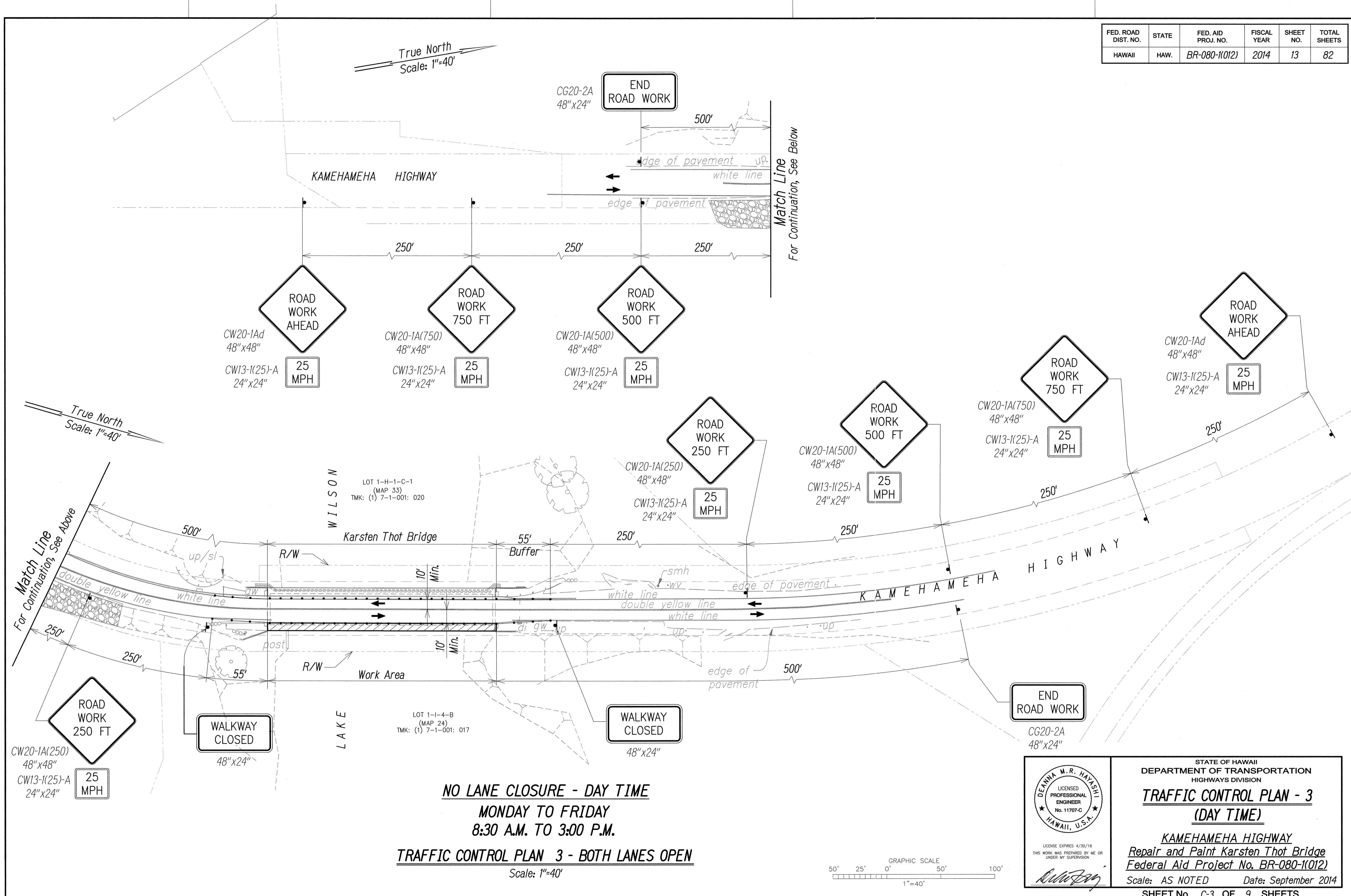

True North  
Scale: 1"=40'

True North  
Scale: 1"=40'

**NO LANE CLOSURE - DAY TIME**  
**MONDAY TO FRIDAY**  
**8:30 A.M. TO 3:00 P.M.**

**TRAFFIC CONTROL PLAN 3 - BOTH LANES OPEN**

Scale: 1"=40'

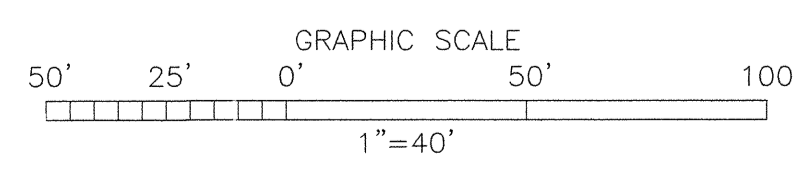

SURVEY PLOTTED BY	DATE
DRAWN BY	
DESIGNED BY	
QUANTITIES BY	
CHECKED BY	
GENERAL PLAN	
NOTEBOOK	
No.	

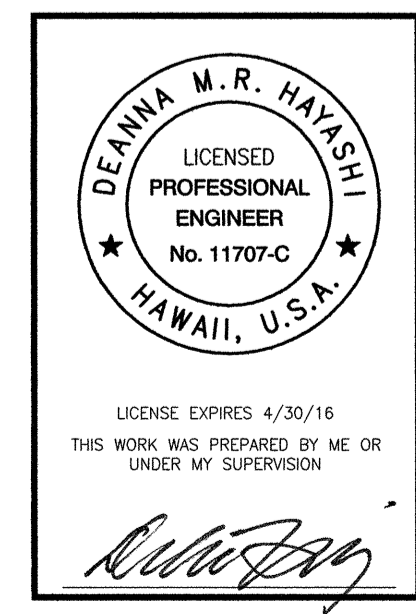

STATE OF HAWAII  
DEPARTMENT OF TRANSPORTATION  
HIGHWAYS DIVISION  
**TRAFFIC CONTROL PLAN - 3**  
**(DAY TIME)**  
**KAMEHAMEHA HIGHWAY**  
**Repair and Paint Karsten Thot Bridge**  
**Federal Aid Project No. BR-080-1(012)**  
Scale: AS NOTED Date: September 2014  
SHEET No. C-3 OF 9 SHEETS

FED. ROAD DIST. NO.	STATE	FED. AID PROJ. NO.	FISCAL YEAR	SHEET NO.	TOTAL SHEETS
HAWAII	HAW.	BR-080-1(012)	2014	14	82

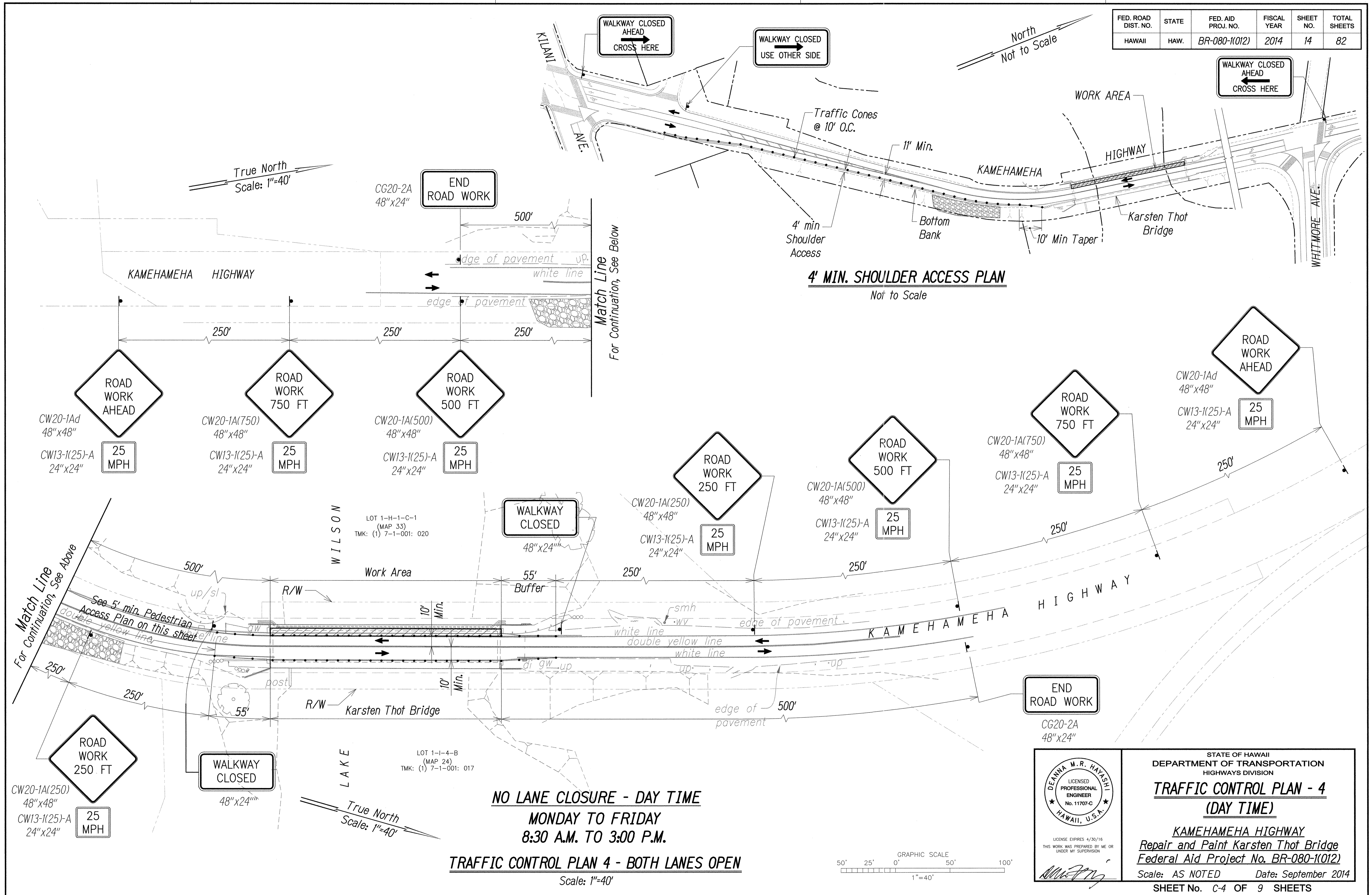

DATE	_____
SURVEY PLOTTED BY	_____
DRAWN BY	_____
TRACED BY	_____
DESIGNED BY	_____
QUANTITIES BY	_____
CHECKED BY	_____
NO.	_____

**NO LANE CLOSURE - DAY TIME**  
**MONDAY TO FRIDAY**  
**8:30 A.M. TO 3:00 P.M.**  
**TRAFFIC CONTROL PLAN 4 - BOTH LANES OPEN**  
 Scale: 1"=40'

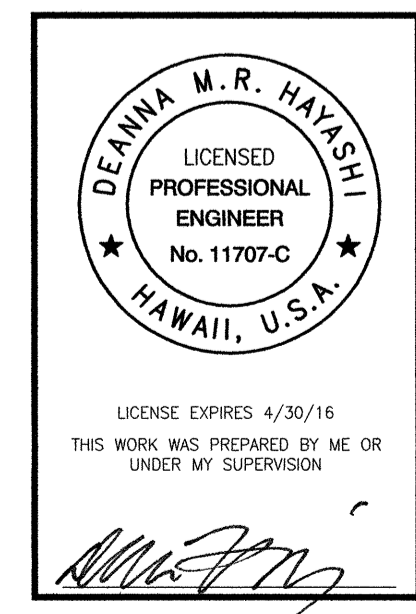
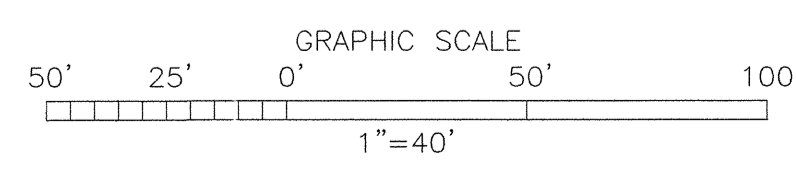

STATE OF HAWAII  
 DEPARTMENT OF TRANSPORTATION  
 HIGHWAYS DIVISION  
**TRAFFIC CONTROL PLAN - 4**  
**(DAY TIME)**  
**KAMEHAMEHA HIGHWAY**  
**Repair and Paint Karsten Thot Bridge**  
 Federal Aid Project No. BR-080-1(012)  
 Scale: AS NOTED Date: September 2014  
 SHEET No. C-4 OF 9 SHEETS



FED. ROAD DIST. NO.	STATE	FED. AID PROJ. NO.	FISCAL YEAR	SHEET NO.	TOTAL SHEETS
HAWAII	HAW.	BR-080-(1012)	2014	16	82

**LEGEND**

- ← Detour Route
- ▴ Sign
- ⊗ Police Officer
- ▬ Variable Message Board

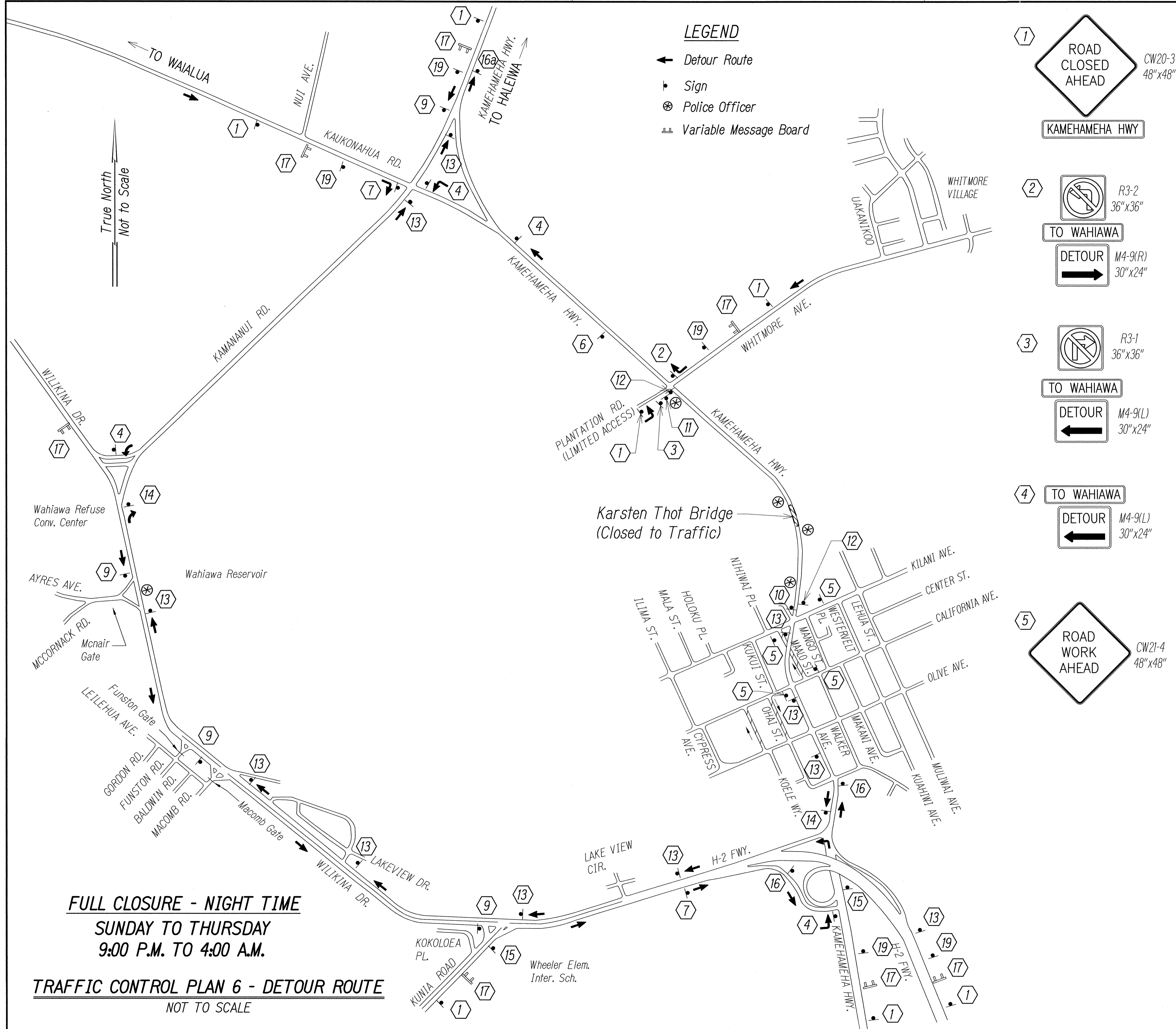

**FULL CLOSURE - NIGHT TIME**  
**SUNDAY TO THURSDAY**  
**9:00 P.M. TO 4:00 A.M.**

**TRAFFIC CONTROL PLAN 6 - DETOUR ROUTE**  
 NOT TO SCALE

DESIGNED BY	DATE
TRACED BY	
DESIGNED BY	
QUANTITIES BY	
CHECKED BY	
ORIGINAL PLAN	
NOTEBOOK	
No.	

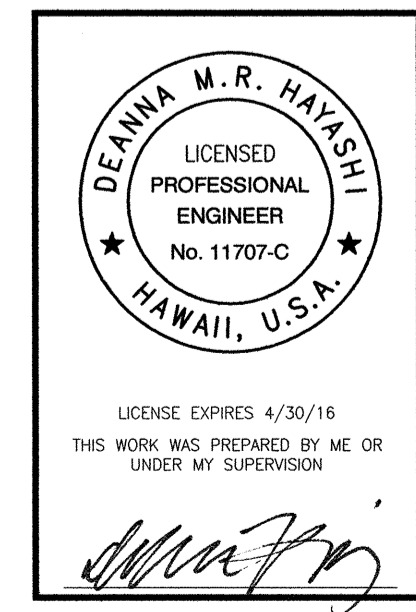
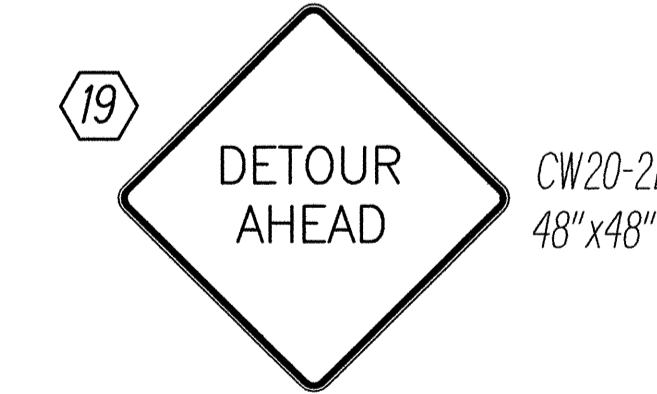
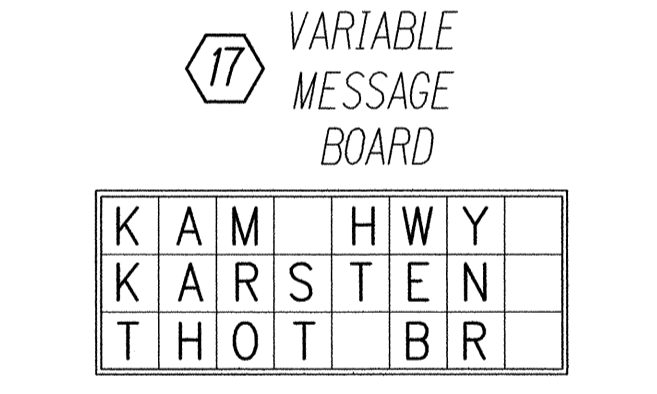
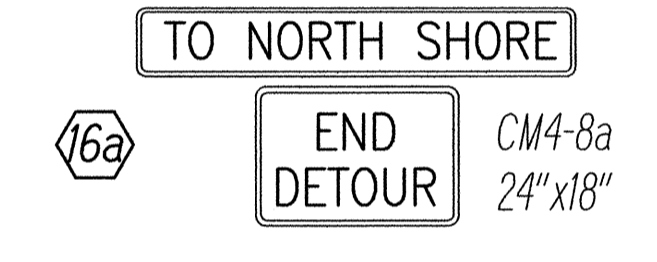
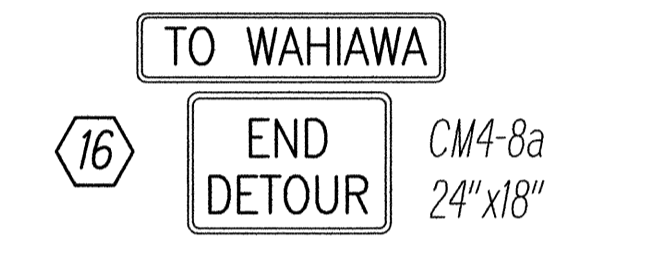
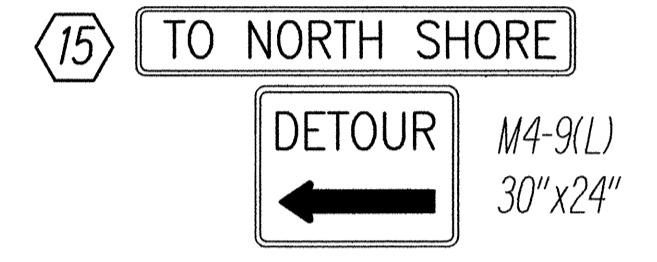
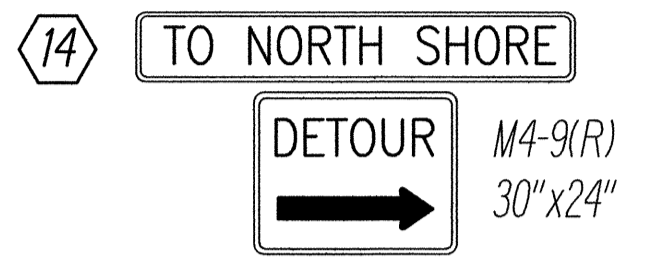
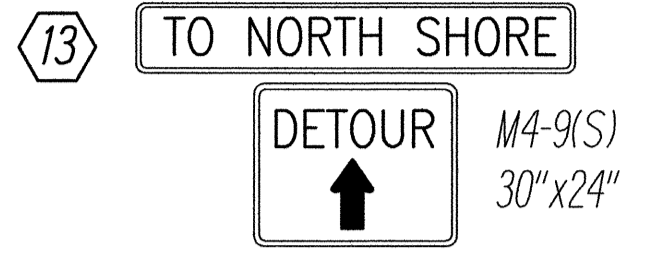
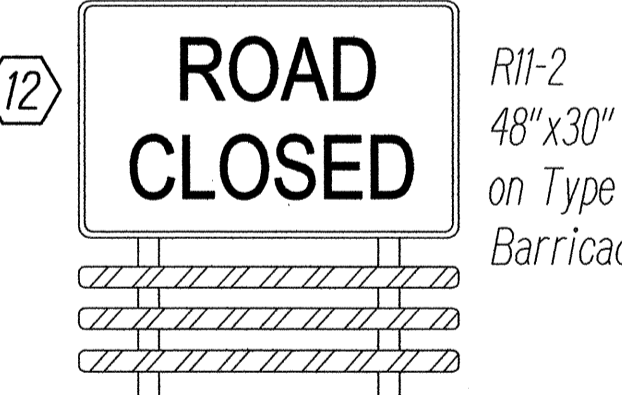
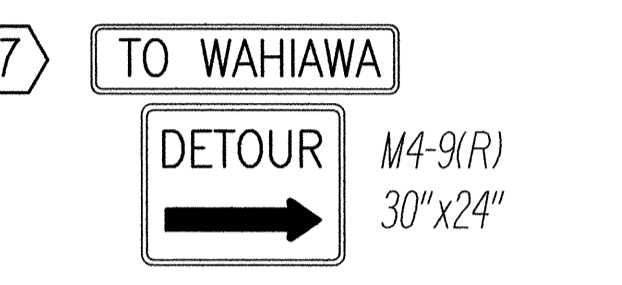
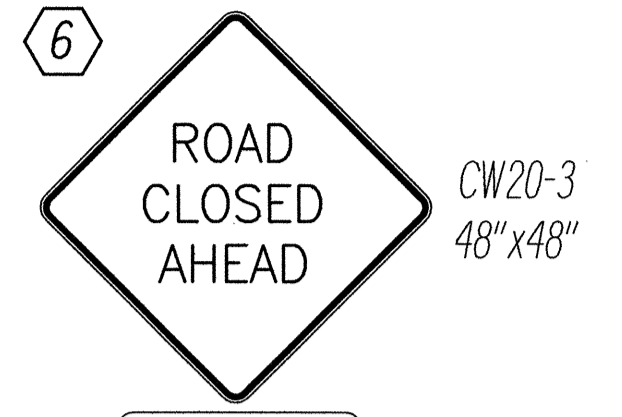
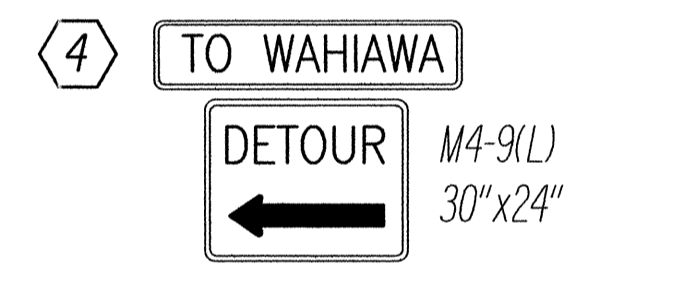
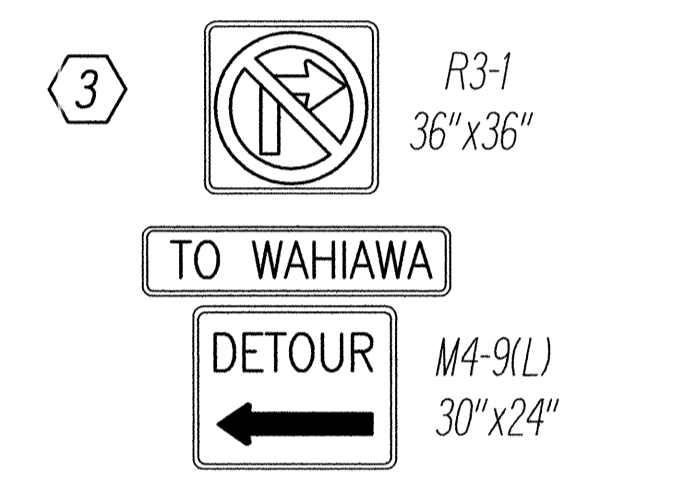
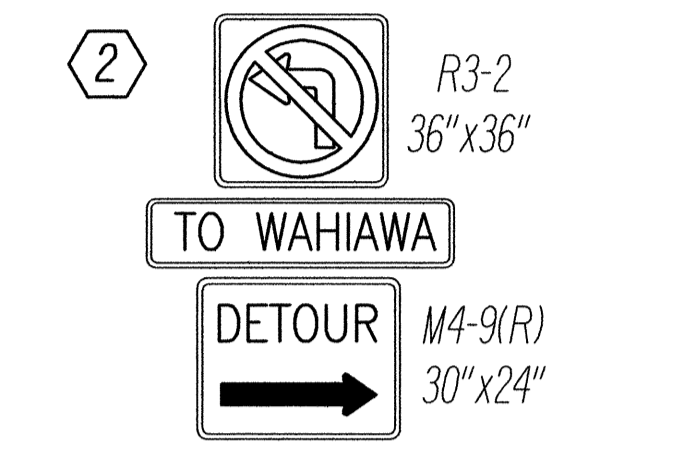
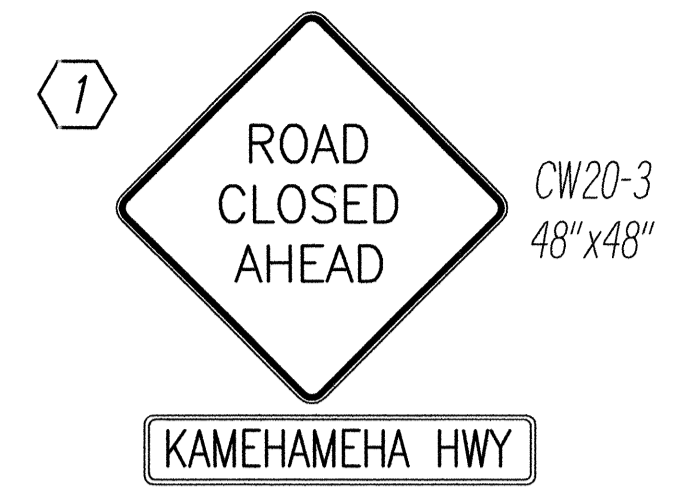

STATE OF HAWAII  
 DEPARTMENT OF TRANSPORTATION  
 HIGHWAYS DIVISION  
**TRAFFIC CONTROL PLAN - 6**  
**DETOUR ROUTE (NIGHT WORK)**  
 KAMEHAMEHA HIGHWAY  
 Repair and Paint Karsten Thot Bridge  
 Federal Aid Project No. BR-080-(1012)  
 Scale: AS NOTED Date: September 2014  
 SHEET No. C-6 OF 9 SHEETS

FED. ROAD DIST. NO.	STATE	FED. AID PROJ. NO.	FISCAL YEAR	SHEET NO.	TOTAL SHEETS
HAWAII	HAW.	BR-080-1(012)	2014	17	82

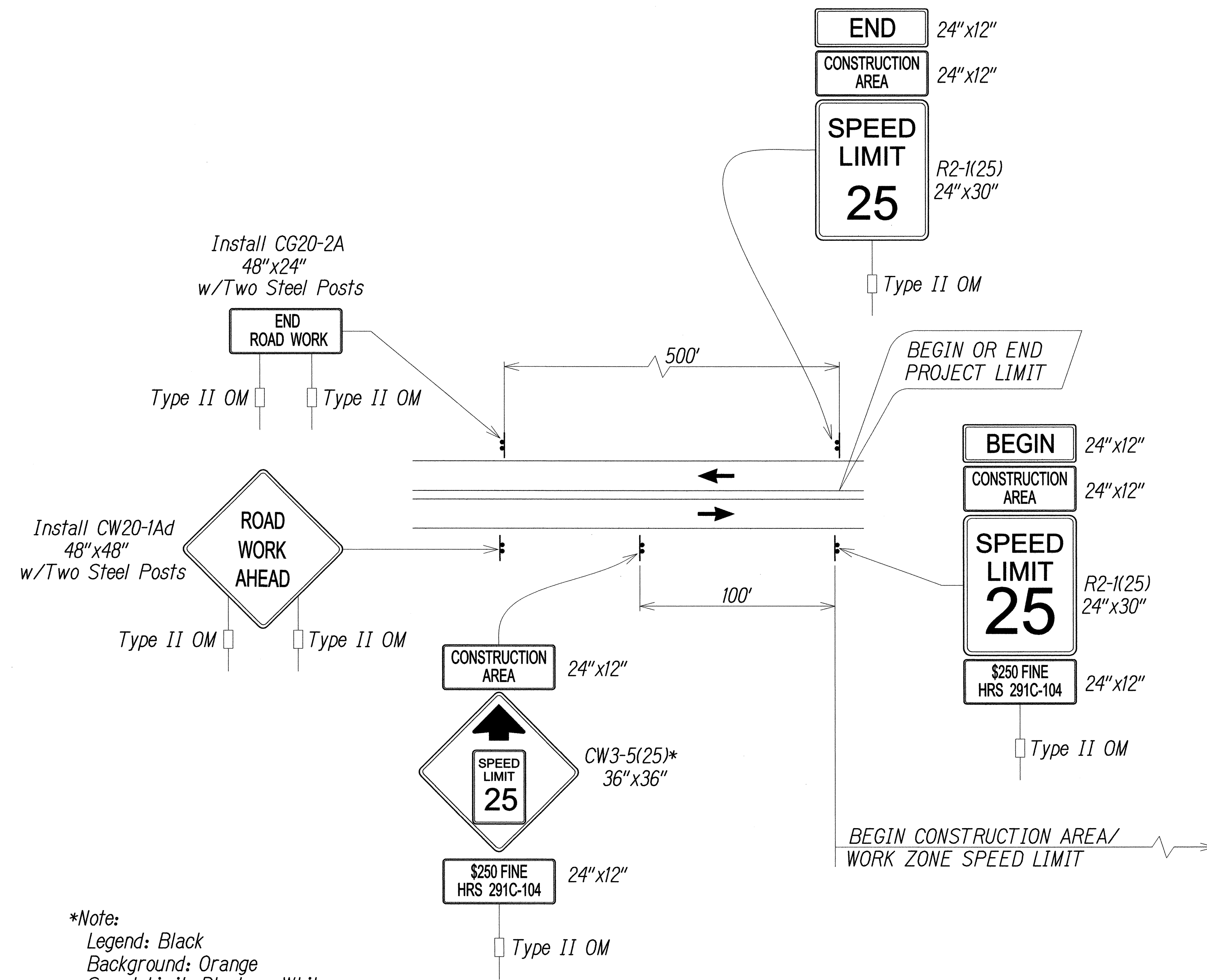

**Work Zone Notes:**

1. This Work Zone Sign Plan is intended for use on long-term stationary work zones/construction phases (3 days or more). All work zones or construction phases less than 3 days duration will use Traffic Control Plans shown in Section 645 of the Special Provisions.
2. All existing regulatory speed limit signs with posts within the work zone/project limits shall be removed and replaced with work zone speed limit sign assemblies R2-1(XX) and CW3-5(XX) with "CONSTRUCTION AREA" and "\$250 FINE HRS 291C-104 Supplemental Signs).
3. Construction sign assemblies shall be installed on both the approaching and trailing ends of each work zone as shown on this plan.
4. Each construction warning sign shall have a minimum of two (2) Type II OM. Each work zone speed limit assembly shall have a minimum of one (1) Type II OM. Installation of each Type II OM shall be considered incidental to Item No. 621.7100, Construction Sign with Posts.
5. Upon the completion of all physical work or as directed by the Engineer, all construction signs and work zone speed limit assemblies shall be removed. All speed limit signs and posts that were existing at the start of the project within the work zone/project limits shall be restored back to their original locations and configurations.
6. Placement of construction signs shall not obstruct the path of pedestrians and bicyclists.
7. The removal and restoration of existing regulatory speed limit signs with new posts along with the installation, maintenance and removal of work zone speed limit sign assemblies shall be considered incidental to Item No. 621.7100, Construction Sign with Posts.

\*Note:  
 Legend: Black  
 Background: Orange  
 Speed Limit: Black on White

**TYPICAL DETAIL FOR CONSTRUCTION SIGNS  
 ON TWO LANE OR MULTILANE UNDIVIDED LOW SPEED HIGHWAY**

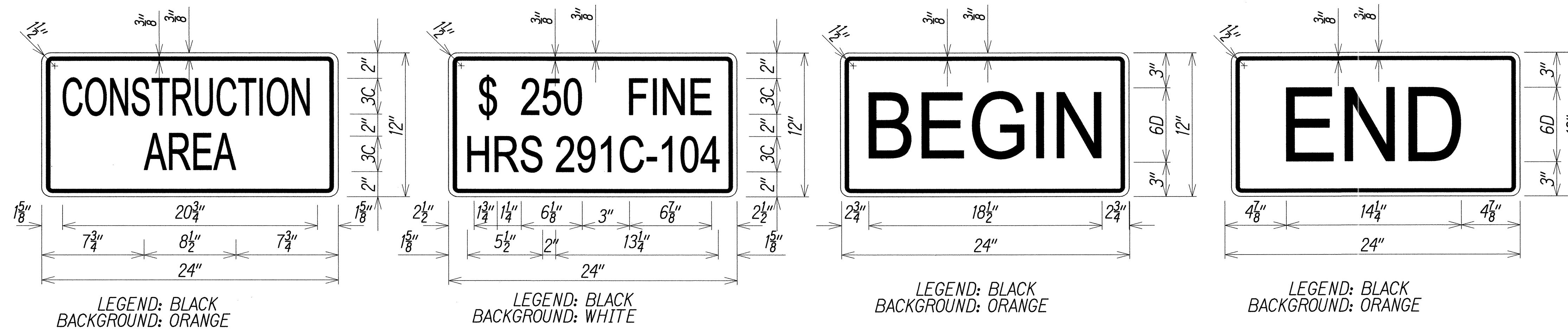

SURVEY PLOTTED BY	DATE
DRAWN BY	
DESIGNED BY	
NOTED BY	
CHECKED BY	
ORIGINAL PLAN	
NOTEBOOK	
No.	

LICENSE EXPIRES 4/30/16  
 THIS WORK WAS PREPARED BY ME OR UNDER MY SUPERVISION

STATE OF HAWAII  
 DEPARTMENT OF TRANSPORTATION  
 HIGHWAYS DIVISION

**LOW SPEED UNDIVIDED HIGHWAY  
 WORK ZONE SIGNING PLAN, NOTES & DETAILS**

KAMEHAMEHA HIGHWAY  
 Repair and Paint Karsten Thot Bridge  
 Federal Aid Project No. BR-080-1(012)

Scale: AS NOTED Date: September 2014

FED. ROAD DIST. NO.	STATE	FED. AID PROJ. NO.	FISCAL YEAR	SHEET NO.	TOTAL SHEETS
HAWAII	HAW.	BR-080-1(012)	2014	18	82

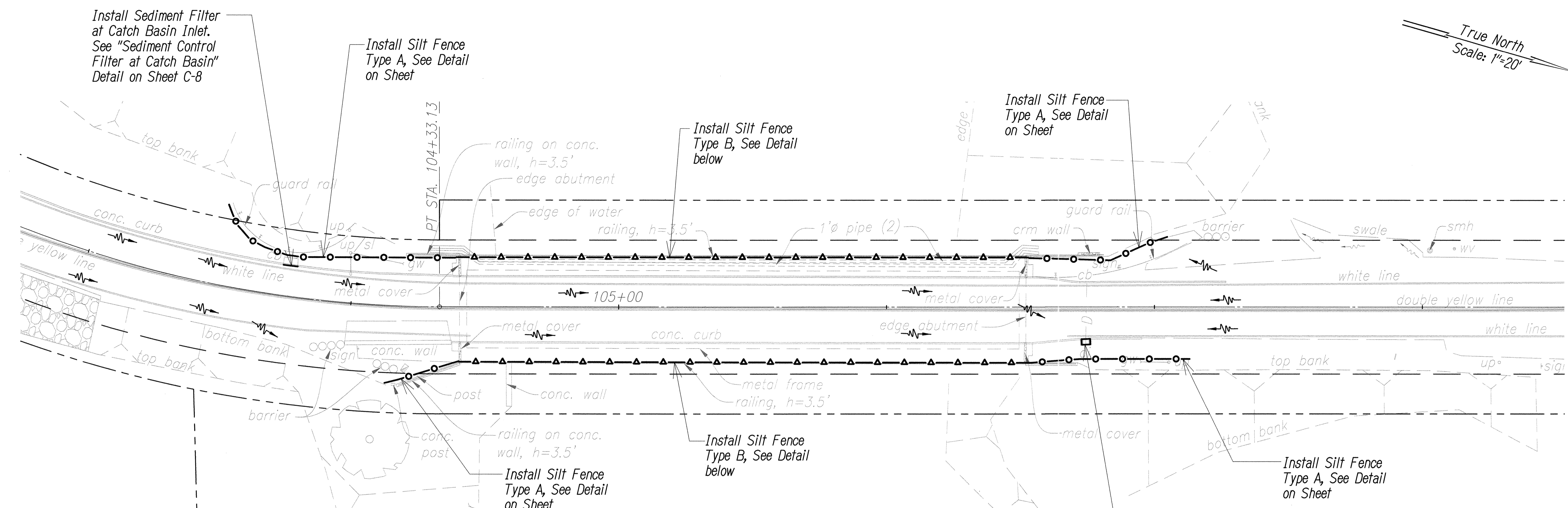

True North  
Scale: 1"=20'

### EROSION CONTROL PLAN

Scale: 1"=20'

#### BMP NOTES:

- The Contractor shall use full water depth silt curtains to enclose the work area to control turbidity during all over-water work. If a plume is observed outside of the silt curtains that is caused by the construction activity, the Contractor shall stop the activity and take corrective action immediately. This work shall be considered part of Best Management Practices (BMP) work.
- No debris shall be allowed to enter the water. The Contractor shall provide a temporary platform or other suitable positive means of capturing debris from construction and demolition operations. These facilities shall be in place prior to starting demolition work. This work shall be considered part of Best Management Practices (BMP) work.
- Wastewater from demolition work shall not be discharged into the reservoir. The Contractor shall capture all pollutants and dispose of them at recycling or disposal facilities permitted by the Department of Health. This work shall be considered part of Best Management Practices (BMP) work.
- The Contractor will be responsible for regulatory fines or penalties that may be imposed by environmental regulatory agencies (EPA and/or State DOH) as a result of improper construction activities.
- Contractor must abide by all State and Federal Environmental laws including the State Water Quality Standards. No Discharges of any kind are permitted to the reservoir waters.

#### LEGEND

- Silt Fence Type A
- Silt Fence Type B
- Sediment Filter
- Sediment Barrier
- Sand Bags

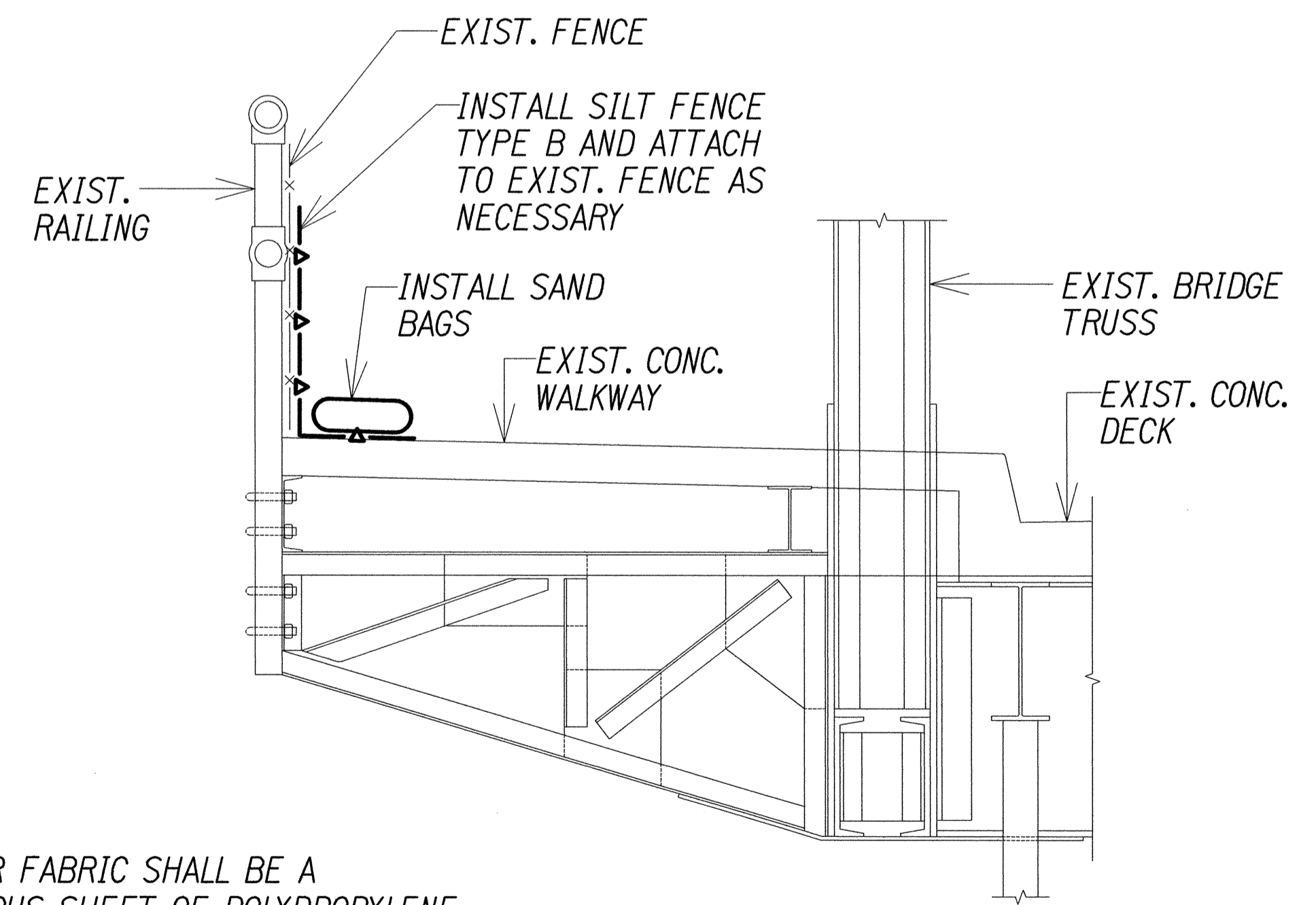

SECTION  
**SILT FENCE-TYPE B**

NOT TO SCALE

**NOTE:**  
FILTER FABRIC SHALL BE A PERVIOUS SHEET OF POLYPROPYLENE, NYLON, POLYESTER OR ETHYLENE YARN WITH UV INHIBITORS AND STABILIZERS.

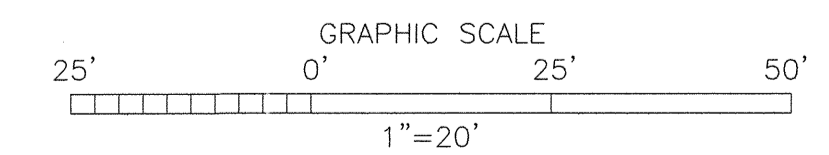

SURVEY PLOTTED BY	DATE
DRAWN BY	
DESIGNED BY	
QUANTITIES BY	
CHECKED BY	
GENERAL PLAN	
NOTEBOOK	
No.	

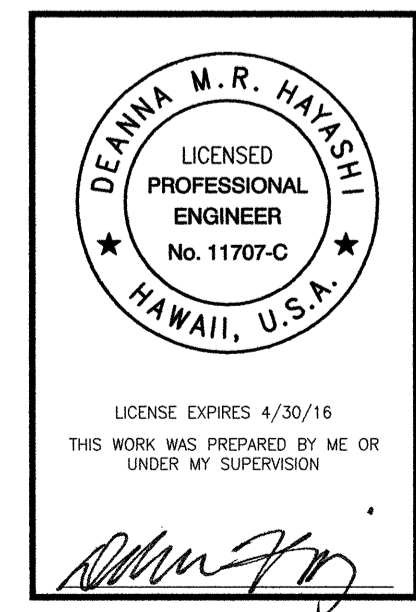

STATE OF HAWAII  
DEPARTMENT OF TRANSPORTATION  
HIGHWAYS DIVISION

**EROSION CONTROL PLAN**

**KAMEHAMEHA HIGHWAY**  
**Repair and Paint Karsten Thot Bridge**  
**Federal Aid Project No. BR-080-1(012)**

Scale: AS NOTED Date: September 2014

SHEET No. C-7 OF 9 SHEETS

FED. ROAD DIST. NO.	STATE	FED. AID PROJ. NO.	FISCAL YEAR	SHEET NO.	TOTAL SHEETS
HAWAII	HAW.	BR-080-1(012)	2014	19	82

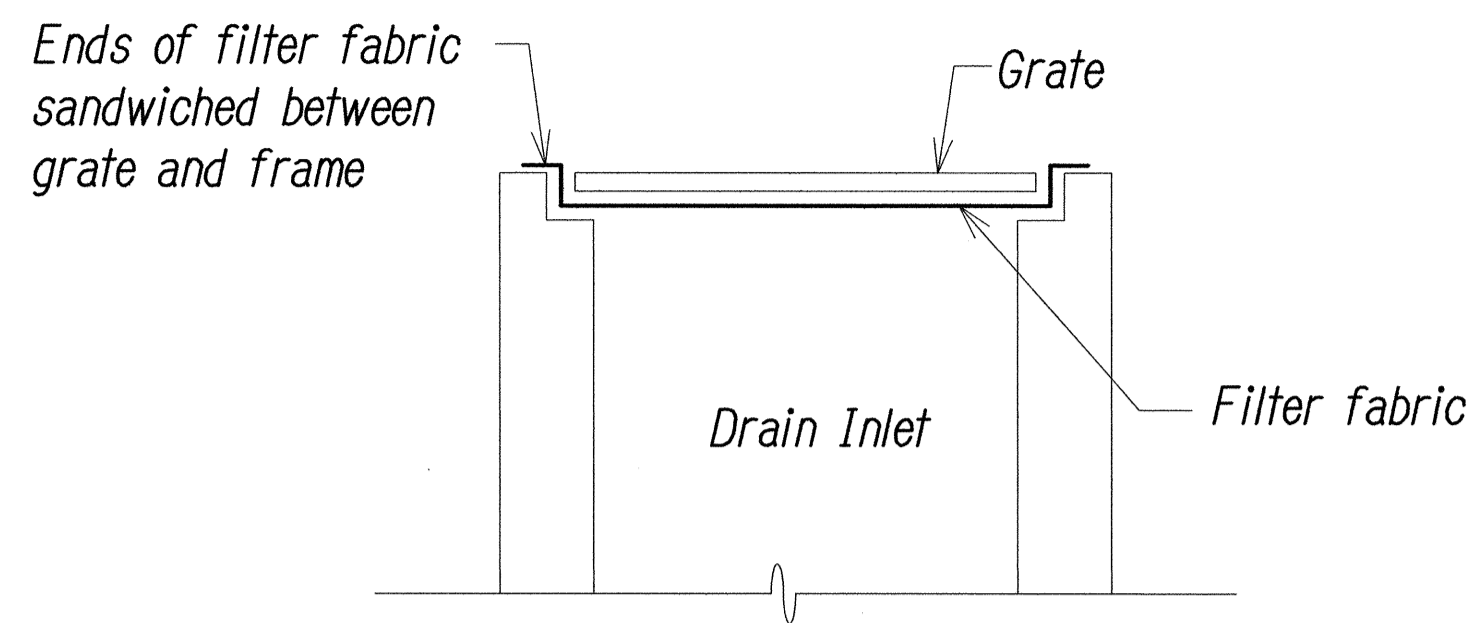

**NOTES:**

1. Filter fabric shall be 15 mil (min.) or approved equal.
2. Contractor shall check the condition of the filter at the beginning and ending of each work day and repair/clean as necessary.
3. The contractor shall remove inlet filters during times of above normal rainfall events and replace them when the event has passed.

**TEMPORARY SEDIMENT BARRIER**

**AT DRAIN INLET**

NOT TO SCALE

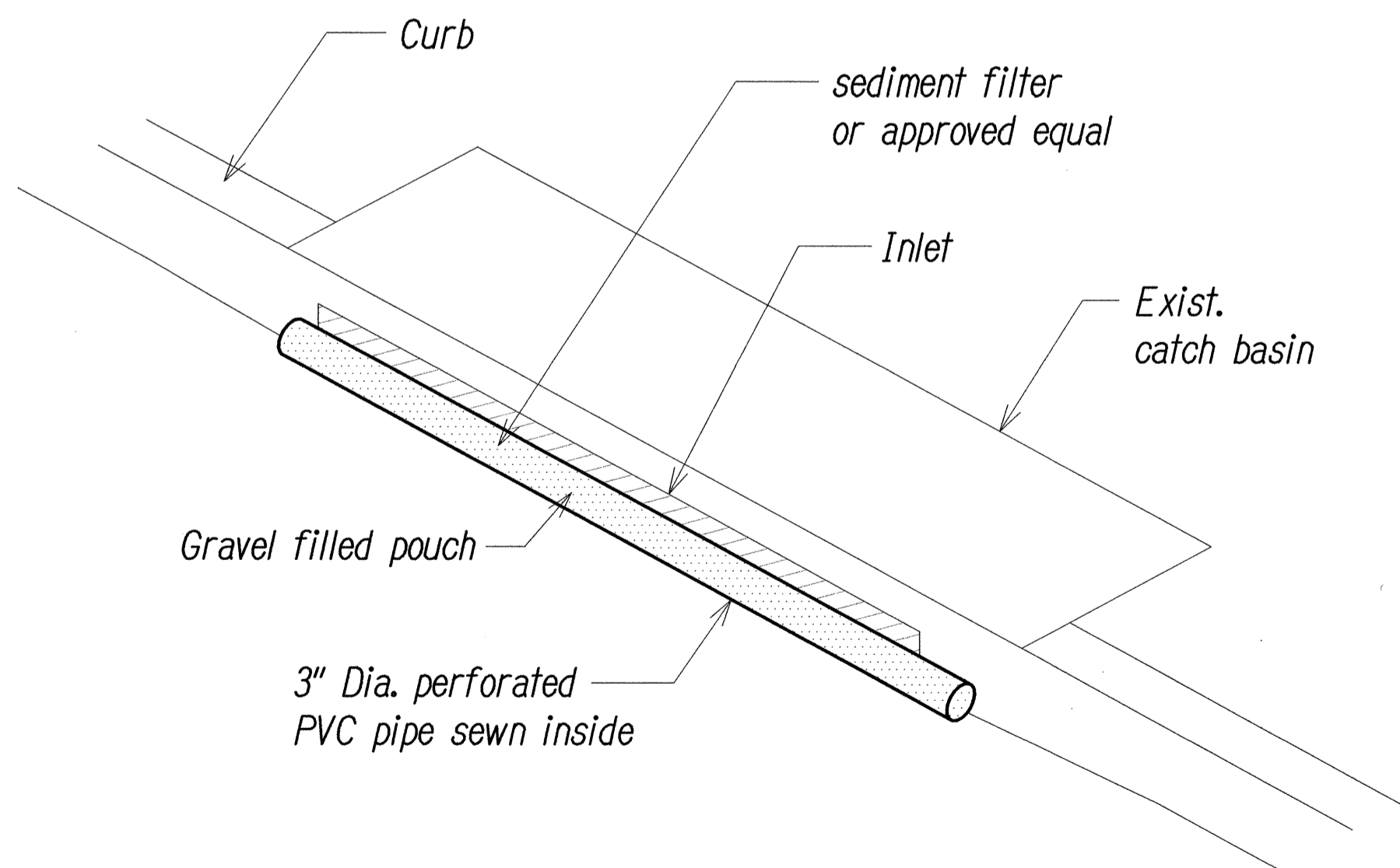

**SEDIMENT CONTROL FILTER**

**AT CATCH BASIN**

NOT TO SCALE

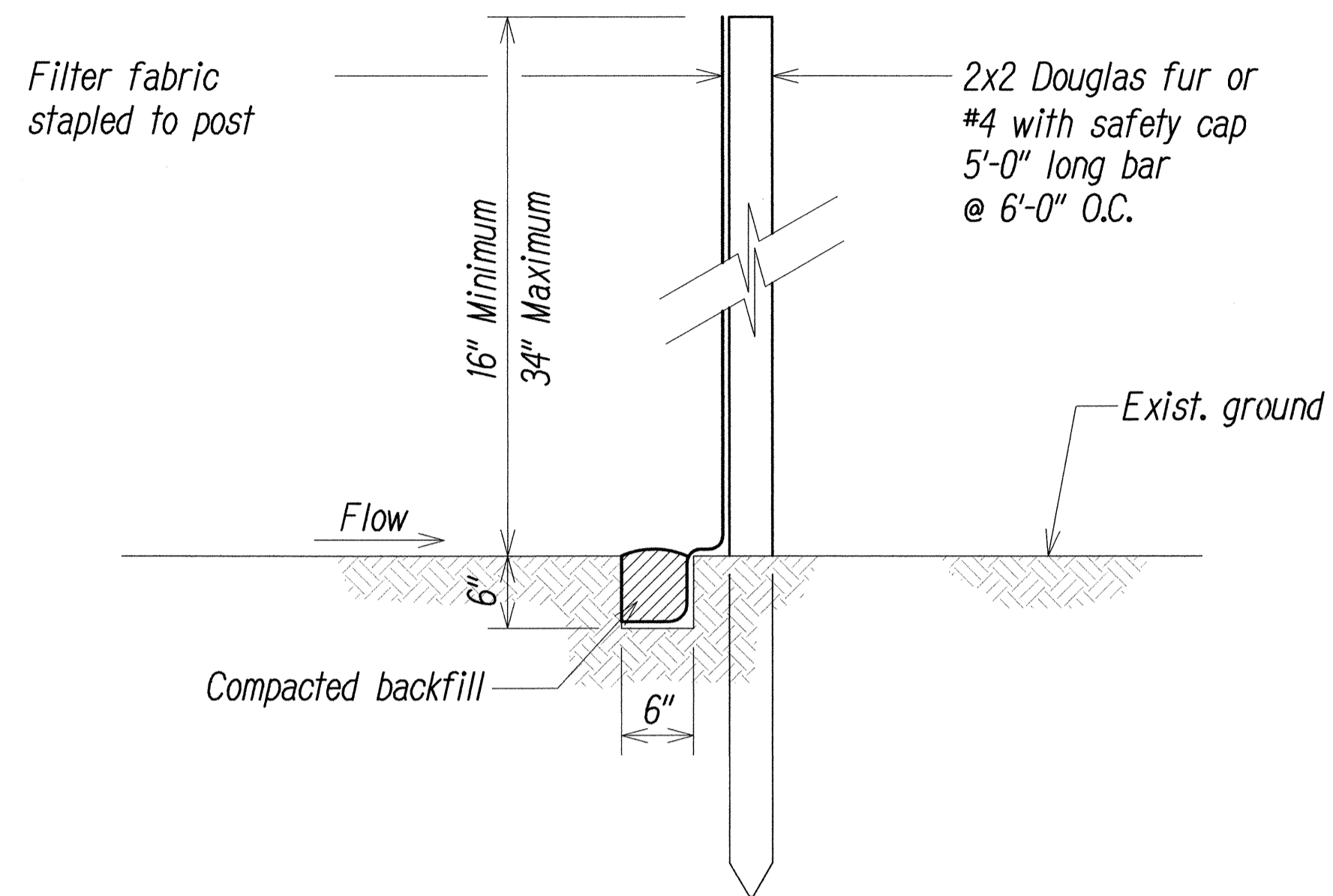

**NOTES:**

Filter fabric shall be a pervious sheet of polypropylene, nylon, polyester or ethylene yarn with UV inhibitors and stabilizers.

**SECTION**

**SILT FENCE-TYPE A**

NOT TO SCALE

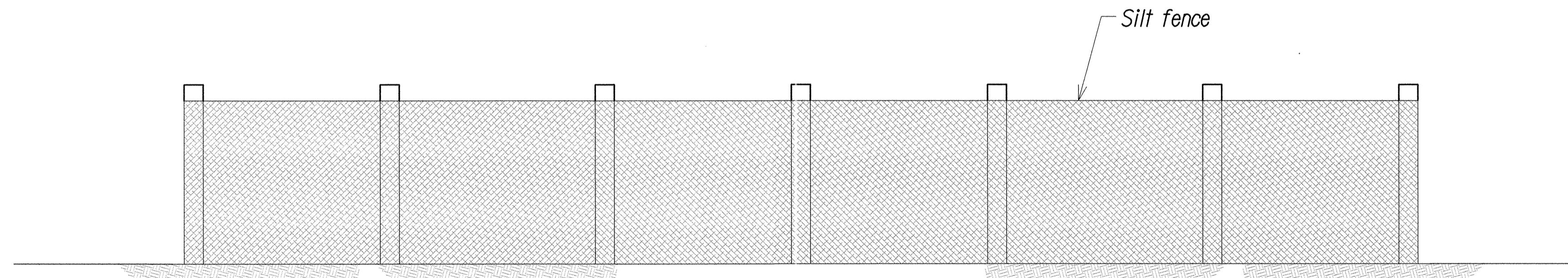

**ELEVATION**

**DETAIL SILT FENCE**

NOT TO SCALE

**BEST MANAGEMENT PRACTICES**

**(BMP) NOTES MINIMUM:**

**DURING CONSTRUCTION**

1. Provide a filter at catch basin openings and/or drain inlets to prevent sediment from entering reservoir, see detail this sheet.
2. During construction, dust pollution shall be kept to a minimum.
3. The contractor shall ensure that all tires of construction vehicles are sufficiently cleaned off so that dirt or debris is not tracked off the construction site. Washing off tires with water will not be acceptable unless the runoff is contained and does not enter the storm drain system.
4. The contractor shall remove filters during times of above normal rainfall events and replace them when event has passed.
5. The contractor shall install a sediment filter at the nearest existing down stream catch basins and/or drain inlets on both sides of the roadway.

**POST CONSTRUCTION**

1. The construction area and surrounding areas shall be cleared of all trash and debris.
2. All mobilized equipment shall be removed.

DESIGNED BY	DATE
DRAWN BY	
TRACED BY	
DESIGNED BY	
QUANTITIES BY	
CHECKED BY	
NO.	

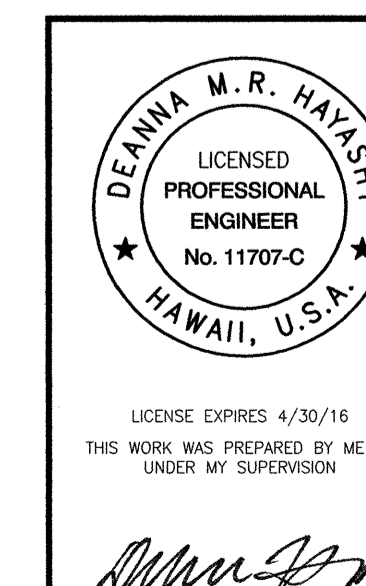

STATE OF HAWAII  
DEPARTMENT OF TRANSPORTATION  
HIGHWAYS DIVISION

**EROSION CONTROL DETAILS  
AND NOTES**

**KAMEHAMEHA HIGHWAY**  
**Repair and Paint Karsten Thot Bridge**  
**Federal Aid Project No. BR-080-1(012)**

Scale: AS NOTED Date: September 2014

SHEET No. C-9 OF 9 SHEETS