

FED. ROAD DIST. NO.	STATE	PROJ. NO.	FISCAL YEAR	SHEET NO.	TOTAL SHEETS
HAWAII	HAW.	78A-01-02M	2002	11	92

LEGEND

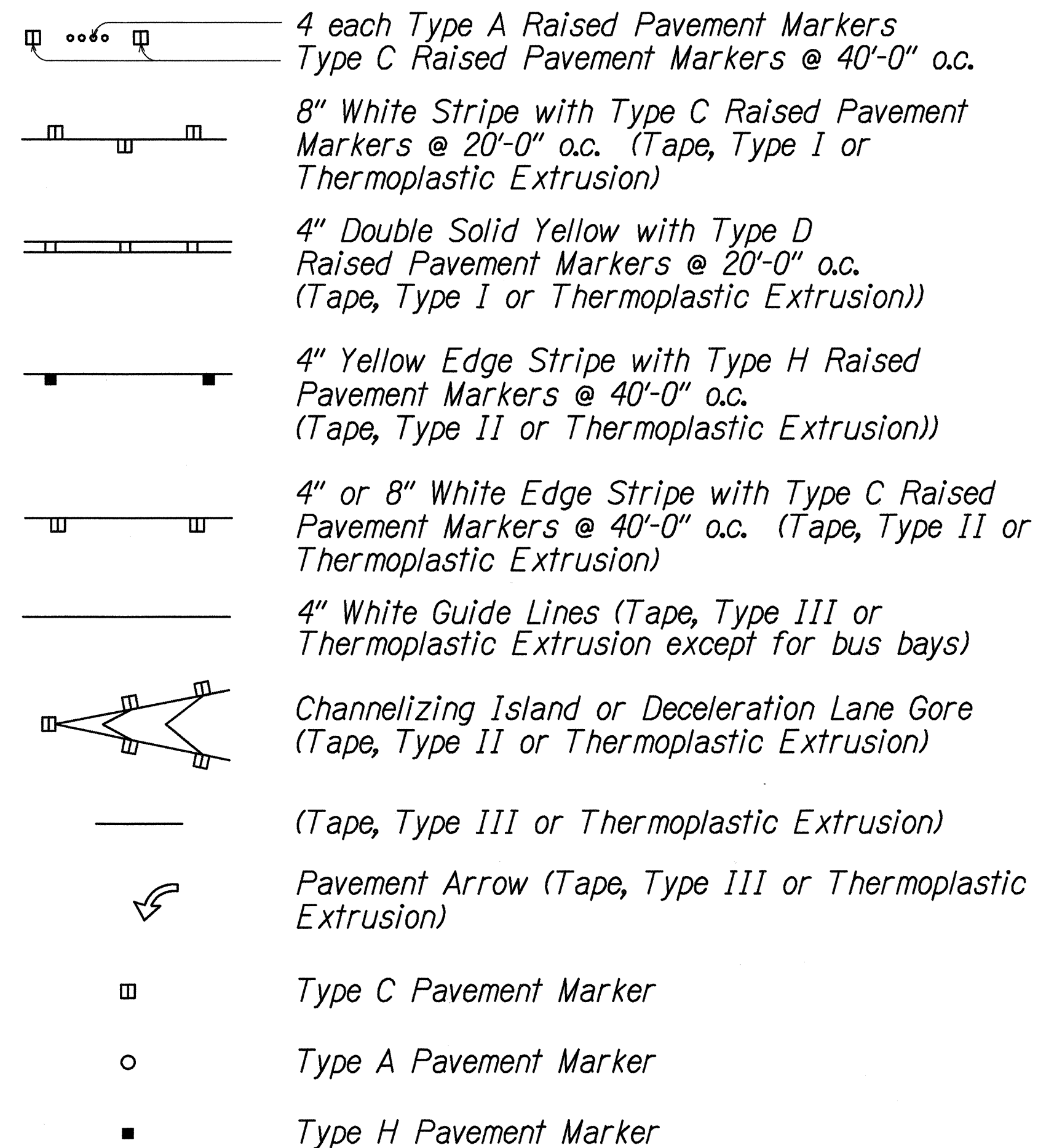

NOTES

1. *Layout of pavement markings and striping shall be done by the Contractor and approved by the Engineer prior to any installation work.*
2. *Existing pavement markings not incorporated in the final traffic pattern shall be removed as directed by the Engineer. Costs shall be incidental to the various pavement marking items.*
3. *Raised pavement markers shall not be installed within crosswalks.*
4. *Existing signs shall remain as posted unless otherwise directed by the Engineer.*
5. *Final locations of all Stop Lines shall be approved by the Engineer prior to installation.*
6. *All pavement striping shall be as noted on the legend or plans.*
7. *All preformed pavement marking tapes over existing pavement shall be applied with an approved primer as recommended by the tape manufacturer and as approved by the Engineer. The primer shall be allowed to dry to the tacky stage prior to tape application.*
8. *The Contractor shall erect at the beginning of the project and at the end of the project advance construction warning signs placed as indicated on the plans or as directed by the Engineer for the duration of the highway project and shall be maintained by the Contractor. These signs shall be placed in addition to the required traffic control signs called for in Section 645 - Traffic Control. The advance construction warning signs shall be new and become the property of the State. The Contractor shall remove, clean, and deliver the signs and posts to the District Baseyard, or as directed by the Engineer, upon the completion of the project.*
9. *The Contractor shall install new Type II Object Marker on all new utility poles that are within the State Highway Right-of-Way as directed by the Engineer. (46 Each)*

ORIGINAL PLAN	SURVEY PLOTTED BY _____ DATE _____
NOTE BOOK	DRAWN BY _____
	TRACED BY _____
	DESIGNED BY _____
	QUANTITIES BY _____
Na. C-50027Adg	CHECKED BY _____

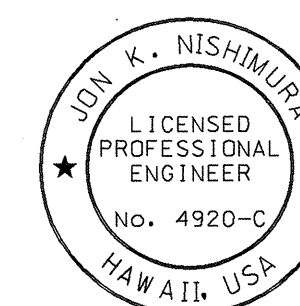

THIS WORK WAS PREPARED BY
ME OR UNDER MY SUPERVISION

Atsuhiko Fujinaga
FUJINAGA & ASSOCIATES, INC.

STATE OF HAWAII
DEPARTMENT OF TRANSPORTATION
HIGHWAYS DIVISION
PAVEMENT MARKING
LEGEND, DETAILS AND NOTES
MOANALUA FREEWAY LIGHTING IMPROVEMENTS
KAMEHAMEHA HIGHWAY TO HI HALAWA INTERCHANGE
PROJ. NO. 78A-01-02M
Oahu, Hawaii
Scale: As Noted Date: May 2002
SHEET No. C-6 OF 23 SHEETS

FED. ROAD DIST. NO.	STATE	PROJ. NO.	FISCAL YEAR	SHEET NO.	TOTAL SHEETS
HAWAII	HAW.	78A-01-02M	2002	12	92

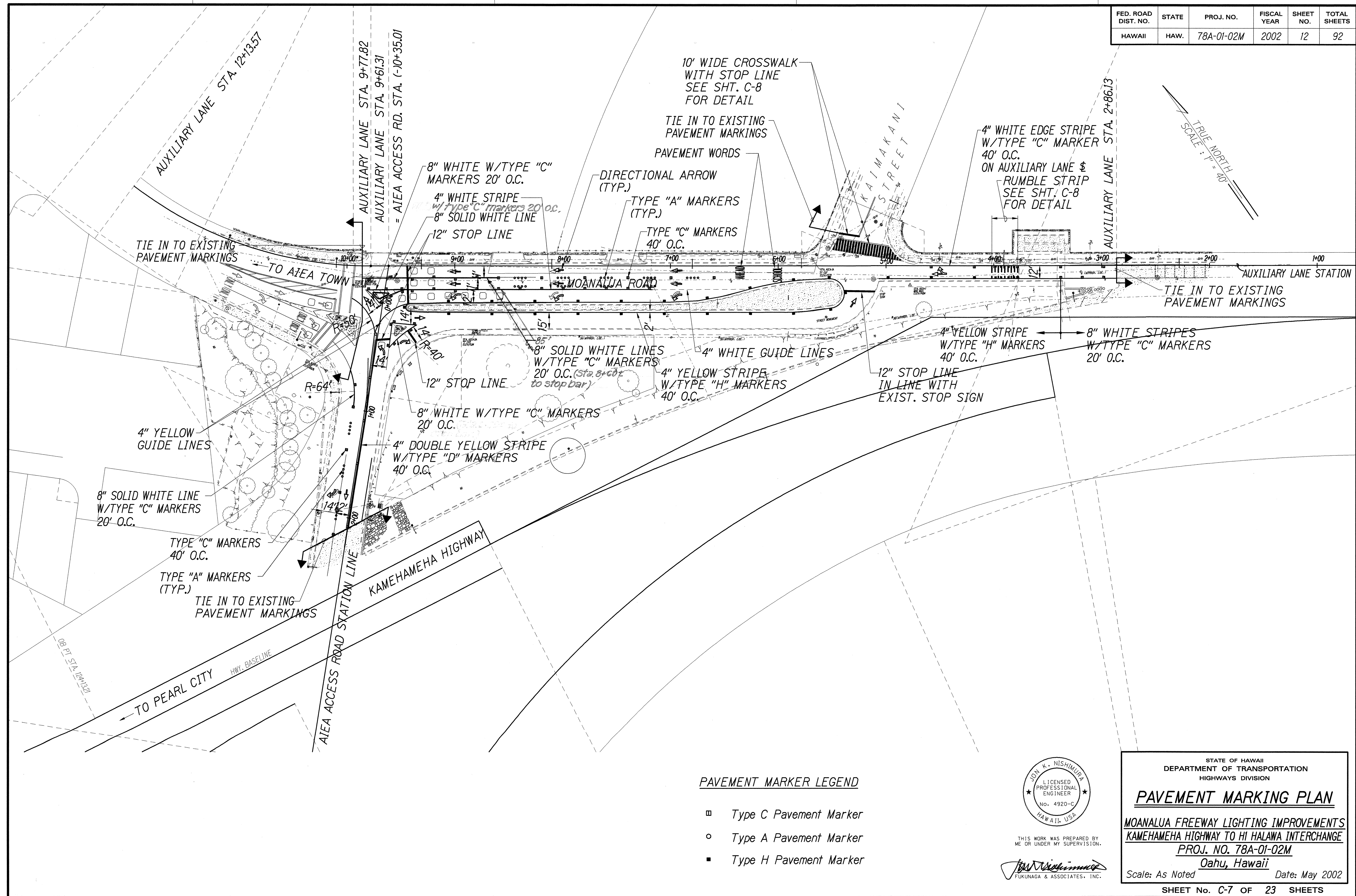

ORIGINAL PLAN	DATE
SURVEY PLOTTED BY	
DRAWN BY	
DESIGNED BY	
CHECKED BY	
DATE	

PAVEMENT MARKER LEGEND

- ▣ Type C Pavement Marker
- Type A Pavement Marker
- Type H Pavement Marker

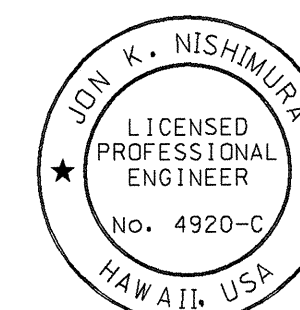

THIS WORK WAS PREPARED BY
ME OR UNDER MY SUPERVISION.

K. Nishimura
FUKUNAGA & ASSOCIATES, INC.

STATE OF HAWAII
DEPARTMENT OF TRANSPORTATION
HIGHWAYS DIVISION

PAVEMENT MARKING PLAN
 MOANALUA FREEWAY LIGHTING IMPROVEMENTS
 KAMEHAMEHA HIGHWAY TO HI HALAWA INTERCHANGE
 PROJ. NO. 78A-01-02M
 Oahu, Hawaii
 Scale: As Noted Date: May 2002

SHEET No. C-7 OF 23 SHEETS

"AS-BUILT"