

INDEX TO DRAWINGS	
SHEET NO.	DESCRIPTION
1	TITLE SHEET
2	STANDARD PLANS SUMMARY
3	GENERAL NOTES, LEGEND, AND ABBREVIATIONS
4 - 6	UTILITY NOTES
7 - 8	WATER POLLUTION AND EROSION CONTROL NOTES
9 - 13	TYPICAL SECTIONS
14 - 23	ROADWAY PLANS
24	ROADWAY CONSTRUCTION DETAILS
25	LOW SPEED DIVIDED HIGHWAY WORK ZONE SIGNING PLAN, NOTES AND DETAILS
26 - 27	MILLED RUMBLE STRIP NOTES AND DETAILS
28	SIGNING AND PAVEMENT MARKING LEGEND, DETAILS AND NOTES
29 - 38	SIGNING AND PAVEMENT MARKING PLANS

STATE OF HAWAII  
DEPARTMENT OF TRANSPORTATION  
HIGHWAYS DIVISION  
HONOLULU, HAWAII  
**"AS-BUILT"**  
PLANS FOR  
**FORT WEAVER ROAD  
PAVEMENT PRESERVATION**  
RENTON ROAD TO THE VICINITY OF EWA BEACH ROAD  
**FEDERAL AID PROJECT NO. STP-076-1(10)**  
DISTRICT OF EWA  
ISLAND OF OAHU

FED. ROAD DIST. NO.	STATE	FEDERAL AID PROJ. NO.	FISCAL YEAR	SHEET NO.	TOTAL SHEETS
HAWAII	HAW.	STP-076-1(10)	2011	1	38

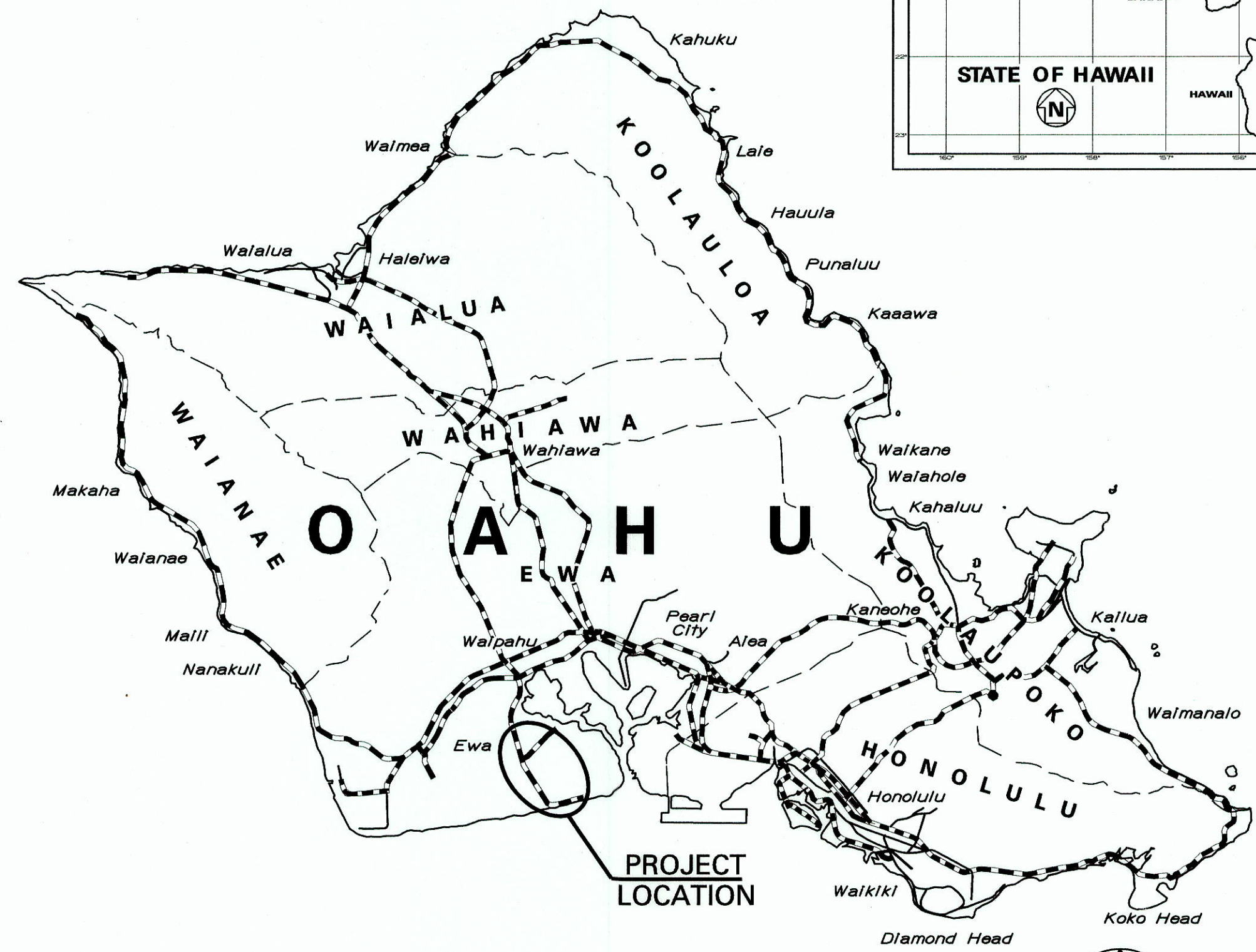
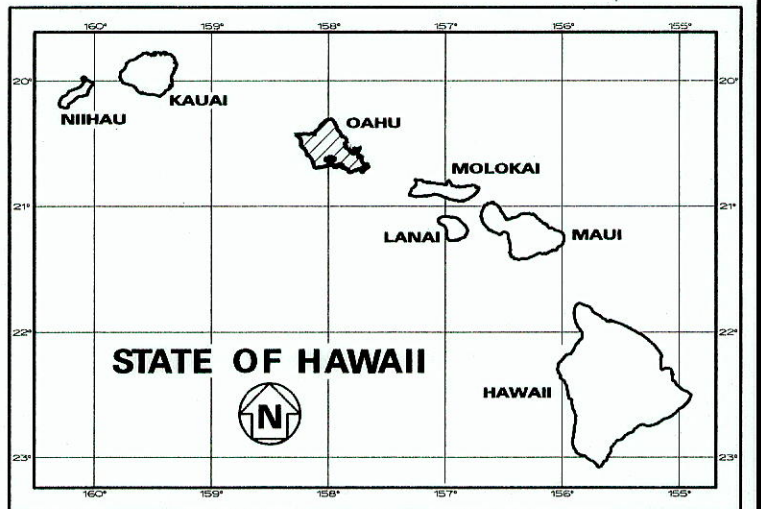

CHANGES MADE DURING CONSTRUCTION HAVE BEEN INCORPORATED ON THESE PLANS EXCEPT CHANGES IN THE ORIGINAL THEORETICAL QUANTITIES. FOR ACTUAL QUANTITIES, REFER TO PROJECT LEDGER AND/OR COMPUTATION BOOK.

*[Signature]* 9/25/15  
RESIDENT ENGINEER DATE

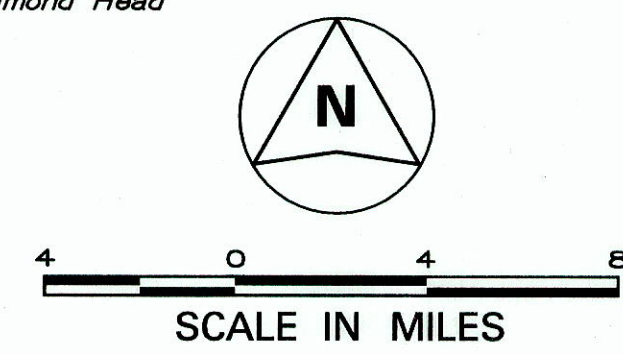

----- FEDERAL AID PROJECTS PREVIOUSLY CONSTRUCTED OR UNDER CONSTRUCTION

MILE POST 0.70 TO MILE POST 3.99

DESIGN DESIGNATION

	MP 0.77-1.28	MP 1.28-2.11	MP 2.11-2.97	MP 2.97-3.99
ADT(2010)	6,660	24,900	32,200	53,900
ADT(2020)	6,790	34,170	32,860	64,900
DHV	510	2,560	2,470	4,900
D	55/45	55/45	60/40	60/40
T	3.5%	3.0%	3.5%	3.0%
T 24	4.5%	3.5%	4.0%	3.5%
V	25.0	25.0	45.0	45.0

DEPARTMENT OF TRANSPORTATION  
STATE OF HAWAII  
APPROVED: *[Signature]*  
DIR. OF TRANSPORTATION DATE

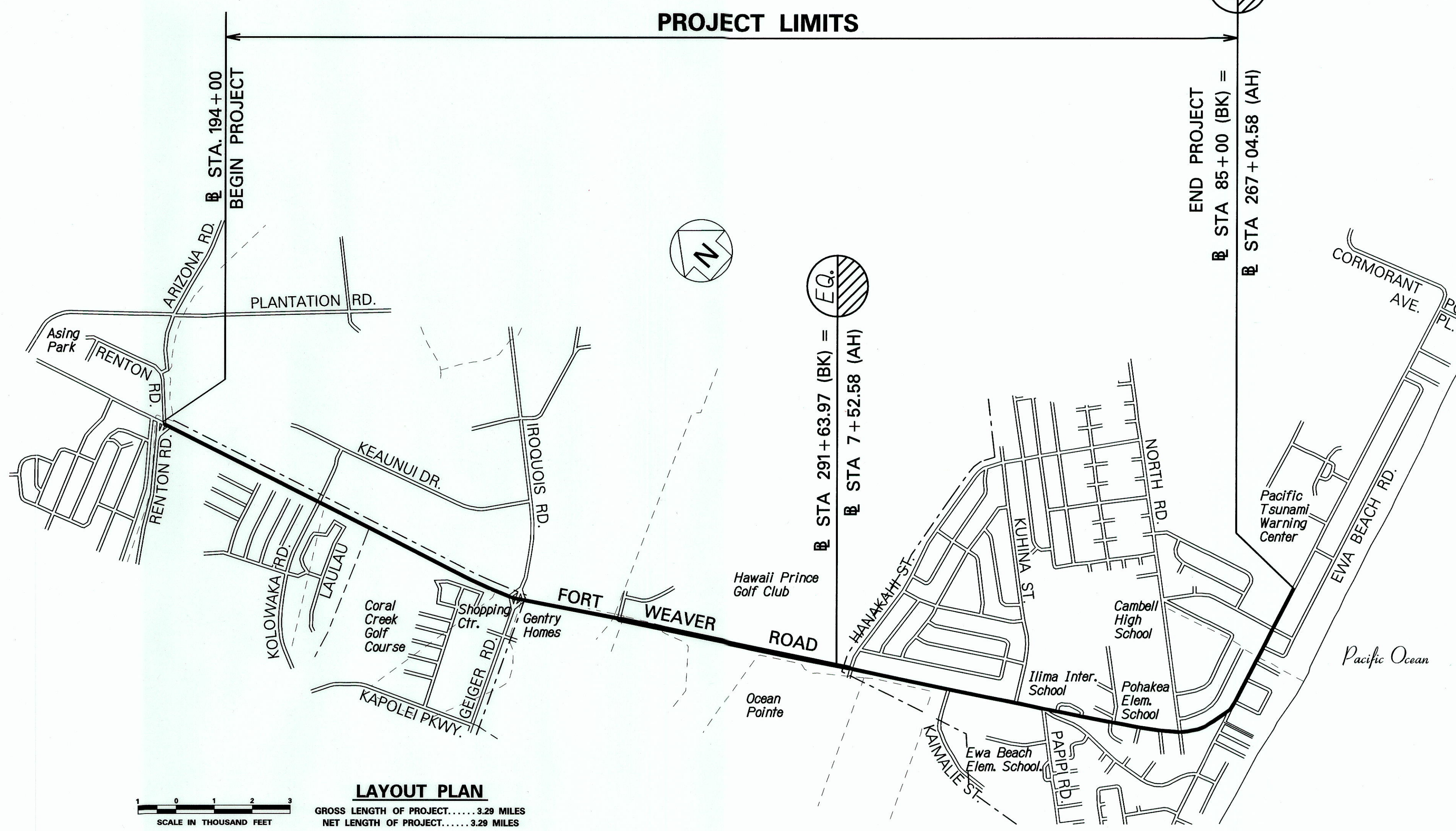

LAYOUT PLAN  
GROSS LENGTH OF PROJECT..... 3.29 MILES  
NET LENGTH OF PROJECT..... 3.29 MILES

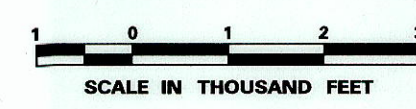

PB AMERICAS, INC. DESIGNED BY  
HWY-DD MANAGED BY  
692-7570 PHONE  
FEB 2011 DATE

ORIGINAL PLAN	SURVEY PLOTTED BY	DATE
NOTE BOOK	DRAWN BY	
	CHECKED BY	
	QUANTITIES BY	