

FED. ROAD DIST. NO.	STATE	FED. AID PROJ. NO.	FISCAL YEAR	SHEET NO.	TOTAL SHEETS
HAWAII	HAW.	CMAQ-076-1(8)	2004	96	127

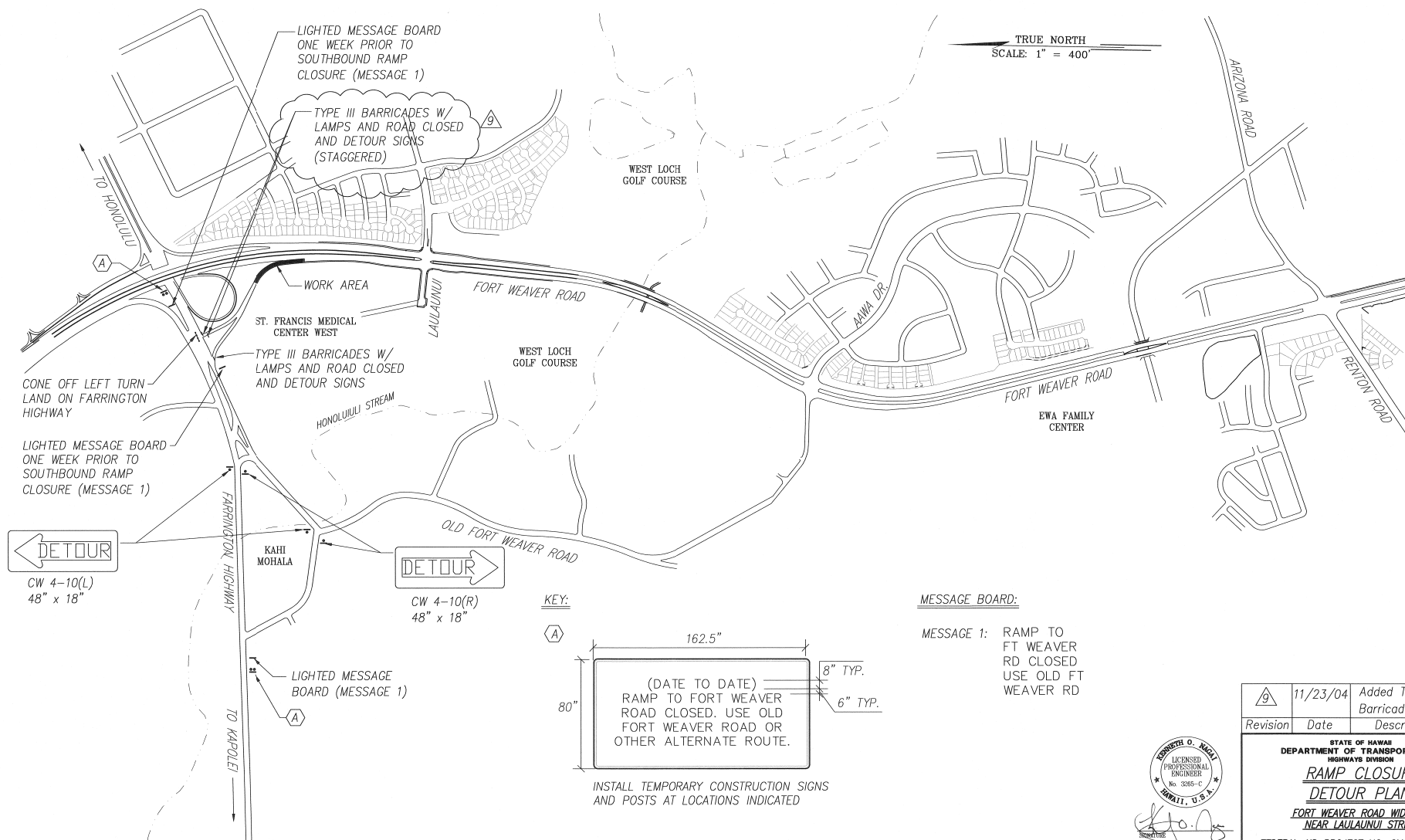

MESSAGE BOARD:

MESSAGE 1: RAMP TO
FT WEAVER
RD CLOSED
USE OLD FT
WEAVER RD

Revision	Date	Description
9	11/23/04	Added Type III Barricade

STATE OF HAWAII DEPARTMENT OF TRANSPORTATION HIGHWAYS DIVISION	
RAMP CLOSURE DETOUR PLAN	
FORT WEAVER ROAD WIDENING NEAR LAULAUNUI STREET	
FEDERAL AID PROJECT NO. CMAQ-076-1(8)	
SCALE: 1"=400'	DATE: October 2003
SHEET No. 1	OF 1 SHEETS



APRIL 30, 2006
EXPIRATION DATE OF LICENSE
THIS WORK WAS PREPARED BY ME OR
UNDER MY SUPERVISION