

DATE	REVISION
8/19/82	Corrected the Limits of the R.R. Track Reconstruction.

FED. ROAD DIST. NO.	STATE	FED. AID PROJ. NO.	FISCAL YEAR	SHEET NO.	TOTAL SHEETS
HAWAII	HAW.	76008-01-82 S-RS-0760(2)	1982	95	163

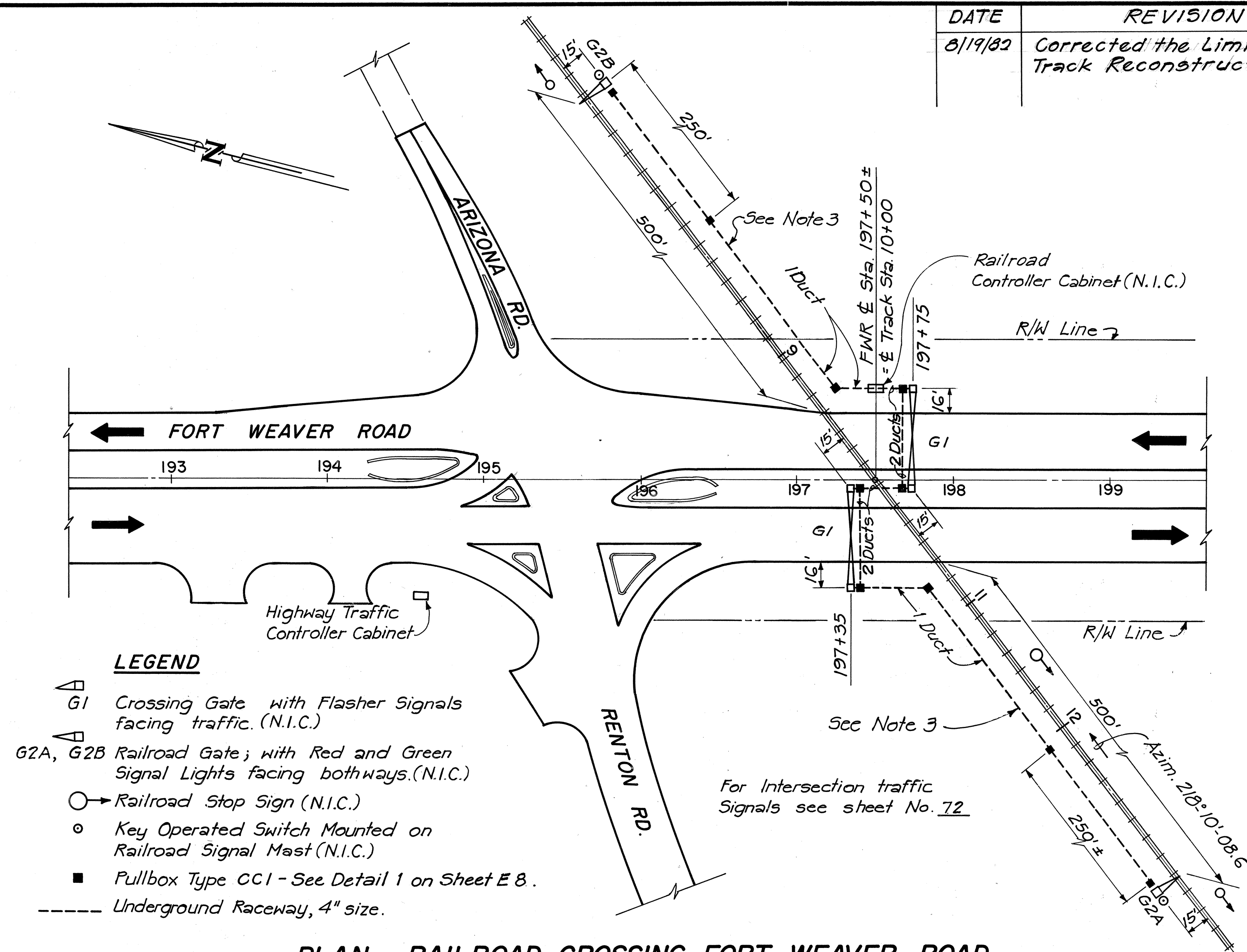

**PLAN - RAILROAD CROSSING-FORT WEAVER ROAD**  
Scale: 1" = 50'

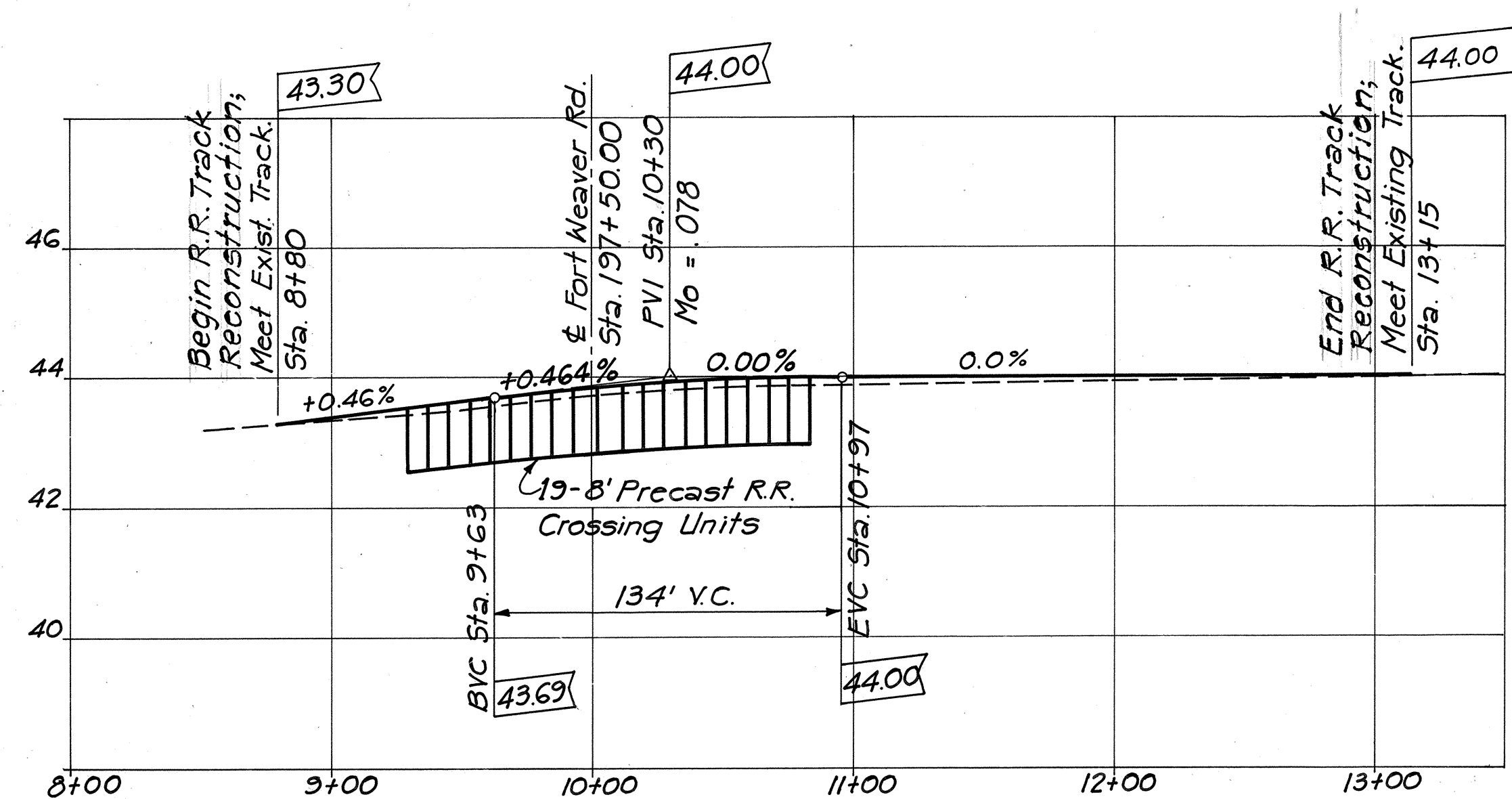

**PROFILE - RAILROAD CROSSING-FORT WEAVER ROAD**  
Scale: Horiz. 1" = 50'  
Vert. 1" = 2'

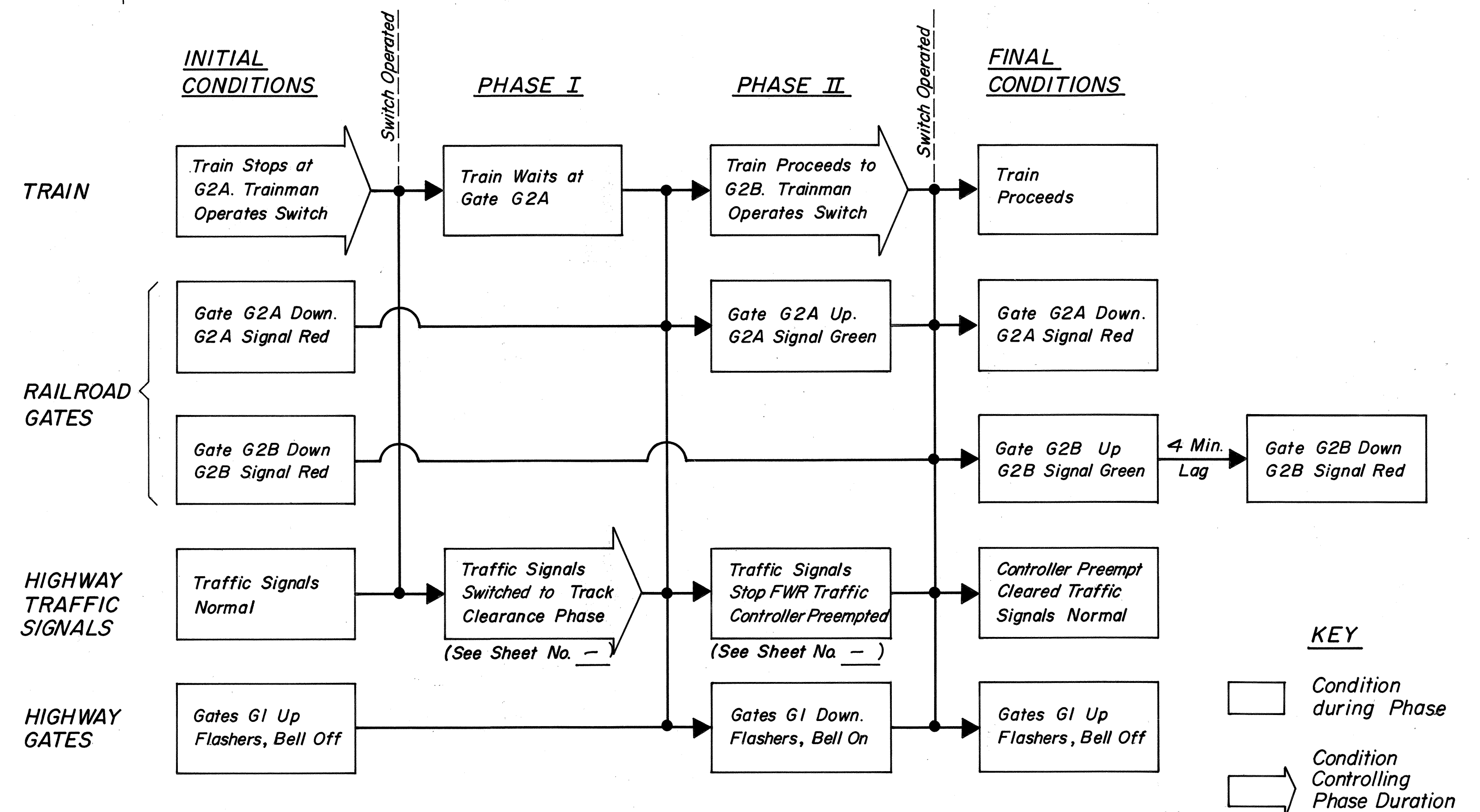

**CROSSING OPERATING SEQUENCE - EASTBOUND TRAIN**

\* Gates G2A and G2B reversed for Westbound Train

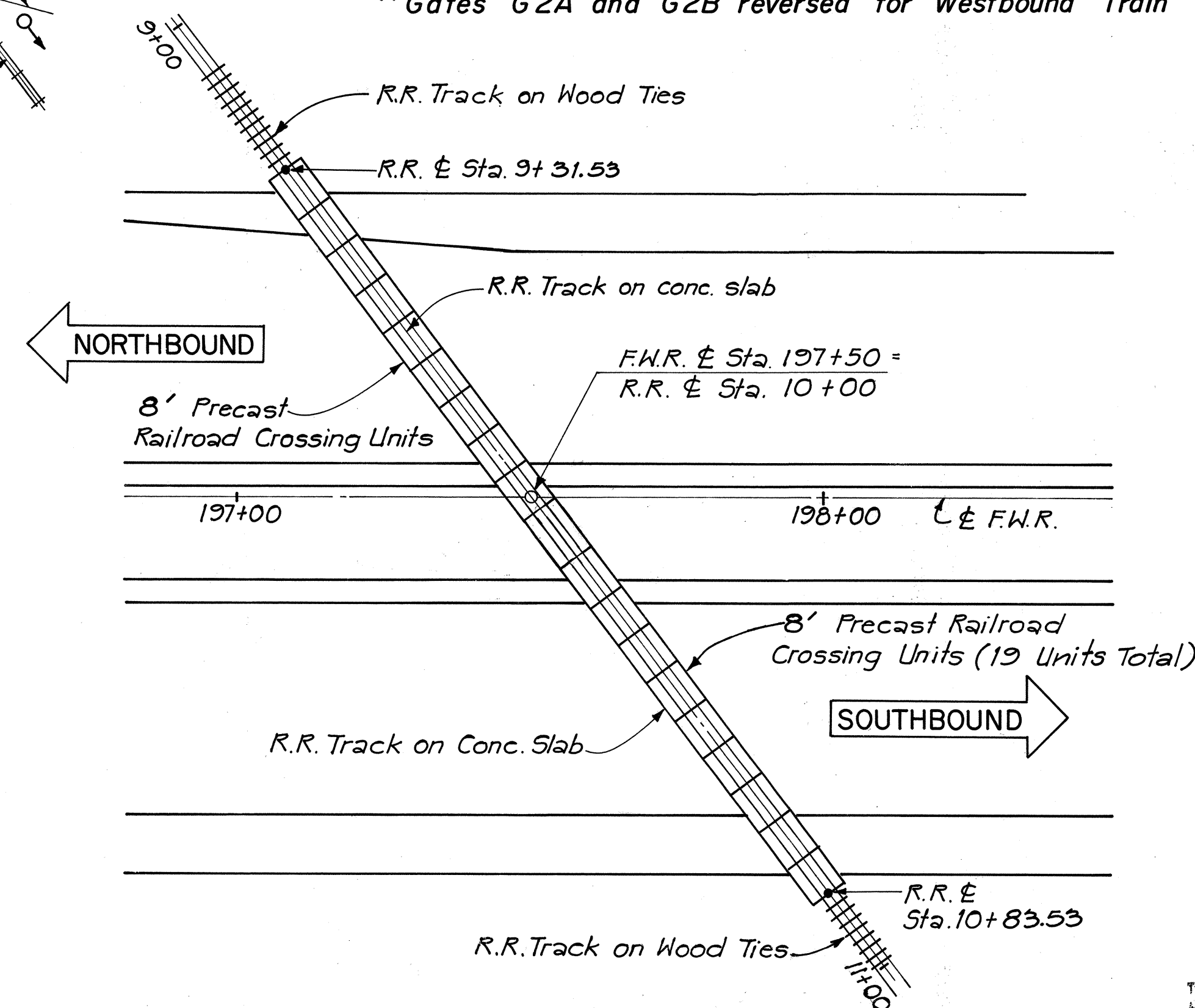

**RAILROAD TRACK PLAN**  
Scale: 1" = 20'

**GENERAL NOTES:**

- Existing Track and Ties from R.R. Sta. 8+80 to R.R. Sta. 13+15 are to be removed in accordance with the requirements of Section 202, "Removal of Structures and Obstructions," of the Standard Specifications.
- For Pavement Striping, see Sheet No. 49.
- Ductlines outside of State R/W will be by Others.

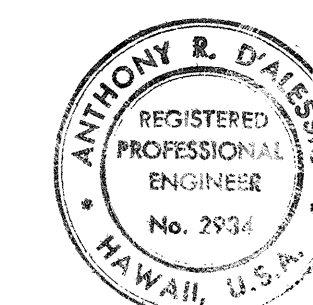

THIS WORK WAS PREPARED BY  
ME OR UNDER MY SUPERVISION  
*Anthony R. Dalesco*

STATE OF HAWAII DEPARTMENT OF TRANSPORTATION HIGHWAYS DIVISION	
<b>RAILROAD CROSSING PLAN AND PROFILE</b>	
FORT WEAVER ROAD VICINITY OF MANGO TREE ROAD TO THE VICINITY OF RENTON ROAD	
SCALE: AS SHOWN	DATE: APRIL 1982
SHEET NO. 1 OF 1 SHEETS	

96 R

Scale : 1" = 2'

Scale :  $1'' = 2'$

N. I. C.

Scale: 6" = 1'

**NOTE :**

Polyethylene base pads for rail shall conform to ASTM Designation D1248, Type III, Class C, Grade 5 for high density polyethylene plastic with a durometer hardness of 60 to 65 D. The hardness shall be stable between plus 140 degrees F and minus 40 degrees F.

**NOTE :**

- NOTE:
1. All concrete shall be precast  
 $f_c' = 5000 \text{ p.s.i.}$
  2. All reinforcing steel shall be grade 60
  3. Sections shall have a length of 8'-0"

Scale : 1" = 1'

6/24/82	Redirected notation of (*406 to the top transverse rebar on detail titled "Precast Concrete Crossing Unit".
DATE	REVISION

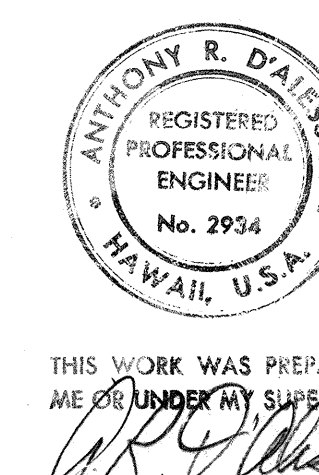

STATE OF HAWAII  
DEPARTMENT OF TRANSPORTATION  
HIGHWAYS DIVISION

## RAILROAD CROSSING DETAILS

FORT WEAVER ROAD  
VICINITY OF MANGO TREE ROAD  
TO THE VICINITY OF RENTON ROAD

SCALE: AS SHOWN      DATE: APRIL 1982

SHEET No. 1 OF 1 SHEETS